

**LEGEND**

[Symbol]	SITE BOUNDARY	[Symbol]	EXISTING ADJACENT LEGAL LINE
[Symbol]	LIMIT OF SITE PLAN CONTROL APPLICATION	[Symbol]	EXISTING CULVERT
[Symbol]	PROPOSED LIGHT DUTY SILT FENCE (AS PER O.P.S.D. 219.110)	[Symbol]	EXISTING STORM MANHOLE
[Symbol]	PROPOSED STRAW BALE (AS PER O.P.S.D. 219.180)	[Symbol]	EXISTING CATCHBASIN
[Symbol]	EXISTING BARRIER CURB TO BE REMOVED	[Symbol]	EXISTING SANITARY MANHOLE
[Symbol]	PROPOSED ASPHALT REMOVAL	[Symbol]	EXISTING HYDRANT
[Symbol]	PROPOSED MUD MAT	[Symbol]	EXISTING VALVE & VALVE BOX
[Symbol]	EXISTING LIGHT STANDARD ON CONCRETE BASE TO BE RELOCATED	[Symbol]	EXISTING CENTERLINE SWALE
[Symbol]		[Symbol]	EXISTING TOP OF GRATE ELEVATION
[Symbol]		[Symbol]	EXISTING INVERT ELEVATION
[Symbol]		[Symbol]	EXISTING OVERHEAD WIRES
[Symbol]		[Symbol]	EXISTING TRAFFIC POLE
[Symbol]		[Symbol]	EXISTING TRAFFIC MANHOLE
[Symbol]		[Symbol]	EXISTING UTILITY POLE
[Symbol]		[Symbol]	EXISTING UTILITY POLE ANCHOR
[Symbol]		[Symbol]	EXISTING TRAFFIC SIGNAL LIGHT
[Symbol]		[Symbol]	EXISTING LIGHT STANDARD ON CONCRETE BASE
[Symbol]		[Symbol]	EXISTING SIGN
[Symbol]		[Symbol]	EXISTING CONCRETE

N.T.S.  
NOTE: ALL EXISTING AND PROPOSED CATCHBASINS ARE TO HAVE AN INSERT UNTIL CONSTRUCTION OF SUBDIVISION IS COMPLETE.

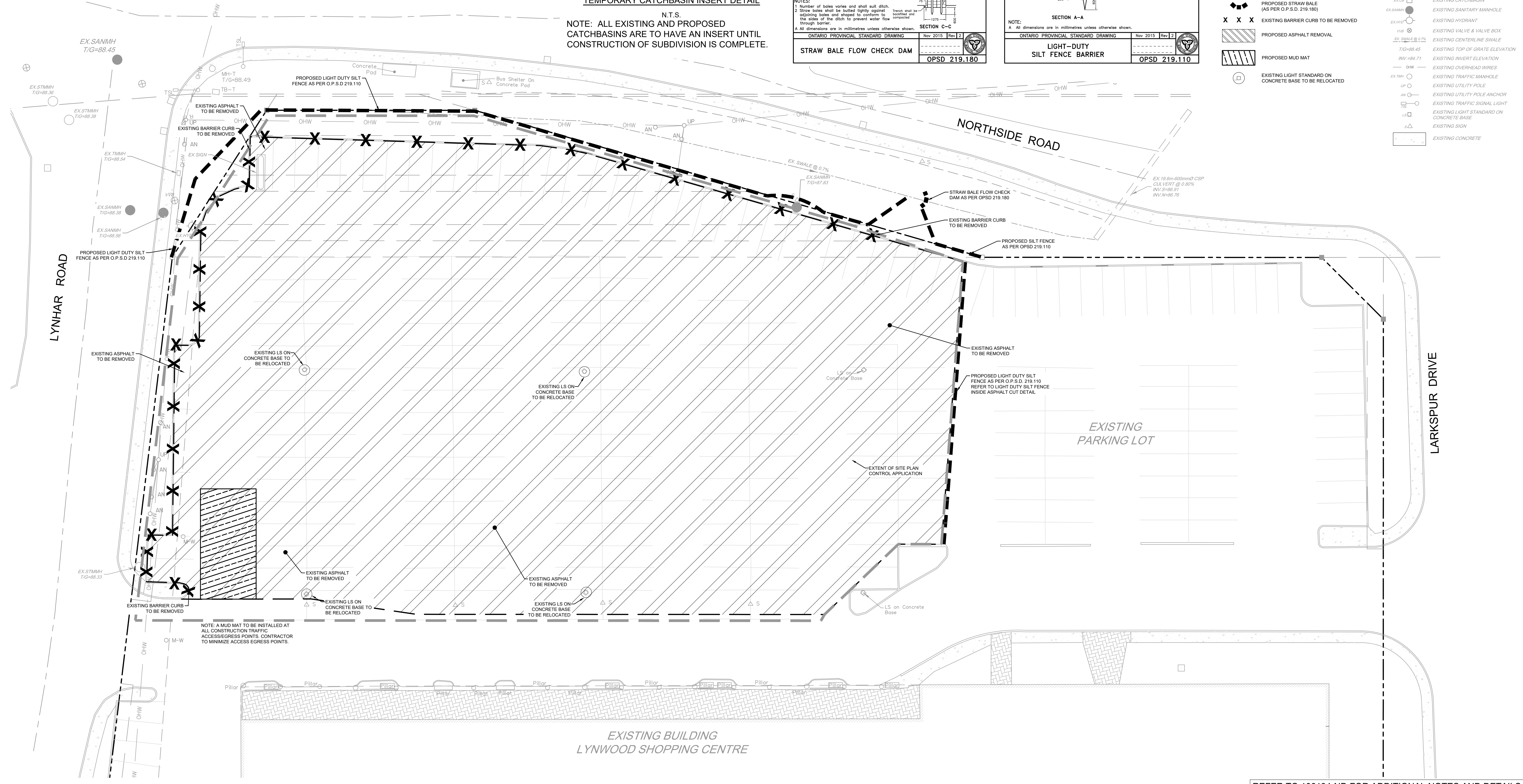

NOTE: A MUD MAT TO BE INSTALLED AT ALL CONSTRUCTION TRAFFIC ACCESS/EGRESS POINTS. CONTRACTOR TO MINIMIZE ACCESS/EGRESS POINTS.

REFER TO 106134-ND FOR ADDITIONAL NOTES AND DETAILS

NOTE: THE POSITION OF ALL POLE LINES, CONDUITS, WATERMANS, SEWERS AND OTHER UNDERGROUND AND OVERGROUND UTILITIES AND STRUCTURES IS NOT NECESSARILY SHOWN ON THE CONTRACT DRAWINGS, AND WHERE SHOWN, THE ACCURACY OF THE POSITION OF SUCH UTILITIES AND STRUCTURES IS NOT GUARANTEED. BEFORE STARTING WORK, DETERMINE THE EXACT LOCATION OF ALL SUCH UTILITIES AND STRUCTURES AND ASSUME ALL LIABILITY FOR DAMAGE TO THEM.

**PRELIMINARY  
NOT FOR  
CONSTRUCTION**

No.	REVISION	DATE	BY
4.	REVISED AS PER CITY OF OTTAWA COMMENTS	JUL 1924	SAZ
3.	REVISED AS PER CITY OF OTTAWA COMMENTS	APR 1924	SAZ
2.	REVISED AS PER CITY OF OTTAWA COMMENTS	NOV 1723	SAZ
1.	ISSUED WITH SITE PLAN APPLICATION	MAR 323	SAZ

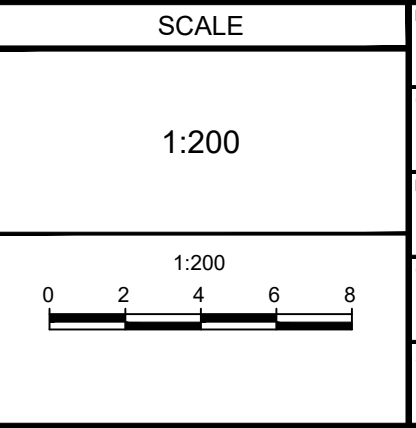

DESIGN	SAZ
CHECKED	MSP
DRAWN	MTM
CHECKED	SAZ
APPROVED	MSP

FOR REVIEW ONLY

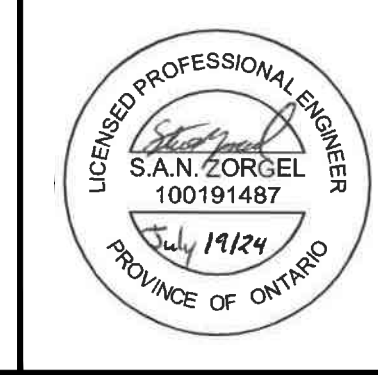

**NOVATECH**  
Engineers, Planners & Landscape Architects  
Suite 200, 240 Michael Cowpland Drive  
Ottawa, Ontario, Canada K2M 1P6  
Telephone: (613) 254-9643  
Facsimile: (613) 254-5867  
Website: www.novatech-eng.com

CITY OF OTTAWA  
1826 ROBERTSON ROAD  
LYNWOOD RETAIL PLAZA  
DRAWING NAME  
**REMOVALS AND EROSION & SEDIMENT CONTROL PLAN**

PROJECT No.: 106134-00  
REV # 4  
DRAWING No.: 106134-RM-ESC  
#19127