

Legend

- Asphalt
- Concrete
- Pavers
- Sod
- Proposed trees
- Proposed shrubs
- Proposed perennials / Ornamental Grasses
- Accessible parking
- Electric vehicle plug-in parking
- Existing trees
- Critical Root Zone
- Existing wood screen fence
- Sound attenuation fence
- Tree protection fence
- 4.5m Geotechnical offset
- 7.5m Geotechnical offset

Plant List

| ID | Qty | Botanical Name | Common Name | Scheduled Size | Remarks |
|---------------------------|-----|--|---|----------------|--------------|
| TREES | | | | | |
| As | 1 | Acer rubrum 'Autumn Spire' | Red Maple | 70mm caliper | WB, Staked |
| GtD | 1 | Gleditsia triacanthos inermis 'Draves' | Streetkeeper Honeylocust | 70mm caliper | WB, Staked |
| Mj | 1 | Malus Evereste | Domestic Apple | 50mm caliper | WB, Staked |
| MHG | 1 | Malus x 'Harvest Gold' | Harvest Gold Crabapple | 50mm caliper | WB, Staked |
| PcN | 1 | Pinus cembra 'Nana' | Dwarf Swiss Stone Pine | 100 cm ht | WB, specimen |
| Pc | 2 | Pyrus calleryana | Callery Pear | 70mm caliper | WB, Staked |
| Qr | 1 | Quercus robur | English Oak | 50mm caliper | WB Staked |
| SrIP | 1 | Syringa reticulata 'Ivory Silk' | Ivory Silk Tree Lilac | 50mm caliper | WB, Staked |
| SHRUBS | | | | | |
| CaW | 1 | Caragana arborescens 'Walker' | Walker's Weeping Peashrub | 125cm STEM | WB, specimen |
| PoDM | 13 | Physocarpus opulifolius 'Donna May' | Little Devil Ninebark | 2 gallon pot | Potted |
| Sp | 8 | Spiraea prunifolia | Bridal Wreath Spirea | 50 cm ht. | Bare root |
| SpMK | 9 | Syringa patula 'Miss Kim' | Miss Kim Dwarf Lilac | 100cm ht. | 3 gallon Pot |
| ToH | 10 | Thuja occidentalis 'Holmstrup' | Holmstrup Eastern Arborvitae | 100 cm ht. | Potted |
| ORNAMENTAL GRASSES | | | | | |
| CaKF | 108 | Calamagrostis x acutiflora 'Karl Foerster' | Karl Foerster Feather Reed Grass | 1 gallon pot | Potted |
| PvHM | 37 | Panicum virgatum 'Heavy Metal' | Heavy Metal Switch Grass | 1 gallon pot | Potted |
| PERENNIALS | | | | | |
| PvA | 130 | Sun perennials (minimum 3 species mix) | Purple Coneflower, Shasta Daisy, Russian Sage | | |
| PvB | 40 | Shade perennials (minimum 3 species mix) | Hostas, Ferns, Rodgersia | | |
| PvC | 190 | Shade groundcovers (minimum 3 species mix) | Cranesbill, Spotted Dead Nettle, Woodland Stonecrop | | |

CONTRACTOR TO REPORT ANY DISCREPANCIES FOUND BETWEEN PLAN & PLANT LIST PRIOR TO PLANTING

| Soil Volume Area, Tree Quantity and Size | Tree Quantity | OTTAWA TARGET SOIL VOLUME (m3) | Design Soil Volume | SOIL ADEQUACY percentage |
|---|---------------|--------------------------------|--------------------|--------------------------|
| AREA A - 1 medium shade tree plant bed (34.5 sq m x 0.7 avg metre deep) | 1 | 25.0 | 24.2 | 96.80% |
| AREA B - 1 small columnar evergreen (10cm DBH)* plant bed (11 sq m x 0.6 avg metre deep) | 1 | 6.0 | 6.6 | 110.00% |
| AREA C - 1 small shade tree, 1 small ornamental tree (15cm DBH)*, 1 small ornamental tree (8cm DBH)* plant bed (67 sq m x 0.4 avg metre deep) | 3 | 21.1 | 26.8 | 127.01% |
| AREA D - 2 large shade trees plant bed (30.7 sq m x 1 avg metre deep) | 2 | 36.0 | 30.7 | 85.28% |
| AREA E - 4 large shrubs* plant bed (14.8 sq m x 0.4 avg metre deep) | 4 | 5.6 | 5.9 | 105.71% |

* Small ornamental trees with growth to 8-15cm DBH using 'How much soil to grow a big tree' by DeepRoot as a guide. Small ornamental, upright evergreens used close to building in accordance with geotechnical report.

4.5 metre offset – allowance for low water requirement plants such as small ornamental plants such as horticultural cedars, junipers, grafted deciduous such as caragana, small crab apples under 4.5 metre height.

4.5 to 7.5 metre offset – allowance for low water requirement trees up to 7.5 metre mature height.

Beyond 7.5 metres – low water requirement trees 7.5 to 14 metre mature height. Trees over 14 metre mature height to be planted mature height away from building.

ALL PLANT MATERIAL SHALL BE WARRANTED FOR TWO YEARS FROM THE DATE OF SUBSTANTIAL PERFORMANCE AS DETERMINED BY THE CITY OF OTTAWA.

NOTE
THIS PLAN IS ISSUED FOR SITE PLAN CONTROL SUBMISSION ONLY. ADDITIONAL DETAILING AND SPECIFICATIONS ARE REQUIRED PRIOR TO TENDERING OR CONSTRUCTION.

DRAWING TO BE READ IN CONJUNCTION WITH TREE CONSERVATION REPORT. REFER TO TREE CONSERVATION REPORT PREPARED BY JES DATED 2021-11-18 FOR TREE PROTECTION MEASURES AND DETAILS. MAP REVISED 2022-07-08

- GENERAL NOTES**
- All general site information and conditions compiled from existing plans, surveys and consultant's field notes. Report all discrepancies prior to any work. No responsibility is born by the Consultant for unknown subsurface conditions.
 - The location of the utilities is approximate only, and the exact location should be determined by consulting the municipal authorities and utility companies concerned. The Contractor shall prove the location of utilities and shall be responsible for adequate protection from damage.
 - All dimensions shown are to be verified on site prior to any construction. No deviations are to be made from the layouts as shown on this plan without prior consultation with the Landscape Architect and Owner.
 - Obtain approval of Landscape Architect for granular base and layout of all pavement areas prior to construction.
 - Stake planting locations and receive approval of Landscape Architect, prior to excavation of any planting pits. No substitutions of plant material shall be made without prior approval of the Landscape Architect.
 - Where clay is encountered proper drainage must be ensured in tree/shrub pits, prior to planting. Have method approved by Landscape Architect.
 - All sodded areas to receive a minimum of 150mm of topsoil over graded sub-base. If sod with mesh is used, mesh to be removed completely during sodding operations. Sod shall come from an approved source and shall be laid within 24 hours of being cut in the nursery. Only nursery sod shall be used.
 - Final subgrade is to be approved by the Landscape Architect prior to sod being laid.
 - Maintain positive surface runoff through the entire construction period.
 - Reinstate all areas and items damaged as a result of construction activities.

| no. | issue / revision | date |
|-----|---------------------------|------------|
| 6 | Re-issued SPC submission | 2024/07/05 |
| 5 | Re-issued SPC submission | 2023/07/20 |
| 4 | Re-issued SPC submission | 2023/04/24 |
| 3 | Re-issued SPC submission | 2023/01/09 |
| 2 | Re-issued SPC submission | 2022/07/08 |
| 1 | Issued for SPC submission | 2021/11/22 |

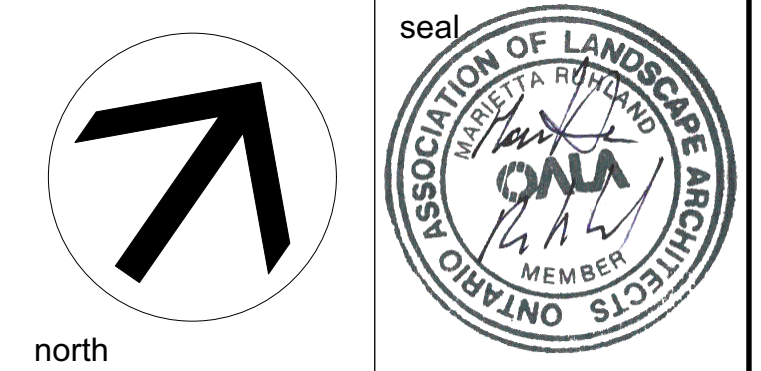

Ruhland & Associates Ltd
landscape architecture • urban design • site planning
Ph: 613-224-4244 Fx: 613-224-1331 info@rala.ca www.rala.ca

project
**3996 INNES RD,
OTTAWA ON**

drawing title
LANDSCAPE PLAN

| | | |
|----------------------------------|---------------------------------|--------------------------|
| scale 1:100 | drawn by C. Reed/T. Frost | designed by C. Reed |
| date November 2021 | checked by M. Ruhland | plot date Nov10, 2021 |
| project number 21-1647 | drawing number L - 01 | |

Contractor to check and verify all dimensions on the job

SOIL VOLUME NOTES TO GO WITH L1

TREE SOIL VOLUME REQUIREMENTS:
 - STANDARD TREE SOIL VOLUMES QUANTITIES INCLUDE THE TOP 900-1000mm OF SOIL/EXISTING SUBSOIL LAYER TO CALCULATE TOTAL SOIL VOLUMES REQUIRED BY CITY OF OTTAWA FOR SUSTAINABLE TREE GROWTH. WHERE LARGER SOFT AREAS ARE AVAILABLE, THE TOP 400-500mm LAYER IS USED TO CALCULATE SOIL VOLUMES.

- WHERE EXISTING MATERIAL BELOW THE SPECIFIED TOPSOIL IS NOT CONDUCTIVE TO TREE GROWTH, AN ADDITIONAL LAYER OF PLANTING MEDIUM IS TO BE INSTALLED BELOW SPECIFIED TOPSOIL DEPTH TO OBTAIN THE SOIL VOLUME DEPTH REQUIRED.

- REFER TO SOIL VOLUME CHART AND PLANS FOR AREA WHERE TREE SOIL VOLUMES ARE REQUIRED.

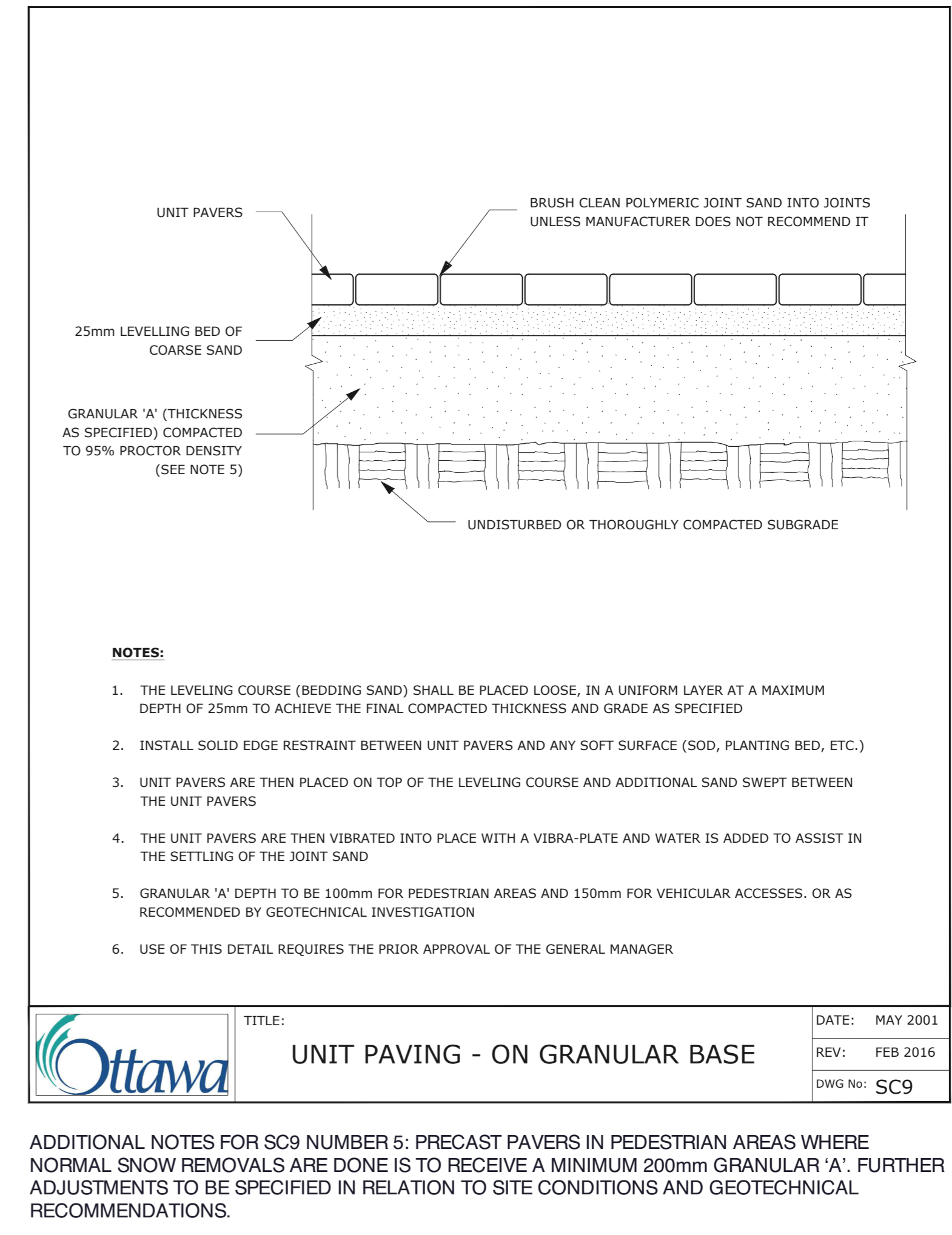
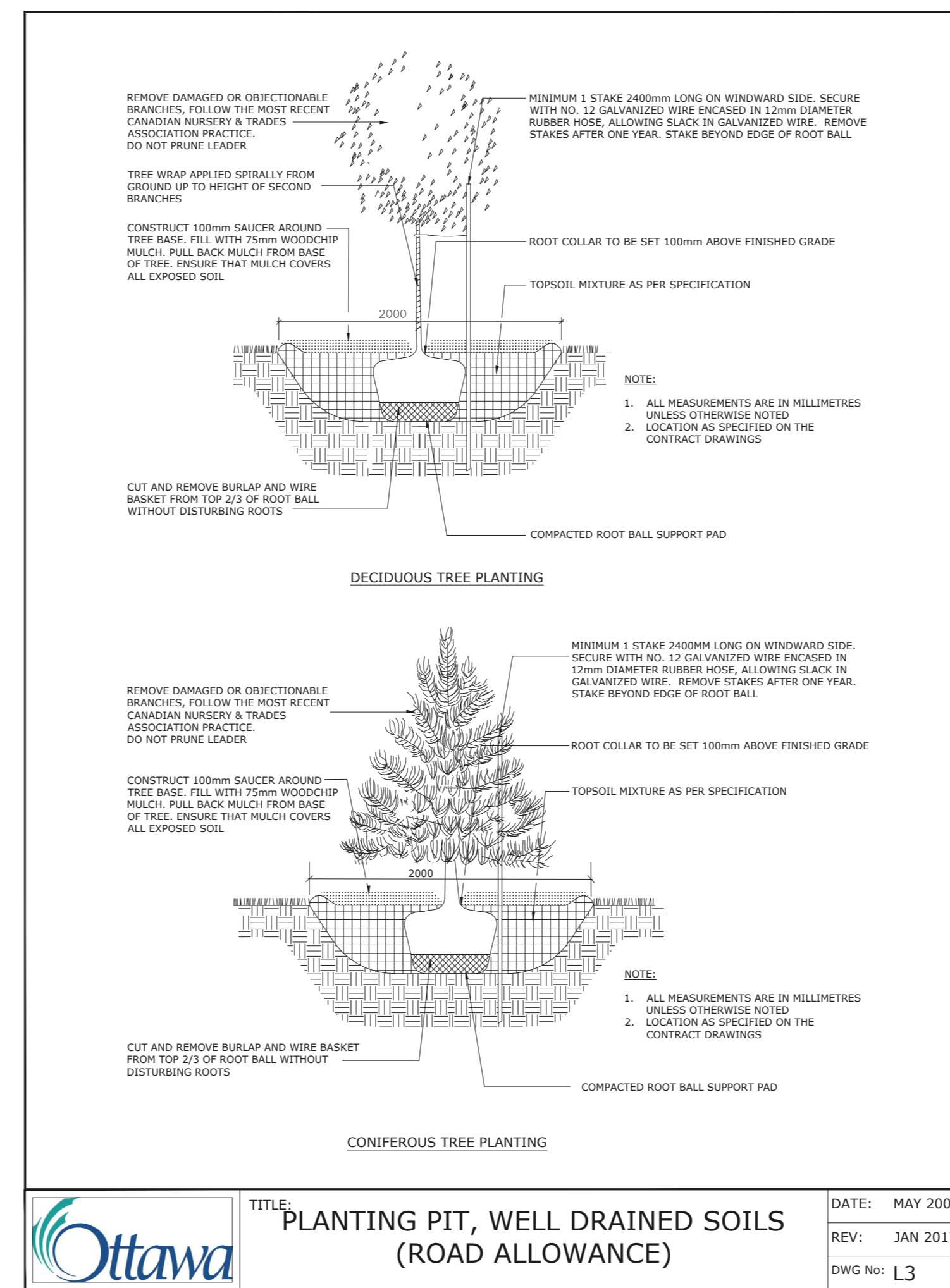
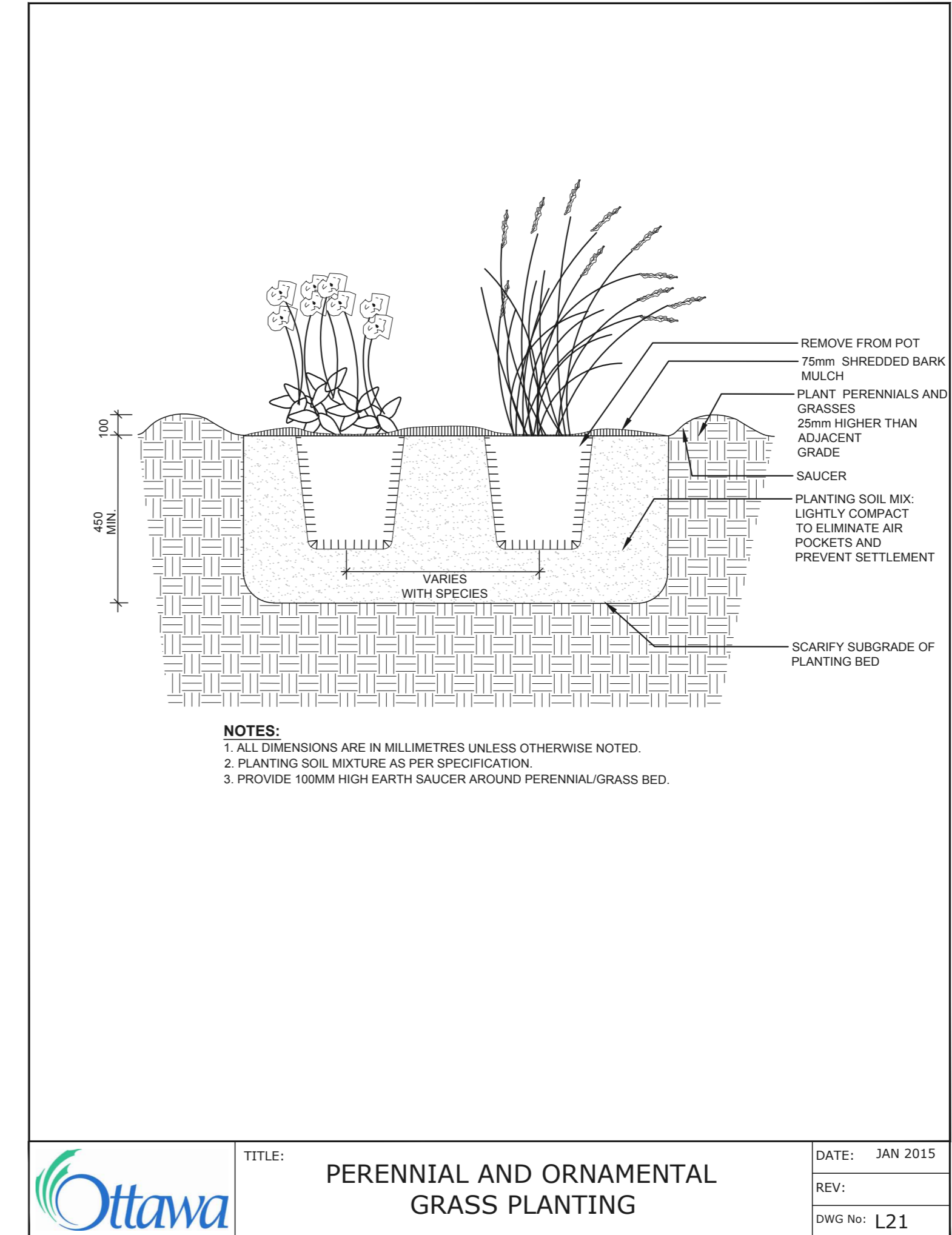
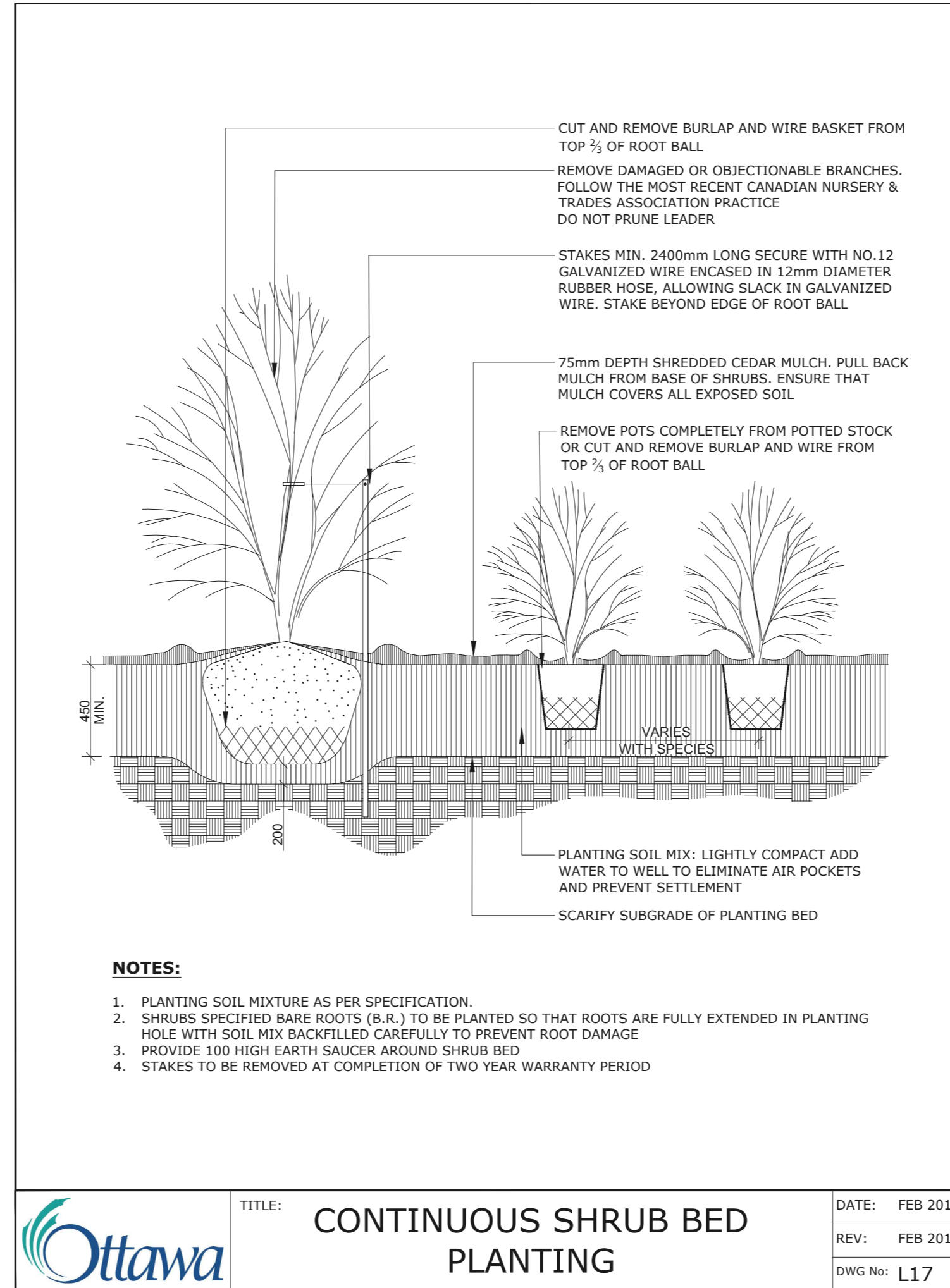
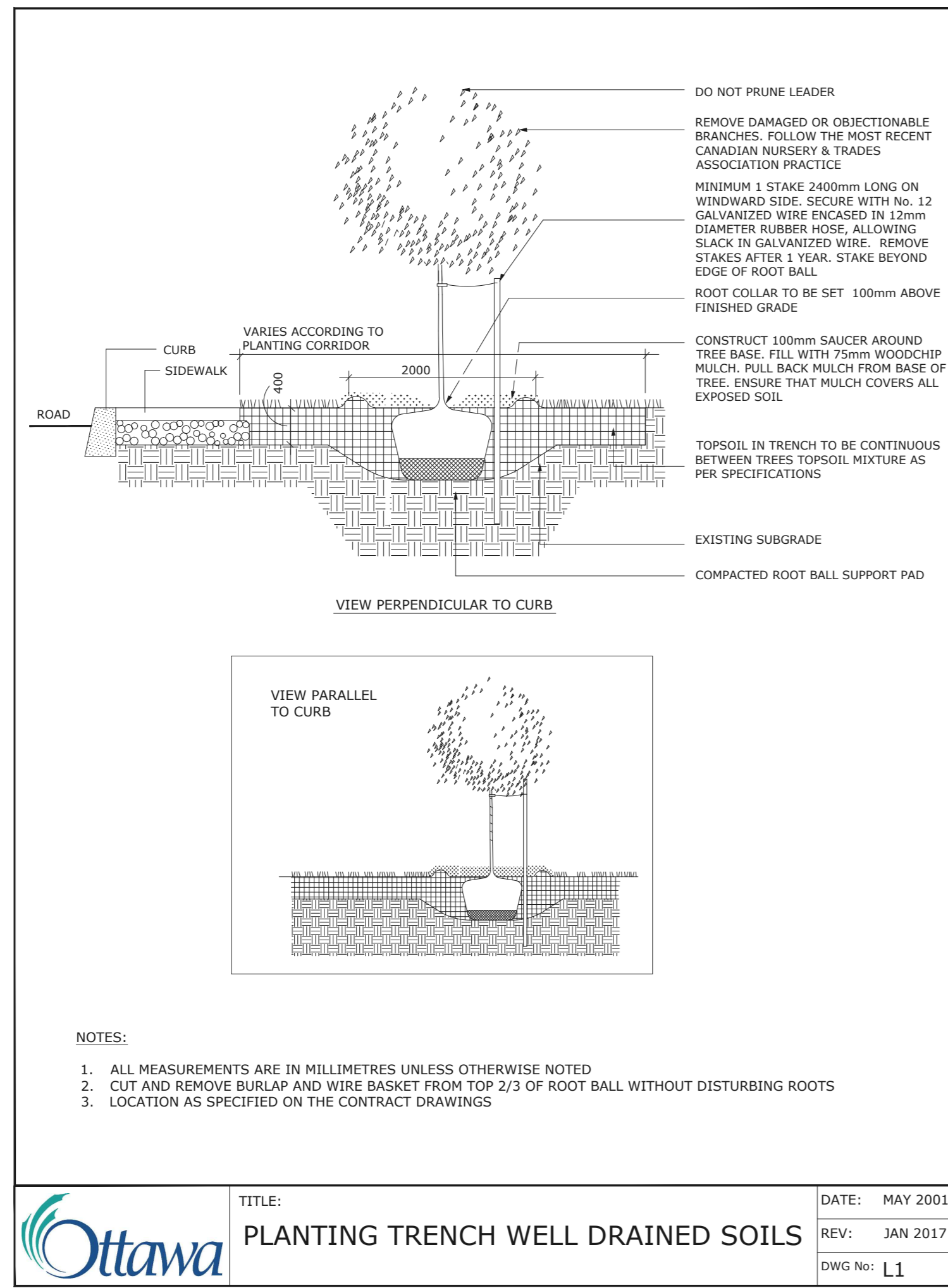

- GENERAL NOTES**
- All general site information and conditions compiled from existing plans, surveys and consultant's field notes. Report all discrepancies prior to any work. No responsibility is born by the Consultant for unknown subsurface conditions.
 - The location of the utilities is approximate only, and the exact location should be determined by consulting the municipal authorities and utility companies concerned. The Contractor shall prove the location of utilities and shall be responsible for adequate protection from damage.
 - All dimensions shown are to be verified on site prior to any construction. No deviations are to be made from the layouts as shown on this plan without prior consultation with the Landscape Architect and Owner.
 - Obtain approval of Landscape Architect for granular base and layout of all pavement areas prior to construction.
 - Stake planting locations and receive approval of Landscape Architect, prior to excavation of any planting pits. No substitutions of plant material shall be made without prior approval of the Landscape Architect.
 - Where clay is encountered proper drainage must be ensured in tree/shrub pits, prior to planting. Have method approved by Landscape Architect.
 - All sodded areas to receive a minimum of 150mm of topsoil over graded sub-base. If sod with mesh is used, mesh to be removed completely during sodding operations. Sod shall come from an approved source and shall be laid within 24 hours of being cut in the nursery. Only nursery sod shall be used.
 - Final subgrade is to be approved by the Landscape Architect prior to sod being laid.
 - Maintain positive surface runoff through the entire construction period.
 - Reinstate all areas and items damaged as a result of construction activities.

| | | |
|---|--------------------------|------------|
| 6 | Re-issued SPC submission | 2024/07/05 |
| 5 | Re-issued SPC submission | 2023/07/20 |
| 4 | Re-issued SPC submission | 2023/04/24 |
| 3 | Re-issued SPC submission | 2023/01/09 |
| 2 | Re-issued SPC submission | 2022/07/08 |
| 1 | Issued for SPC revision | 2021/11/22 |

| no. | issue / revision | date |
|-----|------------------|------|
| | | |

Ruhland & Associates Ltd
 landscape architecture • urban design • site planning
 Ph 613-224-4744 Fx 613-224-1313 info@ral.ca www.ral.ca

project
**3996 INNES RD,
 OTTAWA ON**

DETAILS

| | | |
|----------------------------------|---------------------------------|--------------------------|
| scale | drawn by C. Reed/T. Frost | designed by C. Reed |
| date November 2021 | checked by M. Ruhland | plot date Nov10, 2021 |
| project number 21-1647 | drawing number L - 02 | |

Contractor to check and verify all dimensions on the job

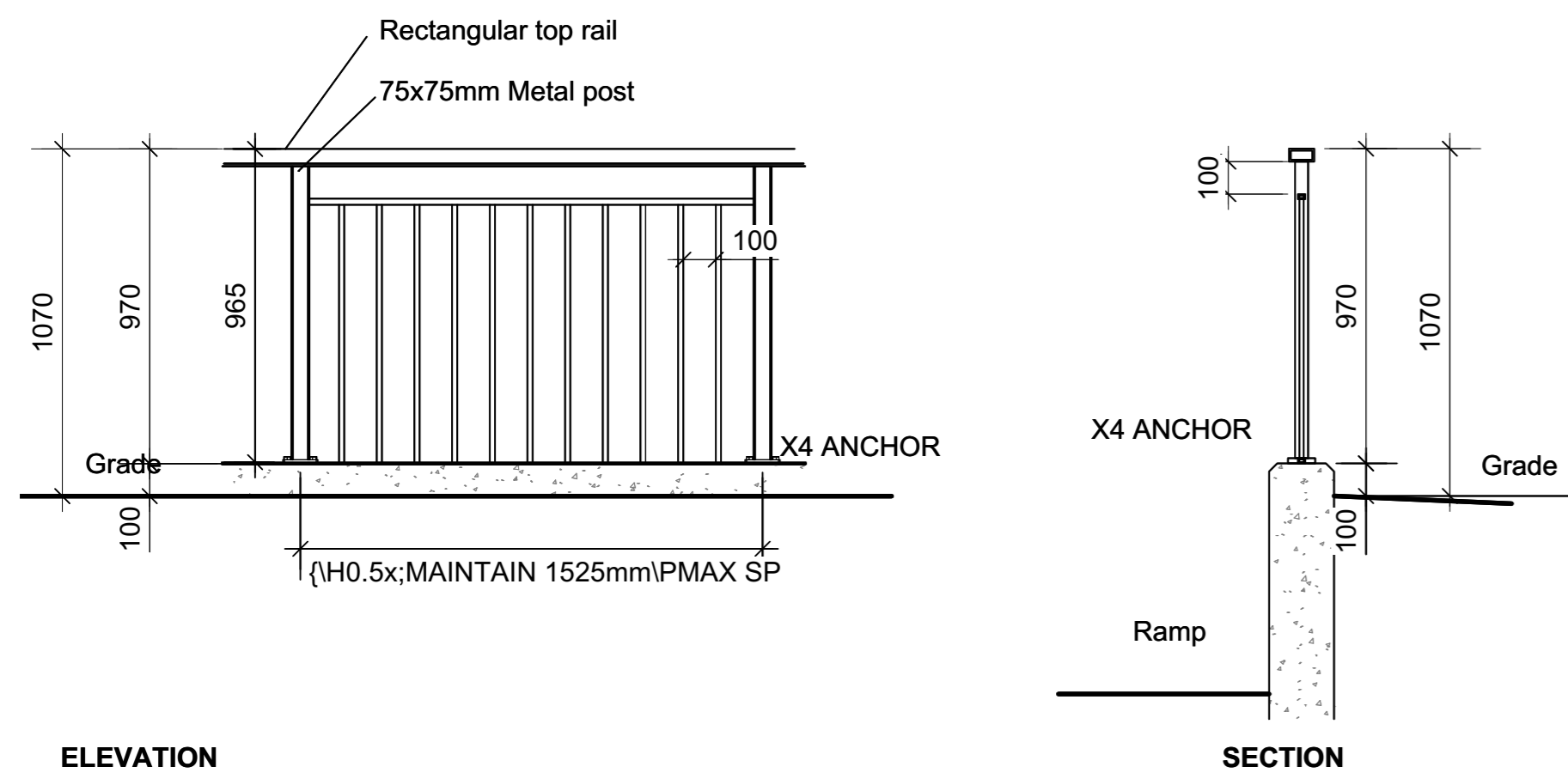

ELEVATION

1 METALLIC GUARD RAIL
Scale: NTS
REFER TO SITE PLAN FOR LOCATIONS



3 SKYLINE OUTDOOR PATIO HARD-TOP GAZEBO
Canvas, w/ Bug Net, Black 10'x12'



4 GLOBAL INDUSTRIAL 4' PARK BENCH
Tan, w/Backrest

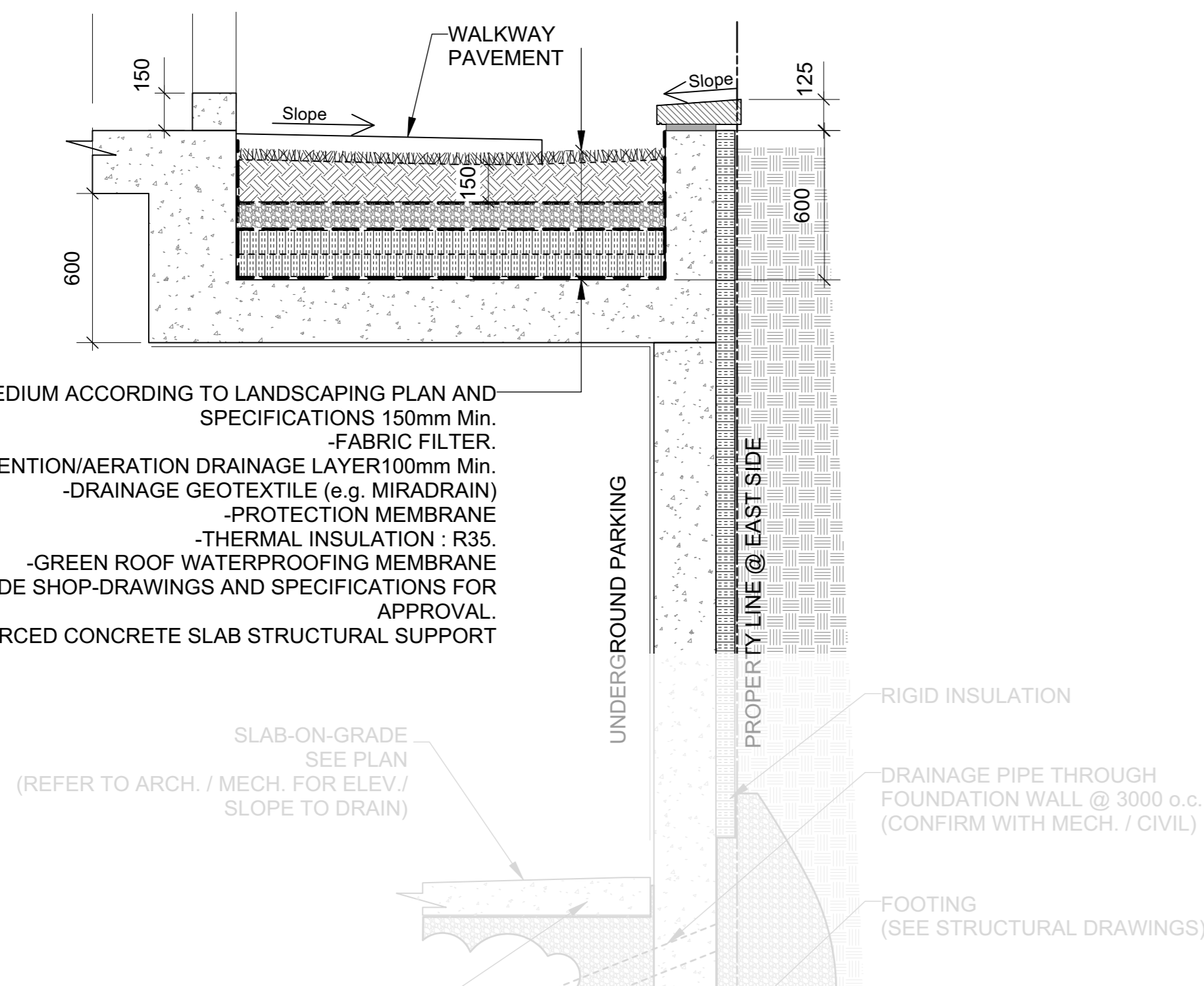

2 SECTION ALONG EAST PROPERTY LINE
Scale: NTS

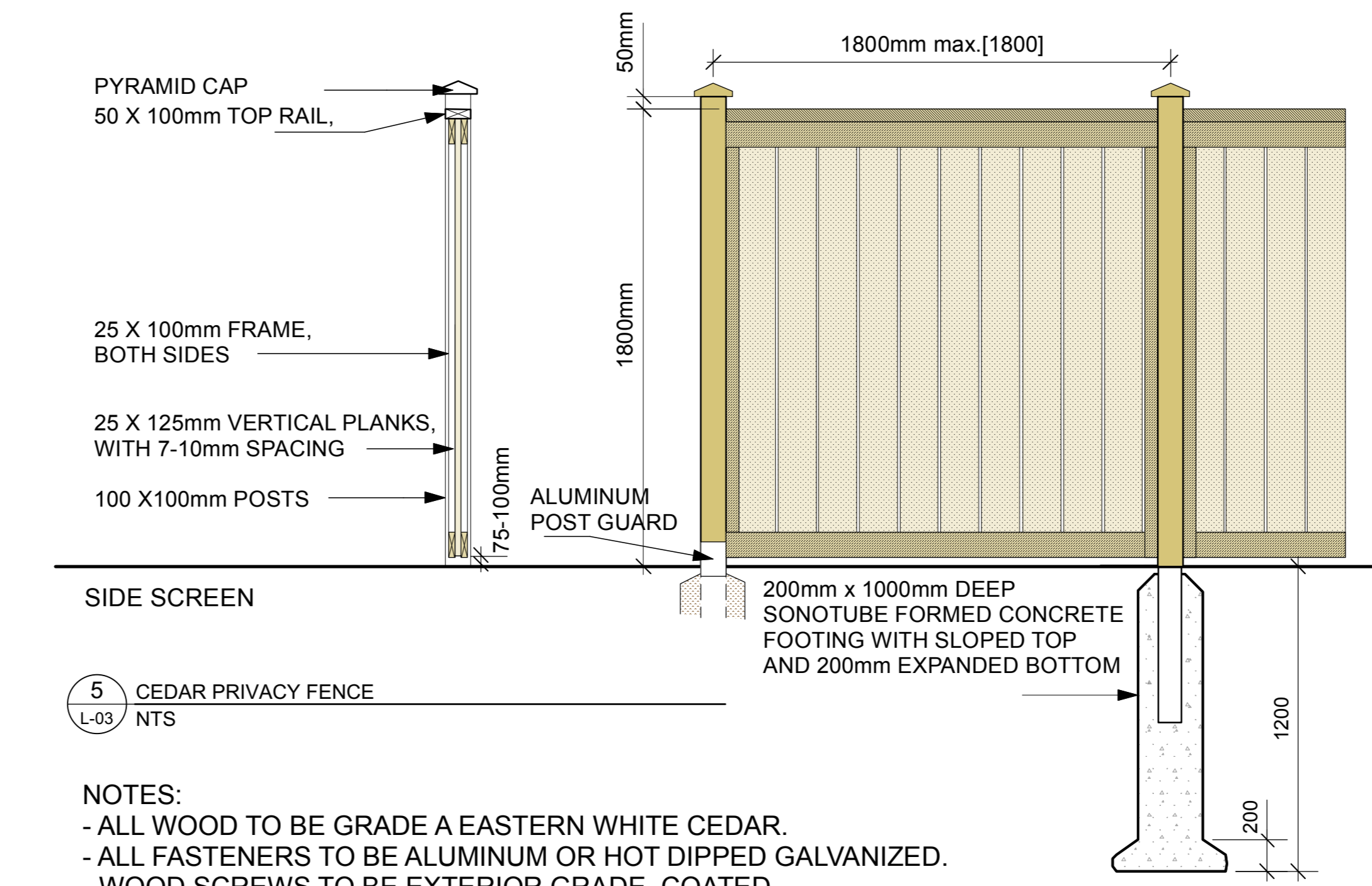

5 CEDAR PRIVACY FENCE
NTS

NOTES:
- ALL WOOD TO BE GRADE A EASTERN WHITE CEDAR.
- ALL FASTENERS TO BE ALUMINUM OR HOT DIPPED GALVANIZED.
- WOOD SCREWS TO BE EXTERIOR GRADE, COATED.
- WOOD FENCE TO BE LEFT NATURAL.
- PROVIDE MOCKUP SAMPLE.

- GENERAL NOTES**
- All general site information and conditions compiled from existing plans, surveys and consultant's field notes. Report all discrepancies prior to any work. No responsibility is born by the Consultant for unknown subsurface conditions.
 - The location of the utilities is approximate only, and the exact location should be determined by consulting the municipal authorities and utility companies concerned. The Contractor shall prove the location of utilities and shall be responsible for adequate protection from damage.
 - All dimensions shown are to be verified on site prior to any construction. No deviations are to be made from the layouts as shown on this plan without prior consultation with the Landscape Architect and Owner.
 - Obtain approval of Landscape Architect for granular base and layout of all pavement areas prior to construction.
 - Stake planting locations and receive approval of Landscape Architect, prior to excavation of any planting pits. No substitutions of plant material shall be made without prior approval of the Landscape Architect.
 - Where clay is encountered proper drainage must be ensured in tree/shrub pits, prior to planting. Have method approved by Landscape Architect.
 - All sodded areas to receive a minimum of 150mm of topsoil over graded sub-base. If sod with mesh is used, mesh to be removed completely during sodding operations. Sod shall come from an approved source and shall be laid within 24 hours of being cut in the nursery. Only nursery sod shall be used.
 - Final subgrade is to approved by the Landscape Architect prior to sod being laid.
 - Maintain positive surface runoff through the entire construction period.
 - Reinstate all areas and items damaged as a result of construction activities.

| | | |
|---|---------------------------|------------|
| 6 | Re-issued SPC submission | 2024/07/05 |
| 5 | Re-issued SPC submission | 2023/07/20 |
| 4 | Re-issued SPC submission | 2023/04/24 |
| 3 | Re-issued SPC submission | 2023/01/09 |
| 2 | Re-issued SPC submission | 2022/07/08 |
| 1 | Issued for SPC submission | 2021/11/22 |

| no. | issue / revision | date |
|-------|------------------|------|
| seal | | |
| | | |
| north | | |

Ruhland & Associates Ltd
landscape architecture • urban design • site planning
Ph 613-224-4744 Fx 613-224-1331 info@rala.ca www.rala.ca

project
**3996 INNES RD,
OTTAWA ON**

| | | |
|----------------------------------|---------------------------------|--------------------------|
| DETAILS | | |
| scale | drawn by C. Reed/T. Frost | designed by C. Reed |
| date November 2021 | checked by M. Ruhland | plot date Nov10, 2021 |
| project number 21-1647 | drawing number L - 03 | |

Contractor to check and verify all dimensions on the job