

REFER TO NOTES
ON DRAWING C-4

ROOF NORTH OF PENTHOUSE: INSTALL A MINIMUM OF 2 SCUPPERS, EACH A MINIMUM 230mm WIDE. BOTTOM OF SCUPPERS SHALL BE 150mm ABOVE ROOF DRAIN (REFER TO ARCHITECTURAL FOR EXACT LOCATIONS AND DETAILS). ROOF SHALL BE DESIGNED TO CARRY THE LOAD OF WATER HAVING A 50mm DEPTH AT SCUPPER OR 200mm DEPTH AT ROOF DRAIN (REFER TO STRUCTURAL).

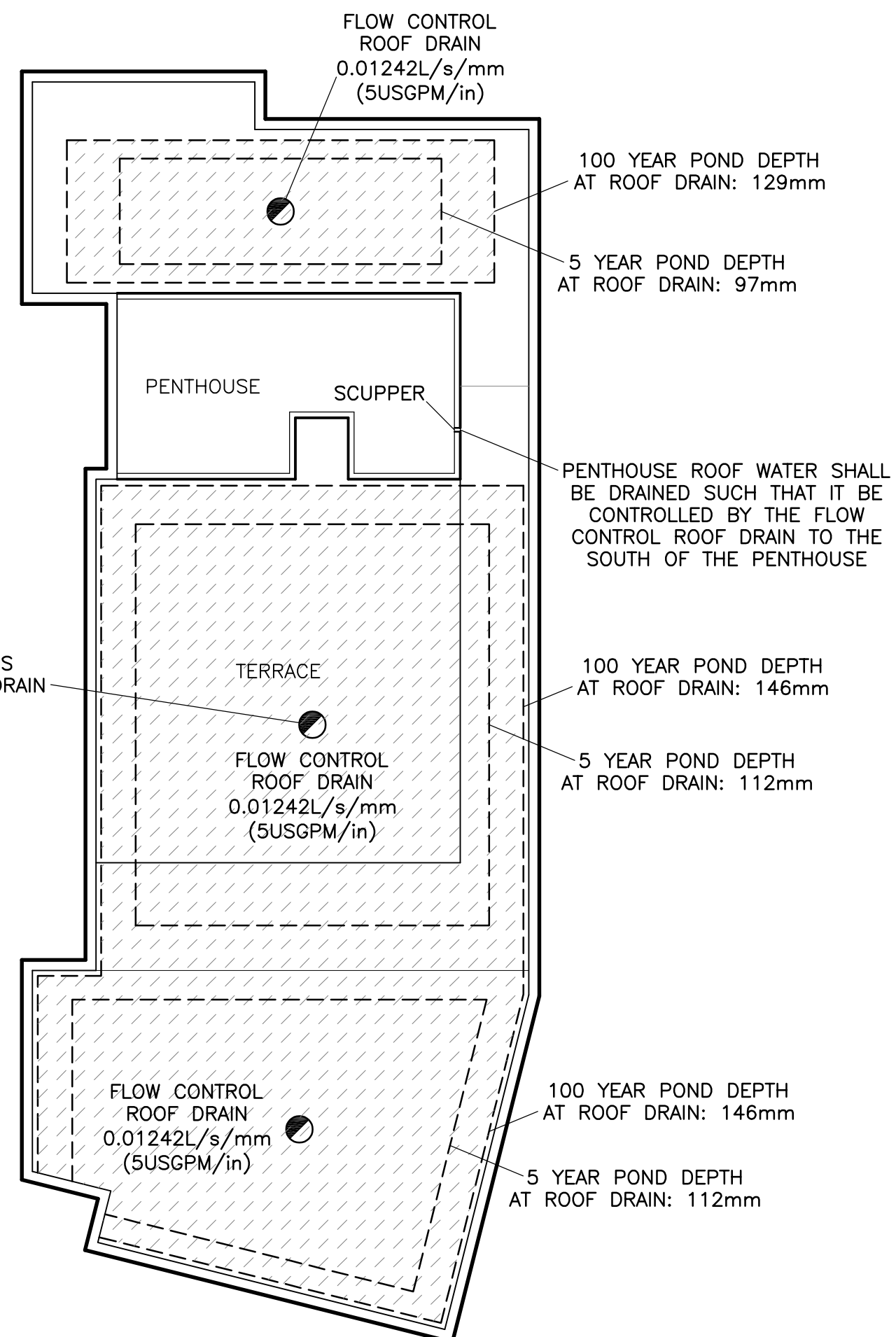

ROOF SOUTH OF PENTHOUSE: INSTALL A MINIMUM OF 6 SCUPPERS, EACH A MINIMUM 310mm WIDE. BOTTOM OF SCUPPERS SHALL BE 150mm ABOVE ROOF DRAINS (REFER TO ARCHITECTURAL FOR EXACT LOCATIONS AND DETAILS). ROOF SHALL BE DESIGNED TO CARRY THE LOAD OF WATER HAVING A 50mm DEPTH AT SCUPPER OR 200mm DEPTH AT ROOF DRAIN (REFER TO STRUCTURAL).

Andrew McCreight

ANDREW MCCREIGHT
MANAGER, DEVELOPMENT REVIEW CENTRAL
PLANNING, DEVELOPMENT & BUILDING SERVICES
DEVELOPMENT DEPARTMENT, CITY OF OTTAWA

APPROVED
By Andrew McCreight at 9:00 am, Jun 24, 2024

ROOF PLAN

REFER TO NOTES
ON DRAWING C-4

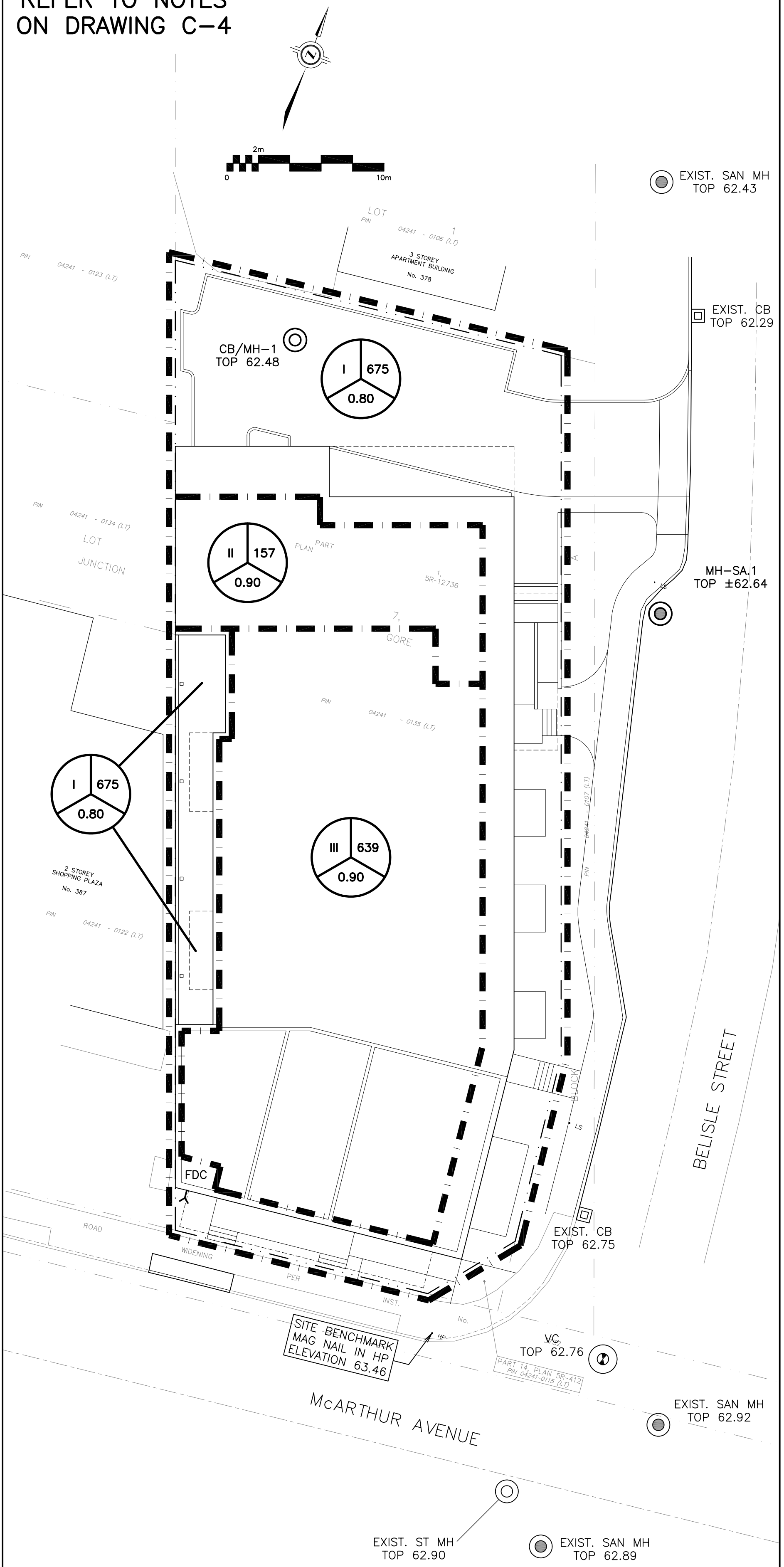

DRAINAGE PLAN

LEGEND

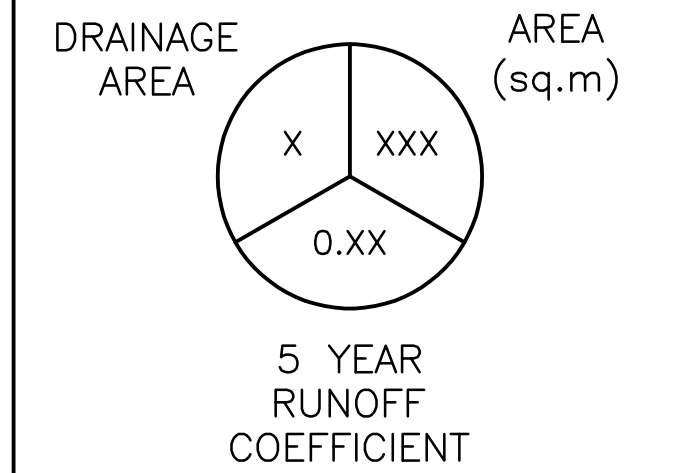

KEY PLAN

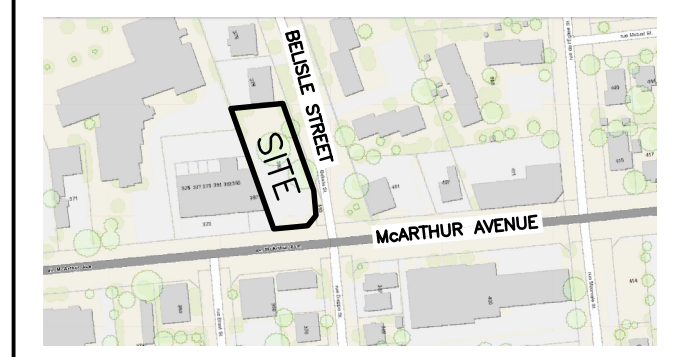

| No. | DATE | REVISION |
|-----|-----------|-------------------------|
| 3 | SEP 22-22 | RE-ISSUED FOR APPROVAL |
| 2 | JUN 15-22 | ISSUED FOR APPROVAL |
| 1 | APR 27-22 | ISSUED FOR COORDINATION |

D. B. GRAY ENGINEERING INC.
Stormwater Management - Grading & Drainage - Storm & Sanitary Sewers - Watermain
700 Long Point Circle 613-425-8044
Ottawa, Ontario d.gray@dbgrayengineering.com

Project
PROPOSED 6-STORY MIXED-USE BUILDING
393 McARTHUR AVENUE
OTTAWA, ONTARIO

Drawing Title
ROOF PLAN AND DRAINAGE PLAN

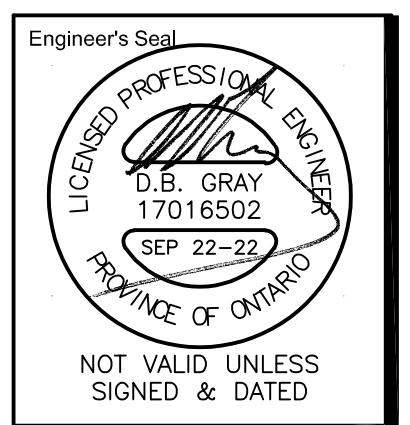

Drawn D.B.G.
H. Scale 1:200
V. Scale
Date APR 27-22
Job No. 21111

Drawing No.
C-3
of 4

NOT VALID UNLESS SIGNED & DATED