

SAN STRUCTURE TABLE				
NAME	RIM ELEV.	INVERT IN	INVERT OUT	DESCRIPTION
MH1A	84.47	NW81.820	SW81.760	STRUC OPSD 701.010 FRAME CITY S25 COVER CITY S24
MH1B	84.50	NW81.141	SE81.090	STRUC OPSD 701.010 FRAME CITY S25 COVER CITY S24
MH1C	84.78	S81.180 NW80.990	E80.921	STRUC OPSD 701.010 FRAME CITY S25 COVER CITY S24
MH1D	84.20	W80.640 SE80.650	NW80.582	STRUC OPSD 701.011 FRAME CITY S25 COVER CITY S24
MHSA46203	84.24	NE81.690 SW81.360	SE81.350	EXISTING MH
MHSA46208	85.10	S81.280 SW81.300	N81.270	EXISTING MH
MHSA50442	84.30	SE80.510	N80.500	EX.MH

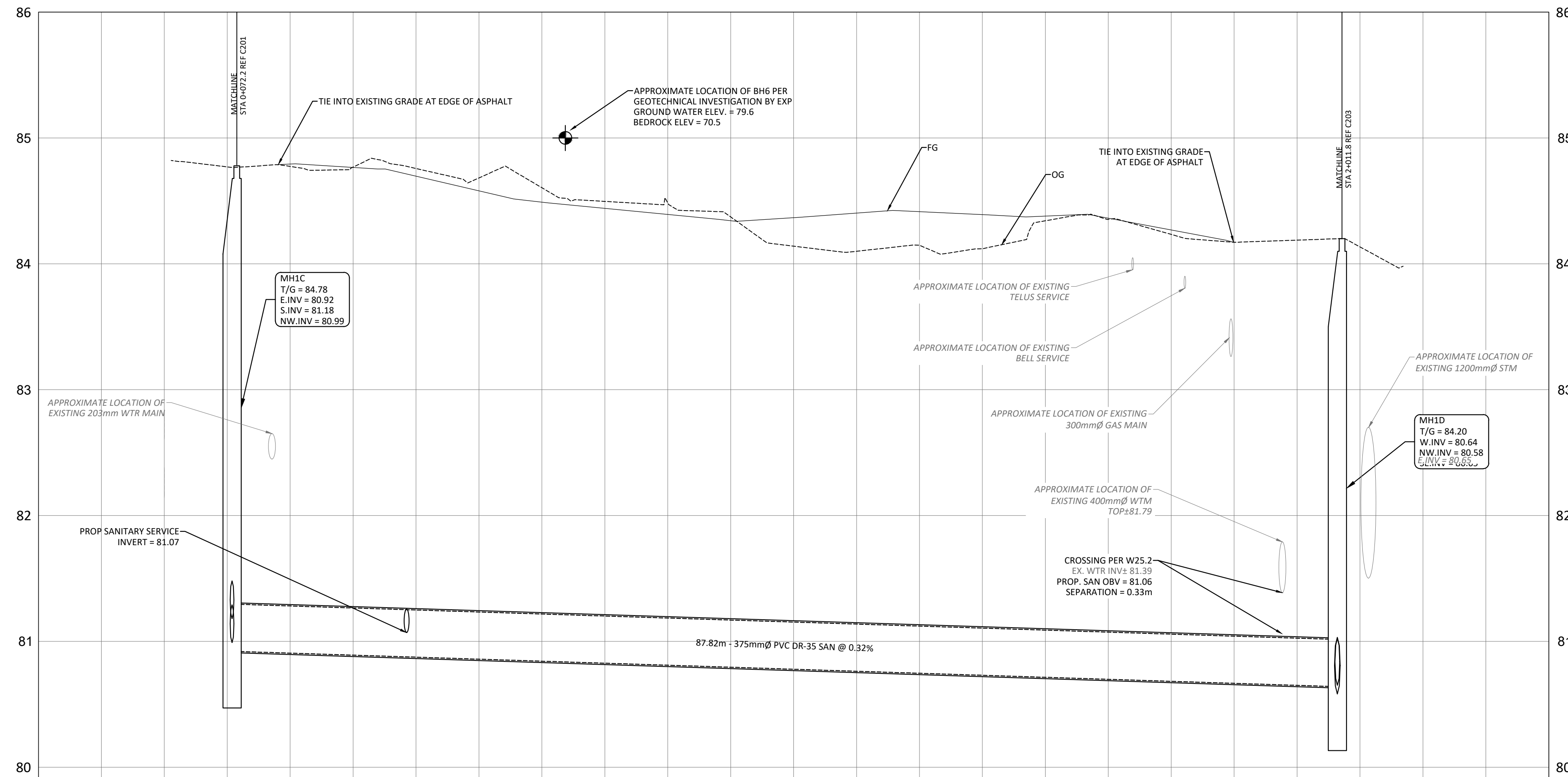

LEGEND	
DC	BARRIER CURB & CURB DEPRESSION
Proposed Concrete Sidewalk/Walkway	PROPOSED CONCRETE SIDEWALK/WALKWAY
Storm Manhole	STORM MANHOLE
Catchbasin, Curb Inlet or Ditch Inlet	CATCHBASIN, CURB INLET OR DITCH INLET
Sanitary Manhole	SANITARY MANHOLE
Property Line	PROPERTY LINE
Water Valve/Chamber	WATER VALVE/CHAMBER
Fire Hydrant	FIRE HYDRANT
Proposed Fire Department Connection	PROPOSED FIRE DEPARTMENT CONNECTION
Proposed Water Meter and Remote Meter	PROPOSED WATER METER AND REMOTE METER
Sediment Control Device	SEDIMENT CONTROL DEVICE PER DETAIL
Curb Opening	CURB OPENING PER OPSD 604.010
Existing Storm Sewer	EXISTING STORM SEWER
Existing San Sewer	EXISTING SAN SEWER
Proposed Watermain/Service	PROPOSED WATERMAIN/SERVICE
Proposed San Sewer/Service	PROPOSED SAN SEWER/SERVICE
Proposed STM Sewer/Service	PROPOSED STM SEWER/SERVICE
Proposed Perforated STM Sewer/Service	PROPOSED PERFORATED STM SEWER/SERVICE
Sloping at 3:1 unless specified	SLOPING AT 3:1 UNLESS SPECIFIED
Proposed Elevation	PROPOSED ELEVATION
Existing Elevation	EXISTING ELEVATION
Top/Bottom Wall Face Elevations	TOP/BOTTOM WALL FACE ELEVATIONS
Proposed Emergency Overland Flow Route	PROPOSED EMERGENCY OVERLAND FLOW ROUTE
Existing Drainage Pattern	EXISTING DRAINAGE PATTERN
Heavy Duty Silt Fence Barrier	HEAVY DUTY SILT FENCE BARRIER PER OPSD 219.130
Building Entrance	BUILDING ENTRANCE
Twsi	TWSI PER SC7.1
Centreline of Swale	CENTRELINE OF SWALE
Proposed Roadcut and Reinstatement	PROPOSED ROADCUT AND REINSTATEMENT PER CITY R10
Temporary Construction Mud Mat	TEMPORARY CONSTRUCTION MUD MAT PER DETAIL
Existing Hydro Line	EXISTING HYDRO LINE
Existing OHW	EXISTING OHW
Existing Gas Line	EXISTING GAS LINE
Existing Bell Service	EXISTING BELL SERVICE



STATION	PROPOSED ELEVATIONS	EXISTING ELEVATIONS
1+000		
1+005.4	80.92	
1+020	84.75 84.76	
1+040	84.56 84.45	
1+060	84.46 84.75	
1+080	84.13 84.02	
1+083.2	80.64	
1+100		

No.	Revisions	Date
2	ISSUED FOR SPC AND MUNICIPAL CONSENT	MAY 17, 2024
1	ISSUED FOR SITE PLAN CONTROL	SETP 25, 2023

Check and verify all dimensions before proceeding with the work. Do not scale drawings.

SCALE 1 : 250

**egis**  
 info.northamerica@egis-group.com  
 www.egis-group.com  
 115 Walgreen Road  
 RR3, Carp, ON K0A 1L0  
 Tel: 613-836-2184 Fax: 613-836-3742

Stamp:

Client: **THEBERGE DEVELOPMENTS LTD.**  
 1600 LAPPERRIERE AVE  
 OTTAWA, ON K1Z 8P5

Project: **780 BASELINE - PHASE 1**

OTTAWA ON

Drawing Title: **PLAN AND PROFILE STA 1+000 TO 1+100**

Scale: 1:250	Project Number: CCO-22-0952
Drawn By: R.R.R.	Checked By: A.M.
Designed By: R.R.R.	Drawing Number: C202

ELEMENT: (U) Ottawa 01 Project: Proposed 2023 780 Baseline Road L1 Drawing: CCO-22-0952 PRESENTATION: PLAN  
 DATE SAVED: Thursday, May 16, 2024 1:54:24 PM EAST SAVED BY: rrobson  
 LAST PLOTTED: Thursday, May 16, 2024 1:54:24 PM C:\BIBL\BIBL\MP\COV\STANDARD.dwg

D07-12-23-0076