

LEGEND

[Symbol]	SITE BOUNDARY	[Symbol]	EXISTING ADJACENT LEGAL LINE
[Symbol]	LIMIT OF SITE PLAN CONTROL APPLICATION	[Symbol]	EXISTING CULVERT
[Symbol]	PROPOSED LIGHT DUTY SILT FENCE (AS PER O.P.S.D. 219.110)	[Symbol]	EXISTING STORM MANHOLE
[Symbol]	PROPOSED STRAW BALE (AS PER O.P.S.D. 219.180)	[Symbol]	EXISTING CATCHBASIN
[Symbol]	EXISTING BARRIER CURB TO BE REMOVED	[Symbol]	EXISTING SANITARY MANHOLE
[Symbol]	PROPOSED ASPHALT REMOVAL	[Symbol]	EXISTING HYDRANT
[Symbol]	PROPOSED MUD MAT	[Symbol]	EXISTING VALVE & VALVE BOX
[Symbol]	EXISTING LIGHT STANDARD ON CONCRETE BASE TO BE RELOCATED	[Symbol]	EXISTING CENTERLINE SWALE
[Symbol]		[Symbol]	EXISTING TOP OF GRATE ELEVATION
[Symbol]		[Symbol]	EXISTING INVERT ELEVATION
[Symbol]		[Symbol]	EXISTING OVERHEAD WIRES
[Symbol]		[Symbol]	EXISTING UTILITY POLE
[Symbol]		[Symbol]	EXISTING TRAFFIC MANHOLE
[Symbol]		[Symbol]	EXISTING UTILITY POLE ANCHOR
[Symbol]		[Symbol]	EXISTING TRAFFIC SIGNAL LIGHT
[Symbol]		[Symbol]	EXISTING LIGHT STANDARD ON CONCRETE BASE
[Symbol]		[Symbol]	EXISTING SIGN
[Symbol]		[Symbol]	EXISTING CONCRETE

N.T.S.
NOTE: ALL EXISTING AND PROPOSED CATCHBASINS ARE TO HAVE AN INSERT UNTIL CONSTRUCTION OF SUBDIVISION IS COMPLETE.

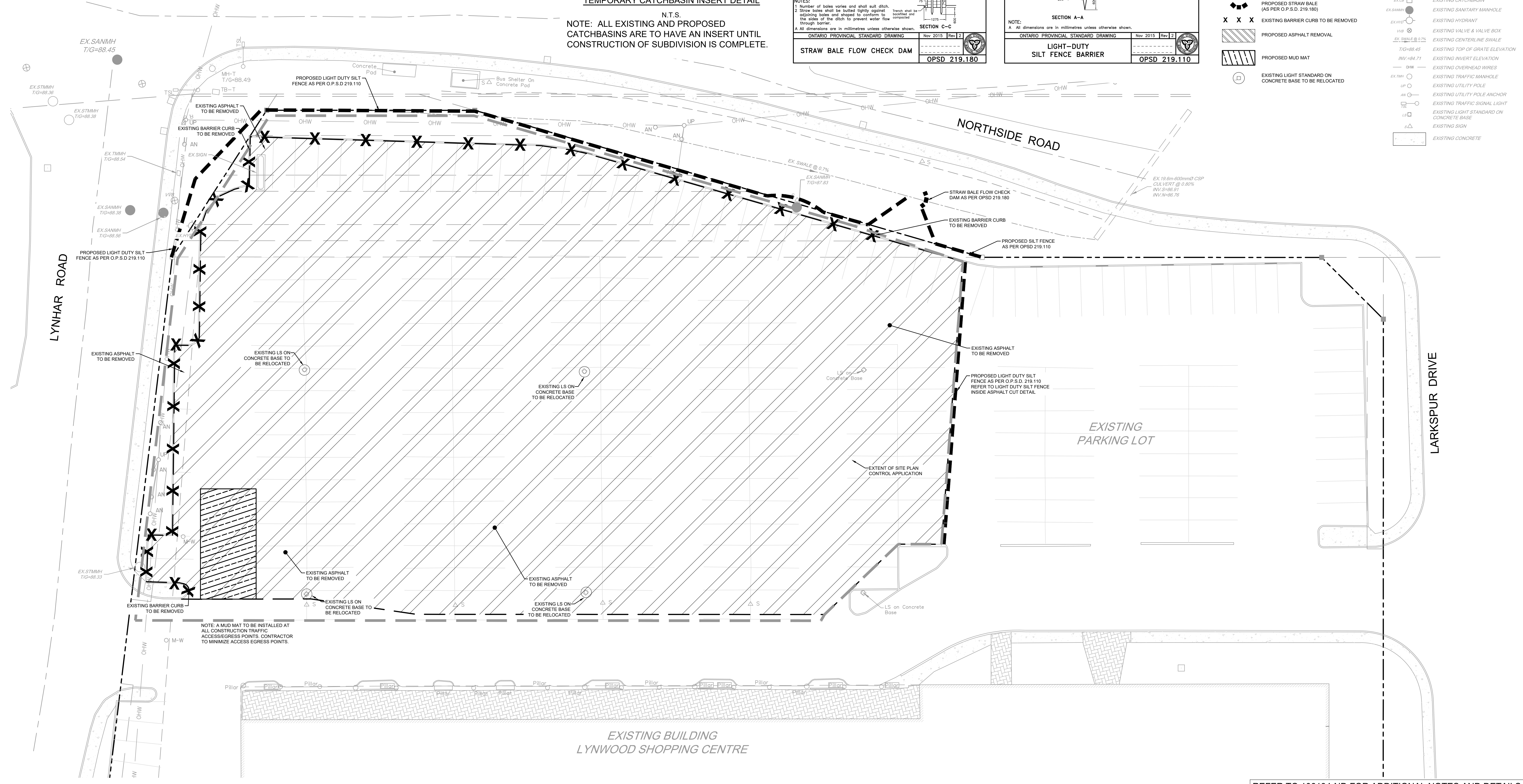

NOTE: A MUD MAT TO BE INSTALLED AT ALL CONSTRUCTION TRAFFIC ACCESS/EGRESS POINTS. CONTRACTOR TO MINIMIZE ACCESS/EGRESS POINTS.

REFER TO 106134-ND FOR ADDITIONAL NOTES AND DETAILS

NOTE: THE POSITION OF ALL POLE LINES, CONDUITS, WATERMANS, SEWERS AND OTHER UNDERGROUND AND OVERGROUND UTILITIES AND STRUCTURES IS NOT NECESSARILY SHOWN ON THE CONTRACT DRAWINGS, AND WHERE SHOWN, THE ACCURACY OF THE POSITION OF SUCH UTILITIES AND STRUCTURES IS NOT GUARANTEED. BEFORE STARTING WORK, DETERMINE THE EXACT LOCATION OF ALL SUCH UTILITIES AND STRUCTURES AND ASSUME ALL LIABILITY FOR DAMAGE TO THEM.

**PRELIMINARY
NOT FOR
CONSTRUCTION**

No.	REVISION	DATE	BY
3.	REVISED AS PER CITY OF OTTAWA COMMENTS	APR 19/24	SAZ
2.	REVISED AS PER CITY OF OTTAWA COMMENTS	NOV 17/23	SAZ
1.	ISSUED WITH SITE PLAN APPLICATION	MAR 3/23	SAZ

SCALE	REVISION	FOR REVIEW ONLY
1:200	SAZ	SAZ
	MSP	MSP
	MTM	MTM
	SAZ	SAZ
	MSP	MSP

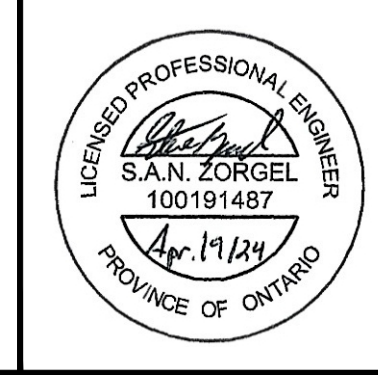

CITY OF OTTAWA 1826 ROBERTSON ROAD LYNWOOD RETAIL PLAZA		PROJECT No. 106134-00
DRAWING NAME REMOVALS AND EROSION & SEDIMENT CONTROL PLAN		REV # 3
DRAWING No. 106134-RM-ESC		

D07-12-23-0027