

ID	Qty	Botanical Name	Common Name	Scheduled Size	Remarks
ArRS	1	Acer rubrum 'Red Sunset'	Red Maple	60mm caliper	WB, Staked
As	3	Acer saccharum	Sugar Maple	70mm caliper	WB, Staked
BpC	2	Betula papyrifera	Paper Birch Clump	40mm caliper	WB, Staked
Co	4	Celtis occidentalis	Common Hackberry	60mm caliper	WB, Staked
GbAG	2	Ginkgo biloba 'Autumn Gold'	Autumn Gold Maidenhair Tree	60mm caliper	WB, Staked
GtS	4	Gleditsia triacanthos var. inermis 'Shademaster'	Shademaster Honeylocust	60mm caliper	WB, Staked
Oma	1	Quercus macrocarpa	Bur Oak	70mm caliper	WB, Staked
Qr	2	Quercus rubra	Northern Red Oak	60mm caliper	WB, Staked
Ta	1	Tilia americana	Basswood	70mm caliper	WB, Staked
LARGE COLUMNAR DECIDUOUS TREES					
CoPS	3	Celtis occidentalis 'Prairie Sentinel'	Prairie Sentinel Hackberry	60mm caliper	WB, Staked
Ag	6	Aesculus glabra	Ohio Buckeye	50mm caliper	WB, Staked
GtD	3	Gleditsia triacanthos inermis 'Draves'	Streetkeeper Honeylocust	60mm caliper	WB, Staked
MEDIUM DECIDUOUS TREES					
Ac	5	Amelanchier canadensis	Serviceberry	45mm caliper	WB, Staked
AgRH	3	Amelanchier x grandiflora 'Robin Hill'	Robin Hill Apple Serviceberry	45mm caliper	WB, Staked
CcgC	7	Crataegus crus-galli inermis 'Cruzam'	Thornless Crusader Cockspear Hawthorn	45mm caliper	WB, Staked
MS	4	Malus x 'Snowdrift'	Snowdrift Crabapple	45mm caliper	WB, Staked
SMALL COLUMNAR DECIDUOUS TREES					
SrIP	1	Syringa reticulata 'Ivory Pillar'	Ivory Pillar Japanese Tree Lilac	50mm caliper	WB, Staked
SMALL DECIDUOUS TREES					
AcB	8	Amelanchier canadensis 'Ballarina'	Ballarina Serviceberry (tree form)	45mm caliper	WB, Staked
MHG	6	Malus x 'Harvest Gold'	Harvest Gold Crabapple	50mm caliper	WB, Staked
SrIS	4	Syringa reticulata 'Ivory Silk'	Ivory Silk Tree Lilac	50mm caliper	WB, Staked
SMALL ORNAMENTAL DECIDUOUS TREES					
BnFV	2	Betula nigra 'Little King'	Fox Valley River Birch	45mm caliper	WB, Staked
CONIFEROUS TREES					
Pr	1	Pinus resinosa	Red Pine	200cm ht	WB, Staked
SMALL CONIFEROUS TREES / CONIFEROUS SHRUBS					
JcPP	5	Juniperus communis 'Pencil Point'	Pencil Point Juniper	125cm ht	Potted
PmT	2	Pinus mugo 'Tannenbaum'	Tannenbaum Mugo Pine	75cm spd	potted
To(N)	11	Thuja occidentalis (Nursery grown)	White Cedar, Eastern Arborvitae	200cm ht	Full clumps
ToF	15	Thuja occidentalis 'Fastigiata'	Fastigiata Eastern Arborvitae	175cm ht	Potted
SHRUBS					
CoBB	22	Cephalanthus occidentalis	Buttombush	50 cm ht.	Potted
DI	85	Diervilla lonicera	Dwarf Bush-honeysuckle	2 gallon pot	0.9m o.c.
Hv	2	Hamamelis virginiana	Witch Hazel	50mm caliper	WB Staked
HaA	18	Hydrangea arborescens 'Annabelle'	Annabelle Hydrangea	2 gallon pot	0.9m o.c.
HalM	22	Hydrangea arborescens 'Invincible Mini Mauvette'	Mini Mauvette Annabelle Hydrangea	2 gallon pot	0.9m o.c.
HpFI	4	Hydrangea paniculata 'Fire & Ice'	Fire & Ice panicled hydrangea	2 gallon pot	0.9m o.c.
Hp	1	Hypericum prolificum	Shrubby St. John's Wort	50cm ht.	2 gallon pot
Lb	2	Lindera benzoin	Northern Spicebush	80cm ht.	spacing 1.1m o.c.
Phv	2	Philadelphus x virginialis	Mockorange	175cm ht	WB, Staked
PoTW	8	Physocarpus opulifolius 'Tiny Wine'	Tiny Wine Dwarf Ninebark	50cm ht.	0.9m o.c.
Ral	23	Ribes alpinum	Alpine Currant	50cm ht.	1.0m o.c.
Rr	46	Rosa rugosa	Rugose Rose	50cm ht.	1.0m o.c.
SbC	37	Spiraea bumalda 'Coccinea'	Dwarf Red Spirea	50cm ht.	0.8m o.c.
SbG	27	Spiraea bumalda 'Goldflame'	Goldflame Spirea	50cm ht.	0.9m o.c.
SJS	33	Spiraea japonica 'Shirobana'	Shirobana Spirea	50cm ht.	0.9m o.c.
SnS	31	Spiraea niponica 'Snowmound'	Snowmound Spirea	50cm ht.	0.9m o.c.
VI	8	Viburnum lentago	Nannyberry Viburnum	100 cm ht.	Potted
PERENNIALS					
PvA	661	Ornamental Grasses	Feather Reed Grass, Switch Grass, Bottlebrush Grass, Fescue	150mm Pot	0.5 - 0.75m o.c.
PvB	484	Sun Perennial varieties	Coneflower, Daylily, Black Eyed Susan, Beesalm, Spiked Speedwell, Blanket Flower, Blazing Star	150mm Pot	0.5 - 0.6m o.c.
PvC	156	Shade Perennial varieties	Ostrich Fern, Hosta varieties, Bigroot Geranium, Astilbe, Lamium	150mm Pot	0.5 - 0.6m o.c.

6			
5			
4			
3	Resubmission for SPC	2024/03/28	
2	Resubmission for SPC	2023/12/21	
1	Issued for SPC	2023/06/21	

DESIGNED BY / CONCELE	CHECKED BY / VERIFIE PAR
M. Ruhland	M. Ruhland
DRAWN BY / DESINE PAR	SCALE / ECHELLE
T. Frost / V. Odusanya	1:250

DETAIL NUMBER
1
SCALE: A1:1
SHEET NUMBER

THIS DRAWING IS THE PROPERTY OF THE CITY OF OTTAWA AND ALL COPYRIGHT IS RESERVED. DIMENSIONS ON DRAWING ARE FOR ESTIMATING PURPOSES ONLY. IT IS THE RESPONSIBILITY OF EACH CONTRACTOR AND SUB-CONTRACTOR OR CONSULTANT TO CHECK AND VERIFY ALL DIMENSIONS AND CONDITIONS ON SITE. NOTIFY OWNER OF ANY ERRORS OR OMISSIONS PRIOR TO COMMENCING THE WORK. DO NOT SCALE THE DRAWINGS.

CE DESSIN CONSTITUE LA PROPRIÉTÉ DE LA VILLE D'OTTAWA ET TOUT DROIT D'AUTEUR EST RÉSERVÉ. LES DIMENSIONS INDICÉES LE SONT À DES FINS ESTIMATIVES SEULEMENT. IL INCOMBE À CHAQUE ENTREPRENEUR, SOUS-CONTRACTANT OU CONSULTANT DE VÉRIFIER TOUTES LES DIMENSIONS ET LES CONDITIONS SUR LE CHANTIER. VEUILLEZ INFORMER LE PROPRIÉTAIRE DE TOUTE ERREUR OU OMISSION AVANT D'ENTAMER LES TRAVAUX. NE DRESSEZ PAS LES PLANS À L'ÉCHELLE.

ARCHITECT / ARCHITECTE
CONSULTANT / EXPERT-CONSEIL

CONSULTANT / EXPERT-CONSEIL
CONSULTANT / EXPERT-CONSEIL

PROJECT / LOCATION / PROJET / ENDROIT

NOELLA LECLAIR STREET

Noella LeClair Street

DRAWING / DESSIN

LANDSCAPE / PLANTING PLAN

BUSINESS ENTITY / NUMÉRO DE L'ENTITÉ
BUILDING NUMBER / NUMÉRO DE BÂTIMENT

SHEET NO. / FEUILLE NO.
L-01

CITY PROJECT NO. / CONS. PROJECT NO. / NUMÉRO DE PROJET / NUMÉRO DE PROJET
CR-23-1710

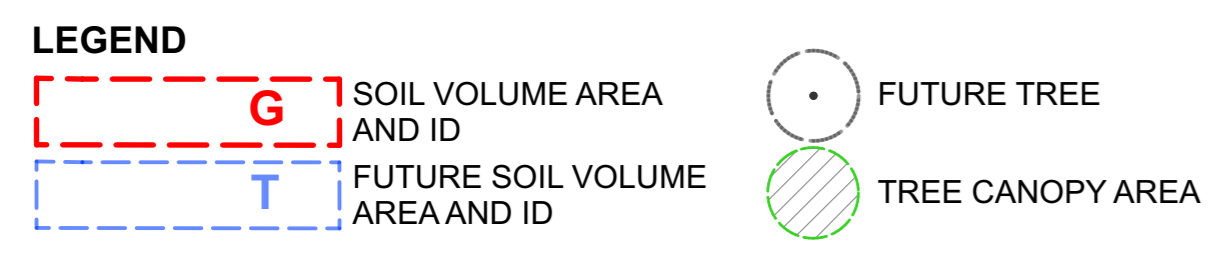
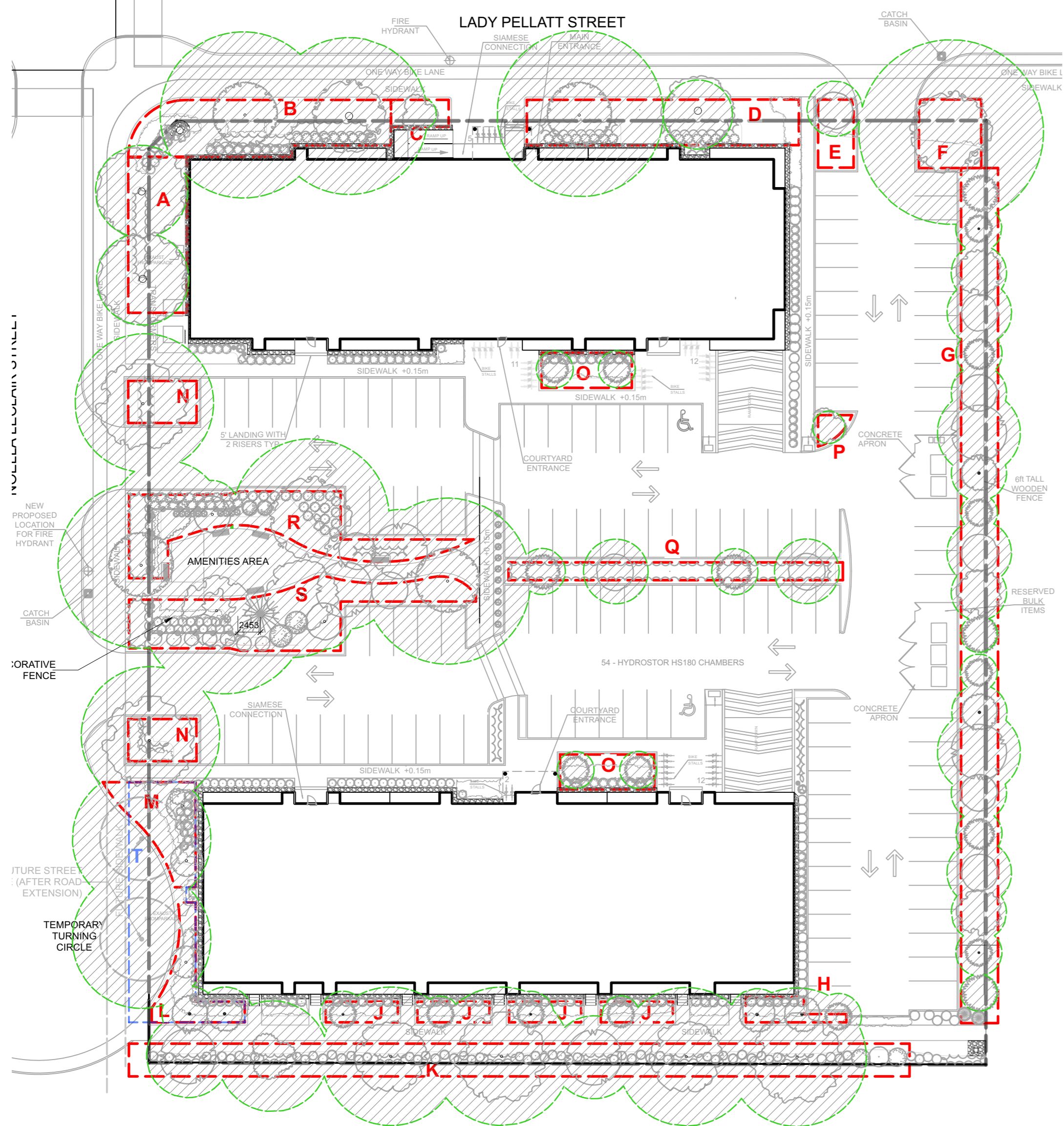

TREE CANOPY COVERAGE	
TOTAL CANOPY AREA	4410 m ²
TOTAL SITE AREA	9256 m ²
PERCENT COVERAGE	48%

TREE SOIL VOLUME REQUIREMENTS:
STANDARD TREE SOIL VOLUMES QUANTITIES INCLUDE THE TOP 900-1000mm OF SOIL / EXISTING SUBSOIL LAYER TO CALCULATE TOTAL SOIL VOLUMES REQUIRED BY CITY OF OTTAWA FOR SUSTAINABLE TREE GROWTH. WHERE LARGER SOFT AREAS ARE AVAILABLE, THE TOP 400-500mm LAYER IS USED TO CALCULATE SOIL VOLUMES (AS PER CITY DETAL L1).

WHERE EXISTING MATERIAL BELOW THE SPECIFIED TOPSOIL IS NOT CONDUCTIVE TO TREE GROWTH, AN ADDITIONAL LAYER OF PLANTING MEDIUM IS TO BE INSTALLED BELOW SPECIFIED TOPSOIL DEPTH TO OBTAIN THE SOIL VOLUME DEPTH REQUIRED.
REFER TO SOIL VOLUME CHART AND PLANS FOR AREA WHERE TREE SOIL VOLUMES ARE REQUIRED.

Soil Volume Area, Tree Quantity and Size	Tree Quantity	OTTAWA Target Soil Volume (m ³)	Design Soil Volume	Soil Adequacy percentage
AREA A - 2 large trees plant bed (105 sq m x 0.4m ave deep)	2	36.0	42.0	117%
AREA B - 2 large trees plant bed (150 sq m x 0.4m ave deep)	2	36.0	60.0	167%
AREA C - 1 small ornamental tree (15cm DBH)* plant bed (18 sq m x 0.4m ave deep)	1	8.0	7.2	90%
AREA D - 2 large trees plant bed (145 sq m x 0.4m ave deep)	2	36.0	58.0	161%
AREA E - 1 small tree plant bed (25 sq m x 0.8m ave deep)	1	20.0	20.0	100%
AREA F - 1 large tree (continuous) plant bed (50 sq m x 0.4m ave deep)	1	18.0	20.0	111%
AREA G - 5 medium trees, 10 small trees, 10 ornamental trees plant bed (300 sq m x 0.8m ave deep)	21	249.0	240.0	96%
AREA H - 2 small ornamental trees (15cm DBH)*, 1 small ornamental trees (10cm DBH)* plant bed (20 sq m x 0.9m ave deep)	3	15.4	18.0	117%
AREA J - 1 small ornamental tree (15cm DBH)* plant bed (18 sq m x 0.8m ave deep)	1	15.0	14.4	96%
AREA K - 5 large trees, 2 medium trees plant bed (250 sq m x 0.6m ave deep)	7	120.0	150.0	125%
AREA L - 1 columnar tree, 2 ornamental trees plant bed (45 sq m x 0.6m ave deep)	3	27.0	27.0	100%
AREA M - 2 columnar trees plant bed (60 sq m x 0.6m ave deep)	2	18.0	36.0	200%
AREA N - 1 large tree plant bed (30 sq m x 0.9m ave deep)	1	30.0	27.0	90%
AREA O - 2 *small ornamental trees (15cm DBH) plant bed (35 sq m x 0.6m ave deep)	2	18.0	21.0	117%
AREA P - 1 small ornamental tree (10cm DBH) plant bed (8 sq m x 0.7m ave deep)	1	6.0	5.6	93%
AREA Q - 4 small trees plant bed (65 sq m x 0.9m ave deep)	4	48.0	58.5	122%
AREA R - 3 large trees, 1 medium tree, 2 small trees plant bed (150 sq m x 0.5m ave deep)	4	57.0	75.0	132%
AREA S - 3 large trees, 1 medium tree, 1 conifer, 2 small trees plant bed (165 sq m x 0.5m ave deep)	5	72.0	82.5	115%
AREA T - 3 large trees (future), 3 columnar trees, 2 ornamental trees plant bed (195 sq m x 0.6m ave deep)	11	108.0	117.0	108%

* Smaller columnar trees, small ornamental trees with growth to 8-15cm DBH, large shrubs, and columnar conifers calculated using 'How much soil to grow a big tree' by DeepRoot as a guide
AREAS WHERE SITE CONSTRAINTS (such as parking lot islands, adjacent hard surface areas): 0.9 TO 1.2m DEPTH IMPORTED TOPSOIL (average depth of 1000mm).
AREAS WITHIN OR ADJACENT TO LARGER SOFT LANDSCAPE AREAS (such as wide boulevards, lawns, etc): 0.4m AVERAGE DEPTH OF IMPORTED TOPSOIL OVER APPROVED EXISTING SUBSOIL. ADDITIONAL IMPORTED TOPSOIL OR APPROVED SUBSOIL TO BE ADDED WHERE SUBGRADE BELOW THE 400mm IMPORTED TOPSOIL IS NOT CONDUCTIVE TO PLANT GROWTH.

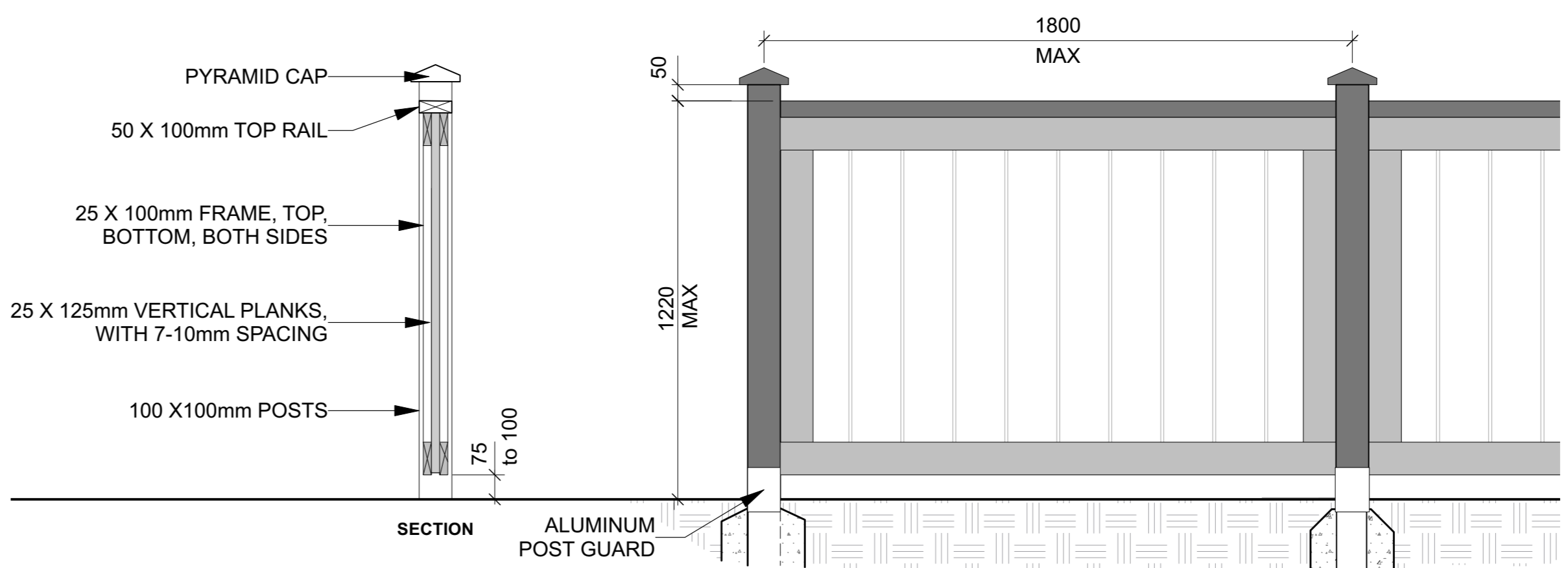

1 Decorative Fence
Scale: NTS
NOTES:
- ALL WOOD TO BE PRESSURE TREATED
- ALL SIZES ARE NOMINAL
- ALL FASTENERS TO BE ALUMINUM OR HOT DIPPED GALVANIZED.
- WOOD SCREWS TO BE EXTERIOR GRADE, COATED.

6			
5			
4			
3	Resubmission for SPC	2024/03/28	
2	Resubmission for SPC	2023/12/21	
1	Issued for SPC	2023/06/21	

DESIGNED BY / CONÇU PAR M. Ruhland	CHECKED BY / VÉRIFIÉ PAR M. Ruhland
DRAWN BY / DÉSSINÉ PAR T. Frost / V. Odusanya	SCALE / ÉCHELLE

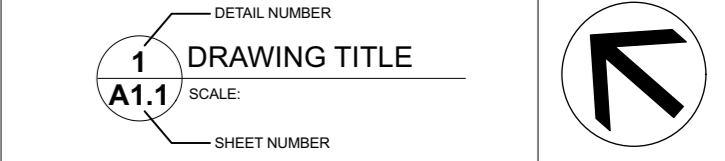

THIS DRAWING IS THE PROPERTY OF THE CITY OF OTTAWA AND ALL COPYRIGHT IS RESERVED. DIMENSIONS ON DRAWING ARE FOR ESTIMATING PURPOSES ONLY. IT IS THE RESPONSIBILITY OF EACH CONTRACTOR AND SUB-CONTRACTOR OR CONSULTANT TO CHECK AND VERIFY ALL DIMENSIONS AND CONDITIONS ON SITE. NOTIFY OWNER OF ANY ERRORS OR OMISSIONS PRIOR TO COMMENCING THE WORK. DO NOT SCALE THE DRAWINGS.

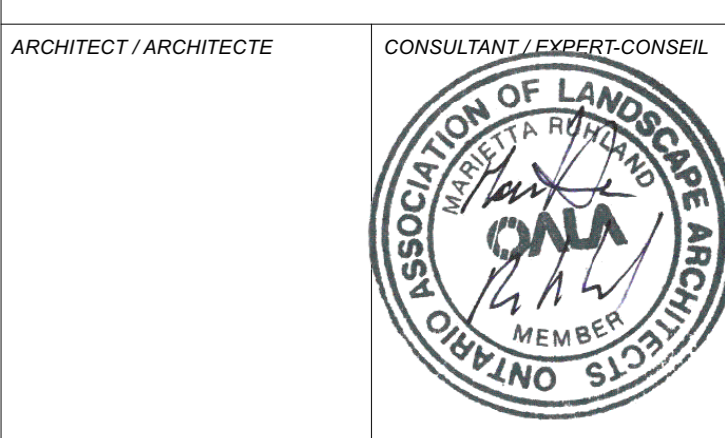

ARCHITECT / ARCHITECTE	CONSULTANT / EXPERT-CONSEIL
CONSULTANT / EXPERT-CONSEIL	CONSULTANT / EXPERT-CONSEIL

PROJECT / LOCATION / PROJET / ENDROIT
NOELLA LECLAIR STREET
Noella LeClair Street

DRAWING / DESSIN
DETAILS

BUSINESS ENTITY / NUMÉRO DE L'ENTITÉ BUILDING NUMBER / NUMÉRO DU BÂTIMENT	SHEET NO. / FEUILLE NO. L-02
CITY PROJECT NO. / NUMÉRO DE PROJET # CR-.....	CONS. PROJECT NO. / NUMÉRO DE PROJET 23-1710

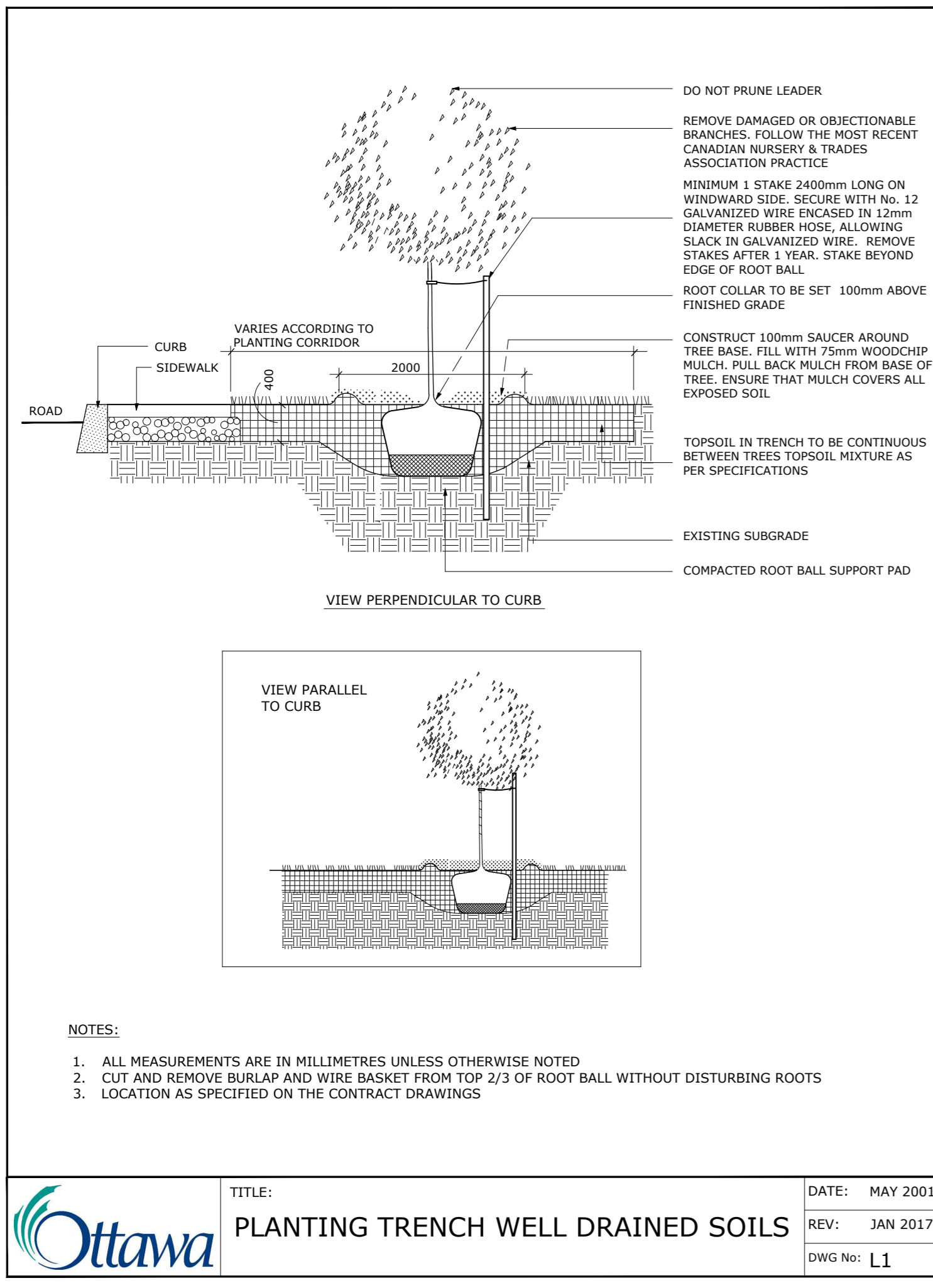

Ottawa TITLE: PLANTING TRENCH WELL DRAINED SOILS DATE: MAY 2001
 REV: JAN 2017
 DWG No: L1

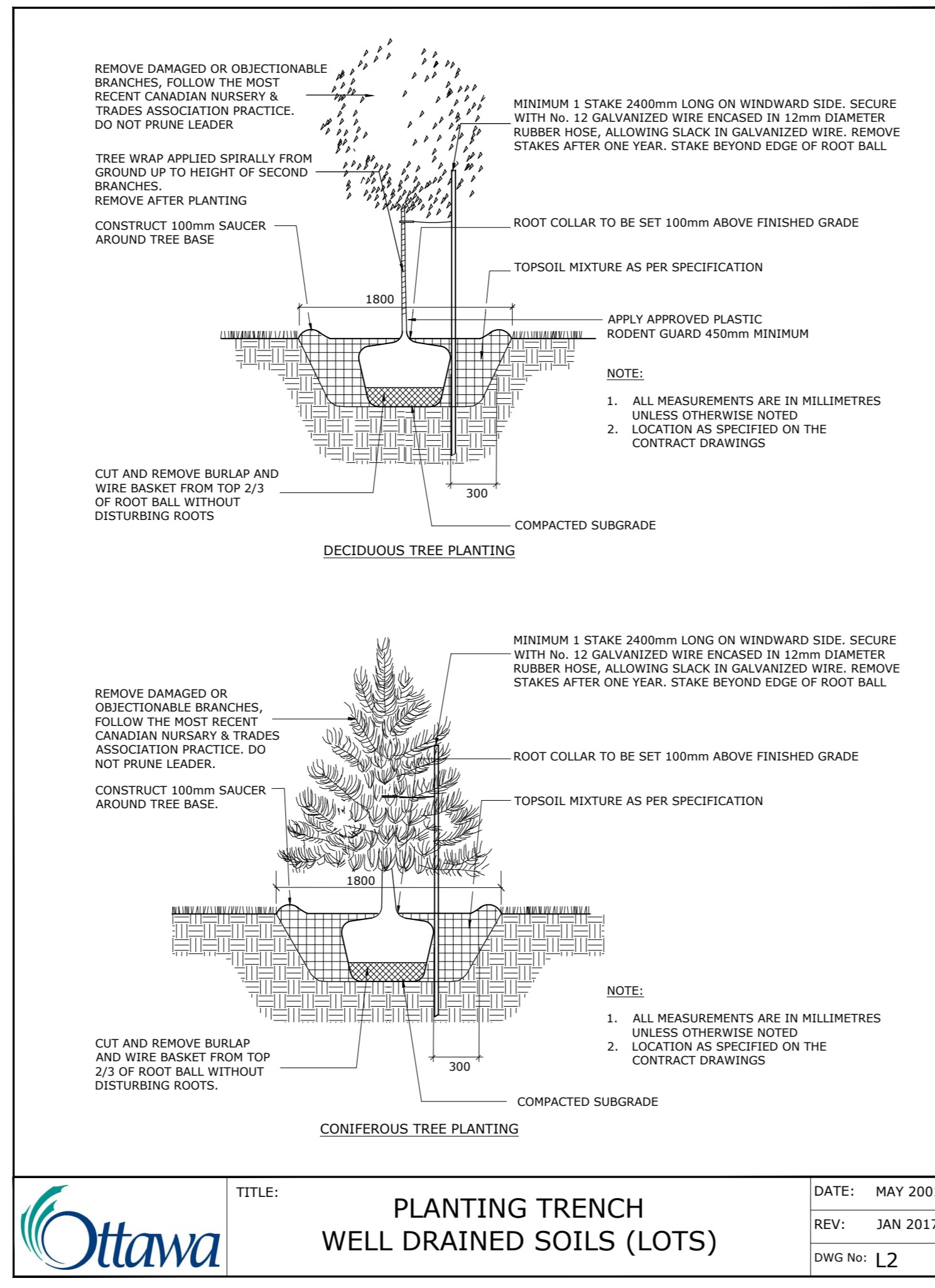

Ottawa TITLE: PLANTING TRENCH WELL DRAINED SOILS (LOTS) DATE: MAY 2001
 REV: JAN 2017
 DWG No: L2

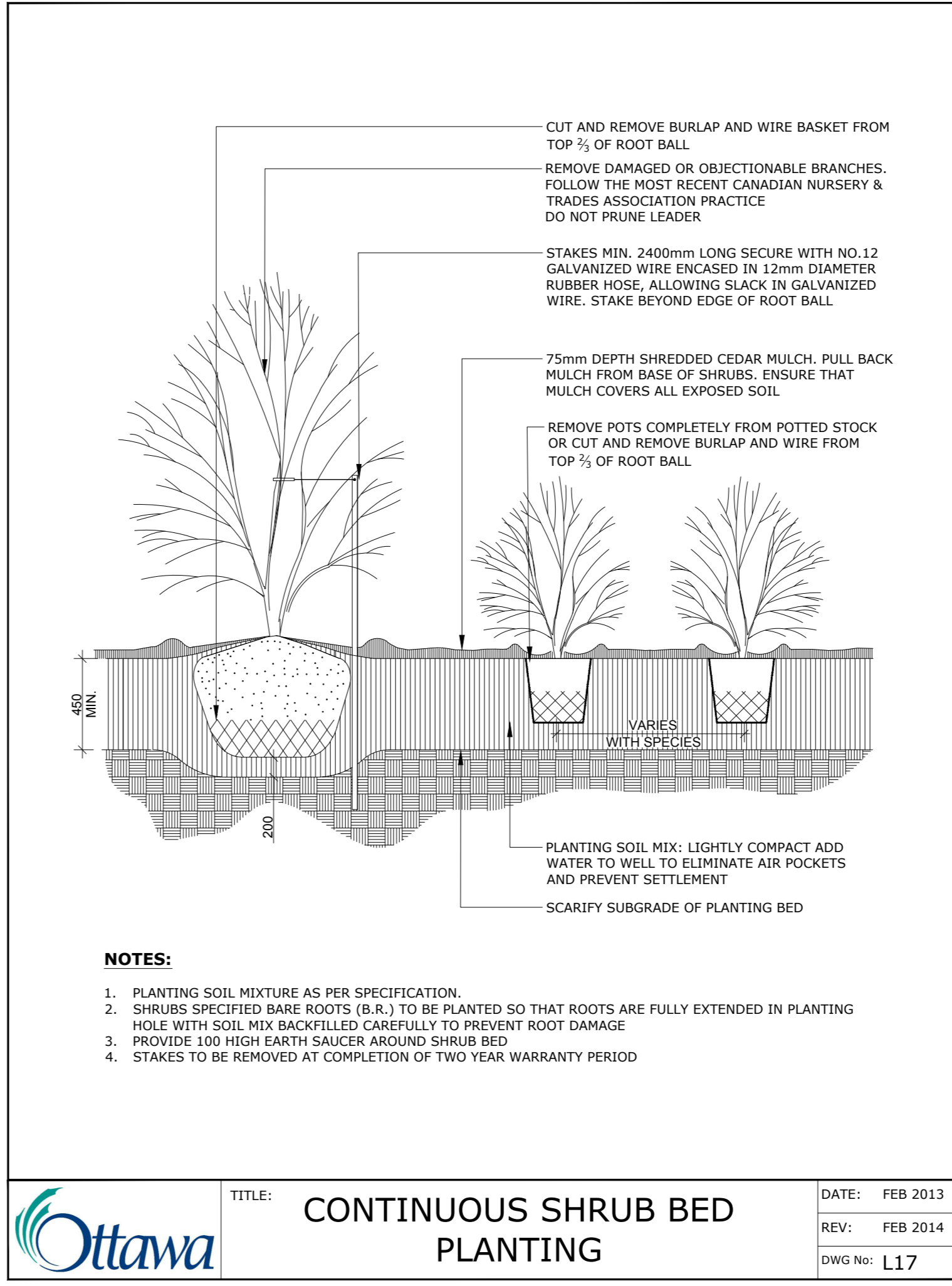

Ottawa TITLE: CONTINUOUS SHRUB BED PLANTING DATE: FEB 2013
 REV: FEB 2014
 DWG No: L17

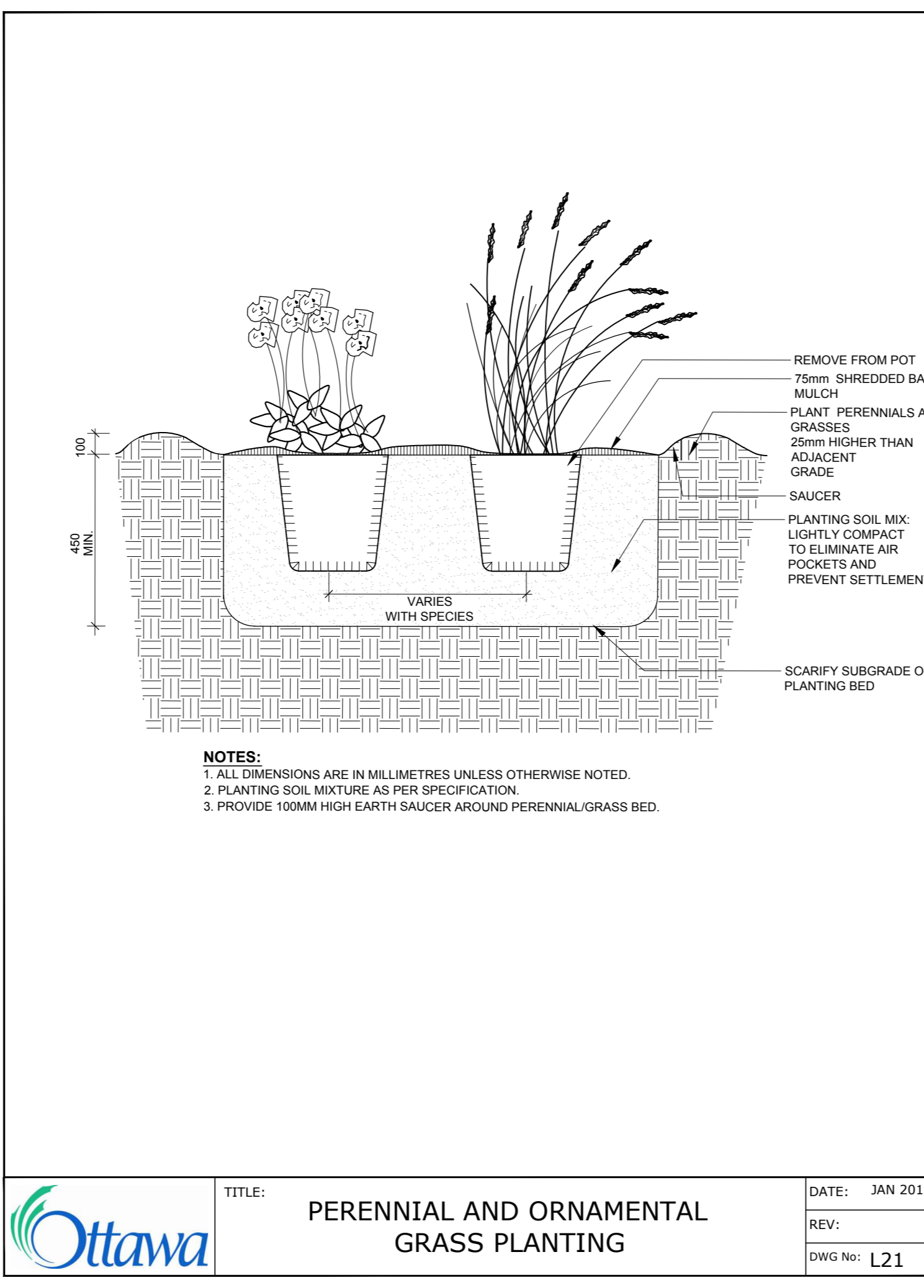

Ottawa TITLE: PERENNIAL AND ORNAMENTAL GRASS PLANTING DATE: JAN 2015
 REV:
 DWG No: L21

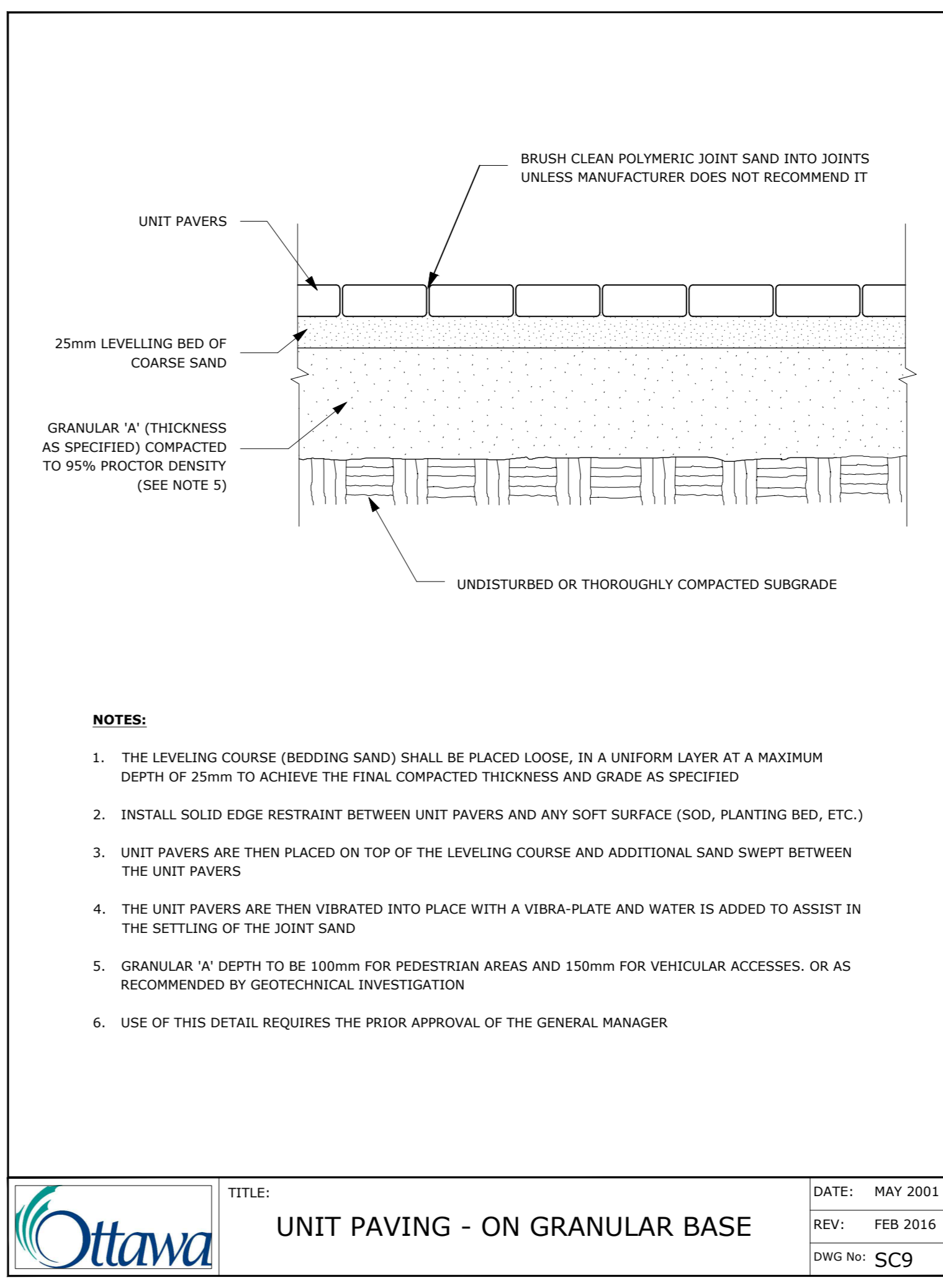

Ottawa TITLE: UNIT PAVING - ON GRANULAR BASE DATE: MAY 2001
 REV: FEB 2016
 DWG No: SC9

ADDITIONAL NOTES FOR NUMBER 5:
 150mm DEPTH GRANULAR 'A' TO BE USED ONLY IN PEDESTRIAN WHERE NO OR HAND SNOW REMOVAL IS PLANNED. ALL OTHER PEDESTRIAN AREAS ARE TO RECEIVE 200mm COMPACTED GRANULAR 'A' MINIMUM. FURTHER ADJUSTMENTS TO BE SPECIFIED IN RELATION TO SITE CONDITIONS AND GEOTECHNICAL RECOMMENDATIONS.

Ottawa
 INFRASTRUCTURE SERVICES
 DESIGN AND CONSTRUCTION

SERVICES D'INFRASTRUCTURE
 DIRECTION DE CONCEPTION ET DE CONSTRUCTION

FOR / POUR
 Planning, Infrastructure and Economic Development Department
INFRASTRUCTURE SERVICES
 DESIGN & CONSTRUCTION

Ruhland & Associates Ltd
 landscape architecture • urban design • site planning
 Ph 613-224-4744 Fx 613-224-1311 info@rala.ca www.rala.ca

6		
5		
4		
3	Resubmission for SPC	2024/03/28
2	Resubmission for SPC	2023/12/21
1	Issued for SPC	2023/06/21

NUMBER / NUMERO	DATE: (Y/M/D) / DATE: (A/M/J)	INITIALS / INITIALES
DESIGNED BY / CONCEU PAR		CHECKED BY / VERIFIE PAR
M. Ruhland		M. Ruhland
DRAWN BY / DESINE PAR		SCALE / ECHELLE
T. Frost / V. Odusanya		

DETAIL NUMBER
1 DRAWING TITLE
 A1.1 SCALE
 SHEET NUMBER

THIS DRAWING IS THE PROPERTY OF THE CITY OF OTTAWA AND ALL COPYRIGHT IS RESERVED. DIMENSIONS ON DRAWING ARE FOR ESTIMATING PURPOSES ONLY. IT IS THE RESPONSIBILITY OF EACH CONTRACTOR AND SUB-CONTRACTOR OR CONSULTANT TO CHECK AND VERIFY ALL DIMENSIONS AND CONDITIONS ON SITE. NOTIFY OWNER OF ANY ERRORS OR OMISSIONS PRIOR TO COMMENCING THE WORK. DO NOT SCALE THE DRAWINGS.

CE DESSIN CONSTITUE LA PROPRIETE DE LA VILLE D'OTTAWA ET TOUT DROIT D'AUTEUR EST RESERVE. LES DIMENSIONS UTILISEES LE SONT A DES FINS ESTIMATION SEULEMENT. IL INCOMBE A CHAQUE ENTREPRENEUR, SOUS-CONTRACTANT OU CONSULTANT DE VERIFIER TOUTES LES DIMENSIONS ET LES CONDITIONS SUR LE CHANTIER. VEUILLEZ INFORMER LE PROPRIETAIRE DE TOUTE ERREUR OU OMISSION AVANT D'ENTAMER LES TRAVAUX. NE DRESSEZ PAS LES PLANS A L'ECHELLE.

ARCHITECT / ARCHITECTE
 CONSULTANT / EXPERT-CONSEIL

ASSOCIATION OF LANDSCAPE ARCHITECTS ONTARIO
 MEMBER

CONSULTANT / EXPERT-CONSEIL
 CONSULTANT / EXPERT-CONSEIL

PROJECT / LOCATION / PROJET / ENDROIT
NOELLA LECLAIR STREET

Noella LeClair Street

DRAWING / DESSIN
DETAILS

BUSINESS ENTITY / NUMERO DE L'ENTITE / BUILDING NUMBER / NUMERO DU BATIMENT
 SHEET NO. / FEUILLE NO.
L-03

CITY PROJECT NO. / CONTS. PROJECT NO. / NUMERO DE PROJET / NUMERO DE PROJET
 # CR-23-1710