

REFER TO NOTES, DETAILS &
SCHEDULES ON DRAWINGS C-4 & C-5

LADY PELLATT STREET

EXIST. ST MH
TOP ±88.26

LEGEND

- FFL FINISHED FLOOR ELEVATION
- BFL BASEMENT FLOOR ELEVATION
- USF UNDERSIDE OF FOOTING
- PROPERTY LINE
- CB [Symbol] CATCH-BASIN
- MH [Symbol] STORM MANHOLE
- CB/MH [Symbol] CATCH-BASIN/MANHOLE
- MH [Symbol] SANITARY MANHOLE
- FH [Symbol] FIRE HYDRANT
- FDC [Symbol] FIRE DEPARTMENT CONNECTION
- - - - - EXISTING GRADE ELEVATION
- ===== 150mm BARRIER CURB
- SILT FENCE BARRIER

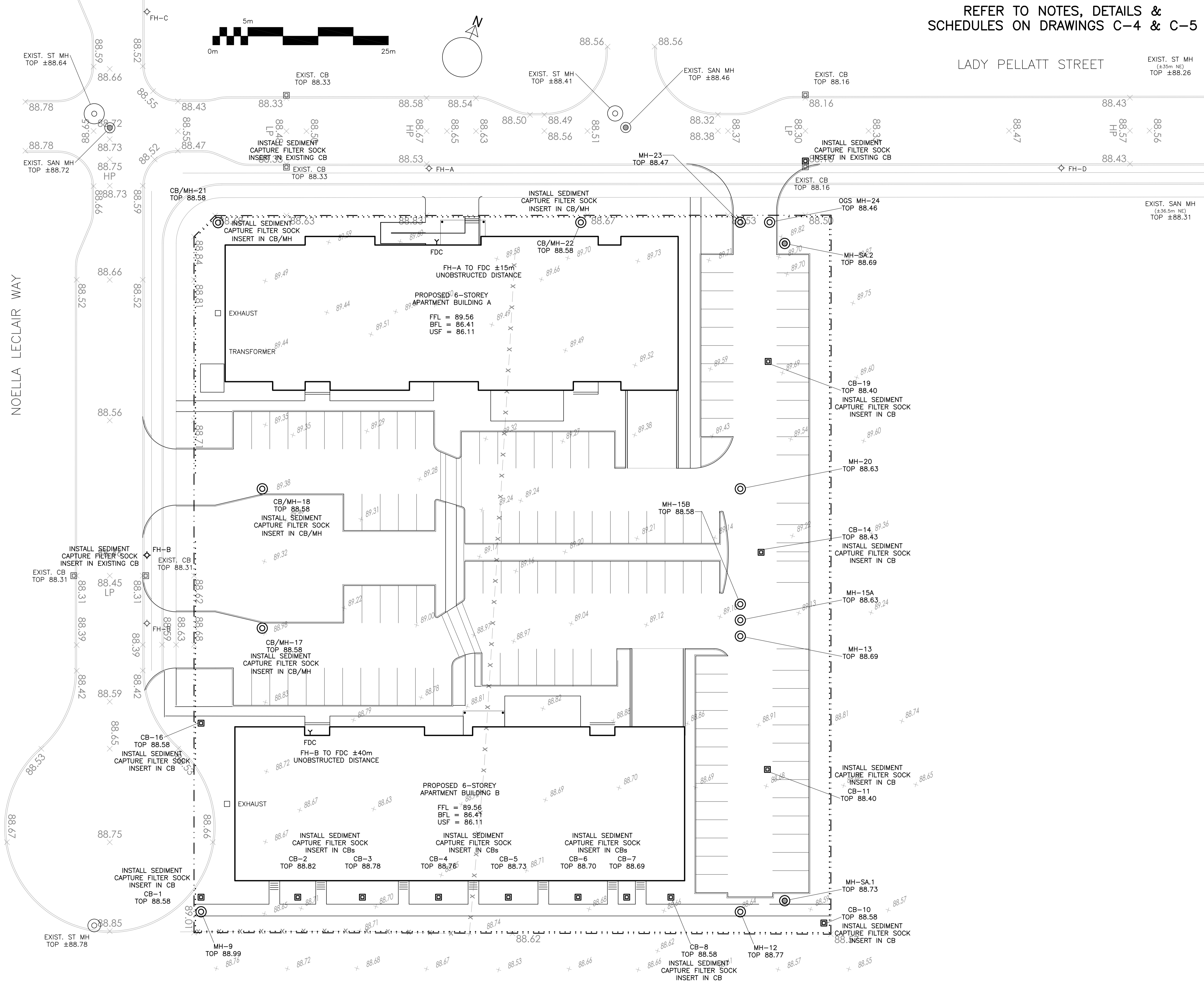

No.	DATE	REVISION
4	MAR 22-24	RE-ISSUED FOR APPROVAL
3	DEC 15-23	RE-ISSUED FOR APPROVAL
2	JUN 28-23	ISSUED FOR APPROVAL
1	JUN 26-23	ISSUED FOR COORDINATION

D. B. GRAY ENGINEERING INC.
Stormwater Management - Grading & Drainage - Storm & Sanitary Sewers - Watermain
 700 Long Point Circle 613-425-8044
 Ottawa, Ontario d.gray@dbgrayengineering.com

Project
PROPOSED 6-STORY APARTMENT BUILDINGS
 1001 NOELLA LECLAIR WAY
 OTTAWA, ONTARIO

EROSION & SEDIMENT CONTROL PLAN

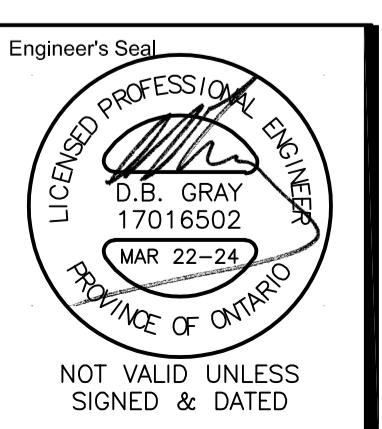

Drawn D.B.G.
 H. Scale 1:250
 V. Scale
 Date JUN 12-23
 Job No. 22068
 Drawing No.
C-3
 of 6