



Copyright Reserved
The Contractor shall verify and be responsible for all dimensions. DO NOT scale the drawing - any errors or omissions shall be reported to Stantec without delay.

Legend

- PROPOSED WATERMAIN
PROPOSED VALVE AND VALVE BOX
PROPOSED FIRE HYDRANT
PROPOSED SANITARY SEWER
PROPOSED STORM SEWER
PROPOSED CATCHBASIN
PROPOSED FIRE DEPARTMENT CONNECTION
EXISTING WATERMAIN
EXISTING VALVE AND VALVE BOX
EXISTING FIRE HYDRANT
EXISTING SANITARY SEWER
EXISTING STORM SEWER
EXISTING CATCHBASIN
PROPOSED DEPRESSED CURB LOCATIONS
PROPOSED BARRIER CURB
PROPOSED RETAINING WALL
THERMAL INSULATION ON STORM SEWER WHERE COVER IS LESS THAN 1.5m. THERMAL INSULATION ON WATERMAIN WHERE COVER IS LESS THAN 2.4m AS PER W22.
WATER METER
PROPOSED SCUPPER LOCATIONS
PROPOSED ROOF DRAINS
ROAD CUT REINSTATEMENT AS PER CITY OF OTTAWA DETAIL R10.
ASPHALT MIX LEVEL B PG58-94
40mm SUPERPAVE 12.5mm SURFACE COURSE
50mm SUPERPAVE 19.0mm BASE COURSE

Notes

- 1. FOR TREE REMOVALS AND PROTECTION SEE LANDSCAPE PLAN L1 DATED 03/05/2024 PREPARED BY JAMES B. LENNOX AND ASSOCIATES INC.

Table with 4 columns: Revision, Date, By, Appd. Contains revision history for the drawing.

Table with 4 columns: File Name, SS, TM, DT. Contains file name 160401787 and dates.

Table with 4 columns: Permit Seal, Dwn, Chkd, Dsgn. Contains drawing information.

Client/Project
PROJECT1 STUDIO
1184 CUMMINGS AVENUE
GLOUCESTER, ON

Title
SITE SERVICE PLAN

Table with 4 columns: Project No., Scale, Drawing No., Sheet. Contains project details.

Table with 4 columns: Drawing No., Sheet, Revision. Contains drawing details.

SSP-1 2 of 7 6 PLAN # 19081



SCHEDULE OF ROOF RELEASE RATES table with columns: DRAINAGE AREA ID, DRAIN TYPE, # DRAINS, SYR HEAD (m), 100 YEAR HEAD (m), SYR RELEASE RATE (L/S), 100 YEAR RELEASE RATE (L/S).

SEWER AND WATERMAIN CROSSING TABLE with columns: CROSSING, STM INV, STM OBV, SAN INV, SAN OBV, WTR STM, WTR TOP, NOTES.

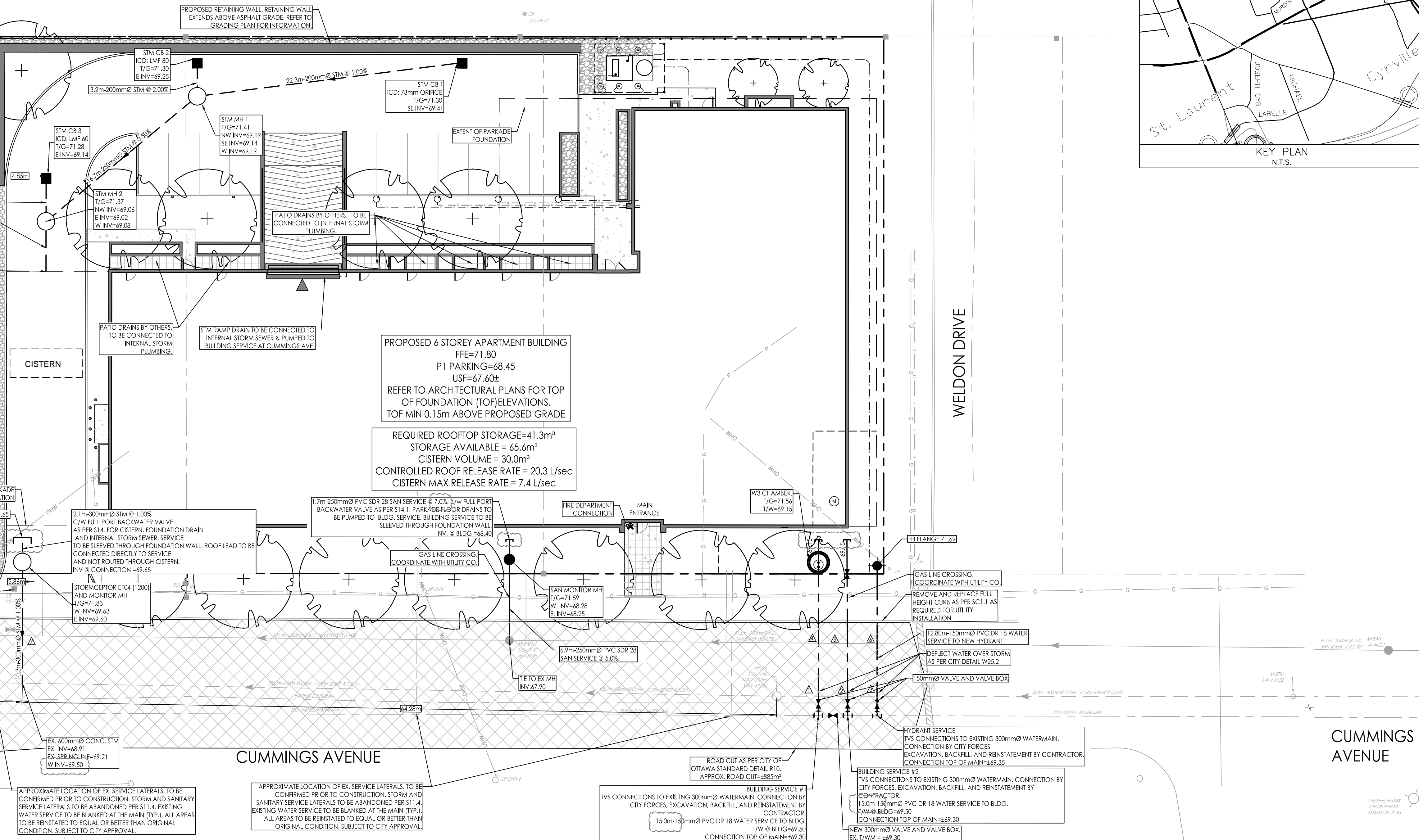

- STORM AND SANITARY SEWERS
1. SEWER TRENCH SHALL CONSIST OF CLASS 'B' BEDDING PER CITY OF OTTAWA STANDARDS S6 AND S7. COMPACTATION SHALL BE A MINIMUM OF 98% STANDARD PROCTOR DENSITY.

- WATER SUPPLY SERVICING
1. THE CONTRACTOR SHALL CONSTRUCT WATERMAIN, WATER SERVICES, CONNECTIONS & APPURTENANCES AS PER CITY OF OTTAWA SPECIFICATIONS & SHALL COORDINATE AND PAY ALL RELATED COSTS INCLUDING THE COST OF CONNECTION, INSPECTION & DISINFECTION BY CITY PERSONNEL.

- GENERAL NOTES
1. ALL WORK SHALL BE CARRIED OUT IN COMPLIANCE WITH THE ONTARIO OCCUPATIONAL HEALTH AND SAFETY ACT AND REGULATIONS FOR CONSTRUCTION PROJECTS.

- 2. THE CONTRACTOR SHALL PROVIDE TO THE ENGINEER 1 (ONE) SET OF AS CONSTRUCTED SITE SERVICING, GRADING, AND SITE ELECTRICAL DWGS.