

- LEGEND**
- PHASE 2 LIMIT OF LANDSCAPE WORKS
 - [Pattern] UNIT PAVING
 - [Pattern] CONCRETE PAVING
EJ=EXPANSION JOINT
CJ=CONTROL JOINT
 - [Pattern] PRE-CAST CONCRETE WALL
 - [Pattern] CAST IN PLACE CONCRETE WALL
 - [Symbol] EXISTING TREE TO BE RETAINED
 - [Symbol] TREE PROTECTION FENCE
 - [Symbol] TREE PLANTING
 - [Symbol] SHRUB PLANTING
 - [Symbol] TOPSOIL AND SEED / SOD
- LIGHTING LEGEND**
- [Symbol] TALL BOLLARD LIGHTS (3m HEIGHT)
 - [Symbol] UPLIGHTS FOR TREES
 - LED TAPE LIGHTS
 - [Symbol] RECESSED LIGHTING (BELOW TRELLIS)
 - [Symbol] ELECTRICAL OUTLETS WITH USB

2	18-01-2023	RE-ISSUED FOR SPA
1	24.06.2022	ISSUED FOR SPA
no.	date	revision

It is the responsibility of the appropriate contractor to check and verify all dimensions on site and report all errors and/or omissions to the architect.

All contractors must comply with all pertinent codes and by-laws.

Do not scale drawings.

This drawing may not be used for construction until signed.

Copyright reserved.

Landscape Architecture
Urban Design
Recreation and Park Planning
Environmental Planning
Arboret

CSW

319 McRae Avenue, Suite 502 Ottawa, Ontario K1Z 0B9
T: (613) 729-4536

Hobin Architecture Incorporated

63 Pamela Street
Ottawa, Ontario
Canada K1S 3K7
T: 613-238-7200
F: 613-235-2005
E: email@hobinarc.com

hobinarc.com

HOBIN
ARCHITECTURE

KEY	BOTANICAL NAME	COMMON NAME	SIZE	QUANTITY	REMARKS
LARGE DECIDUOUS TREES					
AF	ACER FREEMANII 'AUTUMN FANTASY'	AUTUMN FANTASY MAPLE	70mm CAL.	3	B&B/W.B.
GT	GLEDITSIA TRIACANTHOS 'SHADEMASTER'	SHADE MASTER HONEY LOCUST	70mm CAL.	3	B&B/W.B.
GD	GYMNOCLADUS DIOICUS	KENTUCKY COFFEE TREE	70mm CAL.	2	B&B/W.B.
SMALL DECIDUOUS TREES					
AG	AMALANCHIER GRANDIFLORA 'ROBIN HILL'	SERVICEBERRY	50mm CAL.	11	B&B/W.B.
BP	BETULA PAPYRIFERA	SILVER BIRCH	50mm CAL.	11	B&B/W.B. MULTI-STEM
MP	MALUS 'PRAIRIE FIRE'	PRAIRIE FIRE CRABAPPLE	40mm CAL.	13	CONTAINER
CONIFEROUS TREES					
PG	PICEA GLAUCA	WHITE SPRUCE	1.8m HT.	1	B&B/W.B.
PP	PICEA PUNGENS	COLORADO SPRUCE	1.8m HT.	5	B&B/W.B.
PS	PINUS STROBUS	EASTERN WHITE PINE	1.8m HT.	2	B&B/W.B.

APPROVED
By Lily Xu at 10:33 am, Feb 15, 2024

[Signature]

LILY XU, MCIP, RPP
MANAGER, DEVELOPMENT REVIEW SOUTH
PLANNING, INFRASTRUCTURE & ECONOMIC
DEVELOPMENT DEPARTMENT, CITY OF OTTAWA



project
BROOKFIELD RESIDENCE APARTMENT BUILDING
770 BROOKFIELD ROAD, OTTAWA

drawing title
PHASE 2 LANDSCAPE LAYOUT

drawn	date	scale
SE	JUNE 2022	1:250

project
1964-02

drawing no.
L1.0

D07-12-22-0109

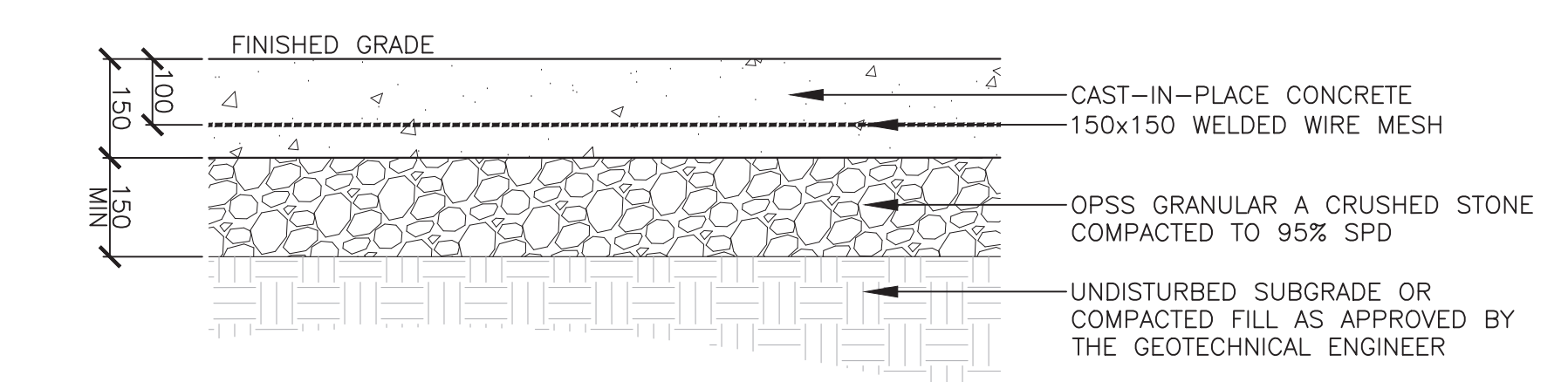

1 CONCRETE PAVING Scale: 1:10

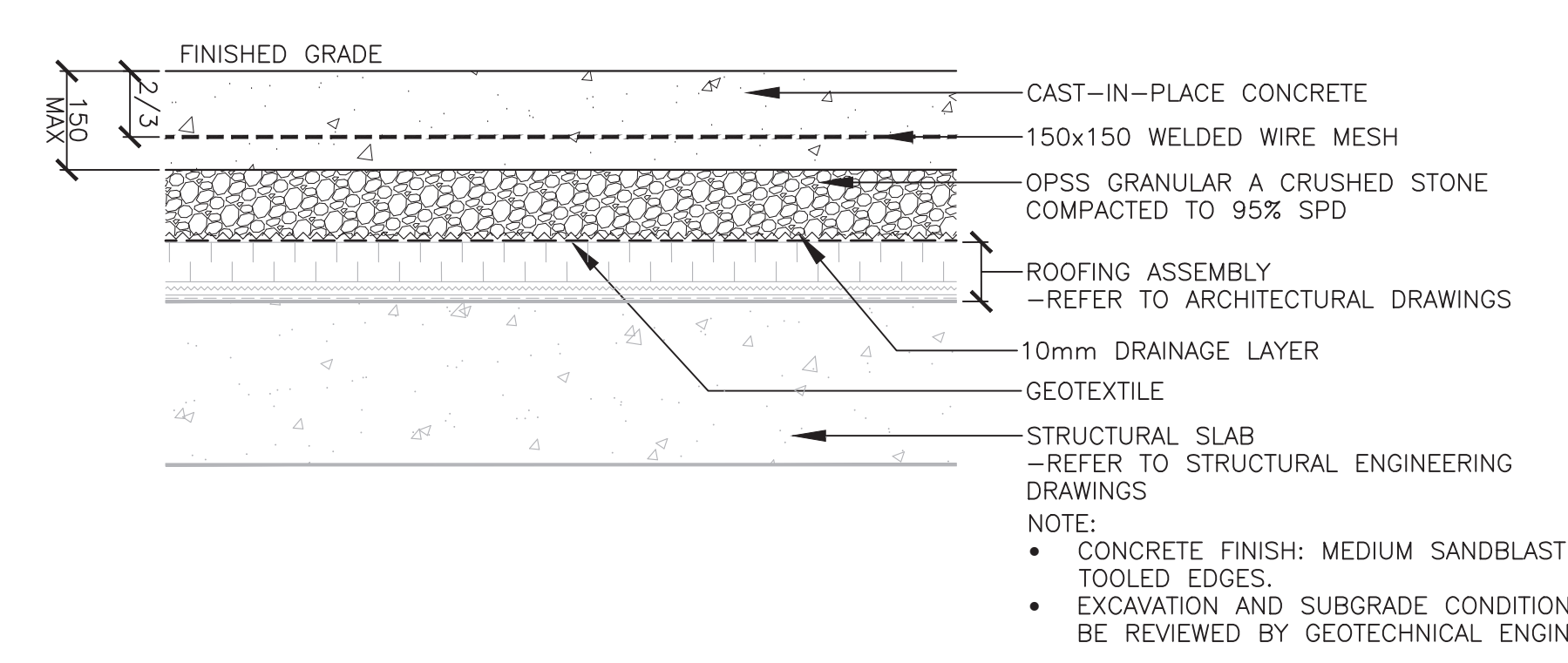

2 CONCRETE PAVING OVER ROOF DECK Scale: 1:10

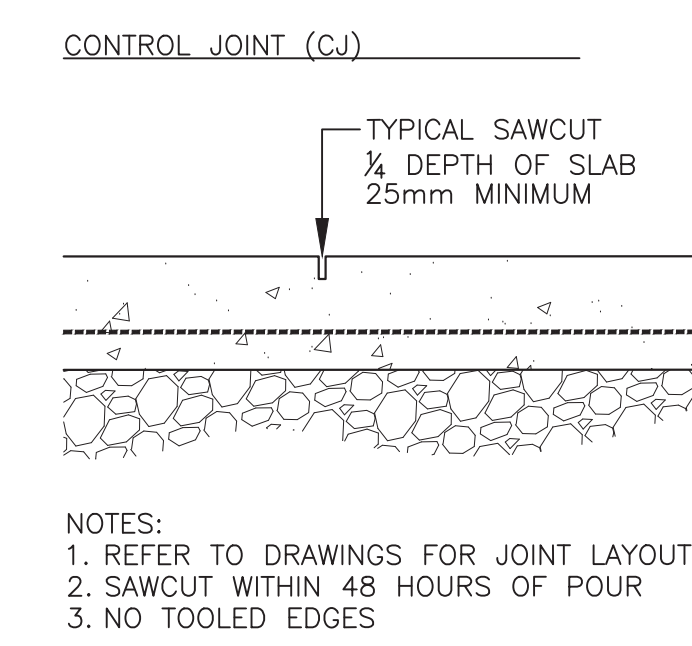

CONTROL JOINT (CJ) NOTES: 1. REFER TO DRAWINGS FOR JOINT LAYOUT 2. SAWCUT WITHIN 48 HOURS OF POUR 3. NO TOOLED EDGES

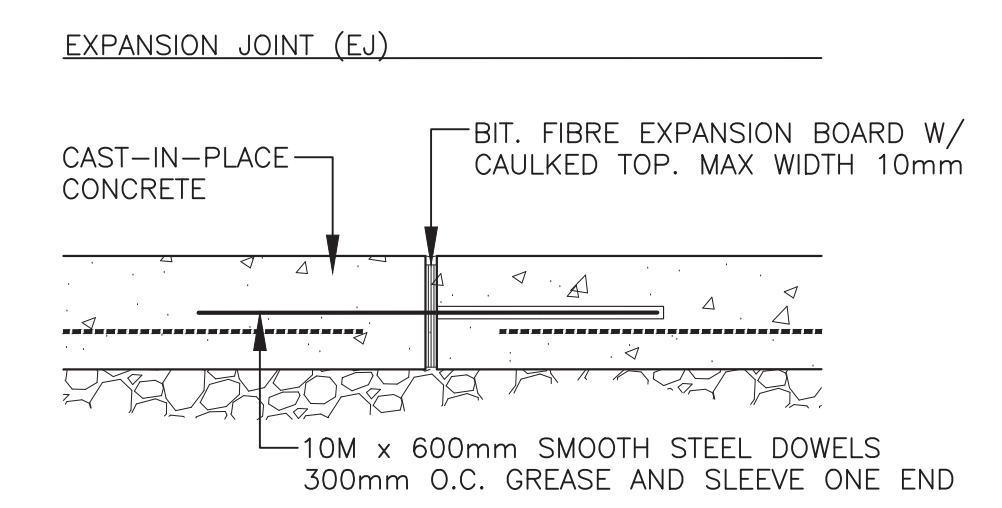

EXPANSION JOINT (EJ) NOTES: 1. REFER TO DRAWINGS FOR JOINT LAYOUT 2. ALL STEEL DOWELS TO BE EPOXY - COATED 3. NO TOOLED EDGES

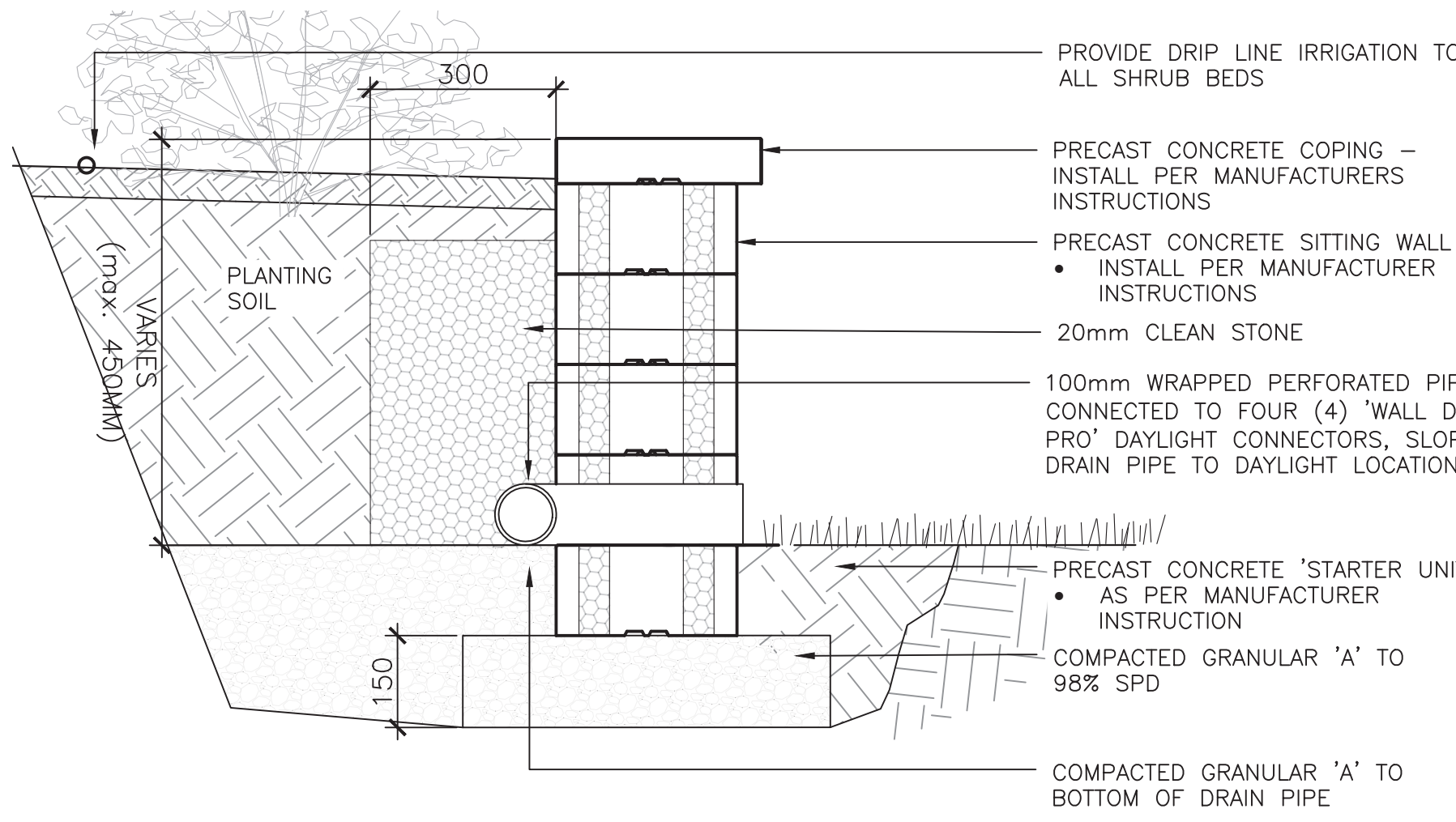

NOTES:
 • ALL VERTICAL WALL JOINTS TO BE STAGGERED
 • ALL CORNERS TO BE OVERLAPPED (NO MITRE CUTS)
 • SECURE ALL WALL UNITS WITH MASONRY ADHESIVE

PRODUCT INFO:
 1. Precast Walls, by Oaks Landscape Products, or approved equal
 1.1. Product: Nueva - 150 Wall units
 1.2. Size: Width of wall shall be 300mm
 1.3. Colour: Greyfield
 2. Precast Coping, by Oaks Landscape Products, or approved equal
 2.1. Product: Nueva Coping Unit
 2.2. Size: 600 x 75 x 340
 2.3. Colour: Marble Grey
 3. Wall Drain Pro Drainage pipe, by Great North Hardscape, or approved equal
 3.1. Product: Wall Drain Pro
 3.2. Size: 150mm height x 45mm width
 3.3. Colour: Grey

6 PRECAST CONCRETE WALL Scale: 1:10

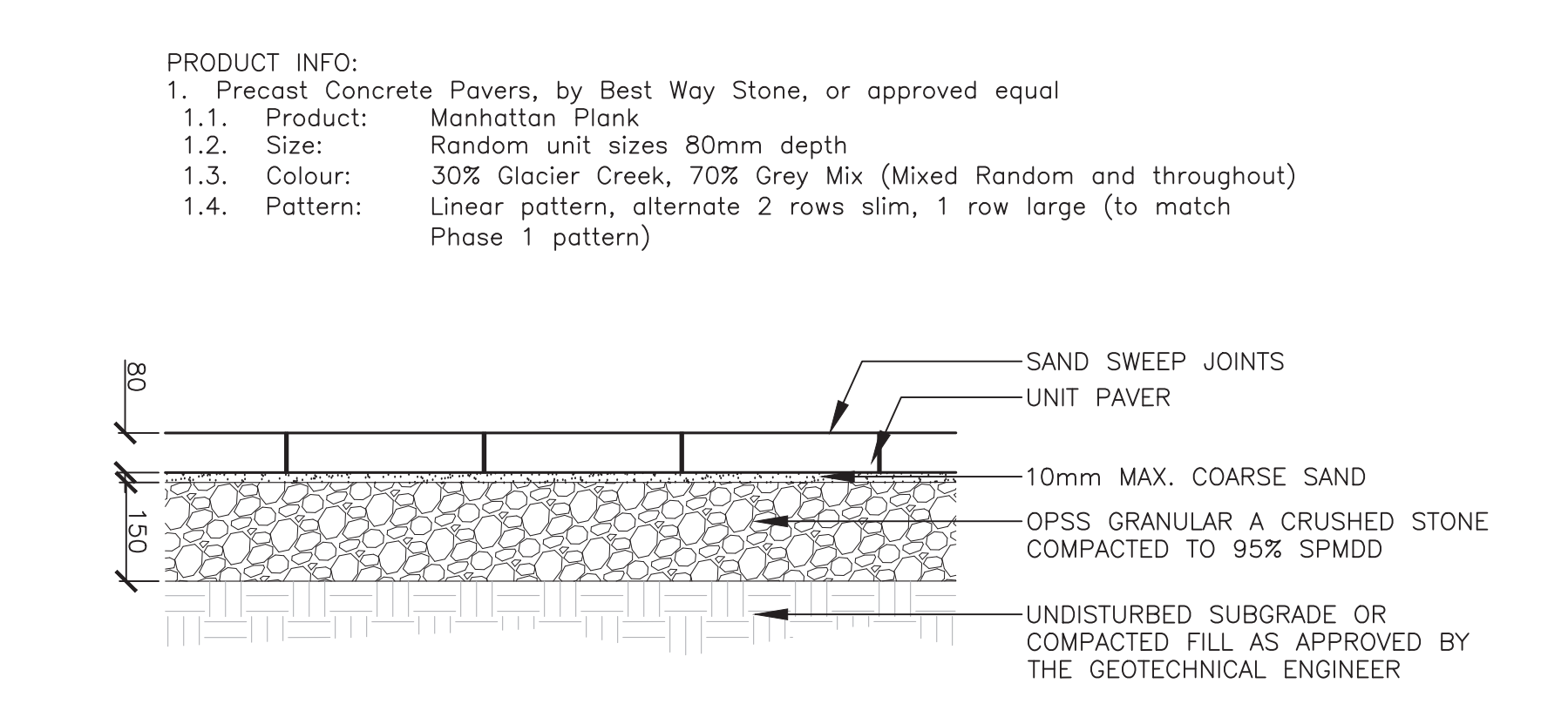

4 UNIT PAVING Scale: 1:10

3 CONCRETE JOINTS Scale: 1:10

PRODUCT INFO:
 1. Precast Concrete Pavers, by Best Way Stone, or approved equal
 1.1. Product: Manhattan Plank
 1.2. Size: Random unit sizes 80mm depth
 1.3. Colour: 30% Glacier Creek, 70% Grey Mix (Mixed Random and throughout)
 1.4. Pattern: Linear pattern, alternate 2 rows slim, 1 row large (to match Phase 1 pattern)

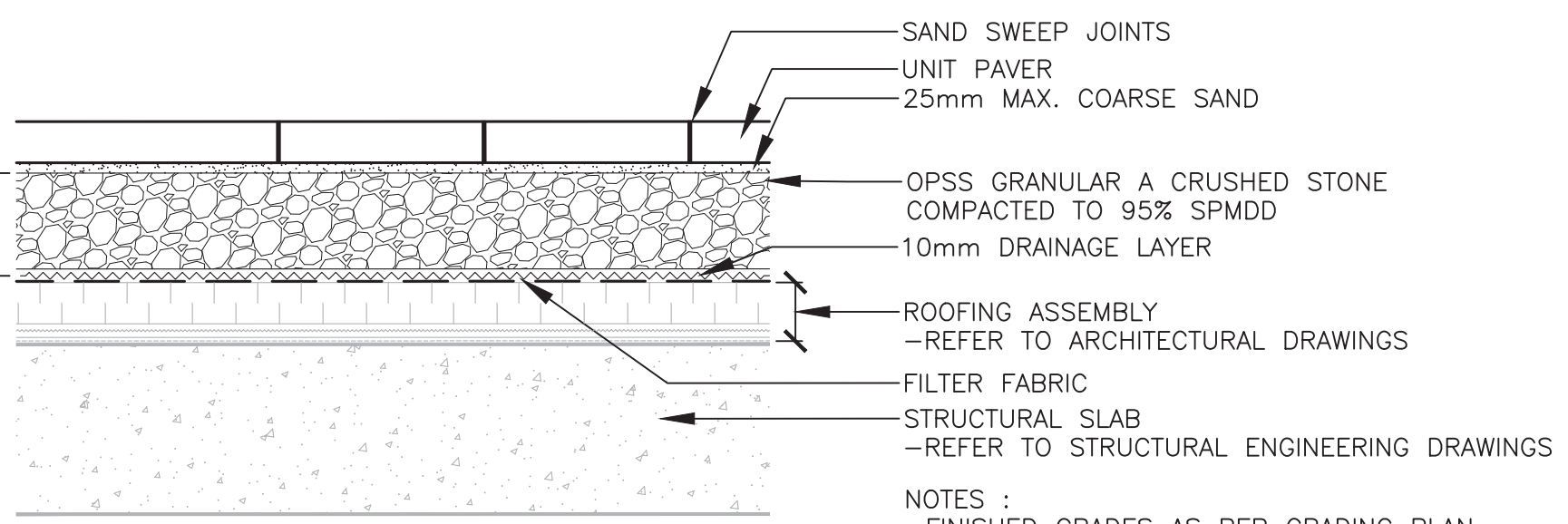

5 UNIT PAVING OVER ROOF DECK Scale: 1:10

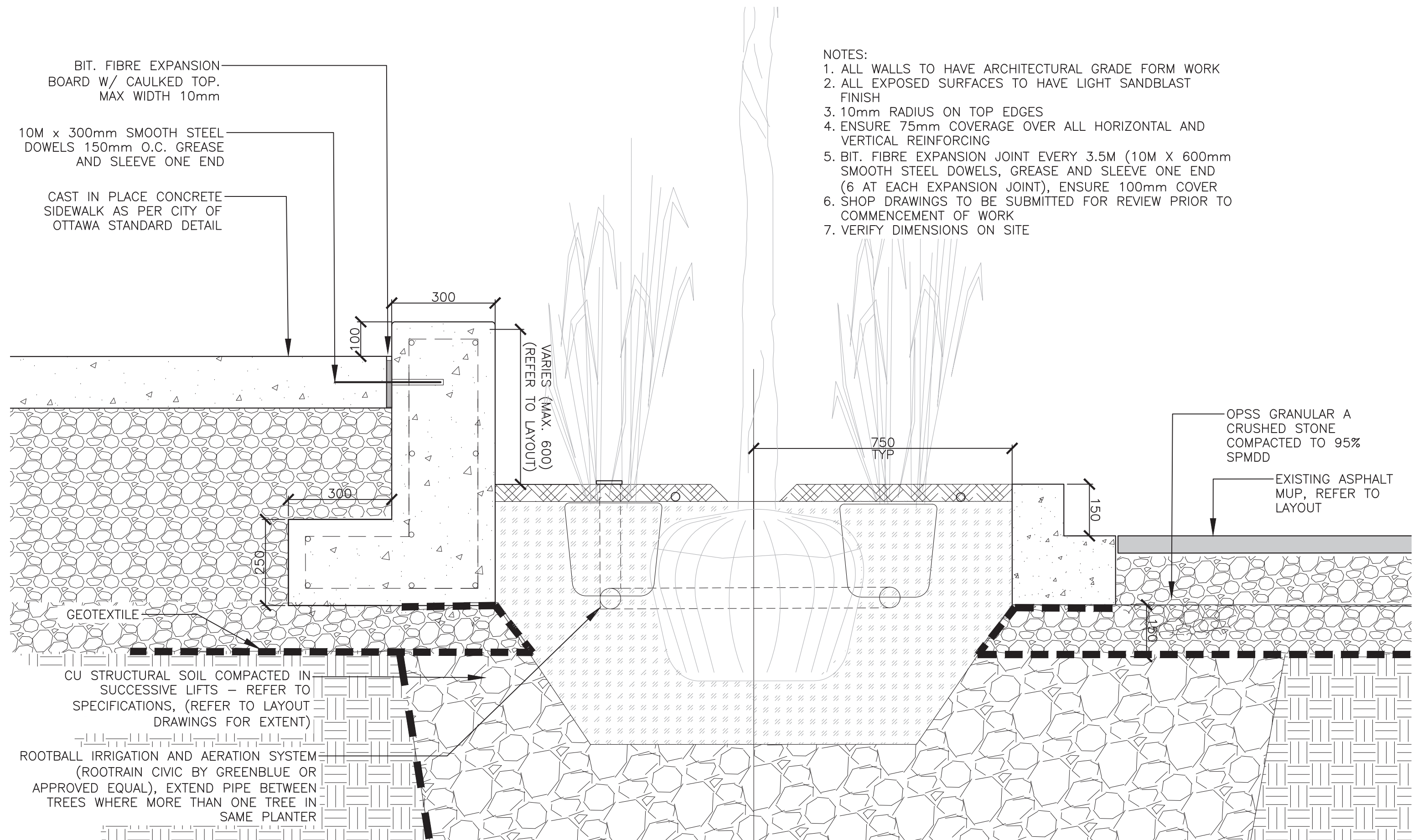

7 C.I.P. CONCRETE PLANTER WALL (AT BROOKFIELD ROAD) Scale: 1:10

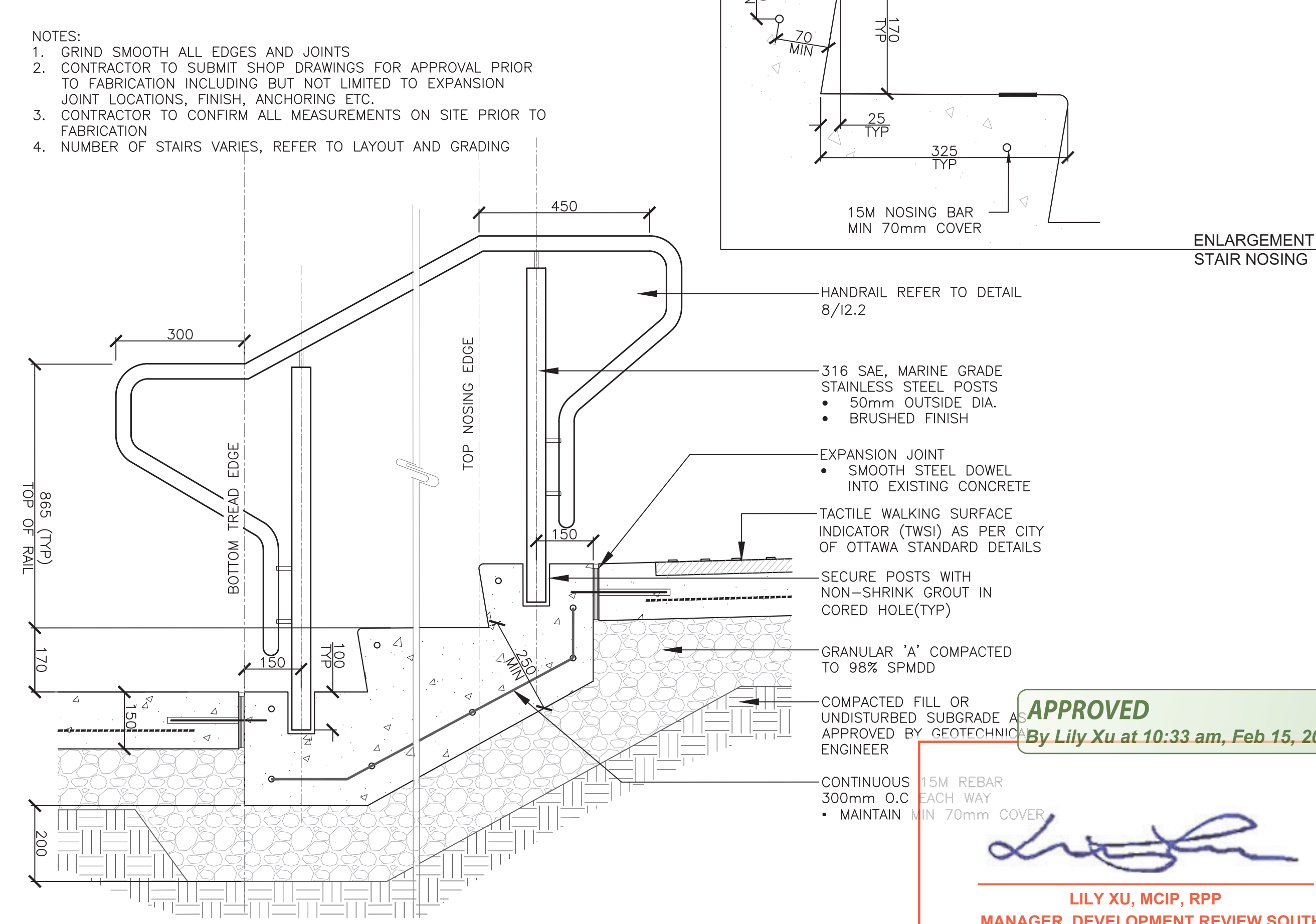

8 C.I.P. CONCRETE STEPS

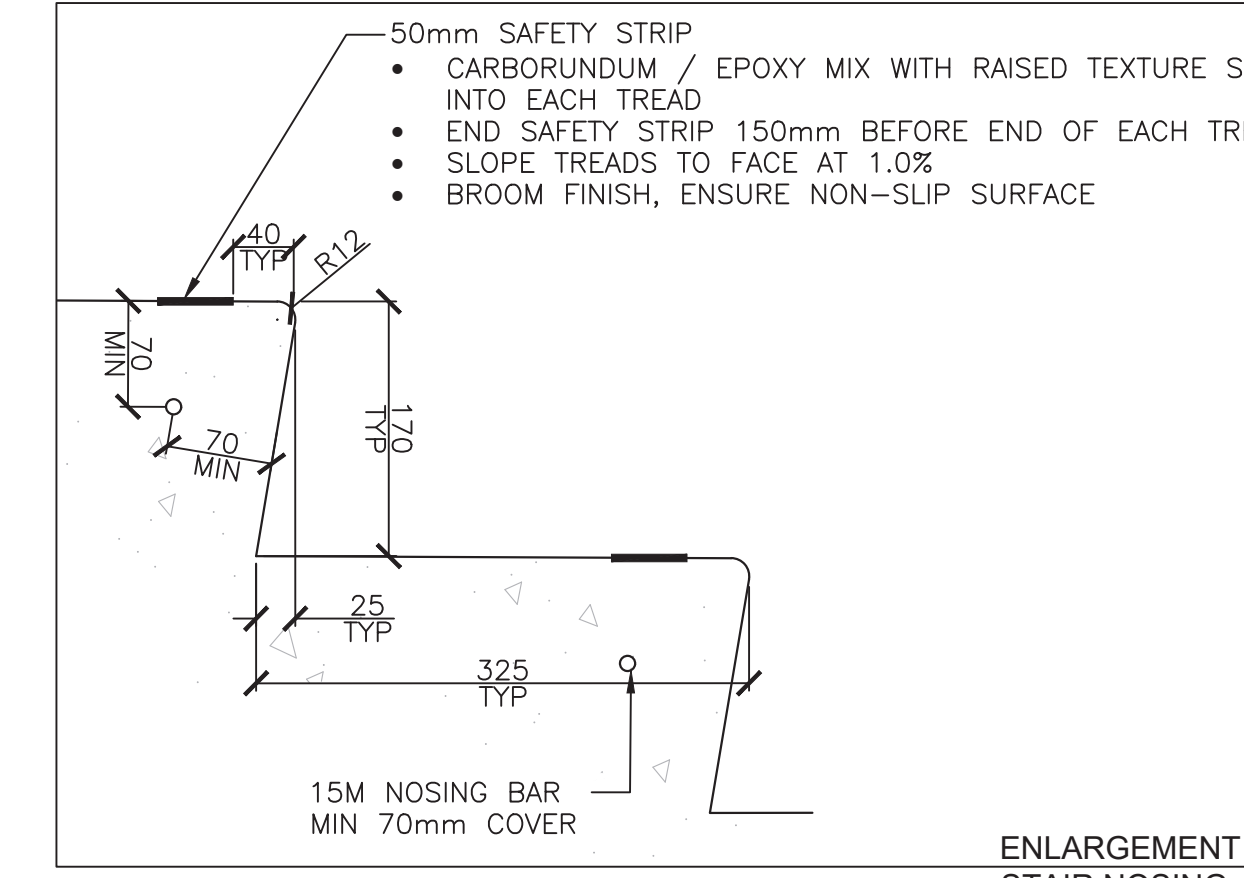

ENLARGEMENT - STAIR NOSING

APPROVED
 By Lily Xu at 10:33 am, Feb 15, 2024

Lily Xu
 LILY XU, MCIP, RPP
 MANAGER, DEVELOPMENT REVIEW SOUTH
 PLANNING, INFRASTRUCTURE & ECONOMIC
 DEVELOPMENT DEPARTMENT, CITY OF OTTAWA

no.	date	revision
2	18.01.2023	RE-ISSUED FOR SPA
1	24.06.2022	ISSUED FOR SPA

It is the responsibility of the appropriate contractor to check and verify all dimensions on site and report all errors and/or omissions to the architect.

All contractors must comply with all pertinent codes and by-laws.

Do not scale drawings.

This drawing may not be used for construction until signed.

Copyright reserved.

Landscape Architecture
 Urban Design
 Recreation and Park
 Planning
 Environmental Planning
 Arborist

CSW

319 McRae Avenue, Suite 502 Ottawa, Ontario K1Z 0B9
 T: (613) 729-4936

Hobin Architecture
 Incorporated

63 Pamela Street
 Ottawa, Ontario
 Canada K1S 3K7

T: 613-238-7200
 F: 613-235-2005
 E: email@hobinarc.com

hobinarc.com

HOBIN
 ARCHITECTURE

project
BROOKFIELD RESIDENCE
 APARTMENT BUILDING
 770 BROOKFIELD ROAD, OTTAWA

drawing title
PHASE 2
 LANDSCAPE DETAILS

drawn	date	scale
SE	JUNE 2022	AS SHOWN
project	1964-02	drawing no.
		L2.0

ASSOCIATION OF LANDSCAPE ARCHITECTS
 OTTAWA CHAPTER

MEMBER

L2.0

D07-12-22-0109

18830

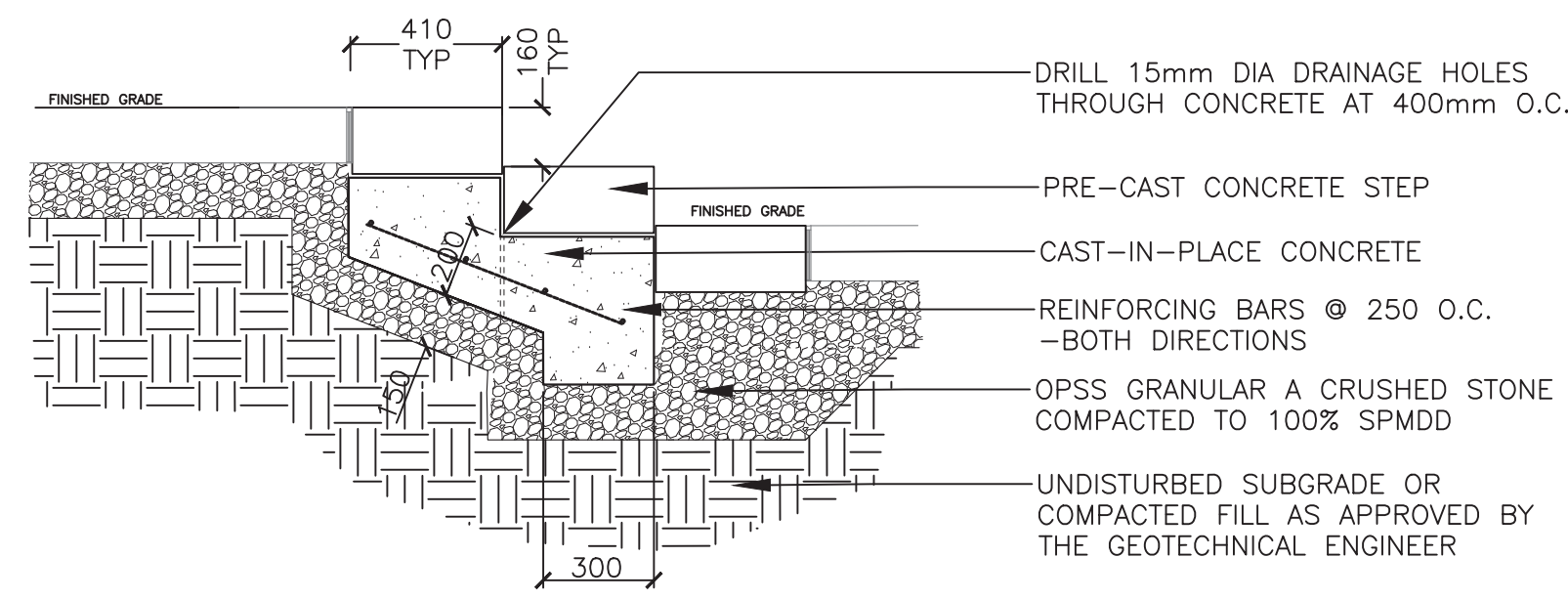

NOTES:
 - GRANULAR BASE TO BE INSPECTED AND APPROVED BY GEOTECHNICAL ENG.
 - ALL REINFORCING IN STAIRS TO BE 15M EPOXY-COATED
 - MAINTAIN 70mm COVER OVER REINFORCING IN CONCRETE
 - SECURE STEPS TO CONCRETE SLAB WITH MASONRY ADHESIVE

PRODUCT INFO:
 1. Precast Concrete Steps, by Permacon, or approved equal
 1.1. Product: Mega Melville Step
 1.2. Size: 180mm x 406mm x 1219mm
 1.3. Colour: Shaded Grey

1 PRECAST CONCRETE STEPS Scale: 1:10

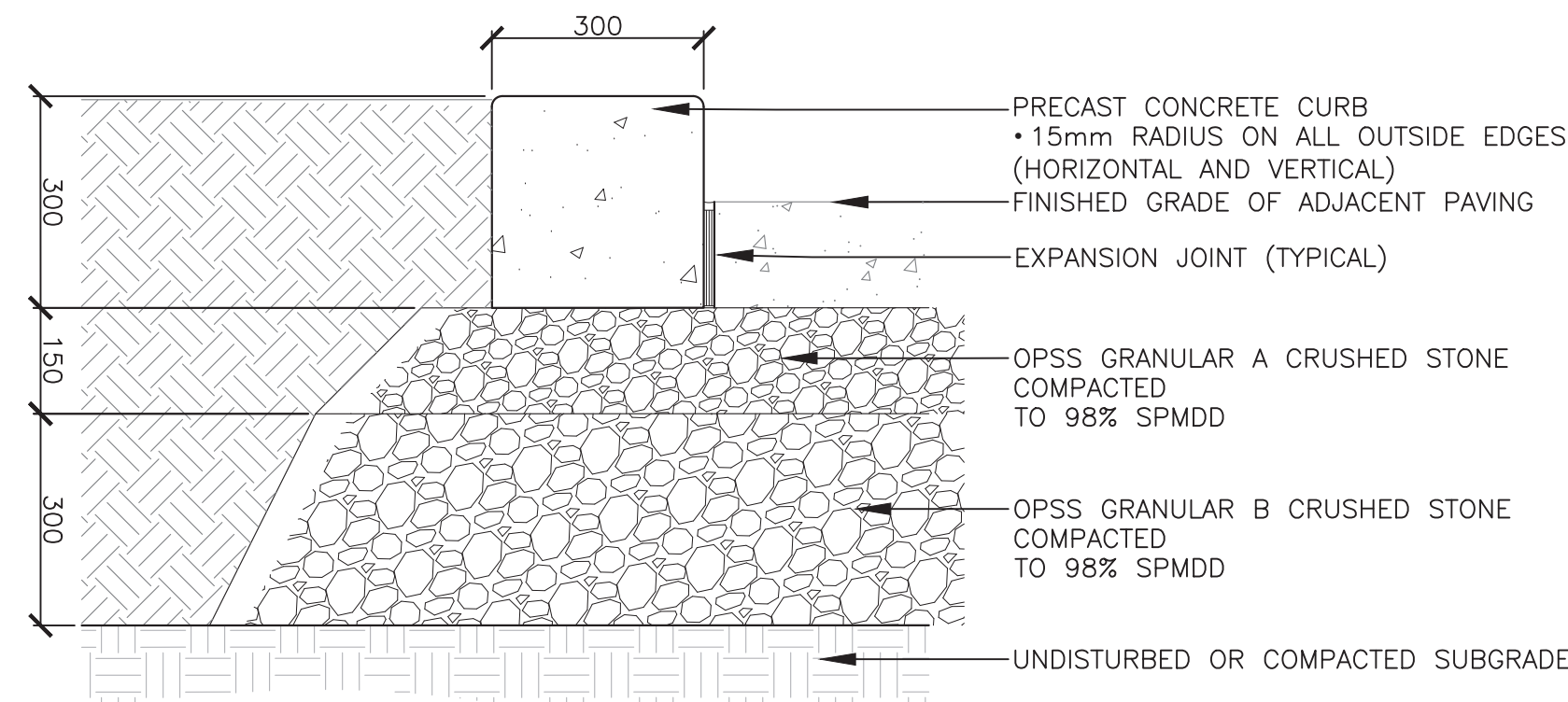

NOTES:
 • EXCAVATION AND SUBGRADE CONDITION TO BE REVIEWED BY GEOTECHNICAL ENGINEER

5 LANDSCAPE CURB Scale: 1:30

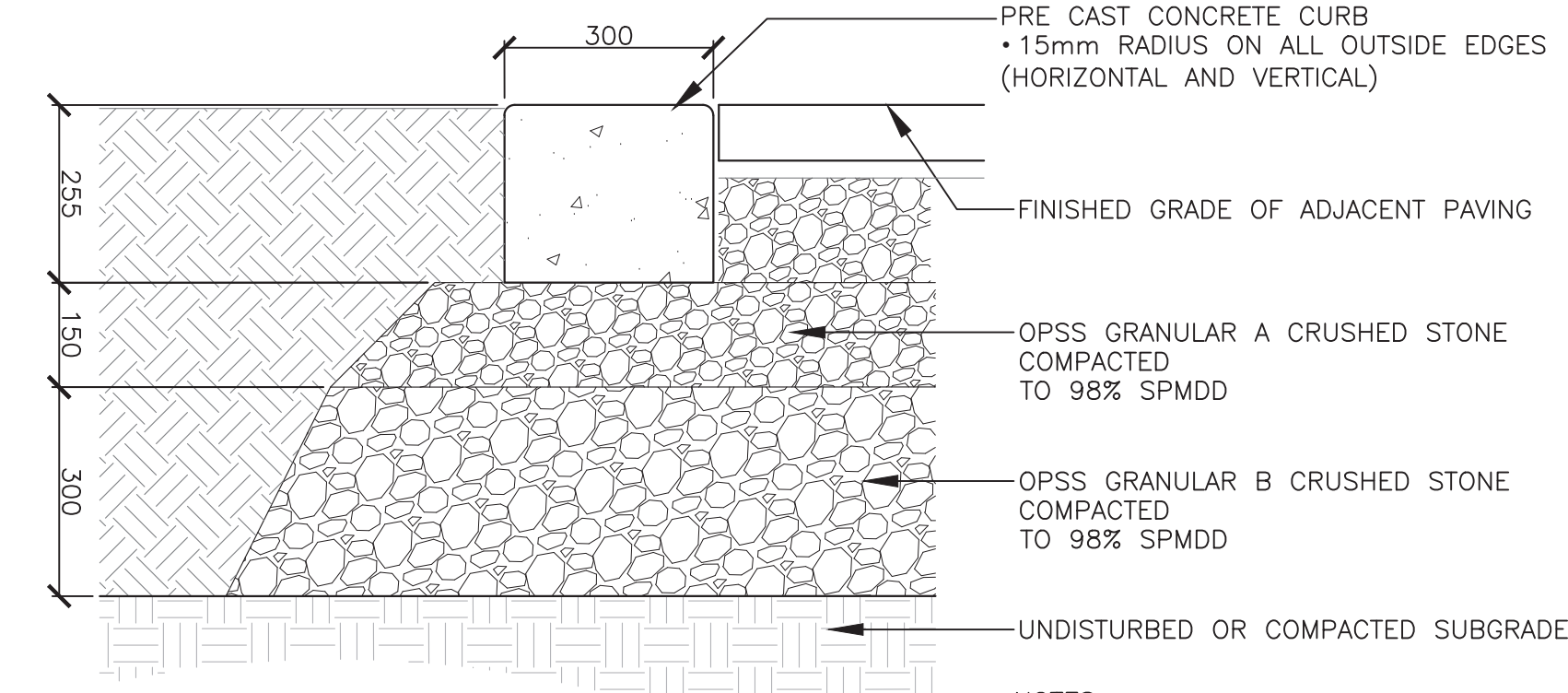

NOTES:
 • EXCAVATION AND SUBGRADE CONDITION TO BE REVIEWED BY GEOTECHNICAL ENGINEER

6 FLUSH LANDSCAPE CURB Scale: 1:30

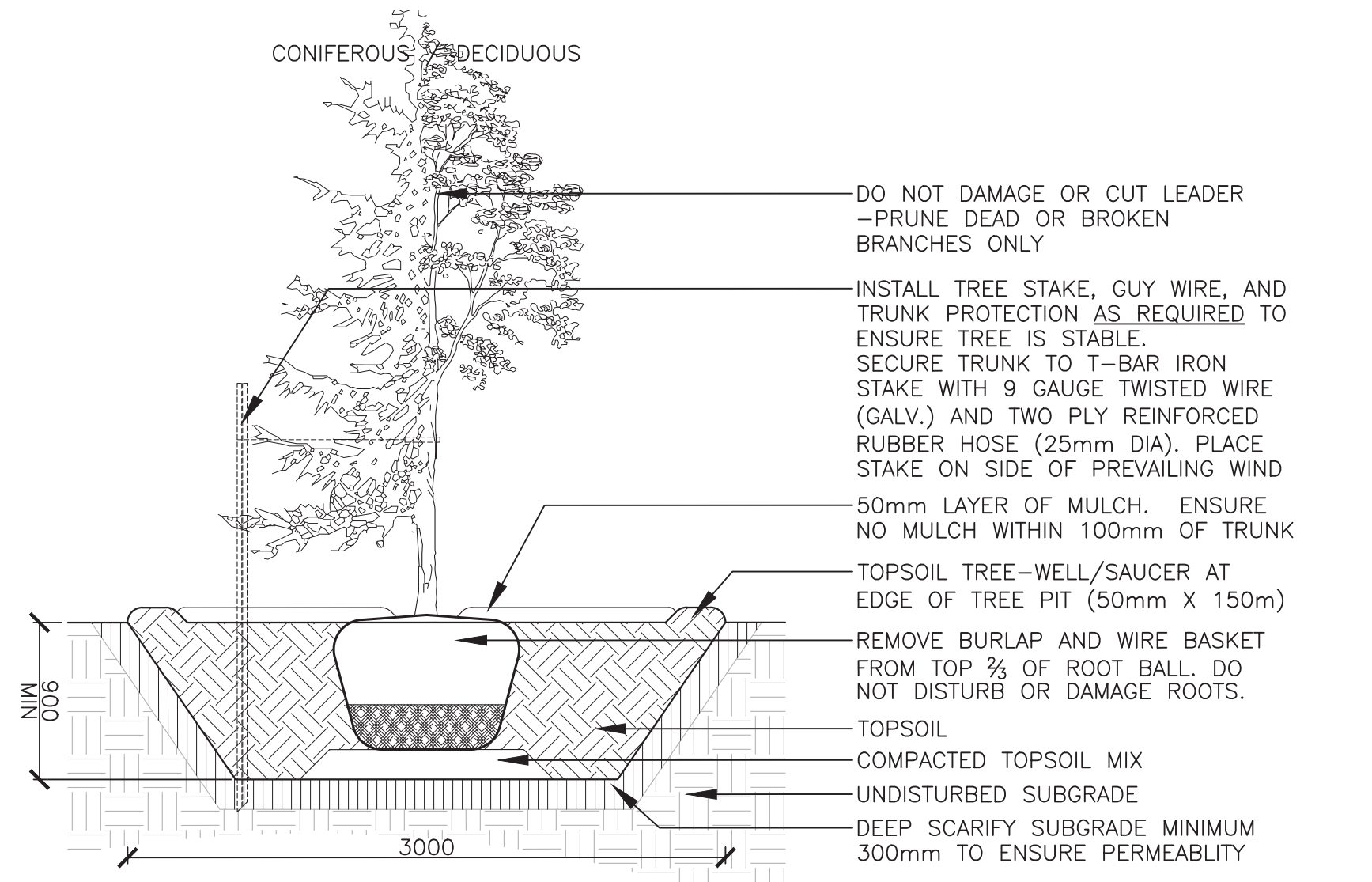

NOTES:
 • DO NOT DAMAGE OR CUT LEADER - PRUNE DEAD OR BROKEN BRANCHES ONLY
 • INSTALL TREE STAKE, GUY WIRE, AND TRUNK PROTECTION AS REQUIRED TO ENSURE TREE IS STABLE. SECURE TRUNK TO T-BAR IRON STAKE WITH 9 GAUGE TWISTED WIRE (GALV.) AND TWO PLY REINFORCED RUBBER HOSE (25mm DIA). PLACE STAKE ON SIDE OF PREVAILING WIND
 • 50mm LAYER OF MULCH. ENSURE NO MULCH WITHIN 100mm OF TRUNK
 • TOPSOIL TREE-WELL/SAUCER AT EDGE OF TREE PIT (50mm X 150m)
 • REMOVE BURLAP AND WIRE BASKET FROM TOP 3/4 OF ROOT BALL. DO NOT DISTURB OR DAMAGE ROOTS.
 • TOPSOIL COMPACTED TOPSOIL MIX
 • UNDISTURBED SUBGRADE
 • DEEP SCARIFY SUBGRADE MINIMUM 300mm TO ENSURE PERMEABILITY

NOTES:
 • TREE STAKES ARE GENERALLY ARE TO BE USED FOR CONDITIONS WHERE THE INSTALLED TREE IS UNSTABLE AND/OR BECOMES UNSTABLE
 • ALLOW 10mm TO 25mm SLACK ON GUY WIRE SUPPORT FOR TREE
 • TOP OF ROOT BALL TO RETAIN SAME ELEVATION AS GROWING CONDITIONS
 • REMOVE STAKES ONE YEAR AFTER INSTALL
 • INSTALL STAKE BEYOND EDGE OF ROOT BALL

2 TREE PLANTING Scale: 1:30

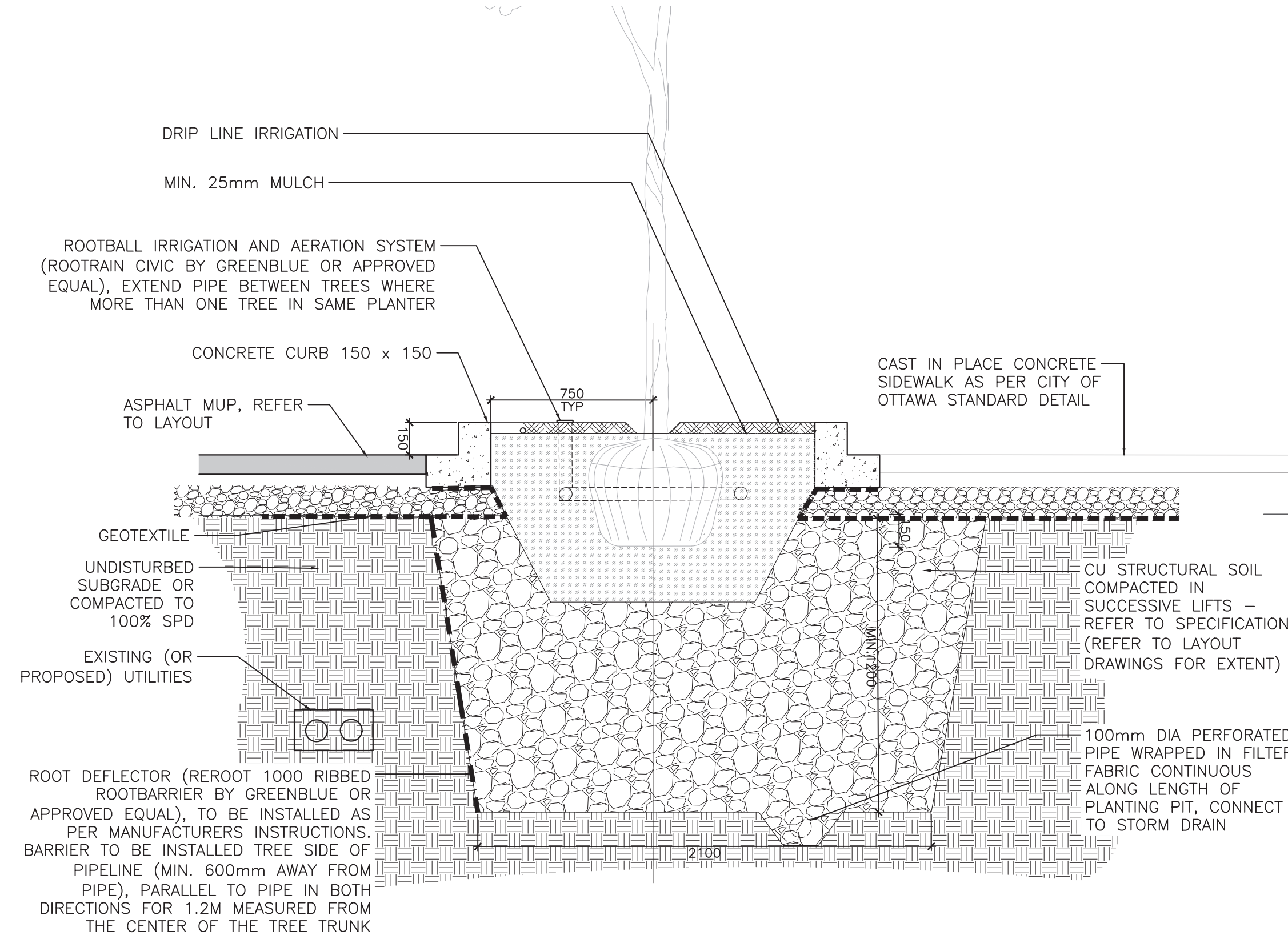

7 TREE PLANTING IN STRUCTURAL SOIL Scale: 1:20

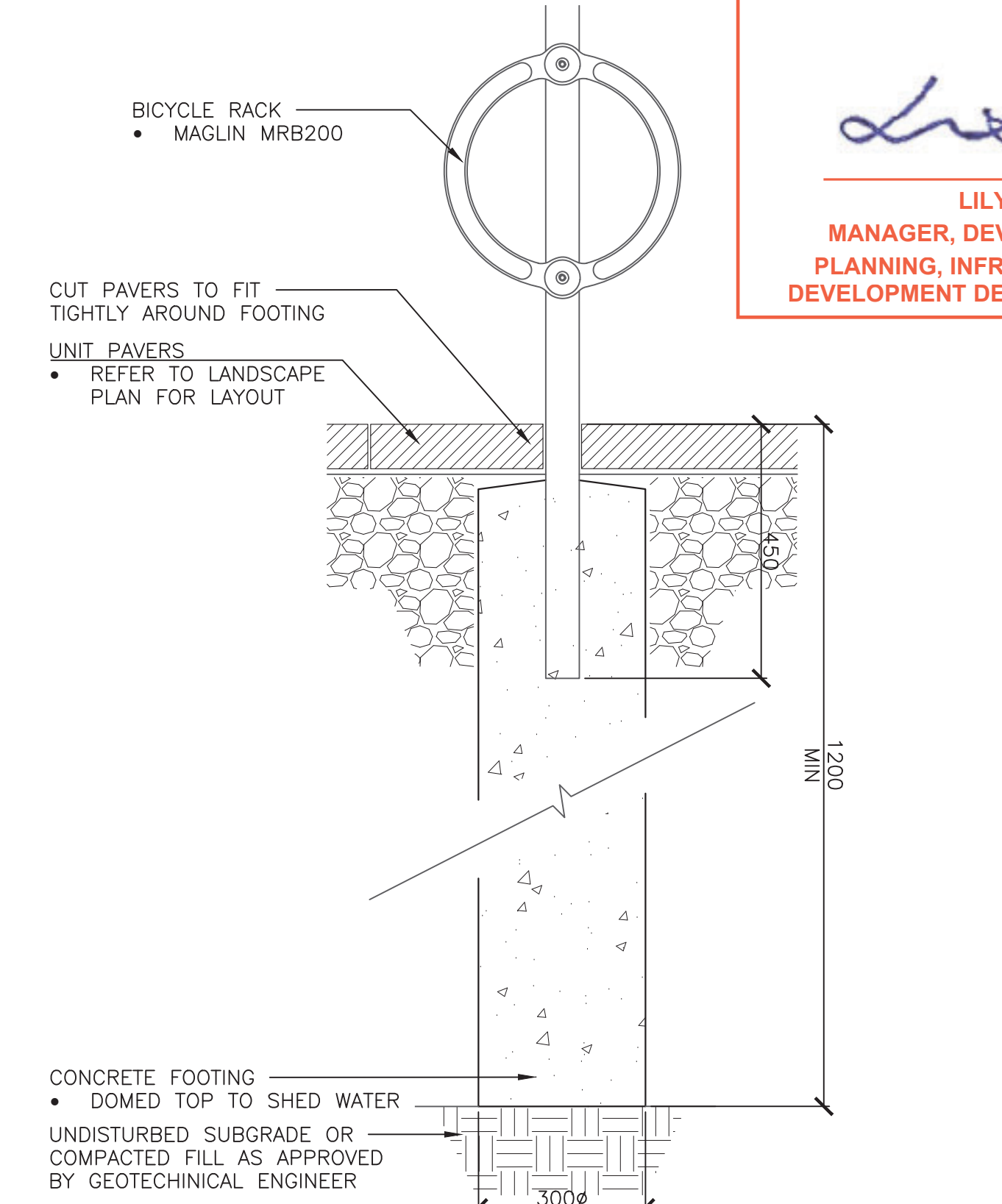

8 BICYCLE RING Scale: 1:10

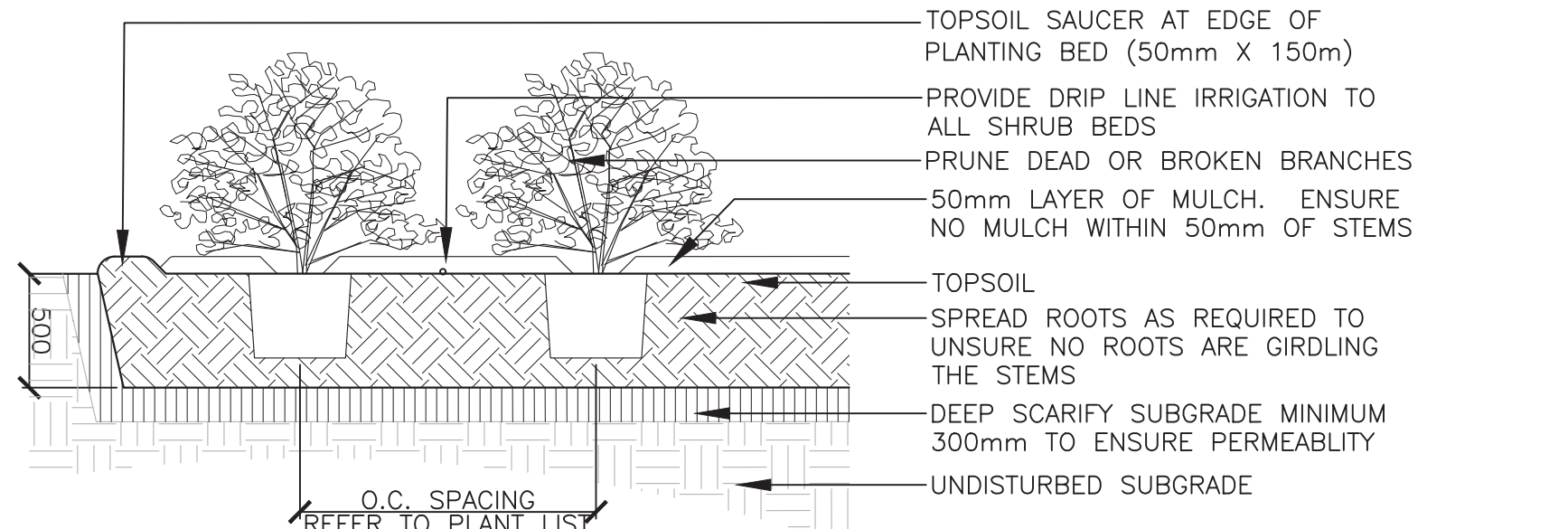

NOTES:
 • TOP OF ROOT BALL TO RETAIN SAME ELEVATION AS GROWING CONDITIONS

3 SHRUB PLANTING Scale: 1:30

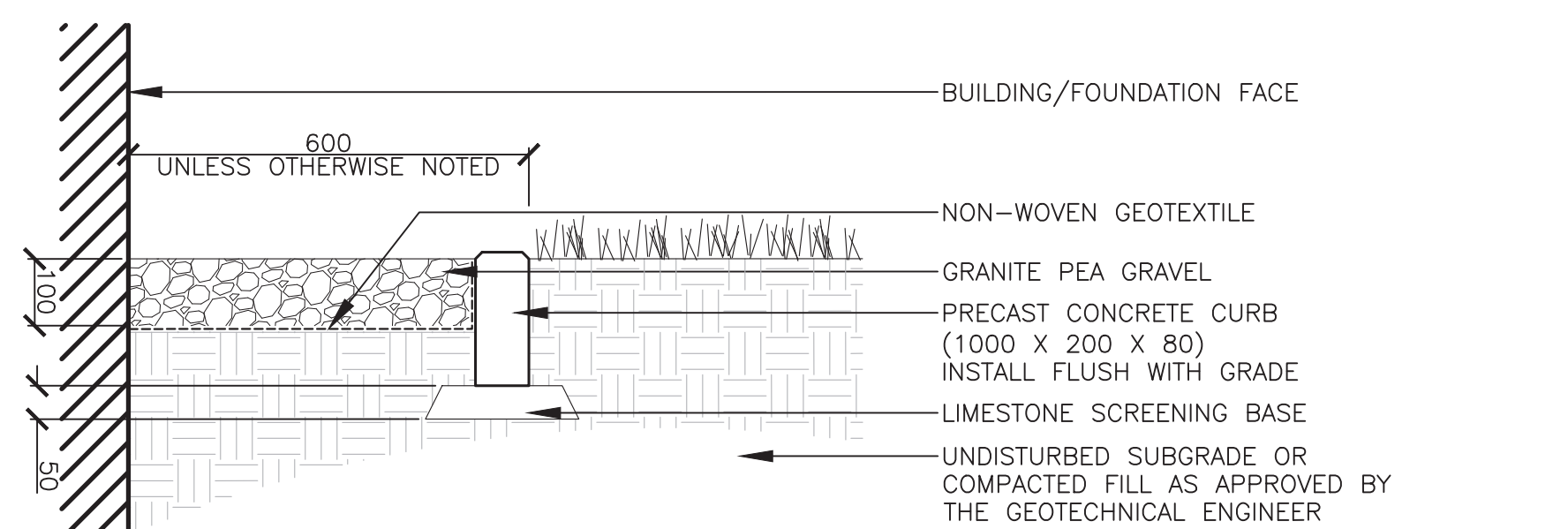

4 MAINTENANCE EDGE Scale: 1:10

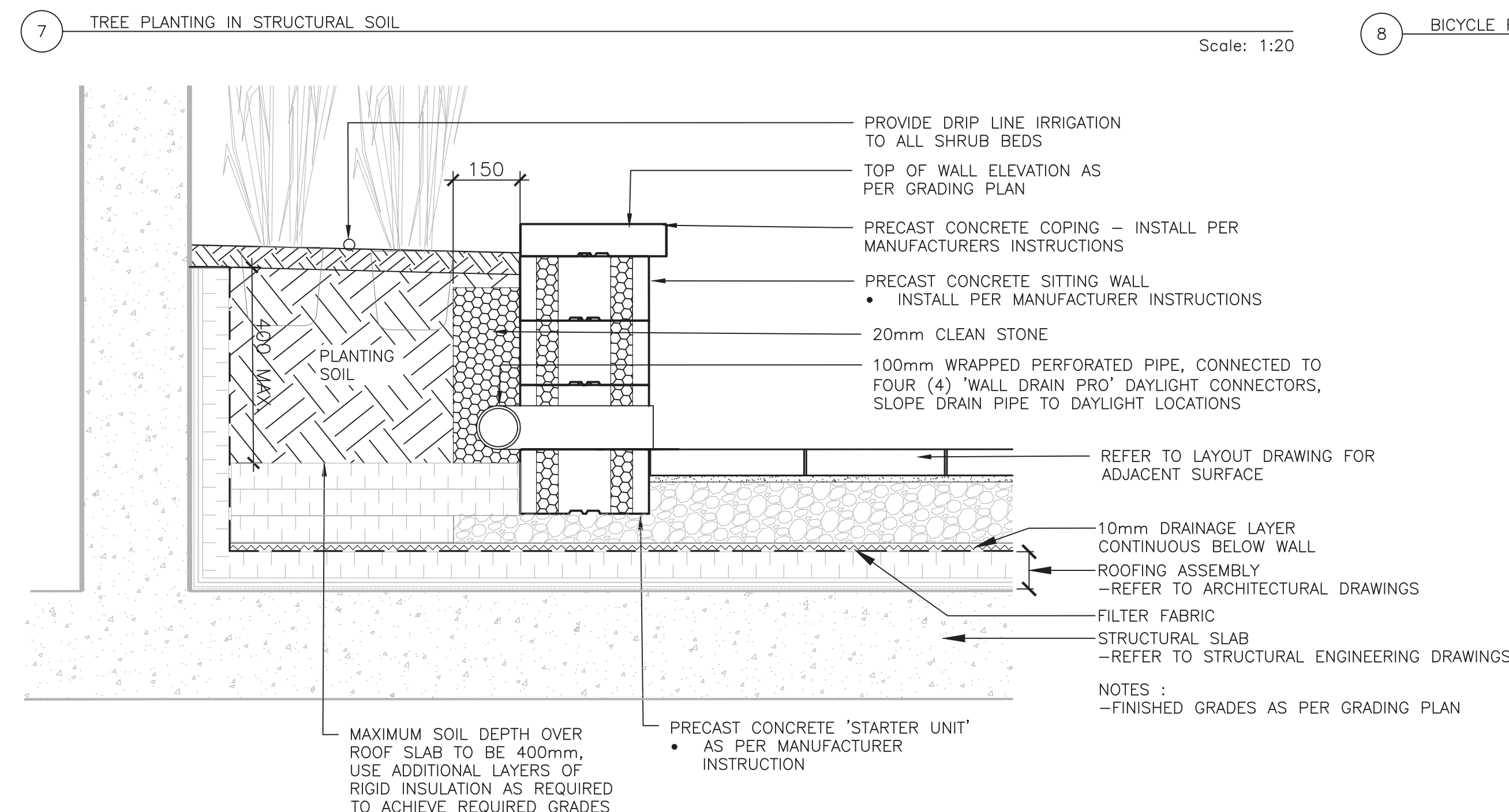

9 PRE-CAST CONCRETE PLANTER WALL Scale: 1:10

APPROVED
 By Lily Xu at 10:33 am, Feb 15, 2024

Lily Xu
 LILY XU, MCIP, RPP

MANAGER, DEVELOPMENT REVIEW SOUTH
 PLANNING, INFRASTRUCTURE & ECONOMIC
 DEVELOPMENT DEPARTMENT, CITY OF OTTAWA

2	18-01-2023	RE-ISSUED FOR SPA
1	24.06.2022	ISSUED FOR SPA
no.	date	revision

It is the responsibility of the appropriate contractor to check and verify all dimensions on site and report all errors and/or omissions to the architect.

All contractors must comply with all pertinent codes and by-laws.

Do not scale drawings.

This drawing may not be used for construction until signed.

Copyright reserved.

CSW
 Landscape Architecture
 Urban Design
 Recreation and Park Planning
 Environmental Planning
 Arborist
 319 McRae Avenue, Suite 502 Ottawa, Ontario K1Z 0B9
 T: (613) 729-4536

Hobin Architecture Incorporated
 63 Pamela Street
 Ottawa, Ontario
 Canada K1S 3K7
 T: 613-238-7200
 F: 613-235-2005
 E: email@hobinarc.com
 hobinarc.com

project
BROOKFIELD RESIDENCE APARTMENT BUILDING
 770 BROOKFIELD ROAD, OTTAWA

drawing title
PHASE 2 LANDSCAPE DETAILS

drawn	date	scale
SE	JUNE 2022	AS SHOWN

project	1964-02
drawing no.	L2.1

ASSOCIATION OF LANDSCAPE ARCHITECTS OF ONTARIO
 MEMBER