

NOTES:

- DO NOT SCALE DRAWINGS;
- NOTES ARE APPLICABLE TO ALL DRAWINGS IN THE SET;
- Fotenn Consultants Inc. IS NOT RESPONSIBLE FOR ACCURACY OF BASE INFORMATION;
- REFER TO CIVIL ENGINEERING DRAWINGS FOR GRADING & SITE SERVICING INFORMATION;
- THE CONTRACTOR IS RESPONSIBLE FOR CONFIRMING SITE CONDITIONS AND REPORTING ANY DISCREPANCIES TO THE LANDSCAPE ARCHITECT;
- THE CONTRACTOR IS RESPONSIBLE FOR CONFIRMING EXACT LOCATIONS OF ALL UNDERGROUND SERVICES AND OBTAINING CLEARANCE FROM ALL APPLICABLE UTILITIES. PROPOSED WORKS FOUND TO BE IN CONFLICT WITH UNDERGROUND SERVICES MAY BE ADJUSTED AT THE DIRECTION OF THE LANDSCAPE ARCHITECT;
- LANDSCAPE ELEMENTS SHOWN ARE SUBJECT TO THE FINAL LOCATION OF UNDERGROUND SERVICES AND UTILITIES;
- DO NOT INSTALL TREES ON PROPERTY / LOT LINES OR WITHIN DRAINAGE EASEMENTS;
- PERFORM WORK IN ACCORDANCE WITH DETAILS AND SPECIFICATIONS;
- ALL PLANT MATERIAL SHALL BE No. 1 NURSERY STOCK AND SHALL MEET OR EXCEED THE SPECIFICATION OF THE Canadian Standards for Nursery Stock, AS PUBLISHED BY THE Canadian Nursery Landscape Association;
- SPECIES SUBSTITUTIONS ARE NOT PERMITTED WITHOUT PRIOR WRITTEN APPROVAL OF THE LANDSCAPE ARCHITECT;
- ALL UN-PAVED SURFACES TO RECEIVE 150mm DEPTH TOPSOIL & SOD.

STANDARDS FOR TREE PLANTING:

- NO PLANTING ON CORNERS OR ANYWHERE WHERE IT WOULD CREATE A SIGHT LINE CONCERN;
- MAINTAIN A MINIMUM DISTANCE OF 2.5m FROM THE CURB FOR DECIDUOUS TREES AND 4.5m FOR CONIFEROUS TREES;
- MAINTAIN A MINIMUM DISTANCE OF 1.5m FOR DECIDUOUS (4.5m FOR CONIFERS) FROM ANY SIDEWALK OR PRIVATE WALKWAY;
- MAINTAIN A MINIMUM DISTANCE OF 1.2m FROM ALL DRIVEWAYS;
- MAINTAIN A MINIMUM DISTANCE OF 2.5m FROM COMMUNITY MAILBOXES, LIGHT STANDARDS, FIRE HYDRANTS AND NO PLANTING IN FRONT OF HYDRANTS;
- MAINTAIN A MINIMUM DISTANCE OF 3.0m FROM ALL HYDRO TRANSFORMERS;
- MAINTAIN A MINIMUM DISTANCE OF 1.0m FROM ALL UNDERGROUND SERVICES;
- MAINTAIN A MINIMUM DISTANCE OF 1.0m FROM ALL BELL AND CABLE BOXES;
- MAINTAIN A MINIMUM DISTANCE OF 10.0 FROM BUS SHELTERS

At Hamlin

ALLISON HAMLIN
MANAGER (A), DEVELOPMENT REVIEW WEST
PLANNING, REAL ESTATE & ECONOMIC DEVELOPMENT
DEPARTMENT, CITY OF OTTAWA

APPROVED
 By Allison Hamlin at 5:16 pm, Feb 29, 2024

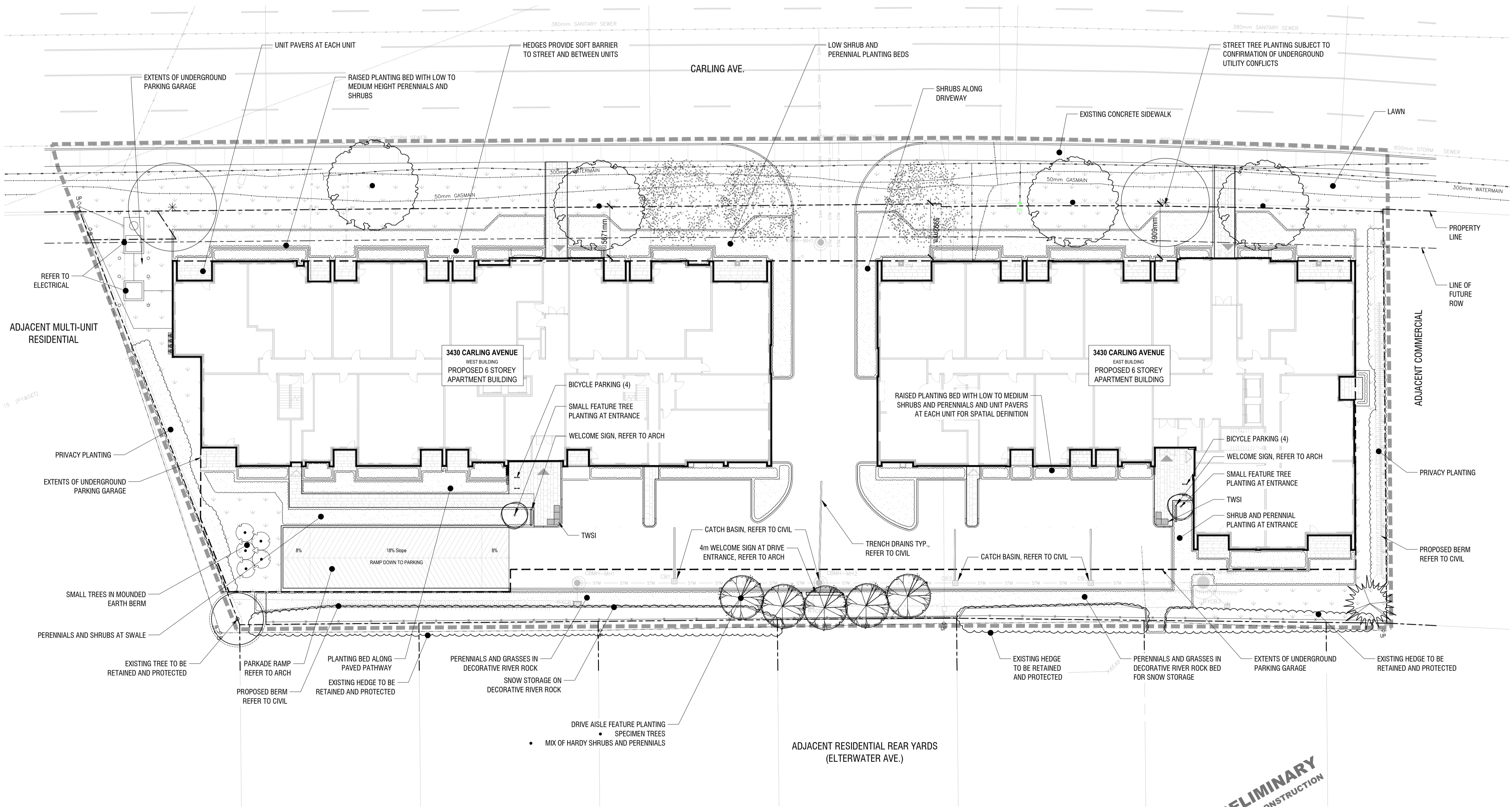

Copyright Reserved
 The Copyrights to all designs and drawings are the property of Fotenn Consultants Inc. Unauthorized reproduction or use is forbidden. DO NOT SCALE DRAWING
 Copyright réservés
 Les droits d'auteur à tous les modèles et dessins sont la propriété de Fotenn Consultants Inc. Reproduction ou utilisation non autorisée est interdite. NE PAS L'ÉCHELLE DE DESSIN



key plan / plan repère

- Legend / légende
- SCOPE OF WORK
 - EXTENTS OF UNDERGROUND PARKING GARAGE
 - TREE PROTECTION FENCING
 - PROPERTY LINE
 - EXISTING TREES TO REMAIN
 - CRITICAL ROOT ZONE
 - DECIDUOUS TREE PLANTING (REFER TO PLANTING SCHEDULE FOR SPECIES AND QUANTITIES)
 - CONIFEROUS TREE AND SHRUB PLANTING (REFER TO PLANTING SCHEDULE FOR SPECIES AND QUANTITIES)
 - PLANTING AREA
 - LAWN
 - 2.1m HIGH BLACK CHAIN LINK FENCE
 - 0.45m HIGH RETAINING WALL
 - BIKE RACK

rev'n	description / la description	yyyy/mm/dd
06	revised in response to Consultant changes	2024/01/12
05	revised in response to City comments	2023/12/18
04	re-issue for SPA	2023/08/24
03	re-issue for SPA	2023/07/24
02	re-issue for SPA	2023/03/31
01	issue for SPA	2022/12/16
00	issue for ZBLA	2022/11/15

FOTENN Planning + Design
 396 Cooper Street, Suite 300
 Ottawa, ON, CANADA K2P 2H7
 613.730.5709
 fotenn.com

north / le nord stamp / le cachet

3430 CARLING AVENUE

LANDSCAPE PLAN

designed / conçu	drawn / dessiné	reviewed / examiné
BM / EM	BM / EM	DF
date	project number / No. du projet	
Nov. 2022		

drawing number / No. du dessin
L1 of 4

1 LANDSCAPE PLAN
L1 1:250

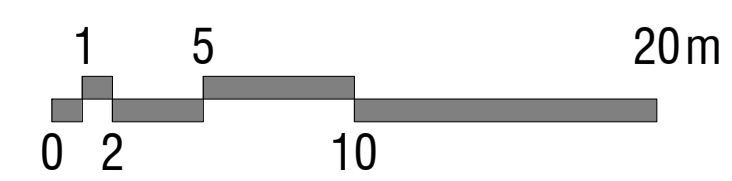

PRELIMINARY
 NOT FOR CONSTRUCTION

PLOT INFORMATION: DWG NAME: P:\PROJECTS\3430 CARLING AVENUE\LANDSCAPE\DESIGN\3430 CARLING AVENUE_LANDSCAPE_L1.DWG PLOT DATE: 2024-01-12 12:52:25 PM SHEET SIZE: 600x900 (mm) PLOTTED BY: Barbara Mitchell LAST SAVED BY: barbamit

CARLING AVE.

APPROVED
 By Allison Hamlin at 5:16 pm, Feb 29, 2024



key plan / plan repère
Allanlin
ALLISON HAMLIN
 MANAGER (A), DEVELOPMENT REVIEW WEST
 PLANNING, REAL ESTATE & ECONOMIC DEVELOPMENT
 DEPARTMENT, CITY OF OTTAWA

- legend / légende
- SYMBOLS LEGEND:**
- SCOPE OF WORK
 - - - EXTENTS OF UNDERGROUND PARKING GARAGE
 - TREE PROTECTION FENCING
 - PROPERTY LINE
 - (Tree symbols) DECIDUOUS TREE AND SHRUB PLANTING (REFER TO PLANTING SCHEDULE FOR SPECIES AND QUANTITIES)
 - (Starburst symbols) CONIFEROUS TREE AND SHRUB PLANTING (REFER TO PLANTING SCHEDULE FOR SPECIES AND QUANTITIES)
 - (Dotted pattern) LAWN
 - (Wall symbol) 0.45m HIGH RETAINING WALL

06	revised in response to Consultant changes	2024/01/12
05	revised in response to City comments	2023/12/18
04	re-issue for SPA	2023/08/24
03	re-issue for SPA	2023/07/24
02	re-issue for SPA	2023/03/31
01	issue for SPA	2022/12/16
00	issue for ZBLA	2022/11/15
rev'n	description / la description	yyyy/mm/dd

FOTENN Planning + Design
 396 Cooper Street, Suite 300
 Ottawa, ON, CANADA K2P 2H7
 613.730.5709
 fotenn.com

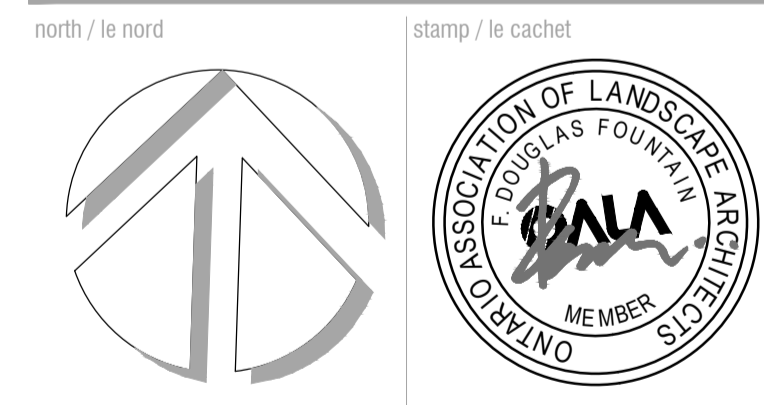

project / projet
3430 CARLING AVENUE

drawing / dessin
LANDSCAPE PLAN

designed / conçu
BM / EM
 date
Nov. 2022
 drawing number / No. du dessin

drawn / dessiné
BM / EM
 project number / No. du projet

reviewed / examiné
DF

L2 of 4

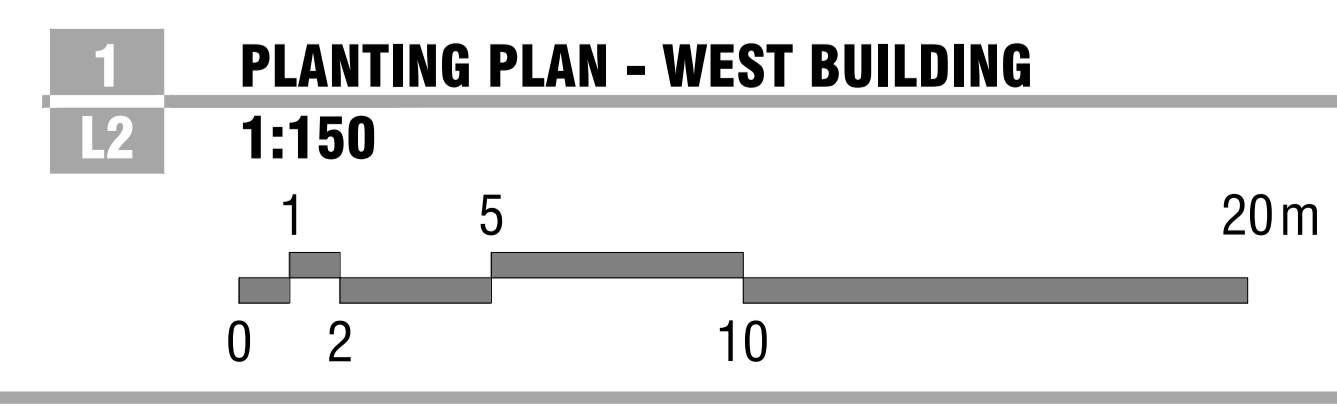
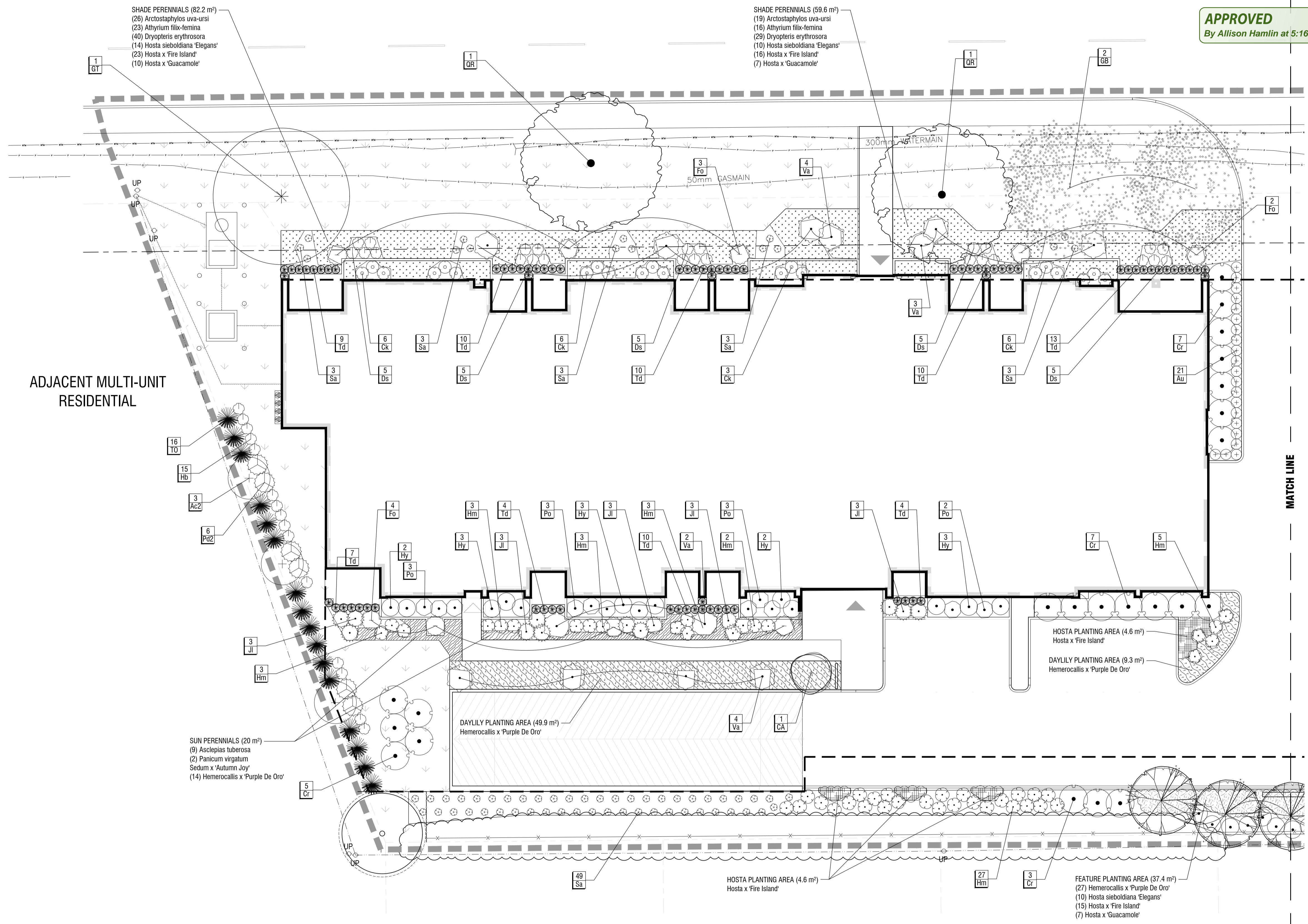

PRELIMINARY
 NOT FOR CONSTRUCTION

PLOT INFORMATION: DWG NAME: P:\PROJECTS\3430 CARLING\3430 Carling - Planting - 3430 Carling.dwg PLOT DATE: 2024-01-12 10:18 AM SHEET SIZE: ISO full sheet A1 (594.0x 841.0 MM) PLOTTED BY: Beama Mahabadi LAST SAVED BY: Beama Mahabadi



key plan / plan repère
 Allison Hamlin

ALLISON HAMLIN
 MANAGER (A), DEVELOPMENT REVIEW WEST
 PLANNING, REAL ESTATE & ECONOMIC DEVELOPMENT
 DEPARTMENT, CITY OF OTTAWA

- Legend / légende
- SCOPE OF WORK
 - - - EXTENTS OF UNDERGROUND PARKING GARAGE
 - TREE PROTECTION FENCING
 - PROPERTY LINE
 - DECIDUOUS TREE AND SHRUB PLANTING (REFER TO PLANTING SCHEDULE FOR SPECIES AND QUANTITIES)
 - CONIFEROUS TREE AND SHRUB PLANTING (REFER TO PLANTING SCHEDULE FOR SPECIES AND QUANTITIES)
 - LAWN
 - 0.45m HIGH RETAINING WALL

06	revised in response to Consultant changes	2024/01/12
05	revised in response to City comments	2023/12/18
04	re-issue for SPA	2023/08/24
03	re-issue for SPA	2023/07/24
02	re-issue for SPA	2023/03/31
01	issue for SPA	2022/12/16
00	issue for ZBLA	2022/11/15

FOTENN Planning + Design
 396 Cooper Street, Suite 300
 Ottawa, ON, CANADA K2P 2H7
 613.730.5709
 fotenn.com

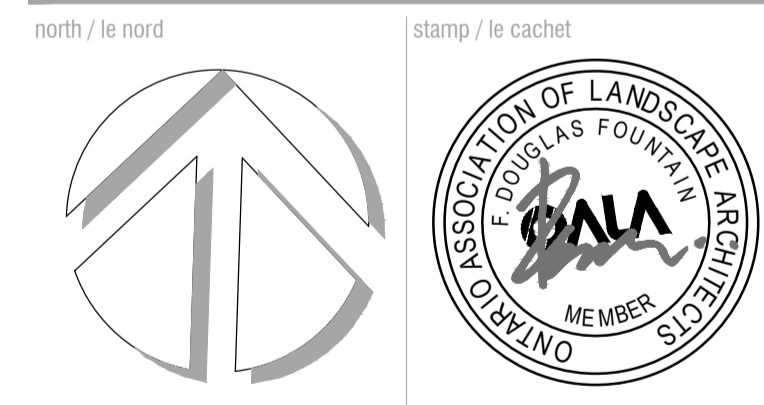

project / projet
3430 CARLING AVENUE

drawing / dessin

LANDSCAPE PLAN

designed / conçu BM / EM	drawn / dessiné BM / EM	reviewed / examiné DF
date Nov. 2022		

drawing number / No. du dessin
L3 of 4

PLANT SCHEDULE

CODE	QTY	BOTANICAL NAME	COMMON NAME	SIZE / CONDITION / SPACING
TREES				
CA	2	Cornus alternifolia	Pagoda Dogwood	50mm cal. / W.B. (single stem, tree form)
GB	3	Ginkgo biloba	Maidenhair Tree	60mm cal. / W.B.
GT	2	Gleditsia triacanthos	Honey Locust	60mm cal. / W.B.
PD	1	Picea glauca 'Densata'	Black Hills White Spruce	175cm ht. / W.B.
QF	5	Quercus robur fastigiata	Pyramidal English Oak	70mm cal. / W.B.
QR	4	Quercus rubra	Red Oak	70mm cal. / W.B.
TO	34	Thuja occidentalis 'Zmatik'	Zmatik Arborvitae	7gal pot / 100cm
SHRUBS				
Ac2	9	Amelanchier canadensis	Canadian Serviceberry	200cm ht. / specimen quality / 5.0m sp.
Au	42	Arctostaphylos uva-ursi	Kinnikinnick	#1 Pot / 75cm sp.
Cr	40	Cornus sericea	Red Twig Dogwood	#3 Pot / Refer to plan for spacing
Ck	42	Cornus sericea 'Kelsey'	Kelsey's Dwarf Red Twig Dogwood	#2 Pot / Refer to plan for spacing
Ds	45	Diervilla x splendens 'El Madrigal'	Firefly Nightglow Bush Honeysuckle	#2 Pot / Refer to plan for spacing
Fo	15	Forsythia ovata 'Ottawa'	Early Forsythia	#3 Pot / 125cm sp.
Hm	94	Hydrangea macrophylla	Largeleaf Hydrangea	#2 Pot / Refer to plan for spacing
Hy	50	Hydrangea paniculata	Panicle Hydrangea	#2 Pot / Refer to plan for spacing
Hb	42	Hydrangea paniculata 'Bombshell'	Bombshell Panicle Hydrangea	#2 Pot / 80cm sp.
Jl	35	Juniperus horizontalis 'Limeglow'	Limeglow Creeping Juniper	#2 Pot / Refer to plan for spacing
Po	32	Physocarpus opulifolius 'Dart's Gold'	Dart's Gold Ninebark	#2 Pot / Refer to plan for spacing
Pz	18	Physocarpus opulifolius 'Diabolo'	Ninebark	#3 pot / 150cm sp.
Sa	76	Symphoricarpos albus	Common White Snowberry	#2 Pot / Refer to plan for spacing
Va	18	Viburnum dentatum	Viburnum	#3 Pot / 200cm sp.
HEDGE				
Td	165	Taxus x media	Anglo-Japanese Yew	100cm ht. / specimen quality / Refer to plan for spacing

PLANTING MIX AREAS

APPROVED
 By Allison Hamlin at 5:16 pm, Feb 29, 2024

SUN PERENNIALS	20.0 m ²	
Asclepias tuberosa / Butterfly Milkweed	38	#1 Pot / 45cm sp.
Panicum virgatum / Switch Grass	11	#2 Pot / 75cm sp.
Sedum x Autumn Joy / Autumn Joy Sedum	98	#1 Pot / 45cm sp.
Hemerocallis x Purple De Oro / Purple De Oro Daylily	68	#1 Pot / 60cm sp.
SHADE PERENNIALS	262.6 m ²	
Arctostaphylos uva-ursi / Kinnikinnick	485	#1 Pot / 75cm sp.
Athyrium filix-femina / Common Lady Fern	426	#1 Pot / 90cm sp.
Dryopteris erythrosora / Autumn Fern	757	#1 Pot / 60cm sp.
Hosta sieboldiana 'Elegans' / Elegans Hosta	273	#2 Pot / 90cm sp.
Hosta x Fire Island / Fire Island Hosta	429	#2 Pot / 75cm sp.
Hosta x Guacamole / Guacamole Hosta	192	#2 Pot / 90cm sp.
FEATURE PLANTING AREA	37.4 m ²	
Hemerocallis x Purple De Oro / Purple De Oro Daylily	109	#1 Pot / 60cm sp.
Hosta sieboldiana 'Elegans' / Elegans Hosta	39	#2 Pot / 90cm sp.
Hosta x Fire Island / Fire Island Hosta	61	#2 Pot / 75cm sp.
Hosta x Guacamole / Guacamole Hosta	27	#2 Pot / 90cm sp.
DAYLILY PLANTING AREA	73.2 m ²	
Hemerocallis x Purple De Oro / Purple De Oro Daylily		#1 Pot / 60cm sp.
HOSTA PLANTING AREA	24 m ²	
Hosta x Fire Island / Fire Island Hosta		#2 Pot / 75cm sp.

- NOTES:**
- PLANTING SCHEDULE APPLIES TO PLANTING AS SHOWN ON SHEET L2 AND L3;
 - LANDSCAPE ARCHITECT SHALL ATTEND TO SITE TO APPROVE LAYOUT OF PERENNIALS WITHIN THE BEDS;
 - FOR ALL PLANTING MIX AREAS, DISTRIBUTE PLANTS EVENLY TO CREATE A WELL MIXED VARIETY THROUGHOUT.

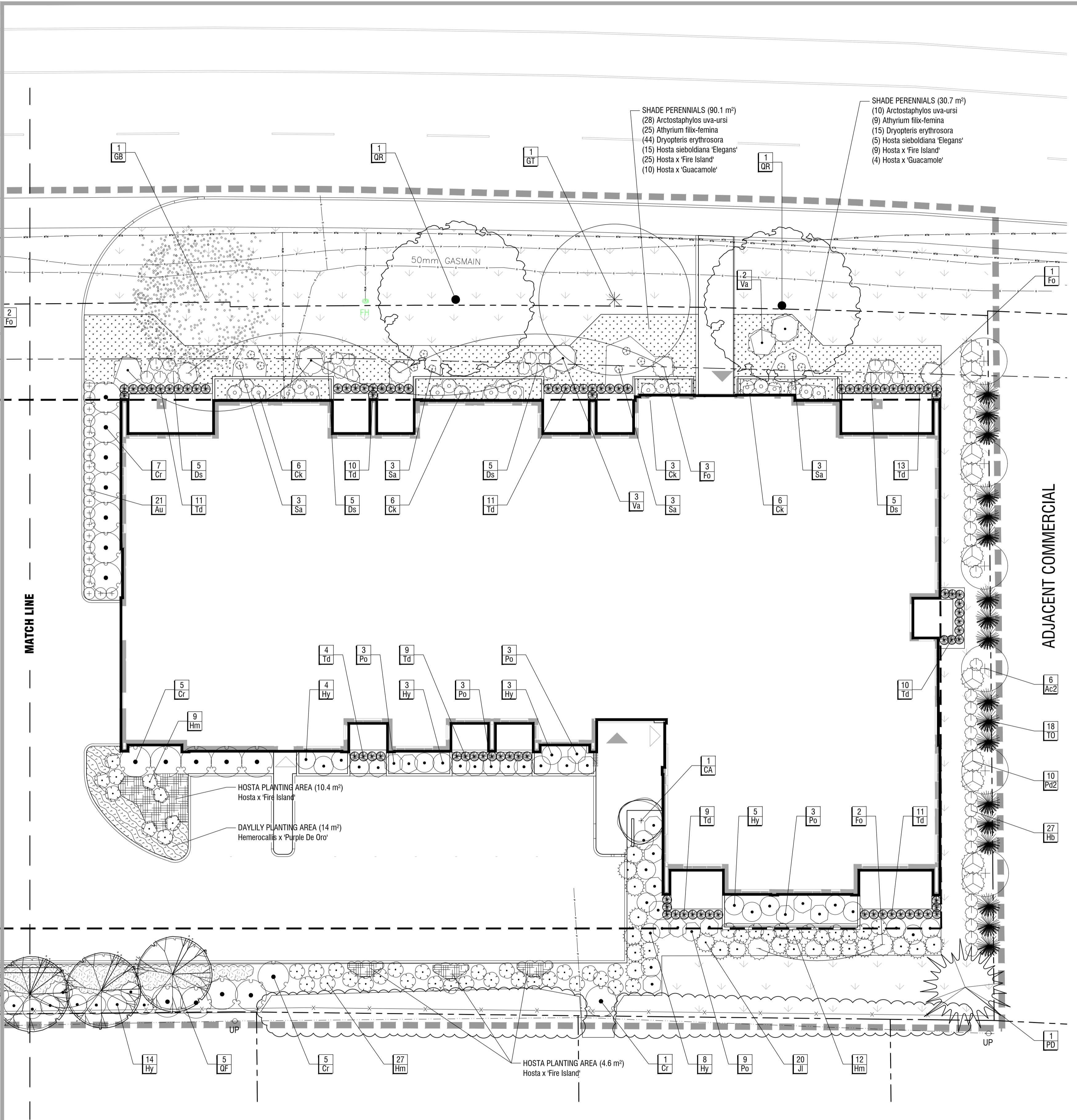

1 PLANTING PLAN - EAST BUILDING

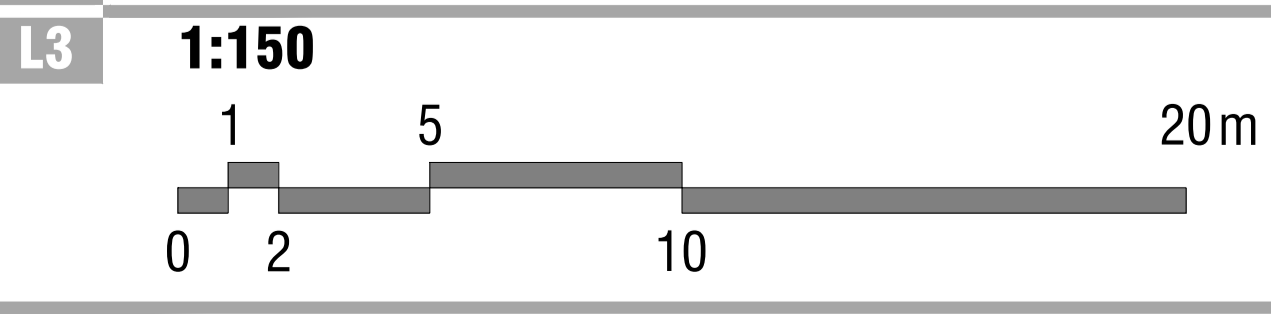

PLOT INFORMATION: DWG NAME: P:\PROJECTS\3430 CARLING\3430 Carling - Planting - L3.dwg PLOT DATE: 2024-01-12 13:04:14 PW: SHEET SIZE: ISO (A1) (841x1189) PLOTTED BY: Beama Mahabadi LAST SAVED BY: Beama Mahabadi

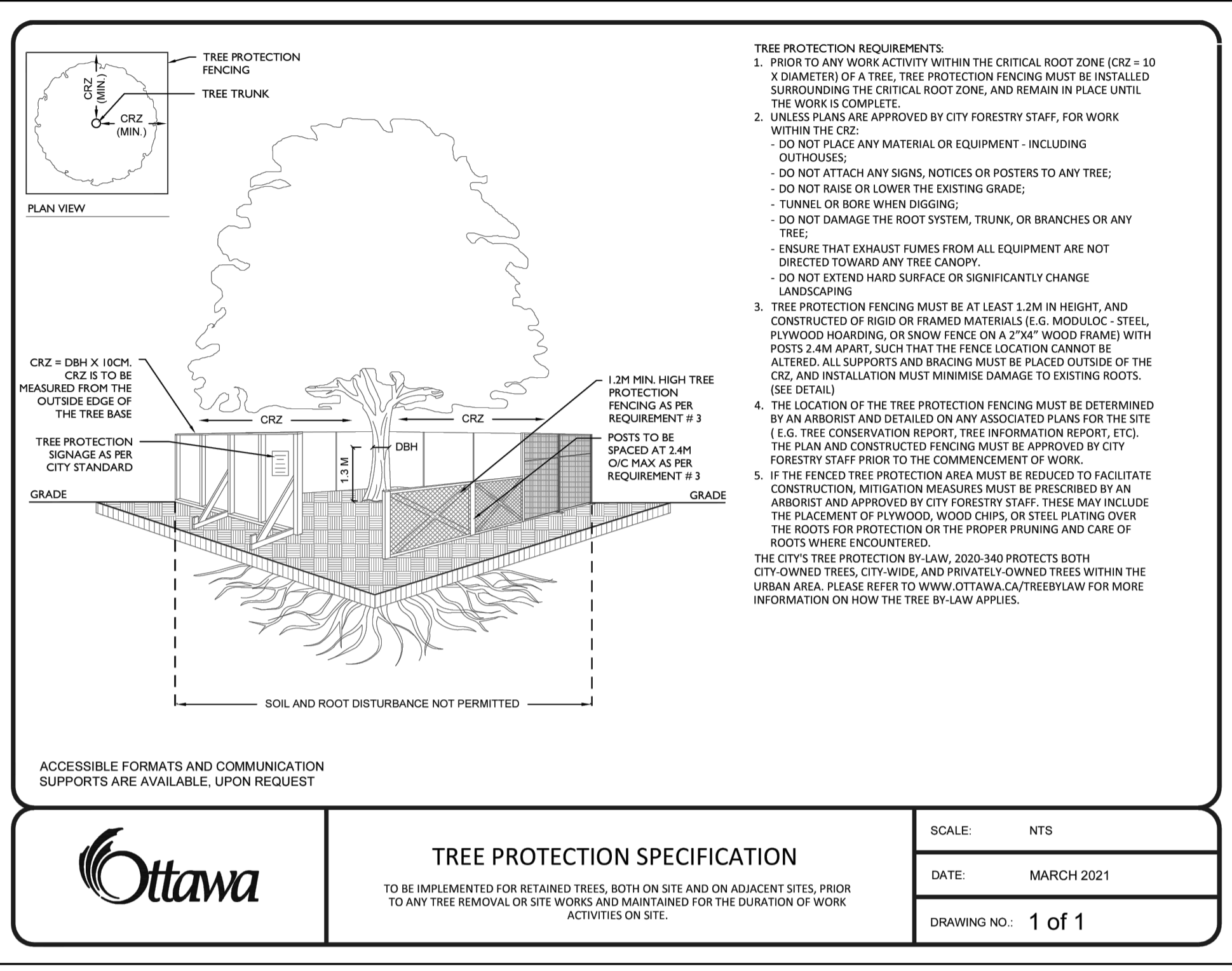

TREE PROTECTION REQUIREMENTS:

- PRIOR TO ANY WORK ACTIVITY WITHIN THE CRITICAL ROOT ZONE (CRZ = 10 X DIAMETER) OF A TREE, TREE PROTECTION FENCING MUST BE INSTALLED SURROUNDING THE CRITICAL ROOT ZONE, AND REMAIN IN PLACE UNTIL THE WORK IS COMPLETE.
- UNLESS PLANS ARE APPROVED BY CITY FORESTRY STAFF, FOR WORK WITHIN THE CRZ:
 - DO NOT PLACE ANY MATERIAL OR EQUIPMENT - INCLUDING OUTHOUSES;
 - DO NOT ATTACH ANY SIGNS, NOTICES OR POSTERS TO ANY TREE;
 - DO NOT RAISE OR LOWER THE EXISTING GRADE;
 - TUNNEL OR BORE WHEN DIGGING;
 - DO NOT DAMAGE THE ROOT SYSTEM, TRUNK, OR BRANCHES OR ANY TREE;
 - ENSURE THAT EXHAUST FUMES FROM ALL EQUIPMENT ARE NOT DIRECTED TOWARD ANY TREE CANOPY;
 - DO NOT EXTEND HARD SURFACE OR SIGNIFICANTLY CHANGE LANDSCAPING
- TREE PROTECTION FENCING MUST BE AT LEAST 1.2M IN HEIGHT, AND CONSTRUCTED OF RIGID OR FRAMED MATERIALS (E.G. MODULOC - STEEL, PLYWOOD HOARDING, OR SNOW FENCE ON A 2"x4" WOOD FRAME) WITH POSTS 2.4M APART, SUCH THAT THE FENCE LOCATION CANNOT BE ALTERED. ALL SUPPORTS AND BRACING MUST BE PLACED OUTSIDE OF THE CRZ, AND INSTALLATION MUST MINIMIZE DAMAGE TO EXISTING ROOTS. (SEE DETAIL)
- THE LOCATION OF THE TREE PROTECTION FENCING MUST BE DETERMINED BY AN ARBORIST AND DETAILED ON ANY ASSOCIATED PLANS FOR THE SITE (E.G. TREE CONSERVATION REPORT, TREE INFORMATION REPORT, ETC). THE PLAN AND CONSTRUCTED FENCING MUST BE APPROVED BY CITY FORESTRY STAFF PRIOR TO THE COMMENCEMENT OF WORK.
- IF THE FENCED TREE PROTECTION AREA MUST BE REDUCED TO FACILITATE CONSTRUCTION, MITIGATION MEASURES MUST BE PRESCRIBED BY AN ARBORIST AND APPROVED BY CITY FORESTRY STAFF. THESE MAY INCLUDE THE PLACEMENT OF PLYWOOD, WOOD CHIPS, OR STEEL PLATING OVER THE ROOTS FOR PROTECTION OR THE PROPER PRUNING AND CARE OF ROOTS WHERE ENCOUNTERED.

THE CITY'S TREE PROTECTION BY-LAW, 2020-340 PROTECTS BOTH CITY-OWNED TREES, CITY-WIDE, AND PRIVATELY OWNED TREES WITHIN THE URBAN AREA. PLEASE REFER TO WWW.OTTAWA.CA/TREEBYLAW FOR MORE INFORMATION OR HOW THE TREE BY-LAW APPLIES.



TREE PROTECTION SPECIFICATION

TO BE IMPLEMENTED FOR RETAINED TREES, BOTH ON SITE AND ON ADJACENT SITES, PRIOR TO ANY TREE REMOVAL OR SITE WORKS AND MAINTAINED FOR THE DURATION OF WORK ACTIVITIES ON SITE.

SCALE: NTS
DATE: MARCH 2021
DRAWING NO.: 1 of 1

1 TREE PROTECTION FENCING
L4 n.t.s.

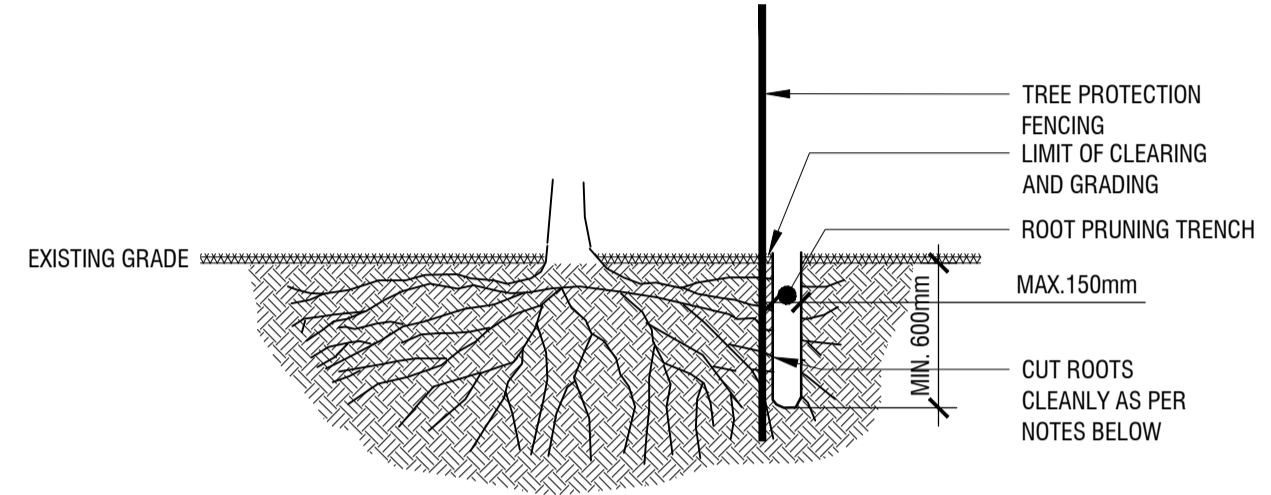

- NOTES:
- PROPER ROOT PRUNING TECHNIQUE REQUIRED WHEN TREE ROOTS ENCOUNTERED DURING EXCAVATION.
 - EXCAVATIONS WITHIN DRIFLINE SHOULD BE BY DIRECTIONAL MICRO-TUNNELLING AND BORING. OUTSIDE THE DRIFLINE, ROOTS SHOULD BE CUT CLEANLY (AS PER ABOVE DRAWING) WITH PRUNING SHEARS OR A SAW WIPED WITH ALCOHOL BEFORE EACH CUT.
 - AFTER ROOTS ARE CLEANLY CUT, THE AREA SHOULD BE BACKFILLED WITH SUITABLE MATERIAL (TO BE APPROVED BY LANDSCAPE ARCHITECT) TO PREVENT DESICCATION;
 - WHERE APPROPRIATE, THE TREES SHALL UNDERGO AN OVERALL PRUNING TO RESTORE TREE APPEARANCE AND / OR RESTORE THE BALANCE BETWEEN TOP GROWTH AND ROOTS. DO NOT PRUNE LEADERS.

2 ROOT PRUNING DETAIL
L4 n.t.s.

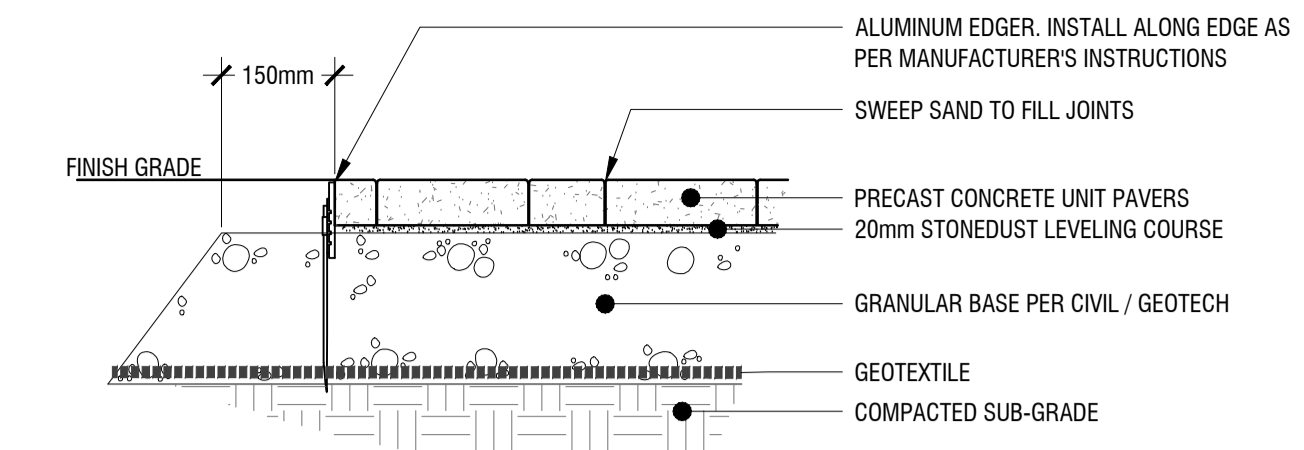

NOTE: ENSURE POSITIVE DRAINAGE AWAY FROM BUILDING

3 PRECAST UNIT PAVERS
L4 n.t.s.

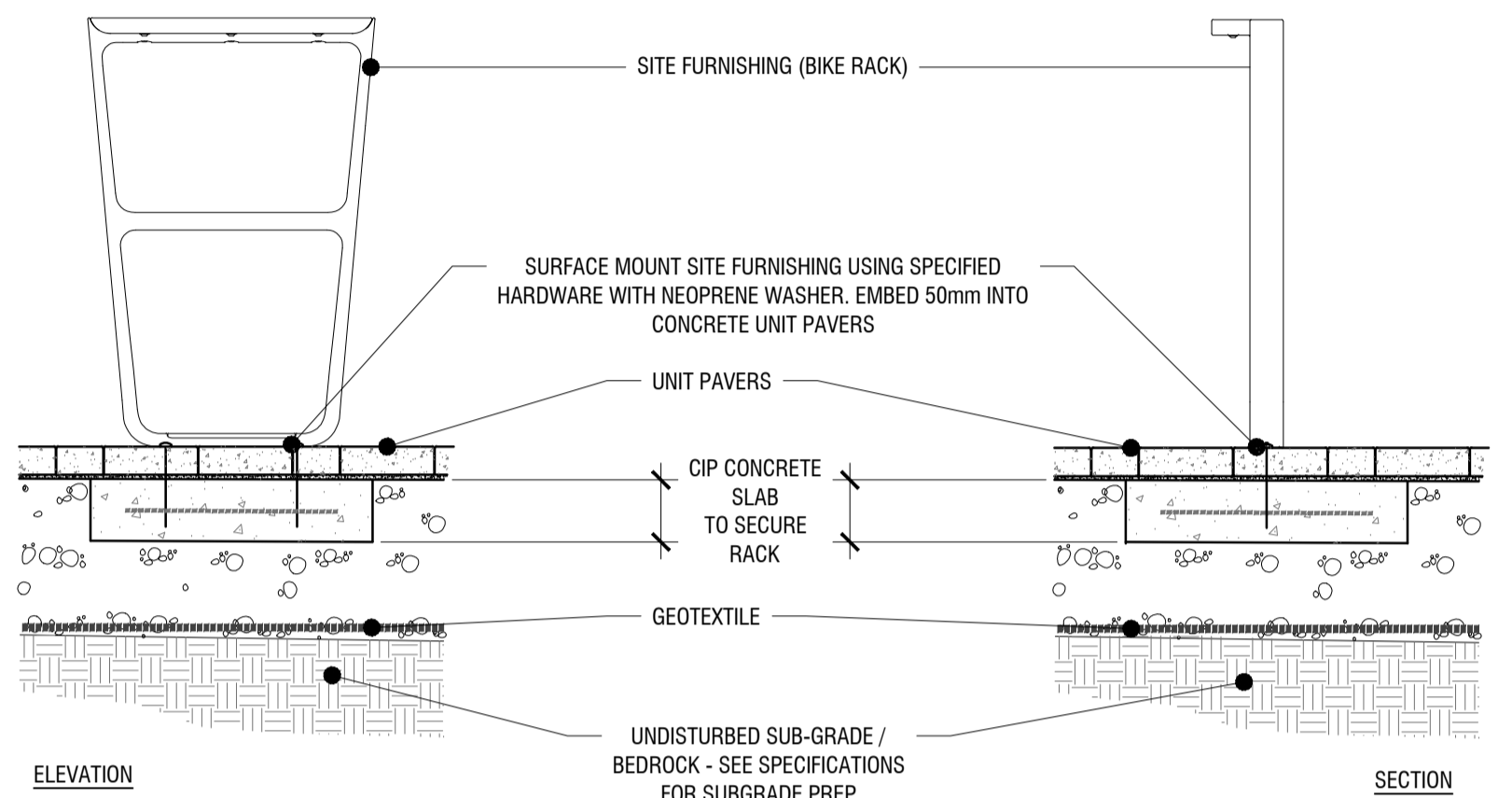

4 SURFACE MOUNTED BIKE RACK ON PAVERS W/ CIP CONC. MOUNT
L4 n.t.s.

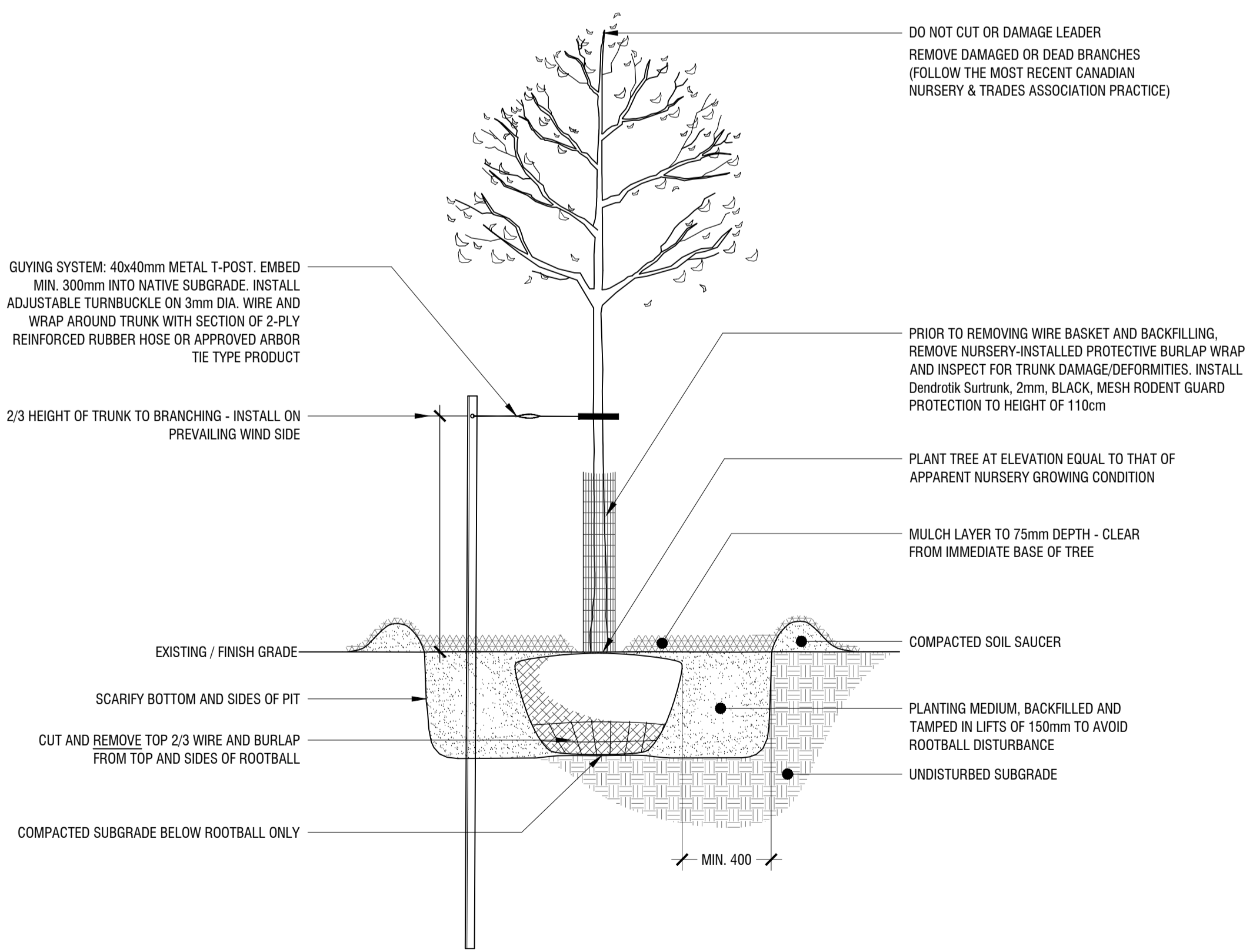

5 DECIDUOUS TREE PLANTING
L4 n.t.s.

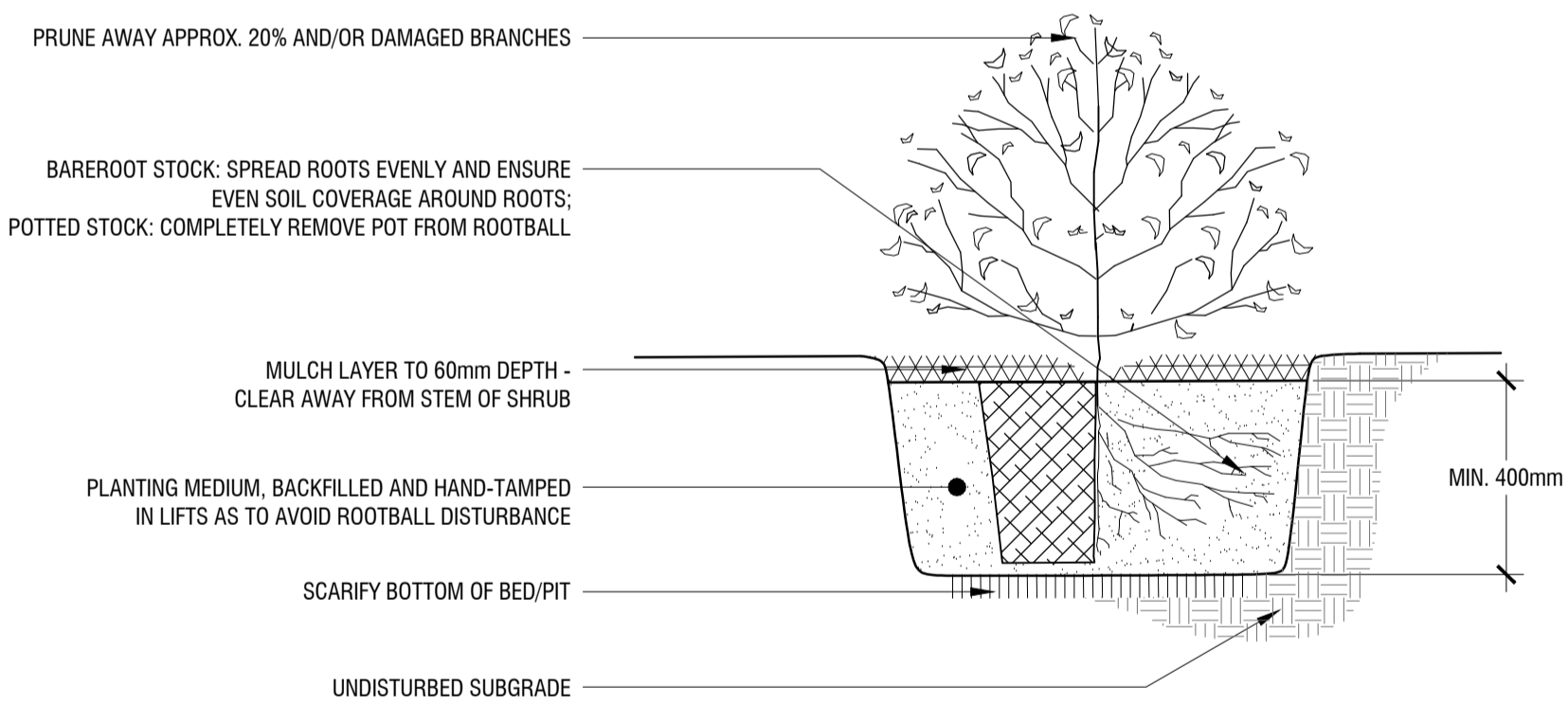

6 SHRUB PLANTING
L4 n.t.s.

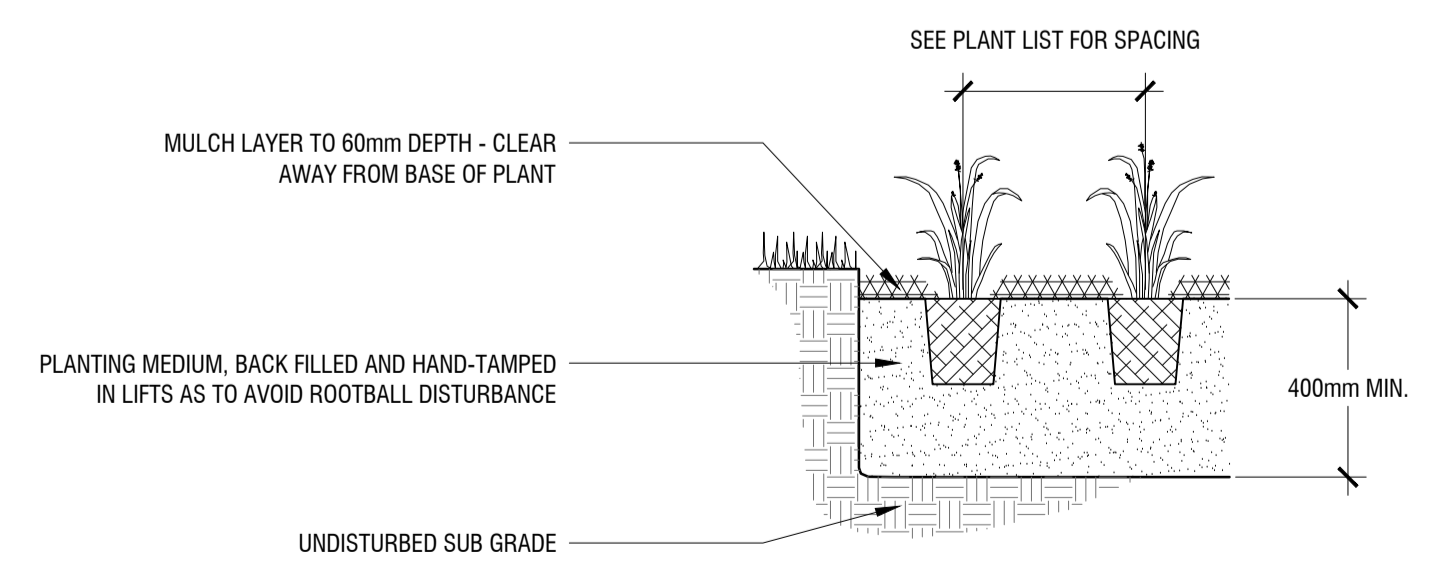

7 PERENNIAL PLANTING
L4 n.t.s.

Copyright Reserved
The Copyrights to all designs and drawings are the property of Fotenn Consultants Inc. Unauthorized reproduction or use is forbidden. DO NOT SCALE DRAWING
Copyright réservés
Les droits d'auteur à tous les modèles et dessins sont la propriété de Fotenn Consultants Inc. Reproduction ou utilisation non autorisée est interdite. NE PAS L'ÉCHELLE DE DESSIN



Client / Client

legenda / légende

Allan Hamlin

ALLISON HAMLIN
MANAGER (A), DEVELOPMENT REVIEW WEST
PLANNING, REAL ESTATE & ECONOMIC DEVELOPMENT
DEPARTMENT, CITY OF OTTAWA

APPROVED
By Allison Hamlin at 5:16 pm, Feb 29, 2024

rev'n	description / la description	yyyy/mm/dd
06	revised in response to Consultant changes	2024/01/12
05	revised in response to City comments	2023/12/18
04	re-issue for SPA	2023/08/24
03	re-issue for SPA	2023/07/24
02	re-issue for SPA	2023/03/31
01	issue for SPA	2022/12/16
00	issue for ZBLA	2022/11/15

FOTENN Planning + Design
396 Cooper Street, Suite 300
Ottawa, ON, CANADA K2P 2H7
613.730.5709
fotenn.com

north / le nord stamp / le cachet

project / projet

3430 CARLING AVENUE

drawing / dessin

LANDSCAPE PLAN

designed / conçu **BM / EM** drawn / dessiné **BM / EM** reviewed / examiné **DF**
date **Nov. 2022** project number / No. du projet

drawing number / No. du dessin

L4 of 4

PLOT INFORMATION: DWG NAME: P:\PROJECTS\3430 Carling Avenue\landscape\DESIGN\DECISION\DECISION\3430 Carling_Avenue.dwg PLOT DATE: 2024-01-17 13:02:19 SHEET SIZE: ISO (A1) (841x594) PLOTTED BY: Bevan Mahabadi LAST SAVED BY: Bevan Mahabadi