

ESTIMATED CANOPY COVERAGE - PROPOSED AND EXISTING

Table with 5 columns: SIZE OF PROPOSED TREE, AVERAGE MATURE SPREAD, CANOPY COVERAGE PER TREE AT MATURITY (m2), QUANTITY OF TREES, TOTAL CANOPY COVERAGE (m2). Rows include Deciduous - Small, Deciduous - Medium, Deciduous - Large, and Coniferous.

Table with 5 columns: AVERAGE MATURE SPREAD, CANOPY COVERAGE PER TREE AT MATURITY (m2), QUANTITY OF TREES, TOTAL CANOPY COVERAGE (m2). Rows include Deciduous trees to remain, Conifers to remain, and Existing vegetation retained beyond the construction limit.

Table with 5 columns: AVERAGE MATURE SPREAD, CANOPY COVERAGE PER TREE AT MATURITY (m2), QUANTITY OF TREES, TOTAL CANOPY COVERAGE (m2). Rows include Existing vegetation retained beyond the construction limit (North-east side of building).

- 1. Area of a circle = (x r r) x pi
2. Canopy coverage per tree calculation: (average mature spread/2) x (average mature spread/2) x pi
3. Note that calculations do not include trees proposed in the R.O.W.

APPROVED
By Krishon Walker at 9:47 am, Mar 05, 2024
KRISHON WALKER
PLANNER
PLANNING, REAL ESTATE & ECONOMIC DEVELOPMENT
DEPARTMENT, CITY OF OTTAWA

SOIL CALCULATIONS

Table with 10 columns: Planting bed no., Available Soil Area (sq m), Available Soil Volume (cu m), No. of trees proposed (Small, Medium, Large, Evergreen, Large (30m)), Existing trees, Total No. of trees, Min. required Soil volume total (cu m).

Note: For all planting beds proposed, the available soil depth is considered to be 1m.

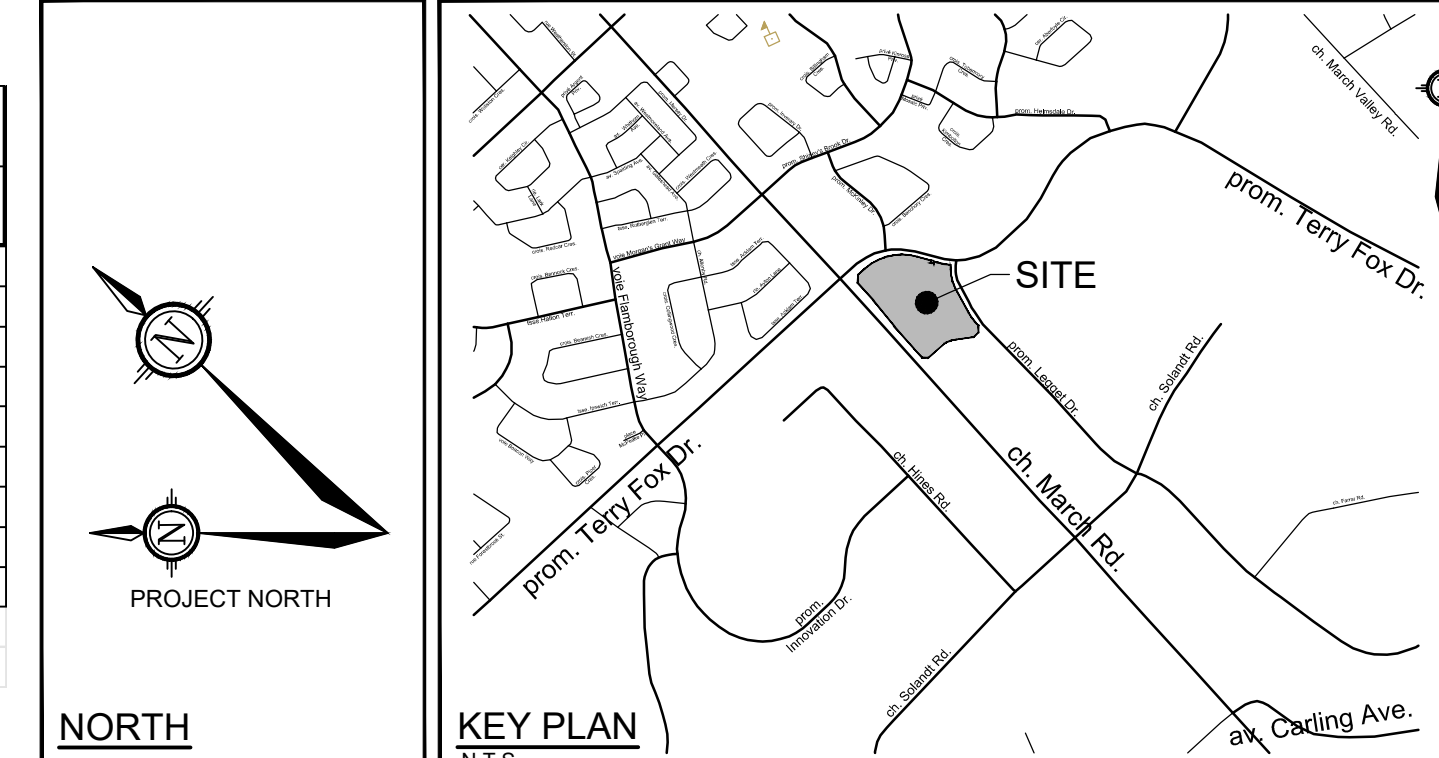

LEGEND

- 3-D1 DETAIL SHEET - NOVATECH OR CITY
EXISTING PAVERS
EXISTING CONCRETE SIDEWALK
PROPOSED CONCRETE SIDEWALK
PROPOSED SHRUBS
PERENNIALS AND ORNAMENTAL GRASSES
PROPOSED DECIDUOUS TREE
PROPOSED CONIFEROUS TREE
EXISTING TREE TO REMAIN
SPECIES (SEE PLANT LIST)
QUANTITY
TREE PROTECTION FENCE
SILT FENCE
EXISTING VEGETATION BEYOND THE LIMIT OF CONSTRUCTION TO REMAIN
BOLLARD

CITY DETAILS

Related details from City of Ottawa Standard Tender Documents Volume No. 2 Standard Detail Drawings.

NOVATECH DETAILS

Found on Sheet L2.
D1. Standard Deciduous Tree Planting
D2. Standard Coniferous Tree Planting
D3. Shrub and Perennial Planting
D4. Tree Protection Fence
D5. Shrub Naturalization

SEED MIX AND APPLICATION

For areas steeper than 3:1. Contractor to apply erosion control blanket. Erosion control blanket to be machine woven mat made from natural wood, coco or cotton fiber...

In addition to the specified seed mixes, all applications are to include a nurse crop as noted.

NURSE CROP
Annual Ryegrass
Seeding Rate: 2kg/ha

SEED MIX A (FOR PARKING ISLANDS AND REINSTATEMENT AREA)
CAMPUS GREEN MIX by DLF Pickseed
Seeding Rate: 2kg/ha

SEED MIX B (FOR SWM FACILITY)
RETENTION AREA MIX by DLF Pickseed
Seeding Rate: 2kg/ha

SUMMARY OF TREES

- 1. There are a total of 133 existing trees to remain as indicated on 121334-TR1 plan.
2. There are a total of 161 existing trees to be removed as indicated on 121334-TR1 plan.
3. There are a total of 124 trees proposed, 88 trees in the property limit and 36 trees in the ROW along March road as indicated on the Landscape plan 121334-L1.
4. With 712 parking spaces proposed, a 5:1 ratio of parking to trees would yield a recommendation of 142 trees.

PLANT LIST

Table with 6 columns: KEY / CITY, BOTANICAL NAME, COMMON NAME, SIZE, COND, SPACING. Lists various tree and shrub species like White Spruce, Silver Maple, etc.

NOTE: THE POSITION OF ALL POLE LINES, CONDUITS, WATERMANS, SEWERS AND OTHER UNDERGROUND AND OVERGROUND UTILITIES AND STRUCTURES IS NOT NECESSARILY SHOWN ON THE CONTRACT DRAWINGS, AND WHERE SHOWN, THE ACCURACY OF THE POSITION OF SUCH UTILITIES AND STRUCTURES IS NOT GUARANTEED BEFORE STARTING WORK, DETERMINE THE EXACT LOCATION OF ALL SUCH UTILITIES AND STRUCTURES AND ASSUME ALL LIABILITY FOR DAMAGE TO THEM.

OWNER INFORMATION
COLLIERIES
191 BAY STREET
TORONTO, ONTARIO, M5J 2V1
AARON CLOOD
PHONE: (647) 798-9534
EMAIL: Aaron.Clood@colleries.com

NOT FOR CONSTRUCTION

Table with 4 columns: No., REVISION, DATE, BY. Lists revision history.

SCALE 1:400
FOR REVIEW ONLY
NOVATECH logo and contact information.

LOCATION: CITY OF OTTAWA, 600 MARCH ROAD - NOKIA PARKING LOT EXPANSION
DRAWING NAME: LANDSCAPE PLAN
121334-L1

This drawing has been prepared in conjunction with CSW Landscape Architects Limited and is based on the Tree Information Report (TIR) completed by CSW dated 27th October 2022. Information regarding tree removal and tree protection measures has been prepared by Novatech.