

- LEGEND**
- 3-D1: DETAIL SHEET # NOVATECH OR CITY
 - PROPERTY LIMIT
 - PROPOSED RIPRAP
 - SEED MIX B - RETENTION AREA
 - PROPOSED DRY SHRUB MIX
 - PROPOSED DECIDUOUS TREE
 - PROPOSED CONIFEROUS TREE
 - EXISTING TREE TO REMAIN
 - SPECIES (SEE PLANT LIST)
 - QUANTITY
 - NATURALIZATION MIX AREA
 - TREE PROTECTION FENCE
 - SILT FENCE
 - BOLLARD
- GENERAL**
- Read and interpret this drawing/drawing set in conjunction with all the contract details and specifications, including related civil, utility, structural, architectural, mechanical, electrical, environmental, geotechnical, and survey information.
 - The Contractor is to determine the exact location, size, material, and elevation of all existing utilities prior to commencing construction. Protect and assume responsibility for all existing utilities regardless of being shown on the drawings.
 - It is essential to use the plans and details in conjunction with the specifications and notes.
 - Do not scale drawings. Work to dimensions only.
 - Protect all existing and retained vegetation for the duration of construction according to the contract details and specifications.
 - Reinstatement of areas and items damaged or disturbed, beyond the Limit of Work, because of construction activities, including but not limited to construction staging areas, haul roads, stockpile areas, etc. to the satisfaction of the Consultant. Unless otherwise noted, Contractor is to reinstate all areas to pre-construction condition or better to the satisfaction of the Contract Administrator.
- PLANTING**
- Plant material to be No. 1 Grade and is to comply with Canadian Standards for Nursery Stock (latest edition) published by the Canadian Nursery Landscape Association. Use structurally sound plant material with strong fibrous root system free of disease, defects, and injuries. Use trees with straight trunks, well and characteristically branched for species. Obtain approval from consultant of plant material at source prior to digging. All trees and shrubs to be container grown, potted, W/B or B/B, as indicated on Plant List. Bare root plants are only acceptable for certain species and as approved by the Landscape Architect.
 - Plant material installations are not to be permitted without the written approval from the Consultant, with 48 hours notice, prior to shipping plant material.
 - Plant locations are schematic/ approximate only. Contractor is to stake out locations on site for approval by the Landscape Architect prior to installation. Contractor will assume full responsibility if no Landscape Architect is notified.
 - Ensure trees are thoroughly watered following planting. Monitor material and ensure adequate moisture until acceptance.
 - In heavy clay or poorly drained soils, set root ball with root collar 75-100mm higher than finished grade.
 - Plant Beds - 400mm continuous depth. Applies to shrubs, perennials, vines, and groundcovers.
 - Sod Seed Areas - 100mm depth.
 - Restoration - 300mm depth.
 - Sod to be No. 1 Kentucky Bluegrass Sod grown from minimum mixture of 3 Kentucky Bluegrass cultivars. Quality and source are to comply with Canadian Standards for Nursery Stock, Section 17, (latest edition) published by the Canadian Nursery Landscape Association.
 - Plant Beds - (8-32-16), i.e. 8% Nitrogen, 32% Phosphorus, 16% Potash per manufacturer specifications.
 - Sod Areas - (8-32-16), i.e. 8% Nitrogen, 32% Phosphorus, 16% Potash at a rate of 350g/ha.
 - Where applicable, for any plant areas with a mix of species/cultivar notes, Contractor is to cluster the plants in groups of 3-5 and evenly distribute these in the noted area.

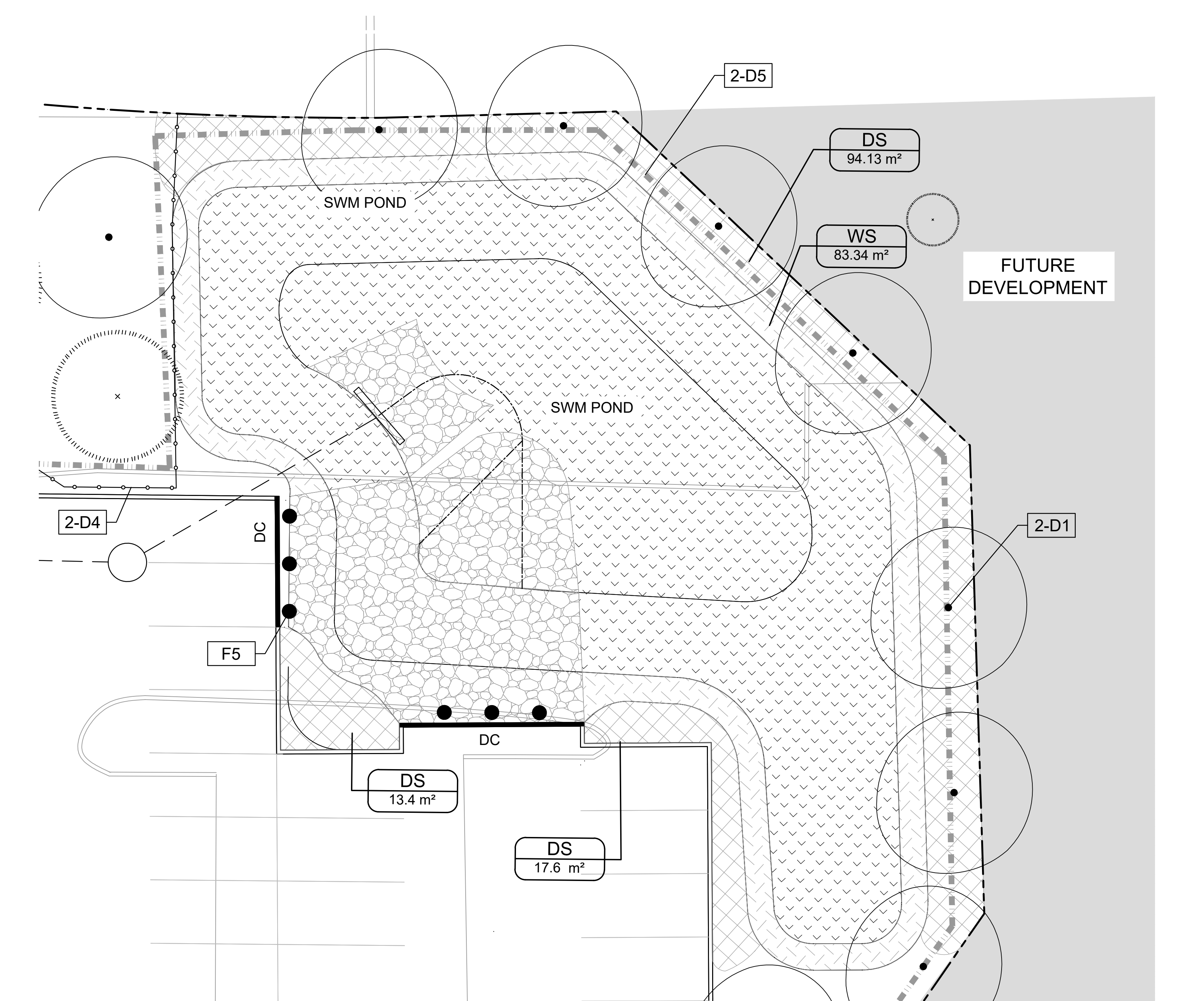

ENLARGEMENT A - SWM POND
SCALE 1:100

PLANT LIST

Dry Shrub Mix (DS)			
Area	Plant	Height	Quantity
125 m ²		1500 mm O.C.	0.51 pcs/m ²
25%	<i>Ceanothus americanus</i>	New Jersey Tea	0.60m Ht BR 1.5m O.C.
20%	<i>Diervilla lonicera</i>	Bush Honeysuckle	0.60m Ht BR 1.5m O.C.
5%	<i>Physocarpus opulifolius</i>	Common Ninebark	0.60m Ht BR 1.5m O.C.
5%	<i>Rhus aromatica</i>	Fragrant Sumac	0.60m Ht BR 1.5m O.C.
25%	<i>Rubus odoratus</i>	Flowering Raspberry	0.60m Ht BR 1.5m O.C.
20%	<i>Symphoricarpos alba</i>	Snowberry	0.60m Ht BR 1.5m O.C.

Wet Shrub Mix (WS)			
Area	Plant	Height	Quantity
84 m ²		1500 mm O.C.	0.51 pcs/m ²
20%	<i>Aronia melanocarpa</i>	Black Chokeberry	0.60m Ht BR 1.5m O.C.
15%	<i>Cephalanthus occidentalis</i>	Buttonbush	0.60m Ht BR 1.5m O.C.
20%	<i>Cornus sericea</i>	Red Osier Dogwood	0.60m Ht BR 1.5m O.C.
5%	<i>Myrica gale</i>	Sweet Gale	0.60m Ht BR 1.5m O.C.
5%	<i>Salix petiolaris</i>	Slender Willow	0.60m Ht BR 1.5m O.C.
20%	<i>Spiraea alba</i>	White Meadowsweet	0.60m Ht BR 1.5m O.C.
15%	<i>Rosa palustris</i>	Swamp Rose	0.60m Ht BR 1.5m O.C.

APPROVED
By Krishon Walker at 9:46 am, Mar 05, 2024

KRISHON WALKER
PLANNER
PLANNING, REAL ESTATE & ECONOMIC DEVELOPMENT
DEPARTMENT, CITY OF OTTAWA

NOT FOR CONSTRUCTION

SCALE				FOR REVIEW ONLY				LOCATION	
5.	REVISED PER CITY COMMENTS	FEB 08/24	RGJ	TCB	CITY OF OTTAWA 600 MARCH ROAD - NOKIA PARKING LOT EXPANSION				PROJECT NO.
4.	ADDRESS INSERTION ON TITLEBLOCK	DEC 21/23	RGJ	RGJ	DRAWING NAME				121334-00
3.	REVISED PER CITY COMMENTS	DEC 05/23	RGJ	TCB	DRAWING NO.				REV 6
2.	REVISED PER CITY COMMENTS	NOV 08/23	RGJ	RGJ	LANDSCAPE ENLARGEMENTS AND DETAILS				121334-L2
1.	ISSUED FOR CITY REVIEW	OCT 02/23	RGJ	RGJ	DRAWING TITLE				
No.	REVISION	DATE	BY	APP/REV					

NOVATECH OR CITY OF OTTAWA PROJECT NO. 121334-00 DATE: 03/05/2024 SCALE: 1:100