

Erosion and Sediment Control Responsibilities

ESC Measure	Symbol	Location	Responsible Contractor	Inspected By	Accepted By	Accepted Date	Accepted Location
Silt Fence	[Symbol]	OPSD 219-110	Overseer's Contract	Weekly	Overseer's Contract	Nil	Nil
Silt Fence	[Symbol]	OPSD 219-110	Overseer's Contract	Weekly	Overseer's Contract	Nil	Nil
Mud Mat	[Symbol]	OPSD 219-110	Overseer's Contract	Weekly	Overseer's Contract	Nil	Nil
Silt Fence	[Symbol]	OPSD 219-110	Overseer's Contract	Weekly	Overseer's Contract	Nil	Nil
Silt Fence	[Symbol]	OPSD 219-110	Overseer's Contract	Weekly	Overseer's Contract	Nil	Nil
Silt Fence	[Symbol]	OPSD 219-110	Overseer's Contract	Weekly	Overseer's Contract	Nil	Nil
Silt Fence	[Symbol]	OPSD 219-110	Overseer's Contract	Weekly	Overseer's Contract	Nil	Nil
Silt Fence	[Symbol]	OPSD 219-110	Overseer's Contract	Weekly	Overseer's Contract	Nil	Nil
Silt Fence	[Symbol]	OPSD 219-110	Overseer's Contract	Weekly	Overseer's Contract	Nil	Nil
Silt Fence	[Symbol]	OPSD 219-110	Overseer's Contract	Weekly	Overseer's Contract	Nil	Nil

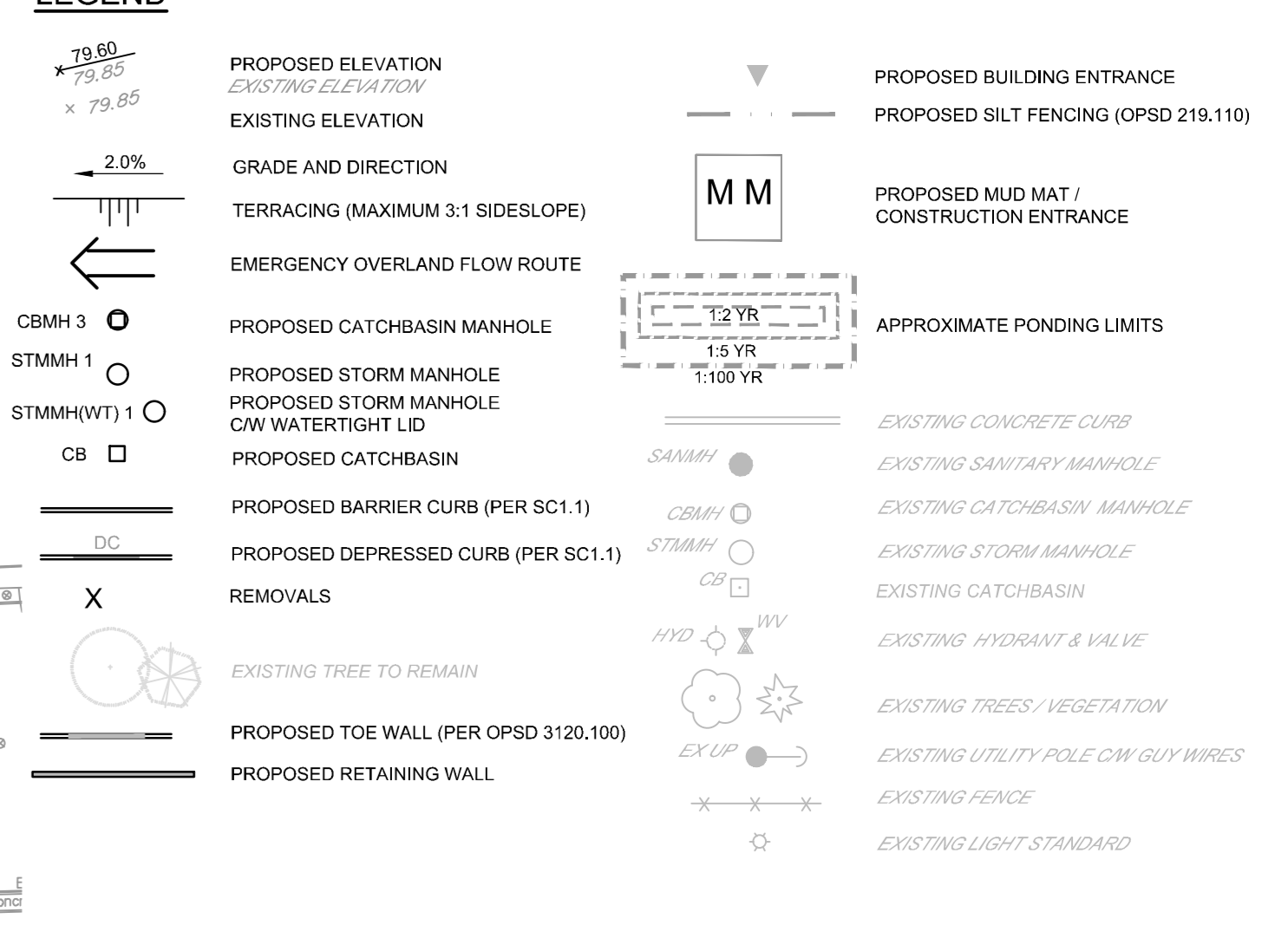
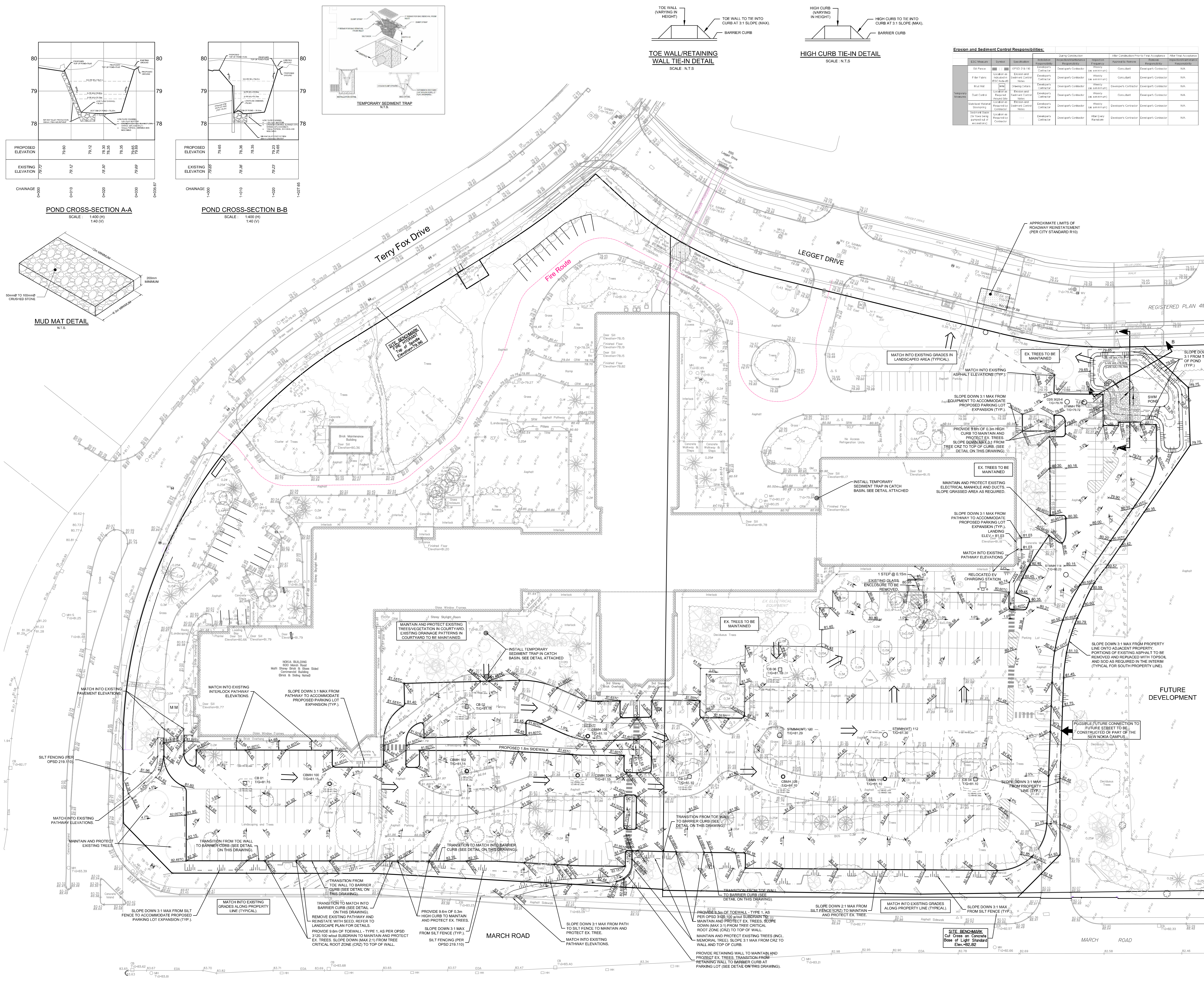
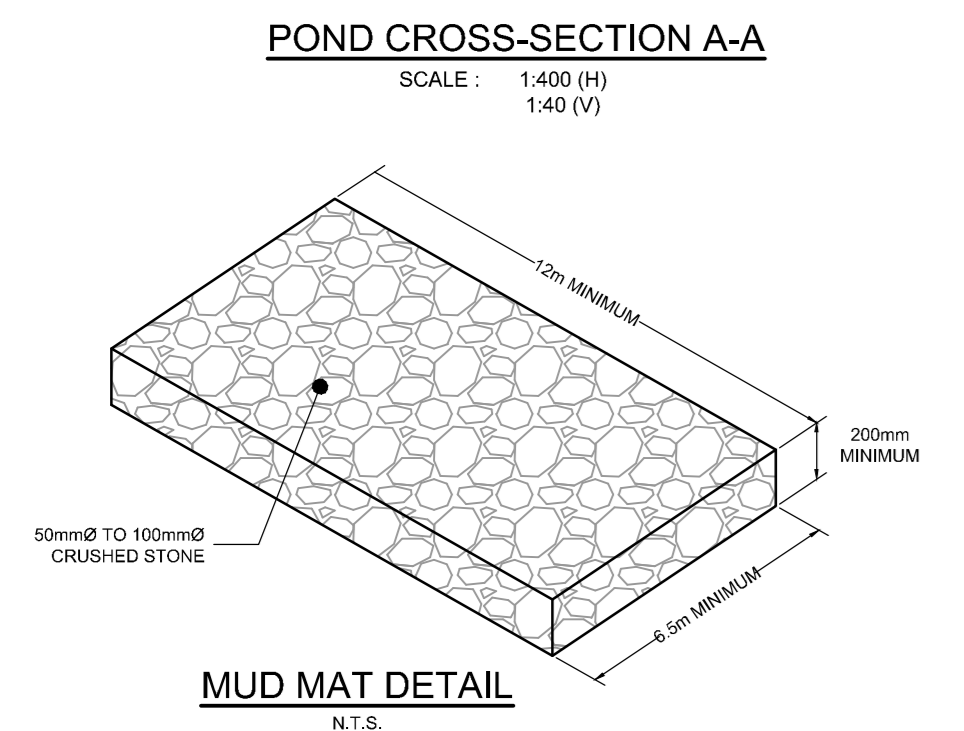
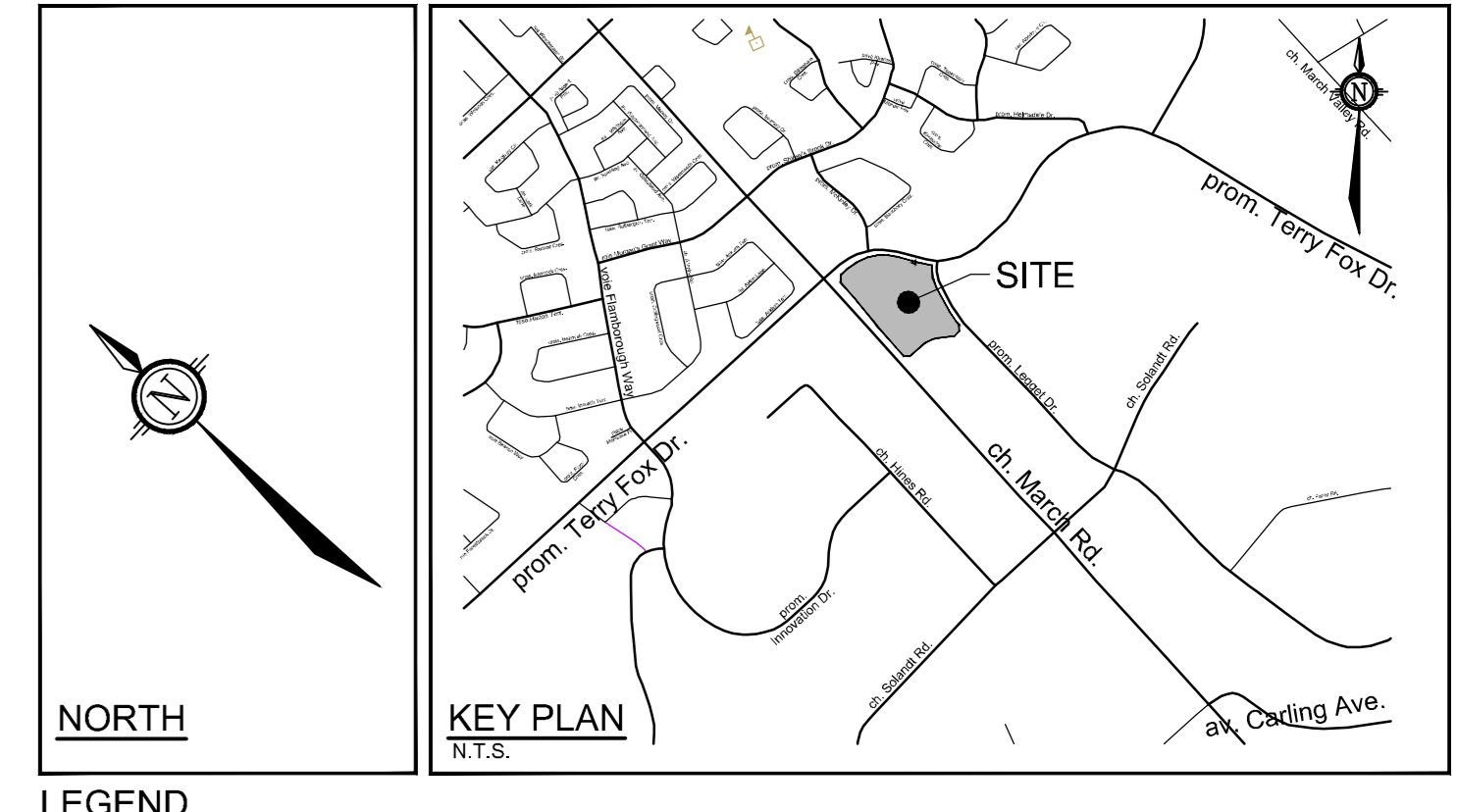

GENERAL NOTES:

- COORDINATE AND SCHEDULE ALL WORK WITH OTHER TRADES AND CONTRACTORS.
- DETERMINE THE EXACT LOCATION, SIZE, MATERIAL AND ELEVATION OF ALL EXISTING UTILITIES PRIOR TO COMMENCING CONSTRUCTION. PROTECT AND ASSUME RESPONSIBILITY FOR ALL EXISTING UTILITIES WHETHER OR NOT SHOWN ON THIS DRAWING.
- OBTAIN ALL NECESSARY PERMITS AND APPROVALS FROM THE CITY OF OTTAWA BEFORE COMMENCING CONSTRUCTION.
- BEFORE COMMENCING CONSTRUCTION OBTAIN AND PROVIDE PROOF OF COMPREHENSIVE ALL RISK AND OPERATIONAL LIABILITY INSURANCE FOR \$5,000,000.00. INSURANCE POLICY TO NAME OWNERS, ENGINEERS AND ARCHITECTS AS CO-INSURED.
- RESTORE ALL DISTURBED AREAS ON-SITE AND OFF-SITE, INCLUDING TRENCHES AND SURFACES ON PUBLIC ROAD ALLOWANCES TO EXISTING CONDITIONS OR BETTER TO THE SATISFACTION OF THE CITY OF OTTAWA AND ENGINEER.
- REMOVE FROM SITE ALL EXCESS EXCAVATED MATERIAL, ORGANIC MATERIAL AND DEBRIS UNLESS OTHERWISE INSTRUCTED BY ENGINEER. EXCAVATE AND REMOVE FROM SITE ANY CONTAMINATED MATERIAL. ALL CONTAMINATED MATERIAL SHALL BE DISPOSED OF AT A LICENSED LANDFILL FACILITY.
- ALL ELEVATIONS ARE GEODETIC.
- REFER TO THE GEOTECHNICAL INVESTIGATION AND HYDROGEOLOGICAL ASSESSMENT - 600 MARCH ROAD - (REPORT NO. 2023-01-11) DATED ON JUNE 16, 2023, FOR SUBSURFACE CONDITIONS, PROPOSED CONSTRUCTION RECOMMENDATIONS AND GEOTECHNICAL INSPECTION REQUIREMENTS. THE GEOTECHNICAL CONSULTANT IS TO REVIEW ON-SITE CONDITIONS AFTER EXCAVATION PRIOR TO PLACEMENT OF THE GRANULAR MATERIAL.
- REFER TO ARCHITECTS AND LANDSCAPE ARCHITECTS DRAWINGS FOR BUILDING AND HARD SURFACE AREAS AND DIMENSIONS.
- REFER TO STORMWATER MANAGEMENT REPORT (R-2023-143) PREPARED BY NOVATECH ENGINEERING CONSULTANTS LTD.
- SAW CUT AND KEY GRIND ASPHALT AT ALL ROAD CUTS AND ASPHALT THE IN POINTS AS PER CITY OF OTTAWA STANDARDS (R10).
- PROVIDE LINE/PARKING PAINTING.

GRADING NOTES:

- ALL TOPSOIL, ORGANIC OR DELETERIOUS MATERIAL MUST BE ENTIRELY REMOVED FROM BENEATH THE PROPOSED PAVED AREAS AS DIRECTED BY THE SITE ENGINEER OR GEOTECHNICAL ENGINEER.
- EXPOSED SUBGRADES IN PROPOSED PAVED AREAS SHOULD BE PROOF ROLLED WITH A LARGE STEEL DRUM ROLLER AND INSPECTED BY THE GEOTECHNICAL ENGINEER PRIOR TO THE PLACEMENT OF GRANULARS.
- ANY SOFT AREAS EVIDENT FROM THE PROOF ROLLING SHOULD BE SUB-EXCAVATED AND REPLACED WITH SUITABLE MATERIAL THAT IS PROST COMPATIBLE WITH THE EXISTING SOILS AS RECOMMENDED BY THE GEOTECHNICAL ENGINEER.
- THE GRANULAR BASE SHOULD BE COMPACTED TO AT LEAST 100% OF THE STANDARD PROCTOR MAXIMUM DRY DENSITY VALUE. ANY ADDITIONAL GRANULAR FILL USED BELOW THE PROPOSED PAVEMENT SHOULD BE COMPACTED TO AT LEAST 90% OF THE STANDARD PROCTOR MAXIMUM DRY DENSITY VALUE.
- MINIMUM OF 2% GRADE FOR ALL GRASS AREAS UNLESS OTHERWISE NOTED.
- MAXIMUM TERRACING GRADE TO BE 3:1 UNLESS OTHERWISE NOTED.
- ALL GRADES BY CURBS ARE EDGE OF PAVEMENT GRADES UNLESS OTHERWISE INDICATED.
- ALL CURBS SHALL BE BARRIER CURB (150mm) UNLESS OTHERWISE NOTED AND CONSTRUCTED AS PER CITY OF OTTAWA STANDARDS (SC1.1). MOUNTABLE CURBS ARE TO BE PER CITY OF OTTAWA STANDARD (SC1.3).
- REFER TO LANDSCAPE PLAN FOR PLANTING AND OTHER LANDSCAPE FEATURE DETAILS.
- CONTRACTOR TO PROVIDE THE CONSULTANT WITH A GRADING PLAN INDICATING AS-BUILT ELEVATIONS OF ALL DESIGN GRADES SHOWN ON THIS PLAN.

EROSION AND SEDIMENT CONTROL NOTES:

- THE CONTRACTOR SHALL IMPLEMENT BEST MANAGEMENT PRACTICES, TO PROVIDE PROTECTION OF THE AREA DRAINAGE SYSTEM AND THE RECEIVING WATER COURSE, DURING CONSTRUCTION ACTIVITIES. THE CONTRACTOR ACKNOWLEDGES THAT FAILURE TO IMPLEMENT APPROPRIATE EROSION AND SEDIMENT CONTROL MEASURES MAY BE SUBJECT TO PENALTIES IMPOSED BY ANY APPLICABLE REGULATORY AGENCY.
- ALL EROSION AND SEDIMENT CONTROLS ARE TO BE INSTALLED TO THE SATISFACTION OF THE ENGINEER AND THE CITY OF OTTAWA. THEY ARE TO BE APPROPRIATE TO THE SITE CONDITIONS, PRIOR TO UNDERTAKING ANY SITE ALTERATIONS (FILLING, GRADING, REMOVAL OF EXISTING MATERIALS, ETC.) AND DURING ALL PHASES OF SITE PREPARATION AND CONSTRUCTION. THESE PRACTICES ARE TO BE IMPLEMENTED IN ACCORDANCE WITH THE CURRENT BEST MANAGEMENT PRACTICES FOR EROSION AND SEDIMENT CONTROL, WHICH SHOULD INCLUDE AS A MINIMUM THOSE MEASURES INDICATED ON THIS PLAN.
- EROSION AND SEDIMENT CONTROL MEASURES WILL BE IMPLEMENTED DURING BEST MANAGEMENT PRACTICES IN ACCORDANCE WITH THE "GUIDELINES ON EROSION AND SEDIMENT CONTROL FOR URBAN CONSTRUCTION SITES" (GOVERNMENT OF ONTARIO, MAY 1987). THE CONTRACTOR SHALL BE SOLELY RESPONSIBLE FOR MEETING ALL REGULATORY AGENCY REQUIREMENTS.
- TO PREVENT SURFACE EROSION FROM ENTERING ANY STORM SEWER SYSTEM OR CONSTRUCTION, FILTER CLOTH WILL BE PLACED UNDER GRATES OF NEARBY CATCHBASINS AND STRUCTURES. A LIGHT DUTY SILT FENCE BARRIER WILL ALSO BE INSTALLED AROUND THE CONSTRUCTION AREA (WHERE APPLICABLE). THESE CONTROL MEASURES WILL REMAIN IN PLACE UNTIL CONSTRUCTION IS COMPLETE.
- TO LIMIT EROSION MINIMIZE THE AMOUNT OF EXPOSED SOILS AT ANY GIVEN TIME. REVEGETATE EXPOSED AREAS AND SLOPES AS SOON AS POSSIBLE AND PROTECT EXPOSED SLOPES WITH NATURAL OR SYNTHETIC MULCHES.
- FOR MATERIAL STOCKPILING MINIMIZE THE AMOUNT OF EXPOSED MATERIALS AT ANY GIVEN TIME. APPLY TEMPORARY SEEDING, TAPPS, CONSTRUCTION AND/OR SURFACE ROUGHENING AS REQUIRED TO STABILIZE STOCKPILED MATERIALS THAT WILL NOT BE USED WITHIN 14 DAYS.
- THE SEDIMENT CONTROL MEASURES SHALL ONLY BE REMOVED WHEN, IN THE OPINION OF THE ENGINEER, THE MEASURES ARE NO LONGER REQUIRED. NO CONTROL MEASURES MAY BE PERMANENTLY REMOVED WITHOUT PRIOR AUTHORIZATION FROM THE ENGINEER.
- THE CONTRACTOR SHALL IMMEDIATELY REPORT TO THE ENGINEER ANY ACCIDENTAL DISCHARGES OF SEDIMENT MATERIAL INTO ANY STORM SEWER SYSTEM. MEASURES INCLUDING ANY REPAIRS TO DUSTING CONTROLS, MEASURES AND CONSTRUCTION ACTIVITIES, AND WHEN DUST LEVELS BECOME VISUALLY APPARENT SPRAY WATER TO MINIMIZE THE RELEASE OF DUST FROM GRAVEL, PAVED AREAS AND EXPOSED SOILS. USE CHEMICAL DUST SUPPRESSANTS ONLY WHERE NECESSARY ON PROBLEM AREAS.
- THE CONTRACTOR ACKNOWLEDGES THAT FAILURE TO IMPLEMENT EROSION AND SEDIMENT CONTROL MEASURES MAY BE SUBJECT TO PENALTIES IMPOSED BY ANY APPLICABLE REGULATORY AGENCY.
- ROADWAYS ARE TO BE SWEEP AS REQUIRED OR AS DIRECTED BY THE ENGINEER AND/OR THE MUNICIPALITY.
- THE CONTRACTOR SHALL ENSURE PROPER DUST CONTROL IS PROVIDED WITH THE APPLICATION OF WATER AND IF REQUIRED, CALCIUM CHLORIDE DURING DRY PERIODS. MONITOR DUST LEVELS DURING SITE PREPARATION, CONSTRUCTION AND CONSTRUCTION ACTIVITIES, AND WHEN DUST LEVELS BECOME VISUALLY APPARENT SPRAY WATER TO MINIMIZE THE RELEASE OF DUST FROM GRAVEL, PAVED AREAS AND EXPOSED SOILS. USE CHEMICAL DUST SUPPRESSANTS ONLY WHERE NECESSARY ON PROBLEM AREAS.

BENCHMARK NOTES:

- ELEVATIONS SHOWN ARE GEODETIC AND ARE REFERRED TO THE CGVD28 GEODETIC DATUM.
- IT IS THE RESPONSIBILITY OF THE USER OF THIS INFORMATION TO VERIFY THAT THE JOB BENCHMARK HAS NOT BEEN ALTERED OR DISTURBED AND THAT ITS RELATIVE ELEVATION AND DESCRIPTION AGREES WITH THE INFORMATION SHOWN ON THIS DRAWING.
- BENCHMARK WAS PROVIDED ON THE TOPOGRAPHIC PLAN OF SURVEY OF BLOCK 6 AND PART OF BLOCK 1 REGISTERED PLAN 4M462 AND PART OF LOTS 8 AND 9 CONCESSION 4, GEOGRAPHIC TOWNSHIP OF MARCH, CITY OF OTTAWA, SURVEYED BY ANIS, OSULLIVAN AND VOLLEBECK LTD.

PAVEMENT STRUCTURES:

- LIGHT DUTY (CAR PARKING PAVEMENT)
 - 50mm RL3 SUPERPAVE 12.5
 - 100mm GRANULAR "A" TYPE II
 - 250mm GRANULAR "B" TYPE II
- HEAVY DUTY (ACCESS ROADS)
 - 40mm RL3 SUPERPAVE 12.5
 - 100mm RL3 SUPERPAVE 10.0
 - 150mm GRANULAR "A"
 - 300mm GRANULAR "B" TYPE II

APPROVED
By *Krishon Walker* at 9:46 am, Mar 05, 2024

KRISHON WALKER
PLANNER
PLANNING, REAL ESTATE & ECONOMIC DEVELOPMENT DEPARTMENT, CITY OF OTTAWA

NOTE: THE POSITION OF ALL POLE LINES, CONDUITS, WATERMANS, SEWERS AND OTHER UNDERGROUND AND OVERGROUND UTILITIES AND STRUCTURES IS NOT NECESSARILY SHOWN ON THE CONTRACT DRAWINGS, AND WHERE SHOWN, THE ACCURACY OF THE POSITION OF SUCH UTILITIES AND STRUCTURES IS NOT GUARANTEED. BEFORE STARTING WORK, DETERMINE THE EXACT LOCATION OF ALL SUCH UTILITIES AND STRUCTURES AND ASSUME ALL LIABILITY FOR DAMAGE TO THEM.

OWNER INFORMATION
NOKIA CO COLLIERS
181 BAY STREET, SUITE 1400
TORONTO, ONTARIO, M5J 2V1
ERIK CUNNINGTON
PHONE: (416) 920-0155
EMAIL: erik.cunnington@colliers.com

SURVEYOR
ANIS, OSULLIVAN, VOLLEBECK LTD.
14 CONCOURSE GATE, SUITE 500
OTTAWA, ONTARIO, K2E 7S6
PHONE: (613) 727-0850

CIVIL ENGINEER/LANDSCAPE ARCHITECT
NOVATECH ENGINEERS, PLANNERS & LANDSCAPE ARCHITECTS
240 MICHAEL, COWPLAND DRIVE, SUITE 200
OTTAWA, ONTARIO, K2M 1P6
PHONE: (613) 254-9643

REVISIONS

No.	REVISION	DATE	BY
1.	PRELIMINARY PLANS ISSUED TO CITY	OCT 2023	FST
2.	ISSUED FOR SPC APPROVAL	NOV 2023	FST
3.	REVISED AS PER CITY COMMENTS	FEB 14/24	FST

SCALE: 1:400

FOR REVIEW ONLY

DESIGN	DATE
ZA	
FST	
ZA	
FST	
FST	

NOVATECH
Engineers, Planners & Landscape Architects
Suite 200, 240 Michael Cowpland Drive
Ottawa, Ontario, Canada K2M 1P6
Telephone: (613) 254-9643
Fax: (613) 254-9887
Website: www.novatech-eng.com

PROFESSIONAL ENGINEER
F.S. TRALUETTE
100041229
PROVINCE OF ONTARIO

LOCATION: CITY OF OTTAWA, 600 MARCH ROAD - NOKIA PARKING LOT EXPANSION

DRAWING NAME: GRADING PLAN AND EROSION & SEDIMENT CONTROL PLAN

PROJECT NO.: 121334-GR

REV. NO.: REV #3

DATE: 121334-GR

PLAN #1907