

SITE BOUNDARIES AND EXISTING GRADES AND OTHER EXISTING FEATURES ARE DERIVED FROM A TOPOGRAPHIC SKETCH PREPARED BY ANNIS OTSULIMAN, VOLLBERG LTD. JOB NO. 16814-16, DATED FEB 24, 2021. EXISTING ELEVATIONS SHOWN ON THE TOPOGRAPHIC SKETCH ARE GEODETIC AND ARE REFERRED TO THE CGVD28 GEODETIC DATUM, DERIVED FROM CITY OF OTTAWA LRT CONTROL MONUMENT 2011-0006 HAVING AN ELEVATION OF 72.657 METRES.

ALL EXISTING TREES ON THE PROPERTY AND RIGHT-OF-WAY SHALL BE PROTECTED DURING AND AFTER CONSTRUCTION AS PER THE MUNICIPAL TREES AND NATURAL AREAS PROTECTION BY-LAW AS AMENDED FROM TIME TO TIME

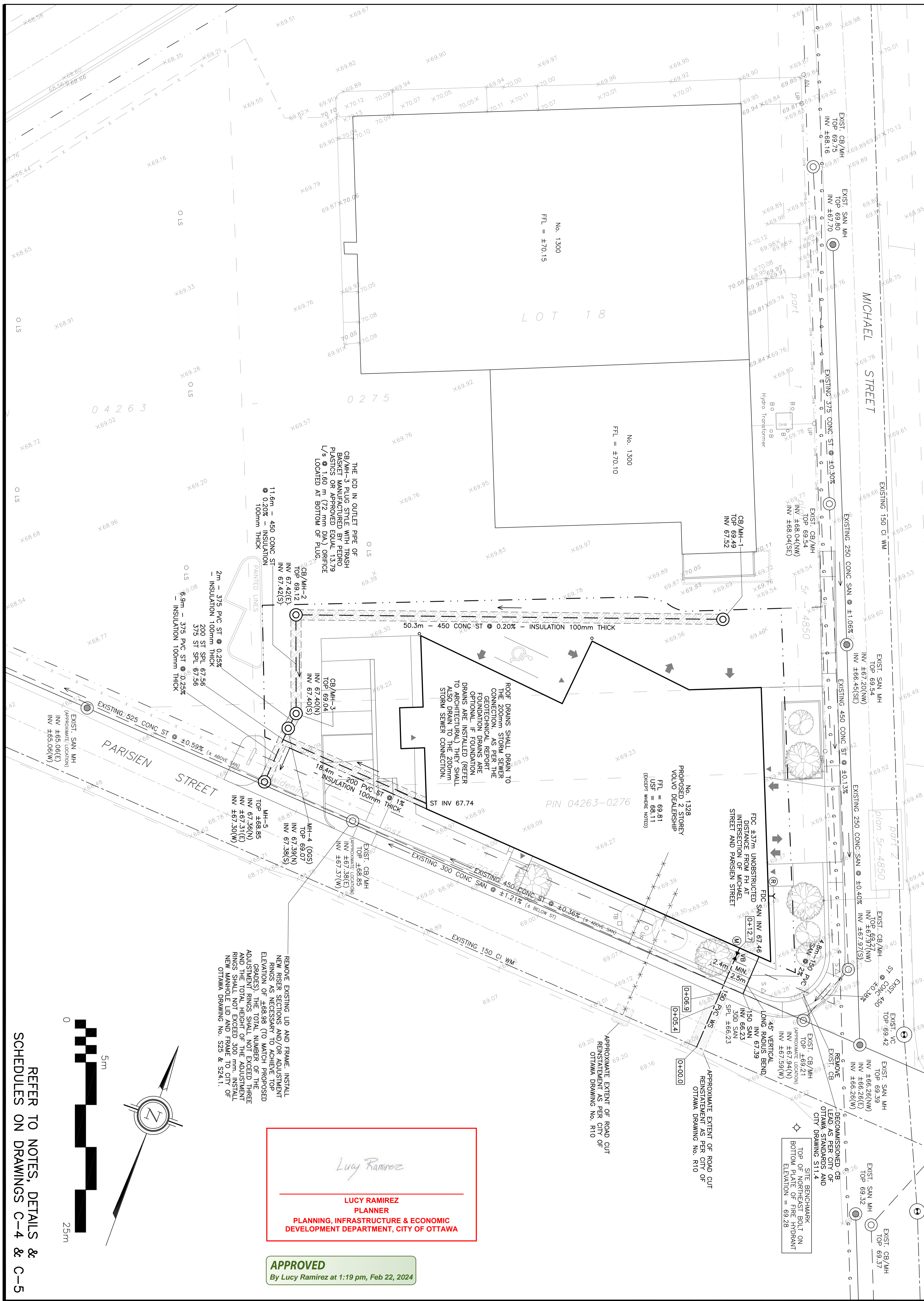

THE IOD IN OUTLET PIPE OF CB/MH-3 PLUG STYLE WITH TRASH BASKET MANUFACTURED BY PERLO PLASTICS OR APPROVED EQUAL 13.79 L/s @ 1.60 m (72 mm DIA.) ORIFICE LOCATED AT BOTTOM OF PLUG.

ROOF DRAINS SHALL DRAIN TO THE 200mm STORM SEWER CONNECTION AS PER THE GEOTECHNICAL REPORT FOUNDATION DRAINS ARE OPTIONAL. IF FOUNDATION DRAINS ARE INSTALLED (REFER TO ARCHITECTURAL) THEY SHALL ALSO DRAIN TO THE 200mm STORM SEWER CONNECTION.

No. 1328  
PROPOSED 2 STOREY  
VOLVO DEALERSHIP  
FTL = 69.81  
USF = 68.11  
(EXCEPT WHERE NOTED)

REMOVE EXISTING LID AND FRAME. INSTALL NEW RINGS AND/OR ADJUSTMENT RINGS AS NECESSARY TO ACHIEVE TOP ELEVATION OF +68.98 (TO MATCH PROPOSED GRADES). THE TOTAL NUMBER OF THE ADJUSTMENT RINGS SHALL NOT EXCEED THREE AND THE TOTAL HEIGHT OF THE ADJUSTMENT RINGS SHALL NOT EXCEED 300 mm. INSTALL NEW MANHOLE LID AND FRAME TO CITY OF OTTAWA DRAWING NO. S25 & S24.1.

*Lucy Ramirez*  
**LUCY RAMIREZ**  
PLANNER  
PLANNING, INFRASTRUCTURE & ECONOMIC  
DEVELOPMENT DEPARTMENT, CITY OF OTTAWA

**APPROVED**  
By Lucy Ramirez at 1:19 pm, Feb 22, 2024

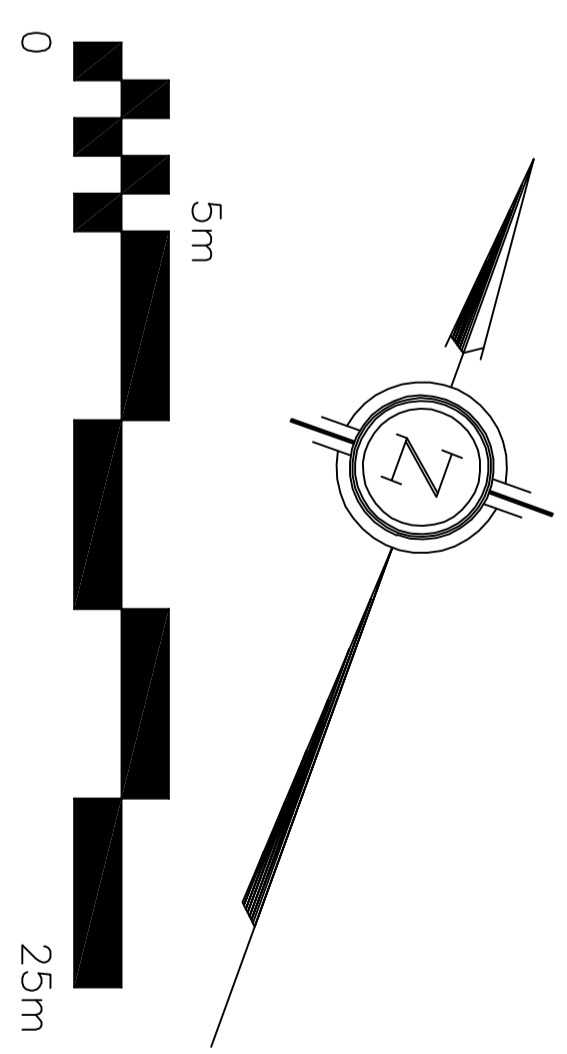

REFER TO NOTES, DETAILS & SCHEDULES ON DRAWINGS C-4 & C-5

**LEGEND**

- CB □ CATCH-BASIN
- MH ○ STORM MANHOLE
- CB/MH ○ CATCH-BASIN/MANHOLE
- MH ○ SANITARY MANHOLE
- VC ○ VALVE CHAMBER
- VB ○ VALVE & VALVE BOX
- FH ○ FIRE HYDRANT
- FDG ○ FIRE DEPARTMENT CONNECTION
- SAN ○ SANITARY SEWER
- ST ○ STORM SEWER
- WS/MH ○ WATER SERVICE WATERMAIN
- SPL ○ SPRINGLINE OF PIPE
- INV ○ INVERT OF PIPE
- (M) ○ WATER METER
- (R) ○ REMOVE WATER METER
- FTL ○ FINISHED FLOOR ELEVATION
- USF ○ UNDERSIDE OF FOOTING
- ○ PROPERTY LINE
- - - ○ EXISTING GRADE ELEVATION
- CR Z ○ CRITICAL ROOT ZONE

**KEY PLAN**

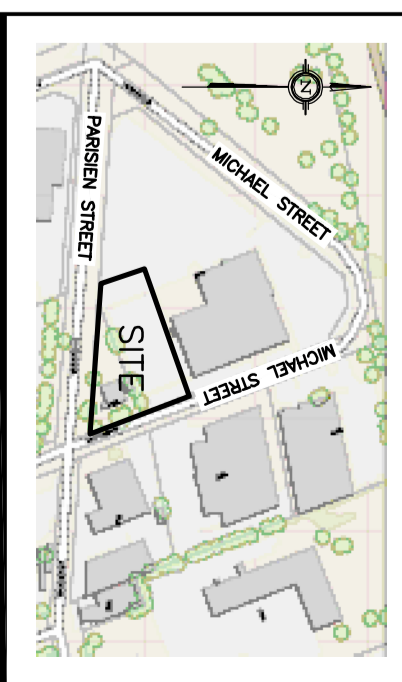

No.	DATE	REVISION
1	NOV 2-21	PRELIMINARY
2	JAN 11-22	ISSUED FOR COORDINATION
3	JAN 12-22	ISSUED FOR APPROVAL
4	JUL 28-22	RE-ISSUED FOR APPROVAL
5	JAN 25-23	RE-ISSUED FOR APPROVAL
6	JUL 24-23	RE-ISSUED FOR APPROVAL

**D. B. GRAY ENGINEERING, INC.**  
Professional Engineers - Consulting & Engineering - Storm & Sewer Systems Management  
7101 Long Point Circle  
Ottawa, Ontario  
613-425-9114  
dgray@dbgrayengineering.com

Project  
**PROPOSED 2 STOREY  
VOLVO DEALERSHIP  
1328 MICHAEL STREET  
OTTAWA, ONTARIO**

Drawing Title  
**SITE SERVICING PLAN**

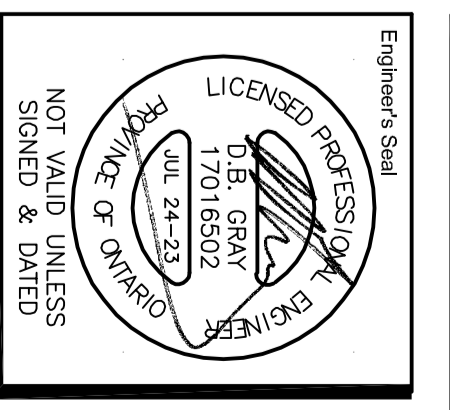

Drawing No.  
**C-1  
of 8**