

THESE DRAWINGS ARE NOT TO BE SCALED. ALL DIMENSIONS MUST BE VERIFIED BY CONTRACTOR PRIOR TO COMMENCEMENT OF ANY WORK. ANY DISCREPANCIES MUST BE REPORTED DIRECTLY TO SRN ARCHITECTS INC.

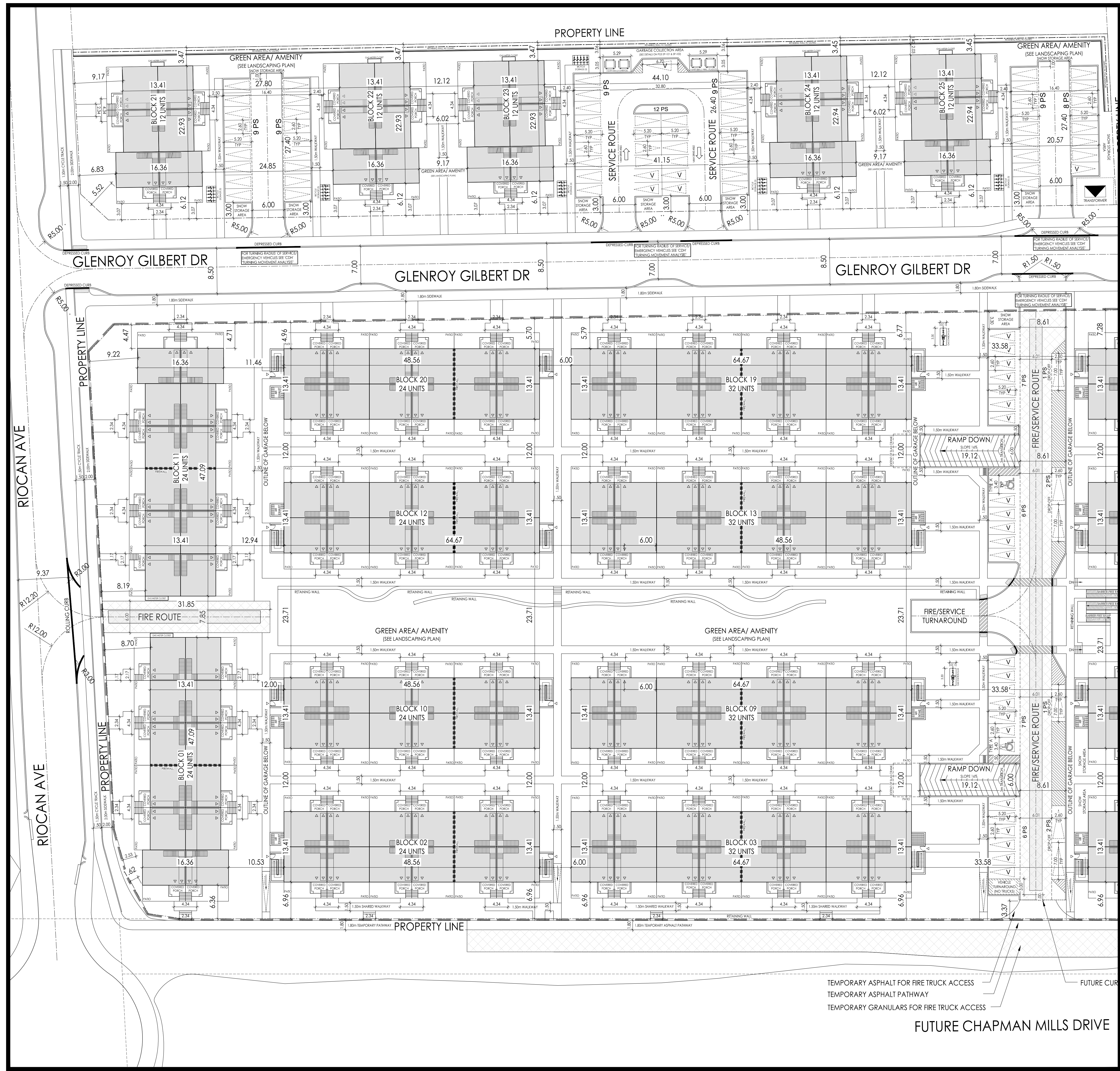

NO.	DATE	ISSUED FOR
13	11-OCT-22	REV. PER CLIENT
14	25-OCT-22	REV. PER SPA
15	14-DEC-22	REV. PER CLIENT
16	01-MAY-23	REV. PER CLIENT
17	17-MAY-23	REV. PER CLIENT
18	23-MAY-23	RE-ISSUED FOR SPA
19	26-JUN-23	REV. PER CLIENT
20	12-OCT-23	REV. PER CLIENT
21	14-DEC-23	REV. PER CONSULTANT
23	21-FEB-24	REV. PER CLIENT

ADDITIONAL NOTES:
 PART OF LOT 14
 CONCESSION 2 (RIDEAU FRONT)
 GEOGRAPHIC TOWNSHIP OF NEPEAN
 CITY OF OTTAWA
 STANTEC GEOMATICS, 2021

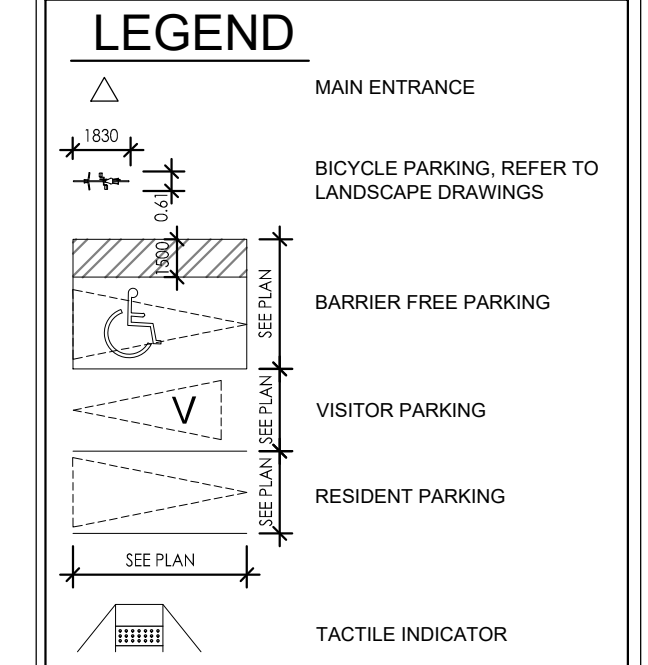

FOR SITE GRADING AND SERVICING REFER TO CIVIL DRAWINGS

PRELIMINARY, NOT FOR CONSTRUCTION
 ALL AREA CALCULATIONS ARE PRELIMINARY

NO.	DATE	REVISION COMMENT

SRN ARCHITECTS
 8395 JANE STREET, SUITE 203
 VAUGHAN, ONTARIO L4K 5Y2
 PHONE: 905-417-5515 FAX: 905-417-5517

CLIENT:
Minto Communities Canada
 200-180 Kent Street
 Ottawa, Ontario K1P 0B6

PROJECT:
Barrhaven Town Centre - Anthem
 Ottawa, Ontario

DRAWING TITLE:
SITE PLAN

DATE: 2022-02-03	SCALE: 1:500
DRAWN BY: AB	CHECKED BY: GR
PROJECT NUMBER:	DRAWING NUMBER:
S21001	A101

1 SITE PLAN (EAST SIDE)
 A101 1:300

