

**NOTE:**  
A GEOTECHNICAL ENGINEER LICENSED IN THE PROVINCE OF ONTARIO IS TO INSPECT ALL SUBGRADE SURFACES FOR FOOTING AND PAVEMENT STRUCTURES PRIOR TO CONSTRUCTION

**NOTE:**  
ALL EXISTING POST & WIRE FENCE, CULVERTS, UTILITY WIRE / POLES, TREES, SHRUBS ETC. WITHIN LOTS, BLOCKS AND ROADS TO BE REMOVED, UNLESS OTHERWISE NOTED

**NOTE RE: PERFORATED PIPE**  
PERFORATED PIPE IS REQUIRED FOR SWALE SLOPE LESS THAN 1.5%. REFER TO CITY STD. S29, S30 FOR REAR YARD TRENCH AND PIPE DETAIL ONLY

**NOTE:**  
ALL SWALES SHALL BE 0.15m DEEP WITH 3:1 SIDE SLOPES UNLESS OTHERWISE INDICATED

**NOTE:**  
ENTRANCES TO PRIVATE SITE PER SC7.1

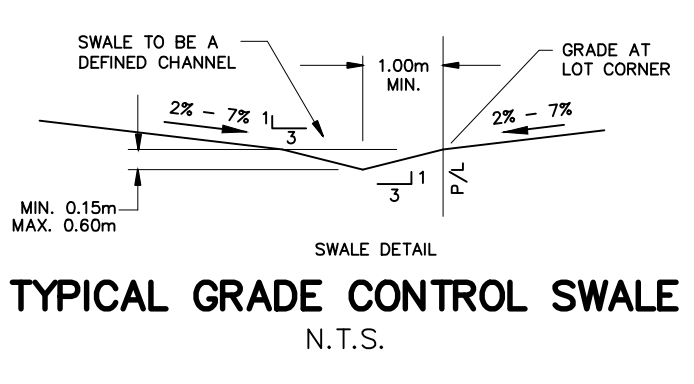

TYPICAL GRADE CONTROL SWALE  
N.T.S.

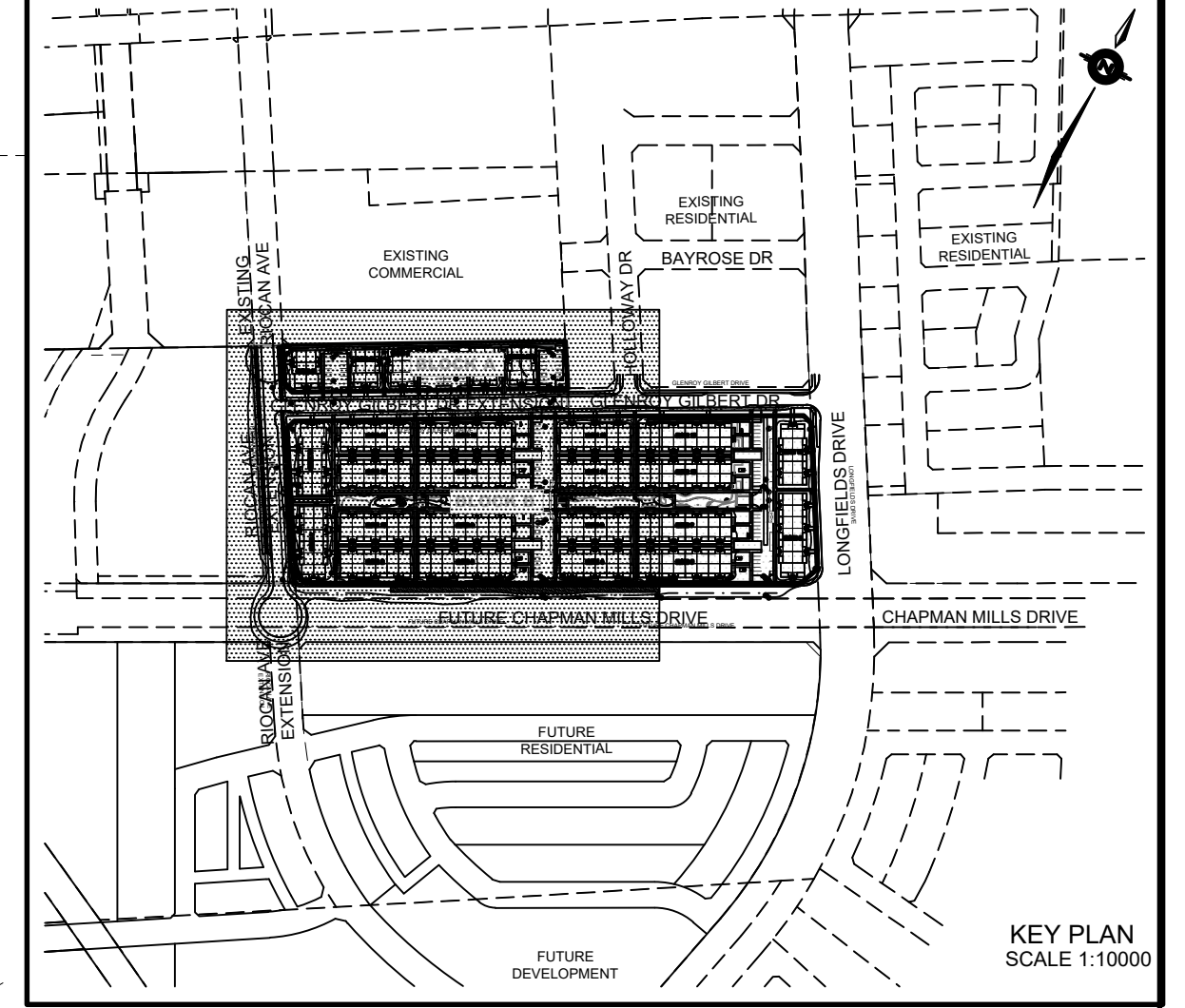

KEY PLAN  
SCALE 1:1000

**LEGEND**

PROPOSED ELEVATION	103.45	OVERLAND FLOW DIRECTION	→
EXISTING ELEVATION	102.73	EXTERNAL OVERLAND FLOW DIRECTION	→
FUTURE ELEVATION	[93.90]	EMERGENCY OVERLAND FLOW DIRECTION	→
PROPOSED SWALE GRADE	1.5%	TOP OF WALL ELEVATION	103.10 T
HIGH POINT	102.16	BOTTOM OF WALL ELEVATION	102.44 B
STREET CATCHBASIN	○	CHAINLINK FENCE (1.5m UNLESS OTHERWISE NOTED)	—
STREET CATCHBASIN WITH CLOSED LID	○	NOISE BARRIER (3.0m UNLESS OTHERWISE NOTED)	—
CATCHBASIN MANHOLE	○	VALVE & VC	—
TEE CATCHBASIN	○	VALVE & VB	—
ELBOW CATCHBASIN	○	BUILDING ENVELOPE	—
HYDRANT, VALVE & VB	○	TOP OF FOUNDATION (TOF)	—
VALVE & VC	○	FINISHED FLOOR ELEVATION (FFE)	—
VALVE & VB	○	UNDERSIDE OF FOOTING ELEVATION (USF)	—
INDICATOR (AS PER CITY OF OTTAWA STD. SC6)	○	ELEVATION REQUIRING WATER PRESSURE REDUCING VALVES	—
INDICATOR (AS PER CITY OF OTTAWA STD. SC6)	○	WALKOUT UNITS	—
INDICATOR (AS PER CITY OF OTTAWA STD. SC6)	○	SLAB ON GRADE	—
INDICATOR (AS PER CITY OF OTTAWA STD. SC6)	○	250# PVC PERFORATED PIPE (REFER TO CITY STD S29 FOR REAR YARD TRENCH AND PIPE DETAILS ONLY) (SUBIRAN APPLIED FOR SLOPE LESS THAN 1.5%)	—
INDICATOR (AS PER CITY OF OTTAWA STD. SC6)	○	LANDS	—
INDICATOR (AS PER CITY OF OTTAWA STD. SC6)	○	HYDRO SWITCHGEAR	—
INDICATOR (AS PER CITY OF OTTAWA STD. SC6)	○	HYDRO TRANSFORMER	—
INDICATOR (AS PER CITY OF OTTAWA STD. SC6)	○	STREET LIGHT STANDARD	—
INDICATOR (AS PER CITY OF OTTAWA STD. SC6)	○	TACTILE WALKING SURFACE INDICATOR (AS PER CITY OF OTTAWA STD. SC6)	—
INDICATOR (AS PER CITY OF OTTAWA STD. SC6)	○	PREVIOUS PHASES / PHASES NOT PART OF CURRENT GRADING APPROVAL	—
INDICATOR (AS PER CITY OF OTTAWA STD. SC6)	○	FIREWALL	—

**NOT FOR CONSTRUCTION**

No.	BY	DATE	DESCRIPTION
7	S.L.M.	24-02-04	SUBMISSION 5
6	S.L.M.	23-10-06	ISSUED FOR TENDER
5	S.L.M.	23-09-22	ISSUED FOR TENDER
4	S.L.M.	23-09-06	ISSUED FOR TENDER

**TOPOGRAPHIC INFORMATION**  
TOPOGRAPHIC INFORMATION PROVIDED BY STANTEC GEOMATICS LTD., PROJECT No. 161614291-111, DATED MARCH 1, 2022

**SITE PLAN INFORMATION**  
SITE PLAN PROVIDED BY SRN ARCHITECTS LTD., PROJECT No. S21001, DATED OCTOBER 5, 2023

**LEGAL INFORMATION**  
CALCULATED DRAFT PLAN PROVIDED BY STANTEC GEOMATICS LTD., PROJECT No. 161614291-131, DATED AUGUST 9, 2023

**BENCH MARK**  
ELEVATIONS ARE REFERRED TO THE CANADIAN GEODETIC VERTICAL DATUM (CGVD-1928:1978) AND ARE DERIVED FROM BENCHMARK MONUMENT No. 196530071\*, HAVING A PUBLISHED ELEVATION OF 99.742 METRES

MINTO COMMUNITIES INC.  
BARRHAVEN TOWN CENTRE  
GLENROY GILBERT DRIVE RIOCAN AVENUE & CHAPMAN MILLS DRIVE EXTENSION

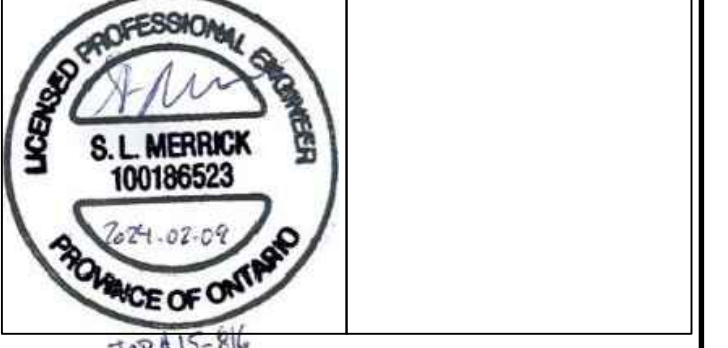

CITY ROW GRADING PLAN WEST

DRAWN BY: AM	CHECKED BY: BC	PROJECT No. 15-816
DESIGNED BY: BC	CHECKED BY: SM	SHEET No. 10
SCALE: 1:500		

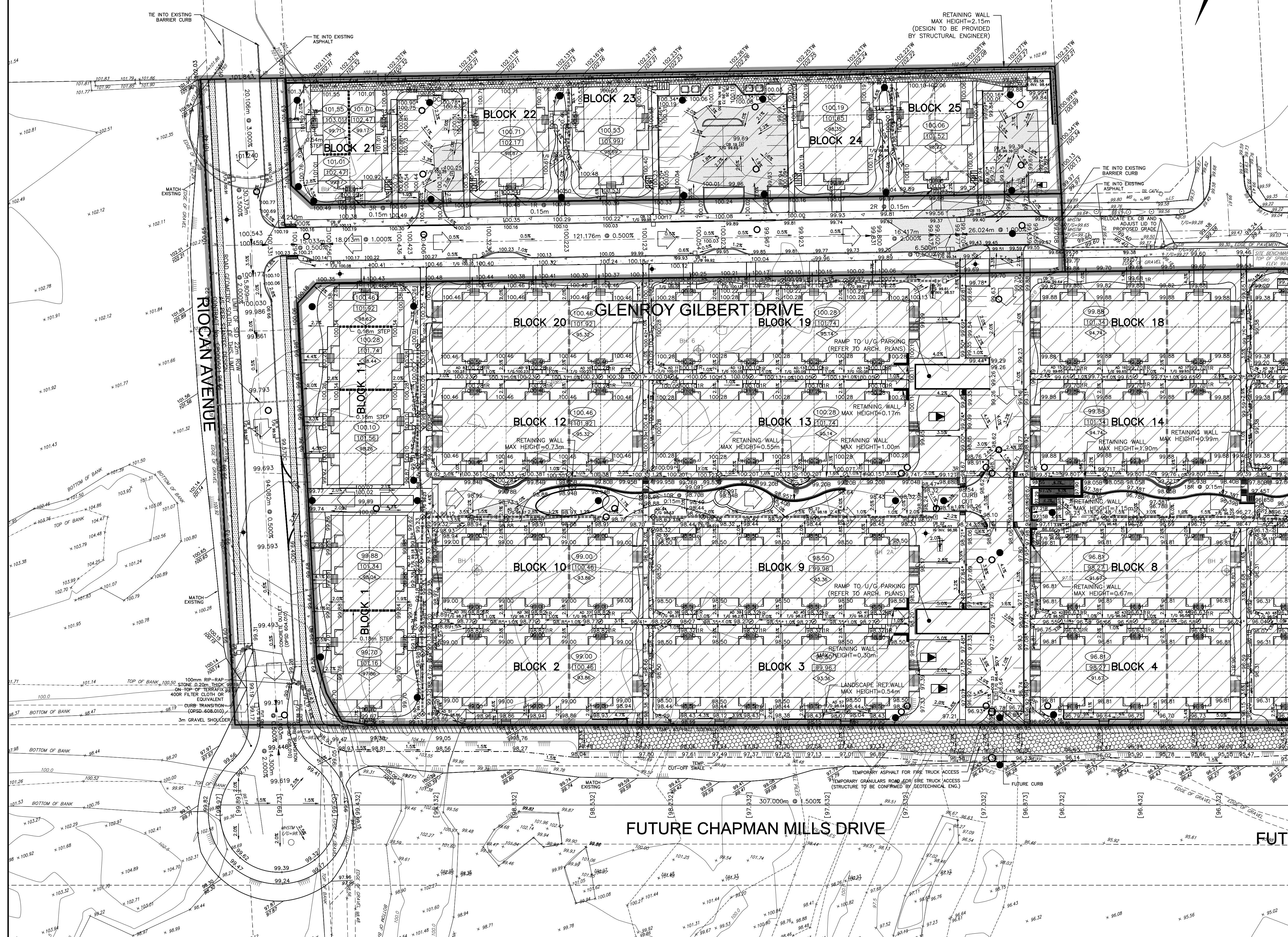

CITY PLAN No. 18822  
CITY FILE No. D07-12-22-0104