

NOTE:
A GEOTECHNICAL ENGINEER LICENSED IN THE PROVINCE OF ONTARIO IS TO INSPECT ALL SUBGRADE SURFACES FOR FOOTING AND PAVEMENT STRUCTURES PRIOR TO CONSTRUCTION

NOTE:
ALL EXISTING POST & WIRE FENCE, CULVERTS, UTILITY WIRE / POLES, TREES, SHRUBS ETC. WITHIN LOTS, BLOCKS AND ROADS TO BE REMOVED, UNLESS OTHERWISE NOTED

NOTE RE: PERFORATED PIPE
PERFORATED PIPE IS REQUIRED FOR SWALE SLOPE LESS THAN 1.5%. REFER TO CITY STD. S29, S30 FOR REAR YARD TRENCH AND PIPE DETAIL ONLY

NOTE:
ALL SWALES SHALL BE 0.15m DEEP WITH 3:1 SIDE SLOPES UNLESS OTHERWISE INDICATED

ANY DISTURBED AREA DURING CONSTRUCTION TO BE RESTORED TO ORIGINAL CONDITION OR BETTER TO THE SATISFACTION OF THE AUTHORITIES HAVING JURISDICTION

NOTE:
REFER TO DETAIL ON DWG 2 FOR FURTHER DETAILS ON SERVICES TO THE STACKED TOWNHOMES

NOTE:
REFER TO CITY STD. SC7.1 FOR DRIVEWAY DETAIL

NOTE:
ENTRANCES TO PRIVATE SITE PER SC7.1

CONTRACTOR TO VERIFY THE PRECISE LOCATIONS AND INVERT ELEVATIONS OF EX. UNDERGROUND SERVICES AND EX. UTILITIES PRIOR TO STARTING CONSTRUCTION

PERMISSION REQUIRED FOR WORK ON ADJACENT LANDS

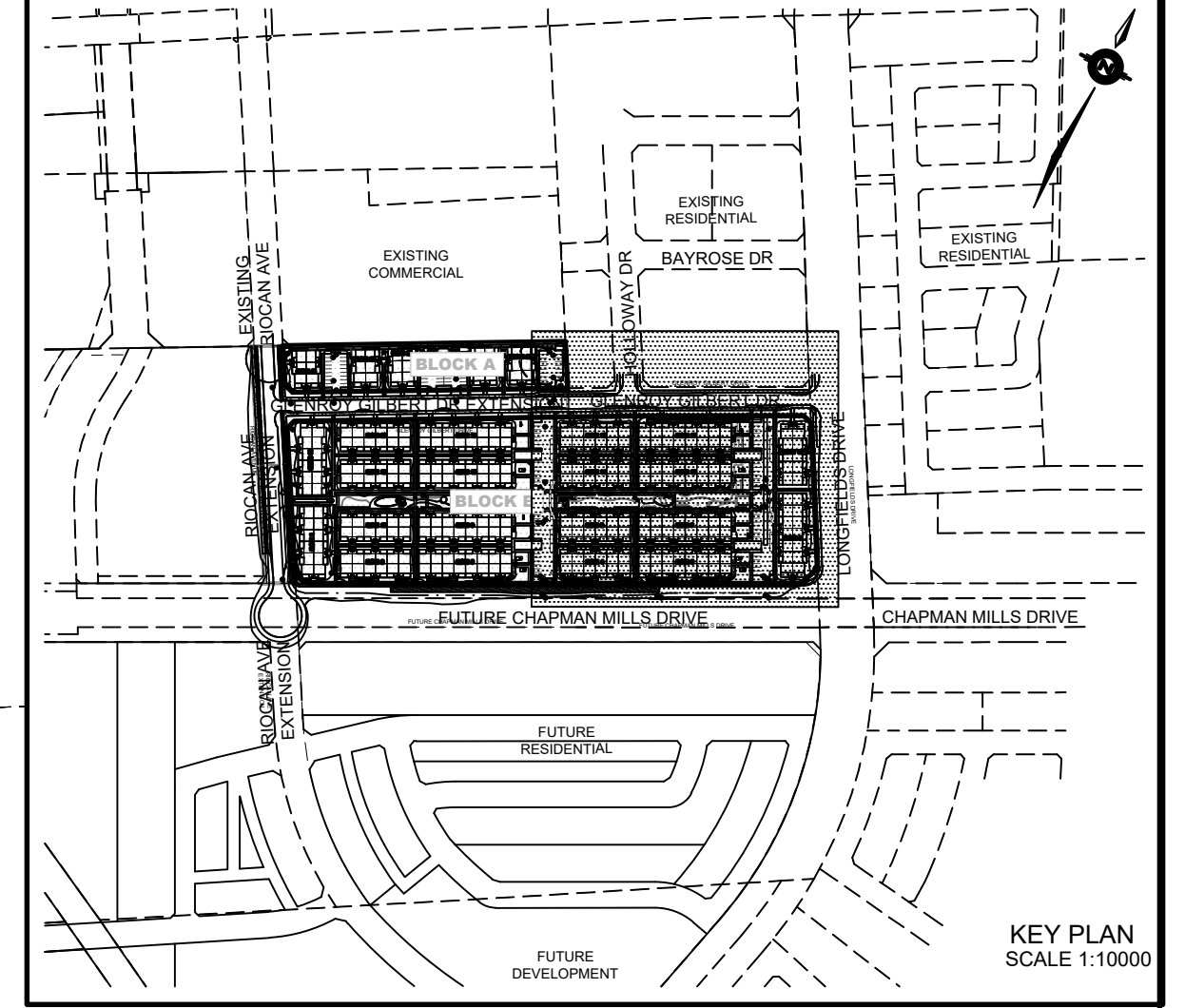

LEGEND

PROPOSED ELEVATION	103.45	OVERLAND FLOW DIRECTION	→
EXISTING ELEVATION	102.73	EXTERNAL OVERLAND FLOW DIRECTION	→
FUTURE ELEVATION	[93.90]	EMERGENCY OVERLAND FLOW DIRECTION	→
PROPOSED SWALE GRADE	1.5%	TOP OF WALL ELEVATION	103.10 T
HIGH POINT	102.16	RETAINING WALL AND ELEVATIONS	102.44 B
STREET CATCHBASIN		CHAINLINK FENCE (1.5m UNLESS OTHERWISE NOTED)	
STREET CATCHBASIN WITH CLOSED LID		NOISE BARRIER (3.0m UNLESS OTHERWISE NOTED)	
CATCHBASIN MANHOLE		VALVE & VB	
TEE CATCHBASIN		VALVE & VC	
ELBOW CATCHBASIN		BUILDING ENVELOPE	
HYDRANT, VALVE & VB		TOP OF FOUNDATION (TOF)	
VALVE & VC		FINISHED FLOOR ELEVATION (FFE)	
VALVE & VB		UNDERSIDE OF FOOTING ELEVATION (USF)	
DECORATIVE FENCE (SEE LANDSCAPE DWGS FOR DETAIL)		UNITS REQUIRING WATER PRESSURE REDUCING VALVES	
CONSTRUCTION FENCE		WALKOUT UNITS	
PROPERTY BOUNDARY		SLAB ON GRADE	
3:1 TERRACING MAXIMUM SLOPE		HYDRO SWITCHGEAR	
250# PVC PERFORATED PIPE (REFER TO CITY STD S29 FOR REAR YARD TRENCH AND PIPE DETAILS ONLY) (SUBRAN APPLIED FOR SLOPE LESS THAN 1.5%)		HYDRO TRANSFORMER	
PRV		STREET LIGHT STANDARD	
50G		TACTILE WALKING SURFACE INDICATOR (AS PER CITY OF OTTAWA STD. SC6)	
250# PVC PERFORATED PIPE (REFER TO CITY STD S29 FOR REAR YARD TRENCH AND PIPE DETAILS ONLY) (SUBRAN APPLIED FOR SLOPE LESS THAN 1.5%)		PREVIOUS PHASES / PHASES NOT PART OF CURRENT GRADING APPROVAL	
FIREWALL			

NOT FOR CONSTRUCTION

No.	BY	DATE	DESCRIPTION
7	S.L.M.	24-02-09	5TH SUBMISSION
6	S.L.M.	23-10-06	4TH SUBMISSION
5	S.L.M.	23-09-22	ISSUED FOR TENDER
4	S.L.M.	23-09-06	ISSUED FOR TENDER

TOPOGRAPHIC INFORMATION
TOPOGRAPHIC INFORMATION PROVIDED BY STANTEC GEOMATICS LTD., PROJECT No. 161614291-111, DATED MARCH 1, 2022

SITE PLAN INFORMATION
SITE PLAN PROVIDED BY SRN ARCHITECTS LTD., PROJECT No. S21001, DATED DECEMBER 14, 2023

LEGAL INFORMATION
CALCULATED DRAFT PLAN PROVIDED BY STANTEC GEOMATICS LTD., PROJECT No. 161614291-131, DATED AUGUST 9, 2023

BENCH MARK
ELEVATIONS ARE REFERRED TO THE CANADIAN GEODETIC VERTICAL DATUM (CGVD-1928:1978) AND ARE DERIVED FROM BENCHMARK MONUMENT No. 196530071-1, HAVING A PUBLISHED ELEVATION OF 99.742 METRES

MINTO COMMUNITIES INC. BARRHAVEN TOWN CENTRE STAGE 1

DSEL 120 Ber Road Unit 103 Slittsville, Ontario, K2S 1E9 Tel. (613) 836-0856 Fax. (613) 836-7183 www.DSEL.ca

S.L. MERRICK 100166523 LICENSED PROFESSIONAL ENGINEER PROVINCE OF ONTARIO

Ottawa 110 Laurier Ave W Ottawa, Ontario, K1P 1J1 Tel. (613) 580-2400 www.Ottawa.ca

GRADING PLAN EAST

DRAWN BY: AM	CHECKED BY: BC	PROJECT No. 15-816
DESIGNED BY: BC	CHECKED BY: SM	SHEET No. 7
SCALE: 1:400		

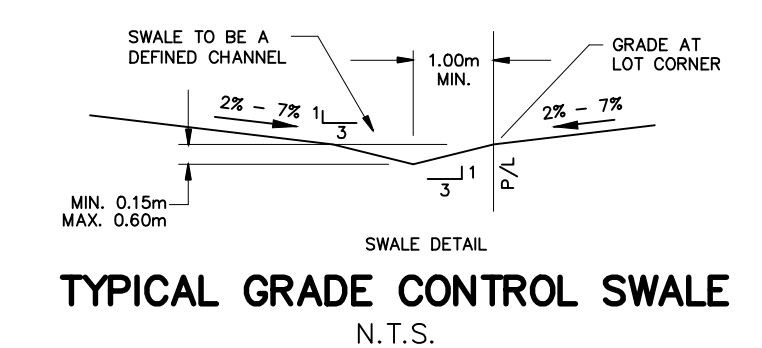

CITY PLAN No. 18822 D07-12-22-0104