

APPROVED
By Adam Brown at 10:13 am, Feb 16, 2024

ADAM BROWN
MANAGER, DEVELOPMENT REVIEW - RURAL
PLANNING, REAL ESTATE & ECONOMIC DEVELOPMENT
DEPARTMENT, CITY OF OTTAWA

CLIENT
A & G OLENDER HOLDINGS LTD.

CONSULTANTS
ARCHITECTS
D2 concepts
7396 RIDGEWOOD AVE., SUITE 201
OTTAWA, ONTARIO, K1V 6M8

CIVIL ENGINEERS
ARCH-NOVA Design Inc.
45 Banner Road NEPEAN ON K2H 8X5
613-702-3403 contact@archnova.ca

- LEGEND
- POTENTIAL AREAS OF TREE RETENTION (REFER TO TREE CONSERVATION REPORT & ENVIRONMENTAL IMPACT STATEMENT PREPARED BY MUNCASTER ENVIRONMENTAL PLANNING INC. JULY 21, 2021) FOR DETAILS
 - EXISTING TREE TO REMAIN (REFER TO TREE CONSERVATION REPORT & ENVIRONMENTAL IMPACT STATEMENT PREPARED BY MUNCASTER ENVIRONMENTAL PLANNING INC. JULY 21, 2021) FOR DETAILS
 - EXISTING TREE TO BE REMOVED (REFER TO TREE CONSERVATION REPORT & ENVIRONMENTAL IMPACT STATEMENT PREPARED BY MUNCASTER ENVIRONMENTAL PLANNING INC. JULY 21, 2021) FOR DETAILS
 - PROPOSED DECIDUOUS TREE
 - PROPOSED ASPHALT WALKWAY
 - PROPOSED PRECAST CONCRETE PAVERS
 - PROPOSED RIVERSTONE MULCH
 - PROPOSED GRASS OR CLOVER SEED
 - PROPOSED ANNUALS 'BY OWNER'
 - PROPOSED ARMOUR STONE RETAINING WALL

No.	Issue	Date	DR	CK
7	REVISED PER NEW SITE PLAN	08/25/2023	ML	JL
6	REVISED PER NEW SITE PLAN	06/14/2023	ML	JL
5	ISSUED FOR DISCUSSION AND REVIEW	02/15/2023	WF	JL
4	ISSUED FOR DISCUSSION AND REVIEW	09/22/2022	ML	JL
3	ISSUED FOR DISCUSSION AND REVIEW	09/11/2022	ML	JL
2	ISSUED FOR DISCUSSION AND REVIEW	10/28/2021	ML	JL
1	ISSUED FOR DISCUSSION AND REVIEW	10/15/2021	ML	JL

JAMES B. LENNOX & ASSOCIATES INC.
LANDSCAPE ARCHITECTS
1332 CARLING AVE. OTTAWA, ONTARIO K2H 5J8
Tel. (613) 722-5168 Fax. (866) 343-3942

PROJECT
4 CAMPBELL REID PROPOSED VET CLINIC
4 CAMPBELL REID COURT, KANATA ON

DRAWING
LANDSCAPE PLAN

SCALE
AS SHOWN

START DATE
AUGUST 2021

PROJECT NO.
21MS2157

PROJECT NORTH

DRAWING NO.
L.1

PLOT SIZE ARCH-D

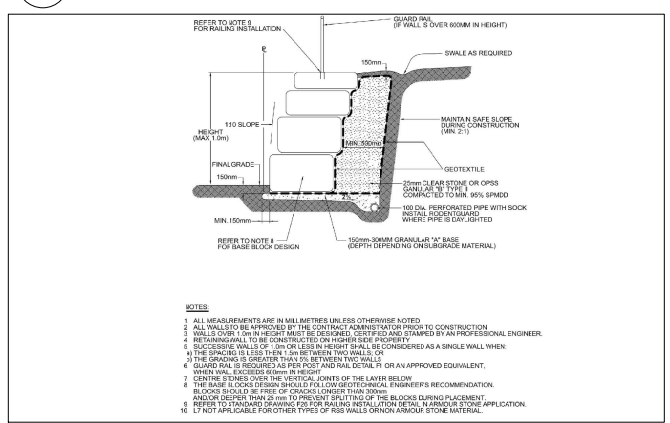
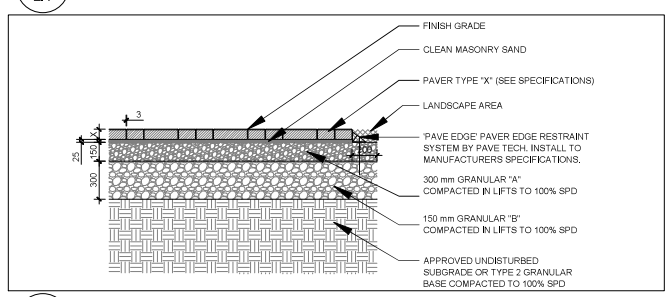
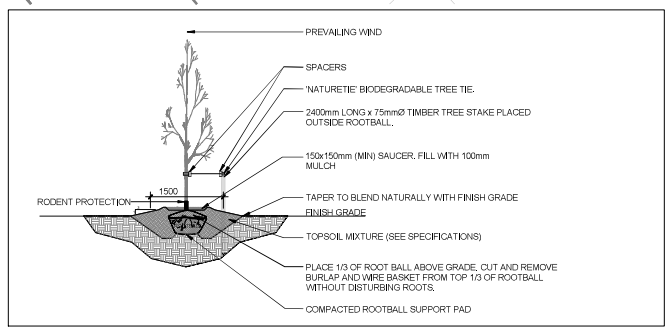
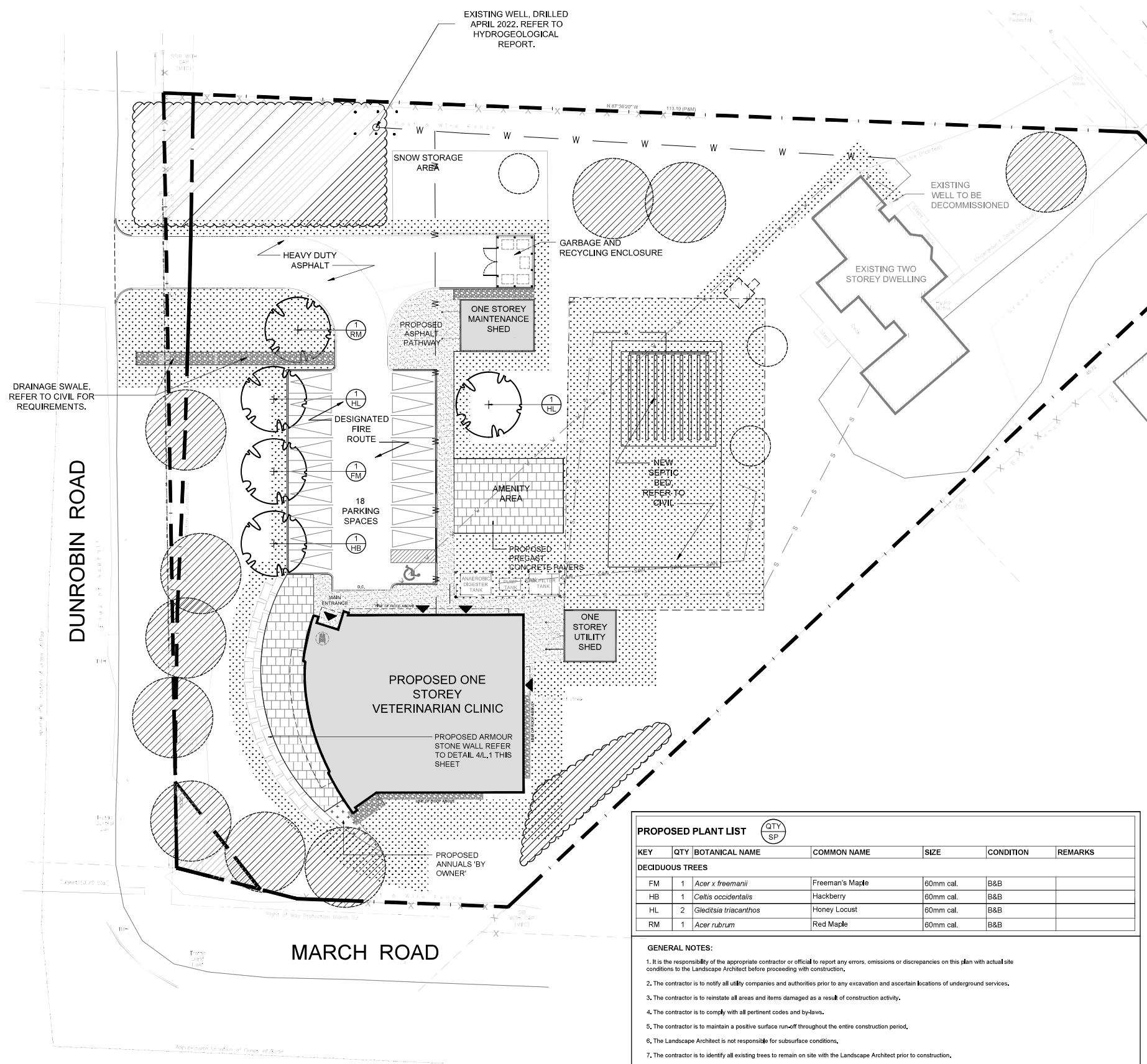

PROPOSED PLANT LIST

KEY	QTY	BOTANICAL NAME	COMMON NAME	SIZE	CONDITION	REMARKS
DECIDUOUS TREES						
FM	1	<i>Acer x freemanii</i>	Freeman's Maple	60mm cal.	B&B	
HB	1	<i>Celtis occidentalis</i>	Hackberry	60mm cal.	B&B	
HL	2	<i>Gleditsia triacanthos</i>	Honey Locust	60mm cal.	B&B	
RM	1	<i>Acer rubrum</i>	Red Maple	60mm cal.	B&B	

- GENERAL NOTES:**
- It is the responsibility of the appropriate contractor or official to report any errors, omissions or discrepancies on this plan with actual site conditions to the Landscape Architect before proceeding with construction.
 - The contractor is to notify all utility companies and authorities prior to any excavation and ascertain locations of underground services.
 - The contractor is to reinstate all areas and items damaged as a result of construction activity.
 - The contractor is to comply with all pertinent codes and by-laws.
 - The contractor is to maintain a positive surface run-off throughout the entire construction period.
 - The Landscape Architect is not responsible for subsurface conditions.
 - The contractor is to identify all existing trees to remain on site with the Landscape Architect prior to construction.
 - The contractor is to stake the proposed location of all plant material in conjunction with the Landscape Architect prior to excavation.
 - Minimum distances for selected deciduous trees are as follows:
 - Building Foundations 7.5m
 - Sidewalks 1.5m
 - Public Streets 2.5m
 - Underground Infrastructure 2.0m
 - All trees within 1m of underground utility trenches are to be excavated by hand.
 - Remove all protective wrapping from tree trunks after installation.
 - Staking of trees shall only be performed if necessary.
 - Ensure that mulch is pulled back a min. distance of 75mm from base of tree trunk.

1 LANDSCAPE PLAN
L.1 SCALE 1:250

0 2 4 6 8 10m