

APPROVED
By John Bernier at 11:11 am, Oct 02, 2023

JOHN BERNIER
PLANNER
PLANNING, REAL ESTATE & ECONOMIC DEVELOPMENT
DEPARTMENT, CITY OF OTTAWA

- GENERAL NOTES:**
- IT IS THE RESPONSIBILITY OF THE APPROPRIATE CONTRACTOR OR OFFICIAL TO REPORT ANY ERRORS, OMISSIONS OR DISCREPANCIES ON THIS PLAN WITH ACTUAL SITE CONDITIONS TO THE LANDSCAPE ARCHITECT BEFORE PROCEEDING WITH CONSTRUCTION.
 - THE CONTRACTOR IS TO NOTIFY ALL UTILITY COMPANIES AND AUTHORITIES PRIOR TO ANY EXCAVATION AND ASCERTAIN LOCATIONS OF UNDERGROUND SERVICES.
 - THE CONTRACTOR IS TO REINSTATE ALL AREAS AND ITEMS DAMAGED AS A RESULT OF CONSTRUCTION ACTIVITY.
 - THE CONTRACTOR IS TO COMPLY WITH ALL PERTINENT CODES AND BY-LAWS.
 - THE CONTRACTOR IS TO MAINTAIN A POSITIVE SURFACE RUN-OFF THROUGHOUT THE ENTIRE CONSTRUCTION PERIOD.
 - THE LANDSCAPE ARCHITECT IS NOT RESPONSIBLE FOR SUBSURFACE CONDITIONS.
 - THE CONTRACTOR IS TO IDENTIFY ALL EXISTING TREES TO REMAIN ON SITE WITH THE LANDSCAPE ARCHITECT PRIOR TO CONSTRUCTION.
 - THE CONTRACTOR IS TO STAKE THE PROPOSED LOCATION OF ALL PLANT MATERIAL IN CONJUNCTION WITH THE LANDSCAPE ARCHITECT PRIOR TO EXCAVATION.
 - MINIMUM DISTANCES FOR SELECTED DECIDUOUS TREES ARE AS FOLLOWS:
 - BUILDING FOUNDATIONS - 7.5M
 - SIDEWALKS - 1.5M
 - PUBLIC STREETS - 2.5M
 - UNDERGROUND INFRASTRUCTURE - 2.0M
 - ALL TREES WITHIN 1M OF UNDERGROUND UTILITY TRENCHES ARE TO BE EXCAVATED BY HAND.
 - REMOVE ALL PROTECTIVE WRAPPING FROM TREE TRUNKS AFTER INSTALLATION.
 - STAKING OF TREES SHALL ONLY BE PERFORMED IF NECESSARY.
 - ENSURE THAT MULCH IS PULLED BACK A MINIMUM DISTANCE OF 75MM FROM BASE OF TREE TRUNK.

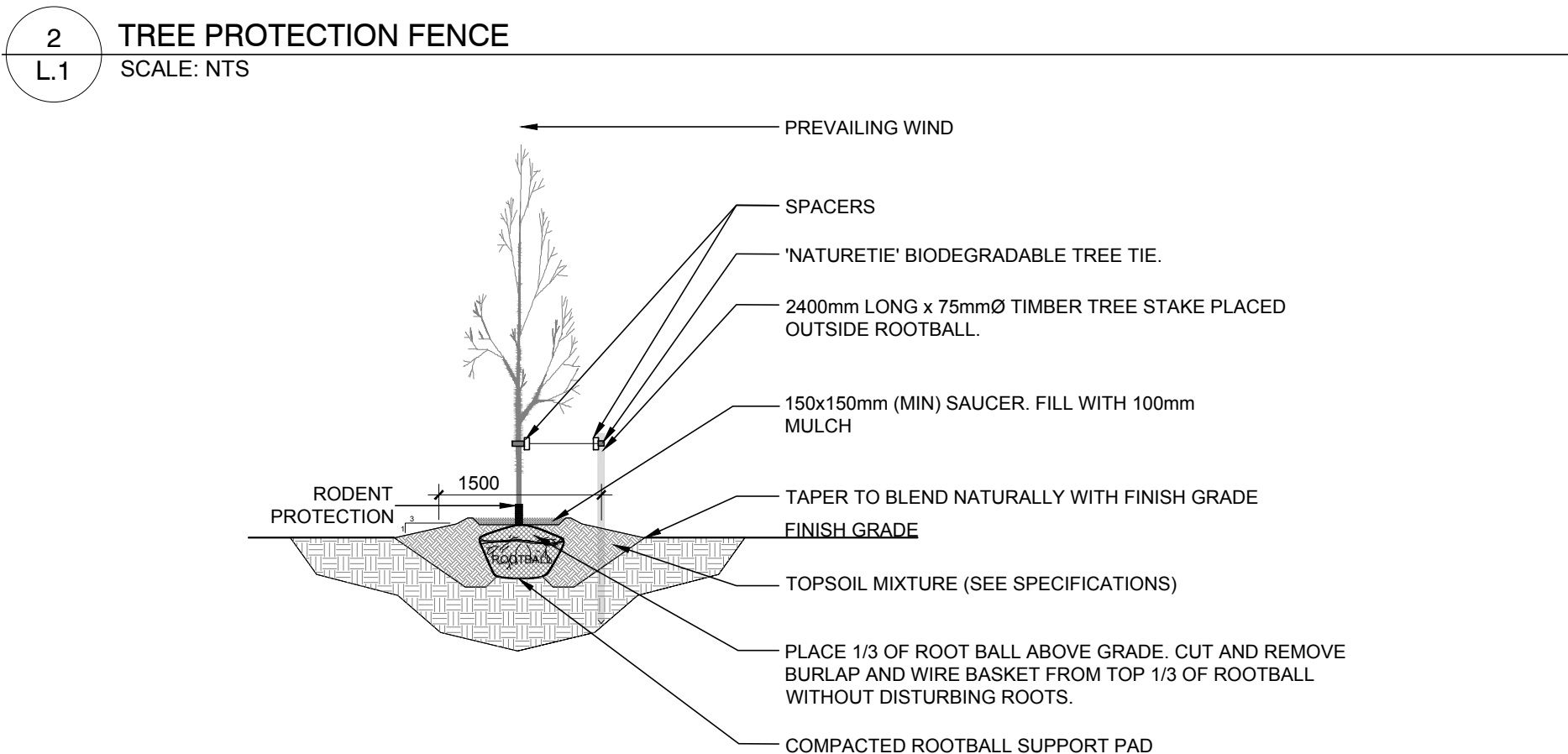
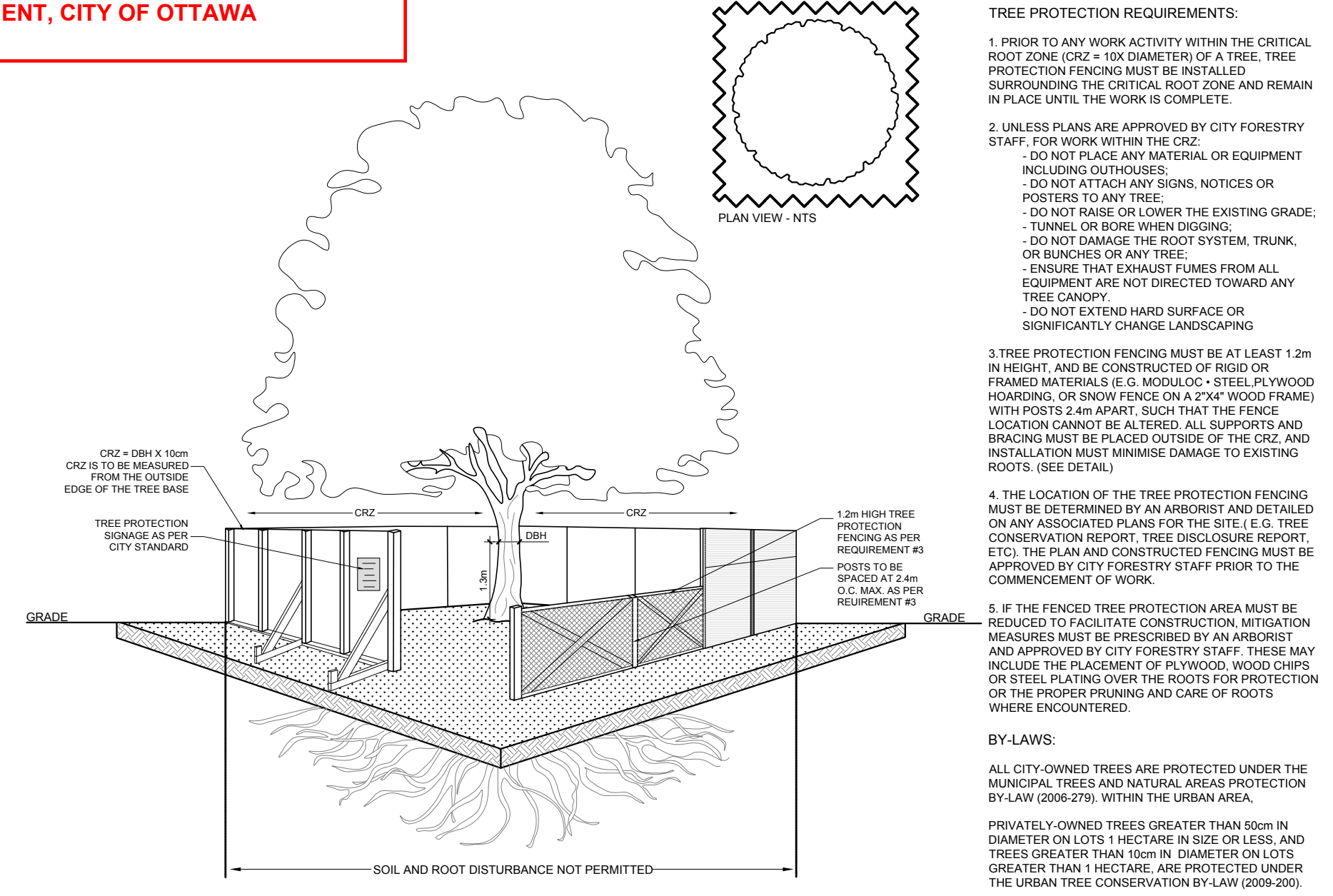
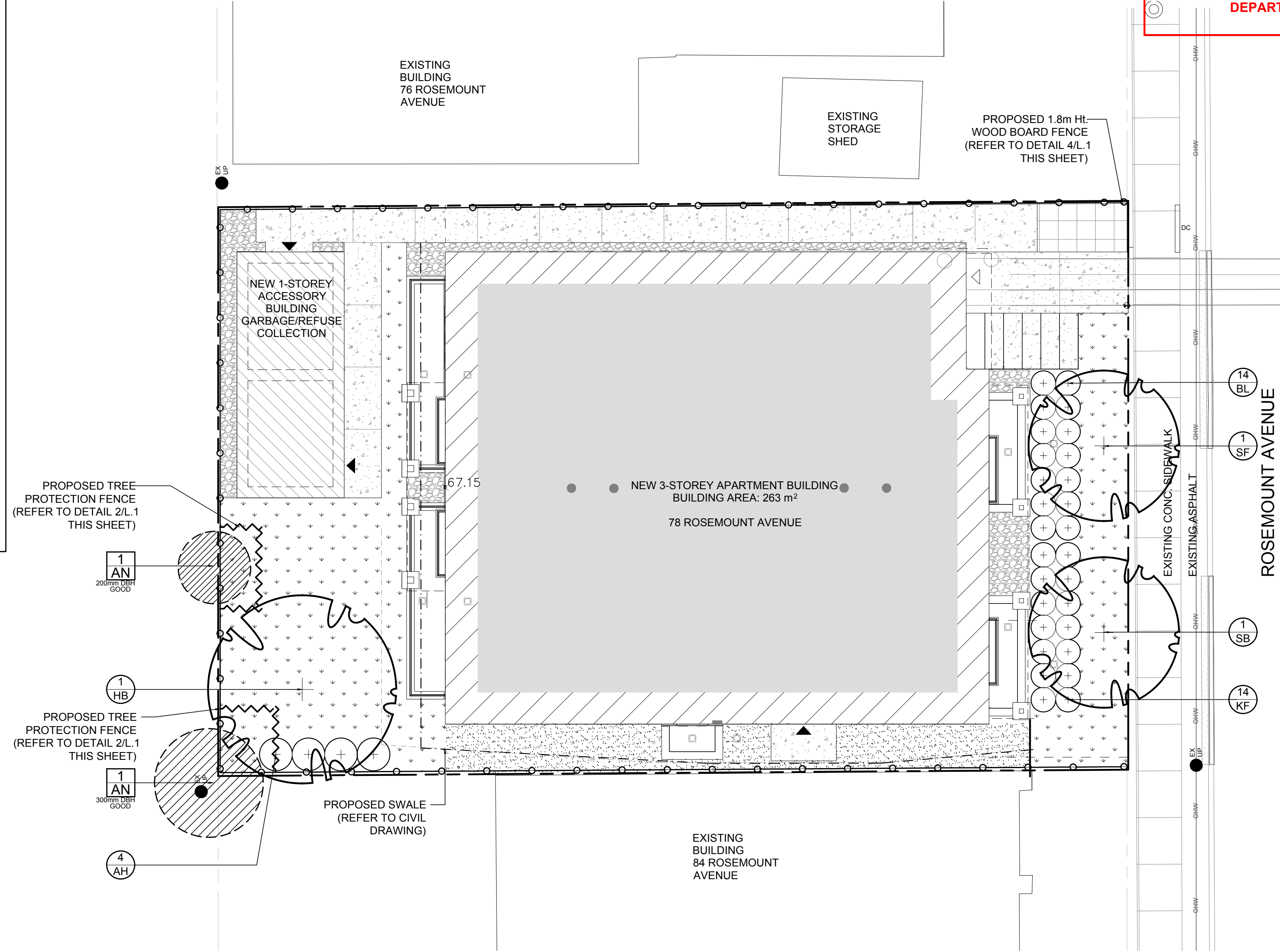

1 TREE CONSERVATION REPORT & LANDSCAPE PLAN
SCALE: 1:100

KEY	QTY	BOTANICAL NAME	COMMON NAME	SIZE	CONDITION	REMARKS	OWNERSHIP
AN	2	<i>Acer negundo</i>	Manitoba Maple	300-200mm DBH	GOOD	To remain	11 Beverley Avenue

KEY	QTY	BOTANICAL NAME	COMMON NAME	SIZE	CONDITION	REMARKS
TREES						
HB	1	<i>Celtis occidentalis</i>	Common Hackberry	60mm CAL.	B&B	
SB	1	<i>Amelanchier canadensis</i>	Serviceberry	60mm CAL.	B&B	Single leader
SF	1	<i>Amelanchier laevis</i> 'JSF-ARB'	Spring Flurry Serviceberry	60mm CAL.	B&B	Single leader
SHRUBS						
AH	4	<i>Hydrangea arborescens</i> 'Annabelle'	Annabelle Hydrangea	3 gallon pot	Potted	1000mm o.c.
ORNAMENTAL GRASSES						
BL	14	<i>Leymus arenarius</i> 'Blue Dune'	Blue Lyme Grass	250mm pot	Potted	800mm o.c.
KF	14	<i>Calamagrostis x acutiflora</i> 'Karl Foerster'	Feather Reed Grass	250mm pot	Potted	800mm o.c.

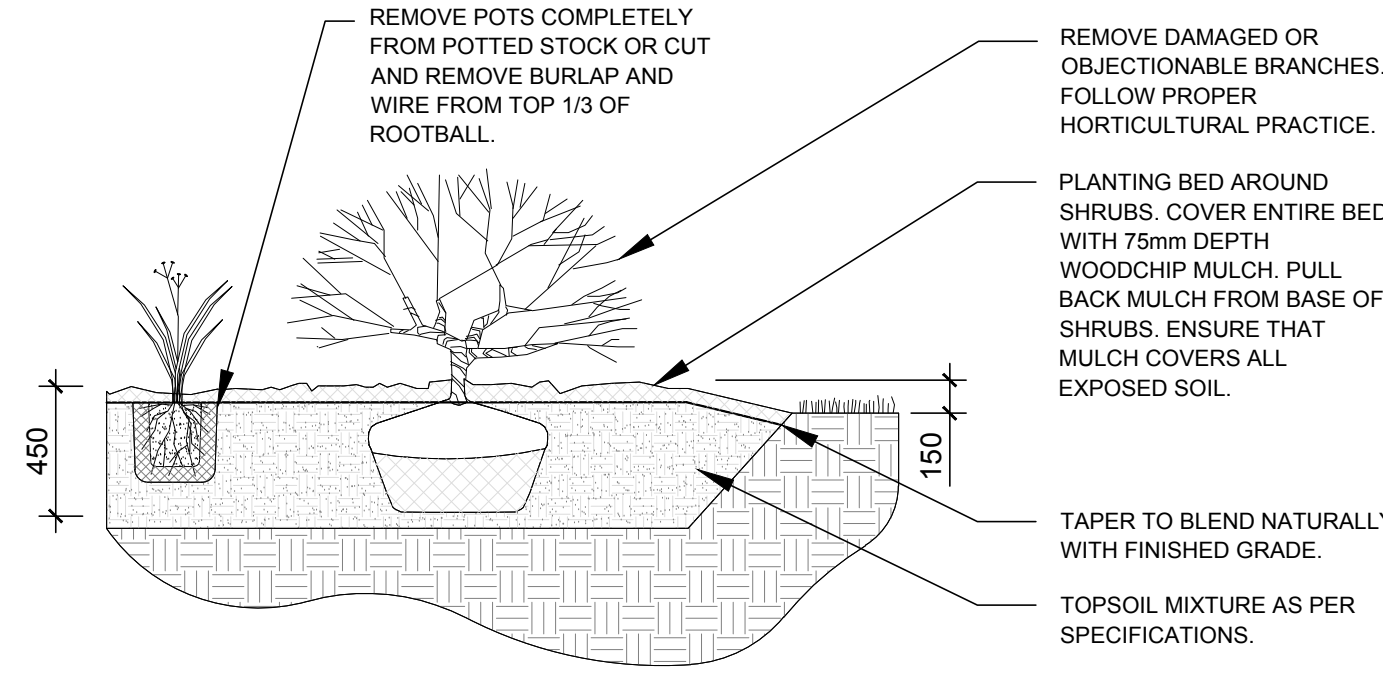

5 SHRUB / ORNAMENTAL GRASS PLANTING
SCALE: NTS

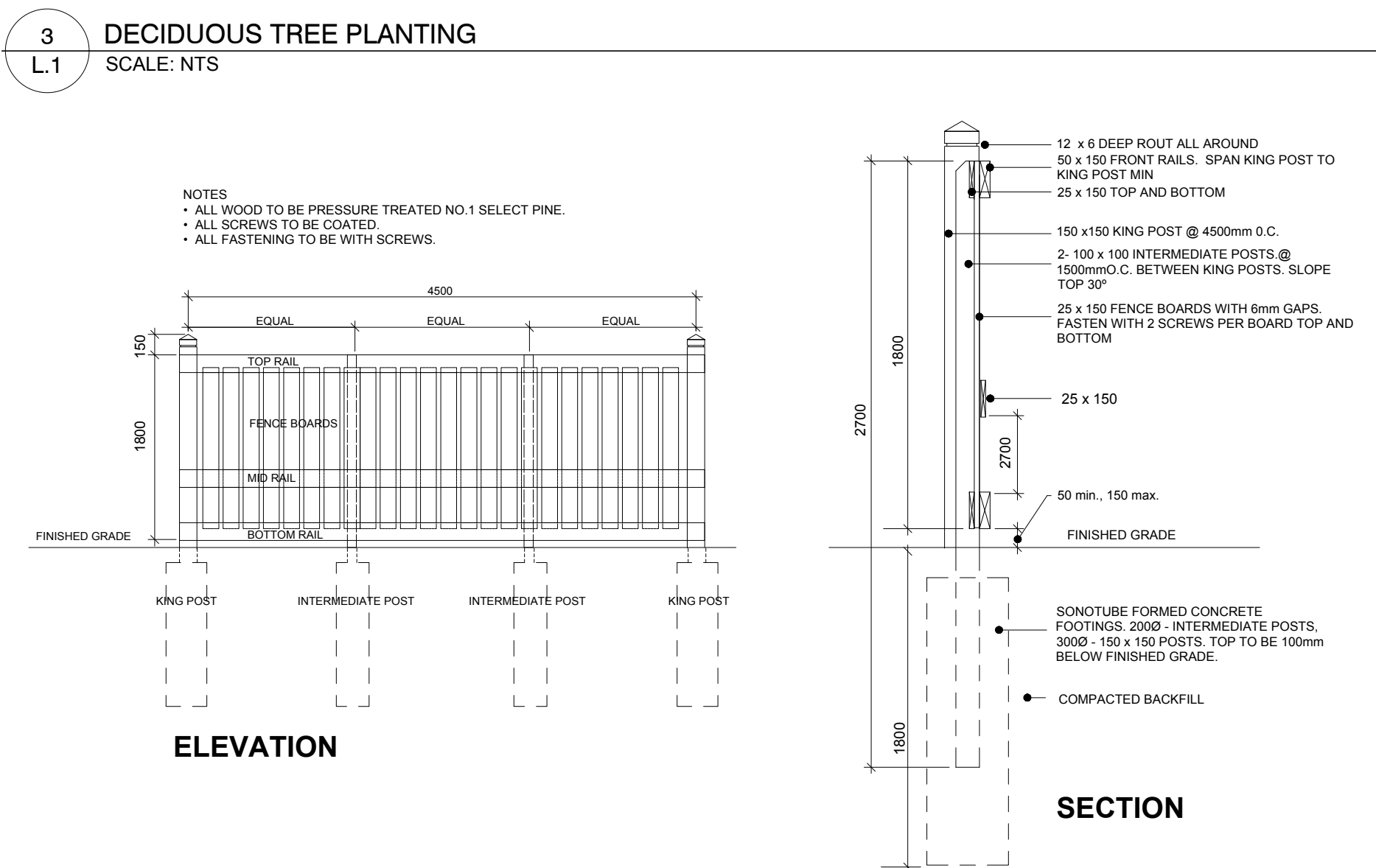

4 1.8m Ht. WOOD SCREEN FENCE
SCALE: NTS

CLIENT
78 ROSEMOUNT AVE INC.

CONSULTANTS
ARCHITECTS:
CSV ARCHITECTS
sustainable design · conception écologique
613.564.8118 190 O'Connor Street, Suite 100
www.csv.ca Ottawa, Ontario, K2P 2R3

CIVIL ENGINEERS:
CIVIL ENGINEER
McIntosh Perry
115 Walgreen Road, R.R. 3
Carp, ON K0A 1L0
613-936-2184
www.mcintoshperry.com

- LEGEND**
- PROPOSED DECIDUOUS TREE
 - PROPOSED SHRUBS / ORNAMENTAL GRASSES
 - PROPOSED CLOVER SEED
 - PROPOSED PEASTONE MULCH
 - PROPOSED RIVERSTONE MULCH
 - PROPOSED PRECAST CONCRETE PAVERS
 - PROPOSED CONCRETE SIDEWALK
 - EXISTING TREE TO REMAIN
 - TREE PROTECTION FENCE
 - PROPOSED 1.8m Ht. WOOD SCREEN FENCE

No.	Issue	Date	DR	CK
2	REVISED PER CITY COMMENTS	01/18/2023	ML	JL
1	ISSUED FOR SITE PLAN CONTROL	08/04/2022	ML	JL

JAMES B. LENNOX & ASSOCIATES INC.
LANDSCAPE ARCHITECTS
3312 CARLING AVE. OTTAWA, ONTARIO K2H 5A8
Tel. (613) 722-5168 Fax. (1866) 343-3942

PROJECT
PROPOSED THREE STOREY APARTMENT BUILDING
78 ROSEMOUNT AVENUE, OTTAWA ON

DRAWING
TREE CONSERVATION REPORT & LANDSCAPE PLAN

STAMP	SCALE
	AS SHOWN
	START DATE
	JULY 2022
	PROJECT NO.

PROJECT NORTH

DRAWING NO.
L.1

PLOT SIZE ARCH-D