

**INLET CONTROL DEVICE DATA TABLE: AREA A-5 (OUTLET PIPE OF STM MH 06)**

DESIGN EVENT	ICD TYPE (PLUG TYPE)	DIAMETER OF OUTLET PIPE (mm)	PEAK DESIGN FLOW (L/s)	PEAK DESIGN FLOW (L/s)	DESIGN HEAD (m)	WATER ELEVATION (m)	VOLUME (m <sup>3</sup> )	AVAILABLE STORAGE
1:2 YR	CIRCULAR	227mmØ	110.7	55.4	0.99	95.96	137	
1:5 YR	ORIFICE PLUG	375mmØ	141.1	70.6	1.61	96.58	191	> 675 m <sup>3</sup>
1:100 YR	ORIFICE PLUG	450mmØ	182.4	91.2	2.69	97.66	435	

**INLET CONTROL DEVICE DATA TABLE: AREA A-6 (OUTLET PIPE OF STM MH 11)**

DESIGN EVENT	ICD TYPE (PLUG TYPE)	DIAMETER OF OUTLET PIPE (mm)	PEAK DESIGN FLOW (L/s)	PEAK DESIGN FLOW (L/s)	DESIGN HEAD (m)	WATER ELEVATION (m)	VOLUME (m <sup>3</sup> )	AVAILABLE STORAGE
1:2 YR	TEMPEST	300mmØ	3.6	1.8	1.20	95.80	7	
1:5 YR	VORTEX LMF MODEL 60	300mmØ	4.7	2.4	2.15	96.75	9	39 m <sup>3</sup>
1:100 YR	VORTEX LMF MODEL 60	300mmØ	5.9	3.0	3.40	98.00	20	

THIS PLAN IS TO BE READ IN CONJUNCTION WITH CIVIL PLANS 119123-NLD AND 119123-GR1&GR2

NOTE:  
THE POSITION OF ALL POLE LINES, CONDUITS, WATERMANS, SEWERS AND OTHER UNDERGROUND AND OVERGROUND UTILITIES AND STRUCTURES IS NOT NECESSARILY SHOWN ON THE CONTRACT DRAWINGS, AND WHERE SHOWN, THE ACCURACY OF THE POSITION OF SUCH UTILITIES AND STRUCTURES IS NOT GUARANTEED. BEFORE STARTING WORK, DETERMINE THE EXACT LOCATION OF ALL SUCH UTILITIES AND STRUCTURES AND ASSUME ALL LIABILITY FOR DAMAGE TO THEM.

No.	REVISION	DATE	BY
2	REVISED PER CITY COMMENTS	OCT 6/23	DDB
1	ISSUED FOR CITY OF OTTAWA REVIEW	MAY 3/23	DDB

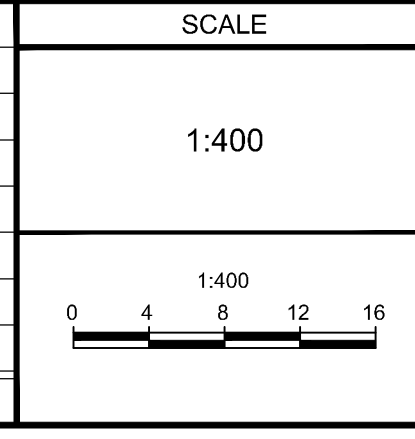

DESIGN	SM / BM / DDB
CHECKED	DDB
DRAWN	SM
CHECKED	BM / DDB
APPROVED	DDB

**FOR REVIEW ONLY**

PROFESSIONAL ENGINEER  
D. D. BLAIR  
100122737  
P. 6  
10003  
PROVINCE OF ONTARIO

**NOVATECH**  
Engineers, Planners & Landscape Architects  
Suite 200, 240 Michael Cowpland Drive  
Ottawa, Ontario, Canada K2M 1P6  
Telephone (613) 254-9643  
Facsimile (613) 254-5867  
Website www.novatech-eng.com

LOCATION  
CITY OF OTTAWA  
480 & 486 CITIGATE DRIVE - PROPOSED WAREHOUSES

DRAWING NAME  
GENERAL PLAN OF SERVICES

PROJECT No. 119123  
REV # 2  
DRAWING No. 119123-GP1

D07-12-23-0064

plan #

BUILDING 'A' ROOF DRAIN TABLE: AREA R-1 (ROOF DRAINS A1 to A25)						
AREA ID	ROOF DRAIN NO. (WATTS MODEL)	ROOF DRAIN OPENING SETTING	1.5 YEAR RELEASE RATE	APPROX. 5-YR PONDING DEPTH	1-100 YEAR RELEASE RATE	APPROX. 100-YR PONDING DEPTH
R-1	RD 1 (RD-100-A-ADJ)	3/4 EXPOSED	1.26 L/s	11 cm	1.34 L/s	13 cm
R-1	RD 2 (RD-100-A-ADJ)	3/4 EXPOSED	1.26 L/s	11 cm	1.34 L/s	14 cm
R-1	RD 3 (RD-100-A-ADJ)	3/4 EXPOSED	1.26 L/s	11 cm	1.34 L/s	14 cm
R-1	RD 4 (RD-100-A-ADJ)	3/4 EXPOSED	1.26 L/s	11 cm	1.34 L/s	14 cm
R-1	RD 5 (RD-100-A-ADJ)	3/4 EXPOSED	1.26 L/s	11 cm	1.34 L/s	14 cm
R-1	RD 6 (RD-100-A-ADJ)	3/4 EXPOSED	1.26 L/s	11 cm	1.34 L/s	14 cm
R-1	RD 7 (RD-100-A-ADJ)	3/4 EXPOSED	1.26 L/s	11 cm	1.34 L/s	14 cm
R-1	RD 8 (RD-100-A-ADJ)	1/4 EXPOSED	0.79 L/s	11 cm	0.95 L/s	14 cm
R-1	RD 9 (RD-100-A-ADJ)	1/4 EXPOSED	0.79 L/s	11 cm	0.95 L/s	14 cm
R-1	RD 10 (RD-100-A-ADJ)	1/4 EXPOSED	0.79 L/s	11 cm	0.95 L/s	14 cm
R-1	RD 11 (RD-100-A-ADJ)	1/4 EXPOSED	0.79 L/s	11 cm	0.95 L/s	14 cm
R-1	RD 12 (RD-100-A-ADJ)	1/4 EXPOSED	0.79 L/s	11 cm	0.95 L/s	14 cm
R-1	RD 13 (RD-100-A-ADJ)	1/4 EXPOSED	0.79 L/s	11 cm	0.95 L/s	14 cm
R-1	RD 14 (RD-100-A-ADJ)	1/4 EXPOSED	0.79 L/s	11 cm	0.95 L/s	14 cm
R-1	RD 15 (RD-100-A-ADJ)	1/4 EXPOSED	0.79 L/s	11 cm	0.95 L/s	14 cm
R-1	RD 16 (RD-100-A-ADJ)	1/4 EXPOSED	0.79 L/s	11 cm	0.95 L/s	14 cm
R-1	RD 17 (RD-100-A-ADJ)	1/4 EXPOSED	0.79 L/s	11 cm	0.95 L/s	14 cm
R-1	RD 18 (RD-100-A-ADJ)	1/4 EXPOSED	0.79 L/s	11 cm	0.95 L/s	15 cm
R-1	RD 19 (RD-100-A-ADJ)	1/4 EXPOSED	0.79 L/s	11 cm	0.95 L/s	15 cm
R-1	RD 20 (RD-100-A-ADJ)	FULLY EXPOSED	1.34 L/s	11 cm	1.89 L/s	14 cm
R-1	RD 21 (RD-100-A-ADJ)	3/4 EXPOSED	1.34 L/s	11 cm	1.58 L/s	15 cm
R-1	RD 22 (RD-100-A-ADJ)	3/4 EXPOSED	1.34 L/s	11 cm	1.58 L/s	15 cm
R-1	RD 23 (RD-100-A-ADJ)	3/4 EXPOSED	1.34 L/s	11 cm	1.58 L/s	15 cm
R-1	RD 24 (RD-100-A-ADJ)	3/4 EXPOSED	1.34 L/s	11 cm	1.58 L/s	15 cm
R-1	RD 25 (RD-100-A-ADJ)	FULLY EXPOSED	1.34 L/s	11 cm	1.89 L/s	14 cm

BUILDING 'B' ROOF DRAIN TABLE: AREA R-2 (ROOF DRAINS B1 to B25)						
AREA ID	ROOF DRAIN NO. (WATTS MODEL)	ROOF DRAIN OPENING SETTING	1.5 YEAR RELEASE RATE	APPROX. 5-YR PONDING DEPTH	1-100 YEAR RELEASE RATE	APPROX. 100-YR PONDING DEPTH
R-2	RD 1 (RD-100-A-ADJ)	FULLY EXPOSED	1.34 L/s	11 cm	1.89 L/s	14 cm
R-2	RD 2 (RD-100-A-ADJ)	3/4 EXPOSED	1.34 L/s	11 cm	1.58 L/s	15 cm
R-2	RD 3 (RD-100-A-ADJ)	3/4 EXPOSED	1.34 L/s	11 cm	1.58 L/s	15 cm
R-2	RD 4 (RD-100-A-ADJ)	3/4 EXPOSED	1.34 L/s	11 cm	1.58 L/s	15 cm
R-2	RD 5 (RD-100-A-ADJ)	3/4 EXPOSED	1.34 L/s	11 cm	1.58 L/s	15 cm
R-2	RD 6 (RD-100-A-ADJ)	FULLY EXPOSED	1.34 L/s	11 cm	1.89 L/s	14 cm
R-2	RD 7 (RD-100-A-ADJ)	1/4 EXPOSED	0.79 L/s	11 cm	0.95 L/s	14 cm
R-2	RD 8 (RD-100-A-ADJ)	1/4 EXPOSED	0.79 L/s	11 cm	0.95 L/s	14 cm
R-2	RD 9 (RD-100-A-ADJ)	1/4 EXPOSED	0.79 L/s	11 cm	0.95 L/s	14 cm
R-2	RD 10 (RD-100-A-ADJ)	1/4 EXPOSED	0.79 L/s	11 cm	0.95 L/s	14 cm
R-2	RD 11 (RD-100-A-ADJ)	1/4 EXPOSED	0.79 L/s	11 cm	0.95 L/s	14 cm
R-2	RD 12 (RD-100-A-ADJ)	1/4 EXPOSED	0.79 L/s	11 cm	0.95 L/s	14 cm
R-2	RD 13 (RD-100-A-ADJ)	1/4 EXPOSED	0.79 L/s	11 cm	0.95 L/s	14 cm
R-2	RD 14 (RD-100-A-ADJ)	1/4 EXPOSED	0.79 L/s	11 cm	0.95 L/s	14 cm
R-2	RD 15 (RD-100-A-ADJ)	1/4 EXPOSED	0.79 L/s	11 cm	0.95 L/s	14 cm
R-2	RD 16 (RD-100-A-ADJ)	1/4 EXPOSED	0.79 L/s	11 cm	0.95 L/s	14 cm
R-2	RD 17 (RD-100-A-ADJ)	1/4 EXPOSED	0.79 L/s	11 cm	0.95 L/s	15 cm
R-2	RD 18 (RD-100-A-ADJ)	1/4 EXPOSED	0.79 L/s	11 cm	0.95 L/s	15 cm
R-2	RD 19 (RD-100-A-ADJ)	3/4 EXPOSED	1.26 L/s	11 cm	1.34 L/s	14 cm
R-2	RD 20 (RD-100-A-ADJ)	3/4 EXPOSED	1.34 L/s	11 cm	1.58 L/s	14 cm
R-2	RD 21 (RD-100-A-ADJ)	3/4 EXPOSED	1.34 L/s	11 cm	1.58 L/s	14 cm
R-2	RD 22 (RD-100-A-ADJ)	3/4 EXPOSED	1.34 L/s	11 cm	1.58 L/s	14 cm
R-2	RD 23 (RD-100-A-ADJ)	3/4 EXPOSED	1.34 L/s	11 cm	1.58 L/s	14 cm
R-2	RD 24 (RD-100-A-ADJ)	3/4 EXPOSED	1.26 L/s	11 cm	1.34 L/s	14 cm
R-2	RD 25 (RD-100-A-ADJ)	FULLY EXPOSED	1.34 L/s	11 cm	1.58 L/s	13 cm

CRITICAL SEWER PIPE CROSSING TABLE				
CROSSING	LOWER PIPE	HIGHER PIPE	CLEARANCE	SURFACE ELEVATION
①	200mmØ TWM=96.74	250mmØ SAN INV=97.04	± 0.3m	99.27 m
②	375mmØ STM OBV=95.97	200mmØ USWM=96.55	± 0.6m	99.29 m
③	375mmØ STM OBV=96.13	250mmØ SAN INV=97.65	± 1.5m	99.62 m
④	375mmØ STM OBV=96.17	200mmØ US WM=97.11	± 0.9m	99.71 m
⑤	200mmØ TFL=97.10	200mmØ US WM=97.40	± 0.3m	100.00 m
⑥	200mmØ TFL=95.90	375mmØ STM INV=96.42	± 0.6m	98.05 m
⑦	200mmØ TFL=94.34	1200mmØ STM INV=94.99	± 0.5m	98.15 m
⑧	200mmØ TWM=94.49	375mmØ STM INV=94.99	± 0.5m	97.68 m

THIS PLAN IS TO BE READ IN CONJUNCTION WITH CIVIL PLANS 119123-NLD AND 119123-GR1&GR2

\* REFER TO THE 'DEVELOPMENT SERVICING STUDY AND STORMWATER MANAGEMENT REPORT' (R-2023-069) PREPARED BY NOVATECH FOR DRAINAGE AREA IDENTIFIERS AND STORMWATER MANAGEMENT DETAILS.  
\*\* ALL CONTROLLED FLOW ROOF DRAINS FOR THE PROPOSED BUILDINGS TO BE WATTS 'ADJUSTABLE ACCUTROL' ROOF DRAINS.

\* REFER TO THE 'DEVELOPMENT SERVICING STUDY AND STORMWATER MANAGEMENT REPORT' (R-2023-069) PREPARED BY NOVATECH FOR DRAINAGE AREA IDENTIFIERS AND STORMWATER MANAGEMENT DETAILS.  
\*\* ALL CONTROLLED FLOW ROOF DRAINS FOR THE PROPOSED BUILDINGS TO BE WATTS 'ADJUSTABLE ACCUTROL' ROOF DRAINS.

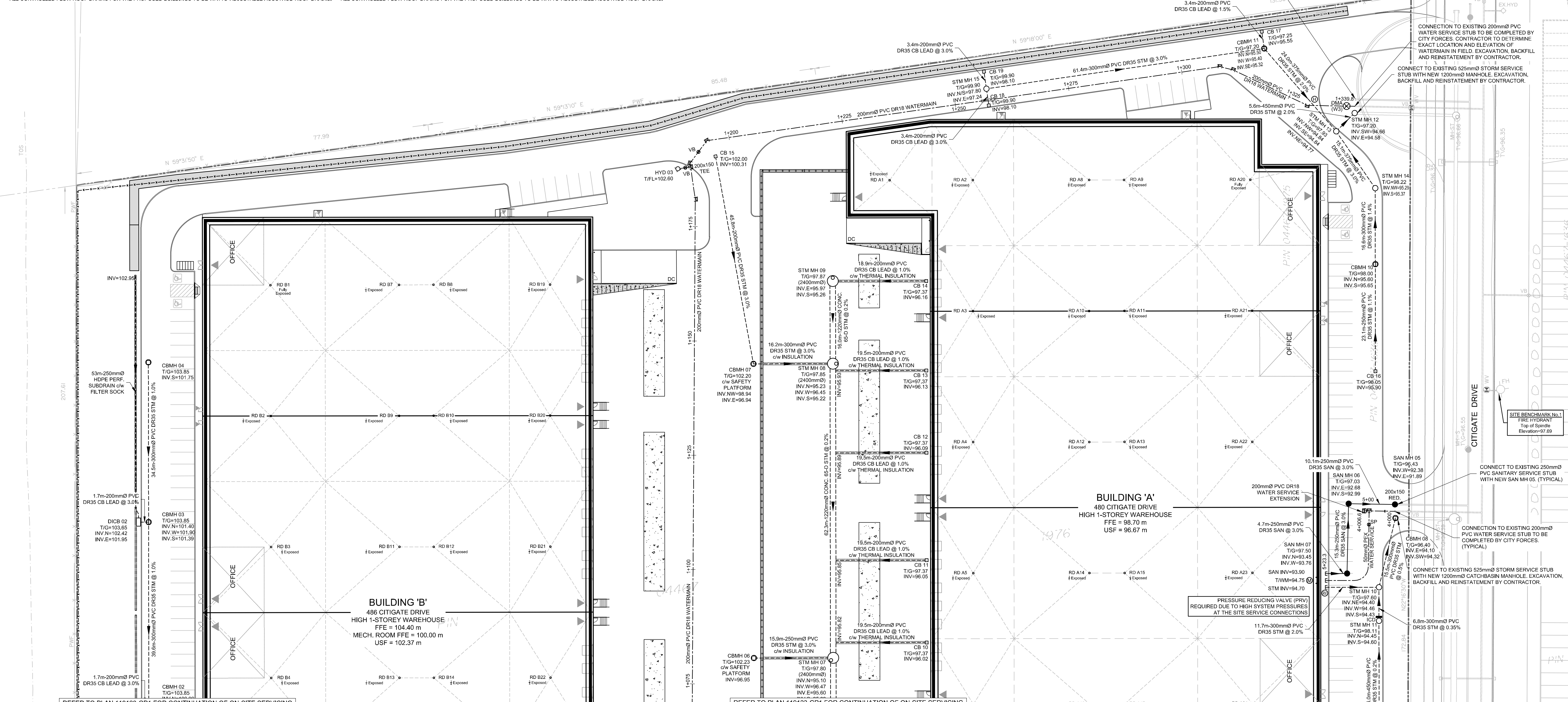

NOTE: THE POSITION OF ALL POLE LINES, CONDUITS, WATERMANS, SEWERS AND OTHER UNDERGROUND AND OVERGROUND UTILITIES AND STRUCTURES IS NOT NECESSARILY SHOWN ON THE CONTRACT DRAWINGS, AND WHERE SHOWN, THE ACCURACY OF THE POSITION OF SUCH UTILITIES AND STRUCTURES IS NOT GUARANTEED. BEFORE STARTING WORK, DETERMINE THE EXACT LOCATION OF ALL SUCH UTILITIES AND STRUCTURES AND ASSUME ALL LIABILITY FOR DAMAGE TO THEM.

REFER TO PLAN 119123-GP1 FOR CONTINUATION OF ON-SITE SERVICING

REFER TO PLAN 119123-GP1 FOR CONTINUATION OF ON-SITE SERVICING

No.	REVISION	DATE	BY
2	REVISED PER CITY COMMENTS	OCT 6/23	DDB
1	ISSUED FOR CITY OF OTTAWA REVIEW	MAY 3/23	DDB

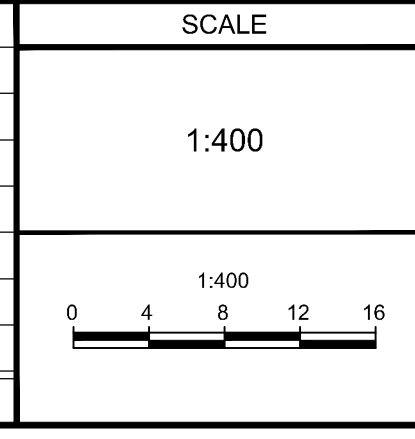

SCALE: 1:400

DESIGN: SM / BM / DDB  
CHECKED: DDB  
DRAWN: SM  
CHECKED: BM / DDB  
APPROVED: DDB

FOR REVIEW ONLY

PROFESSIONAL ENGINEER  
D. D. BLAIR  
100122737  
PROVINCE OF ONTARIO

**NOVATECH**  
Engineers, Planners & Landscape Architects  
Suite 200, 240 Michael Cowpland Drive  
Ottawa, Ontario, Canada K2M 1P6  
Telephone: (613) 254-9643  
Facsimile: (613) 254-5867  
Website: www.novatech-eng.com

LOCATION: CITY OF OTTAWA  
480 & 486 CITIGATE DRIVE - PROPOSED WAREHOUSES

DRAWING NAME: GENERAL PLAN OF SERVICES

PROJECT No.: 119123  
REV # 2  
DRAWING No.: 119123-GP2

D07-12-23-0064