

NOTE:
A GEOTECHNICAL ENGINEER LICENSED IN THE PROVINCE OF ONTARIO IS TO INSPECT ALL SUBGRADE SURFACES FOR FOOTING AND PAVEMENT STRUCTURES PRIOR TO CONSTRUCTION

NOTE:
ALL EXISTING POST & WIRE FENCE, CULVERTS, UTILITY WIRE / POLES, TREES, SHRUBS ETC. WITHIN LOTS, BLOCKS AND ROADS TO BE REMOVED, UNLESS OTHERWISE NOTED

NOTE RE: PERFORATED PIPE
PERFORATED PIPE IS REQUIRED FOR SWALE SLOPE LESS THAN 1.5%. REFER TO CITY STD. S29, S30 FOR REAR YARD TRENCH AND PIPE DETAIL ONLY

NOTE:
ALL SWALES SHALL BE 0.15m DEEP WITH 3:1 SIDE SLOPES UNLESS OTHERWISE INDICATED

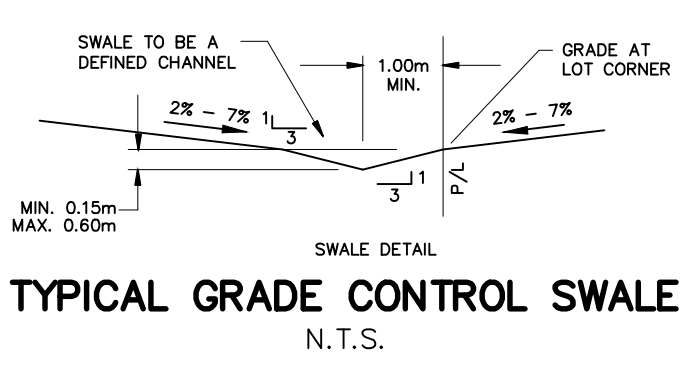

ANY DISTURBED AREA DURING CONSTRUCTION TO BE RESTORED TO THE ORIGINAL CONDITION OR BETTER TO THE SATISFACTION OF THE AUTHORITIES HAVING JURISDICTION

CONTRACTOR TO VERIFY THE PRECISE LOCATIONS AND INVERT ELEVATIONS OF EX. UNDERGROUND SERVICES AND EX. UTILITIES PRIOR TO STARTING CONSTRUCTION

PERMISSION REQUIRED FOR WORK ON ADJACENT LANDS

NOTE:
ENTRANCES TO PRIVATE SITE PER SC7.1

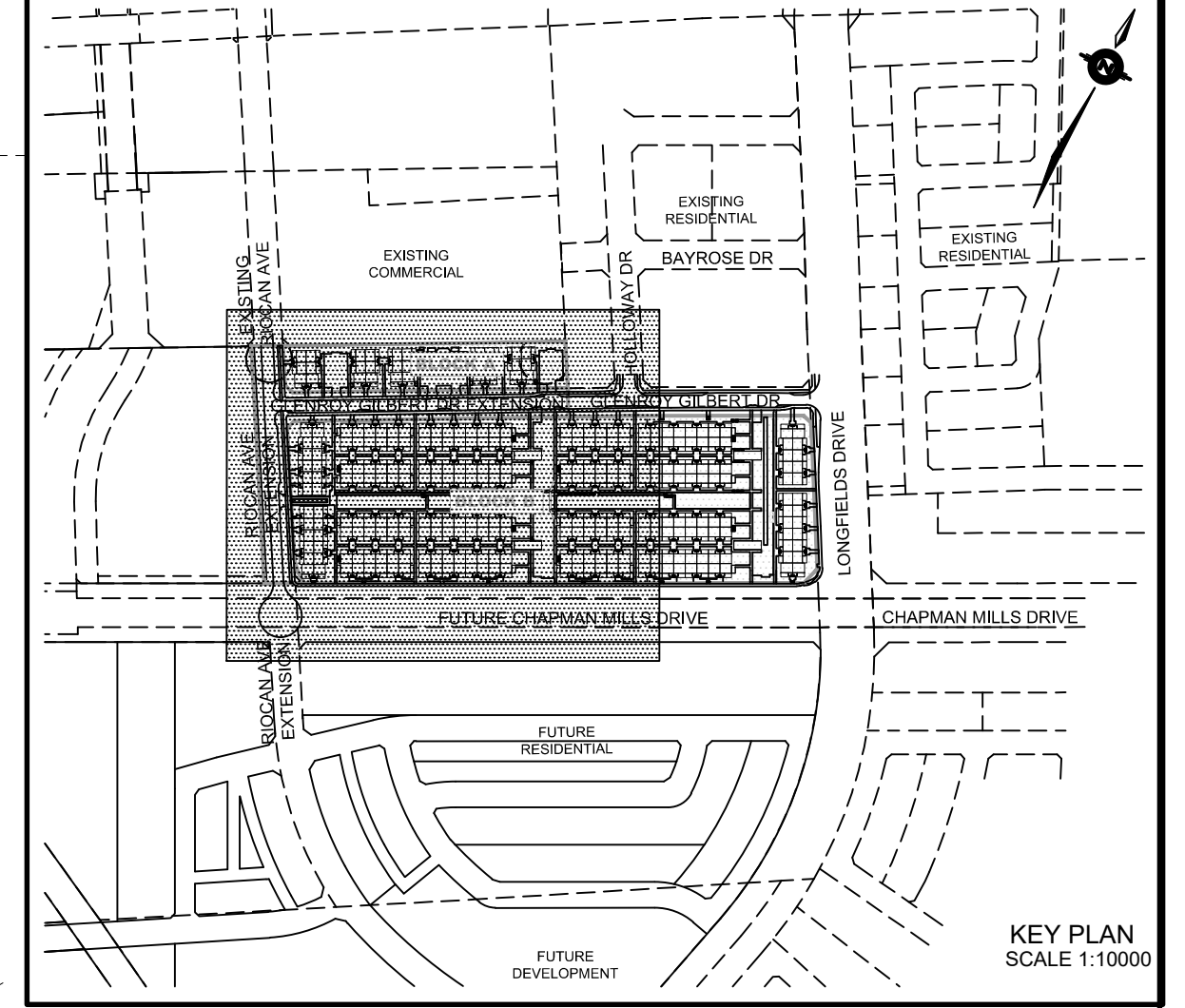

LEGEND

| | | | |
|--|---------|--|----------|
| PROPOSED ELEVATION | 103.45 | OVERLAND FLOW DIRECTION | → |
| EXISTING ELEVATION | 102.73 | EXTERNAL OVERLAND FLOW DIRECTION | → |
| FUTURE ELEVATION | [93.90] | EMERGENCY OVERLAND FLOW DIRECTION | → |
| PROPOSED SWALE GRADE | 1.5% | TOP OF WALL ELEVATION | 103.10 T |
| HIGH POINT | 102.16 | BOTTOM OF WALL ELEVATION | 102.44 B |
| STREET CATCHBASIN | ○ | CHAINLINK FENCE (1.5m UNLESS OTHERWISE NOTED) | — |
| STREET CATCHBASIN WITH CLOSED LID | ○ | NOISE BARRIER (3.0m UNLESS OTHERWISE NOTED) | — |
| CATCHBASIN MANHOLE | ○ | VALVE & VC | ○ |
| TEE CATCHBASIN | ○ | VALVE & VB | ○ |
| ELBOW CATCHBASIN | ○ | BUILDING ENVELOPE | — |
| HYDRANT, VALVE & VB | ○ | TOP OF FOUNDATION (TOF) | — |
| HYDRANT, VALVE & VC | ○ | FINISHED FLOOR ELEVATION (FFE) | — |
| VALVE & VC | ○ | UNDERSIDE OF FOOTING ELEVATION (USF) | — |
| VALVE & VB | ○ | ELEVATION REQUIRING WATER PRESSURE REDUCING VALVES | — |
| ADJUST LID TO PROPOSED GRADE | ○ | WALKOUT UNITS | — |
| RELOCATE EX. CB AND ADJUST LID TO PROPOSED GRADE | ○ | SLAB ON GRADE | — |
| RELOCATE EX. CB AND ADJUST LID TO PROPOSED GRADE | ○ | LANDS MAX HYDRO SWITCHGEAR | — |
| RELOCATE EX. CB AND ADJUST LID TO PROPOSED GRADE | ○ | HYDRO TRANSFORMER | — |
| RELOCATE EX. CB AND ADJUST LID TO PROPOSED GRADE | ○ | STREET LIGHT STANDARD | — |
| RELOCATE EX. CB AND ADJUST LID TO PROPOSED GRADE | ○ | TACTILE WALKING SURFACE INDICATOR (AS PER CITY OF OTTAWA STD. SC6) | — |
| RELOCATE EX. CB AND ADJUST LID TO PROPOSED GRADE | ○ | PREVIOUS PHASES / PHASES NOT PART OF CURRENT GRADING APPROVAL | — |
| RELOCATE EX. CB AND ADJUST LID TO PROPOSED GRADE | ○ | | |

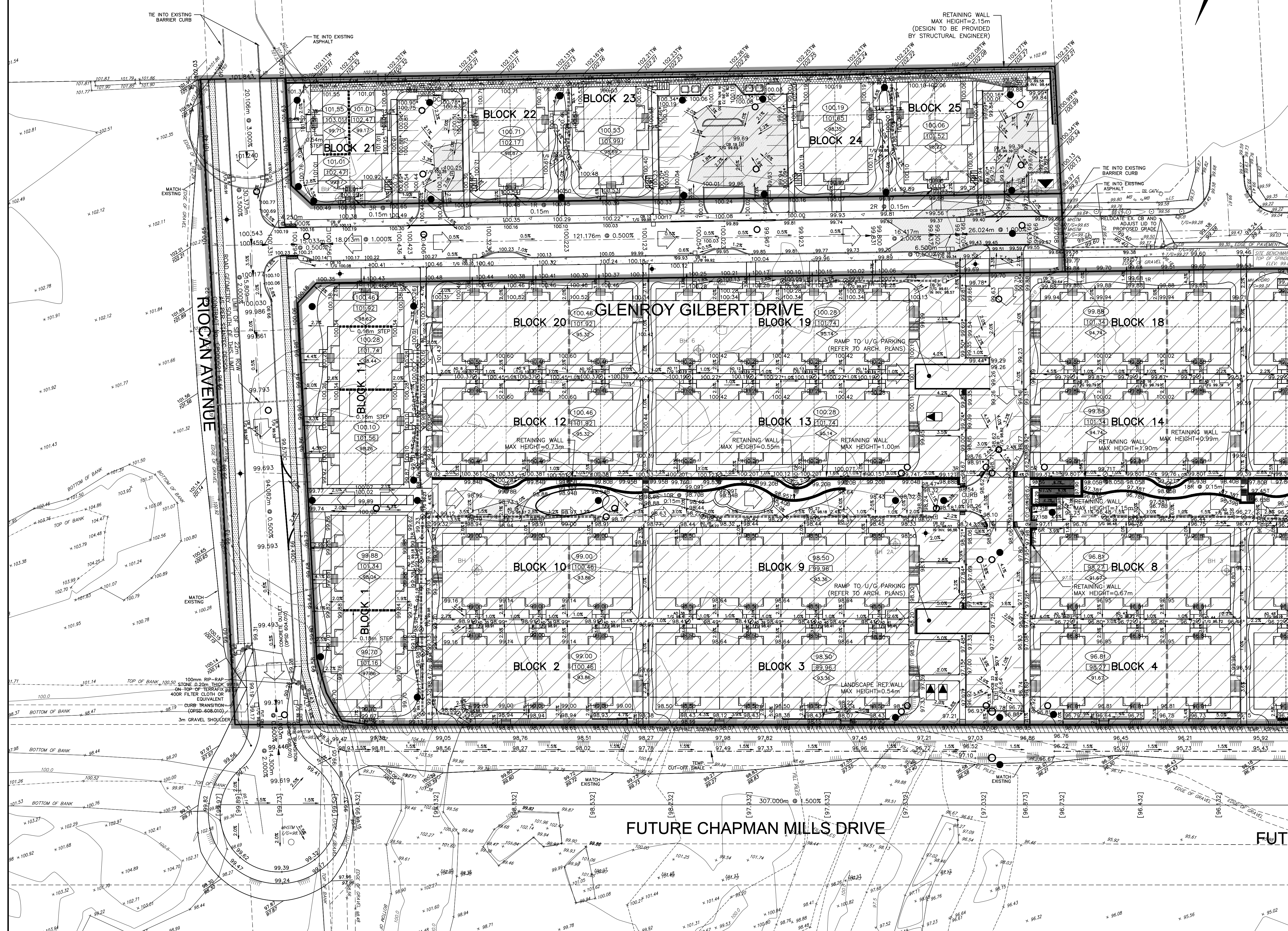

NOT FOR CONSTRUCTION

| No. | BY | DATE | DESCRIPTION |
|-----|--------|----------|-------------------|
| 6 | S.L.M. | 23-10-06 | ISSUED FOR TENDER |
| 5 | S.L.M. | 23-09-22 | ISSUED FOR TENDER |
| 4 | S.L.M. | 23-09-06 | ISSUED FOR TENDER |
| 3 | S.L.M. | 23-06-30 | 3RD SUBMISSION |

TOPOGRAPHIC INFORMATION
TOPOGRAPHIC INFORMATION PROVIDED BY STANTEC GEOMATICS LTD., PROJECT No. 161614291-111, DATED MARCH 1, 2022

SITE PLAN INFORMATION
SITE PLAN PROVIDED BY SRN ARCHITECTS LTD., PROJECT No. S21001, DATED OCTOBER 5, 2023

LEGAL INFORMATION
CALCULATED DRAFT PLAN PROVIDED BY STANTEC GEOMATICS LTD., PROJECT No. 161614291-131, DATED AUGUST 9, 2023

BENCH MARK
ELEVATIONS ARE REFERRED TO THE CANADIAN GEODETIC VERTICAL DATUM (CGVD-1928:1978) AND ARE DERIVED FROM BENCHMARK MONUMENT No. 196530071*, HAVING A PUBLISHED ELEVATION OF 99.742 METRES

MINTO COMMUNITIES INC.
BARRHAVEN TOWN CENTRE
GLENROY GILBERT DRIVE RIOCHAN AVENUE & CHAPMAN MILLS DRIVE EXTENSION

DSEL
120 Ber Road Unit 103
Slittsville, Ontario, K2S 1E9
Tel. (613) 836-0856
Fax. (613) 836-7183
www.DSEL.ca

PROFESSIONAL ENGINEER
S.L. MERRICK
10166523
1975-10-04
PROVINCE OF ONTARIO

Ottawa
110 Laurier Ave W
Ottawa, Ontario, K1P 1J1
Tel. (613) 580-2400
www.Ottawa.ca

CITY ROW GRADING PLAN WEST

| | | |
|-----------------|----------------|--------------------|
| DRAWN BY: AM | CHECKED BY: BC | PROJECT No. 15-816 |
| DESIGNED BY: BC | CHECKED BY: SM | SHEET No. 10 |
| SCALE: 1:500 | | |

CITY PLAN No. 18822
CITY FILE No. D07-12-22-0104