

1Door4Care - CHEO Integrated Treatment Centre: Parking Garage

ISSUED FOR SPC RESUBMISSION
2023-09-18

VOLUME 3 : LANDSCAPE



© 2023 Montgomery Sisam Architects Inc.
All rights reserved. No part of this document may
be reproduced, stored in a retrieval system, or
transmitted in any form or by any means
without prior written permission from
Montgomery Sisam Architects Inc.
2023-08-11 8:49:41 PM



*REFER TO EACH VOLUME FOR SHEET LIST OF RESPECTIVE DISCIPLINE

SHEET LIST - LANDSCAPE ARCHITECTURAL	
Sheet Number	Sheet Name
LP0000	SHEET LIST
LP0100	ENTIRE LANDSCAPE AND KEY PLAN
LP0110	EXISTING CONDITIONS AND REMOVAL PLAN AT NORTH SIDE OF PARKADE
LP0120	PARKADE TREE PRESERVATION & REMOVAL PLAN
LP0130	PARKADE LANDSCAPE UTILITY PLAN
LP0140	PARKADE LANDSCAPE PLAN
LP0150	LANDSCAPE DETAILS



1Door4Care



PROJECT NORTH (PN)

KEYPLAN

#	date	revision
5	2023-09-18	ISSUED FOR SPC RESUBMISSION IW
4	2023-08-31	ISSUED FOR VON DO SUBMISSION IW
3	2023-08-16	ISSUED FOR SPC APPLICATION IW
2	2023-07-31	ISSUED FOR VON DO SUBMISSION IW
1	2023-04-20	ISSUED FOR TECHNICAL SUBMISSION IW

date revision

revisions



All drawing and specifications are the property of the architect. The contractor shall verify all dimensions and information on site and report any discrepancy to architect before proceeding.

1Door4Care CHEO Integrated Treatment Centre

401 Smyth Rd
Ottawa, ON K1H 8L1

SHEET LIST

scale:
 drawn by: IWRM
 reviewed by: VK
 job number: 2007
 plot date: 2023/09/18
 drawing number:

LP0000

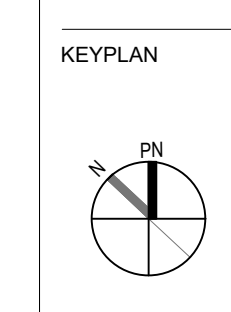

- LEGEND**
- PROPERTY LINE
 - LIMIT OF CONSTRUCTION LINE
 - CONCRETE PAVING
 - TINTED CONCRETE PAVING
 - ASPHALT
 - LINE PAINTING ON ASPHALT
 - TACTILE ATTENTION INDICATOR
 - TACTILE DIRECTIONAL INDICATOR
 - EXISTING DECIDUOUS TREE TO REMAIN
 - EXISTING CONIFEROUS TREE TO REMAIN
 - EXISTING VEGETATION TO REMAIN
 - EXISTING SOIL
 - SOIL
 - NATIVE SEED MIX
 - DECIDUOUS TREE
 - PERENNIALS & GROUNDCOVERS
 - MULTI-PURPOSE PATH SEE CIVIL
 - BENCH
 - CATCH BASIN REFER TO CIVIL
 - MANHOLE REFER TO CIVIL
 - FIRE HYDRANT REFER TO CIVIL
 - LIGHT POLES SEE ELEC.

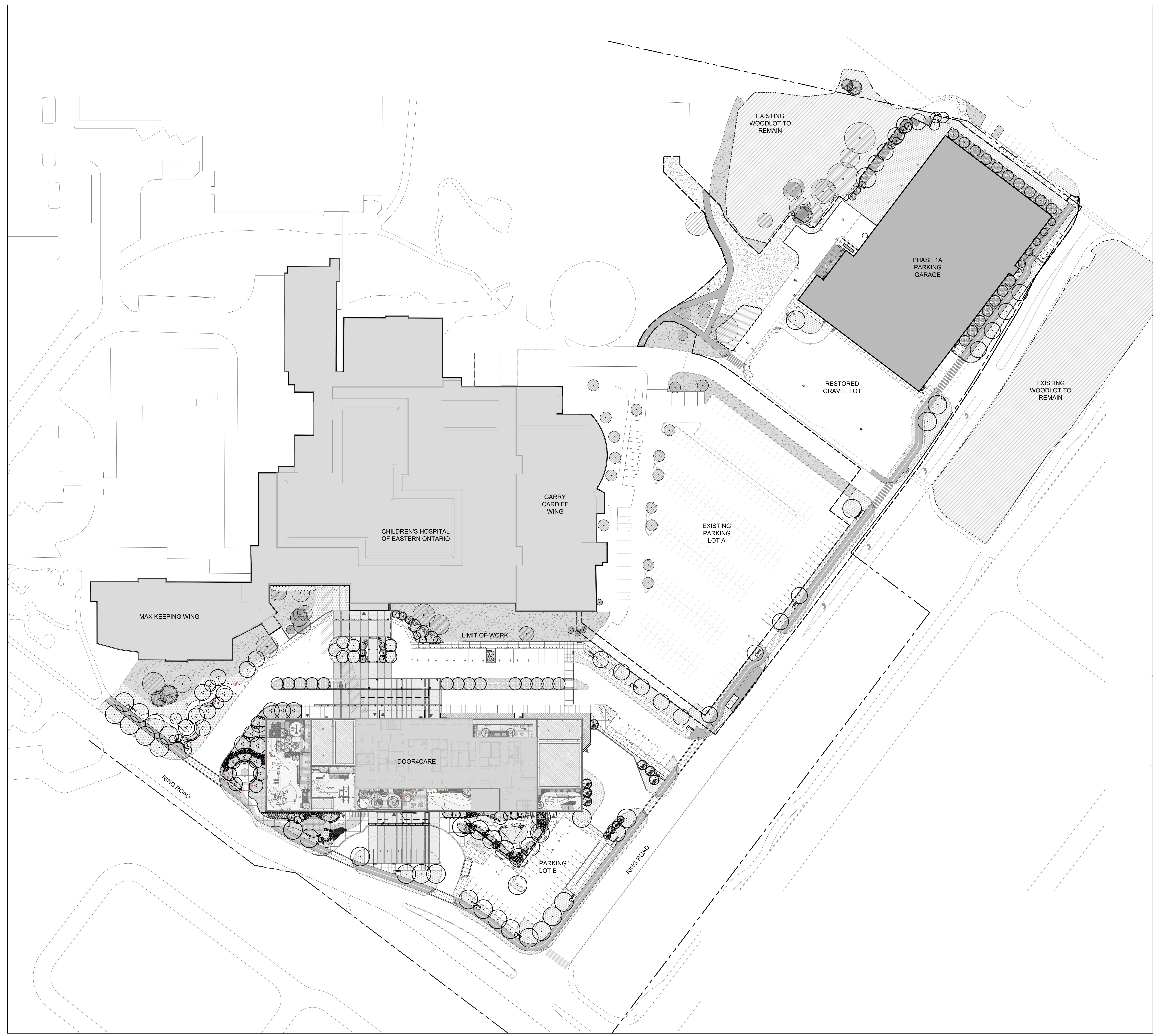

#	date	revision	by
5	2023-09-18	ISSUED FOR SPC RESUBMISSION	IW
4	2023-08-02	ISSUED FOR SPC RESPONSE	IW
3	2023-08-16	ISSUED FOR SPC APPLICATION	IW
2	2023-07-31	ISSUED FOR SPC SUBMISSION	IW
1	2023-04-20	ISSUED FOR TECHNICAL SUBMISSION	IW

date revision by

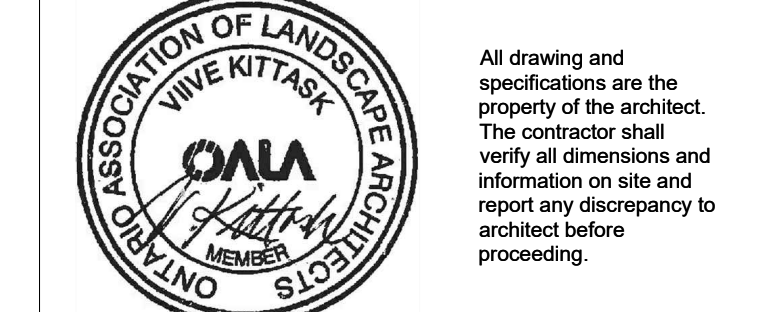

1Door4Care: CHEO Integrated Treatment Centre: Parking Garage

401 Smyth Rd, Ottawa, ON

OVERALL LANDSCAPE AND KEY PLAN

scale: 1:500
 drawn by: IW/RM
 reviewed by: VK
 job number: 2207
 plot date: 2023/09/18
 drawing number:

LP0100

KEYPLAN

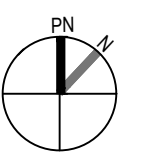

LEGEND

- PROPERTY LINE
- EXISTING SOD
- EXISTING DECIDUOUS TREE TO REMAIN
- EXISTING CONIFEROUS TREE TO REMAIN
- EXISTING DECIDUOUS TREE TO REMOVE
- EXISTING CONIFEROUS TREE TO REMOVE
- EXISTING VEGETATION TO REMAIN
- EXISTING TO BE REMOVED
- EXISTING ASPHALT PAVING TO BE REPAIRED
- TREE PROTECTION HOARDING

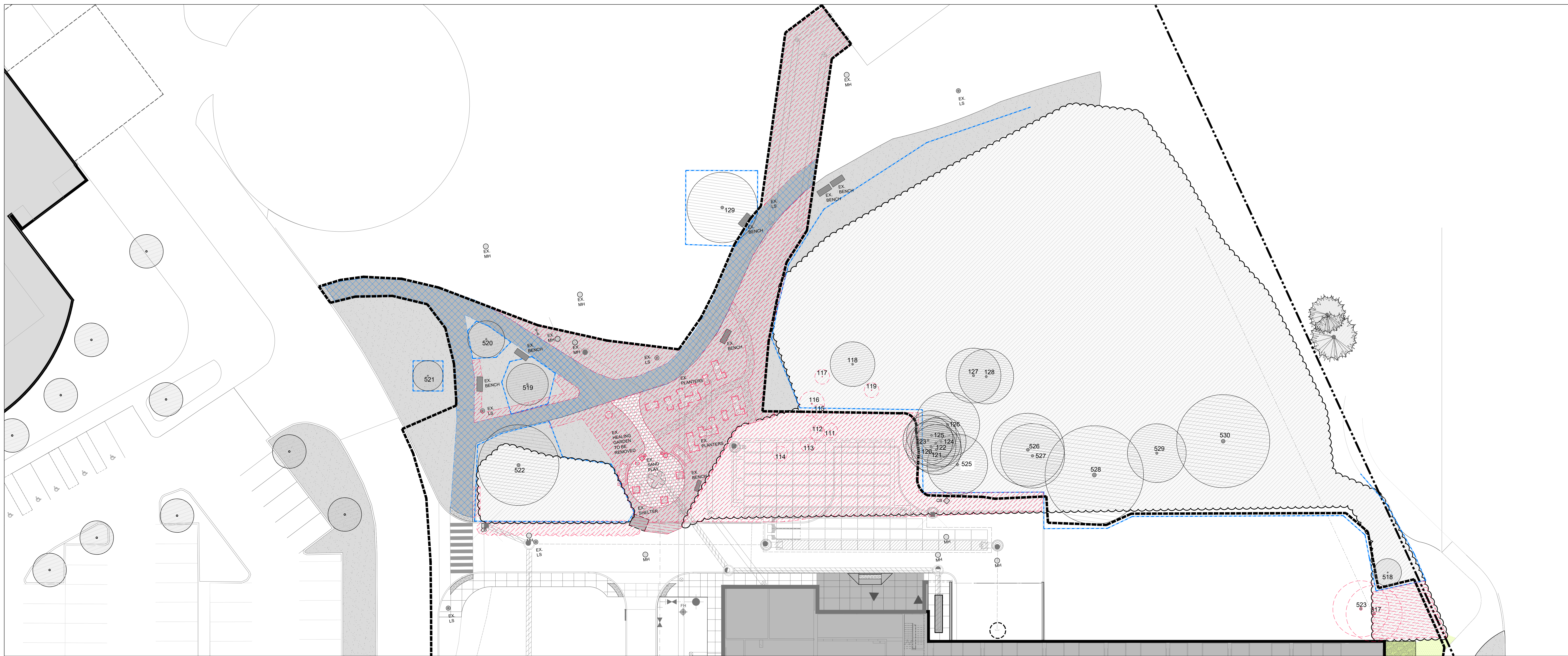

L1
PROVIDE EXISTING CONDITIONS AND REMOVALS PLAN AT NORTH SIDE OF PARKADE
PLAN VIEW

SCALE 1:200

- NOTES:
1. EXISTING HEALING GARDEN IS TO BE REMOVED. CLIENT TO PROVIDE LIST OF ANY COMPONENTS TO BE RETAINED. CHEO TO PROVIDE LOCATION FOR ITEMS TO BE STOCKPILED, IF REQUIRED.
 2. CONTRACTOR TO REGRADE AREA OF DISTURBANCE AND INSTALL TOPSOIL AND NATIVE SEED MIX.
 3. CONTRACTOR TO MINIMIZE DISTURBANCE OF EXISTING TREES AND WOODLOT.
 4. ANY EXCAVATION NEAR TREE PROTECTION ZONES OF EXISTING TREES IS TO BE REVIEWED BY ARBORIST.

#	date	revision	by
6	2023-09-21	ISSUED FOR 100% DD RESUBMISSION	IW
5	2023-09-18	ISSUED FOR SPC RESUBMISSION	IW
4	2023-08-31	ISSUED FOR 100% DD SUBMISSION	IW
3	2023-08-22	ISSUED FOR 95% DD SUBMISSION RESPONSE	IW
2	2023-07-31	ISSUED FOR 95% DD SUBMISSION	IW
1	2023-04-20	ISSUED FOR TECHNICAL SUBMISSION	IW

PROFESSIONAL LANDSCAPE ARCHITECT
ONTARIO
DATA
REGISTERED PROFESSIONAL
LANDSCAPE ARCHITECT

All drawing and specifications are the property of the architect. The contractor shall verify all dimensions and information on site and report any discrepancy to architect before proceeding.

1Door4Care: CHEO Integrated Treatment Centre: Parking Garage

401 Smyth Rd, Ottawa, ON

EXISTING CONDITIONS AND REMOVALS PLAN

scale: 1:200
drawn by: IW/RM
reviewed by: VK
job number: 2207
plot date: 2023/08/18
drawing number:

LP0101E



Key	Qty	Botanical Name	Common Name	Cal.	Spnd.	Hgt.	Root	Remarks
TYPICAL PARKING GARAGE PLANT LIST								
TREES								
Ar	1	Acer rubrum	Red Maple	80		8-8		Native
As	6	Acer saccharum	Sugar Maple	80		8-8		Native
Cb	5	Carpinus betulus 'twilight'	Pyramidal European Hornbeam	80		8-8		Drought Tolerant
Qb	7	Quercus ilicifolia 'Princeton Sentry'	Princeton Sentry Maidenhair Tree	80		8-8		Soil Tolerant
Qc	10	Quercus x alba x robur 'Crimson Spire'	Crimson Spire Oak	80		8-8		
PERENNIALS AND GRASSES								
al		Artemisia ludoviciana	Silver Sagebrush				1 gallon pot	Native
am		Achillea millefolium	Common Yarrow				1 gallon pot	Native / Butterfly friendly
ac		Aconitum canadense	Canada Aconite				1 gallon pot	Native
af		Agastache foeniculum	Anise Hyssop				1 gallon pot	Native
ca		Cornus canadensis	Banberry				1 gallon pot	Native
dc		Deschampsia cespitosa	Tufted Hair Grass				1 gallon pot	Native
ep		Echinacea purpurea	Purple Coneflower				1 gallon pot	Native / Butterfly friendly
fr		Fragaria vesca	Woodland Strawberry				1 gallon pot	Native
hp		Hypoxis patula	Buttercup Grass				2 gallon pot	Native
lp		Lupinus perennis	Sundial Lupine				1 gallon pot	Native
sp		Sedum spectabile	Bricklayer's Stonecrop				1 gallon pot	Native
TYPICAL WOODLOT RESTORATION PLANT LIST								
TREES								
Bs	3	Betula alleghaniensis	Yellow Birch	80		8-8		Native
Cc	5	Carpinus canadensis	Blue Beech					Native
Co	1	Corylus rostrata	Shagbark Hickory	80		8-8		Native
Fa	2	Fraxinus americana	White Ash					Native
Qb	3	Quercus bicolor	Swamp White Oak					Native
SHRUBS								
ac	3	Ametanochloa canadensis	Shadblow Senecioideae	1750		8-8		Native / Multi-stemmed
ve	5	Viburnum acerifolium	Northeast Viburnum				3 gallon pot	Native
PERENNIALS AND GRASSES								
ms	75	Mnemonia struthiopteris	Ostrich Fern					
sp	100	Adiantum pedatum	Maidenhair Fern					

NOTE: CONTRACTOR TO MAKE GOOD ALL LANDSCAPE DAMAGED DURING CONSTRUCTION



KEYPLAN

LEGEND	
[Symbol]	PROPERTY LINE
[Symbol]	LIMIT OF CONSTRUCTION LINE
[Symbol]	CONCRETE PAVING
[Symbol]	TINTED CONCRETE PAVING
[Symbol]	ASPHALT
[Symbol]	LINE PAINTING ON ASPHALT
[Symbol]	TACTILE ATTENTION INDICATOR
[Symbol]	TACTILE DIRECTIONAL INDICATOR
[Symbol]	EXISTING DECIDUOUS TREE TO REMAIN
[Symbol]	EXISTING CONIFEROUS TREE TO REMAIN
[Symbol]	EXISTING VEGETATION TO REMAIN
[Symbol]	EXISTING SOD
[Symbol]	SOD
[Symbol]	NATIVE SEED MIX
[Symbol]	DECIDUOUS TREE
[Symbol]	PERENNIALS & GROUNDCOVERS
[Symbol]	MULTI-PURPOSE PATH SEE CIVIL
[Symbol]	BENCH
[Symbol]	CATCH BASIN REFER TO CIVIL
[Symbol]	MANHOLE REFER TO CIVIL
[Symbol]	FIRE HYDRANT REFER TO CIVIL
[Symbol]	LIGHT POLES SEE ELEC.

#	date	revision	by
5	2023-09-18	ISSUED FOR SPC RESUBMISSION	WV
4	2023-08-02	ISSUED FOR SPC RESPONSE	WV
3	2023-08-16	ISSUED FOR SPC APPLICATION	WV
2	2023-07-31	ISSUED FOR SPC SUBMISSION	WV
1	2023-04-20	ISSUED FOR TECHNICAL SUBMISSION	WV

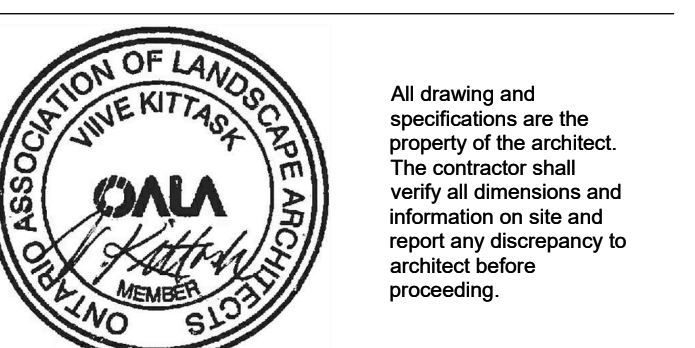

1Door4Care: CHEO Integrated Treatment Centre: Parking Garage

401 Smyth Rd, Ottawa, ON

PARKADE LANDSCAPE PLAN

scale: 1/200
 drawn by: WVRM
 reviewed by: VK
 job number: 2027
 plot date: 2023/09/18
 drawing number:

LP0101

City of Ottawa File No. D07-12-22-0170
 City of Ottawa Plan No. 18912

2023/11/20 11:31:47 PM AutodeskDWG2000_L1D4C_CHEO_P20230918_L1D4C-CHEO_MSA_MVA_R22.dwg

REFER TO ARBORIST REPORT PREPARED BY COLVILLE CONSULTING INC. FILE NO. C23080 DATED SEPTEMBER 19, 2023.

Table with columns: Tag #, Species, Scientific Name, Location, DBH (cm), Critical Root Zone (cm), Driveway, Health, Recommendation, Field Notes/Condition Comments, Date, Northing, Easting.

Table with columns: Tag #, Species, Scientific Name, Location, DBH (cm), Critical Root Zone (cm), Driveway, Health, Recommendation, Field Notes/Condition Comments, Date, Northing, Easting.

Table with columns: Tag #, Species, Scientific Name, Location, DBH (cm), Critical Root Zone (cm), Driveway, Health, Recommendation, Field Notes/Condition Comments, Date, Northing, Easting.

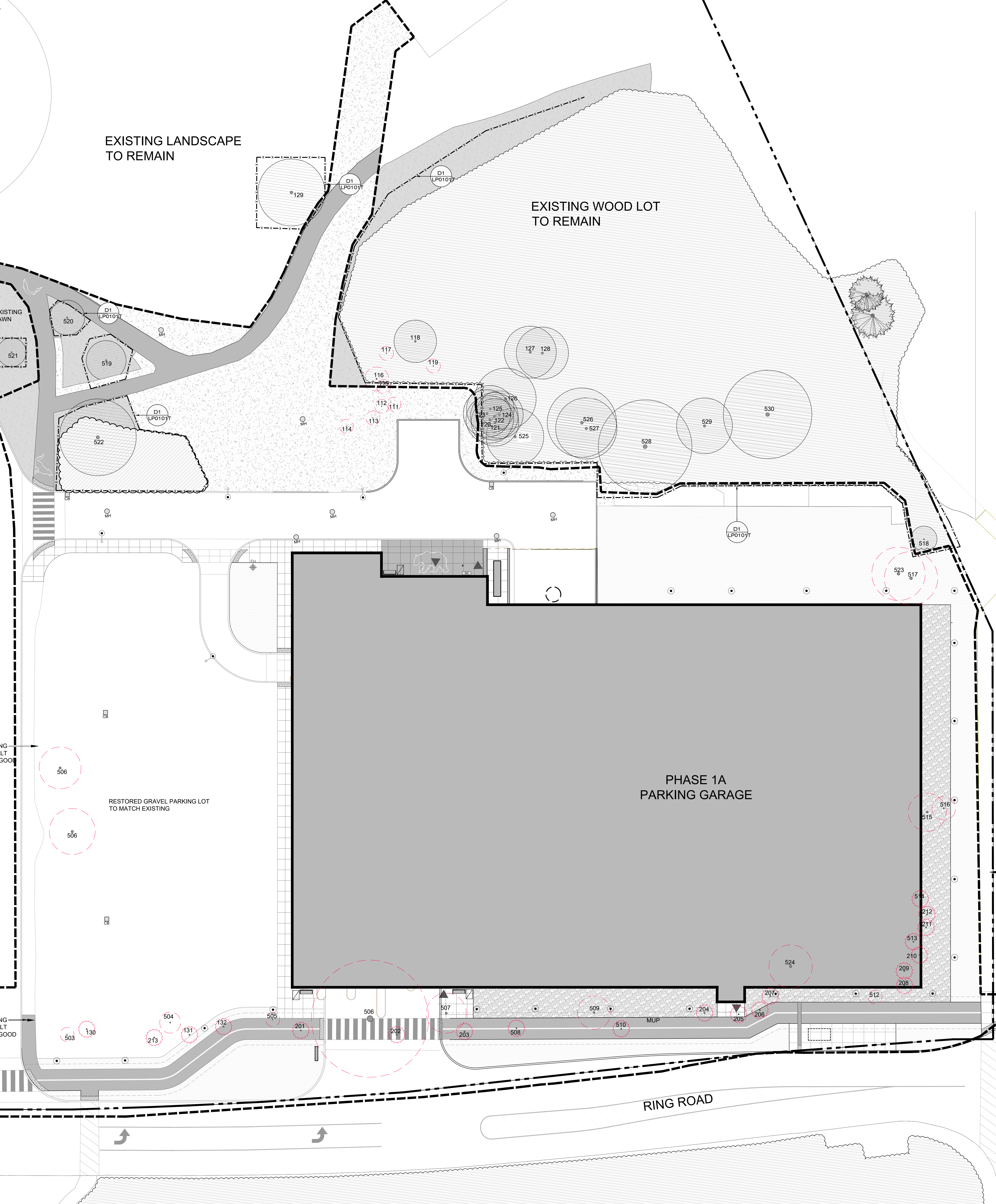

EXISTING LANDSCAPE TO REMAIN

EXISTING WOOD LOT TO REMAIN

EXISTING LAWN

EXISTING PARKING LOT

PHASE 1A PARKING GARAGE

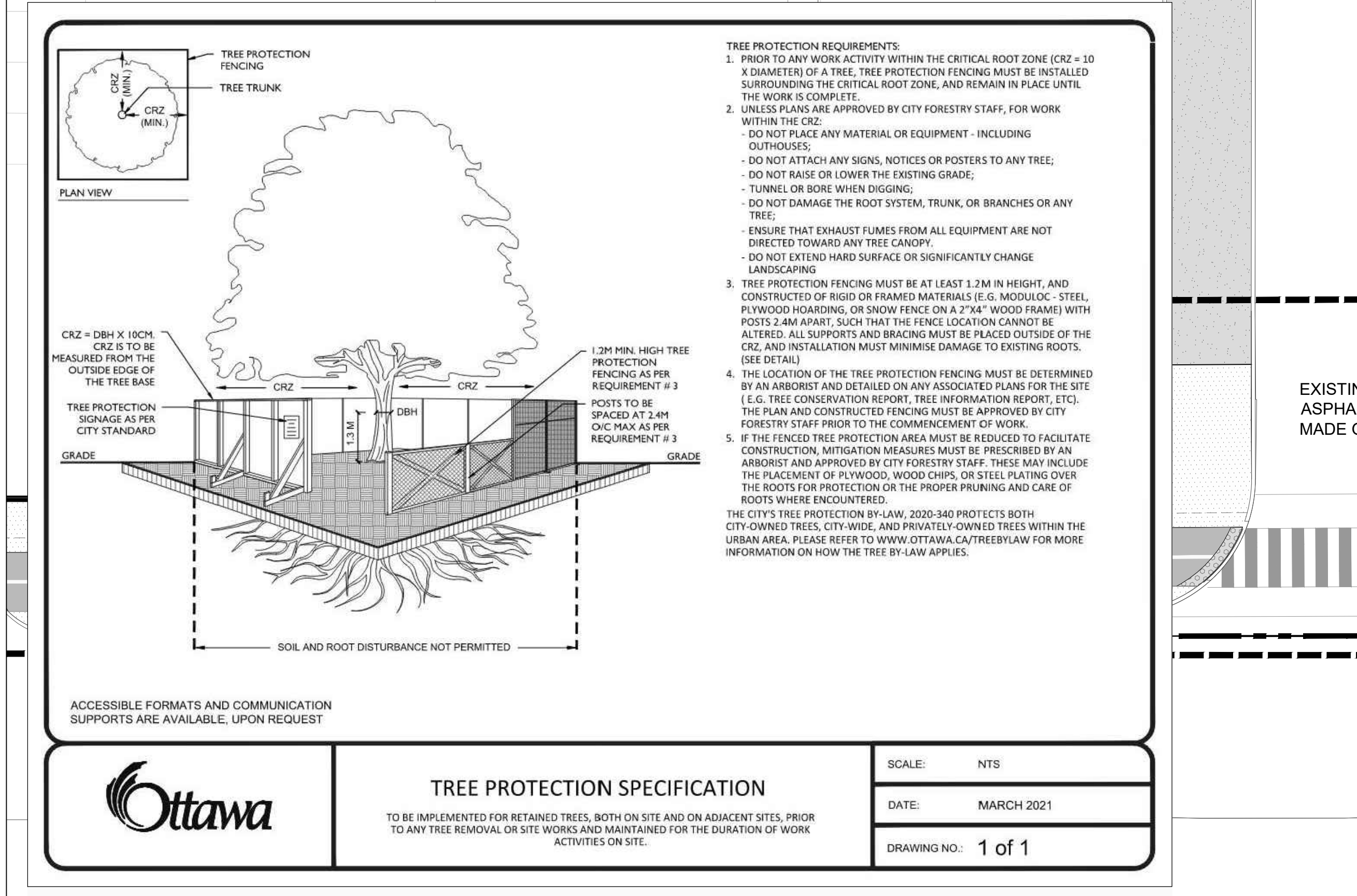

VERTECHS DESIGN landscape architects

LEGEND table with symbols for PROPERTY LINE, LIMIT OF CONSTRUCTION LINE, CONCRETE PAVING, TINTED CONCRETE PAVING, ASPHALT, TACTILE ATTENTION INDICATOR, EXISTING SOIL, SOIL, NATIVE SEED MIX, EXISTING DECIDUOUS TREE TO REMAIN, EXISTING CONIFEROUS TREE TO REMAIN, EXISTING CONIFEROUS TREE TO REMOVE, EXISTING DECIDUOUS TREE TO REMOVE, EXISTING VEGETATION TO REMAIN, TREE PROTECTION HOARDING, LIGHT POLES SEE ELEC.

Revision table with columns: No., Description, Date, By.

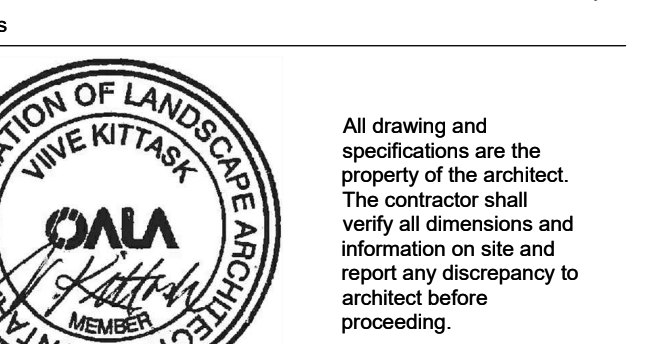

1Door4Care: CHEO Integrated Treatment Centre: Parking Garage

Scale: 1:200, Date: MARCH 2021, Drawing No: 1 of 1

City of Ottawa File No. D07-12-22-0170 City of Ottawa Plan No. 18912

KEYPLAN

LEGEND	
PROPERTY LINE	PROPOSED WATER LINE
LIMIT OF CONSTRUCTION LINE	EXISTING WATER LINE
CONCRETE PAVING	PROPOSED STORM LINE
TINTED CONCRETE PAVING	EXISTING STORM LINE
ASPHALT	PROPOSED DETENTION GALLERY SEE CIVIL
TACTILE ATTENTION INDICATOR	PROPOSED SANITARY LINE
TACTILE DIRECTIONAL INDICATOR	EXISTING SANITARY LINE
EXISTING SOD	PROPOSED HYDRO DUCTS
SOD	EXISTING UG HYDRO LINES
NATIVE SEED MIX	MANHOLE REFER TO CIVIL
EXISTING DECIDUOUS TREE TO REMAIN	PIPE INSULATION SEE CIVIL
EXISTING CONIFEROUS TREE TO REMAIN	CATCH BASIN REFER TO CIVIL
EXISTING VEGETATION TO REMAIN	FIRE HYDRANT REFER TO CIVIL
DECIDUOUS TREE	LIGHT POLES SEE ELEC
MULTI PURPOSE PATH	
BENCH	

#	DATE	REVISION	BY
5	2023-09-18	ISSUED FOR SPC RESUBMISSION	IW
4	2023-08-02	ISSUED FOR SPC RESPONSE	IW
3	2023-08-16	ISSUED FOR SPC APPLICATION	IW
2	2023-07-31	ISSUED FOR UG/DI SUBMISSION	IW
1	2023-04-20	ISSUED FOR TECHNICAL SUBMISSION	IW

ALL DRAWING AND SPECIFICATIONS ARE THE PROPERTY OF THE ARCHITECT. THE CONSULTANT SHALL VERIFY ALL DIMENSIONS AND INFORMATION ON SITE AND REPORT ANY DISCREPANCY TO ARCHITECT BEFORE PROCEEDING.

1Door4Care: CHEO Integrated Treatment Centre: Parking Garage

401 Smyth Rd, Ottawa, ON

PARKADE LANDSCAPE UTILITY PLAN

scale: 1/200
 drawn by: IWRM
 reviewed by: VK
 job number: 2207
 plot date: 2023/09/18
 drawing number:

LP0101U



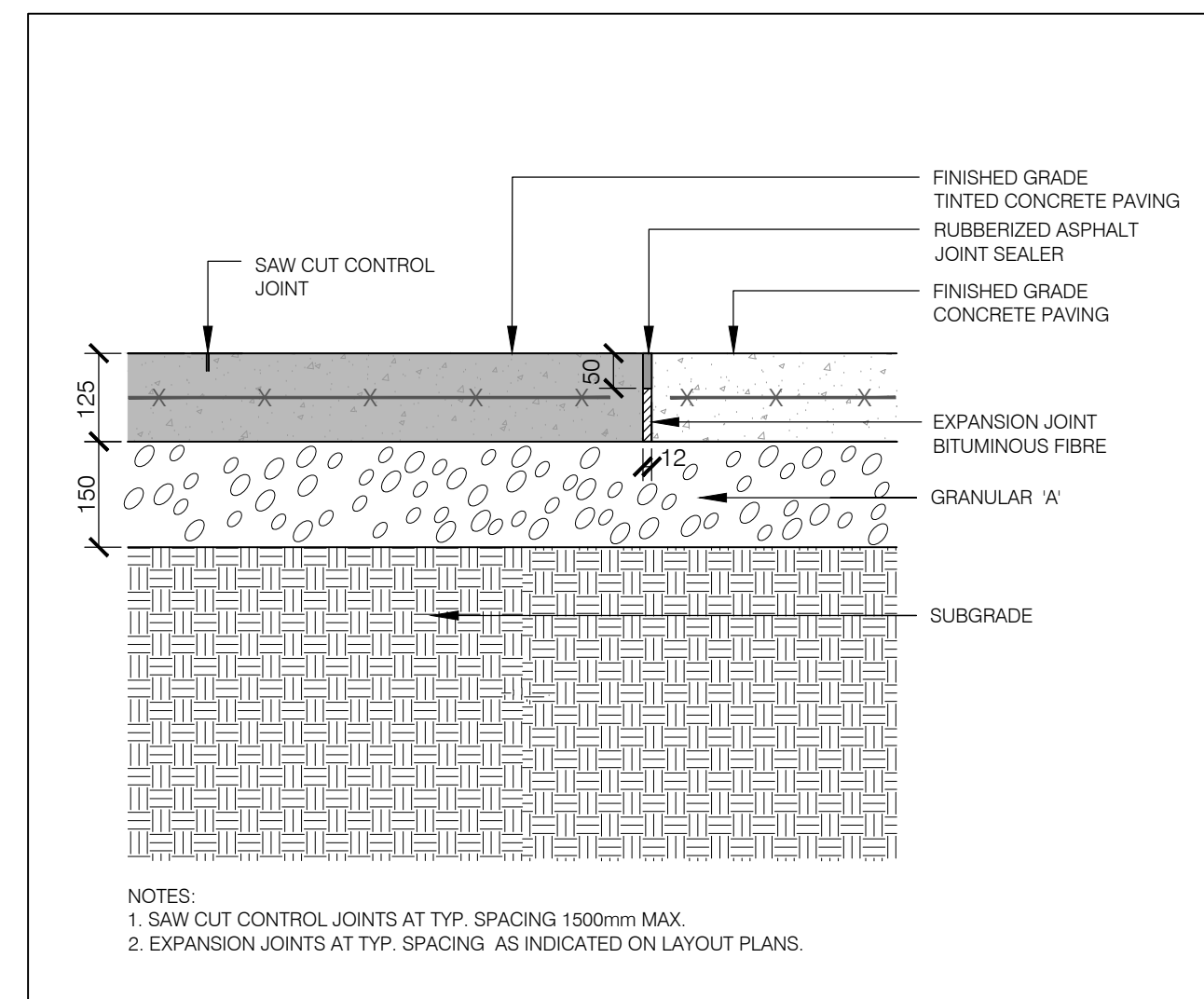

01
UP000
TYPICAL CONCRETE AND TINTED CONCRETE PAVING ON GRADE SECTION SCALE 1:10

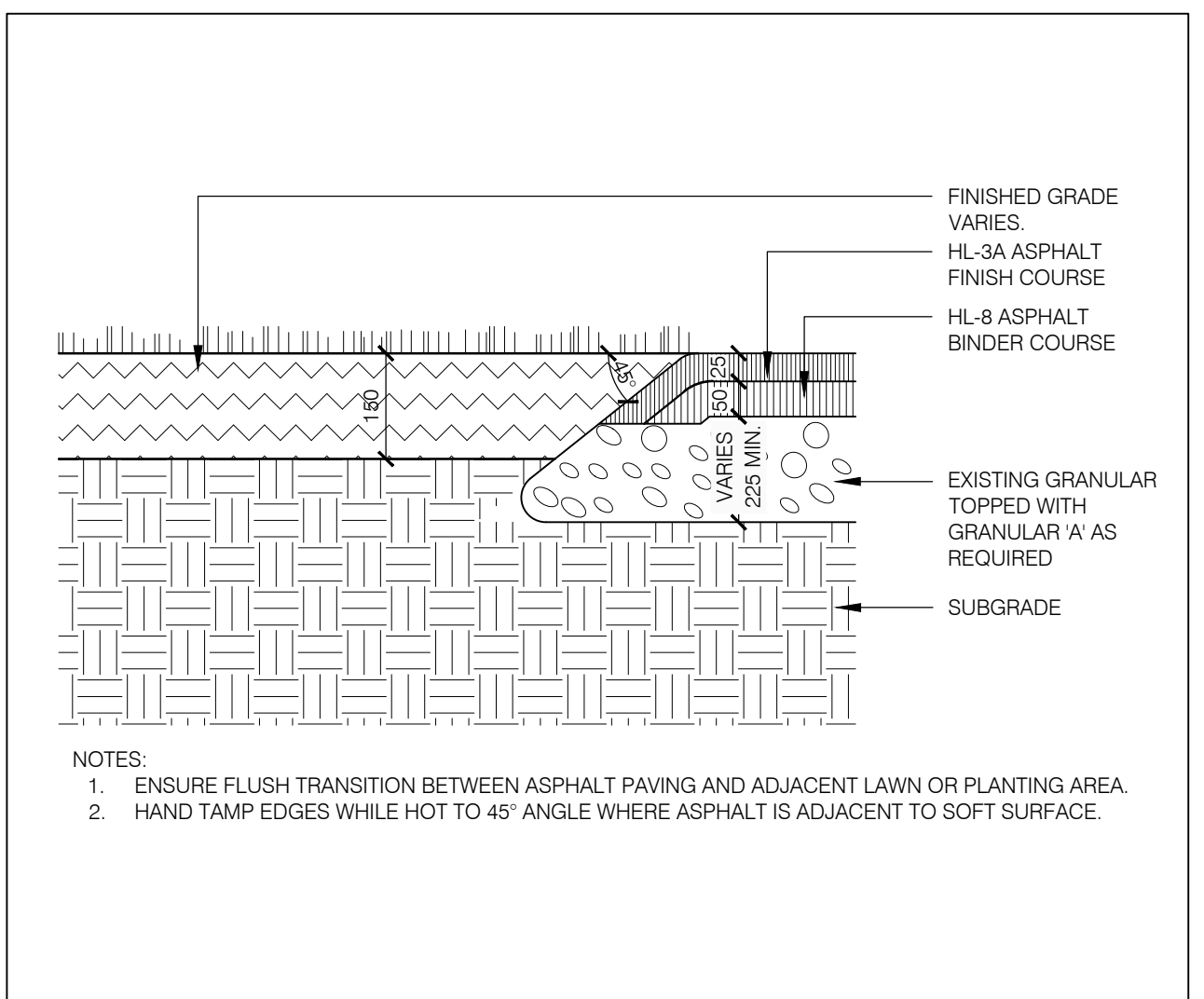

02
UP000
TYPICAL MEDIUM DUTY ASPHALT PAVING SECTION SCALE 1:10

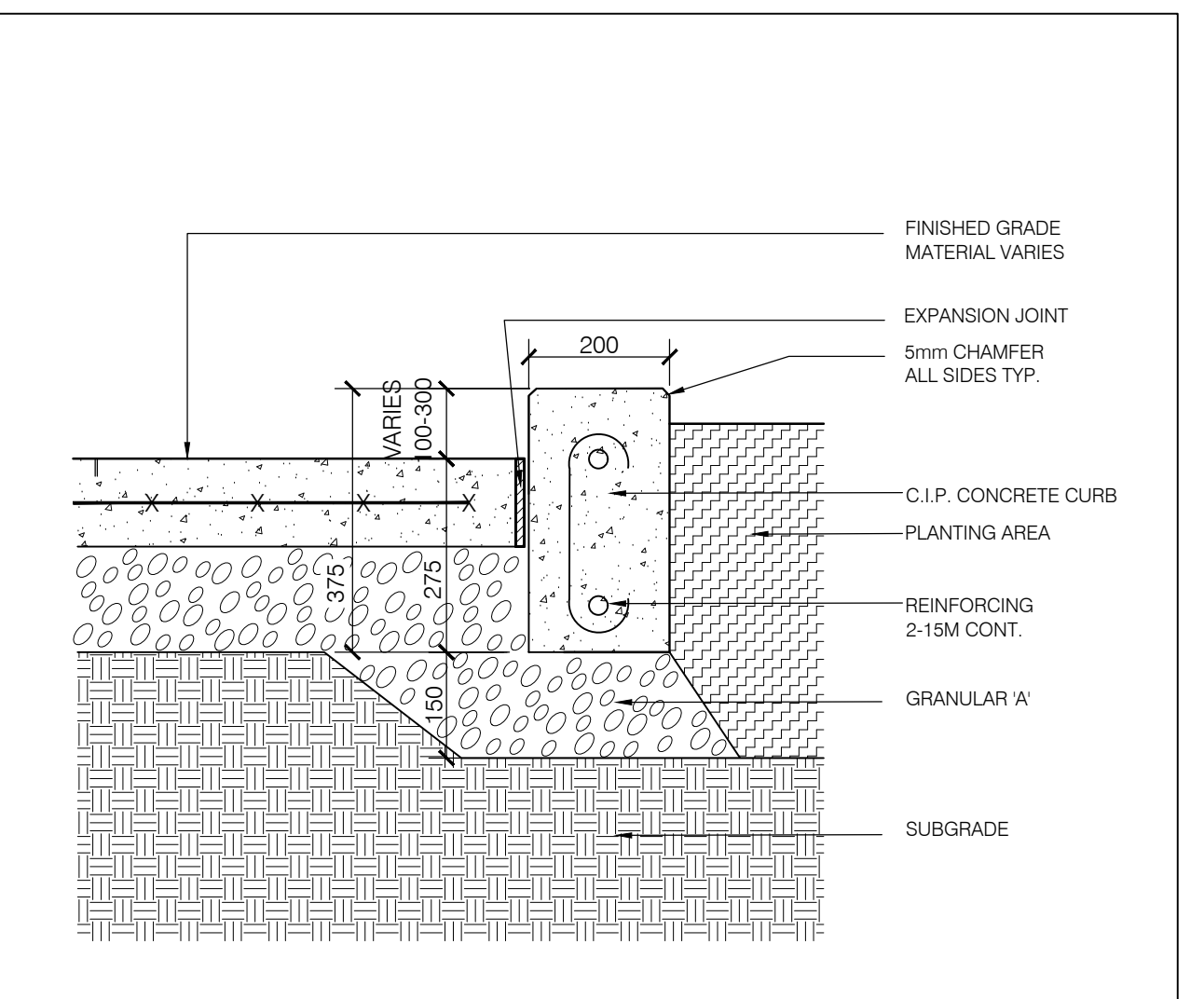

03
UP000
TYPICAL CONCRETE PLANTER CURB ON GRADE SECTION SCALE 1:10

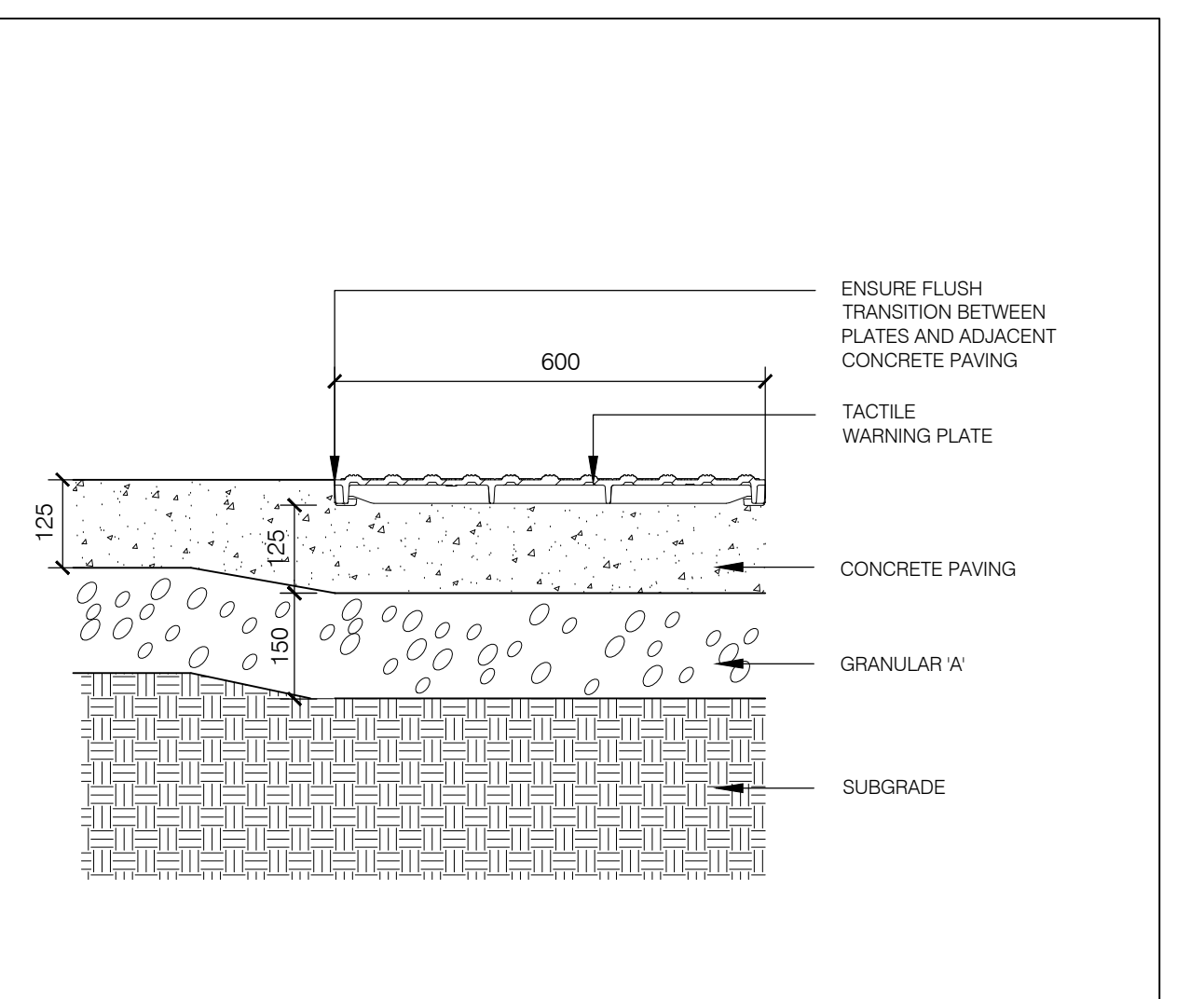

04
L0001
TYPICAL TACTILE ATTENTION INDICATOR SECTION SCALE 1:10

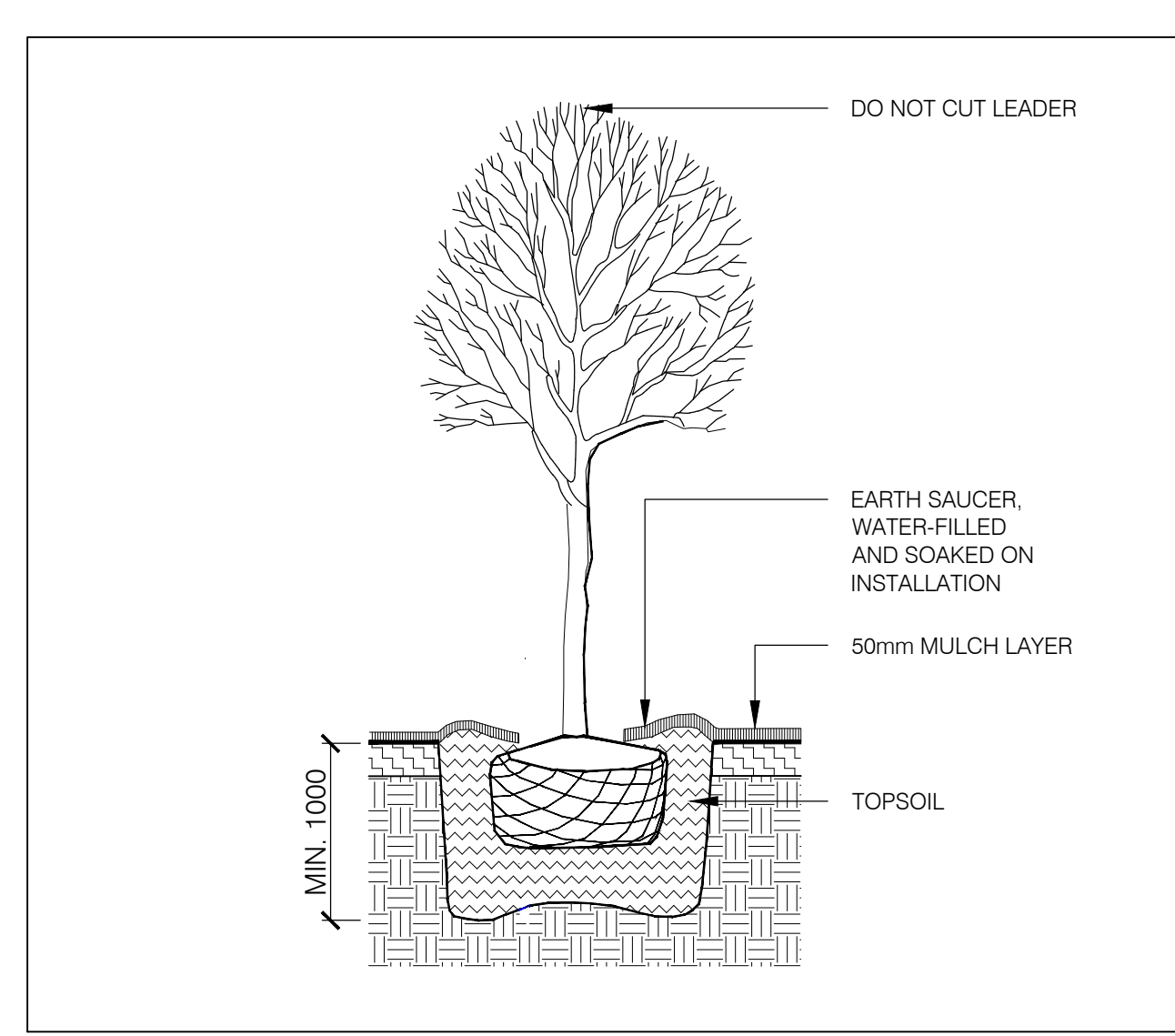

06
LP000
TYPICAL DECIDUOUS TREE PLANTING SECTION SCALE 1:25

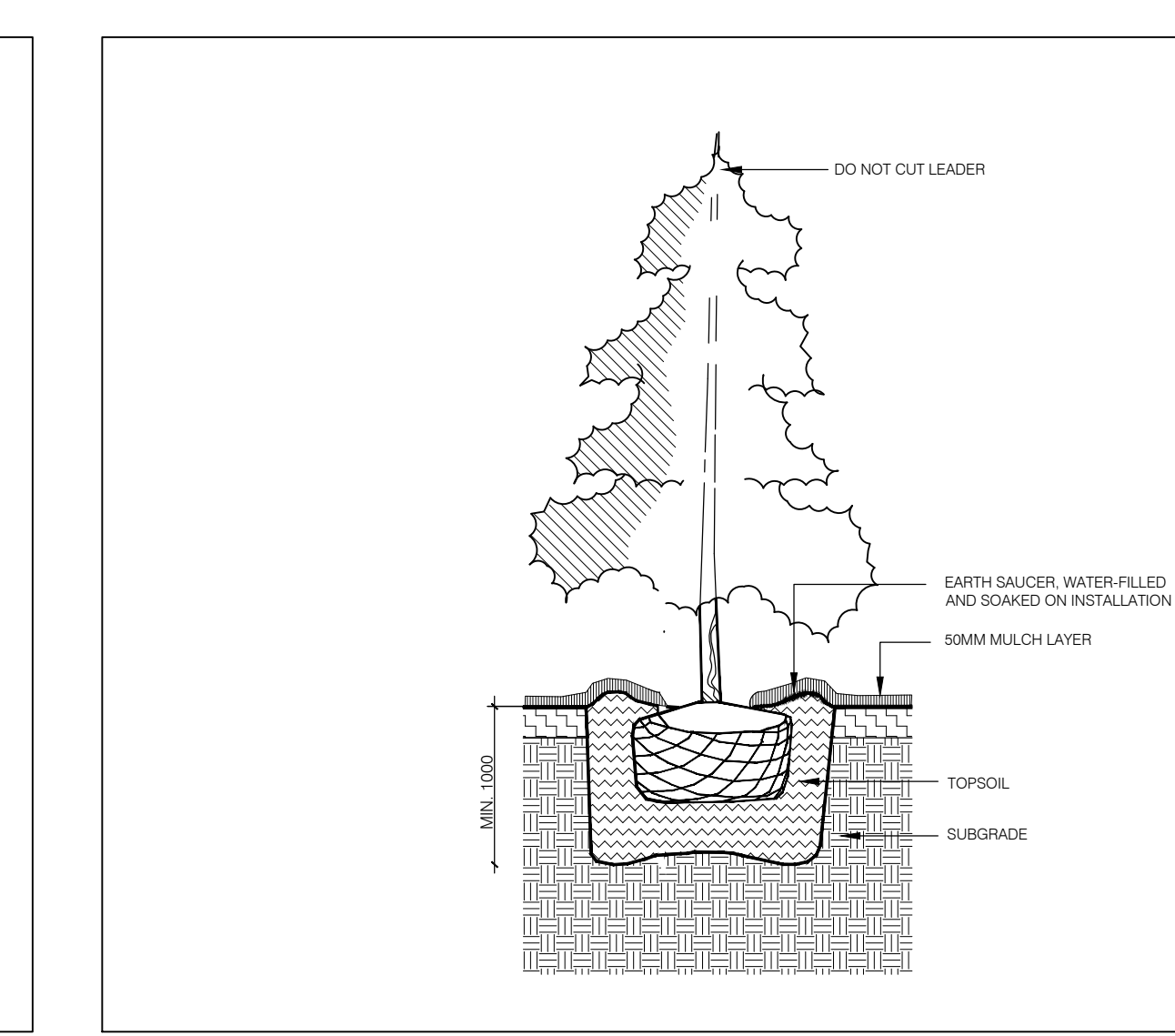

07
LP000
TYPICAL CONIFEROUS TREE PLANTING CITY OF OTTAWA STANDARD DETAIL SCALE 1:25

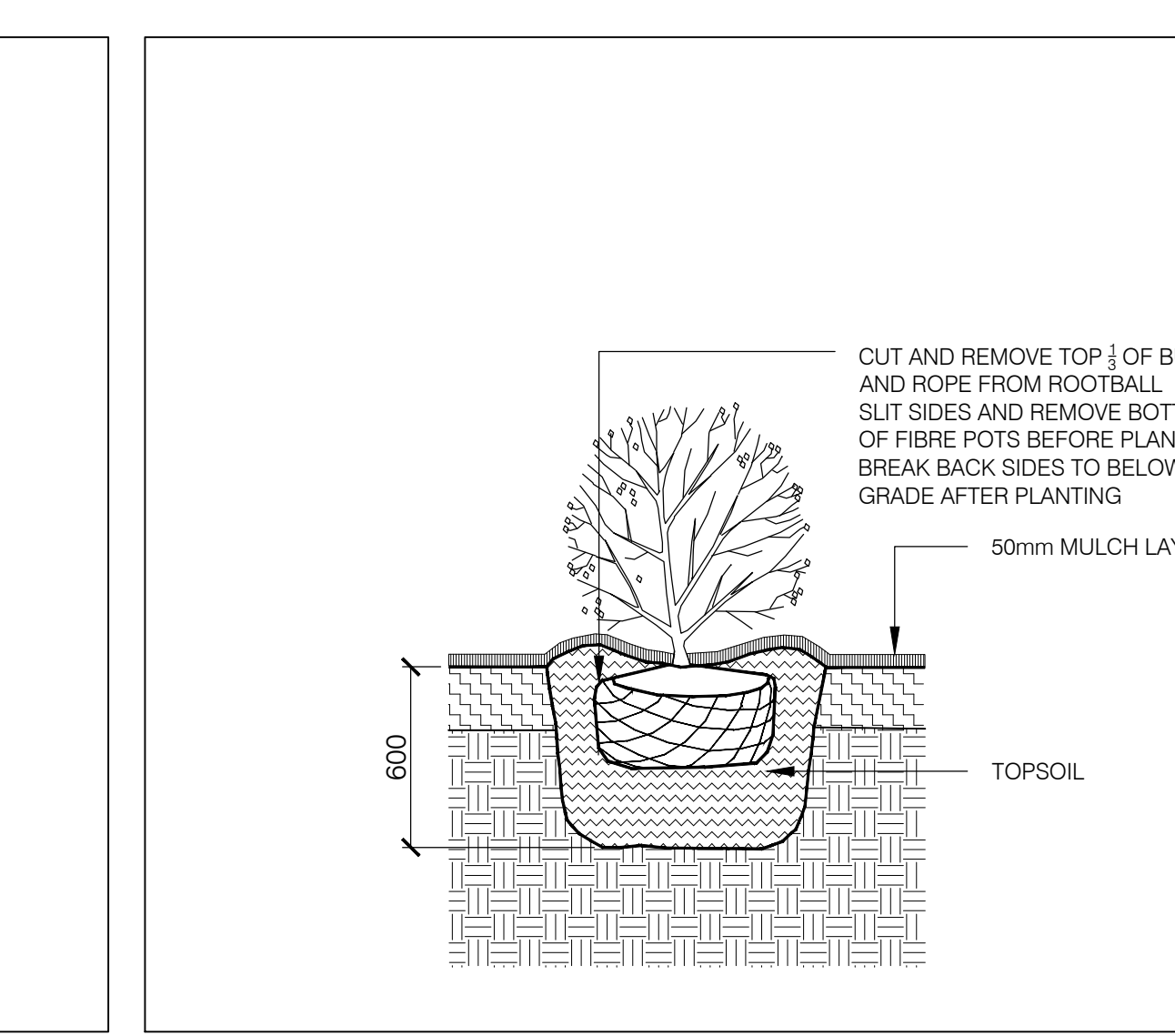

08
LP000
TYPICAL SHRUB PLANTING CITY OF OTTAWA STANDARD DETAIL SCALE 1:25

Esplanade Bench With Tropical Wood Slats

PS-840-AL-WD3-WD3-A Esplanade WD-W

Our 'Esplanade' bench features an all-welded aluminum powdercoated frame, and Tropical Wood Slats. Shown here in our 'Pewter' powdercoat finish with IPE wood slats. Available in a variety of sizes and finishes, freestanding or bolt-down.

HAUSER
SITE FURNITURE

Width: 72" (182.9 cm)
Depth: 27.25" (69.2 cm)
Height: 31" (78.7 cm)
Seat Height: 18" (45.7 cm)
Arm Height: 27" (68.6 cm)

sales@hauserite.com | 1-800-268-7328 | hauserite.com

09
LP000
TYPICAL BENCH TYPE ONE MANUFACTURER'S CUT SHEET NOT TO SCALE

LEXICON

MRR-1500-00016
Legacy #: LXRCI03-48-MS-VGST-VGST-RS

MAGLIN
SITE FURNITURE

MATERIALS: The trash/recycle unit is constructed using a steel frame with laser cut and formed steel body panels. Three 9 gallon (33 litre) commercial grade plastic bins and standard metal lids are provided.

FINISH: All steel components are protected with 1-Coat hot-dip galvanneal. The Maglin Powdercoat System provides a durable finish on all metal surfaces.

INSTALLATION: The trash/recycle unit is delivered pre-assembled. Holes (3/8") are provided in each mounting foot for securing to base.

TO SPECIFY: Select MRR-1500-00016
Options:
- Powdercoat Color

HEIGHT: 47.5" (120.7 cm) LENGTH: 39" (99.1 cm) DEPTH: 18" (45.7 cm) WEIGHT: 216.24 lbs (98.1 kg)

7 430 2nd Ave
1st Floor
Ottawa, ON K1P 6K7
www.maglin.com
info@maglin.com

All drawings, specifications, design and details on this page remain the property of Maglin Site Furniture Inc. and may not be used without Maglin Site Furniture Inc. permission. © Maglin Site Furniture Inc. 2023

10
LP000
TYPICAL WASTE RECEPTACLE TYPE ONE MANUFACTURER'S CUT SHEET NOT TO SCALE

#	date	revision	by
5	2023-09-18	ISSUED FOR SPC RESUBMISSION	IW
4	2023-08-02	ISSUED FOR SPC RESPONSE	IW
3	2023-08-16	ISSUED FOR SPC APPLICATION	IW
2	2023-07-31	ISSUED FOR SPC SUBMISSION	IW
1	2023-04-20	ISSUED FOR TECHNICAL SUBMISSION	IW

revisions

QUALITY ASSURANCE
ALL DRAWINGS AND SPECIFICATIONS ARE THE PROPERTY OF THE ARCHITECT. THE CONTRACTOR SHALL VERIFY ALL DIMENSIONS AND INFORMATION ON SITE AND REPORT ANY DISCREPANCY TO ARCHITECT BEFORE PROCEEDING.

1Door4Care: CHEO Integrated Treatment Centre: Parking Garage

401 Smyth Rd, Ottawa, ON

LANDSCAPE DETAILS

scale:	AS SHOWN
drawn by:	IWRM
reviewed by:	VK
job number:	2027
plot date:	2023/09/18
drawing number:	LP0200