

# HUNTMAR DRIVE

THIS PLAN IS TO BE READ IN CONJUNCTION WITH CIVIL PLANS 122151-NLD1&2, 122151-GP1&2 AND 122151-GR1&GR2

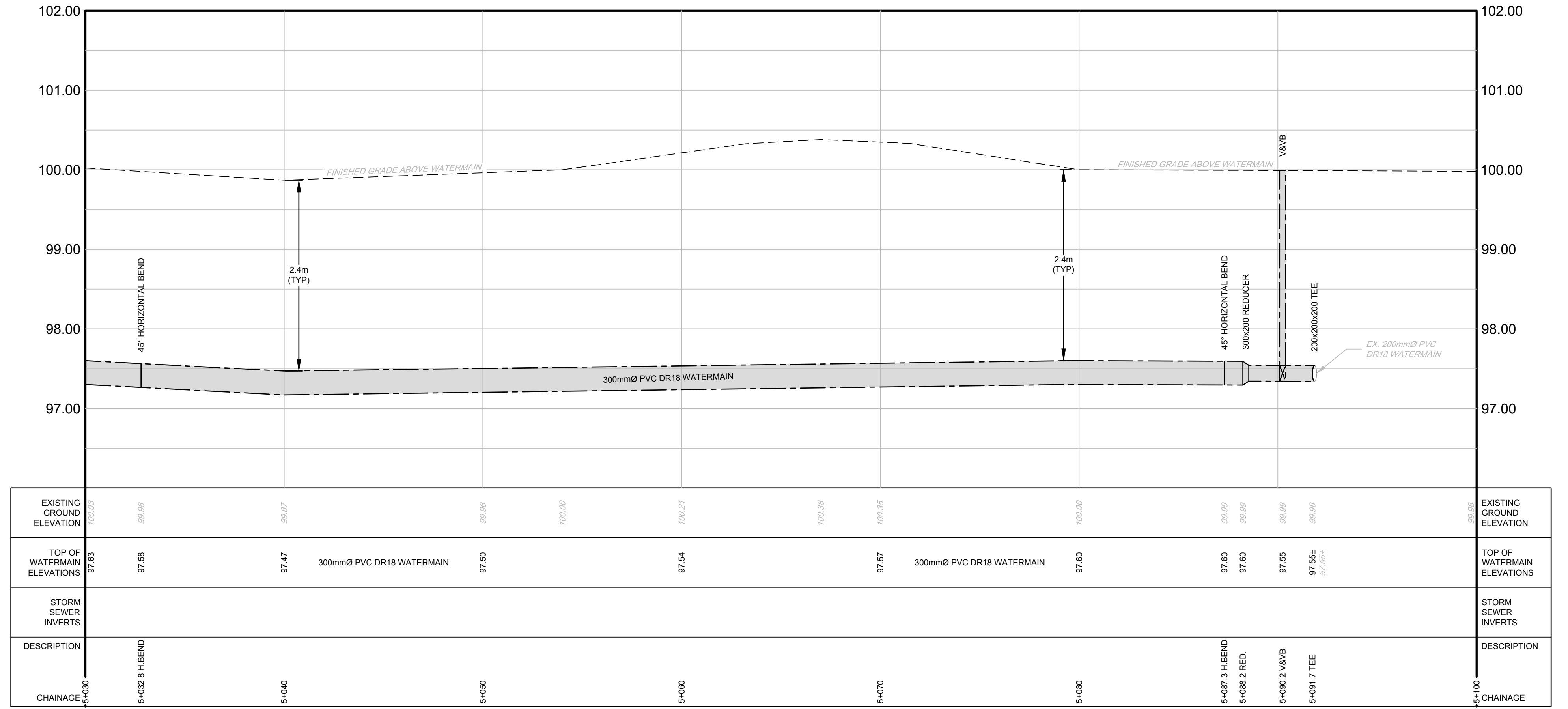
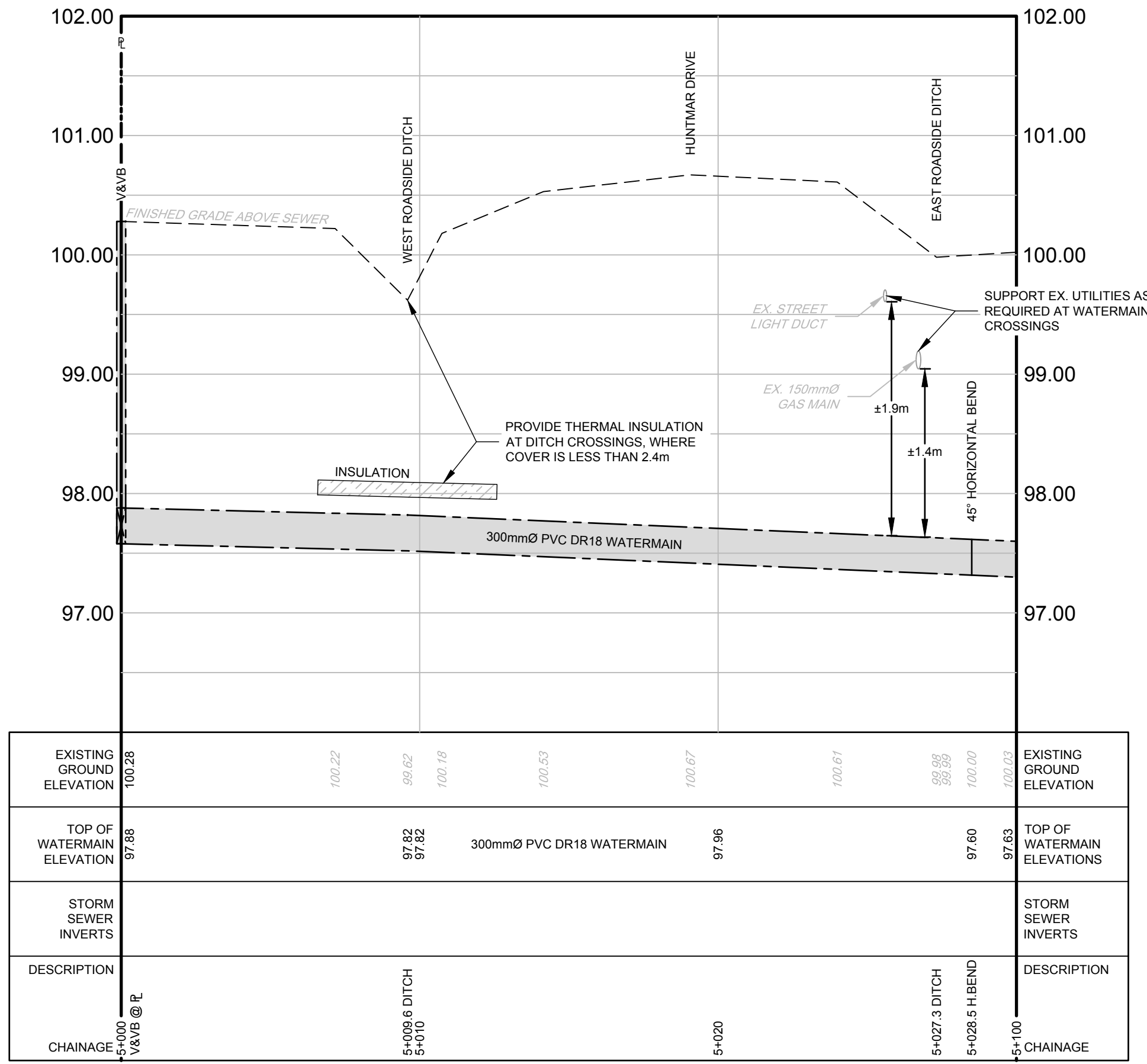

NOTE:  
THE POSITION OF ALL POLE LINES, CONDUITS, WATERMANS, SEWERS AND OTHER UNDERGROUND AND OVERGROUND UTILITIES AND STRUCTURES IS NOT NECESSARILY SHOWN ON THE CONTRACT DRAWINGS, AND WHERE SHOWN, THE ACCURACY OF THE POSITION OF SUCH UTILITIES AND STRUCTURES IS NOT GUARANTEED. BEFORE STARTING WORK, DETERMINE THE EXACT LOCATION OF ALL SUCH UTILITIES AND STRUCTURES AND ASSUME ALL LIABILITY FOR DAMAGE TO THEM.

No.	REVISION	DATE	BY
6	RE-ISSUED FOR SITE PLAN APPROVAL	SEPT 15/23	DDB
5	ISSUED FOR SITE PLAN APPROVAL	AUG 4/23	DDB
4	ISSUED FOR BUILDING PERMIT	JUL 14/23	DDB
3	REVISED PER CITY COMMENTS	MAY 31/23	DDB
2	REVISED PER CITY COMMENTS	MAR 30/23	DDB
1	ISSUED FOR CITY OF OTTAWA REVIEW	DEC 16/22	DDB

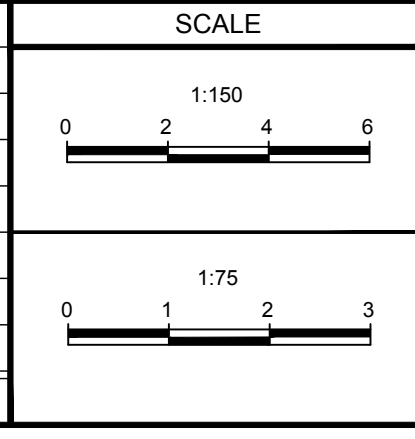

DESIGN	SM / BM / DDB
CHECKED	DDB
DRAWN	SM
CHECKED	BM / DDB
APPROVED	DDB



**NOVATECH**  
Engineers, Planners & Landscape Architects  
Suite 200, 240 Michael Cowpland Drive  
Ottawa, Ontario, Canada K2M 1P6  
Telephone: (613) 254-9643  
Facsimile: (613) 254-5867  
Website: www.novatech-eng.com

LOCATION  
CITY OF OTTAWA  
405 HUNTMAR DRIVE - WAREHOUSE DEVELOPMENT

DRAWING NAME  
PLAN and PROFILE  
OFF-SITE WATERMAIN EXTENSION  
STATION 5+000 to 5+100

PROJECT No. 122151  
REV # 6  
DRAWING No. 122151-PR1