

**EXISTING TREE LIST**

KEY	QTY	BOTANICAL NAME	COMMON NAME	SIZE	CONDITION	REMARKS
EL	1	Ulmus americana	American Elm	100mm dia.	Good	To remain
GT	1	Gleditsia triacanthos	Honey Locust	350mm dia.	Good	To remain

**PROPOSED PLANT LIST**

KEY	QTY	BOTANICAL NAME	COMMON NAME	SIZE	CONDITION	SPACING
JL	2	Syringa reticulata	Japanese Tree Lilac	60mm dia.	B&B	

- GENERAL NOTES:**
- It is the responsibility of the appropriate contractor or official to report any errors, omissions or discrepancies on this plan with actual site conditions to the Landscape Architect before proceeding with construction.
  - The contractor is to notify all utility companies and authorities prior to any excavation and ascertain locations of underground services.
  - The contractor is to reinstate all areas and items damaged as a result of construction activity.
  - The contractor is to comply with all pertinent codes and by-laws.
  - The contractor is to maintain a positive surface run-off throughout the entire construction period.
  - The Landscape Architect is not responsible for subsurface conditions.
  - The contractor is to identify all existing trees to remain on site with the Landscape Architect prior to construction.
  - The contractor is to stake the proposed location of all plant material in conjunction with the Landscape Architect prior to excavation.
  - All trees within 1m of underground utility trenches are to be excavated by hand.
  - Remove all protective wrapping from tree trunks after installation.
  - Staking of trees shall only be performed if necessary.
  - Ensure that mulch is pulled back a min. distance of 75mm from base of tree trunk.

**CLIENT**  
VP CAPITAL PARKING  
VP TRS HOLDINGS INC.  
400 Beaver Street, Ottawa, ON

**CONSULTANTS**  
**ARCHITECTS:** CHMEL ARCHITECTS  
2701 FERRY RD. OTTAWA, ON K1P 1P6  
Tel: (613) 224-3385

**CIVIL ENGINEERS:** ANLEY GROUP  
2701 FERRY RD. OTTAWA, ON K1P 1P7  
Tel: (613) 822-1022

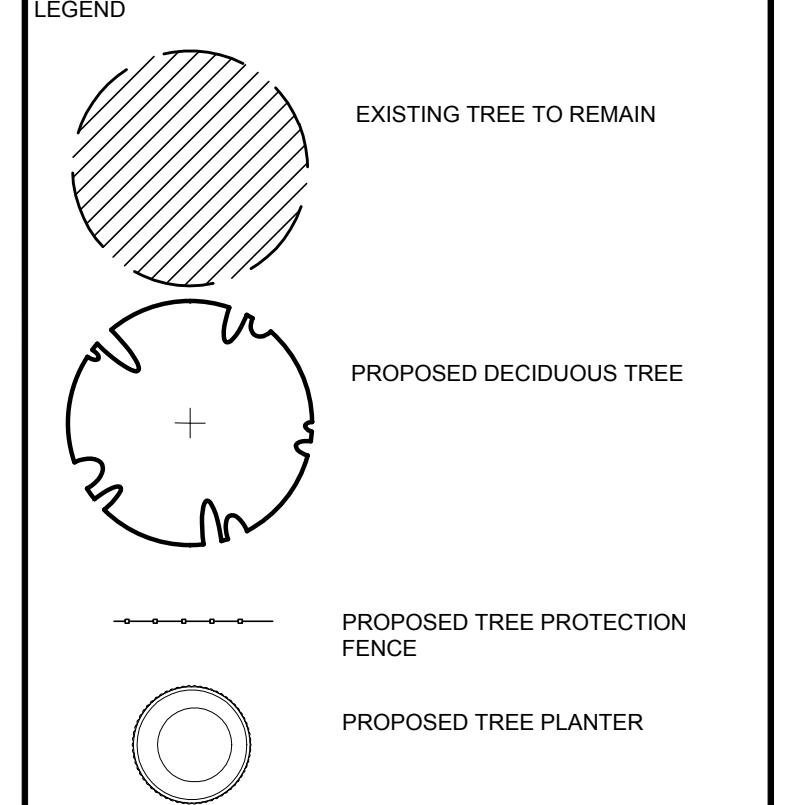

**1 TREE CONSERVATION REPORT & LANDSCAPE PLAN**  
L.1 SCALE 1:100



- NOTES:**
- INSTALL FENCE PRIOR TO ANY CONSTRUCTION ACTIVITY.
  - NO CONSTRUCTION ACTIVITIES INCLUDING MATERIAL STORAGE OR DISPOSAL, OR PARKING IS TO TAKE PLACE WITHIN THE DESIGNATED PROTECTION AREA.
  - ANY ROOTS ENCOUNTERED, ARE TO BE CLEANLY CUT WITH A SAW OR PRUNERS (DO NOT USE BACKHOE OR OTHER HEAVY EQUIPMENT). ROOTS ARE TO BE COVERED IMMEDIATELY WITH TOPSOIL, BURLAP OR MULCH AND KEPT DAMP.
- PROTECTION MEASURES TO BE TAKEN DURING CONSTRUCTION:**
- UNDER THE GUIDANCE OF AN ARBORIST, ERECT A FENCE AT THE CRITICAL ROOT ZONE (CRZ) OF TREES WHERE THE CRZ IS ESTABLISHED AS BEING 12 CENTIMETRES FROM THE TRUNK OF A TREE FOR EVERY CENTIMETRE OF TRUNK DIAMETER AT BREAST HEIGHT. THE CRZ IS CALCULATED AS DBH X 12 CM.
  - DO NOT PLACE ANY MATERIAL OR EQUIPMENT WITHIN THE CRZ OF THE TREE
  - DO NOT ATTACH ANY SIGNS, NOTICES OR POSTERS TO ANY TREE.
  - DO NOT RAISE OR LOWER THE EXISTING GRADE WITHIN THE CRZ WITHOUT APPROVAL.
  - TUNNEL OR BORE WHEN DIGGING WITHIN THE CRZ OF A TREE.
  - DO NOT DAMAGE THE ROOT SYSTEM, TRUNK, OR BRANCHES OF ANY TREE.
  - ENSURE THAT EXHAUST FUMES FROM ALL EQUIPMENT ARE NOT DIRECTED TOWARDS ANY TREE CANOPY.

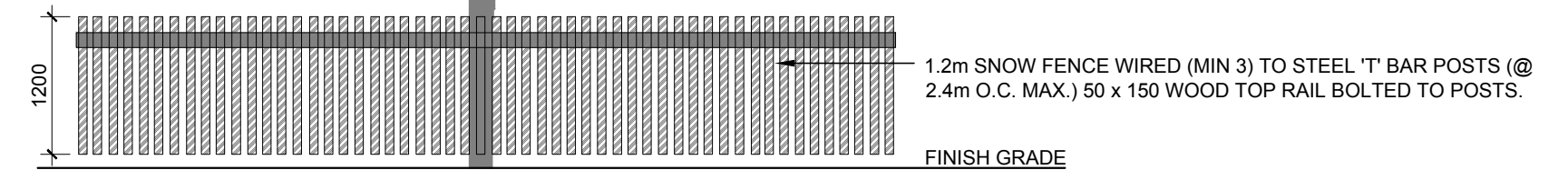
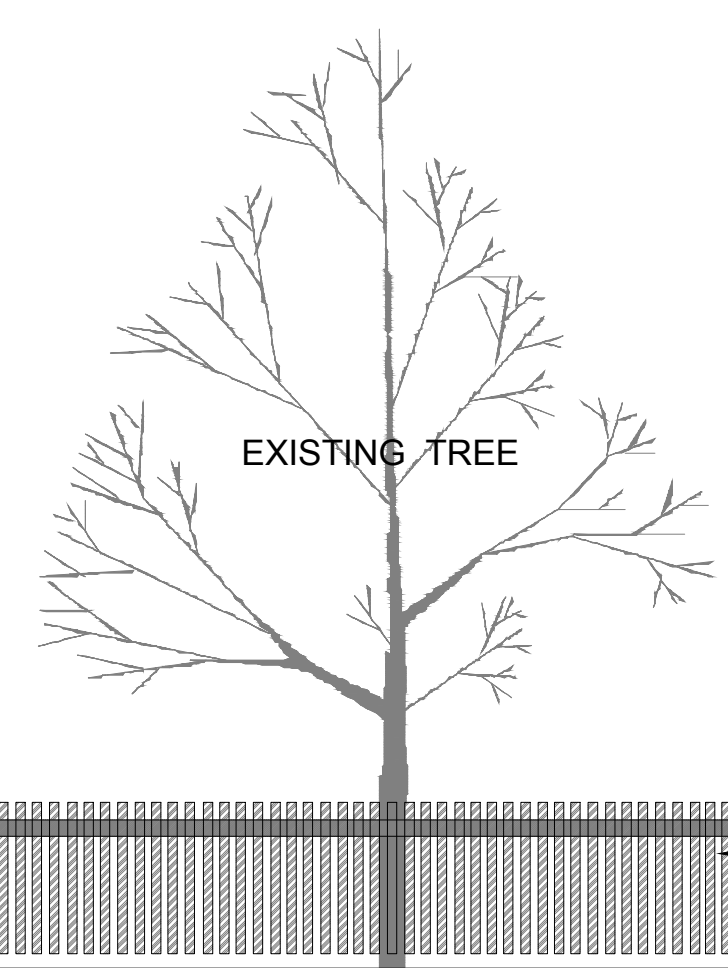

**3 TREE PROTECTION FENCE (TEMPORARY DURING CONSTRUCTION)**  
L.1 N.T.S.

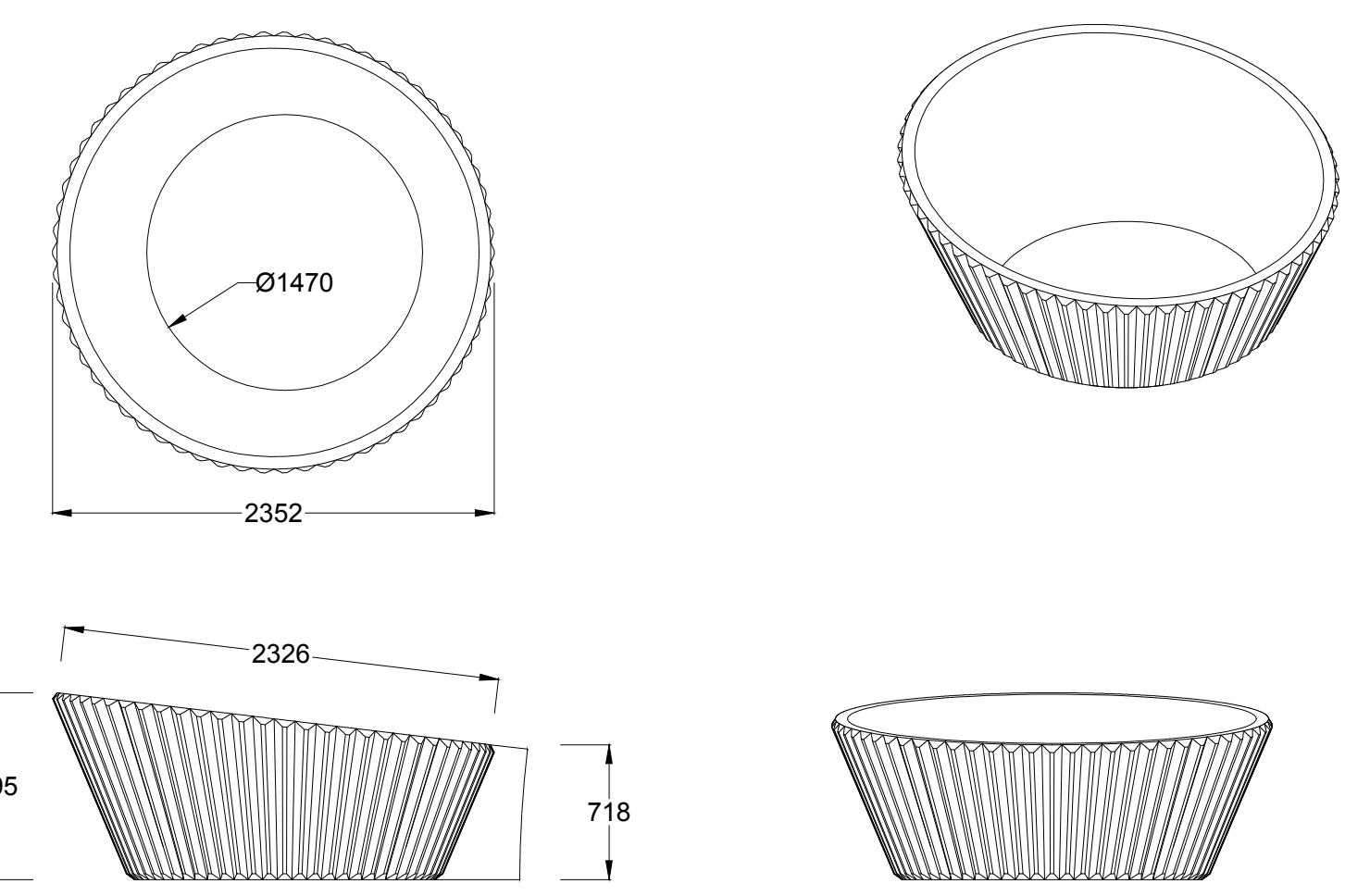

**4 REINFORCED CAST STONE TREE PLANTER BY "LANDSCAPE FORMS"**  
L.1 N.T.S.

No.	Issue	Date	DR	CK
2	REVISED AS PER CITY COMMENTS	08/11/2023	LC	JL
1	ISSUED FOR SITE PLAN APPROVAL	04/18/2023	LC	JL

**JAMES B. LENNOX & ASSOCIATES INC.**  
**LANDSCAPE ARCHITECTS**  
3332 CARLING AVE. OTTAWA, ONTARIO K2H 1S6  
Tel. (613) 722-5168 Fax. (613) 343-3942

**PROJECT**  
SOMERSET APARTMENTS  
352 SOMERSET STREET, OTTAWA, ON.

**DRAWING**  
LANDSCAPE PLAN

	SCALE
	AS SHOWN
	START DATE
APRIL, 2023	
PROJECT NO.	

PROJECT NORTH	DRAWING NO.
	<b>L.1</b>
	PLOT SIZE ARCH-D