

# 1Door4Care - CHEO Integrated Treatment Centre: Parking Garage

ISSUED FOR SPC SUBMISSION  
2023-08-16

VOLUME 1 : LANDSCAPE



© 2023 Montgomery Sisam Architects Inc.  
All rights reserved. No part of this document may  
be reproduced, stored in a retrieval system, or  
transmitted in any form or by any means  
without prior written permission by Montgomery Sisam Architects Inc.  
2023-08-11 8:49:41 PM



SHEET LIST - LANDSCAPE ARCHITECTURAL	
Sheet Number	Sheet Name
LP0000	SHEET LIST
LP0001	GENERAL LANDSCAPE AND KEY PLAN
LP0001	PARADE LANDSCAPE PLAN
LP0001	TREE PRESERVATION RECORDS PLAN
LP0010	PARADE LANDSCAPE UTILITY PLAN
LP0020	LANDSCAPE DETAILS



PROJECT  
NORTH (PN)

KEYPLAN

#	date	revision	by
3	2023-08-16	ISSUED FOR SPC APPLICATION	IWM
2	2023-07-31	ISSUED FOR 90% DD SUBMISSION	IWM
1	2023-04-20	ISSUED FOR TECHNICAL SUBMISSION	IWM

# date revision by

revisions

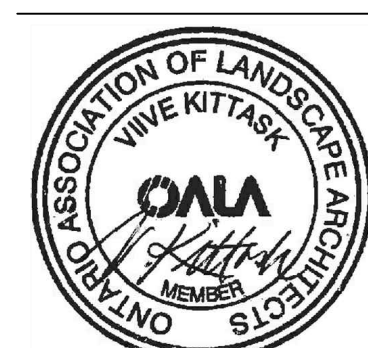

All drawing and specifications are the property of the architect. The contractor shall verify all dimensions and information on site and report any discrepancy to architect before proceeding.

1Door4Care CHEO Integrated Treatment Centre

401 Smyth Rd  
Ottawa, ON K1H 8L1

SHEET LIST

scale:  
drawn by: IWM  
reviewed by: VK  
job number: 2207  
plot date: 2023/08/16  
drawing number:

LP0000

KEYPLAN

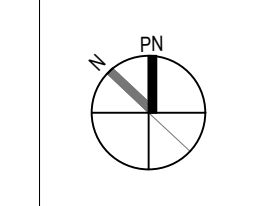

LEGEND

- PROPERTY LINE
- CONCRETE PAVING
- TINTED CONCRETE PAVING
- ASPHALT
- TACTILE ATTENTION INDICATOR
- EXISTING SOG
- SOG
- EXISTING DECIDUOUS TREE TO REMAIN
- EXISTING VEGETATION TO REMAIN
- RESTORATION PLANTING
- DECIDUOUS TREE
- MULTI PURPOSE PATH
- BENCH
- MANHOLE REFER TO CIVIL
- CATCH BASIN REFER TO CIVIL
- FIRE HYDRANT REFER TO CIVIL

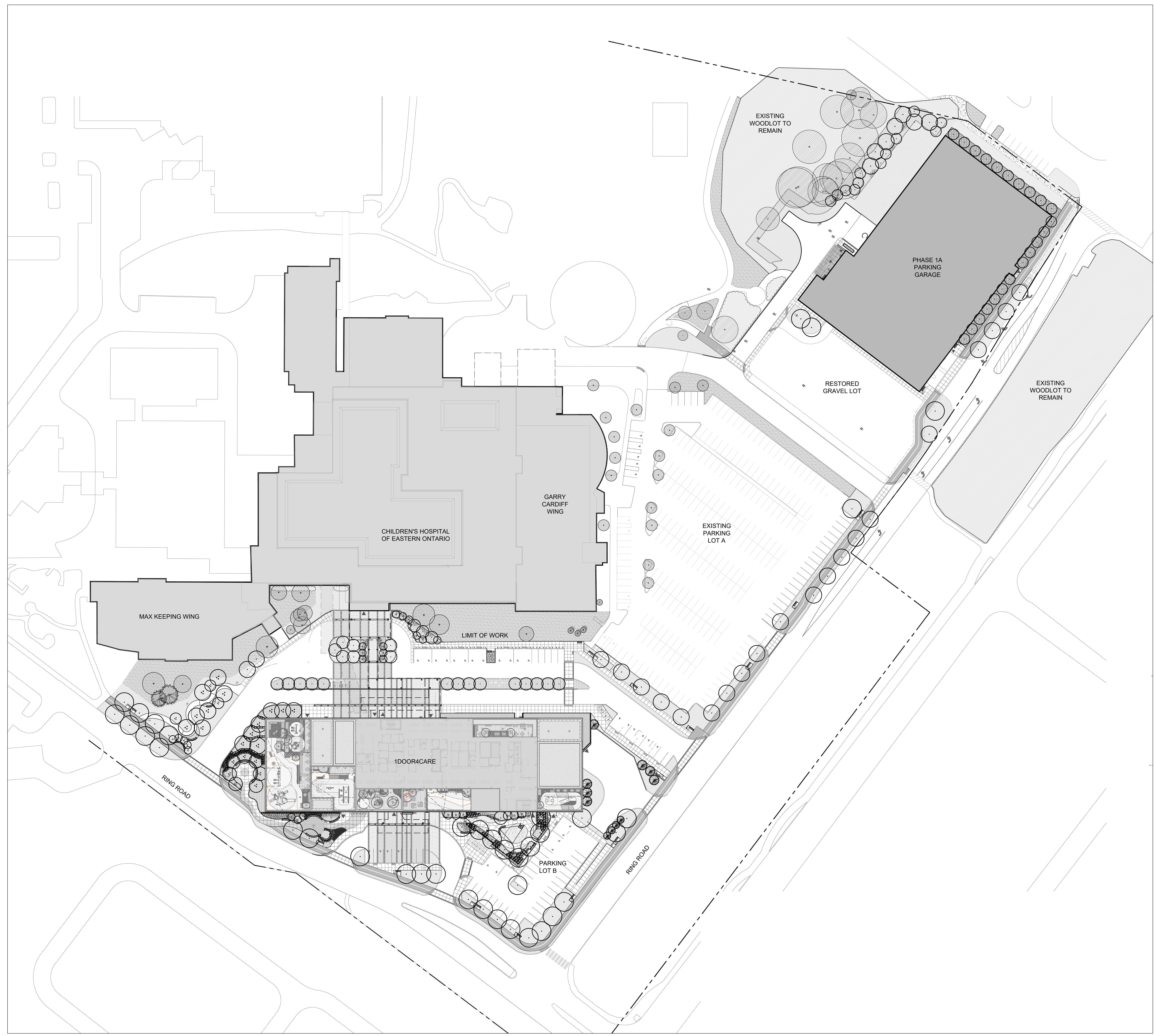

#	date	revision	by
3	2023-08-16	ISSUED FOR SPC APPLICATION	IW
2	2023-07-31	ISSUED FOR 90% DD SUBMISSION	IW
1	2023-04-20	ISSUED FOR TECHNICAL SUBMISSION	IW

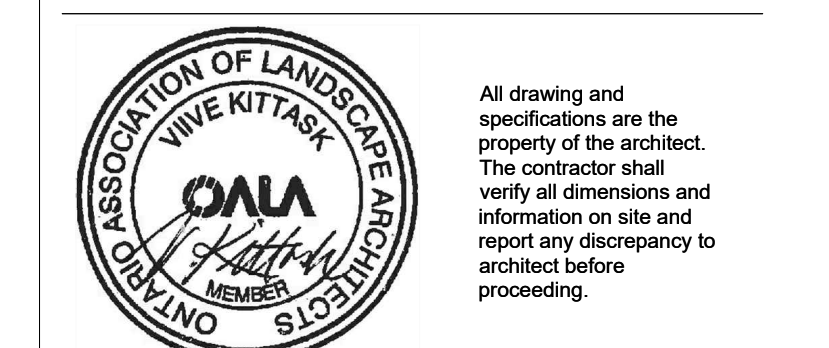

1Door4Care: CHEO Integrated Treatment Centre: Parking Garage

401 Smyth Rd, Ottawa, ON

OVERALL LANDSCAPE AND KEY PLAN

scale: 1:500  
 drawn by: IW/RM  
 reviewed by: VK  
 job number: 2207  
 plot date: 2023/08/16  
 drawing number:

**LP0100**

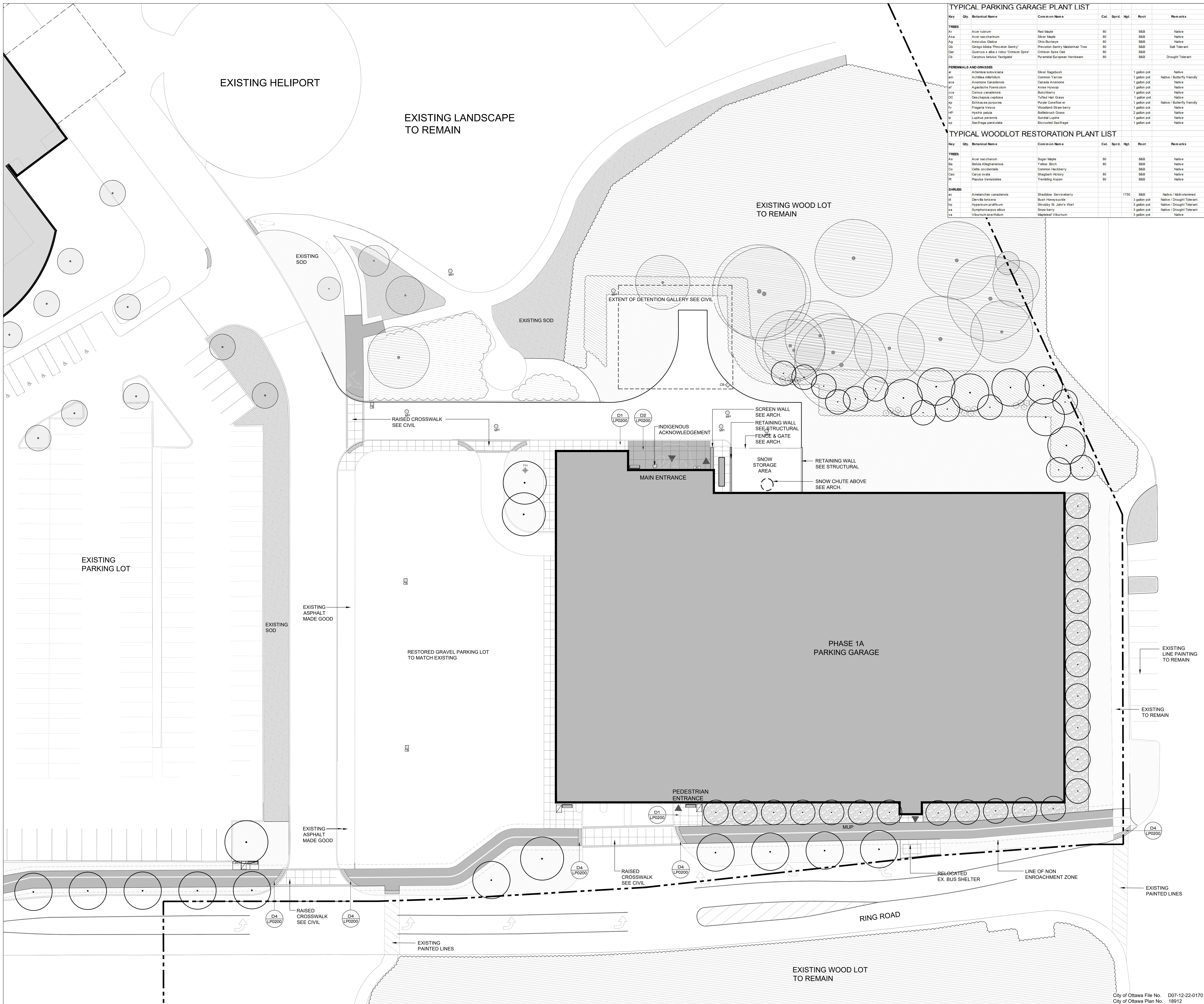

**TYPICAL PARKING GARAGE PLANT LIST**

Key	Qty.	Botanical Name	Common Name	Cal.	Spnd.	Hgt.	Root	Remarks
<b>TREES</b>								
Ar		Acer rubrum	Red Maple	80		8-10	BBB	Native
Asa		Acer saccharum	Silver Maple	80		8-10	BBB	Native
Ag		Aspidodermis glabra	Ohio Buckeye	80		8-10	BBB	Native
Gr		Gingko biloba 'Princeton Sentry'	Princeton Sentry Maidenhair Tree	80		8-10	BBB	Salt Tolerant
Gr		Quercus s. alba x robur 'Crimson Spire'	Crimson Spire Oak	80		8-10	BBB	Native
Gr		Carpinus betulus 'Fastigiat'	Pyramidal European Hornbeam	80		8-10	BBB	Drought Tolerant
<b>PERENNIALS AND GRASSES</b>								
Ar		Alchemilla adonidifolia	Silver Sagebrush			1 gallon pot		Native
Am		Asclepias tuberosa	Common Yellow			1 gallon pot		Native / Butterfly friendly
Ar		Anemone canadensis	Canada Anemone			1 gallon pot		Native
Ar		Asarum canadense	Wild Ginger			1 gallon pot		Native
Ar		Cornus canadensis	Bunchberry			1 gallon pot		Native
DC		Deschampsia cespitosa	Tufted Hair Grass			1 gallon pot		Native / Butterfly friendly
Ar		Echinacea purpurea	Purple Coneflower			1 gallon pot		Native
Fr		Fragaria vesca	Woodland Strawberry			1 gallon pot		Native
Gr		Hymenophyllum wilsonii	Wilson's Spotted Lungwort			1 gallon pot		Native
Gr		Lupinus perennis	Spring Lupine			1 gallon pot		Native
Gr		Saxifraga paniculata	Encrusted Saxifrage			1 gallon pot		Native

**TYPICAL WOODLOT RESTORATION PLANT LIST**

Key	Qty.	Botanical Name	Common Name	Cal.	Spnd.	Hgt.	Root	Remarks
<b>TREES</b>								
Ar		Acer saccharum	Sugar Maple	80		8-10	BBB	Native
Ba		Betula alleghaniensis	Yellow Birch	80		8-10	BBB	Native
Co		Cornus occidentalis	Common Hackberry	80		8-10	BBB	Native
Gr		Corylus avellana	Shagbark Hickory	80		8-10	BBB	Native
Pt		Populus tremuloides	Trembling Aspen	80		8-10	BBB	Native
<b>SHRUBS</b>								
Ar		Amandorcher canadensis	Shadbush Serviceberry	1750		8-10	BBB	Native / Multi-stemmed
Gr		Diervilla lonicera	Bush Honeysuckle			3 gallon pot		Native / Drought Tolerant
Gr		Hesperis matronalis	Matron's Wreath			3 gallon pot		Native / Drought Tolerant
Gr		Symphoricarpos albus	Snow berry			3 gallon pot		Native / Drought Tolerant
Gr		Viburnum acerifolium	Mapleleaf Viburnum			3 gallon pot		Native

**KEYPLAN**

**LEGEND**

- PROPERTY LINE
- CONCRETE PAVING
- TINTED CONCRETE PAVING
- ASPHALT
- TACTILE ATTENTION INDICATOR
- EXISTING SOD
- SOD
- EXISTING DECIDUOUS TREE TO REMAIN
- EXISTING VEGETATION TO REMAIN
- RESTORATION PLANTING
- DECIDUOUS TREE
- MULTI PURPOSE PATH
- BENCH
- MANHOLE REFER TO CIVIL
- CATCH BASIN REFER TO CIVIL
- FIRE HYDRANT REFER TO CIVIL

3	2023-08-16	ISSUED FOR SPC APPLICATION	WV
2	2023-07-31	ISSUED FOR S/N/D SUBMISSION	WV
1	2023-04-20	ISSUED FOR TECHNICAL SUBMISSION	WV

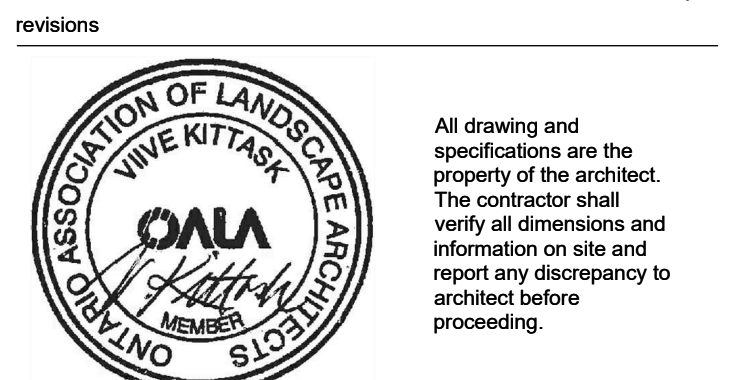

1Door4Care: CHEO Integrated Treatment Centre: Parking Garage

401 Smyth Rd, Ottawa, ON

**PARKADE LANDSCAPE PLAN**

scale: 1/200  
 drawn by: WRM  
 reviewed by: VK  
 job number: 2207  
 plot date: 2023/08/16  
 drawing number:

**LP0101**

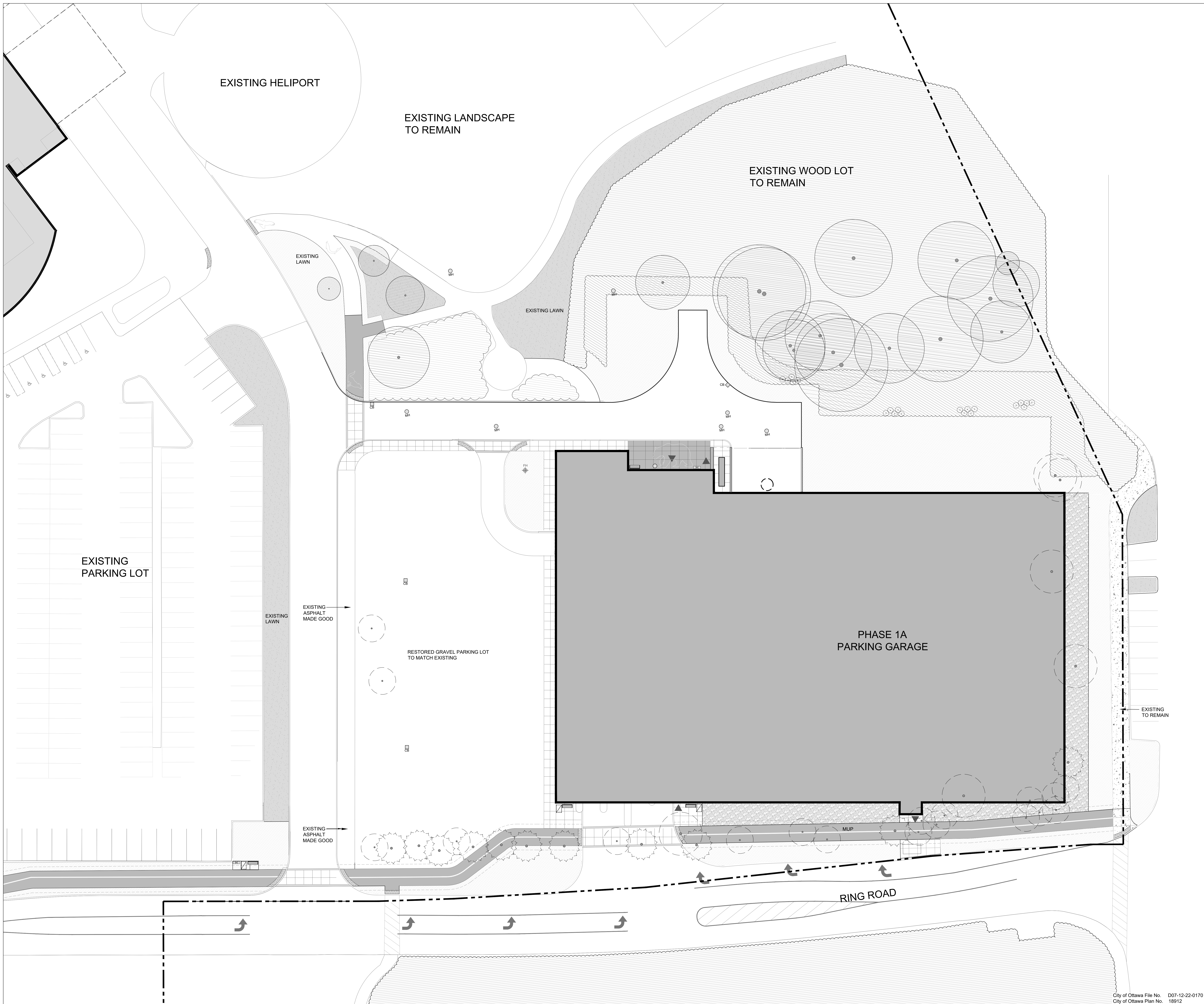

KEYPLAN

- LEGEND
- PROPERTY LINE
  - CONCRETE PAVING
  - TINTED CONCRETE PAVING
  - ASPHALT
  - TACTILE ATTENTION INDICATOR
  - EXISTING SOIL
  - SOIL
  - EXISTING DECIDUOUS TREE TO REMAIN
  - EXISTING DECIDUOUS TREE TO REMOVE
  - EXISTING CONIFEROUS TREE TO REMOVE
  - EXISTING VEGETATION TO REMAIN
  - RESTORATION PLANTING

#	date	revision	by
3	2023-08-16	ISSUED FOR SPC APPLICATION	IW
2	2023-07-31	ISSUED FOR 50% DD SUBMISSION	IW
1	2023-04-20	ISSUED FOR TECHNICAL SUBMISSION	IW

revisions

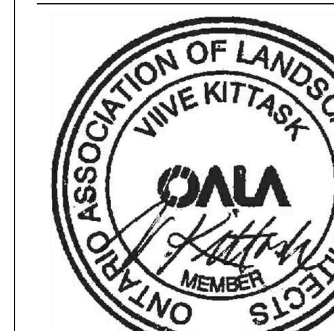

All drawing and specifications are the property of the architect. The contractor shall verify all dimensions and information on site and report any discrepancy to architect before proceeding.

1Door4Care: CHEO Integrated Treatment Centre: Parking Garage

401 Smyth Rd, Ottawa, ON

**PARKADE TREE PRESERVATION & REMOVALS PLAN**

scale: 1/200  
 drawn by: IW/RM  
 reviewed by: VK  
 job number: 2207  
 plot date: 2023/08/16  
 drawing number:

**LP0101T**

LEGEND	
[Symbol]	PROPERTY LINE
[Symbol]	CONCRETE PAVING
[Symbol]	TINTED CONCRETE PAVING
[Symbol]	ASPHALT
[Symbol]	TACTILE ATTENTION INDICATOR
[Symbol]	EXISTING SOD
[Symbol]	EXISTING DECIDUOUS TREES TO REMAIN
[Symbol]	EXISTING VEGETATION TO REMAIN
[Symbol]	RESTORATION PLANTING
[Symbol]	DECIDUOUS TREES
[Symbol]	MULTI-PURPOSE PATH
[Symbol]	BENCH
[Symbol]	PROPOSED WATER LINE
[Symbol]	EXISTING WATER LINE
[Symbol]	PROPOSED STORM LINE
[Symbol]	EXISTING STORM LINE
[Symbol]	PROPOSED SC-740 CHAMBER SEE CIVIL
[Symbol]	PROPOSED SANITARY LINE
[Symbol]	EXISTING SANITARY LINE
[Symbol]	PROPOSED HYDRO DUCTS
[Symbol]	EXISTING UG HYDRO LINES
[Symbol]	MANHOLE REFER TO CIVIL
[Symbol]	PIPE INSULATION SEE CIVIL

#	DATE	REVISION	BY
3	2023-08-16	ISSUED FOR SPC APPLICATION	IW
2	2023-07-31	ISSUED FOR IAWQ D0 SUBMISSION	IW
1	2023-04-20	ISSUED FOR TECHNICAL SUBMISSION	IW

PROFESSIONAL LANDSCAPE ARCHITECT

VERTECHS DESIGN

ALL DRAWING AND SPECIFICATIONS ARE THE PROPERTY OF THE ARCHITECT. THE CONSULTANT SHALL VERIFY ALL DIMENSIONS AND INFORMATION ON SITE AND REPORT ANY DISCREPANCY TO ARCHITECT BEFORE PROCEEDING.

1Door4Care: CHEO Integrated Treatment Centre: Parking Garage

401 Smyth Rd, Ottawa, ON

PARKADE LANDSCAPE UTILITY PLAN

scale: 1/200

drawn by: IWRM

reviewed by: VK

job number: 2007

plot date: 2023/08/16

drawing number: L0602U



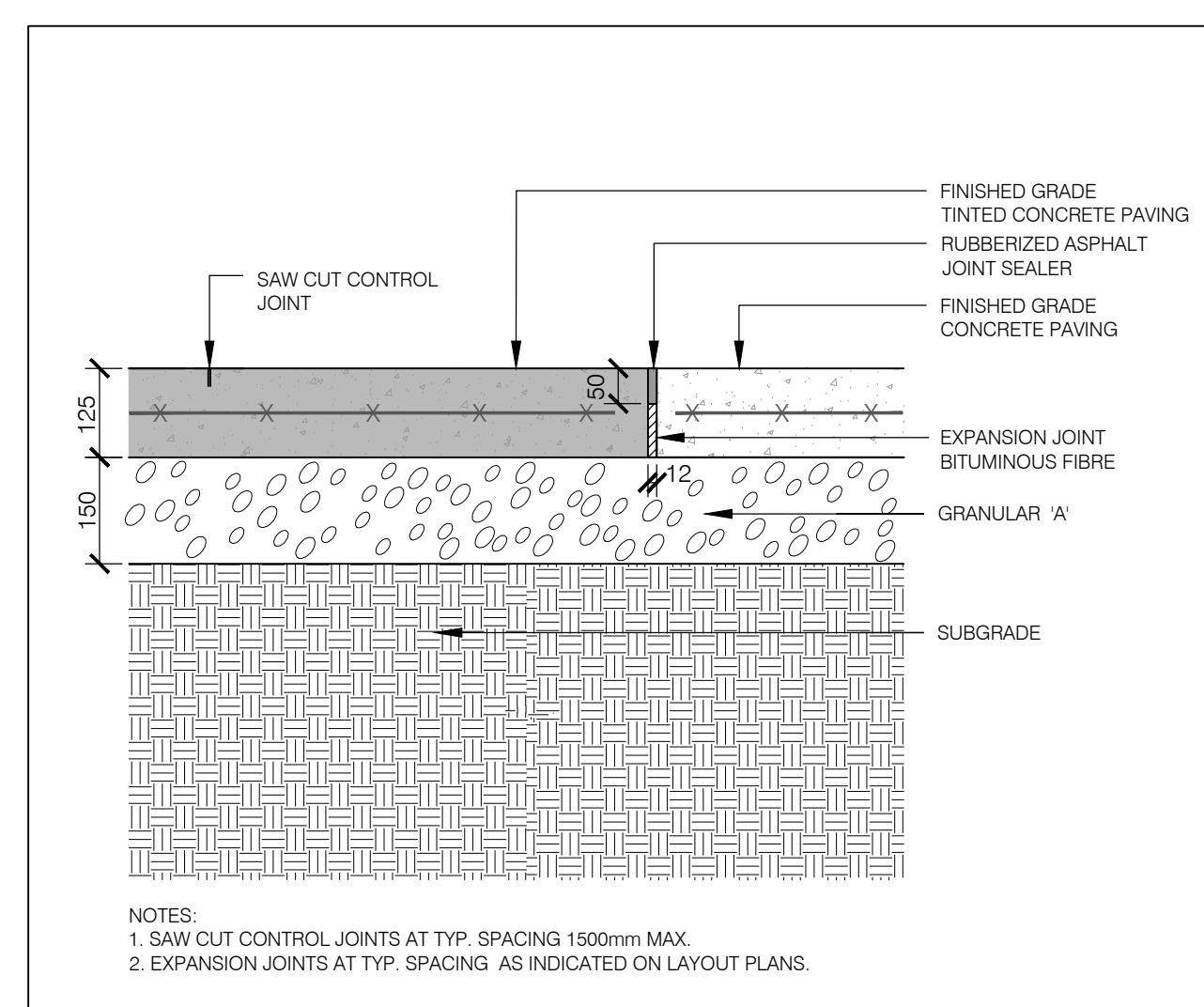

01  
UP000  
**TYPICAL CONCRETE AND TINTED CONCRETE PAVING ON GRADE**  
SECTION  
SCALE 1:10

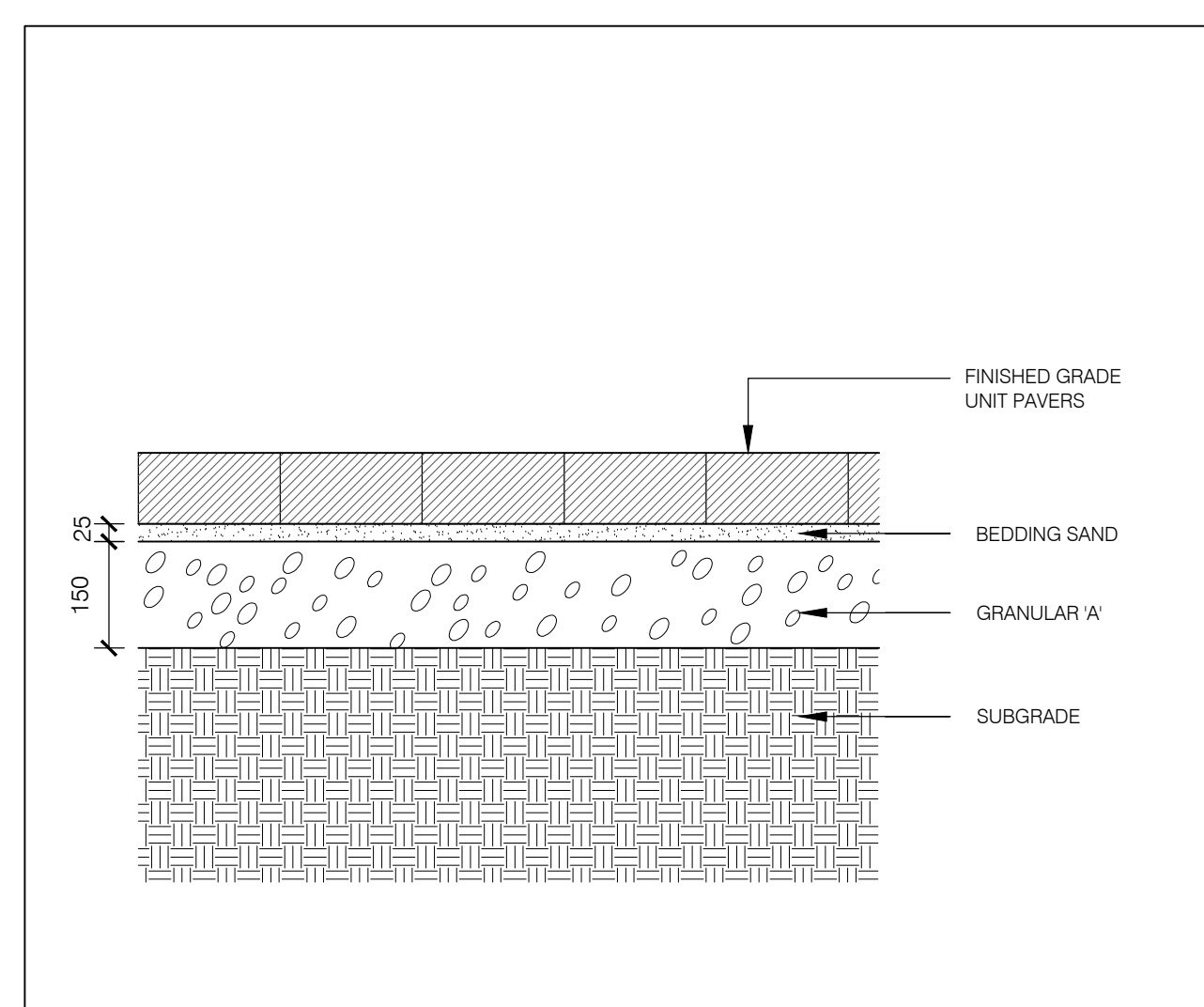

02  
UP000  
**TYPICAL UNIT PAVING ON GRADE**  
SECTION  
SCALE 1:10

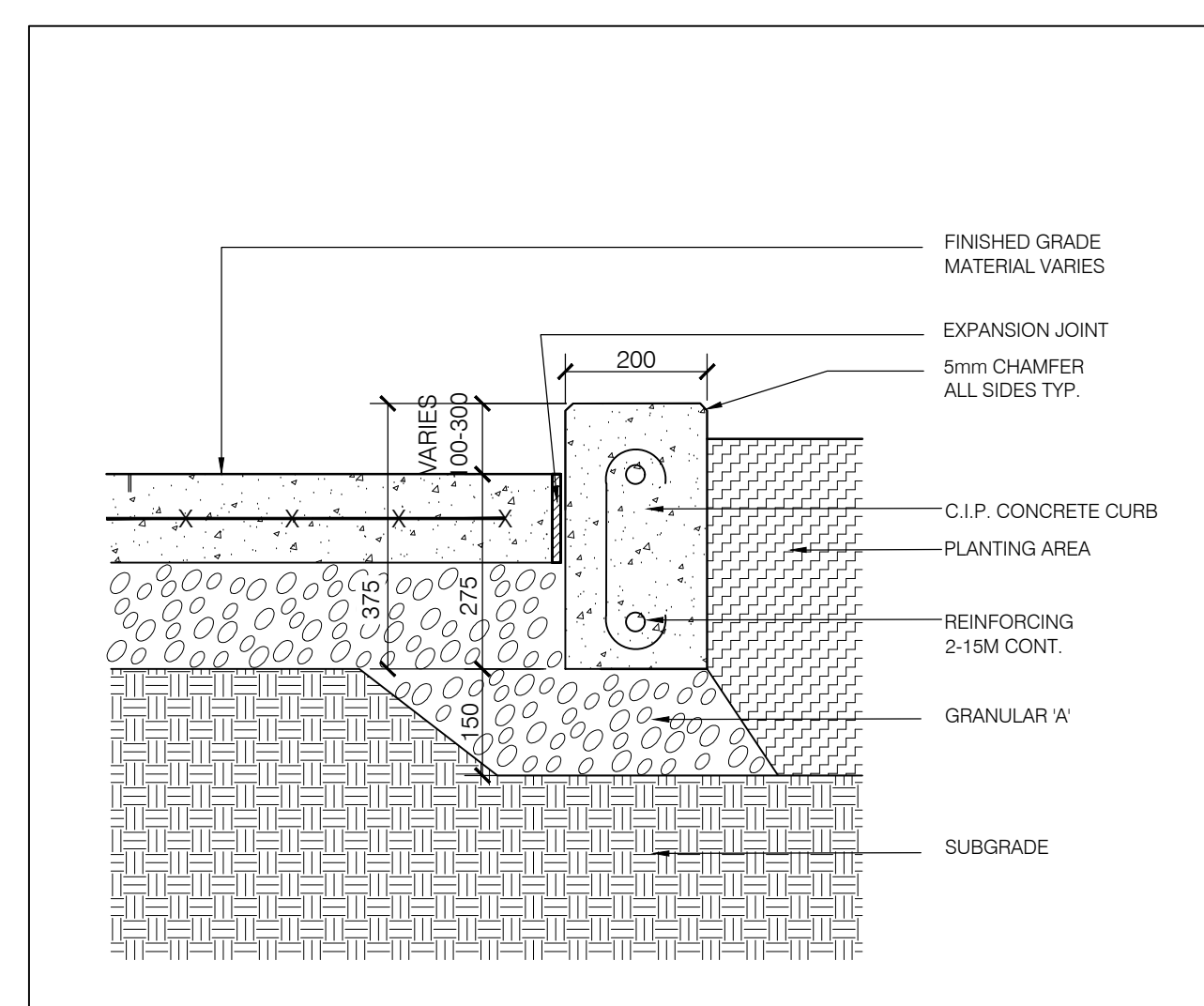

03  
UP000  
**TYPICAL CONCRETE PLANTER CURB ON GRADE**  
SECTION  
SCALE 1:10

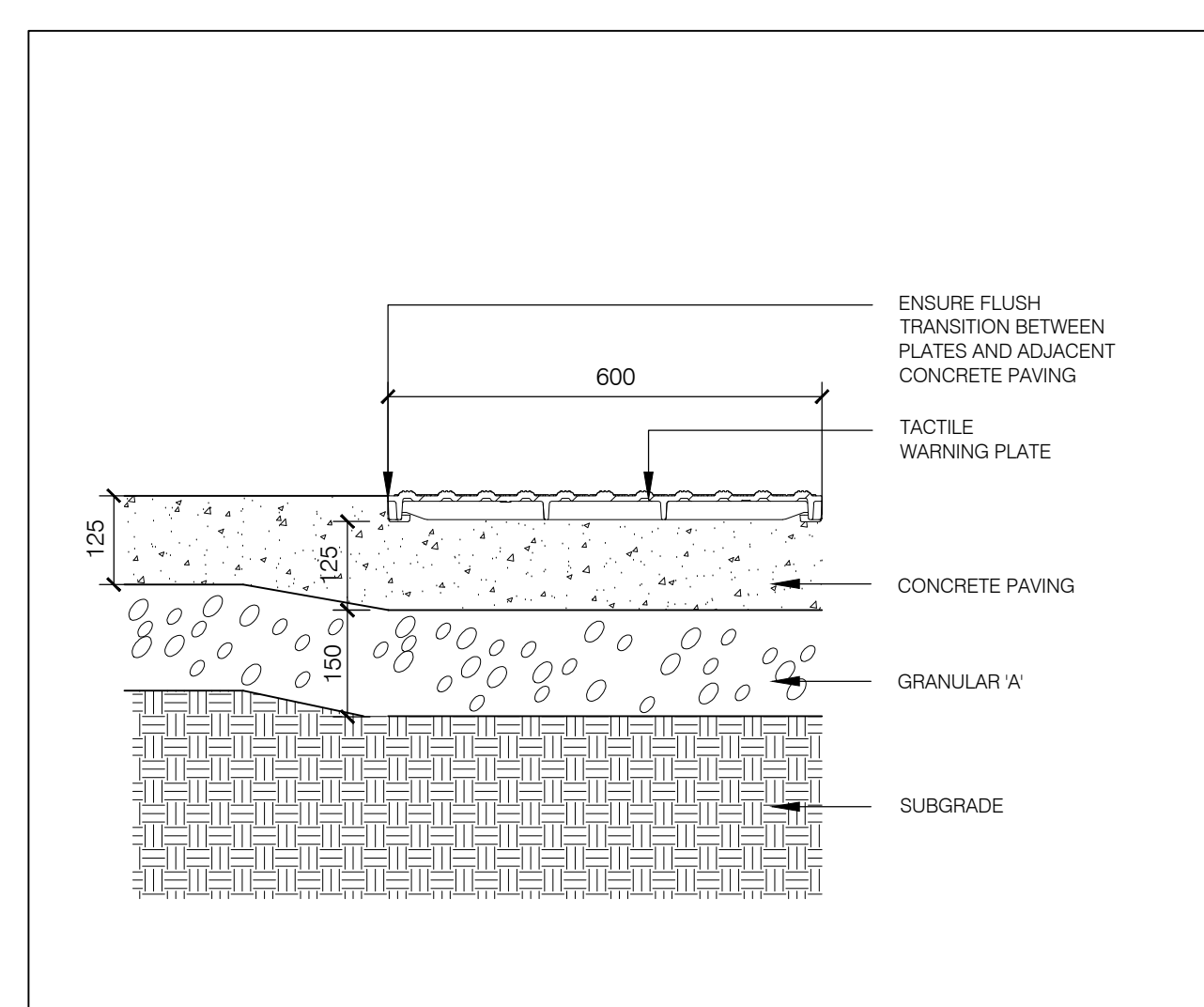

04  
L0001  
**TYPICAL TACTILE ATTENTION INDICATOR**  
SECTION  
SCALE 1:10

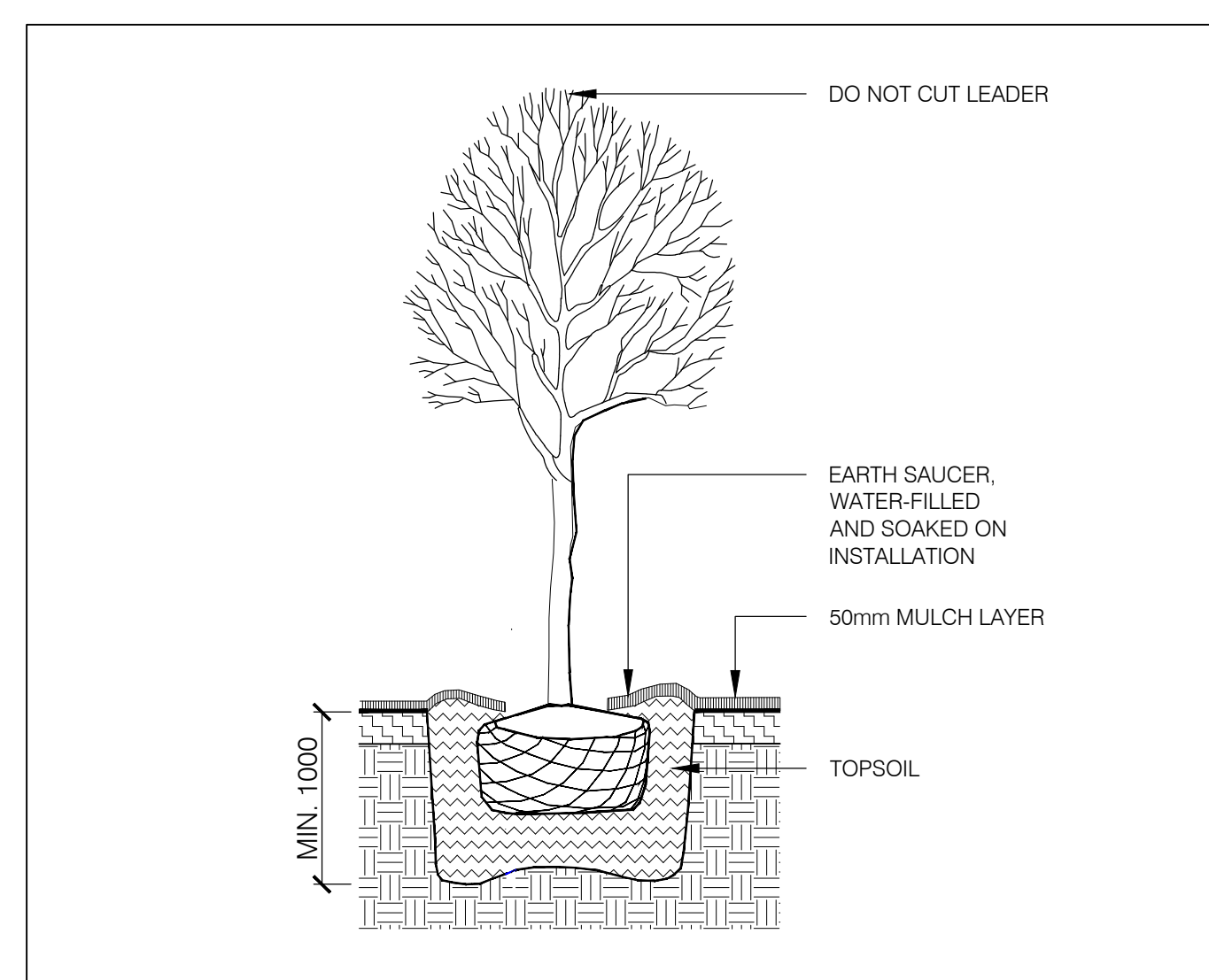

06  
UP000  
**TYPICAL DECIDUOUS TREE PLANTING**  
SECTION  
SCALE 1:25

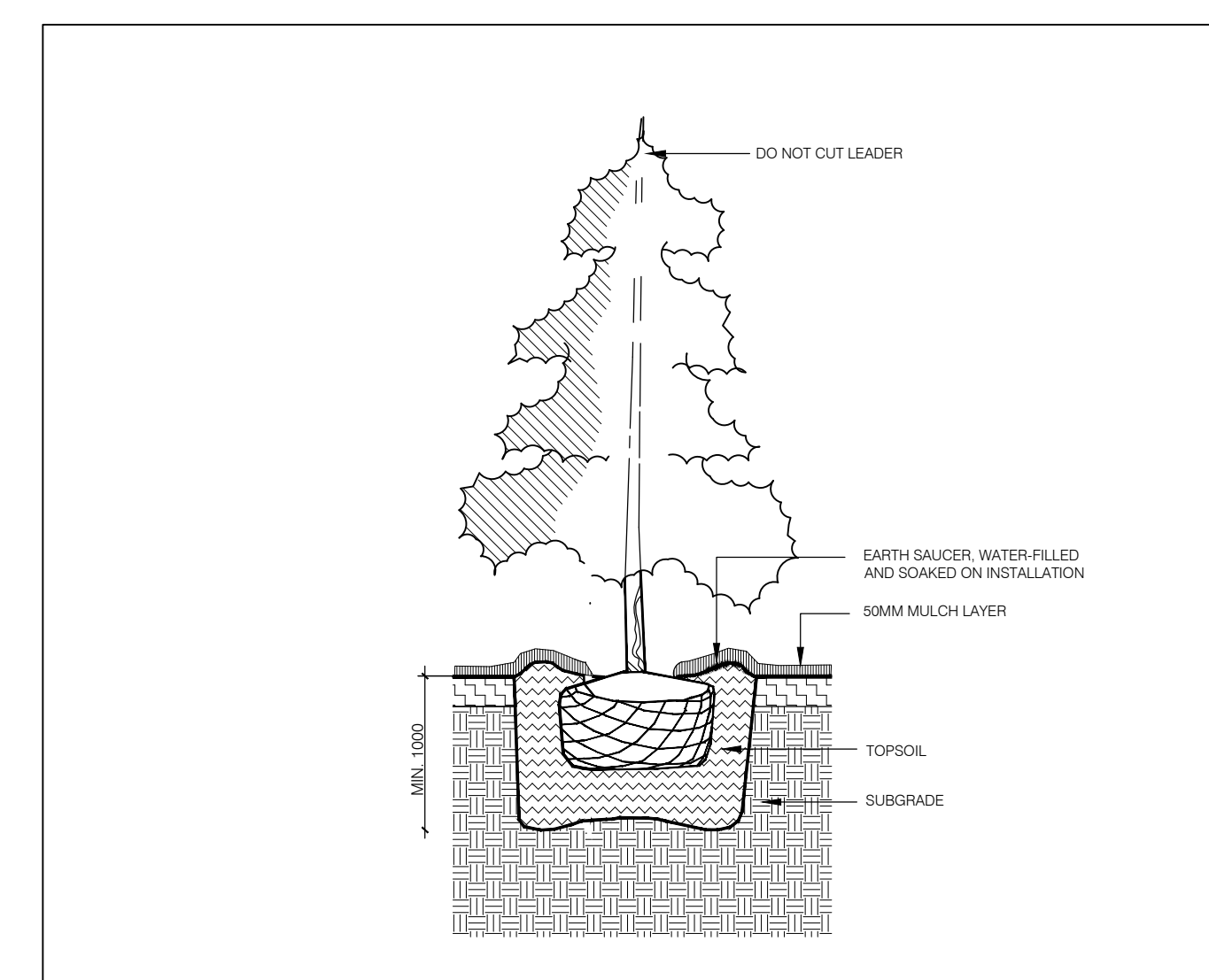

07  
UP000  
**TYPICAL CONIFEROUS TREE PLANTING**  
CITY OF OTTAWA STANDARD DETAIL  
SCALE 1:25

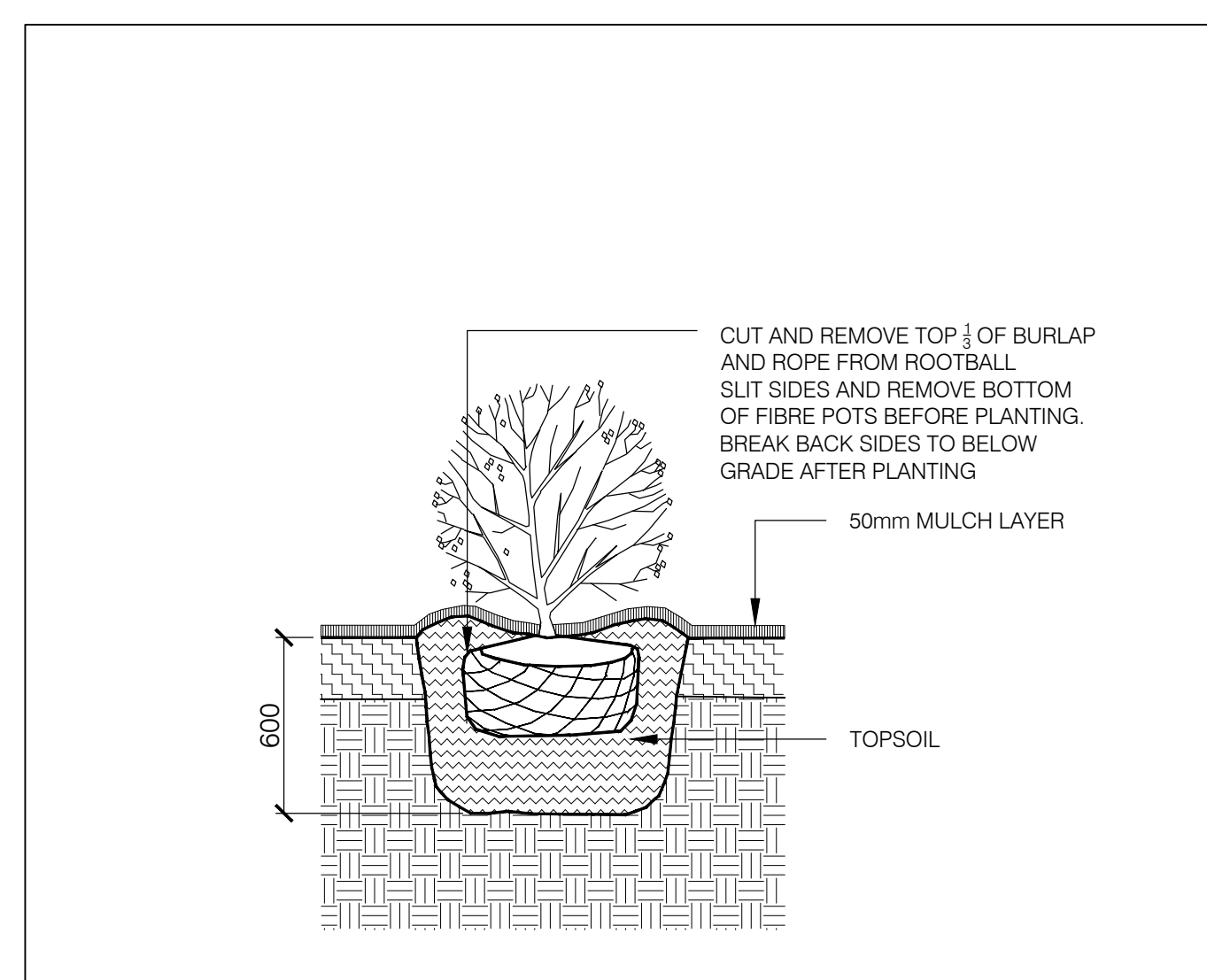

08  
UP000  
**TYPICAL SHRUB PLANTING**  
CITY OF OTTAWA STANDARD DETAIL  
SCALE 1:25

**Esplanade Bench With Tropical Wood Slats**  
PS-840-AL-WD3-WD3-A Esplanade WD-W

Our 'Esplanade' bench features an all-welded aluminum powdercoated frame, and Tropical Wood Slats. Shown here in our 'Pewter' powdercoat finish with IPE wood slats. Available in a variety of sizes and finishes, freestanding or bolt-down.

**HAUSER**  
SITE FURNITURE

Width: 72" (182.9 cm)  
Depth: 27.25" (69.2 cm)  
Height: 31" (78.7 cm)  
Seat Height: 18" (45.7 cm)  
Arm Height: 27" (68.6 cm)

sales@hausersite.com | 1-800-268-7328 | hausersite.com

09  
UP000  
**TYPICAL BENCH TYPE ONE**  
MANUFACTURERS CUT SHEET  
NOT TO SCALE

**MRR-1500-00016**  
Legacy #: LXR1503-48-MS-VGST-VGST-RS

**LEXICON**

**MATERIALS:** The trash/recycle unit is constructed using a steel frame with laser cut and formed steel body panels. Three 9 gallon (33 litre) commercial grade plastic bins and standard metal lids are provided.

**FINISH:** All steel components are protected with 5-Coat hot dipping. The Maglin Powdercoat System provides a durable finish on all metal surfaces.

**INSTALLATION:** The trash/recycle unit is delivered pre-assembled. Holes (3/8") are provided in each mounting foot for securing to base.

**TO SPECIFY:** Select MRR-1500-00016  
Options:  
- Powdercoat Color

HEIGHT: 47.5" (120.7cm)    LENGTH: 39" (99.8cm)    DEPTH: 18" (45.3cm)    WEIGHT: 216.24 lbs (98.9kg)

**MAGLIN**  
SITE FURNITURE

7 400 2nd Ave. S.W.  
Burien, WA 98148  
www.maglin.com  
info@maglin.com

All drawings, specifications, design and details on this page remain the property of Maglin Site Furniture Inc. and may not be used without Maglin's authorization.  
Options and specifications may vary due to manufacturing requirements of our products.

010  
UP000  
**TYPICAL WASTE RECEPTACLE TYPE ONE**  
MANUFACTURERS CUT SHEET  
NOT TO SCALE

#	date	revision	by
3	2023-08-16	ISSUED FOR SPC APPLICATION	WV
2	2023-07-31	ISSUED FOR 90% DD SUBMISSION	WV
1	2023-04-20	ISSUED FOR TECHNICAL SUBMISSION	WV

revisions

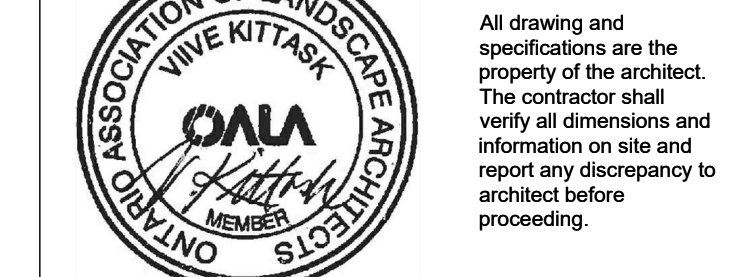

All drawing and specifications are the property of the architect. The contractor shall verify all dimensions and information on site and report any discrepancy to architect before proceeding.

1Door4Care: CHEO Integrated Treatment Centre: Parking Garage  
401 Smyth Rd, Ottawa, ON

**LANDSCAPE DETAILS**

scale: AS SHOWN  
drawn by: WVRM  
reviewed by: VK  
job number: 2207  
plot date: 2023/08/16  
drawing number:

**LP0200**