

THIS PLAN IS TO BE READ IN CONJUNCTION WITH CIVIL PLANS 122151-NLD1&2, 122151-GR1&2 AND 122151-PR1

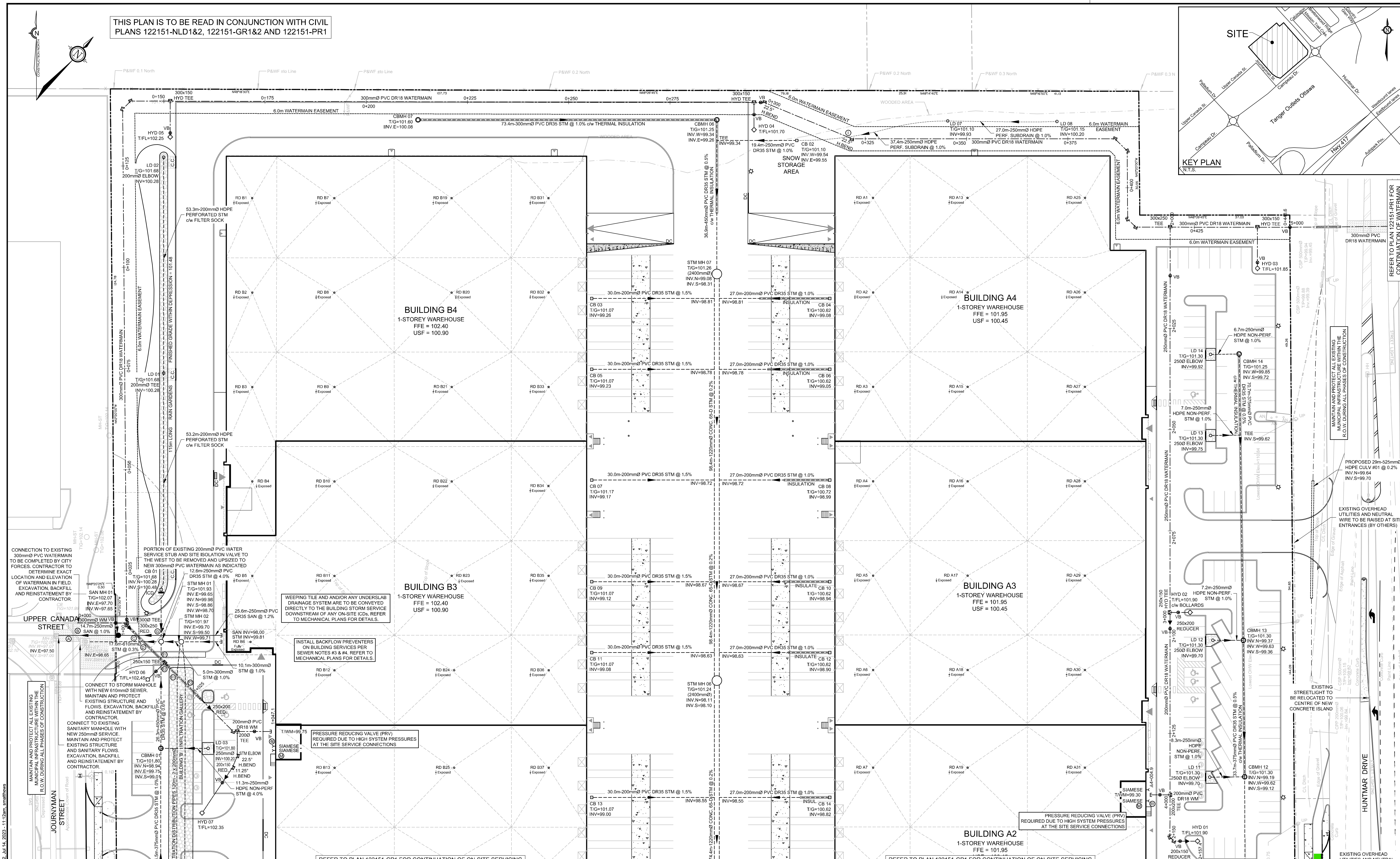
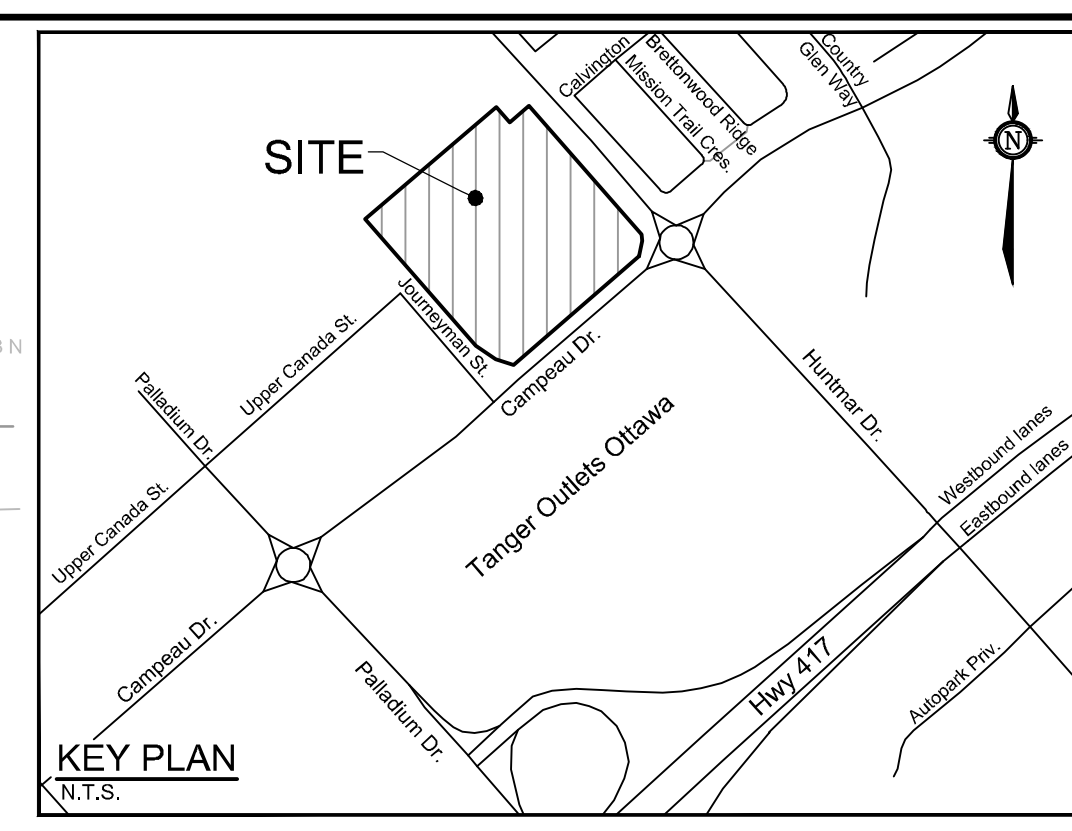

CONNECTION TO EXISTING 300mm Ø PVC WATERMAIN TO BE COMPLETED BY CITY FORCES. CONTRACTOR TO DETERMINE EXACT LOCATION AND ELEVATION OF WATERMAIN IN FIELD. EXCAVATION, BACKFILL AND REINSTATEMENT BY CONTRACTOR.

PORTION OF EXISTING 200mm Ø PVC WATER SERVICE STUB AND SITE ISOLATION VALVE TO THE WEST TO BE REMOVED AND UPSIZED TO NEW 300mm Ø PVC WATERMAIN AS INDICATED. CONTRACTOR TO DETERMINE EXACT LOCATION AND ELEVATION OF WATERMAIN IN FIELD. EXCAVATION, BACKFILL AND REINSTATEMENT BY CONTRACTOR.

WEAVING TILE AND/OR ANY UNDERSLAB DRAINAGE SYSTEM ARE TO BE CONVEYED DIRECTLY TO THE BUILDING STORM SERVICE DOWNSTREAM OF ANY ON-SITE ICDs. REFER TO MECHANICAL PLANS FOR DETAILS.

INSTALL BACKFLOW PREVENTERS ON BUILDING SERVICES PER SEWER NOTES #3 & #4. REFER TO MECHANICAL PLANS FOR DETAILS.

PRESSURE REDUCING VALVE (PRV) REQUIRED DUE TO HIGH SYSTEM PRESSURES AT THE SITE SERVICE CONNECTIONS.

EXISTING OVERHEAD UTILITIES AND NEUTRAL WIRE TO BE RAISED AT SITE ENTRANCES (BY OTHERS).

EXISTING STREIGHTLIGHT TO BE RELOCATED TO CENTRE OF NEW CONCRETE ISLAND.

MAINTAIN AND PROTECT ALL EXISTING MUNICIPAL INFRASTRUCTURE WITHIN THE P.L.O.T. DURING ALL PHASES OF CONSTRUCTION.

NOTE:  
THE POSITION OF ALL POLE LINES, CONDUITS, WATERMANS, SEWERS AND OTHER UNDERGROUND AND OVERGROUND UTILITIES AND STRUCTURES IS NOT NECESSARILY SHOWN ON THE CONTRACT DRAWINGS, AND WHERE SHOWN, THE ACCURACY OF THE POSITION OF SUCH UTILITIES AND STRUCTURES IS NOT GUARANTEED. BEFORE STARTING WORK, DETERMINE THE EXACT LOCATION OF ALL SUCH UTILITIES AND STRUCTURES AND ASSUME ALL LIABILITY FOR DAMAGE TO THEM.

No.	REVISION	DATE	BY
5	ISSUED FOR SITE PLAN APPROVAL	AUG 4/23	DDB
4	ISSUED FOR BUILDING PERMIT	JUL 14/23	DDB
3	REVISED PER CITY COMMENTS	MAY 31/23	DDB
2	REVISED PER CITY COMMENTS	MAR 30/23	DDB
1	ISSUED FOR CITY OF OTTAWA REVIEW	DEC 16/22	DDB

SCALE  
1:400

DESIGN	SM / BM / DDB
CHECKED	DDB
DRAWN	SM
CHECKED	BM / DDB
APPROVED	DDB

**FOR REVIEW ONLY**

**NOVATECH**  
Engineers, Planners & Landscape Architects  
Suite 200, 240 Michael Cowpland Drive  
Ottawa, Ontario, Canada K2M 1P6  
Telephone: (613) 254-8643  
Facsimile: (613) 254-8867  
Website: www.novatech-eng.com

LOCATION  
CITY OF OTTAWA  
405 HUNTMAR DRIVE - WAREHOUSE DEVELOPMENT

DRAWING NAME  
GENERAL PLAN OF SERVICES

PROJECT No. 122151  
REV # 5  
DRAWING No. 122151-GP2

D07-12-22-0186

#18906