

APPROVED
By Adam Brown at 3:09 pm, Jul 25, 2023

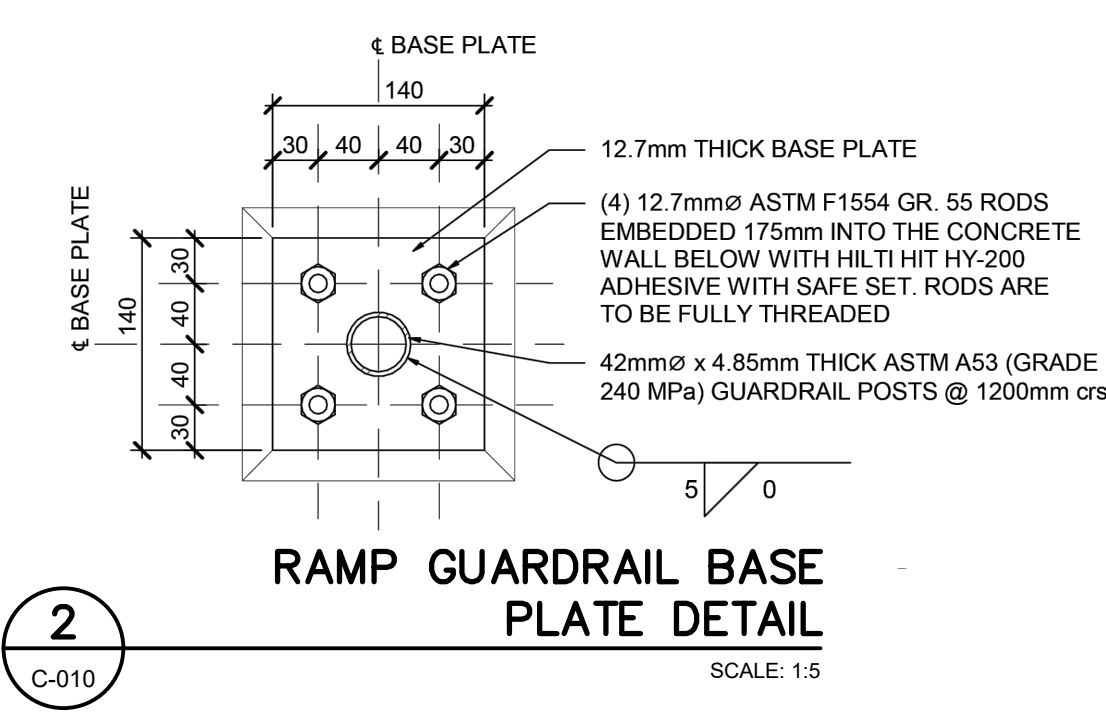

ADAM BROWN
MANAGER, DEVELOPMENT REVIEW - RURAL
PLANNING, REAL ESTATE & ECONOMIC DEVELOPMENT
DEPARTMENT, CITY OF OTTAWA



RETAINING WALL NOTES:

- DESIGN BASED ON CSA S6-19 AND OBC 2012 (AMENDED 2020). LOADING AS FOLLOWS:
 - BACKFILL PRESSURES IN ACCORDANCE WITH GOLDERWSP GEOTECHNICAL REPORT.
 - LIVE LOAD SURCHARGE PRESSURE: 12 kPa
 - COMPACTION PRESSURES AS PER CSA S6-19.
 - DRAINED BACKFILL CONDITIONS
 - DESIGN FOR SEISMIC PRESSURES AS PER CSA S6-19 AND GOLDERWSP GEOTECHNICAL REPORT.
 - GUARDRAIL HAS BEEN DESIGNED IN ACCORDANCE WITH OBC 2012, CLAUSE 4.1.5.14 FOR LOCATIONS WITH LIMITED OCCUPANCY WHERE GATHERING OF MANY PEOPLE IS IMPROBABLE.
- FOUNDATIONS SHALL BE FOUNDED ON NATIVE WEATHERED CLAY CRUST WITH A MINIMUM BEARING CAPACITY OF 165 kPa (ULS) AND 125 kPa (SLS).
- CAST-IN-PLACE CONCRETE: CLASS 'C1', MINIMUM SPECIFIED COMPRESSIVE STRENGTH = 35 MPa @ 56 DAYS.
- ALL REINFORCING TO CSA G30.18, GRADE 400W.
- ALL LAP SPLICES SHALL BE CLASS 'B' LAP SPLICES IN ACCORDANCE WITH CSA A23.3-14.
- MINIMUM COVER IS 75mm CAST DIRECTLY AGAINST SOIL AND 60mm EXPOSED TO SALTS AND CHLORIDES.
- STEEL DESIGN IN ACCORDANCE WITH CSA S16-14.

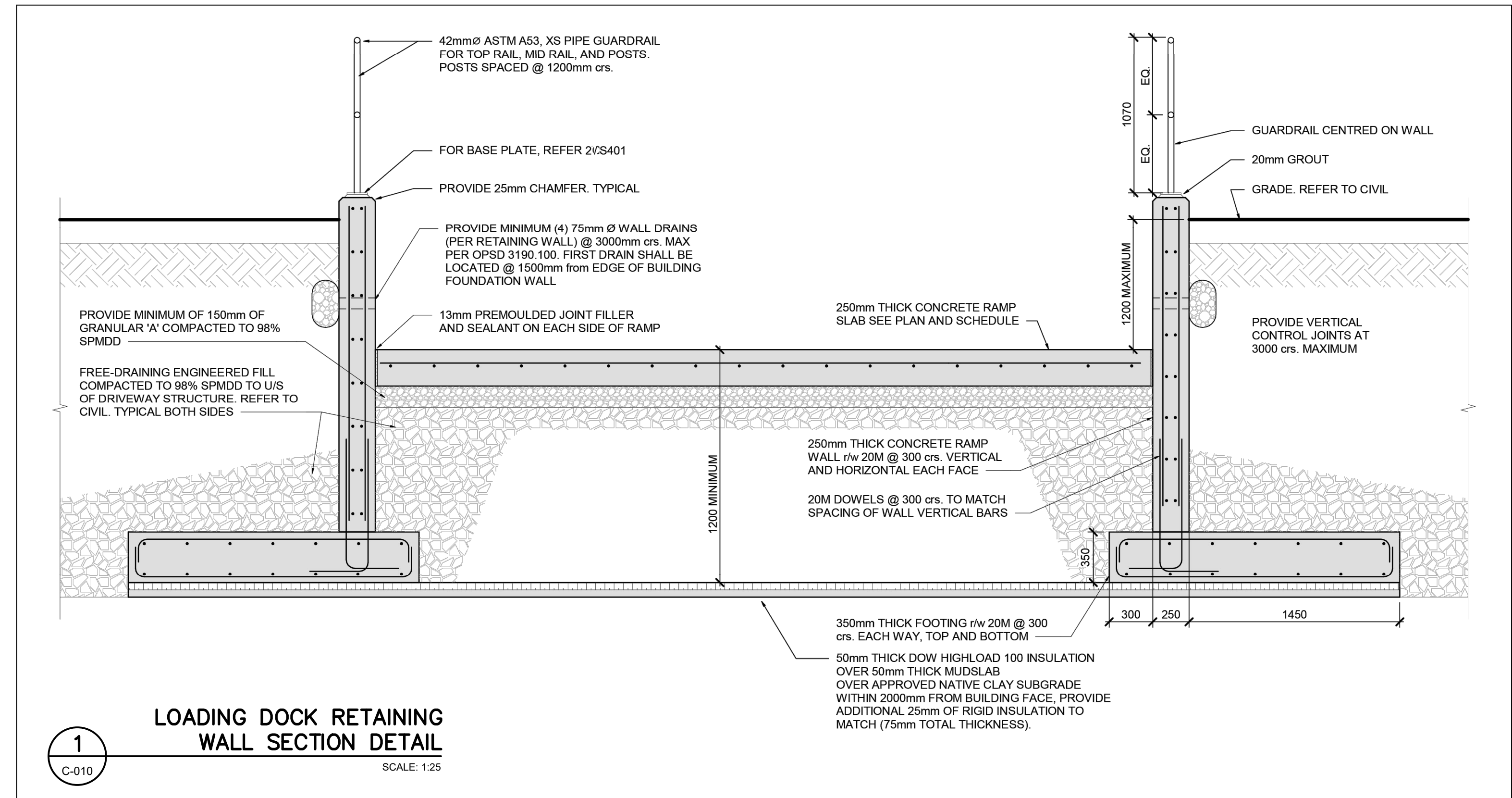

No.	ISSUE / REVISION	DDMMYY
06	CITY OFS COMMENTS	08/06/23
05	RE-ISSUED FOR CITY SITE PLAN APPROVAL	11/05/23
04	CITY SITE PLAN APPROVAL	17/03/23
03	ISSUED FOR CITY SITE PLAN APPROVAL	21/12/22
02	RE-ISSUED FOR CITY SITE PLAN APPROVAL	12/09/22
01	ISSUED FOR CITY SITE PLAN APPROVAL	06/04/22
00	ISSUED FOR CLIENT REVIEW	04/04/22

THESE DRAWINGS HAVE BEEN PRODUCED BY J.L. RICHARDS & ASSOCIATES LIMITED AND ARE SUBJECT TO COPYRIGHT AND USE RESTRICTIONS SET OUT IN THE APPLICABLE PROJECT CONTRACT. ANY USE, REUSE, OR MODIFICATION OF THESE DRAWINGS FOR PURPOSES OTHER THAN THE ORIGINAL PROJECT OR EXECUTION OF THE DESCRIBED WORK IS NOT PERMITTED OR ENDORSED WITHOUT THE PRIOR WRITTEN AUTHORIZATION OF J.L.R. J.L.R. MAKES NO WARRANTIES, EITHER EXPRESS OR IMPLIED, OF THE SUITABILITY OR FITNESS OF THESE DRAWINGS FOR ANY OTHER PURPOSE, AND ANY PARTY WHICH CHOOSES TO USE, MODIFY, OR OTHERWISE RELY ON THESE DRAWINGS WITHOUT J.L.R.'S AUTHORIZATION ACCEPTS THESE LIMITATIONS AND DOES SO AT THEIR SOLE RISK AND WITHOUT LIABILITY TO J.L.R.

VERIFY SHEET SIZE AND SCALES. THE BAR TO THE RIGHT IS 25mm IF THIS IS A FULL SIZE DRAWING. 0 25mm

SCALE:

CLIENT:



CONSULTANT: www.jrichards.ca



CONSULTANT:

PROFESSIONAL STAMP PROJECT NORTH

PROJECT:

HYDRO ONE OPERATIONS CENTRE, ORLEANS
3440 FRANK KENNY ROAD

DRAWING:

LOADING DOCK DETAILS

DESIGN: M.D.
DRAWN: G.C.
CHECKED: D.U.
JLR #: 31500-000

DRAWING #:
C-010

PLOT DATE: July 20, 2023 2:00:11 PM