

GERALDINE WILDMAN
 ACTING MANAGER, DEVELOPMENT REVIEW, EAST
 PLANNING, REAL ESTATE & ECONOMIC DEVELOPMENT
 DEPARTMENT, CITY OF OTTAWA

APPROVED
 By Geraldine Wildman at 12:02 pm, Jul 21, 2023

UTILITY CROSSING

- ① 300mm STORM INV=64.51
150mm WATER T/P=63.80
CLEAR=0.73m
- ② 450mm STORM INV=64.10
150mm WATER T/P=63.30
CLEAR=0.80m
- ③ 600mm STORM T/P=63.955
150mm WATER B/P=64.50
CLEAR=0.545m
- ④ 600mm STORM INV=64.347
200mm SANITARY T/P=62.47
CLEAR=1.48m
- ⑤ 150mm WATER BOTT/P=65.35
200mm SANITARY T/P=62.57
CLEAR=2.78m
- ⑥ 150mm WATER B/P=65.45
750mm STORM T/P=64.866
CLEAR=0.56m
- ⑦ 150mm WATER T/P=65.25
200mm STORM INV=65.75
CLEAR=0.5m

LEGEND:

- WV WATER VALVE
- HYD FIRE HYDRANT
- CB CATCH BASIN
- MH MANHOLE
- CBMH CATCHBASIN MANHOLE
- OF OVERFLOW MANHOLE

SANITARY SEWER INVERTS

- MH-A - 1200 DIA.
FRAME S25/COVER S24
EX. SW INV. 61.55m
E INV. 62.10m
RIM ELEV. 67.00m
- MH-B - 1200 DIA.
FRAME S25/COVER S24
NE INV. 63.00m TOP
W INV. 62.43m BOTTOM
RIM ELEV. 67.30m
- SERVICE STUB
1.4m-200mm DIA. PVC BUILDING
SANITARY SERVICE AT 3.0%
INV. 63.04m

STORM SEWER INVERTS

- EXISTING MH
600x600mm COVER S19.1
EX. SW INV. 63.258m
RIM ELEV. 67.18m
- MH 1 - 1200mm DIA.
FRAME S25/COVER S24.1
NW INV. 65.07
NE INV. 64.93
SE INV. 64.99m
RIM ELEV. 66.58m
- MH 2 - 1200mm DIA.
FRAME S25/COVER S24.1
NW INV. 65.15m
NE INV. 64.90m
SE INV. 64.70m
RIM ELEV. 67.18m
- MH 3 - 1800mm DIA.
FRAME S25/COVER S24.1
NW INV. 64.35m
NE INV. 64.35m
RIM ELEV. 67.42m
- MH 4B - 1800mm DIA.
FRAME S25/COVER S24.1
NW INV. 65.94m
NE INV. 64.28m
SW INV. 64.18m
RIM ELEV. 67.24m
- MH 4 - 1800mm DIA.
FRAME S25/COVER S24.1
NW INV. 65.94m
NE INV. 64.28m
SW INV. 64.18m
RIM ELEV. 67.24m
- MH 4A - 1800mm DIA.
FRAME S25/COVER S24.1
NW INV. 65.95m
NE INV. 64.17m
SW INV. 64.17m
RIM ELEV. 67.38m
- MH 4 - 1800mm DIA.
FRAME S25/COVER S24.1
NW INV. 65.10m
NE INV. 64.12m
SW INV. 64.12m
RIM ELEV. 67.20m
- MH 5 - 1200mm DIA.
FRAME S25/COVER S24.1
NW INV. 63.34m
NE INV. 63.31m
SW INV. 63.30m
W/300mm ORIFICE
RIM ELEV. 67.28m
- MH 6 - 1200mm DIA.
FRAME S25/COVER S24.1
NW INV. 63.31m
NE INV. 63.30m
SW INV. 63.30m
RIM ELEV. 67.28m
- MH 7 - 1200mm DIA.
FRAME S25/COVER S24.1
NW INV. 64.05m
SE INV. 64.05m
RIM ELEV. 66.60m
- MH 8 - 1200mm DIA.
FRAME S25/COVER S24.1
NW INV. 63.31m
NE INV. 64.38m
SW INV. 64.11m
RIM ELEV. 65.70
- MH 9 - 1200mm DIA.
FRAME S25/COVER S24.1
NW INV. 65.07m
SW INV. 64.63m
RIM ELEV. 66.55m
- STORAGE CHAMBER 1 -
30m 2400mmx1800mm
CONCRETE BOX
NW INV. 63.37m
SW INV. 63.34m
- STORAGE CHAMBER 2 -
15m 2400mmx1800mm
CONCRETE BOX
NW INV. 64.02m
SE INV. 63.17m
SW INV. 63.36m
SE INV. 63.36m
- OF1 - OVERFLOW MANHOLE
INV 65.20m
RIM 67.11m
- OF2 - OVERFLOW MANHOLE
INV 65.17m
RIM 67.00m
- OF3 - OVERFLOW MANHOLE
INV 65.19m
RIM 66.95m
- OF4 - OVERFLOW MANHOLE
INV 65.20m
RIM 66.80m
- TWCB 10
600x600mm COVER S19.1
SE INV. 64.35m
RIM ELEV. 65.55m
- CB 11
600x600mm COVER S19.1
SE INV. 64.65m
RIM ELEV. 65.85m
- CB 12
600x600mm COVER S19.1
SE INV. 65.20m
RIM ELEV. 66.40m
- CB 13
600x600mm COVER S19.1
NE INV. 65.17m
S INV. 65.12m
RIM ELEV. 66.50m
- CB 14
600x600mm COVER S19.1
NE INV. 65.20m
RIM ELEV. 66.40m
- CB 15
600x600mm COVER S19.1
NE INV. 65.00m
RIM ELEV. 67.00m
- CB 16
600x600mm COVER S19.1
NE INV. 65.90m
RIM ELEV. 67.10m
- CB 17
600x600mm COVER S19.1
NE INV. 65.50m
RIM ELEV. 67.15m
- CB 18
600x600mm COVER S19.1
NE INV. 65.90m
RIM ELEV. 67.10m
- CB 19
600x600mm COVER S19.1
NE INV. 66.00m
RIM ELEV. 67.10m
- CB 20
600x600mm COVER S19.1
NW INV. 65.50m
RIM ELEV. 67.10m
- CB 21
600x600mm COVER S19.1
NW INV. 65.80m
RIM ELEV. 67.15m
- CB 22
600x600mm COVER S19.1
NW INV. 65.68m
RIM ELEV. 67.08m
- CB 23
600x600mm COVER S19.1
NW INV. 64.11m
RIM ELEV. 67.00m
- CBMH 24 - 1200mm DIA.
FRAME S25/COVER S24.1
NW INV. 66.13m
RIM ELEV. 67.80m
- CB 25
600x600mm COVER S19.1
NW INV. 66.40m
RIM ELEV. 67.70m
- CB 26
300mm COVER S31
NW INV. 65.90m
RIM ELEV. 67.10m
- CB 27
300mm COVER S31
NW INV. 65.15m
RIM ELEV. 66.35m
- CB 28
300mm COVER S31
NW INV. 64.44m
RIM ELEV. 65.50m
- CB 29
300mm COVER S31
NW INV. 65.10m
RIM ELEV. 67.10m
- CB 30
300mm COVER S31
NW INV. 65.10m
RIM ELEV. 67.30m

ALL EXISTING INVERTS TO BE FIELD CHECKED
 PRIOR TO CONSTRUCTION

SWM CRITERIA
 5 YEAR RELEASE RATE = 254.3 L/S
 100 YEAR RELEASE RATE = 254.3 L/S
 100 YEAR STORAGE VOLUME = 161.9m³

BUILDING
 USF = 11,789 m²

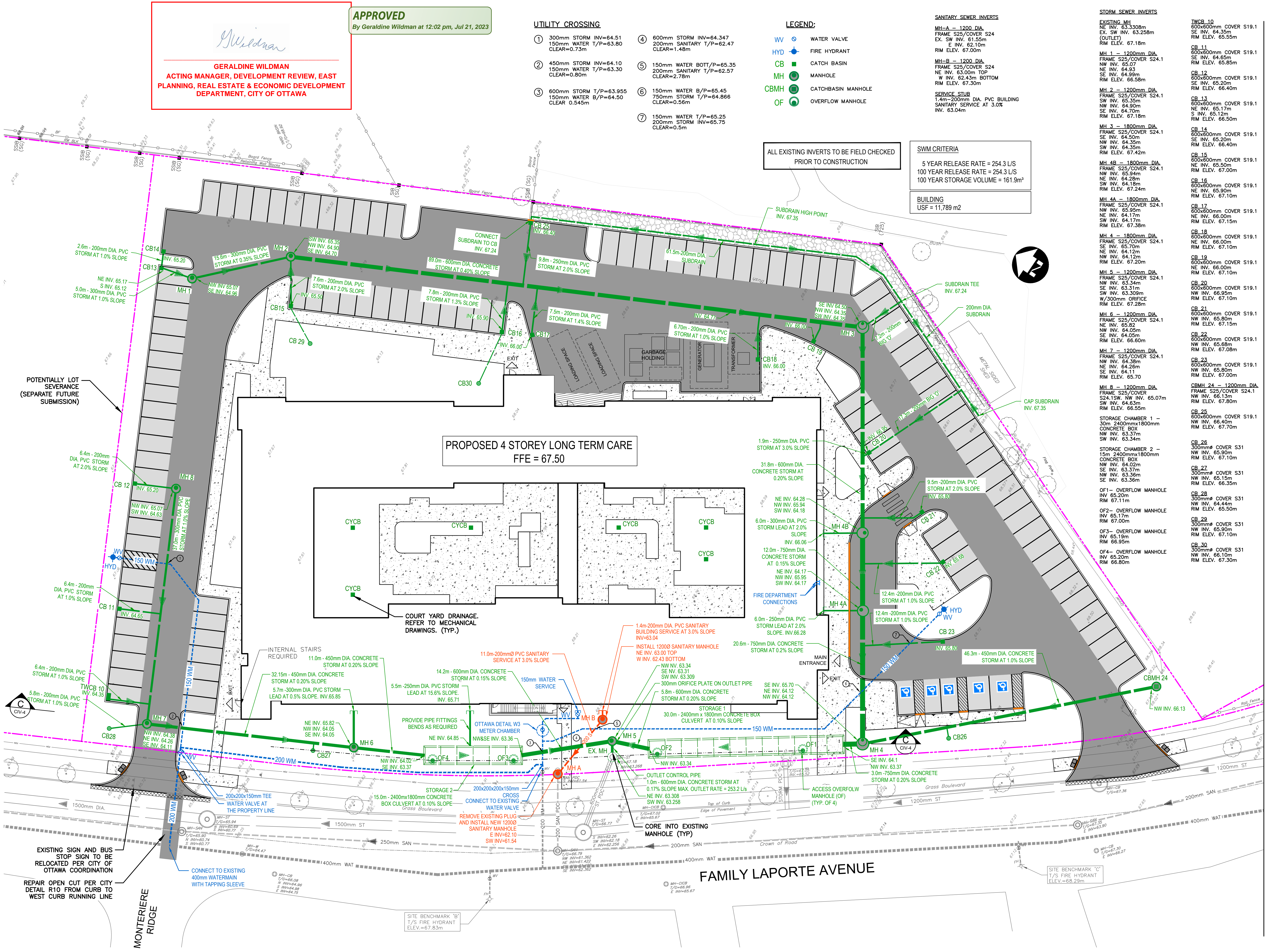

Conditions of Use
 Verify elevations and/or dimensions on drawing prior to use.
 Report any discrepancies to Dillon Consulting Limited.
 Do not scale dimensions from drawing.
 Do not modify drawing, re-use it, or use it for purposes other
 than those intended at the time of its preparation without prior
 written permission from Dillon Consulting Limited.



#	date:	revision:	by:
5	24/03/2023	RE-ISSUED FOR SITE PLAN CONTROL APPLICATION AND ZONING BY-LAW AMENDMENT	CDP, DS
4	27/01/2023	RE-ISSUED FOR SITE PLAN CONTROL APPLICATION AND ZONING BY-LAW AMENDMENT	CDP, DS
3	27/01/2023	ISSUED FOR BUILDING PERMIT	CDP, DS
2	19/08/2022	RE-ISSUED FOR SITE PLAN CONTROL APPLICATION AND ZONING BY-LAW AMENDMENT	CDP, DS
1	12/02/2021	SPA / ZBA SUBMISSION	CDP

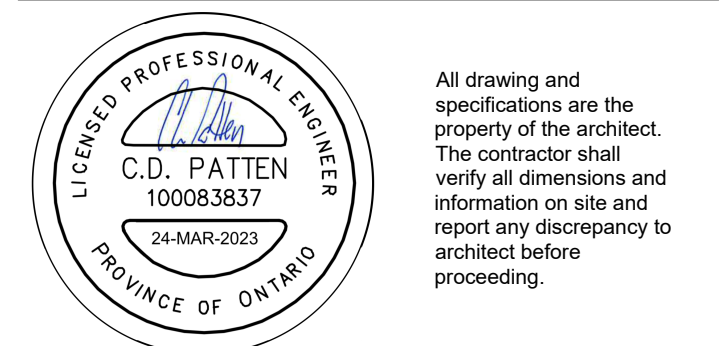

Arch Corp - Orleans

375 FAMILLE-LAPORTE AVENUE (formerly 1161 OLD MONTREAL RD.),
 ORLEANS ON, K4A 3N6

SITE SERVICING PLAN

scale: 1:250
 drawn by: DS
 reviewed by: CDP
 job number: 21-2647
 plot date: March 24, 2023

drawing number: **CIV-1**

FILENAME: C:\P\WORKING\DIRECTOR\PROJECTS\2021\2021-03-24\21-2647-00-CIV-CON-DWG PLOTTED BY: STODCA, DORINA
 PLOT DATE: 2023-03-24 @ 3:35:33 PM PLOT SCALE: 1:254 PLOT STYLE: DILLON-STANDARD.CBT

18897