

HALF MOON BAY SOUTH PHASE 8

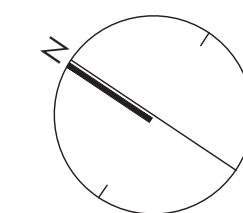

LIST OF DRAWINGS:

- L-01 - LANDSCAPE PLAN
- L-02 - LANDSCAPE PLAN
- D-01 - DETAILS
- D-02 - DETAILS
- D-03 - ROW CROSS-SECTION



KEYMAP
1:750

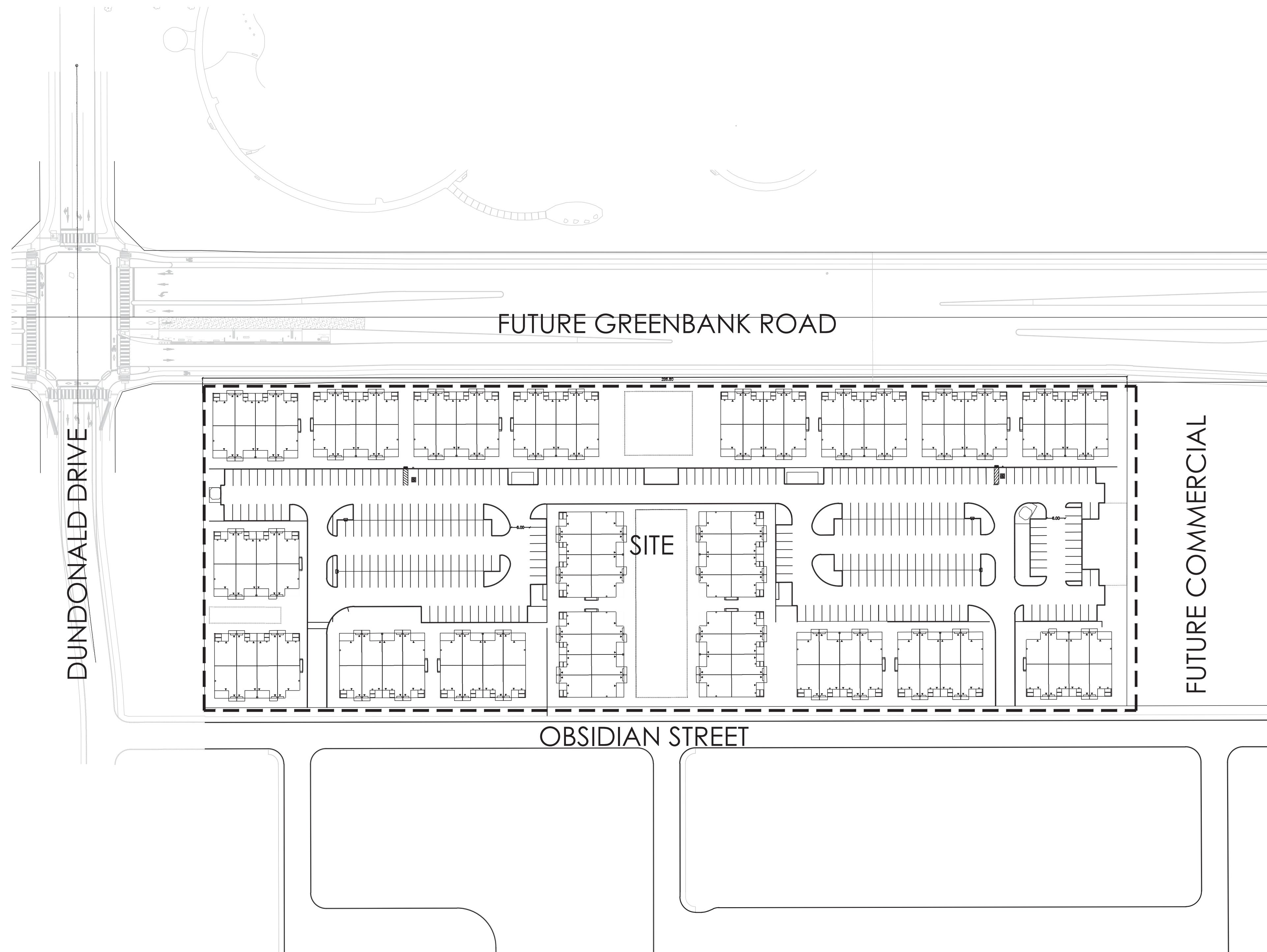

Contractor shall check all dimensions on the work and report any discrepancy to the Landscape Architect before proceeding. All drawings and specifications are the property of the Landscape Architect and must be returned at the completion of the work. This drawing is not to be used for construction until signed by the Landscape Architect.

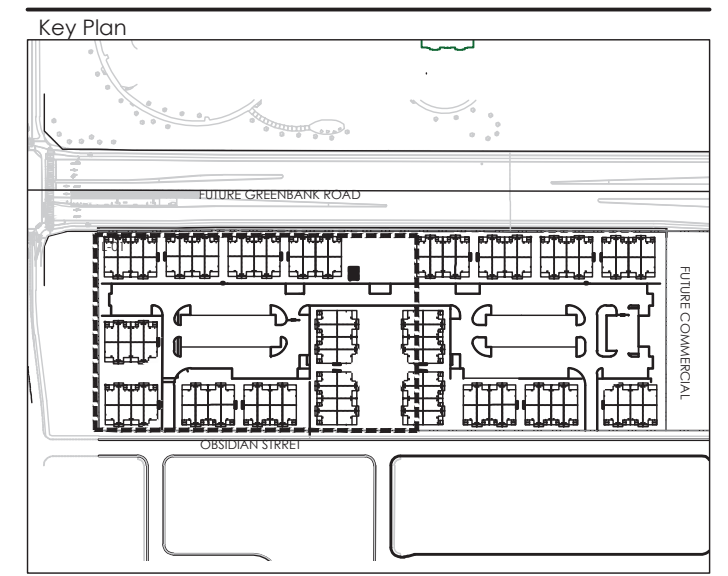

LEGEND

--- PROPERTY LINE

FENCING

--- WASTE ENCLOSURE FENCE

--- 1.8m PRIVACY FENCE

PLANTING

○ LARGE DECIDUOUS TREE

○ SMALL DECIDUOUS TREE

○ DECIDUOUS SHRUB

○ CONIFEROUS SHRUB

PAVING

ASPHALT PAVING

CIP CONCRETE PAVING

HEAVY DUTY CONCRETE PAVING

RIVERSTONE PAVING

UNIT PAVING

PLANTING KEY

XX TREE SPECIES QUANTITY

XX SHRUB SPECIES QUANTITY

DETAIL KEY

1 DETAIL NO.

D-01 SHEET NO.

No.	Description	Date
11	Re-issued for fourth submission	JUNE 20/23
10	Issued for fourth submission	JUNE 08/23
9	Re-issued for third submission	MAR 31/23
8	Issued for third submission	MAR 24/23
7	Issued for client review	MAR 17/23
6	Issued for client review	MAR 10/23
5	Issued for Second Submission	DEC 04/22
4	Issued for Second Submission	NOV 24/22
3	Issued for Second Submission	NOV 18/22
2	Re-issued for First Submission	MAR 21/22
1	Issued for First Submission	NOV 20/21

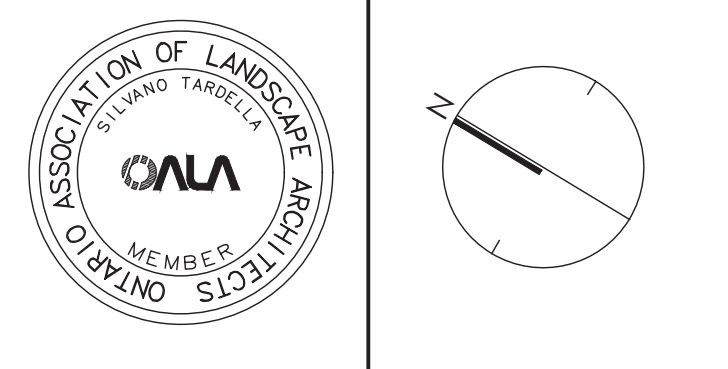

NAK
design strategies

1285 WELLINGTON STREET WEST, OTTAWA, ON K1Y 3A8 CANADA
T 613.237.2345 F 613.237.4423 NAKDESIGNSTRATEGIES.COM

HALF MOON BAY SOUTH
PHASE 8

Title: LANDSCAPE PLAN

Date: JUNE 2023
Scale: 1:250
Drawn: AM/SE
Checked: SE/SC
Job No.: 20-210

Sheet: L-01

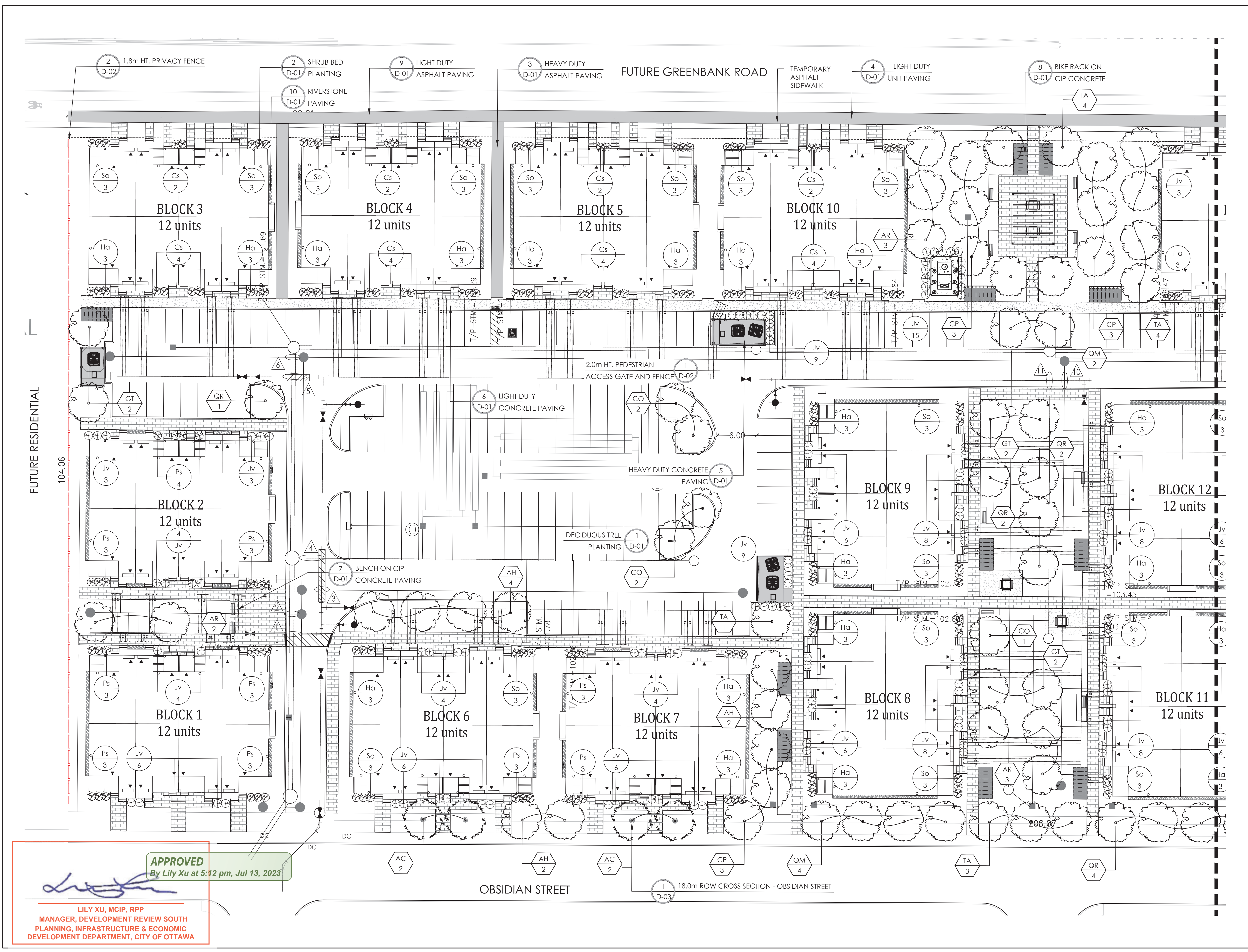

APPROVED
By Lily Xu at 5:12 pm, Jul 13, 2023

LILY XU, MCIP, RPP
MANAGER, DEVELOPMENT REVIEW SOUTH
PLANNING, INFRASTRUCTURE & ECONOMIC
DEVELOPMENT DEPARTMENT, CITY OF OTTAWA

Contractor shall check all dimensions on the work and report any discrepancy to the Landscape Architect before proceeding. All drawings and specifications are the property of the Landscape Architect and must be returned at the completion of the work. This drawing is not to be used for construction until signed by the Landscape Architect.

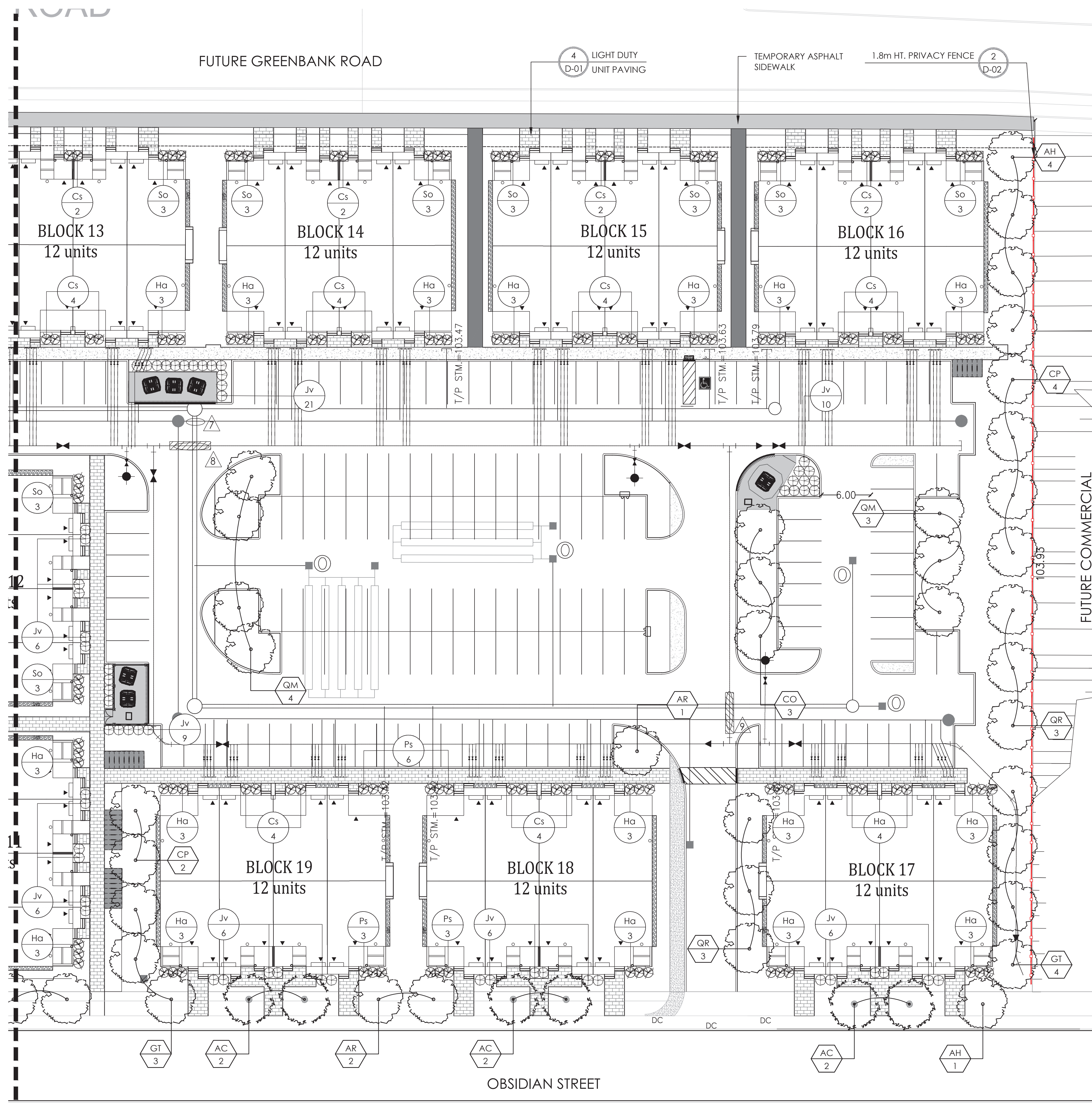

- GENERAL NOTES:**
1. ACER RUBRUM, CELTIS OCCIDENTALIS, AND QUERCUS RUBRA TO BE SPRING DUG SPECIMENS AND PLANTED IN THE SPRING ONLY.
 2. THE LOCATION OF THE TREES SHOWN ON THIS PLAN IS APPROXIMATE AND SHALL NOT BE SCALED FROM THIS DRAWING. THIS PLAN MUST BE READ IN CONJUNCTION WITH THE APPROVED CUP AND CITY CROSS SECTIONS.
 3. CONTRACTOR SHALL ENSURE THAT ALL UTILITY LOCATIONS ARE OBTAINED PRIOR TO ANY EXCAVATION FOR LANDSCAPING.
 4. LOCATION OF ALL PLANT MATERIALS TO BE STAKED BY THE CONTRACTOR AND VERIFIED IN THE FIELD BY LANDSCAPE ARCHITECT & CITY OF OTTAWA PRIOR TO THE EXCAVATION OF PITS.
 5. ALL PLANT MATERIAL SHALL BE NURSERY GROWN STOCK UNLESS OTHERWISE NOTED.
 6. TREES TO HAVE A MINIMUM 1800 CLEAR STEM ABOVE GRADE.
 7. PLACE SOD ON A MINIMUM 150mm TOPSOIL.
 8. CONTRACTOR TO MAKE GOOD ALL EXISTING AREAS DAMAGED BY HIS WORK TO THE SATISFACTION OF THE CITY OF OTTAWA.
 9. THE CITY WILL BE NOTIFIED IF ANY TREES CANNOT BE LOCATED OR PLANTED DUE TO CONFLICTS WITH UTILITIES OR DRIVEWAYS. THE REQUIRED TREES NOT PLANTED ARE SUBJECT TO TREE BANKING. THE FINAL NUMBER OF TREES TO BE BANKED WILL BE PROVIDED TO THE CITY FOLLOWING ALL PLANTINGS.
 10. ALL PLANT MATERIAL SHALL BE WARRANTED FOR TWO YEARS FROM THE DATE OF PERFORMANCE ACCEPTANCE AS DETERMINED BY THE CITY OF OTTAWA.
 11. PERIODIC REVIEWS OF PLANTING SHALL BE CARRIED OUT BY THE LANDSCAPE ARCHITECT.
 12. PLANTINGS TO BE STAKED FOR APPROVAL PRIOR TO CONSTRUCTION

- PLANTING NOTES:**
1. CONTRACTOR TO VERIFY LOCATION OF ALL SERVICES PRIOR TO ANY EXCAVATION.
 2. LOCATIONS OF ALL PLANT MATERIALS TO BE STAKED BY THE CONTRACTOR AND VERIFIED IN THE FIELD BY LANDSCAPE ARCHITECT PRIOR TO THE EXCAVATION OF PITS.
 3. ALL PLANT MATERIAL SHALL BE NURSERY GROWN STOCK UNLESS OTHERWISE NOTED.
 4. DECIDUOUS TREES TO HAVE A MINIMUM 1800 CLEAR STEM ABOVE GRADE.
 5. ALL PLANT MATERIAL SHALL BE WARRANTED FOR TWO YEARS FROM THE DATE OF PERFORMANCE ACCEPTANCE AS DETERMINED BY THE LANDSCAPE ARCHITECT.
 6. ALL STEEL T-BARS TO BE REMOVED AT THE ONE YEAR INTERIM INSPECTION UNLESS OTHERWISE DIRECTED BY THE LANDSCAPE ARCHITECT.
 7. CONTRACTOR TO MAKE GOOD ALL EXISTING AREAS DAMAGED BY HIS WORK TO THE SATISFACTION OF THE LANDSCAPE ARCHITECT.
 8. PERIODIC REVIEWS OF PLANTING SHALL BE CARRIED OUT BY THE LANDSCAPE ARCHITECT.
 9. ANY PROPOSED SUBSTITUTIONS OF PLANT SPECIES SHALL BE MADE WITH PLANTS OF EQUIVALENT OVERALL FORM, HEIGHT, BRANCHING HABIT, FLOWER, LEAF, COLOR, FRUIT AND CULTURE AND ONLY AFTER APPROVAL OF THE LANDSCAPE ARCHITECT.

- SHRUB NOTES:**
1. PLACE THE SHRUB AS UPRIGHT AS POSSIBLE, INCLUDING ON SLOPES.
 2. PLANT SHRUBS AT THE PROPER DEPTH AS INDICATED ON THE DRAWINGS.
 3. PACK THE SOIL WELL AROUND THE PLANT BASE TO REMOVE AIR POCKETS, BUT DO NOT COMPACT SOIL. PRESS SOIL GENTLY BUT FIRMLY TO PREVENT SHOCKING THE ROOTS.
 4. PLACE SPECIES ACCORDING TO THE QUANTITIES AND SPACING AS INDICATED ON THE DRAWINGS.
 5. PLANT SHRUBS AT THE PROPER DEPTH THE ROOT COLLARS SHOULD BE AT GROUND LEVEL.
 6. MULCH THE SOIL SURFACE AS INDICATED ON DRAWINGS.
 7. WATER PLANTS THOROUGHLY FOLLOWING PLANTING.
 8. REFER TO SPECIFICATIONS FOR MAINTENANCE REQUIREMENTS.

- SOD NOTES:**
1. SODDED AREAS SHALL HAVE A MINIMUM 150mm TOPSOIL.
 2. FIRM THE SOIL BY GENTLY TAMPING OR ROLLING THE TOPSOIL. DO NOT COMPACT THE SOIL. EXCESSIVE FORCE WILL DESTROY THE SOIL STRUCTURE AND INHIBIT GERMINATION.
 3. CUT THE GRASS TO 50mm WHENEVER IT REACHES THE HEIGHT OF 70mm. REMOVE CLIPPINGS THAT WILL SMOTHER GRASS.
 4. SODDED AREAS WILL BE ACCEPTED BY THE PROJECT MANAGER FOLLOWING PERFORMANCE ACCEPTANCE PROVIDED:
 - SEEDING AREAS ARE PROPERLY ESTABLISHED.
 - TURF IS FREE OF DEAD SPOTS AND WEEDS.
 - NO SURFACE SOIL IS VISIBLE WHEN GRASS HAS BEEN CUT TO A HEIGHT OF 50mm.
 - TURF AREAS HAVE BEEN CUT NO LESS THAN TWICE, THE LAST CUT BEING CARRIED OUT WITHIN 24 HOURS PRIOR TO THE ACCEPTANCE INSPECTION.

KEY	BOTANICAL NAME	COMMON NAME	QUANTITY	SIZE	REMARKS
DECIDUOUS TREES					
AR	ACER RUBRUM	RED MAPLE	11	50mm CAL.	B&B / W.B.
CO	CELTIS OCCIDENTALIS	HACKBERRY	8	50mm CAL.	B&B / W.B.
GT	GEDISIA TRI. VAR. INERMIS	HONEYLOCUST 'IMPERIAL'	12	50mm CAL.	B&B / W.B.
AH	AESCULUS HIPPOCASTANUM	HORSE CHESTNUT	12	50mm CAL.	B&B / W.B.
QM	QUERCUS MACROCARPA	BURR OAK	13	50mm CAL.	B&B / W.B.
QR	QUERCUS RUBRA	RED OAK	14	50mm CAL.	B&B / W.B.
TA	TILIA AMERICANA	BASSWOOD	12	50mm CAL.	B&B / W.B.
CP	NORTHERN CATALPA	CATALPA SPECIOSA	15	50mm CAL.	B&B / W.B.
AC	AMELANCHIER CANADENSIS	SERVICEBERRY	10	50mm CAL.	B&B / W.B.
			110		
DECIDUOUS SHRUBS					
Cs	CORNUS SERICA 'KELSEY'	KELSEY DOGWOOD	56	3 GAL.	POTTED
Ha	HYDRANGEA ABORESCENS 'ANNABELLE'	ANNABELLE HYDRANGEA	109	3 GAL.	POTTED
Ps	PHYLADELPHUS X 'SNOWBELLE'	SNOWBELLE MOCKORANGE	43	3 GAL.	POTTED
So	ASTILBE CHINENSIS 'DIAMONDS AND PEARLS'	FALSE SPIREA	75	3 GAL.	POTTED
			283		
CONIFEROUS SHRUBS					
Jv	JUNIPERUS VIRGINIANA 'BLUE ARROW'	BLUE ARROW JUNIPER	190	3 GAL.	POTTED

APPROVED
By Lily Xu at 5:11 pm, Jul 13, 2023

Lily Xu
LILY XU, MCIP, RPP
MANAGER, DEVELOPMENT REVIEW SOUTH
PLANNING, INFRASTRUCTURE & ECONOMIC
DEVELOPMENT DEPARTMENT, CITY OF OTTAWA

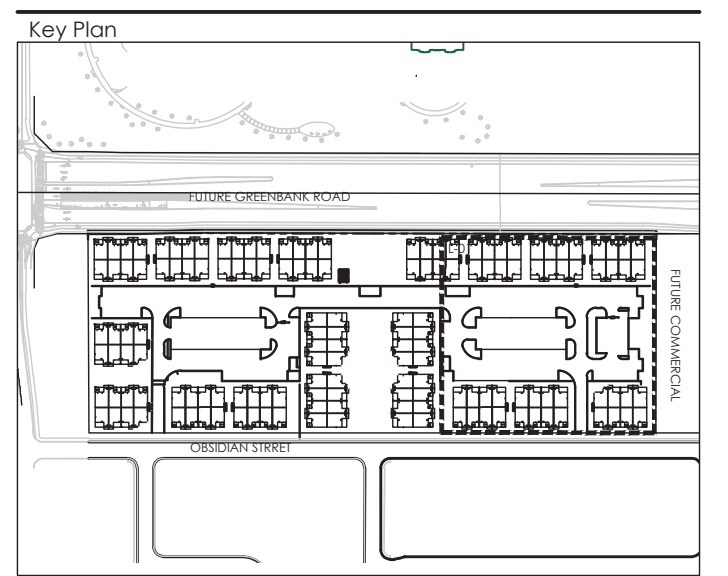

LEGEND

--- PROPERTY LINE

FENCING

--- WASTE ENCLOSURE FENCE

--- 1.8m PRIVACY FENCE

PLANTING

○ LARGE DECIDUOUS TREE

○ SMALL DECIDUOUS TREE

○ DECIDUOUS SHRUB

○ CONIFEROUS SHRUB

PAVING

ASPHALT PAVING

CIP CONCRETE PAVING

HEAVY DUTY CONCRETE PAVING

RIVERSTONE PAVING

UNIT PAVING

PLANTING KEY

XX TREE SPECIES QUANTITY

XX SHRUB SPECIES QUANTITY

DETAIL KEY

1 DETAIL NO.

DT SHEET NO.

No.	Description	Date
11	Re-issued for fourth submission	JUNE 20/23
10	Issued for fourth submission	JUNE 08/23
9	Re-issued for third submission	MAR 31/23
8	Issued for third submission	MAR 24/23
7	Issued for client review	MAR 17/23
6	Issued for client review	MAR 10/23
5	Issued for Second Submission	DEC 06/22
4	Issued for Second Submission	NOV 24/22
3	Issued for Second Submission	NOV 18/22
2	Re-issued for First Submission	MAR 21/22
1	Issued for First Submission	NOV 20/21

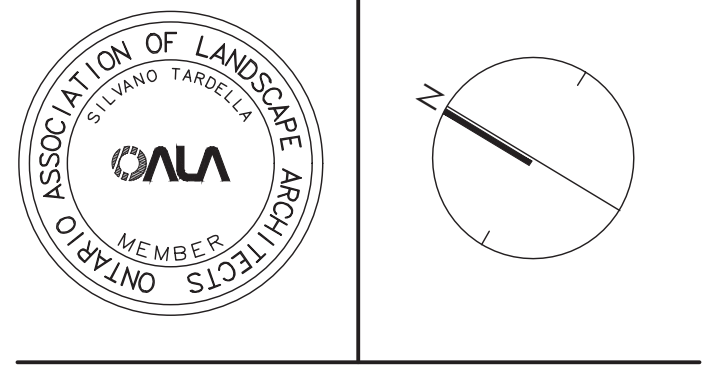

NAK
design strategies

1285 WELLINGTON STREET WEST, OTTAWA, ON K1Y 3A8 CANADA
T 613.237.2346 F 613.237.4423 NAKDESIGNSTRATEGIES.COM

HALF MOON BAY SOUTH
PHASE 8

Title: LANDSCAPE PLAN

Date: JUNE 2023
Scale: 1/250
Drawn: AM/SE
Checked: SM/SC
Job No.: 20-210

Sheet: L-02

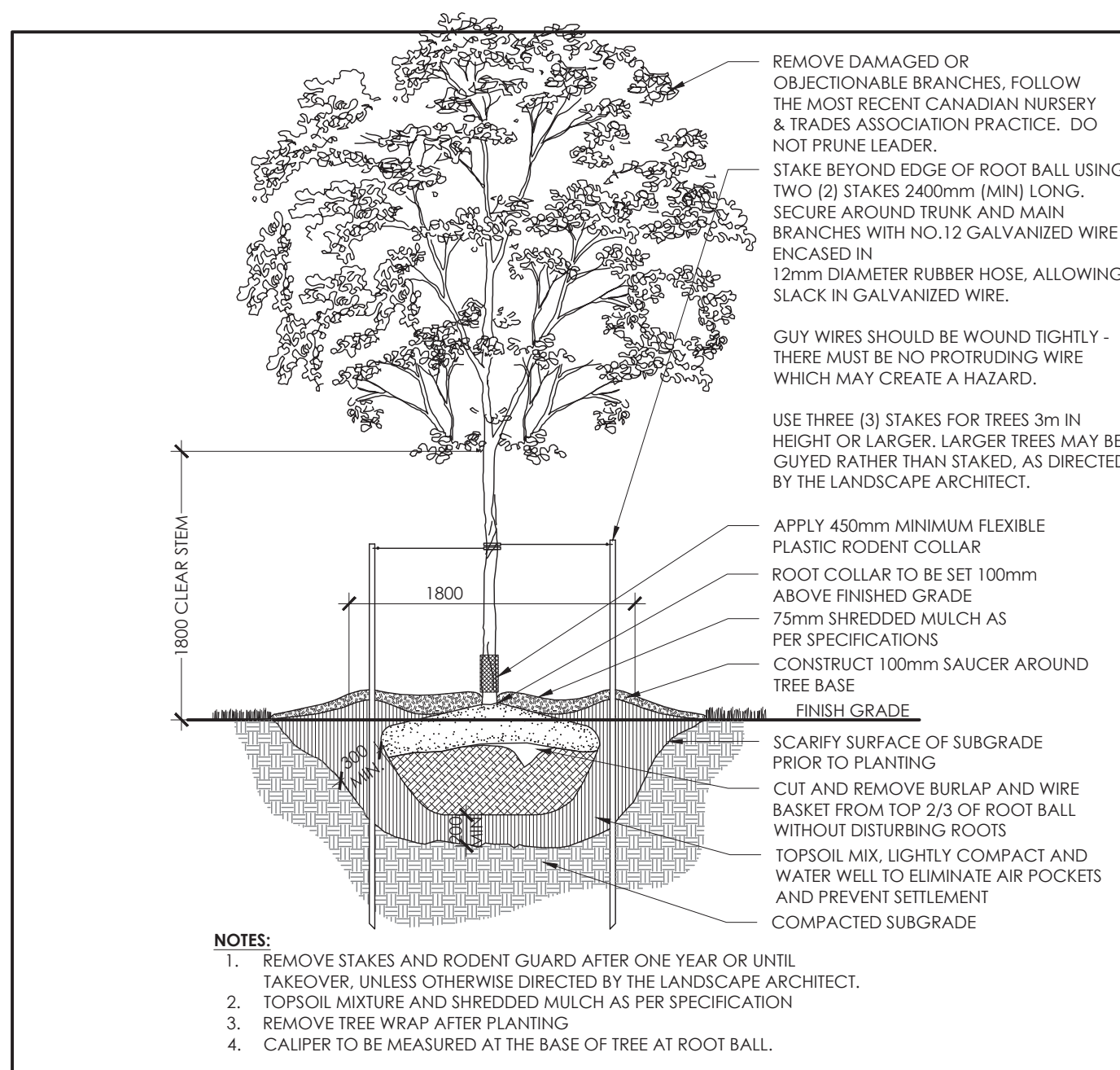

1 DECIDUOUS TREE PLANTING
N.T.S.

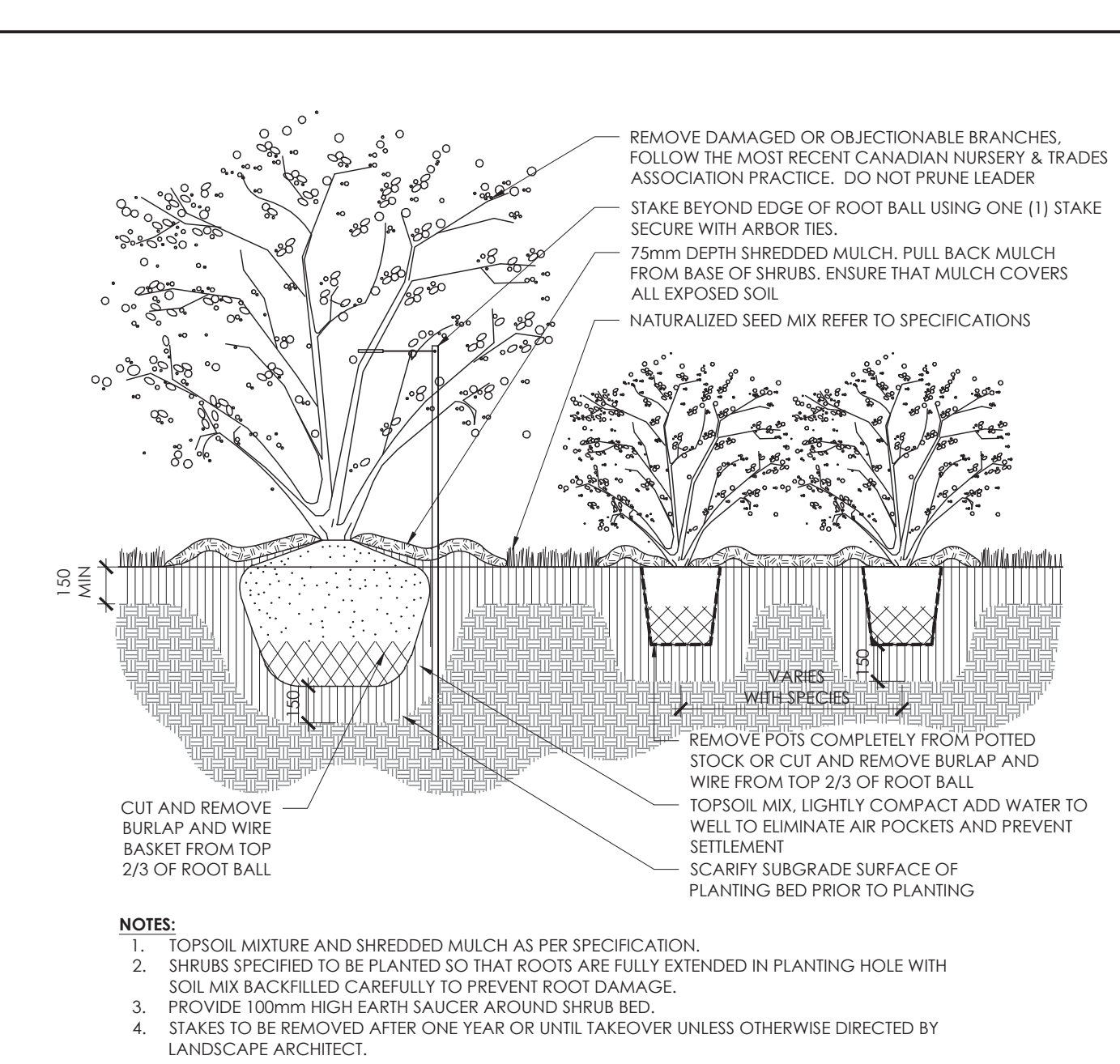

2 SHRUB BED PLANTING
N.T.S.

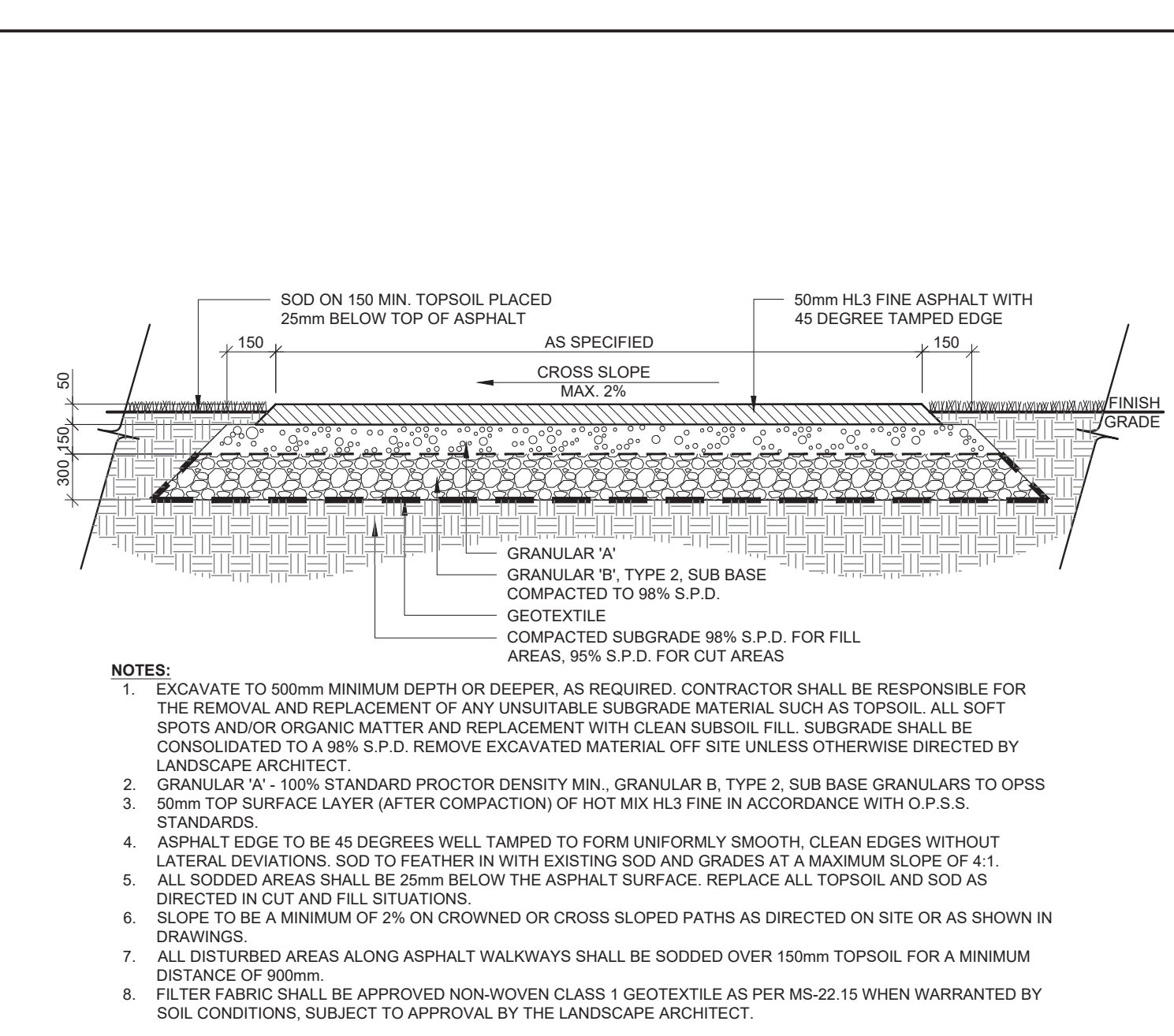

3 HEAVY DUTY ASPHALT PAVING
N.T.S.

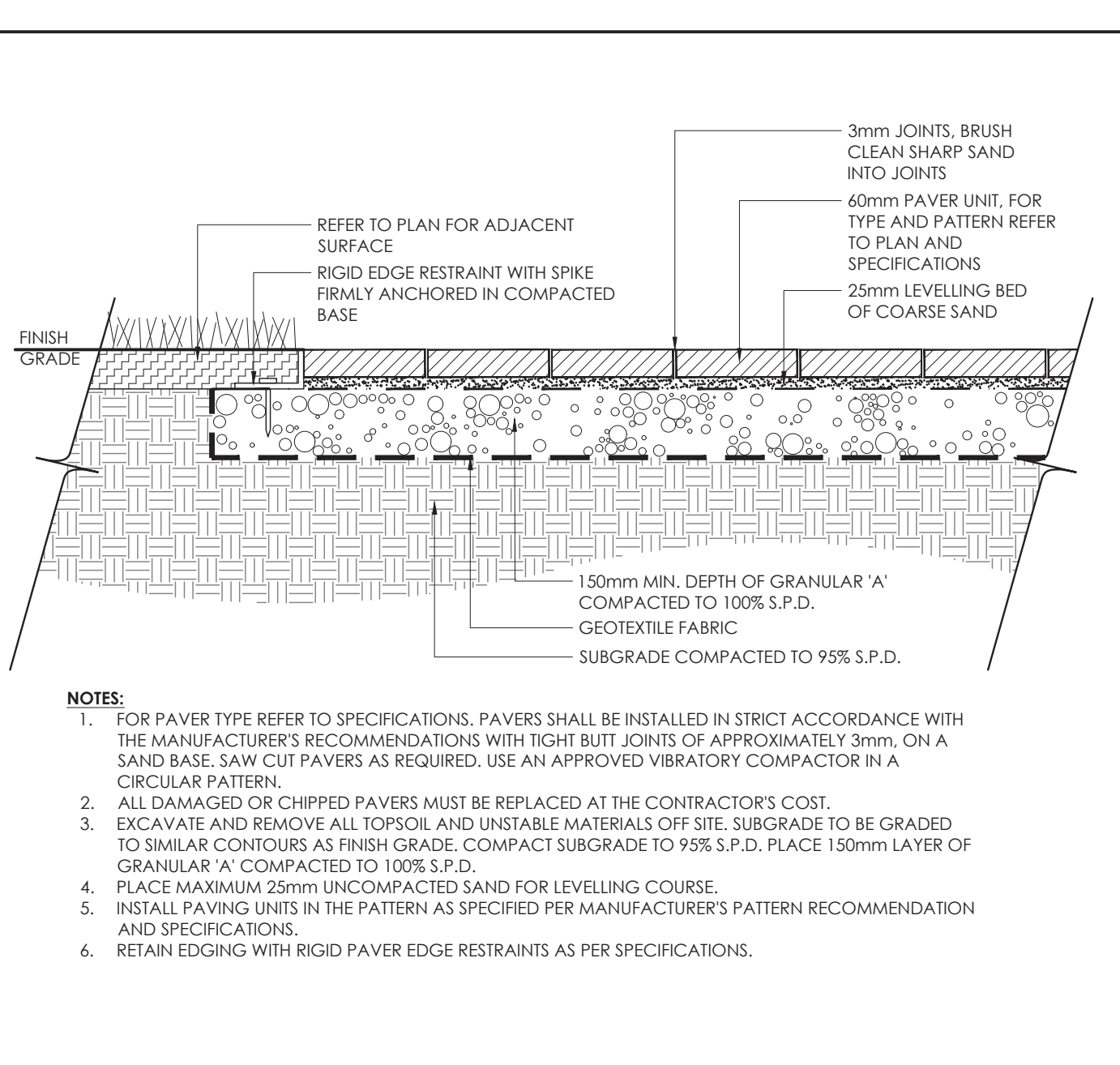

4 LIGHT DUTY UNIT PAVING
N.T.S.

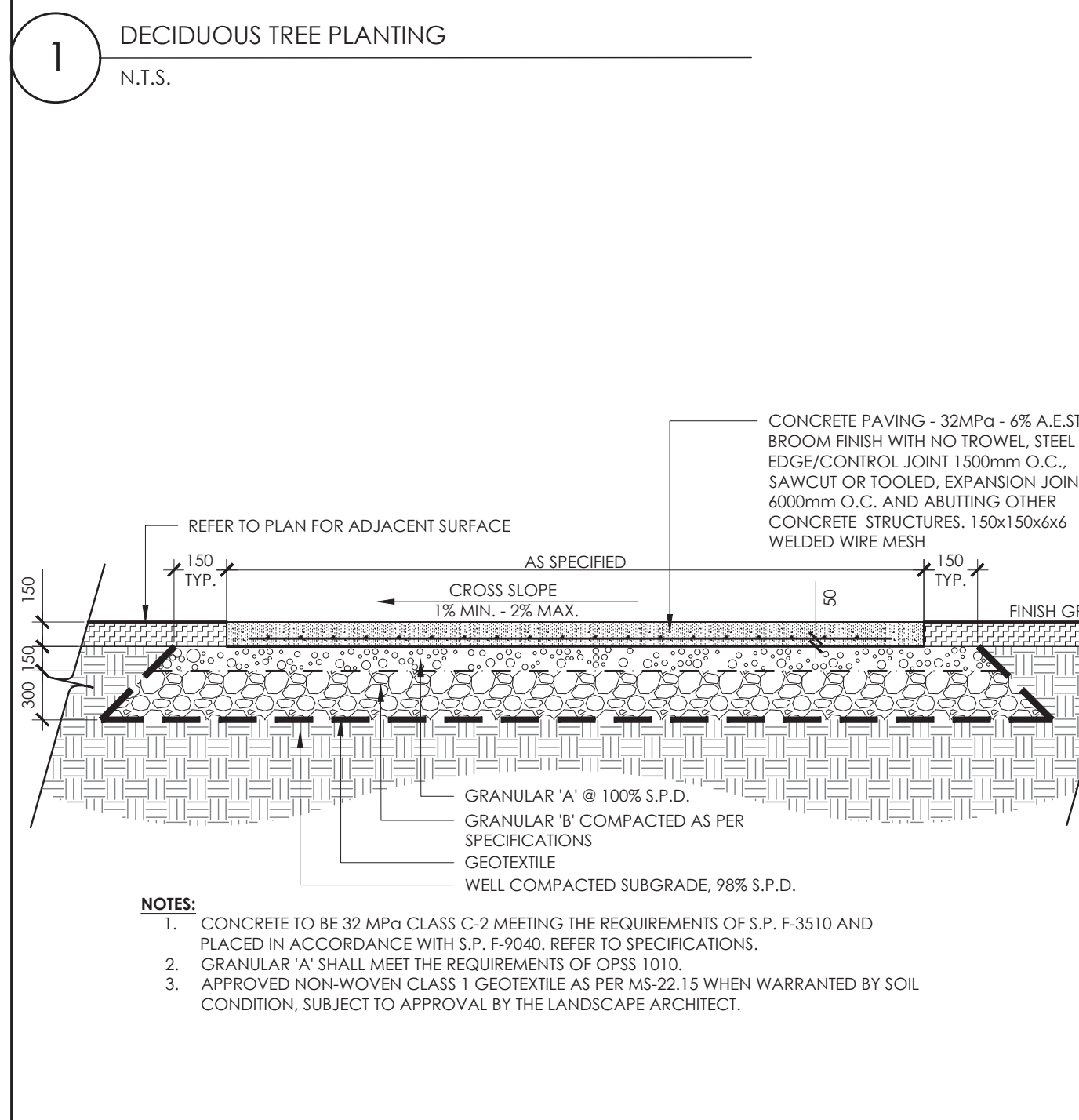

5 HEAVY DUTY CONCRETE PAVING
N.T.S.

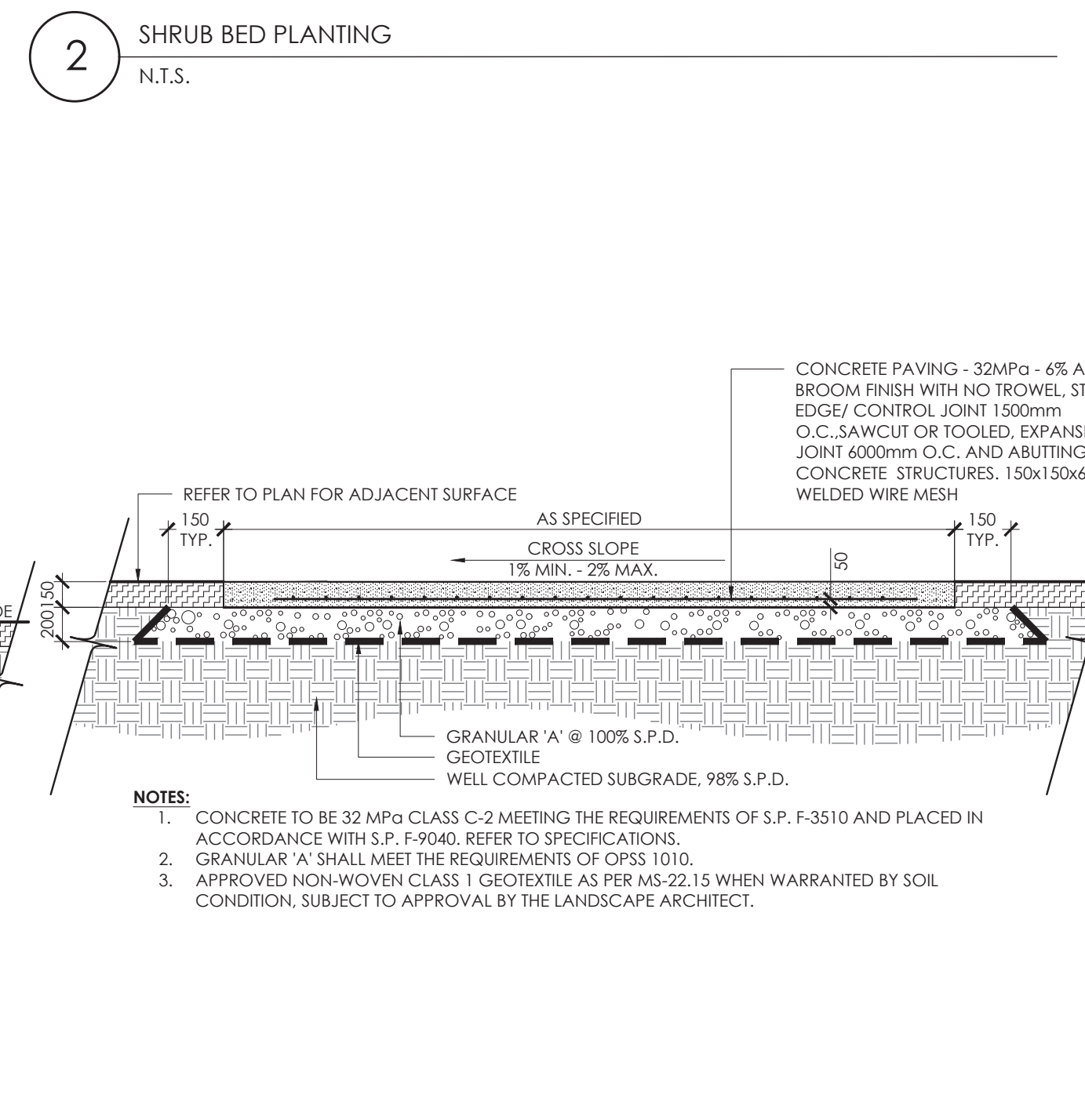

6 LIGHT DUTY CONCRETE PAVING
N.T.S.

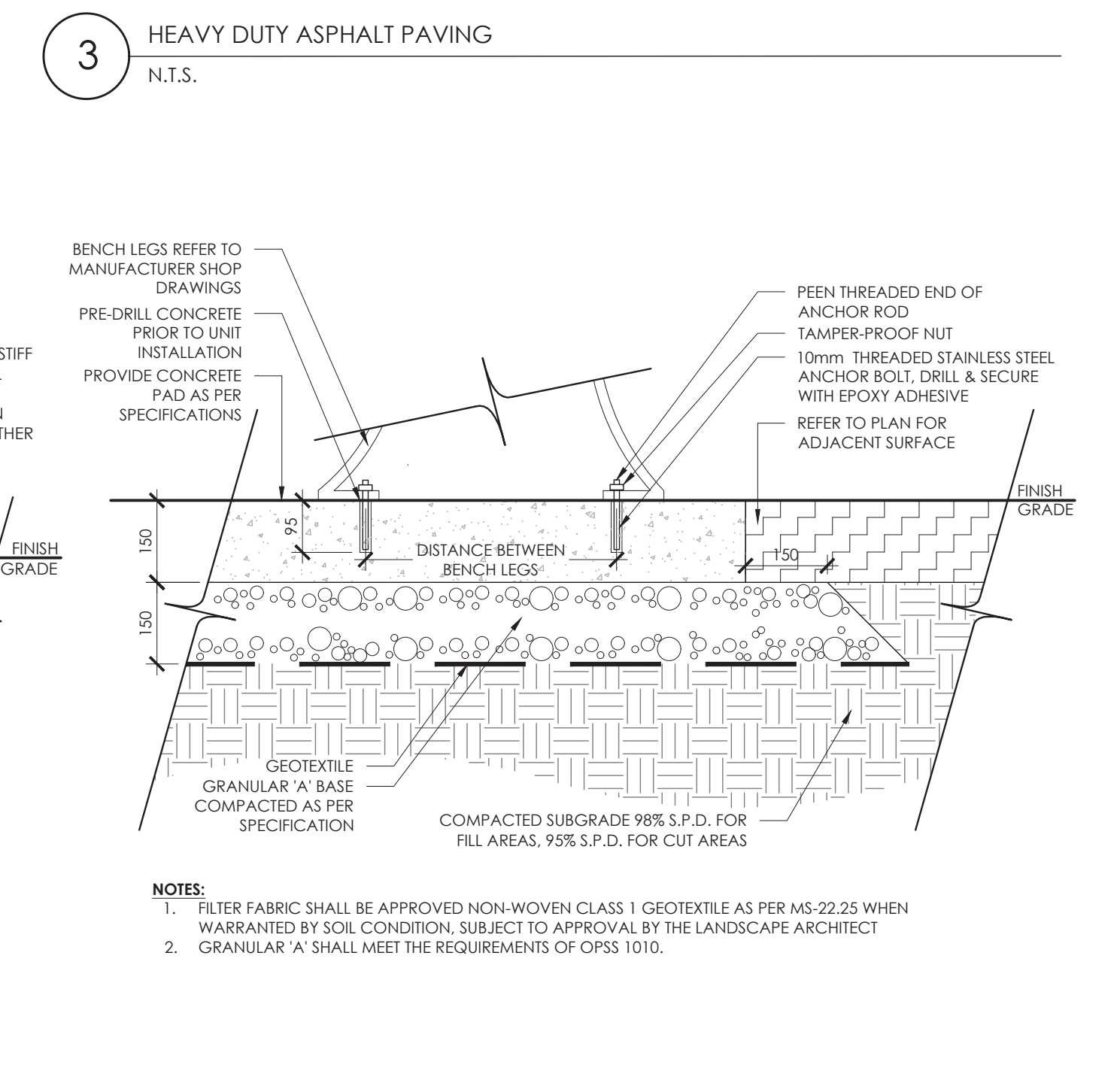

7 BENCH MOUNTING ON CONCRETE BASE
N.T.S.

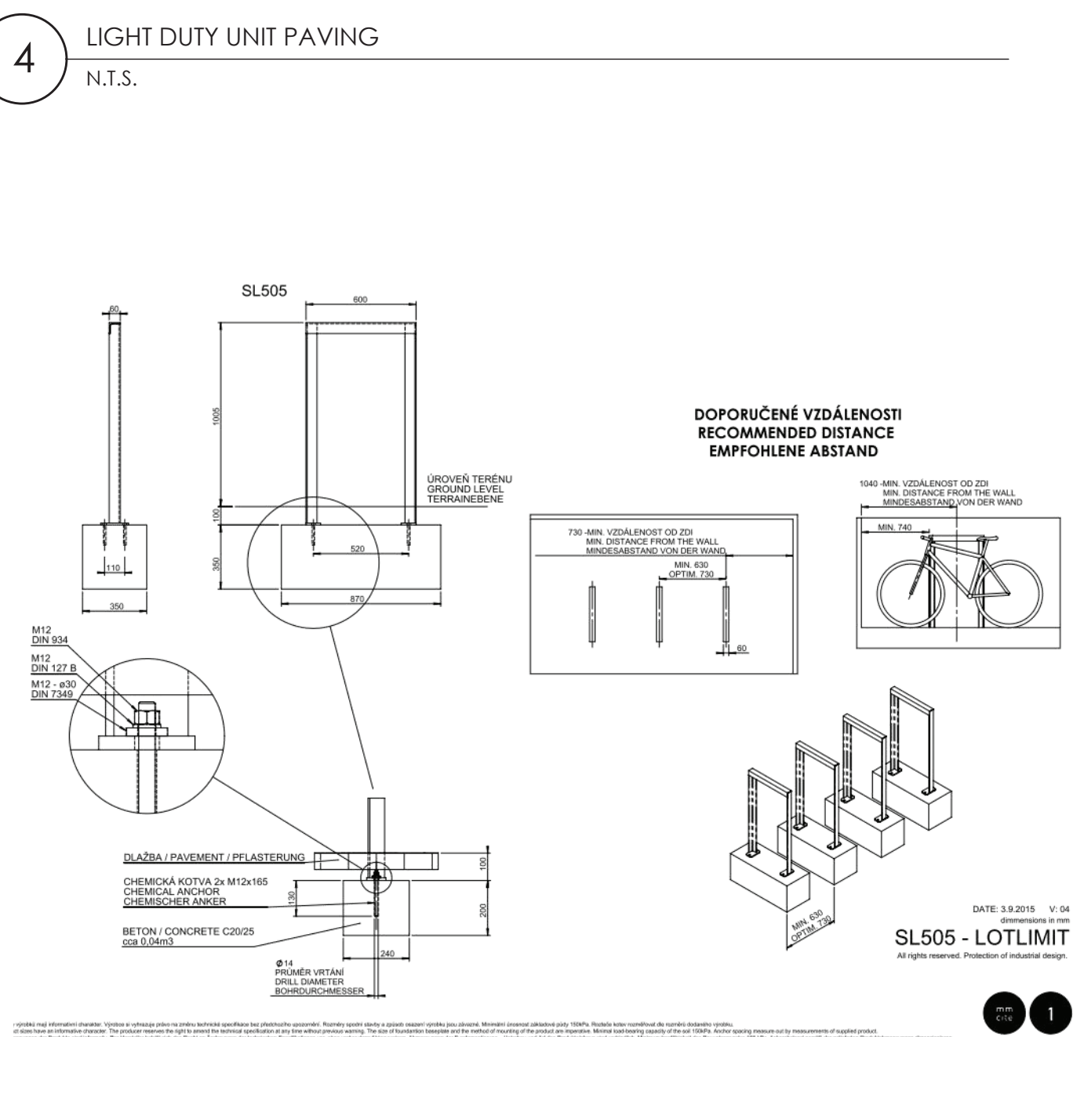

8 BIKE RACK - ON CIP CONCRETE
N.T.S.

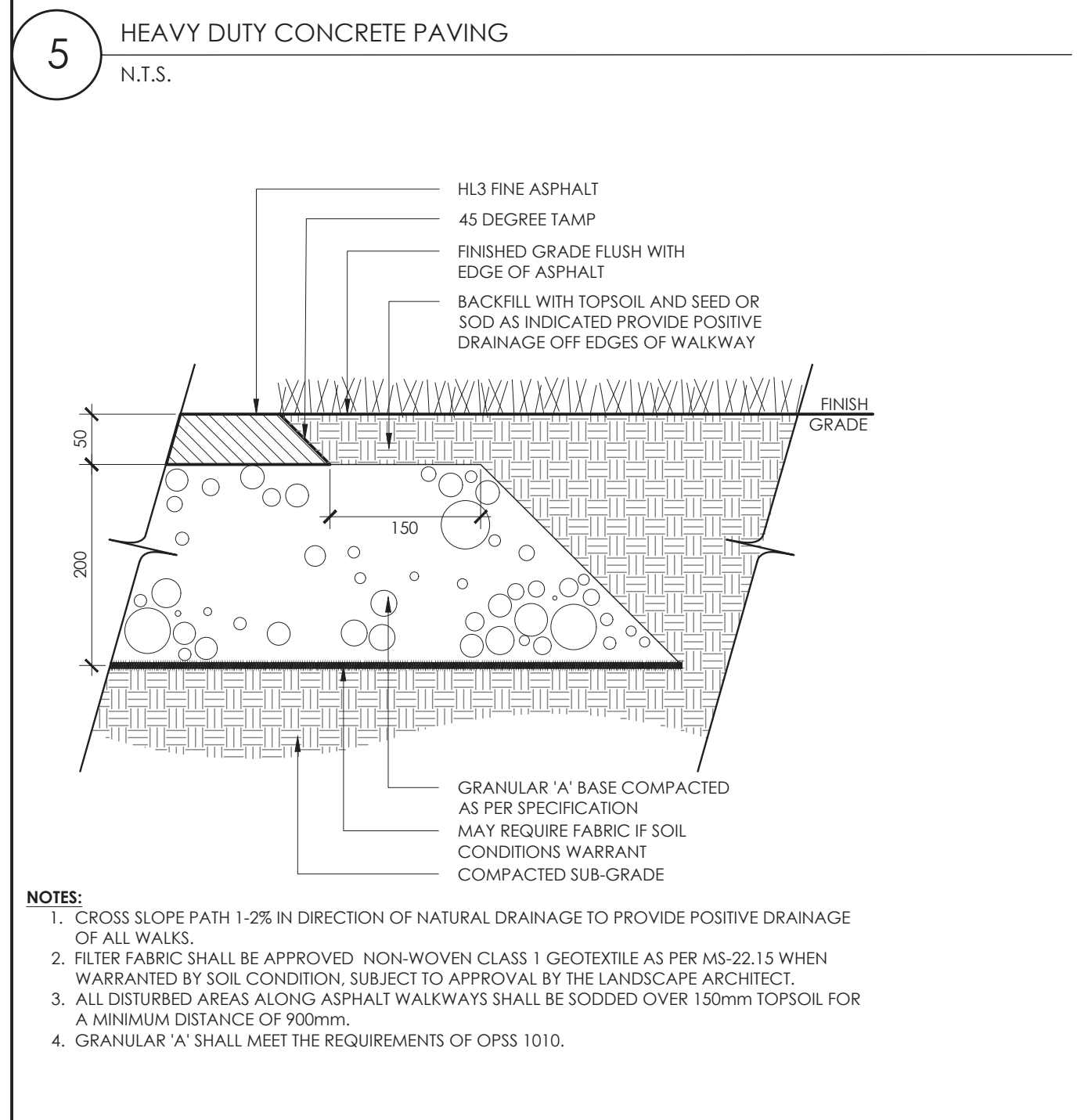

9 LIGHT DUTY ASPHALT PAVING
N.T.S.

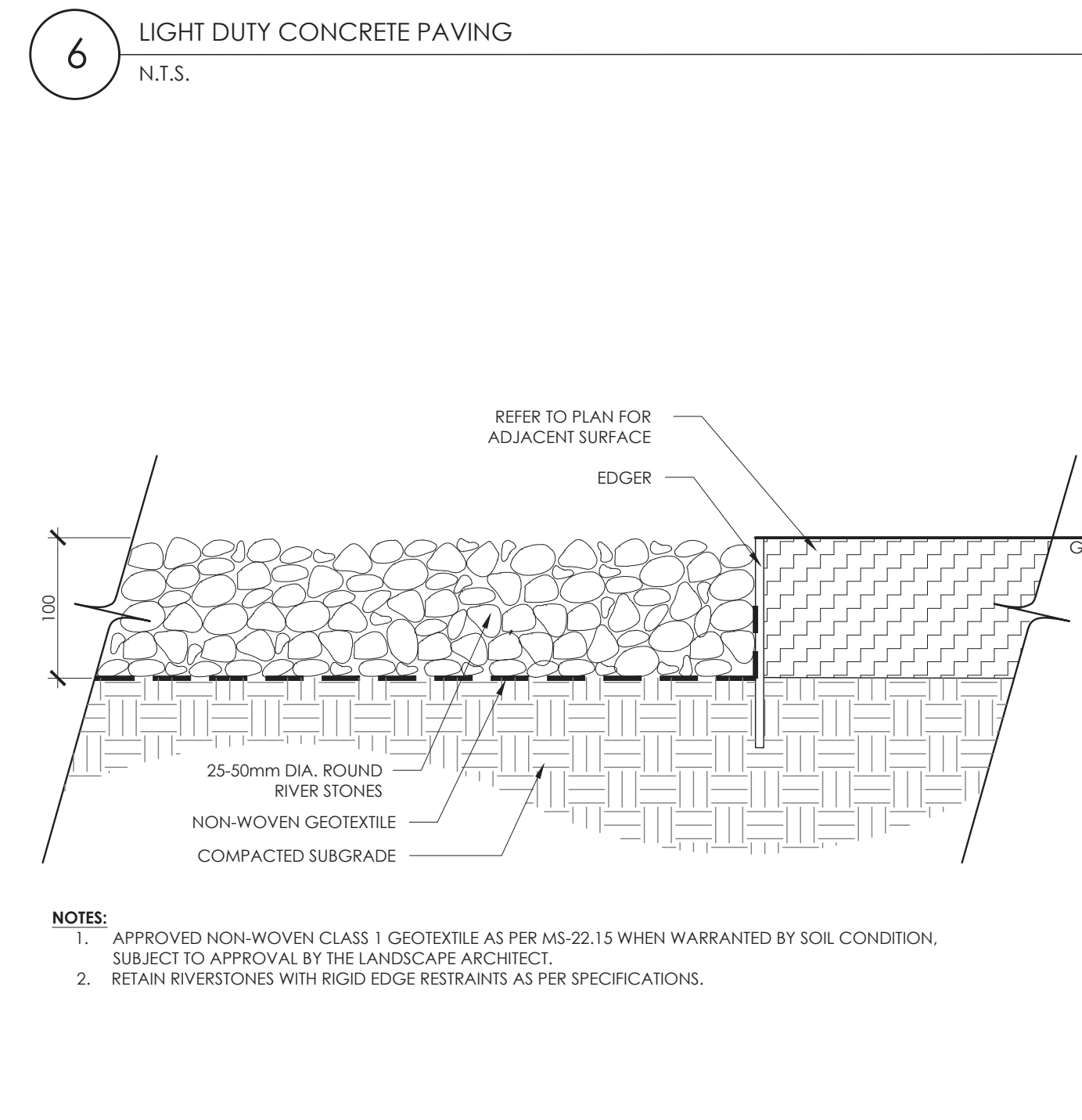

10 RIVER STONE PAVING
N.T.S.

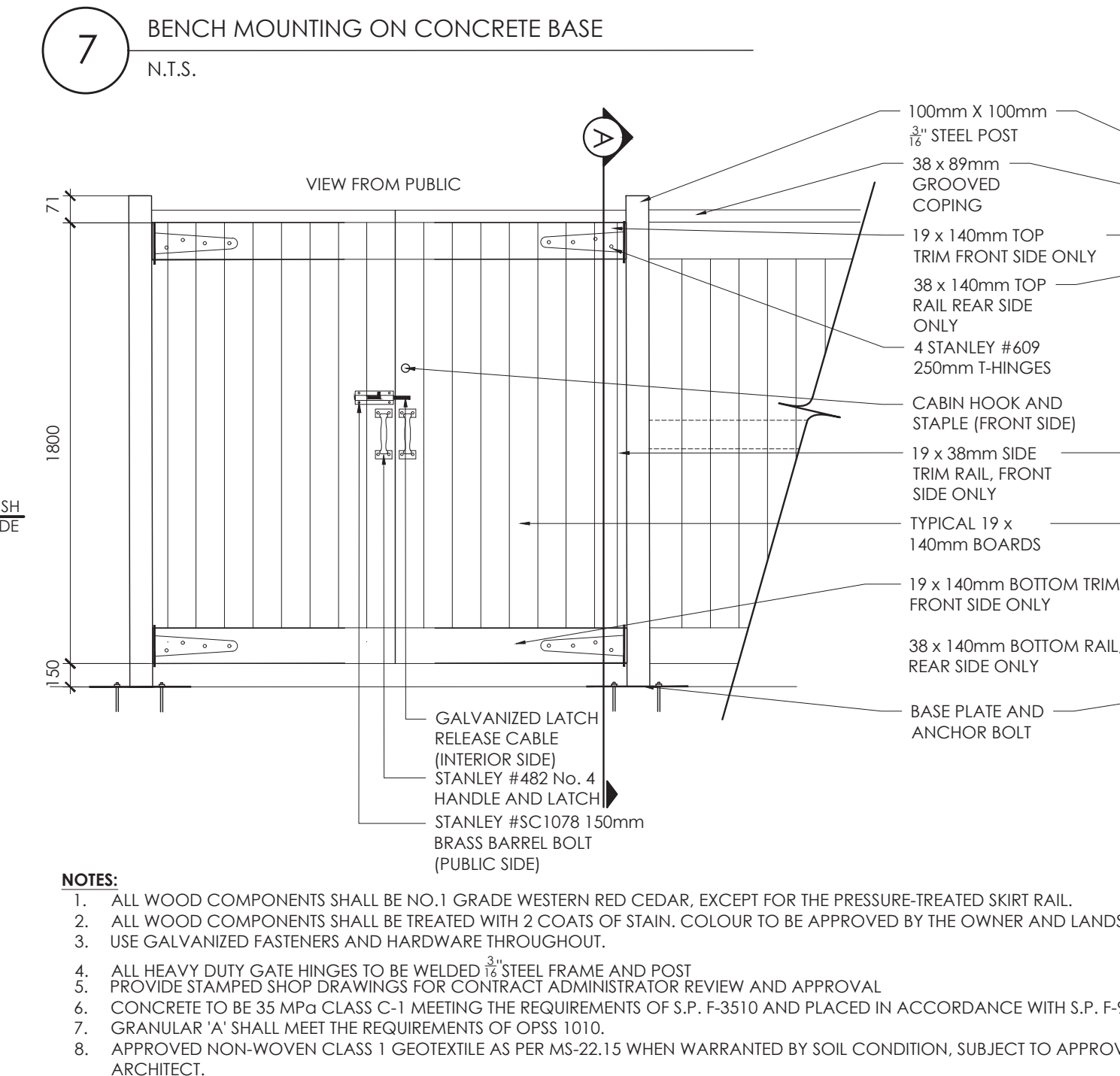

11 2.0m HT. PEDESTRIAN ACCESS GATE AND FENCE
N.T.S.

Contractor shall check all dimensions on the work and report any discrepancy to the Landscape Architect before proceeding. All drawings and specifications are the property of the Landscape Architect and must be returned at the completion of the work. This drawing is not to be used for construction until signed by the Landscape Architect.

Key Plan

No.	Description	Date
11	Re-issued for fourth submission	JUNE 20/23
10	Issued for fourth submission	JUNE 08/23
9	Re-issued for third submission	MAR 31/23
8	Issued for third submission	MAR 24/23
7	Issued for client review	MAR 17/23
6	Issued for client review	MAR 10/23
5	Issued for Second Submission	DEC 06/22
4	Issued for Second Submission	NOV 24/22
3	Issued for Second Submission	NOV 18/22
2	Re-issued for First Submission	NOV 21/22
1	Issued for First Submission	NOV 2021

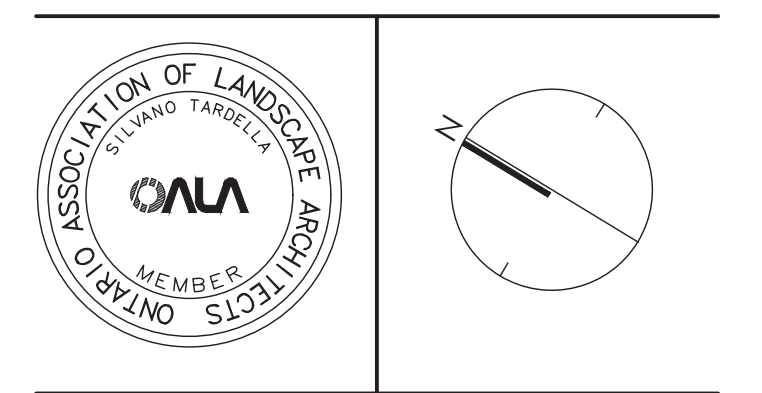

NAK design strategies
1285 WELLINGTON STREET WEST, OTTAWA, ON K1Y 3A8 CANADA
T 613.237.2345 F 613.237.4423 NAKDESIGNSTRATEGIES.COM

HALF MOON BAY SOUTH
PHASE 8

Title
DETAILS

Date: JUNE 2023
Scale: N.T.S.
Drawn: AM/SE
Checked: SE/SC
Job No.: 20-210

APPROVED
By Lily Xu at 5:12 pm, Jul 13, 2023

Lily Xu
LILY XU, MCIP, RPP
MANAGER, DEVELOPMENT REVIEW SOUTH
PLANNING, INFRASTRUCTURE & ECONOMIC
DEVELOPMENT DEPARTMENT, CITY OF OTTAWA

Contractor shall check all dimensions on the work and report any discrepancy to the Landscape Architect before proceeding. All drawings and specifications are the property of the Landscape Architect and must be returned at the completion of the work. This drawing is not to be used for construction until signed by the Landscape Architect.

Key Plan

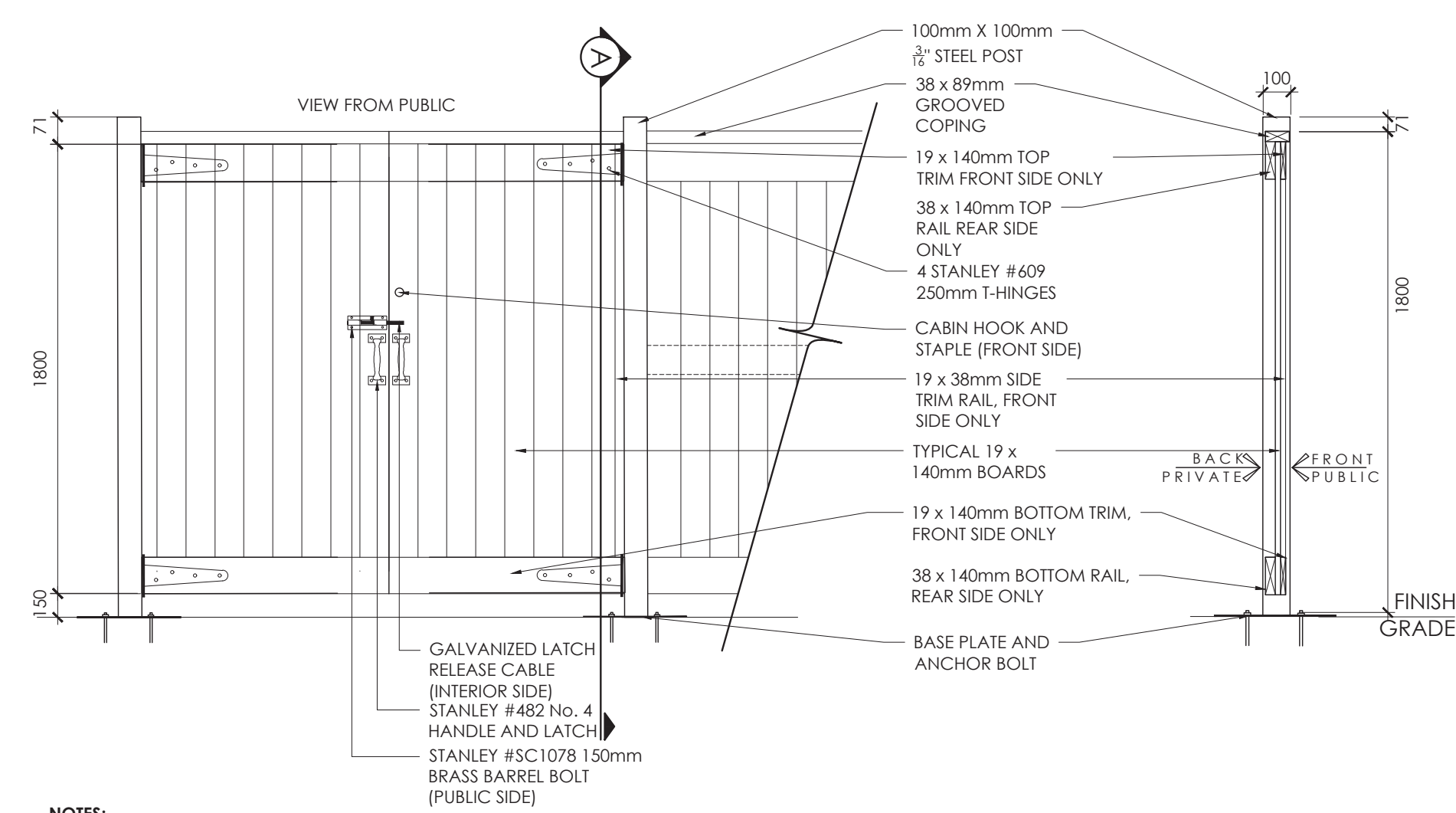

- NOTES:**
1. ALL WOOD COMPONENTS SHALL BE NO.1 GRADE WESTERN RED CEDAR, EXCEPT FOR THE PRESSURE-TREATED SKIRT RAIL.
 2. ALL WOOD COMPONENTS SHALL BE TREATED WITH 2 COATS OF STAIN, COLOUR TO BE APPROVED BY THE OWNER AND LANDSCAPE ARCHITECT.
 3. USE GALVANIZED FASTENERS AND HARDWARE THROUGHOUT.
 4. ALL HEAVY DUTY GATE HINGES TO BE WELDED $\frac{1}{2}$ " STEEL FRAME AND POST.
 5. PROVIDE STAMPED SHOP DRAWINGS FOR CONTRACT ADMINISTRATOR REVIEW AND APPROVAL.
 6. CONCRETE TO BE 35 MPa CLASS C-1 MEETING THE REQUIREMENTS OF S.P. F-3510 AND PLACED IN ACCORDANCE WITH S.P. F-9040. SEE SPECIFICATIONS.
 7. GRANULAR 'A' SHALL MEET THE REQUIREMENTS OF OPS 1010.
 8. APPROVED NON-WOVEN CLASS 1 GEOTEXTILE AS PER MS-22.15 WHEN WARRANTED BY SOIL CONDITION, SUBJECT TO APPROVAL BY THE LANDSCAPE ARCHITECT.

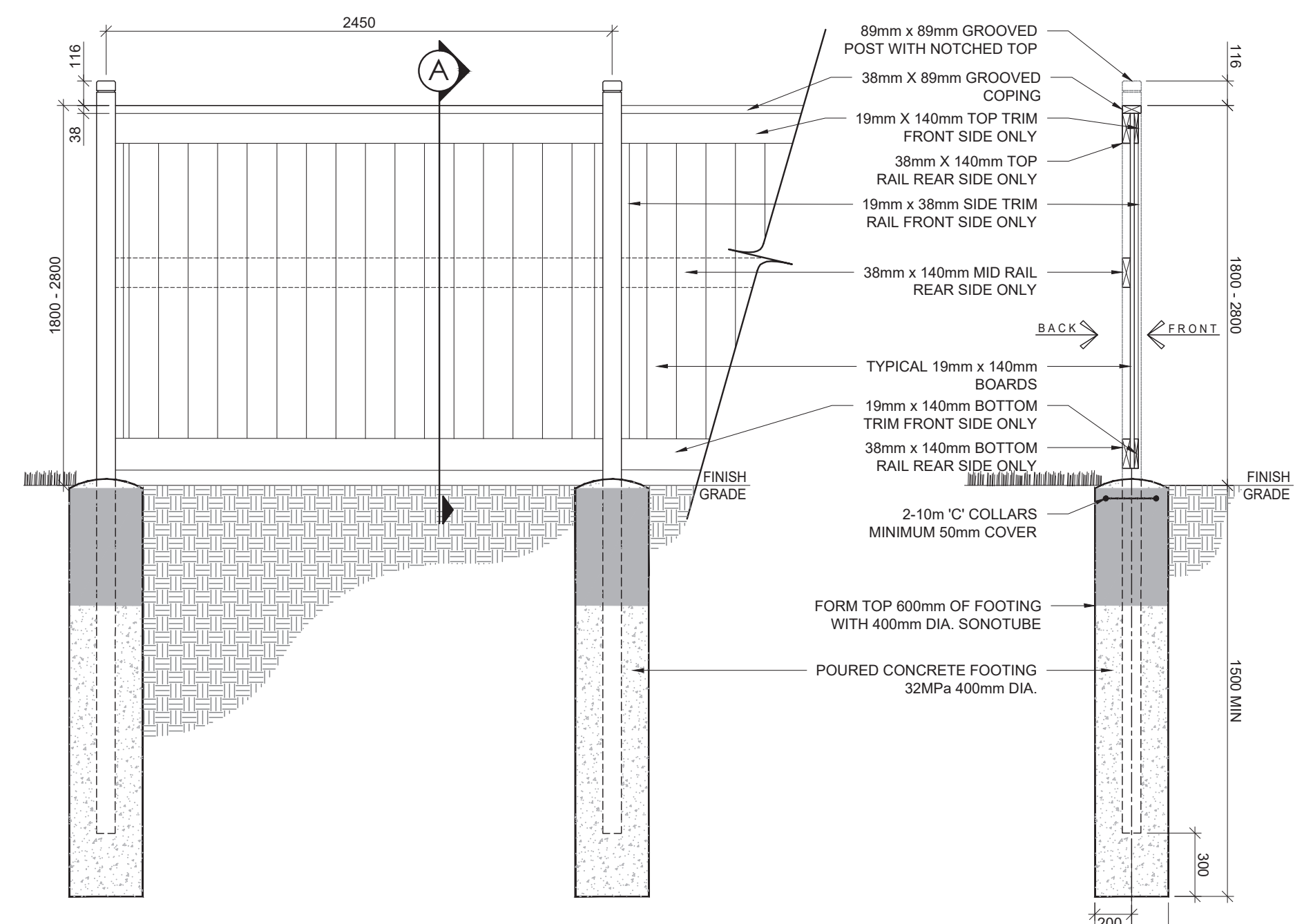

ELEVATION-FRONT SIDE

- NOTES:**
1. ALL WOOD COMPONENTS SHALL BE NO.1 CONSTRUCTION GRADE WESTERN RED CEDAR, EXCEPT FOR THE PRESSURE-TREATED SKIRT RAIL.
 2. ALL WOOD COMPONENTS SHALL BE TREATED WITH 2 COATS OF STAIN, COLOUR TO BE APPROVED BY THE OWNER AND LANDSCAPE ARCHITECT.
 3. USE GALVANIZED FASTENERS AND HARDWARE THROUGHOUT.

2 1.8m PRIVACY FENCE
N.T.S.

1 2.0m HT. PEDESTRIAN ACCESS GATE AND FENCE
N.T.S.

No.	Description	Date
11	Re-Issued for fourth submission	JUNE 20/23
10	Issued for fourth submission	JUNE 08/23
9	Re-Issued for third submission	MAR 31/23
8	Issued for third submission	MAR 24/23
7	Issued for client review	MAR 17/23
6	Issued for client review	MAR 10/23
5	Issued for Second Submission	DEC 06/22
4	Issued for Second Submission	NOV 24/22
3	Issued for Second Submission	NOV 18/22
2	Re-Issued for First Submission	MAR 21/22
1	Issued for First Submission	NOV 2021

Revision
City Approval Stamp

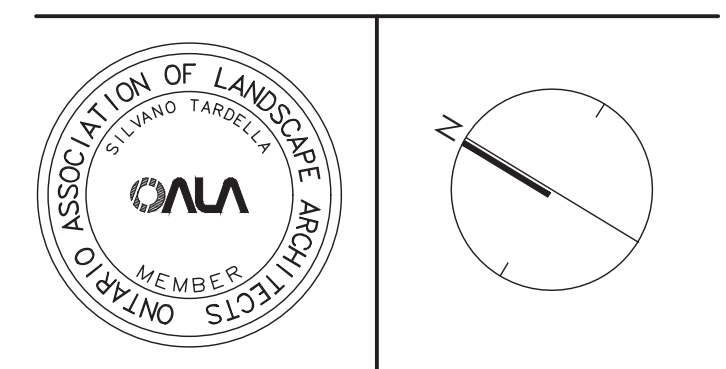

NAK design strategies
1285 WELLINGTON STREET WEST, OTTAWA, ON K1Y 3A8 CANADA
T 613.237.2345 F 613.237.6423 NAKDESIGNSTRATEGIES.COM

Project
HALF MOON BAY SOUTH
PHASE 8

Title
DETAILS

Date	JUNE 2023	Sheet	
Scale	N.T.S.		
Drawn	AM/SE		
Checked	SE/SC		
Job No.	20-210		

APPROVED
By Lily Xu at 5:12 pm, Jul 13, 2023



LILY XU, MCIP, RPP
MANAGER, DEVELOPMENT REVIEW SOUTH
PLANNING, INFRASTRUCTURE & ECONOMIC
DEVELOPMENT DEPARTMENT, CITY OF OTTAWA

D-02

Contractor shall check all dimensions on the work and report any discrepancy to the Landscape Architect before proceeding. All drawings and specifications are the property of the Landscape Architect and must be returned at the completion of the work. This drawing is not to be used for construction until signed by the Landscape Architect.

Key Plan

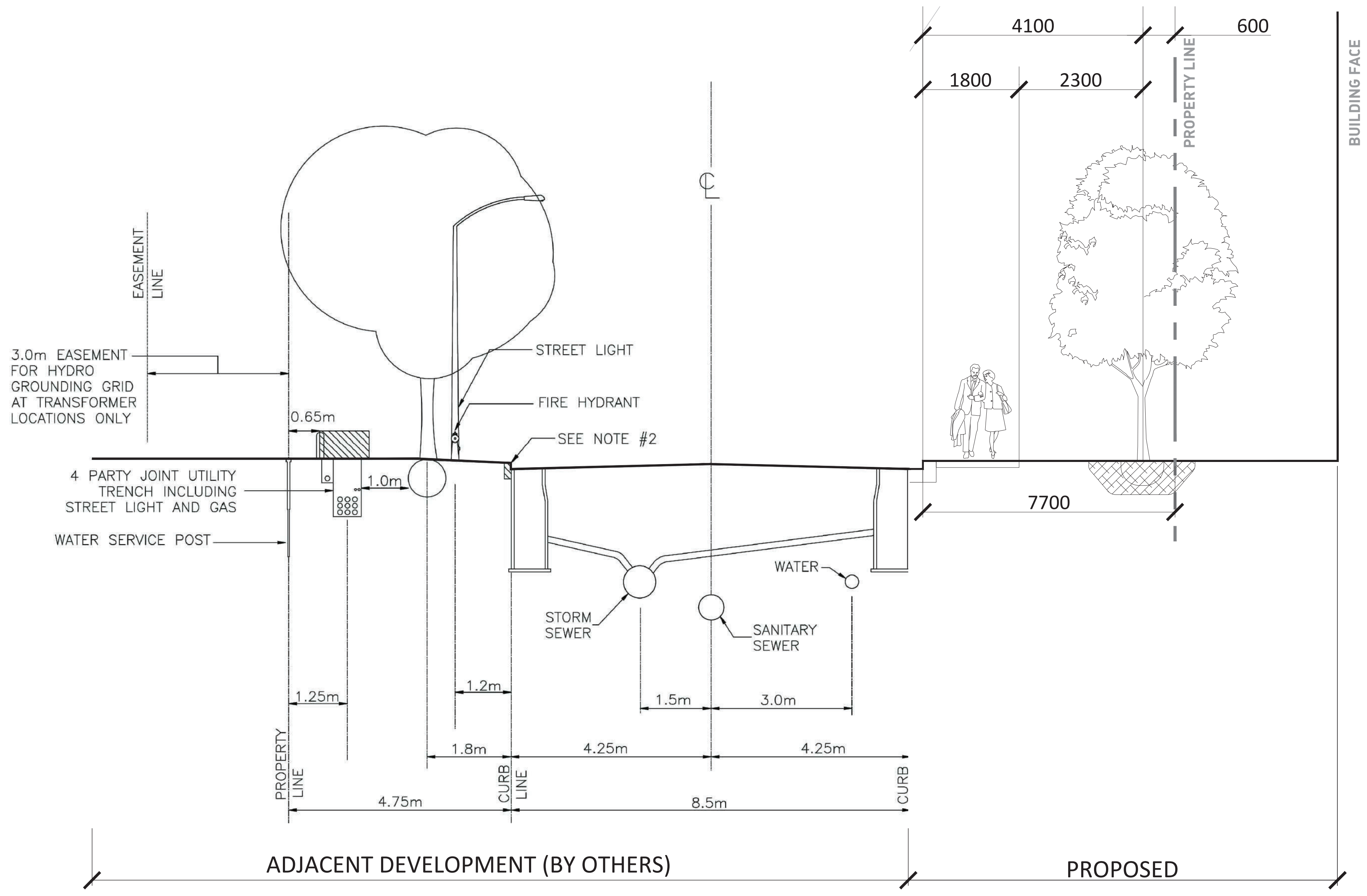

1 18.0m ROW CROSS SECTION - OBSIDIAN STREET
N.T.S.

11	Re-issued for fourth submission	JUNE 20/23
10	Issued for fourth submission	JUNE 08/23
9	Re-issued for third submission	MAR 31/23
8	Issued for third submission	MAR 24/23
7	Issued for client review	MAR 17/23
6	Issued for client review	MAR 10/23
5	Issued for Second Submission	DEC 06/22
4	Issued for Second Submission	NOV 24/22
3	Issued for Second Submission	NOV 18/22
2	Re-issued for First Submission	MAR 21/22
1	Issued for First Submission	NOV 2021
No.	Description	Date

Revision
City Approval Stamp

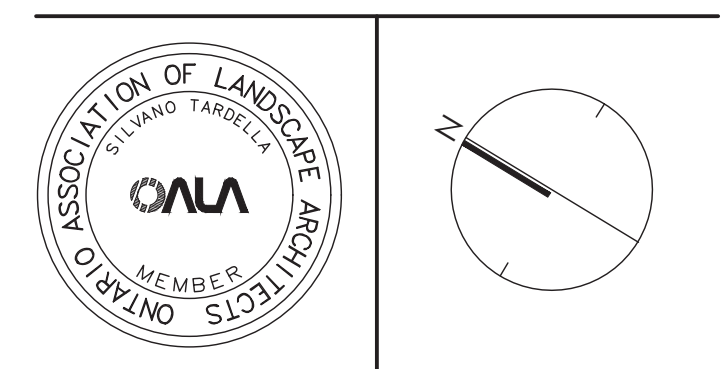

NAK design strategies
1285 WELLINGTON STREET WEST, OTTAWA, ON K1Y 3A8 CANADA
T 613.237.2345 F 613.237.4423 NAKDESIGNSTRATEGIES.COM

Project
HALF MOON BAY SOUTH
PHASE 8

Title
ROW CROSS-SECTION

APPROVED
By Lily Xu at 5:13 pm, Jul 13, 2023

Lily Xu
LILY XU, MCIP, RPP
MANAGER, DEVELOPMENT REVIEW SOUTH
PLANNING, INFRASTRUCTURE & ECONOMIC
DEVELOPMENT DEPARTMENT, CITY OF OTTAWA

Date JUNE 2023
Scale N.T.S.
Drawn SE
CheckedJSC
Job No. 20-210

Sheet
D-03