

Lighting • Controls • Shades



Control the Experience

Project name	Project number	Date		2936 Baseline Road, Suite 100 Tel: 613-592-9948 Ottawa, Ontario Fax: 613-592-9984 K2H 1B3 www.fluxlighting.ca
4 CAMPBELL REID COURT	23080	2023.06.19		
Drawing name	Drawing number	Drawn by	Checked by	
PHOTOMETRIC SUMMARY	L-01	E CARMICHAEL		

DRAWING INFORMATION

- ① LUMINAIRE MOUNTING HEIGHTS INDICATED IN DRAWINGS BY EC
- ② WALL SCONCE - M/H INDICATED IS DISTANCE FROM FLOOR TO CENTER OF FIXTURE
- ③ REFER TO ENGINEERED DRAWINGS FOR FURTHER SITE INFORMATION
- ④ CALCULATION POINT PLANE INDICATED IN SCHEDULE BY EC

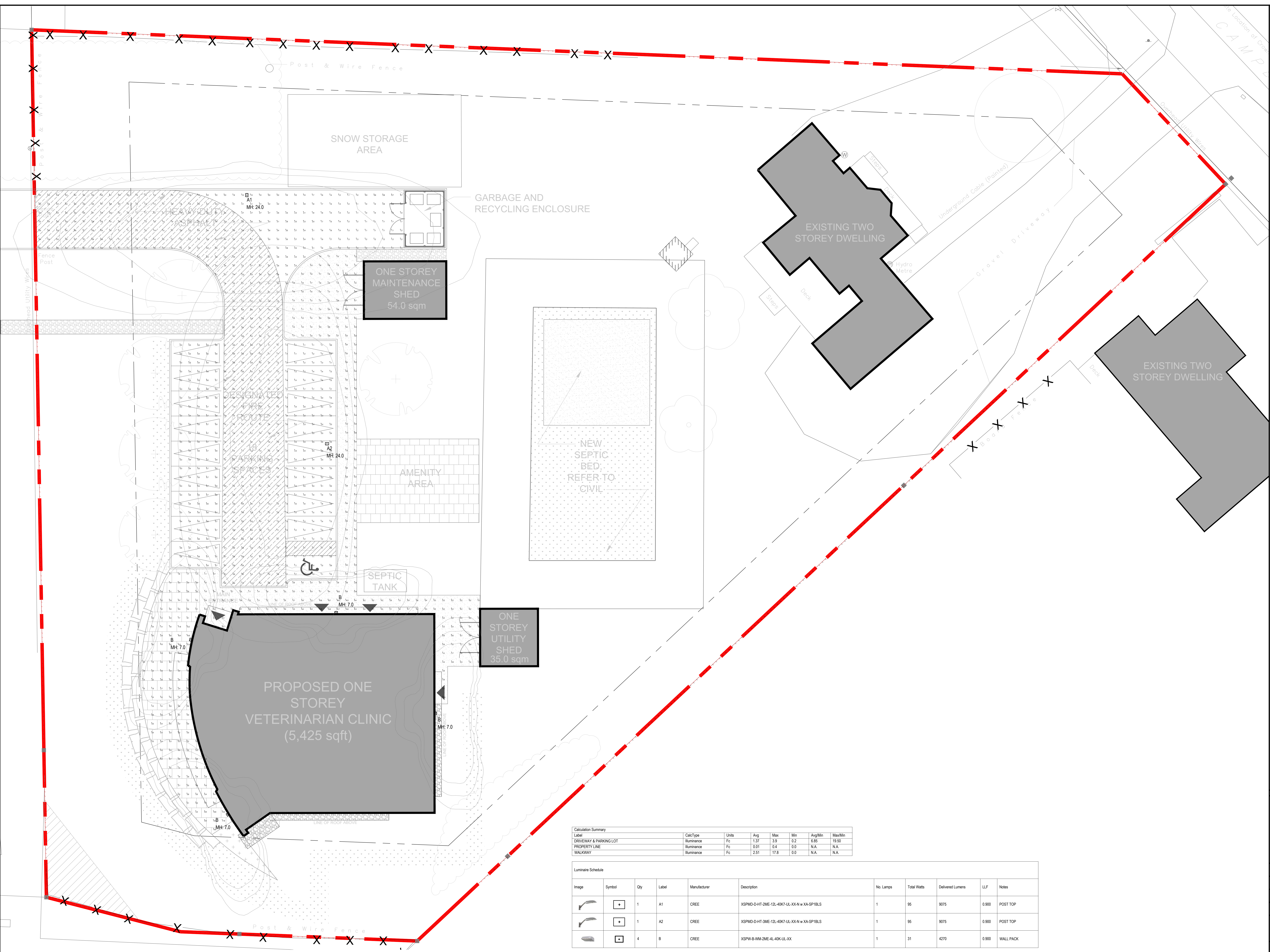

Calculation Summary

Label	Calc Type	Units	Avg	Max	Min	Avg/Min	Max/Min
DRIVEWAY & PARKING LOT	Illuminance	Fc	1.37	3.9	0.2	6.85	19.50
PROPERTY LINE	Illuminance	Fc	0.01	0.4	0.0	N.A.	N.A.
WALKWAY	Illuminance	Fc	2.51	17.6	0.0	N.A.	N.A.

Luminaire Schedule

Image	Symbol	Qty	Label	Manufacturer	Description	No. Lamps	Total Watts	Delivered Lumens	LLF	Notes
	+	1	A1	CREE	XSPMD-0-HT-2ME-12L-40K7-UL-XX-N w XX-SP18LS	1	96	9075	0.900	POST TOP
	+	1	A2	CREE	XSPMD-0-HT-3ME-12L-40K7-UL-XX-N w XX-SP18LS	1	96	9075	0.900	POST TOP
	□	4	B	CREE	XSPW-B-WM-2ME-4L-40K-UL-XX	1	31	4270	0.900	WALL PACK

① POINT BY POINT PHOTOMETRIC CALCULATION
L-02
SCALE: 1:120

② SCHEDULE AND CALCULATION SUMMARY
L-02
SCALE: NTS

REV	DESCRIPTION	DATE
1	ISSUED FOR REVIEW	
2		
3		

Project Name: 4 CAMPBELL REID COURT
 Drawing Name: PHOTOMETRIC SUMMARY
 Scale: AS SHOWN
 Date: 2023.06.19
 Project Number: 23080
 Drawing Number: L-02

Lighting • Controls • Shades
FUX
 Control the Experience