

**PAVEMENT DESIGN**  
 40mm SUPERPAVE 12.5 ASPHALTIC CONCRETE  
 50mm SUPERPAVE 19.0 ASPHALTIC CONCRETE  
 50mm SUPERPAVE 19.0 ASPHALTIC CONCRETE  
 150mm OPSS GRANULAR A CRUSHED STONE  
 600mm OPSS GRANULAR B TYPE II

ANY DISTURBED AREA DURING CONSTRUCTION TO BE RESTORED TO THE ORIGINAL CONDITION OR BETTER TO THE SATISFACTION OF THE AUTHORITIES HAVING JURISDICTION

CONTRACTOR TO VERIFY THE PRECISE LOCATIONS AND INVERT ELEVATIONS OF EX. UNDERGROUND SERVICES AND EX. UTILITIES PRIOR TO STARTING CONSTRUCTION

**NOTE:**  
 ALL EXISTING TREES, SHRUBS ETC. WITHIN LOTS, BLOCKS AND ROADS TO BE REMOVED, UNLESS OTHERWISE NOTED

PERMISSION REQUIRED FOR WORK ON ADJACENT LANDS

**NOTE: CATCHBASIN DATA**  
 FOR CATCHBASIN DATA, REFER TO DRAWING No. 3 FOR DETAIL.

**NOTE:**  
 FOR WATERMAIN STUBS, 2.4m MIN. COVER TO BE PROVIDED

**NOTE-RE: TEST PIT/BOREHOLE EXCAVATIONS**  
 ANY DISTURBED MATERIAL ENCOUNTERED BELOW THE SUBGRADE LEVEL WITHIN A BUILDING FOOTPRINT TO BE SUB-EXCAVATED AND BACKFILLED WITH COMPACTED ENGINEERED FILL AS PER GEOTECHNICAL ENGINEERS RECOMMENDATION.

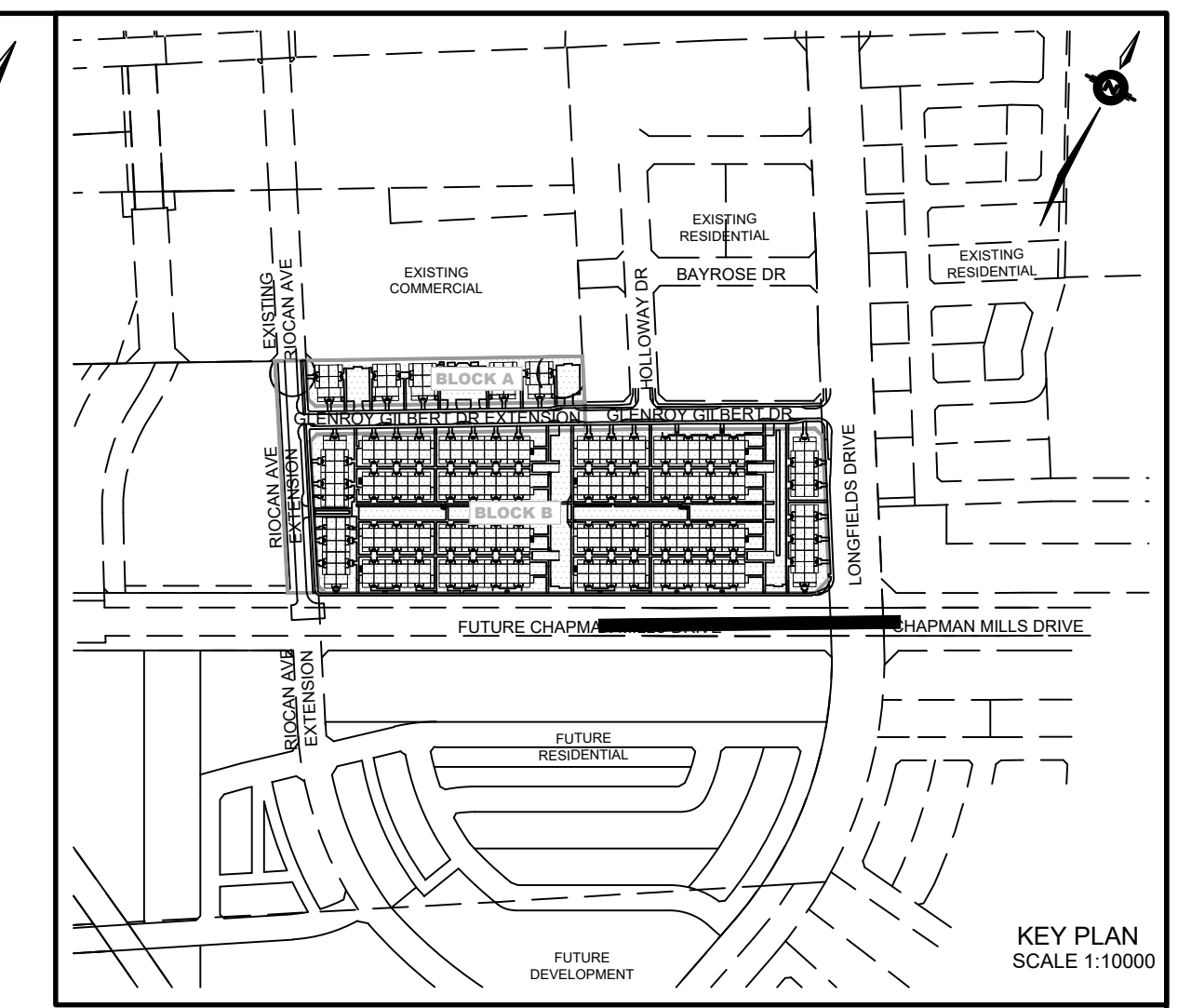
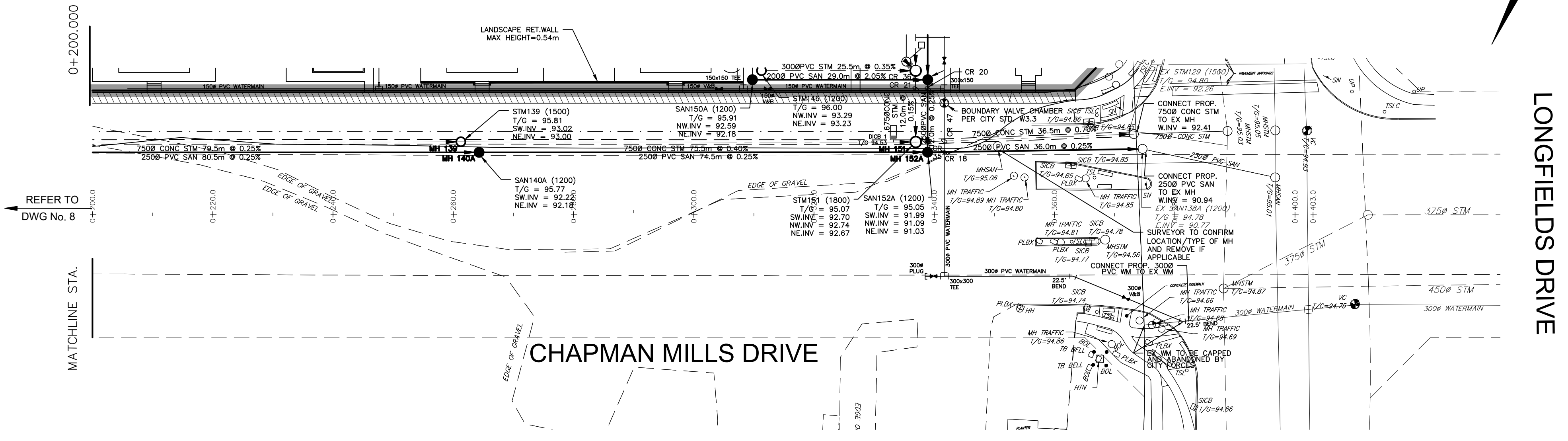

LONGFIELDS DRIVE

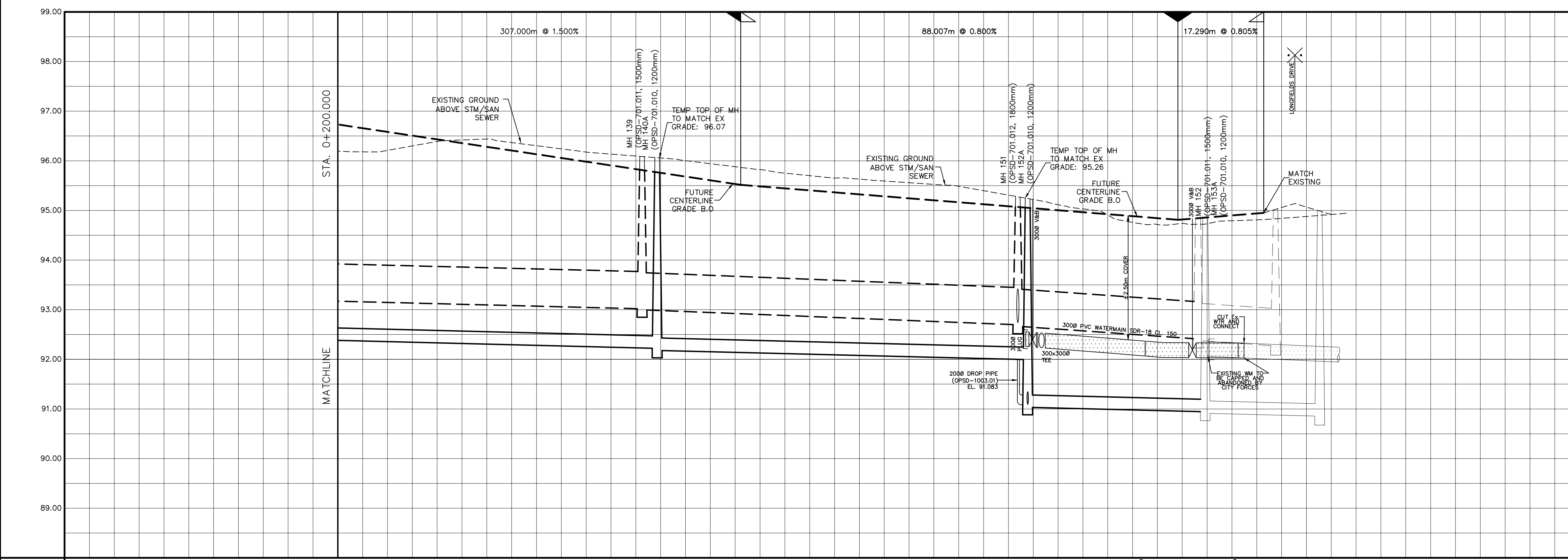
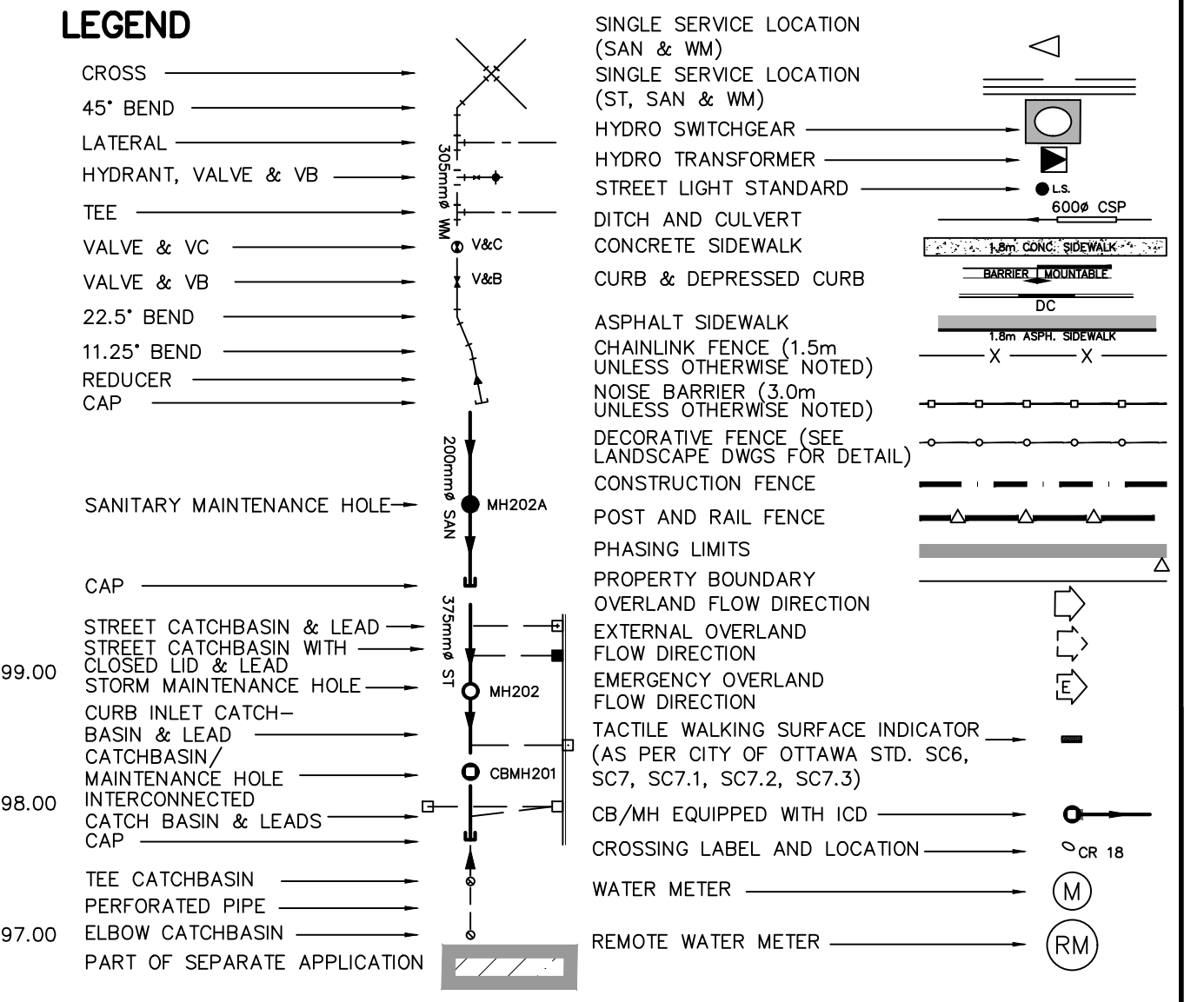

TOP OF WATERMAIN	99.00	98.00	97.00	96.00	95.00	94.00	93.00	92.00	91.00	90.00	89.00
SANITARY INVERT	92.22	92.22	92.22	92.22	92.22	92.22	92.22	92.22	92.22	92.22	92.22
STORM INVERT	92.22	92.22	92.22	92.22	92.22	92.22	92.22	92.22	92.22	92.22	92.22
PROPOSED GRADES	96.732	96.432	96.132	95.832	95.532	95.232	94.932	94.632	94.332	94.032	93.732
CENTERLINE CHAINAGE	0+200.000	0+220.000	0+240.000	0+260.000	0+280.000	0+300.000	0+320.000	0+340.000	0+360.000	0+380.000	0+400.000

**NOT FOR CONSTRUCTION**

No.	BY	DATE	DESCRIPTION
3	S.L.M.	23-06-30	3RD SUBMISSION
2	S.L.M.	23-03-10	2ND SUBMISSION
1	S.L.M.	22-06-10	1ST SUBMISSION

**TOPOGRAPHIC INFORMATION**  
 TOPOGRAPHIC INFORMATION PROVIDED BY STANTEC GEOMATICS LTD., PROJECT No. 161614291-111, DATED MARCH 1, 2022

**SITE PLAN INFORMATION**  
 SITE PLAN PROVIDED BY SRN ARCHITECTS LTD., PROJECT No. S21001, DATED JUNE 27, 2023

**LEGAL INFORMATION**  
 CALCULATED DRAFT PLAN PROVIDED BY STANTEC GEOMATICS LTD., PROJECT No. 161614291-111, DATED MAY 9, 2022

**BENCH MARK**  
 ELEVATIONS ARE REFERRED TO THE CANADIAN GEODETIC VERTICAL DATUM (CGVD-1928:1978) AND ARE DERIVED FROM BENCHMARK MONUMENT No. 196530071\*, HAVING A PUBLISHED ELEVATION OF 99.742 METRES

MINTO COMMUNITIES INC.      BARRHAVEN TOWN CENTRE  
 GLENROY GILBERT DRIVE RIOCAN AVENUE & CHAPMAN MILLS DRIVE EXTENSION

**DSEL**  
 LICENSED PROFESSIONAL ENGINEER  
 S. L. MERRICK  
 100186523  
 2023-06-30  
 PROVINCE OF ONTARIO

120 Iber Road Unit 103  
 Slitsville, Ontario, K2S 1E9  
 Tel. (613) 836-0856  
 Fax. (613) 836-7183  
 www.DSEL.ca

Ottawa  
 110 Laurier Ave W  
 Ottawa, Ontario, K1P 1J1  
 Tel. (613) 580-2400  
 www.Ottawa.ca

PLAN AND PROFILE OF  
**CHAPMAN MILLS DRIVE**  
 STA 0+200.000 TO STA 0+420.000

© DSEL

DRAWN BY: AM	CHECKED BY: BC	PROJECT No. 15-816
DESIGNED BY: BC	CHECKED BY: SM	SHEET No. 9

SCALE: HORZ: 1:500      0 5 10 15 20  
 VERT: 1:50      0 0.5 1.0 1.5 2.0

CITY PLAN No. 18822  
 CITY FILE No. D07-12-22-0104