

**NOTE:**  
A GEOTECHNICAL ENGINEER LICENSED IN THE PROVINCE OF ONTARIO IS TO INSPECT ALL SUBGRADE SURFACES FOR FOOTING AND PAVEMENT STRUCTURES PRIOR TO CONSTRUCTION

**NOTE:**  
ALL EXISTING POST & WIRE FENCE, CULVERTS, UTILITY WIRE / POLES, TREES, SHRUBS ETC. WITHIN LOTS, BLOCKS AND ROADS TO BE REMOVED, UNLESS OTHERWISE NOTED

**CONTRACTOR TO VERIFY THE PRECISE LOCATIONS AND INVERT ELEVATIONS OF EX. UNDERGROUND SERVICES AND EX. UTILITIES PRIOR TO STARTING CONSTRUCTION**

**NOTE RE: PERFORATED PIPE**  
PERFORATED PIPE IS REQUIRED FOR SWALE SLOPE LESS THAN 1.5% REFER TO CITY STD. S29, S30 FOR REAR YARD TRENCH AND PIPE DETAIL ONLY

PERMISSION REQUIRED FOR WORK ON ADJACENT LANDS

**NOTE:**  
ALL SWALES SHALL BE 0.15m DEEP WITH 3:1 SIDE SLOPES UNLESS OTHERWISE INDICATED

**NOTE:**  
ENTRANCES TO PRIVATE SITE PER SC7.1

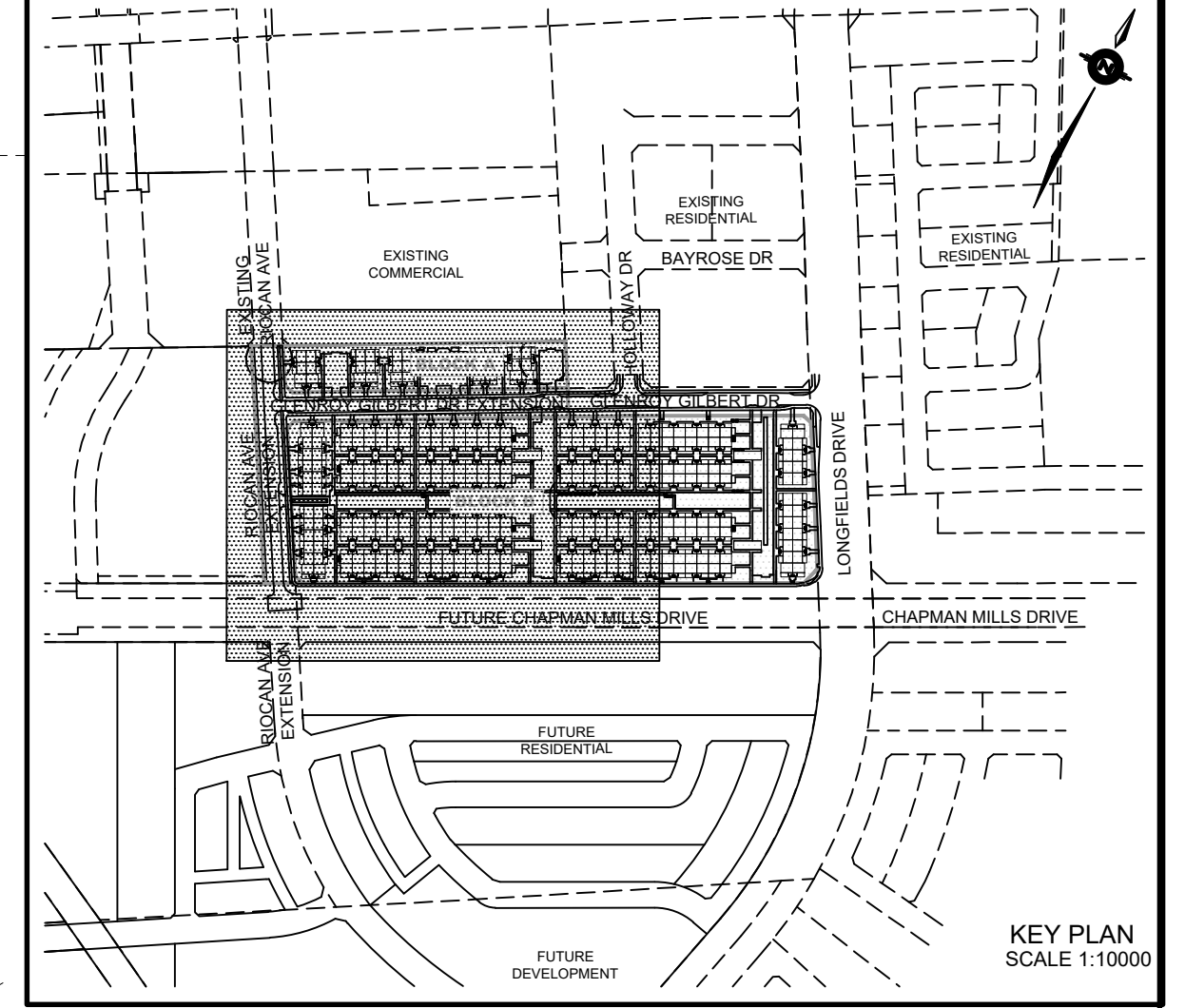
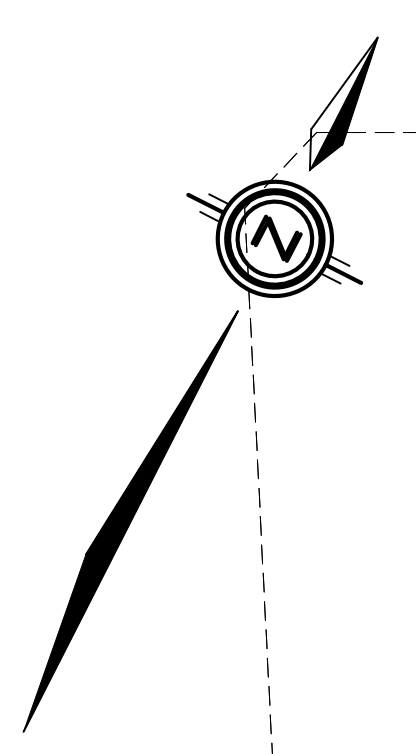
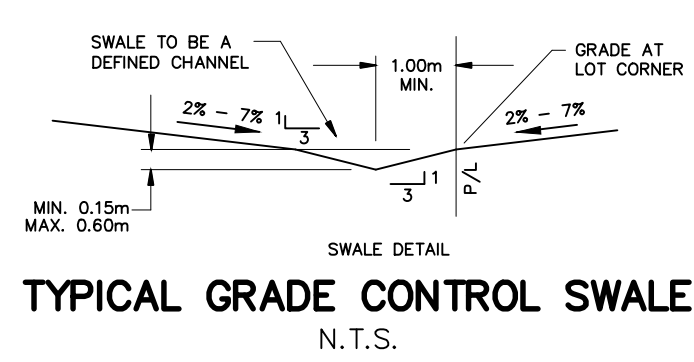

**LEGEND**

PROPOSED ELEVATION	103.45	OVERLAND FLOW DIRECTION	→
EXISTING ELEVATION	102.73	EXTERNAL OVERLAND FLOW DIRECTION	→
FUTURE ELEVATION	[93.90]	EMERGENCY OVERLAND FLOW DIRECTION	→
PROPOSED SWALE GRADE	1.5%	RETAINING WALL AND ELEVATIONS	1/7=103.10 8/7=102.44
HIGH POINT	102.16	CHAINLINK FENCE (1.5m UNLESS OTHERWISE NOTED)	— —
STREET CATCHBASIN		VALVE & VC	— —
STREET CATCHBASIN WITH CLOSED LID		VALVE & VB	— —
CATCHBASIN MANHOLE		BUILDING ENVELOPE	— —
TEE CATCHBASIN		TOP OF FOUNDATION (TOF)	— —
ELBOW CATCHBASIN		FINISHED FLOOR ELEVATION (FFE)	— —
HYDRANT, VALVE & VB		UNDERSIDE OF FOOTING ELEVATION (USF)	— —
HYDRANT, VALVE & VC		ELEVATION (USF)	— —
NOISE BARRIER (3.0m UNLESS OTHERWISE NOTED)		UNITS REQUIRING WATER PRESSURE REDUCING VALVES	— —
NOISE BARRIER (3.0m UNLESS OTHERWISE NOTED)		WALKOUT UNITS	— —
DECORATIVE FENCE (SEE LANDSCAPE DWGS FOR DETAIL)		SLAB ON GRADE	— —
CONSTRUCTION FENCE		LANDS MAX	— —
PROPERTY BOUNDARY		HYDRO SWITCHGEAR	— —
3:1 TERRACING MAXIMUM SLOPE		STREET LIGHT STANDARD	— —
PRV		TACTILE WALKING SURFACE INDICATOR (AS PER CITY OF OTTAWA STD. SC6)	— —
W.O.		PREVIOUS PHASES / PHASES NOT PART OF CURRENT GRADING APPROVAL	— —
SOG			
250# PVC PERFORATED PIPE (REFER TO CITY STD S29 FOR REAR YARD TRENCH AND PIPE DETAILS ONLY)			
(SUBIRAN APPLIED FOR SLOPE LESS THAN 1.5%)			

**NOT FOR CONSTRUCTION**

No.	BY	DATE	DESCRIPTION
3	S.L.M.	23-06-30	3RD SUBMISSION
2	S.L.M.	23-03-10	2ND SUBMISSION
1	S.L.M.	22-06-10	1ST SUBMISSION

**TOPOGRAPHIC INFORMATION**  
TOPOGRAPHIC INFORMATION PROVIDED BY STANTEC GEOMATICS LTD., PROJECT No. 161614291-111, DATED MARCH 1, 2022

**SITE PLAN INFORMATION**  
SITE PLAN PROVIDED BY SRN ARCHITECTS LTD., PROJECT No. S21001, DATED JUNE 27, 2023

**LEGAL INFORMATION**  
CALCULATED DRAFT PLAN PROVIDED BY STANTEC GEOMATICS LTD., PROJECT No. 161614291-111, DATED MAY 9, 2022

**BENCH MARK**  
ELEVATIONS ARE REFERRED TO THE CANADIAN GEODETIC VERTICAL DATUM (CGVD-1928:1978) AND ARE DERIVED FROM BENCHMARK MONUMENT No. 196530071-1, HAVING A PUBLISHED ELEVATION OF 99.742 METRES

MINTO COMMUNITIES INC.  
BARRHAVEN TOWN CENTRE  
GLENROY GILBERT DRIVE RIOCAN AVENUE & CHAPMAN MILLS DRIVE EXTENSION

Ottawa  
110 Laurier Ave W  
Ottawa, Ontario, K1P 1J1  
Tel. (613) 580-2400  
www.Ottawa.ca

**CITY ROW GRADING PLAN WEST**

DRAWN BY: AM	CHECKED BY: BC	PROJECT No. 15-816
DESIGNED BY: BC	CHECKED BY: SM	SHEET No. 10
SCALE: 1:500		

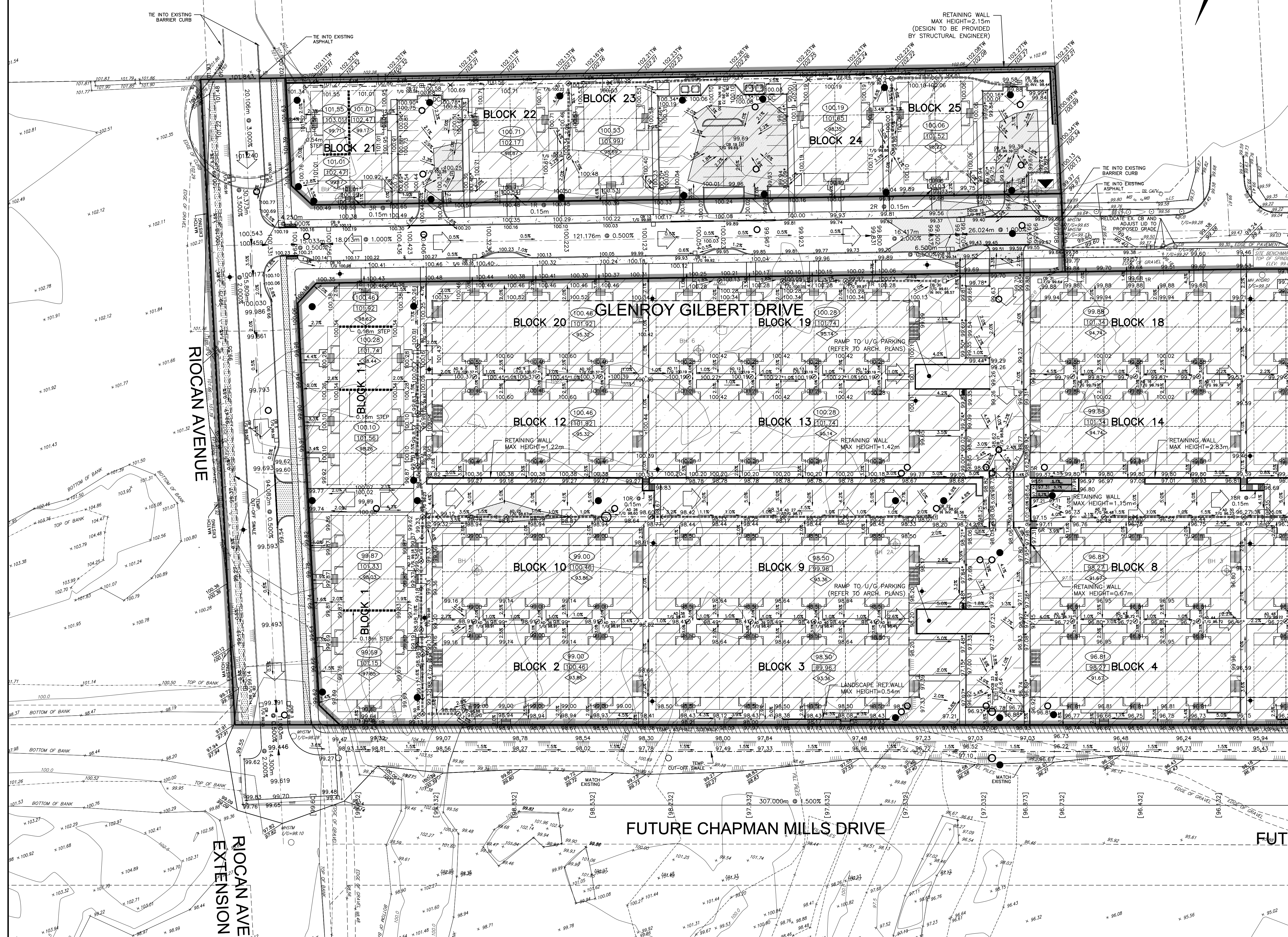

CITY PLAN No. 18822  
CITY FILE No. D07-12-22-0104