

**NOTE:**  
A GEOTECHNICAL ENGINEER LICENSED IN THE PROVINCE OF ONTARIO IS TO INSPECT ALL SUBGRADE SURFACES FOR FOOTING AND PAVEMENT STRUCTURES PRIOR TO CONSTRUCTION

**NOTE:**  
ALL EXISTING POST & WIRE FENCE, CULVERTS, UTILITY WIRE / POLES, TREES, SHRUBS ETC. WITHIN LOTS, BLOCKS AND ROADS TO BE REMOVED, UNLESS OTHERWISE NOTED

**NOTE RE: PERFORATED PIPE**  
PERFORATED PIPE IS REQUIRED FOR SWALE SLOPE LESS THAN 1.5%. REFER TO CITY STD. S29, S30 FOR REAR YARD TRENCH AND PIPE DETAIL ONLY

**NOTE:**  
ALL SWALES SHALL BE 0.15m DEEP WITH 3:1 SIDE SLOPES UNLESS OTHERWISE INDICATED

**NOTE:**  
ENTRANCES TO PRIVATE SITE PER SC7.1

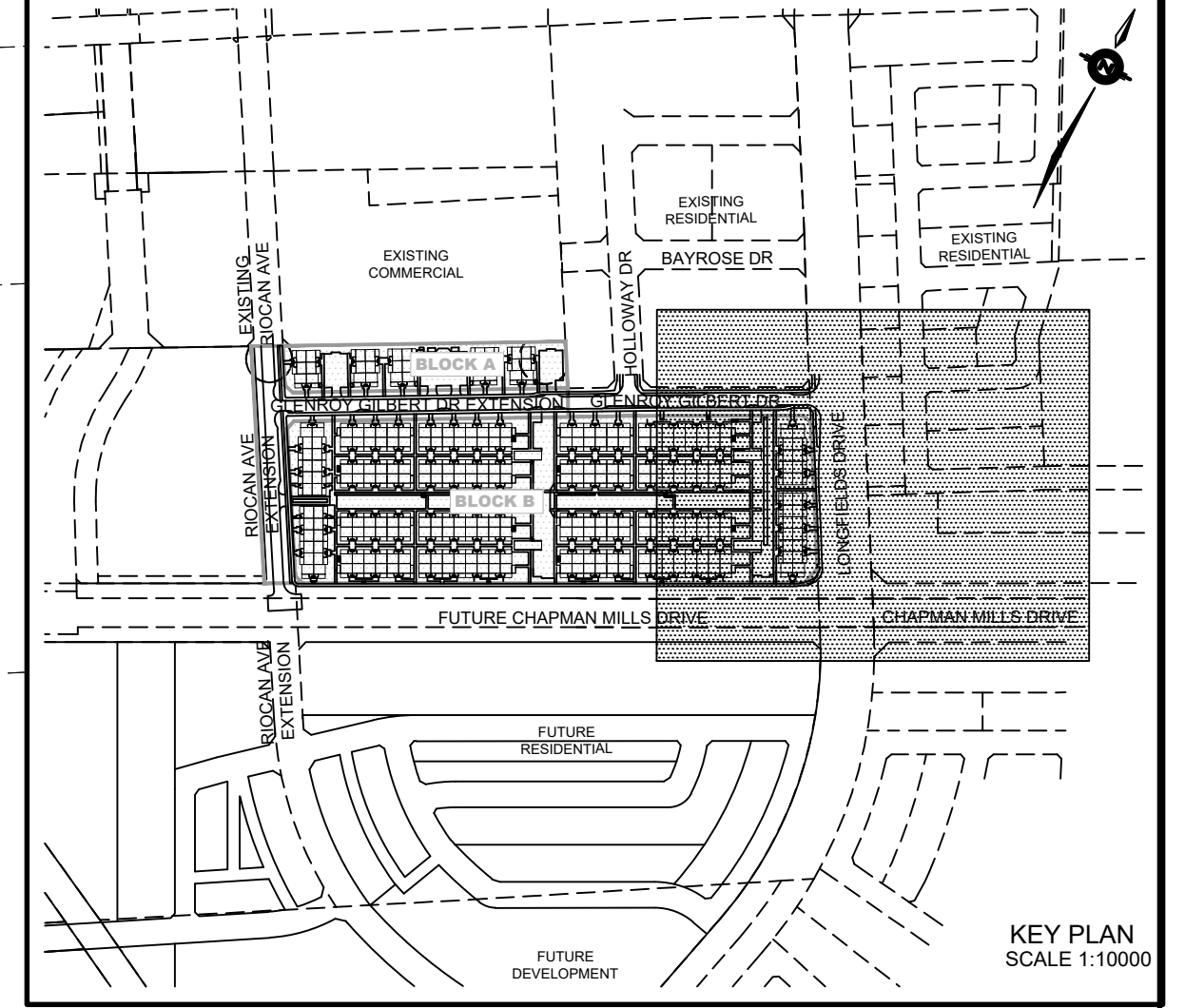
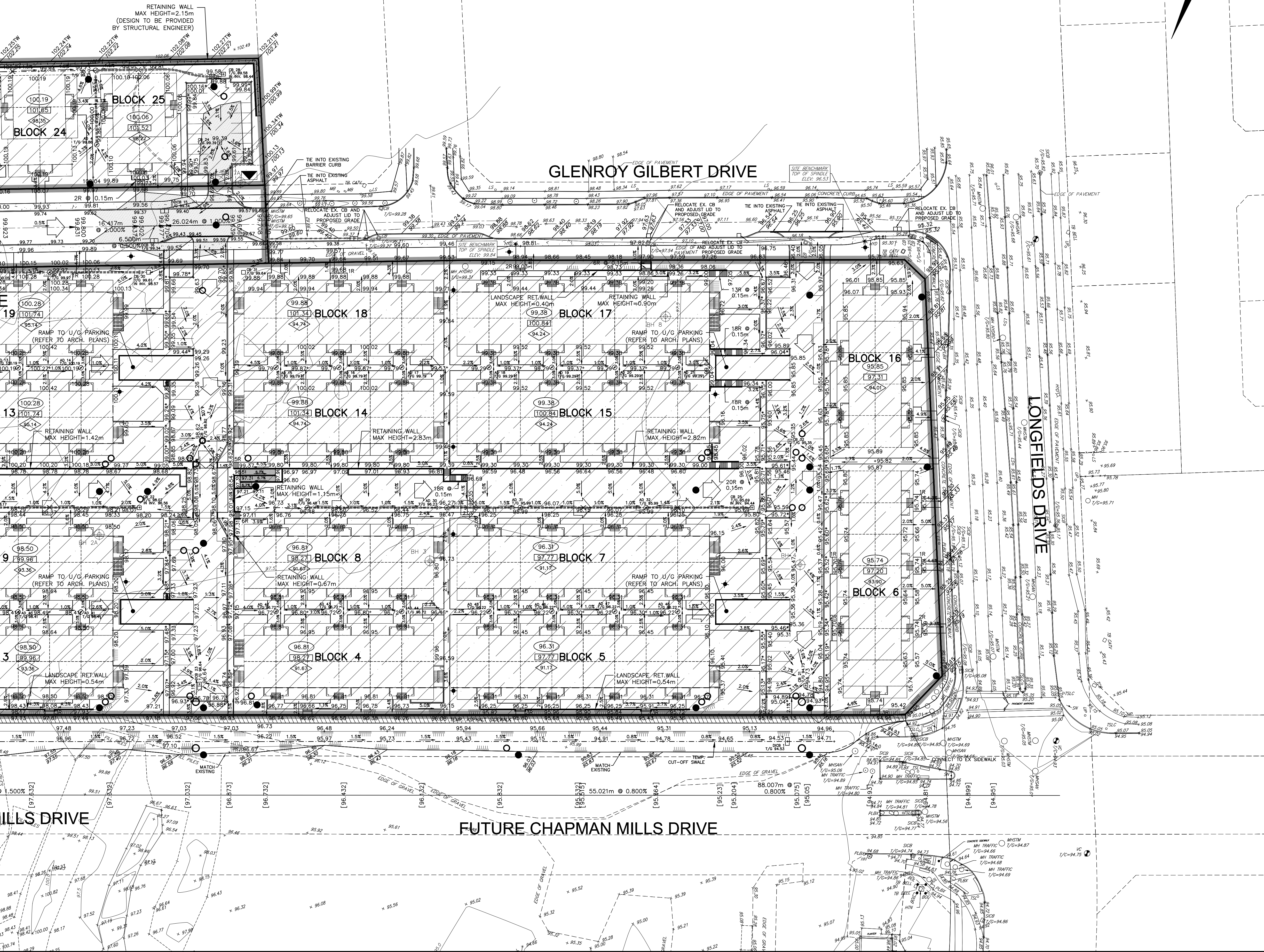
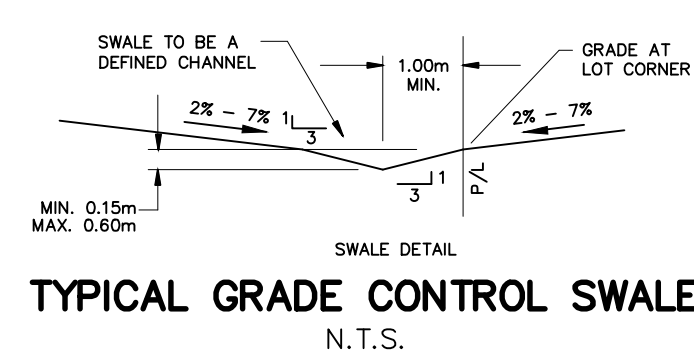

**LEGEND**

PROPOSED ELEVATION	103.45	OVERLAND FLOW DIRECTION	→
EXISTING ELEVATION	102.73	EXTERNAL OVERLAND FLOW DIRECTION	→
FUTURE ELEVATION	[93.90]	EMERGENCY OVERLAND FLOW DIRECTION	→
PROPOSED SWALE GRADE	1.5%	RETAINING WALL AND ELEVATIONS	1.7m-103.10 8.7m-102.44
HIGH POINT	102.16	CHAINLINK FENCE (1.5m UNLESS OTHERWISE NOTED)	— —
STREET CATCHBASIN		NOISE BARRIER (3.0m UNLESS OTHERWISE NOTED)	— —
STREET CATCHBASIN WITH CLOSED LID		DECORATIVE FENCE (SEE LANDSCAPE DWGS FOR DETAIL)	— —
CATCHBASIN MANHOLE		CONSTRUCTION FENCE	— —
TEE CATCHBASIN		PROPERTY BOUNDARY	— —
ELBOW CATCHBASIN		3:1 TERRACING MAXIMUM SLOPE	— —
HYDRANT, VALVE & VB		UNDERSIDE OF FOOTING ELEVATION (USF)	— —
VALVE & VC		UNITS REQUIRING WATER PRESSURE REDUCING VALVES	— —
VALVE & VB		WALKOUT UNITS	— —
BUILDING ENVELOPE		SLAB ON GRADE	— —
TOP OF FOUNDATION (TOF)		HYDRO SWITCHGEAR	— —
FINISHED FLOOR ELEVATION (FFE)		HYDRO TRANSFORMER	— —
UNDERSIDE OF FOOTING ELEVATION (USF)		STREET LIGHT STANDARD	— —
UNITS REQUIRING WATER PRESSURE REDUCING VALVES		TACTILE WALKING SURFACE INDICATOR (AS PER CITY OF OTTAWA STD. S46)	— —
WALKOUT UNITS		PREVIOUS PHASES / PHASES NOT PART OF CURRENT GRADING APPROVAL	— —
SLAB ON GRADE			
250# PVC PERFORATED PIPE (REFER TO CITY STD S29 FOR REAR YARD TRENCH AND PIPE DETAILS ONLY) (SUBIRAN APPLIED FOR SLOPE LESS THAN 1.5%)			

**NOT FOR CONSTRUCTION**

No.	BY	DATE	DESCRIPTION
3	S.L.M.	23-06-30	3RD SUBMISSION
2	S.L.M.	23-03-10	2ND SUBMISSION
1	S.L.M.	22-06-10	1ST SUBMISSION

**TOPOGRAPHIC INFORMATION**  
TOPOGRAPHIC INFORMATION PROVIDED BY STANTEC GEOMATICS LTD., PROJECT No. 161614291-111, DATED MARCH 1, 2022

**SITE PLAN INFORMATION**  
SITE PLAN PROVIDED BY SRN ARCHITECTS LTD., PROJECT No. S21001, DATED JUNE 27, 2023

**LEGAL INFORMATION**  
CALCULATED DRAFT PLAN PROVIDED BY STANTEC GEOMATICS LTD., PROJECT No. 161614291-111, DATED MAY 9, 2022

**BENCH MARK**  
ELEVATIONS ARE REFERRED TO THE CANADIAN GEODETIC VERTICAL DATUM (CGVD-1928:1978) AND ARE DERIVED FROM BENCHMARK MONUMENT No. 196530071-A, HAVING A PUBLISHED ELEVATION OF 99.742 METRES

**MINTO COMMUNITIES INC.**  
BARRHAVEN TOWN CENTRE  
GLENROY GILBERT DRIVE RIOCAN AVENUE & CHAPMAN MILLS DRIVE EXTENSION

**DSEL**  
120 Iber Road Unit 103  
Slitsville, Ontario, K2S 1E9  
Tel. (613) 836-0856  
Fax. (613) 836-7183  
www.DSEL.ca

**S.L. MERRICK**  
100166223  
2023-06-30  
PROVINCE OF ONTARIO  
106415-816

**Ottawa**  
110 Laurier Ave W  
Ottawa, Ontario, K1P 1J1  
Tel. (613) 580-2400  
www.Ottawa.ca

**CITY ROW GRADING PLAN EAST**

DRAWN BY: AM	CHECKED BY: BC	PROJECT No. 15-816
DESIGNED BY: BC	CHECKED BY: SM	SHEET No. 11
SCALE: 1:500		

CITY PLAN No. 18822  
CITY FILE No. D07-12-22-0104