

**PAVEMENT DESIGN**  
 40mm SUPERPAVE 12.5 ASPHALTIC CONCRETE  
 50mm SUPERPAVE 13.0 ASPHALTIC CONCRETE  
 150mm OPSS GRANULAR A CRUSHED STONE  
 450mm OPSS GRANULAR B TYPE II

ANY DISTURBED AREA DURING CONSTRUCTION TO BE RESTORED TO THE ORIGINAL CONDITION OR BETTER TO THE SATISFACTION OF THE AUTHORITIES HAVING JURISDICTION

CONTRACTOR TO VERIFY THE PRECISE LOCATIONS AND INVERT ELEVATIONS OF EX. UNDERGROUND SERVICES AND EX. UTILITIES PRIOR TO STARTING CONSTRUCTION

**NOTE:**  
 ALL EXISTING TREES, SHRUBS ETC. WITHIN LOTS, BLOCKS AND ROADS TO BE REMOVED, UNLESS OTHERWISE NOTED

PERMISSION REQUIRED FOR WORK ON ADJACENT LANDS

**NOTE: CATCHBASIN DATA**  
 FOR CATCHBASIN DATA, REFER TO DRAWING No. 3 FOR DETAIL.

**NOTE:**  
 FOR WATERMAIN STUBS, 2.4m MIN. COVER TO BE PROVIDED

**NOTE-RE: TEST PIT/BOREHOLE EXCAVATIONS**  
 ANY DISTURBED MATERIAL ENCOUNTERED BELOW THE SUBGRADE LEVEL WITHIN A BUILDING FOOTPRINT TO BE SUB-EXCAVATED AND BACKFILLED WITH COMPACTED ENGINEERED FILL AS PER GEOTECHNICAL ENGINEERS RECOMMENDATION.

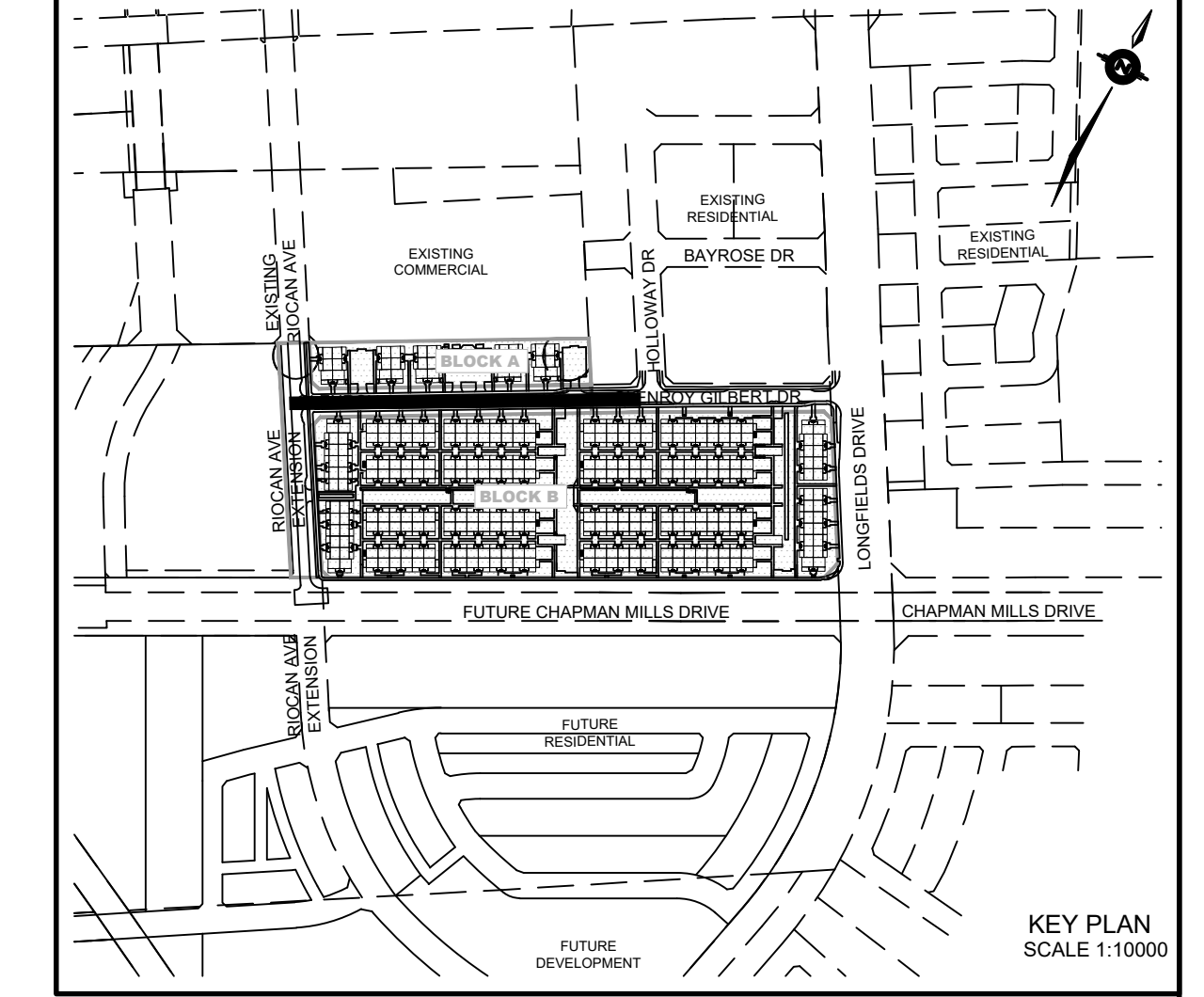
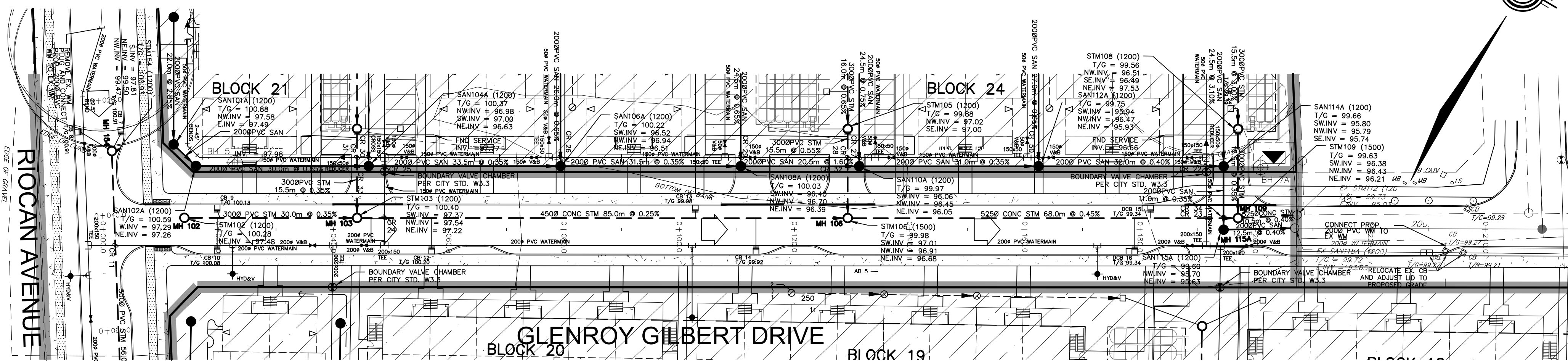

- LEGEND**
- CROSS
  - 45° BEND
  - LATERAL
  - HYDRANT, VALVE & VB
  - TEE
  - VALVE & VC
  - VALVE & VB
  - 22.5° BEND
  - 11.25° BEND
  - REDUCER
  - CAP
  - SANITARY MAINTENANCE HOLE
  - CAP
  - STREET CATCHBASIN & LEAD
  - STREET CATCHBASIN WITH FLOW DIRECTION
  - CLOSED LID & LEAD
  - STORM MAINTENANCE HOLE
  - CURB INLET CATCH-BASIN & LEAD
  - CATCHBASIN/ MAINTENANCE HOLE INTERCONNECTED
  - CATCH BASIN & LEADS
  - TEE CATCHBASIN
  - PERFORATED PIPE
  - ELBOW CATCHBASIN
  - PART OF SEPARATE APPLICATION
  - SINGLE SERVICE LOCATION (SAN & WM)
  - SINGLE SERVICE LOCATION (ST, SAN & WM)
  - HYDRO SWITCHGEAR
  - HYDRO TRANSFORMER
  - STREET LIGHT STANDARD
  - DITCH AND CULVERT
  - CONCRETE SIDEWALK
  - CURB & DEPRESSURE CURB
  - ASPHALT SIDEWALK
  - CHAINLINK FENCE (1.5m UNLESS OTHERWISE NOTED)
  - NOISE BARRIER (3.0m UNLESS OTHERWISE NOTED)
  - DECORATIVE FENCE (SEE LANDSCAPE DWGS FOR DETAIL)
  - CONSTRUCTION FENCE
  - POST AND RAIL FENCE
  - PHASING LIMITS
  - PROPERTY BOUNDARY
  - OVERLAND FLOW DIRECTION
  - EXTERNAL OVERLAND FLOW DIRECTION
  - CLOSED LID & LEAD
  - EMERGENCY OVERLAND FLOW DIRECTION
  - TACTILE WALKING SURFACE INDICATOR (AS PER CITY OF OTTAWA STD. SC6, SC7, SC7-1, SC7-2, SC7-3)
  - CB/MH EQUIPPED WITH ICD
  - CROSSING LABEL AND LOCATION
  - WATER METER
  - REMOTE WATER METER

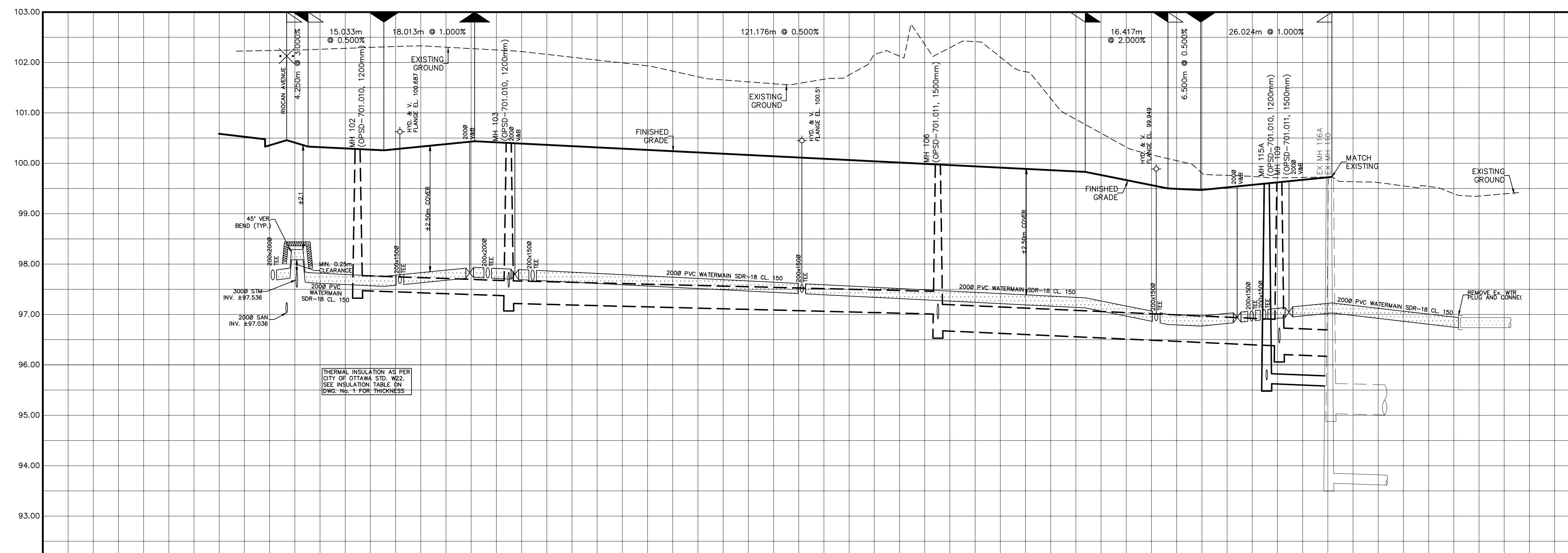

TOP OF WATERMAIN	97.865 98.288 97.931 97.816	97.724 97.756	97.743 97.723	97.623	97.723	97.623 97.612	97.623	97.623	97.423	97.331 97.300	97.610 97.602 96.977 96.970	97.200 97.200 97.100 97.100 97.100	97.200	97.104 96.819	97.200	97.200	TOP OF WATERMAIN	
SANITARY INVERT																	SANITARY INVERT	
STORM INVERT		NE 97.475															STORM INVERT	
PROPOSED GRADES	100.459 100.311 100.311	100.282 100.284	100.436 100.423	100.453 100.404	100.323												PROPOSED GRADES	
CENTERLINE CHAINAGE	0+000.000 0+100.000 0+150.000 0+200.000	0+104.070 0+113.663 0+120.000	0+137.710 0+140.000 0+144.058 0+146.000	0+146.000	0+079.375 0+080.000	0+100.000 0+110.000 0+118.307 0+120.000	0+110.665 0+120.000	0+120.000	0+140.000	0+158.477 0+160.000 0+162.359	0+174.882 0+180.000 0+184.998	0+191.421 0+193.000 0+194.475	0+200.000 0+200.000 0+200.000 0+200.000	0+207.413	0+217.413	0+220.000	0+240.000	CENTERLINE CHAINAGE

NOT FOR CONSTRUCTION

3	S.L.M.	23-06-30	3RD SUBMISSION
2	S.L.M.	23-03-10	2ND SUBMISSION
1	S.L.M.	22-06-10	1ST SUBMISSION
No.	BY	DATE	DESCRIPTION
<b>TOPOGRAPHIC INFORMATION</b> TOPOGRAPHIC INFORMATION PROVIDED BY STANTEC GEOMATICS LTD., PROJECT No. 161614291-111, DATED MARCH 1, 2022			
<b>SITE PLAN INFORMATION</b> SITE PLAN PROVIDED BY SRN ARCHITECTS LTD., PROJECT No. S21001, DATED JUNE 27, 2023			
<b>LEGAL INFORMATION</b> CALCULATED DRAFT PLAN PROVIDED BY STANTEC GEOMATICS LTD., PROJECT No. 161614291-111, DATED MAY 9, 2022			
<b>BENCH MARK</b> ELEVATIONS ARE REFERRED TO THE CANADIAN GEODETIC VERTICAL DATUM (CGVD-1928:1978) AND ARE DERIVED FROM BENCHMARK MONUMENT No. 1965300771, HAVING A PUBLISHED ELEVATION OF 99.742 METRES			
MINTO COMMUNITIES INC.		BARRHAVEN TOWN CENTRE GLENROY GILBERT DRIVE RIOCAN AVENUE & CHAPMAN MILLS DRIVE EXTENSION	
120 Ber Road Unit 103 Slitsville, Ontario, K2S 1E9 Tel. (613) 836-0856 Fax. (613) 836-7183 www.DSEL.ca		110 Laurier Ave W Ottawa, Ontario, K1P 1J1 Tel. (613) 580-2400 www.Ottawa.ca	
PLAN AND PROFILE OF <b>GLENROY GILBERT DRIVE</b> (STA 0+000.000 TO STA 0+240.000)			
DRAWN BY: AM		CHECKED BY: BC	
DESIGNED BY: BC		CHECKED BY: SM	
SCALE: HORZ: 1:500		0 5 10 15 20	
VERT: 1:50		0 0.5 1.0 1.5 2.0	
PROJECT No.		15-816	
SHEET No.		6	

CITY PLAN No. 18822  
 CITY FILE No. D07-12-22-0104