

**NOTE:**  
ALL WATERMAIN CONNECTIONS AND DECOMMISSIONING OF EXISTING WATERMANS TO BE COMPLETED BY CITY FORCES. TRENCH BACKFILL/REINSTATEMENT TO BE COMPLETED BY THE CONTRACTOR TO THE SATISFACTION OF THE CITY OF OTTAWA.

**CONTRACTOR TO VERIFY THE PRECISE LOCATIONS AND INVERT ELEVATIONS OF EX UNDERGROUND SERVICES AND UTILITIES PRIOR TO STARTING CONSTRUCTION**

**ANY DISTURBED AREA DURING CONSTRUCTION TO BE RESTORED TO THE ORIGINAL CONDITION OR BETTER TO THE SATISFACTION OF THE AUTHORITIES HAVING JURISDICTION**

**NOTE:**  
ALL EXISTING TREES, SHRUBS ETC. WITHIN LOTS, BLOCKS AND ROADS TO BE REMOVED, UNLESS OTHERWISE NOTED

**NOTE:**  
THE COVER OF EX. MH, CB, CHAMBER AND OTHER ABOVEGROUND FEATURES TO BE ADJUSTED TO SUIT THE NEW FINISHED GRADE, WHERE APPLICABLE

**NOTE: RE: WATERMAIN / WATER SERVICE**  
1. INSULATION REQUIRED FOR WATERMAIN / WATER SERVICE WHERE THE SEPARATION BETWEEN WATERMAIN / WATER SERVICE AND OTHER SERVICES AND STRUCTURES IS LESS THAN 1.2m AND THE COVER IS LESS THAN 2.4m. REFER TO CITY STD. W3 FOR SERVICE INSTALLATION AT SEWER CROSSING. REFER TO CITY STD. W38 FOR DETAIL

**NOTE: RE: TEST PIT / BOREHOLE EXCAVATIONS**  
ANY DISTURBED MATERIAL ENCOUNTERED BELOW THE SUBGRADE LEVEL WITHIN A BUILDING FOOTPRINT IS TO BE SUB-EVAPORATED AND BACKFILLED WITH COMPACTED ENGINEERED FILL AS PER GEOTECHNICAL ENGINEERS RECOMMENDATION

**NOTE: CROSSINGS**  
FOR CROSSING INFO, REFER TO DRAWING No.2 CROSSING TABLE

**NOTE:**  
FOR WATERMAIN CROSSING BELOW AND ABOVE SEWERS, REFER TO CITY STD. W25 AND W25.2, RESPECTIVELY, WHERE APPLICABLE

**NOTE:**  
FOR WATERMAIN STUDS, 2.4m MIN. COVER TO BE PROVIDED

**NOTE:**  
FOR HOUSE CONNECTIONS INSTALLED UNDER DRIVEWAYS, SLEEVE SHALL BE USED

**PERMISSION REQUIRED FOR WORK ON ADJACENT LANDS**

**NOTE: ICD**  
FOR CATCHBASIN INFO AND ICD INFORMATION, REFER TO DRAWING No.2 FOR DETAIL

**NOTE:**  
FOR DEAD-END WATERMAIN LAYOUTS, REFER TO CITY STD. W37.2

**NOTE:**  
STORM CONNECTIONS TO UG STORAGE TANKS TO BE 375mm @ 0.5% UNLESS OTHERWISE NOTED

**NOTE:**  
ENTRANCES TO PRIVATE SITE PER SC7.1

**NOTE:**  
FOR FOUNDATION SERVICES, CONNECT 2500 PVC PIPE TO STORM MAIN AT OBY SLOPING AT 1.0% UNLESS OTHERWISE NOTED.

**NOTE: RE: TEST PIT / BOREHOLE EXCAVATIONS**  
ANY DISTURBED MATERIAL ENCOUNTERED BELOW THE SUBGRADE LEVEL WITHIN A BUILDING FOOTPRINT IS TO BE SUB-EVAPORATED AND BACKFILLED WITH COMPACTED ENGINEERED FILL AS PER GEOTECHNICAL ENGINEERS RECOMMENDATION

**NOTE:**  
WATER AND SANITARY SERVICES TO BE SLEEVED UNDER U/G STORAGE TANKS

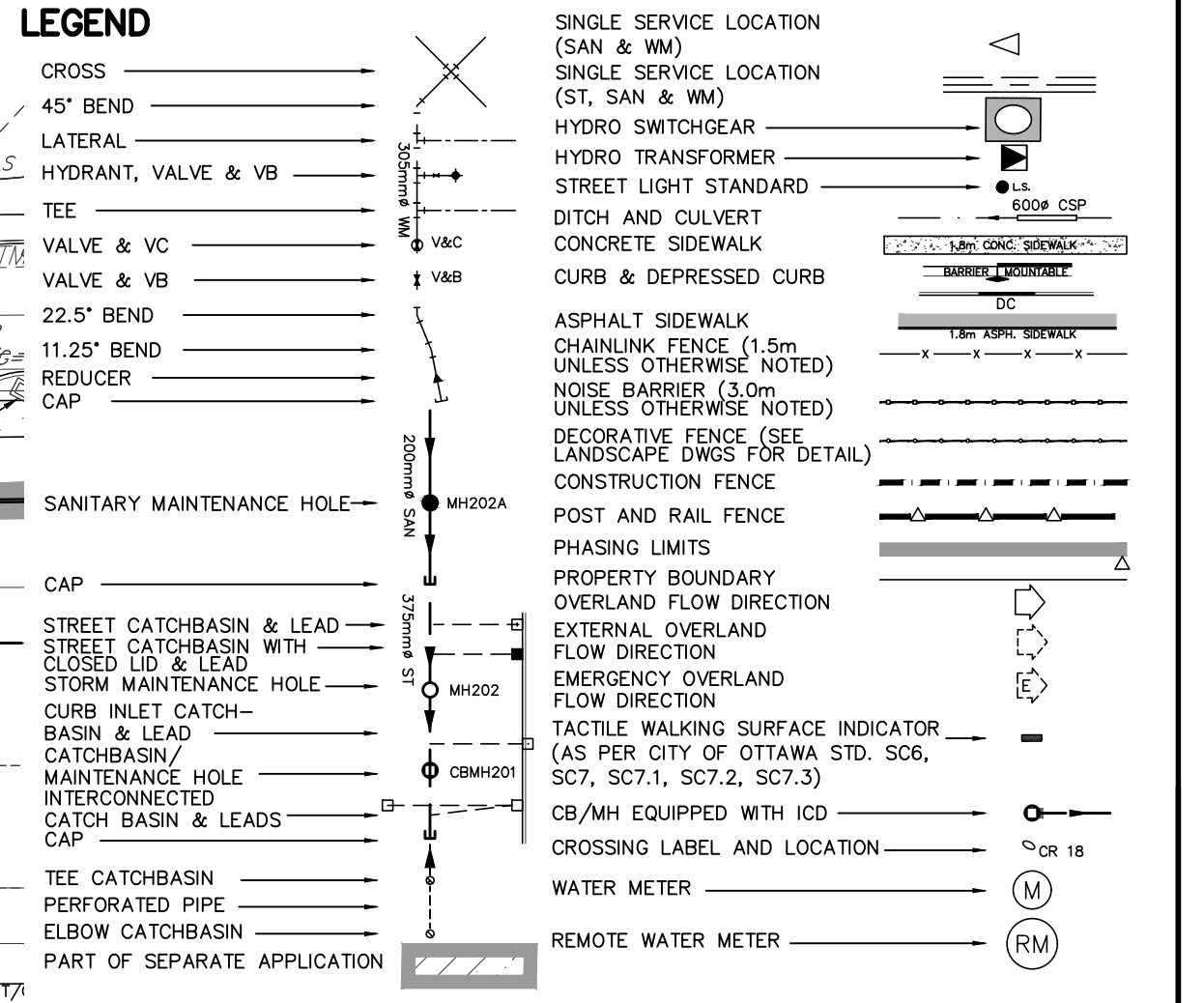
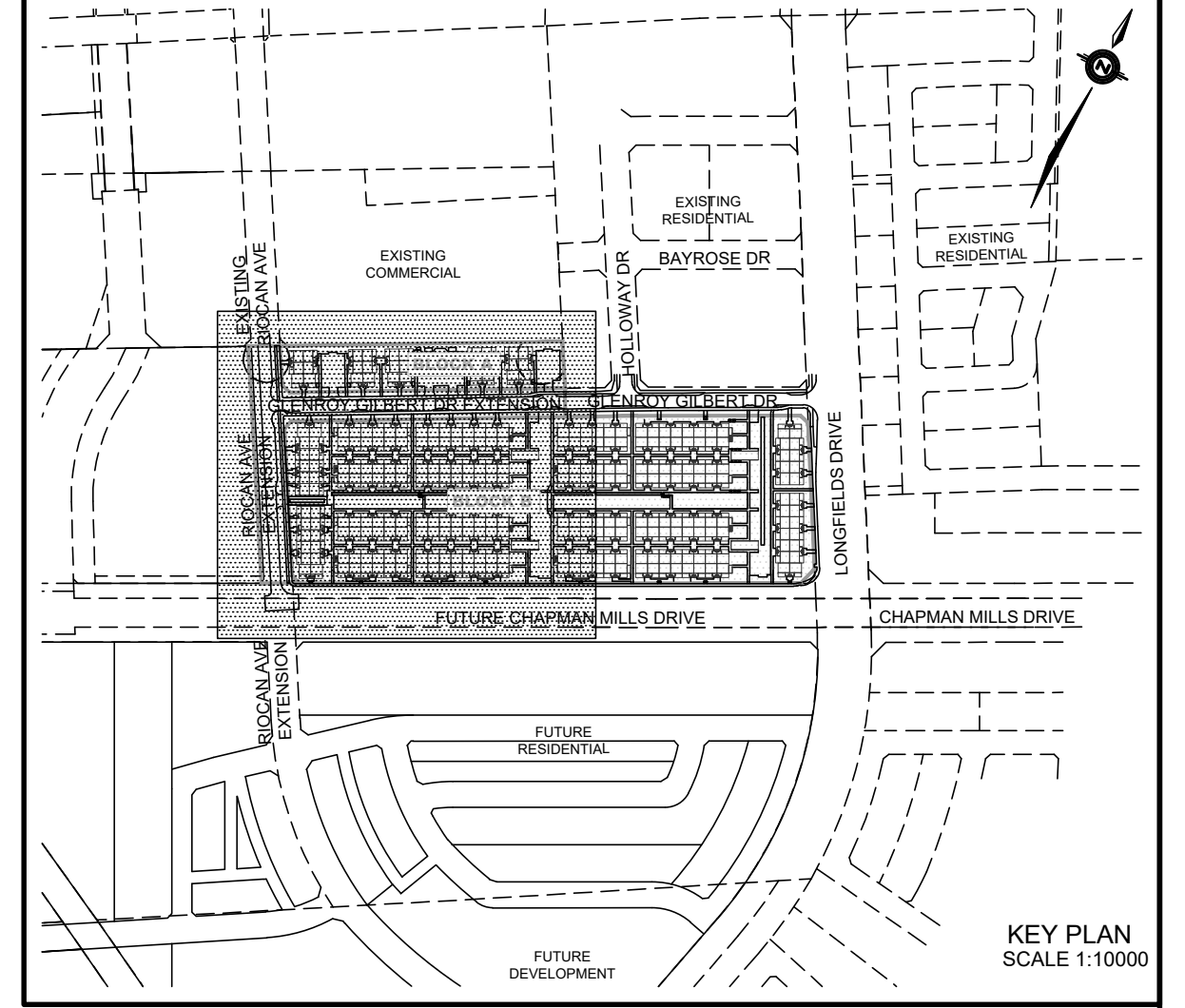
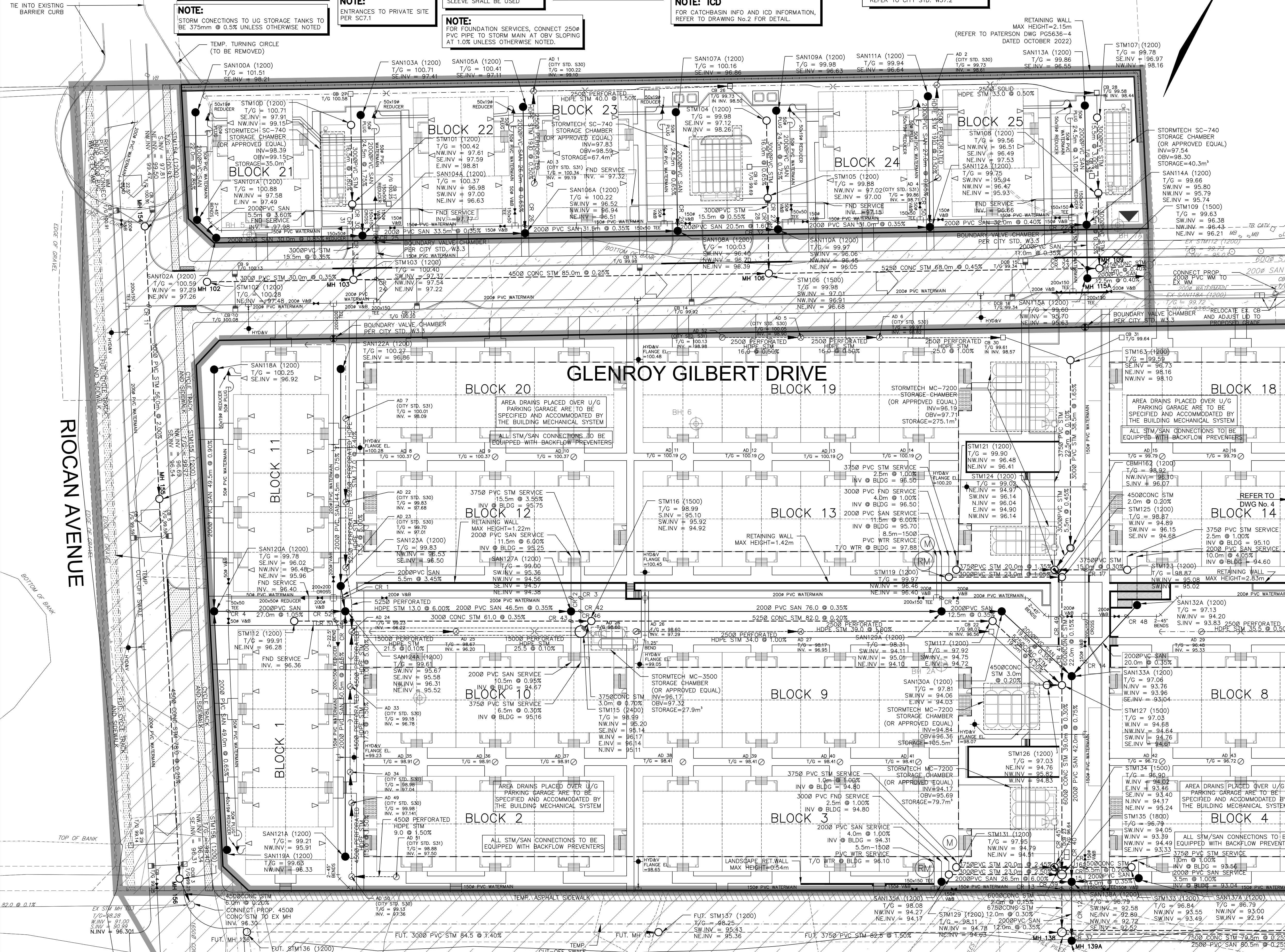

**NOT FOR CONSTRUCTION**

No.	BY	DATE	DESCRIPTION
3	S.L.M.	23-06-30	3RD SUBMISSION
2	S.L.M.	23-03-10	2ND SUBMISSION
1	S.L.M.	22-06-10	1ST SUBMISSION

**TOPOGRAPHIC INFORMATION**  
TOPOGRAPHIC INFORMATION PROVIDED BY STANTEC GEOMATICS LTD., PROJECT No. 161614291-111, DATED MARCH 1, 2022

**SITE PLAN INFORMATION**  
SITE PLAN PROVIDED BY SRN ARCHITECTS LTD., PROJECT No. S21001, DATED JUNE 27, 2023

**LEGAL INFORMATION**  
CALCULATED DRAFT PLAN PROVIDED BY STANTEC GEOMATICS LTD., PROJECT No. 161614291-111, DATED MAY 9, 2022

**BENCH MARK**  
ELEVATIONS ARE REFERRED TO THE CANADIAN GEODETIC VERTICAL DATUM (CGVD-1928:1978) AND ARE DERIVED FROM BENCHMARK MONUMENT No. 196530071, HAVING A PUBLISHED ELEVATION OF 99.742 METRES

**MINTO COMMUNITIES INC.**  
**BARRHAVEN TOWN CENTRE STAGE 1**

**DSEL**  
120 Iber Road Unit 103  
Stittsville, Ontario, K2S 1E9  
Tel. (613) 836-0856  
Fax. (613) 836-7183  
www.DSEL.ca

**S.L. MERRICK**  
LICENSED PROFESSIONAL ENGINEER  
S.L. MERRICK  
101166223  
2023-06-30  
PROVINCE OF ONTARIO

**Ottawa**  
110 Laurier Ave W  
Ottawa, Ontario, K1P 1J1  
Tel. (613) 580-2400  
www.Ottawa.ca

**GENERAL PLAN WEST**

DRAWN BY: AM	CHECKED BY: BC	PROJECT No. 15-816
DESIGNED BY: BC	CHECKED BY: SM	SHEET No. 3
SCALE: 1:400		

CITY PLAN No. 18822  
D07-12-22-0104