

NOTE: ALL WATERMAIN CONNECTIONS AND DECOMMISSIONING OF EXISTING WATERMANS TO BE COMPLETED BY CITY FORCES. TRENCH BACKFILL/REINSTATEMENT TO BE COMPLETED BY THE CONTRACTOR TO THE SATISFACTION OF THE CITY OF OTTAWA.

NOTE-RE: TEST PIT/BOREHOLE EXCAVATIONS
ANY DISTURBED MATERIAL ENCOUNTERED BELOW THE SUBGRADE LEVEL WITHIN A BUILDING FOOTPRINT TO BE SUB-EXCAVATED AND BACKFILLED WITH COMPACTED ENGINEERED FILL AS PER GEOTECHNICAL ENGINEERS RECOMMENDATION.

CONTRACTOR TO VERIFY THE PRECISE LOCATIONS AND INVERT ELEVATIONS OF EX. UNDERGROUND SERVICES AND EX UTILITIES PRIOR TO STARTING CONSTRUCTION

ANY DISTURBED AREA DURING CONSTRUCTION TO BE RESTORED TO THE ORIGINAL CONDITION OR BETTER TO THE SATISFACTION OF THE AUTHORITIES HAVING JURISDICTION

NOTE: FOR WATERMAIN CROSSING BELOW AND ABOVE SEWERS, REFER TO CITY STD. W25 AND W25.2, RESPECTIVELY, WHERE APPLICABLE

NOTE: ENTRANCES TO PRIVATE SITE PER SC7.1

NOTE: FOR WATERMAIN STUDS, 2.4m MIN. COVER TO BE PROVIDED

NOTE: WATER AND SANITARY SERVICES TO BE SLEEVED UNDER U/G STORAGE TANKS

NOTE: FOR FOUNDATION SERVICES, CONNECT 250P PVC PIPE TO STORM MAIN AT OVB SLOPING AT 1.0% UNLESS OTHERWISE NOTED.

NOTE: ALL EXISTING TREES, SHRUBS ETC. WITHIN LOTS, BLOCKS AND ROADS TO BE REMOVED, UNLESS OTHERWISE NOTED

NOTE: THE COVER OF EX. MH, CB, CHAMBER AND OTHER ABOVEGROUND FEATURES TO BE ADJUSTED TO SUIT THE NEW FINISHED GRADE, WHERE APPLICABLE

NOTE: INSULATION REQUIRED FOR WATERMAIN / WATER SERVICE WHERE THE SEPARATION BETWEEN WATERMAIN / WATER SERVICE AND OTHER SERVICES AND STRUCTURES IS LESS THAN 1.2m AND THE COVER IS LESS THAN 2.4m. REFER TO CITY STD. W23 FOR DETAIL.

NOTE: FOR SERVICE INSTALLATION AT SEWER CROSSING, REFER TO CITY STD. W38 FOR DETAIL.

NOTE: ICD FOR CATCHBASIN INFO AND ICD INFORMATION, REFER TO DRAWING No. 3 FOR DETAIL.

PERMISSION REQUIRED FOR WORK ON ADJACENT LANDS

NOTE: FOR DEAD-END WATERMAIN LAYOUTS REFER TO CITY STD. W37.2

NOTE: STORM CONNECTIONS TO U/G STORAGE TANKS TO BE 375mm @ 0.5% UNLESS OTHERWISE NOTED

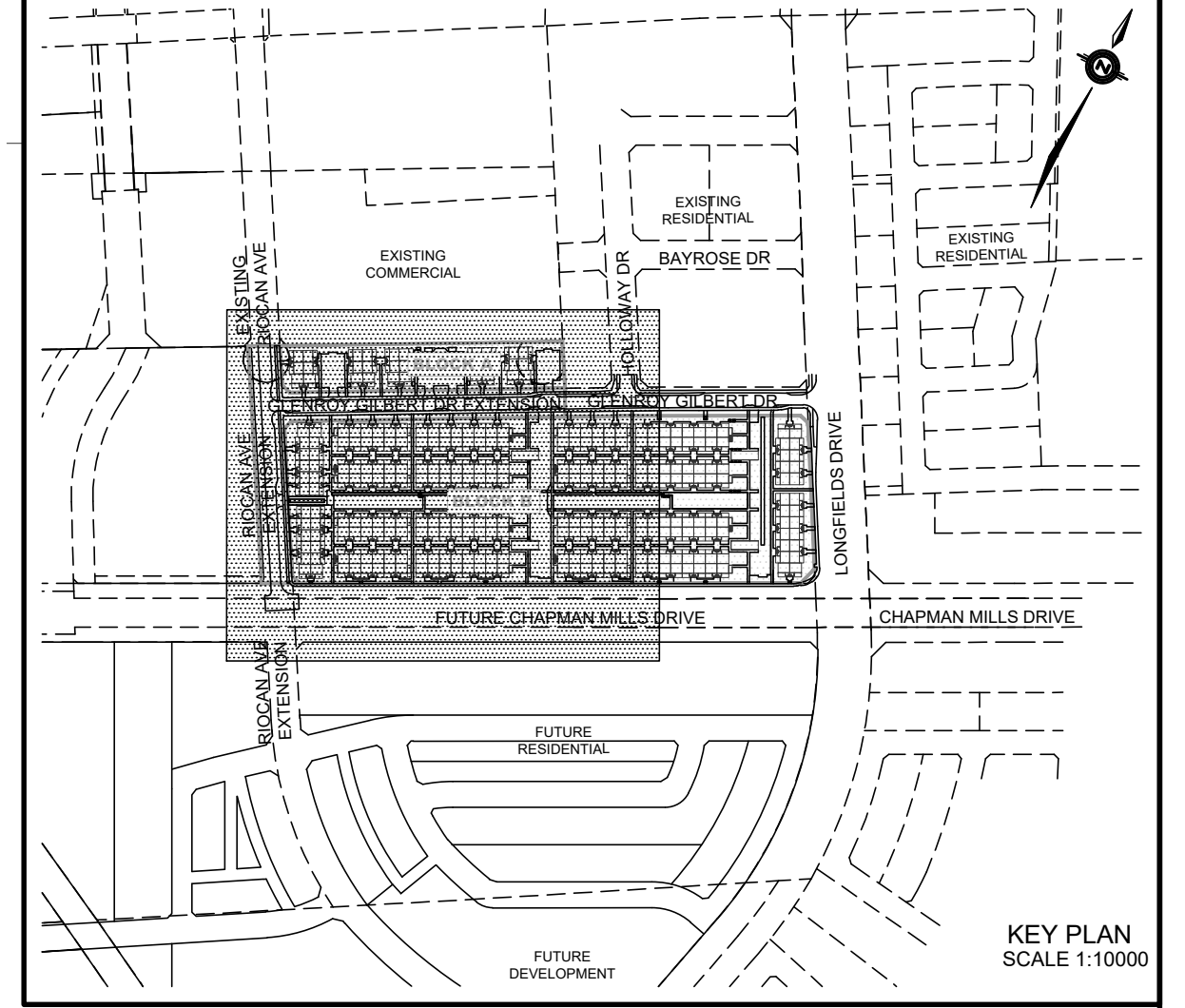

LEGEND

CROSS	SINGLE SERVICE LOCATION (SAN & WM)
45° BEND	SINGLE SERVICE LOCATION (ST, SAN & WM)
LATERAL	HYDRO SWITCHGEAR
HYDRANT, VALVE & VB	HYDRO TRANSFORMER
TEE	STREET LIGHT STANDARD
VALVE & VC	DITCH AND CULVERT
VALVE & VB	CONCRETE SIDEWALK
22.5° BEND	CURB & DEPRESSION CURB
11.25° BEND	ASPHALT SIDEWALK
REDUCER	CHAINLINK FENCE (1.5m UNLESS OTHERWISE NOTED)
CAP	NOISE BARRIER (3.0m UNLESS OTHERWISE NOTED)
	DECORATIVE FENCE (SEE LANDSCAPE DWGS FOR DETAIL)
	CONSTRUCTION FENCE
	POST AND RAIL FENCE
	PHASING LIMITS
	PROPERTY BOUNDARY
	OVERLAND FLOW DIRECTION
	EXTERNAL OVERLAND FLOW DIRECTION
	STREET CATCHBASIN WITH STREET CATCHBASIN & LEAD
	STREET CATCHBASIN WITH CLOSED LID & LEAD
	STORM MAINTENANCE HOLE
	CURB INLET CATCH-BASIN & LEAD
	MAINTENANCE HOLE INTERCONNECTED CATCH BASIN & LEADS
	TEE CATCHBASIN
	PERFORATED PIPE ELBOW CATCHBASIN PART OF SEPARATE APPLICATION
	WATER METER
	REMOTE WATER METER

NOT FOR CONSTRUCTION

No.	BY	DATE	DESCRIPTION
3	S.L.M.	23-06-30	3RD SUBMISSION
2	S.L.M.	23-03-10	2ND SUBMISSION
1	S.L.M.	22-06-10	1ST SUBMISSION

TOPOGRAPHIC INFORMATION
TOPOGRAPHIC INFORMATION PROVIDED BY STANTEC GEOMATICS LTD., PROJECT No. 161614291-111, DATED MARCH 1, 2022

SITE PLAN INFORMATION
SITE PLAN PROVIDED BY SRN ARCHITECTS LTD., PROJECT No. S21001, DATED JUNE 27, 2023

LEGAL INFORMATION
CALCULATED DRAFT PLAN PROVIDED BY STANTEC GEOMATICS LTD., PROJECT No. 161614291-111, DATED MAY 9, 2022

BENCH MARK
ELEVATIONS ARE REFERRED TO THE CANADIAN GEODETIC VERTICAL DATUM (CGVD-1928:1978) AND ARE DERIVED FROM BENCHMARK MONUMENT No. 196530071*, HAVING A PUBLISHED ELEVATION OF 99.742 METRES

MINTO COMMUNITIES INC.
BARRHAVEN TOWN CENTRE
GLENROY GILBERT DRIVE RIOCAN AVENUE & CHAPMAN MILLS DRIVE EXTENSION

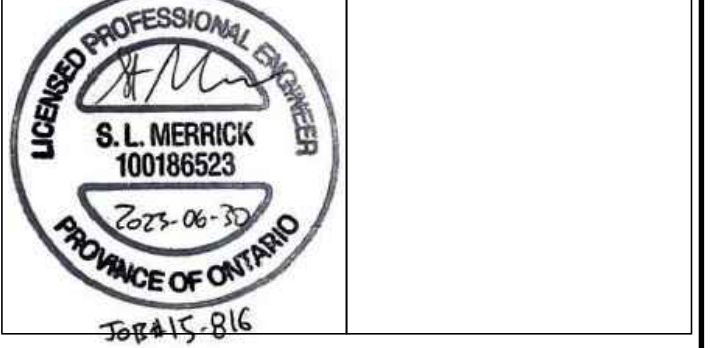

CITY ROW GENERAL PLAN WEST

DRAWN BY: AM	CHECKED BY: BC	PROJECT No. 15-816
DESIGNED BY: BC	CHECKED BY: SM	SHEET No. 4
SCALE: 1:500		

CITY PLAN No. 18822
CITY FILE No. D07-12-22-0104