

**CONCRETE - FINISH LIGHT BROOM, WOOD FLOAT MAGNESIUM FLOAT.**  
ALL CONCRETE FINISHES TO BE APPROVED BY GJA LANDSCAPE ARCHITECT.  
SAWCUT LAYOUT FOR ALL AREAS TO BE MARKED ON SITE IN RED CHALK, REVIEWED, ADJUSTED AND APPROVED BY GJA LANDSCAPE ARCHITECT PRIOR TO ANY CUTTING.  
EXPANSION JOINT LAYOUT FOR ALL AREAS TO BE LAID OUT ON SITE - REVIEWED, ADJUSTED AND APPROVED BY GJA LANDSCAPE ARCHITECT PRIOR TO ANY CONCRETE POURING.  
PROVIDE COLD JOINT DETAIL at End of Previous Pour/Beginning of New Pour, C/W REBAR DOWELS 500mm O.C.  
FINISH: TOOL EDGE FIRST, THEN WIPE OFF TOOL MARKS WHILE APPLYING FINISH.

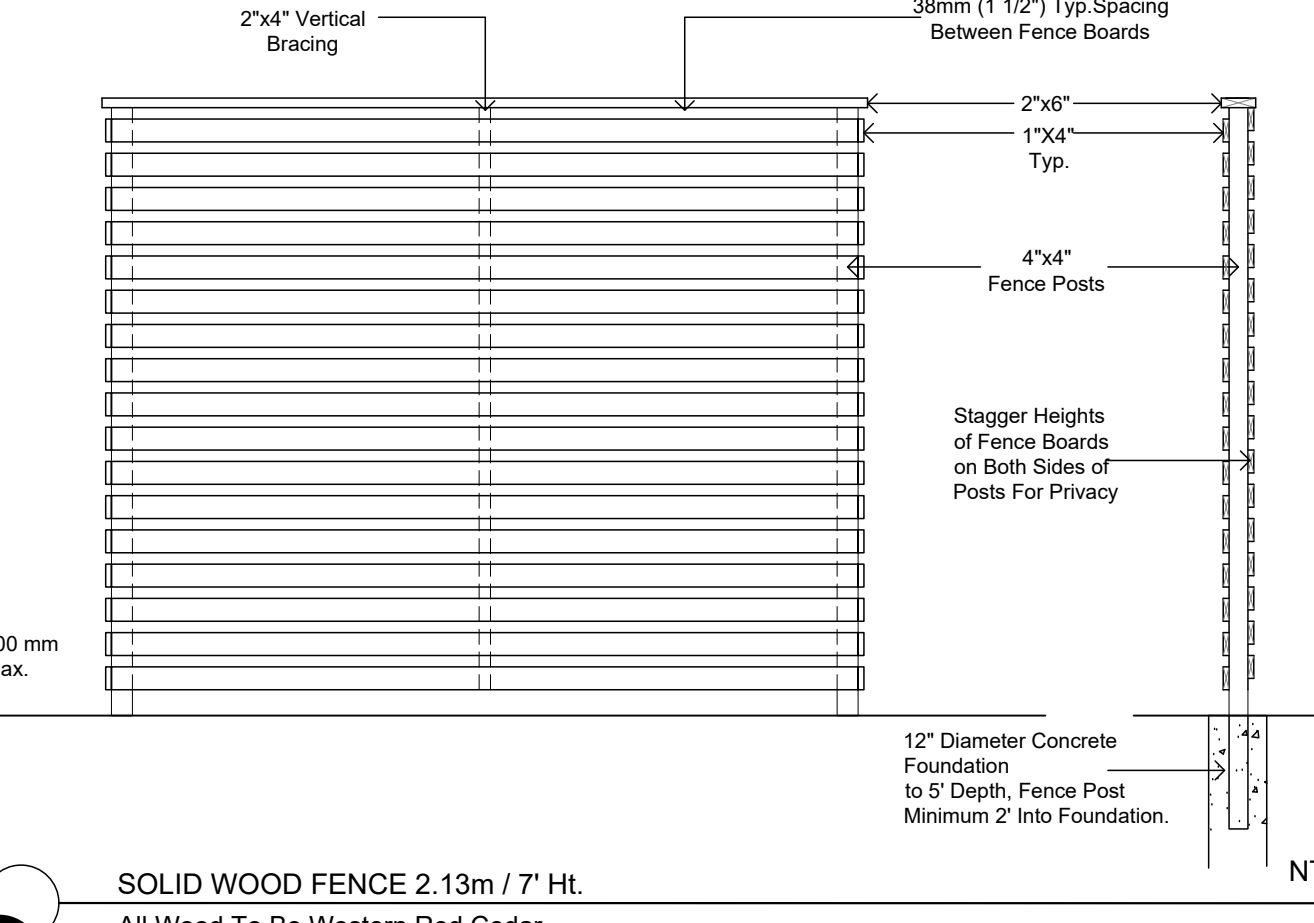

TURF AREAS TO BE SOD C/W 150MM DEPTH TOPSOIL ON APPROVED SUBGRADE | SOD TO BE #1 GRADE TURFGRASS NURSERY SOD per NSGA - Fine Fescue/Kentucky Bluegrass Sod | PLANTING MIX TO BE APPROVED BY LANDSCAPE ARCHITECT | PLANT MATERIAL TO MEET CNLA STANDARDS/BE APPROVED BY LANDSCAPE ARCHITECT PRIOR TO PLANTING | ALL MATERIALS & WORK TO BE MAINTAINED UNTIL FINAL ACCEPTANCE. (MOWING TURF, WEEDING BEDS, WATERING TURF & PLANTS) & INCLUDE 1 YEAR WARRANTY FROM DATE OF FINAL ACCEPTANCE | PROVIDE WATERING OF ALL PLANT MATERIAL AS REQUIRED FOR PROPER ESTABLISHMENT UNTIL END OF WARRANTY PERIOD | REFER TO CIVIL ENGINEER'S DRAWING FOR ELEVATIONS / GRADING | The Landscape Plan is to be read in conjunction with the grading, servicing, site and survey plan | Bare root material to be planted in season only | All plant material locations to be staked on site by the landscape contractor and checked by the landscape architect prior to planting | All trees to be preserved on or directly adjacent to the site will be protected | Plant material are to be installed a minimum of; 3.0m away from any part of any hydro transformer, 3.0m corridor between a fire hydrant and the curb, a 2.5m radius beside or behind a fire hydrant, 2.0m from any servicing/utility line or structure |

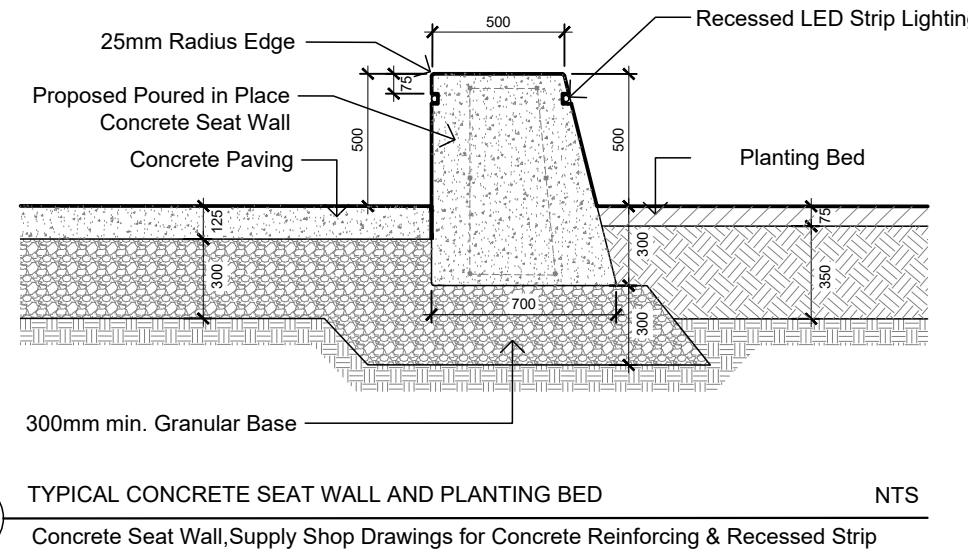
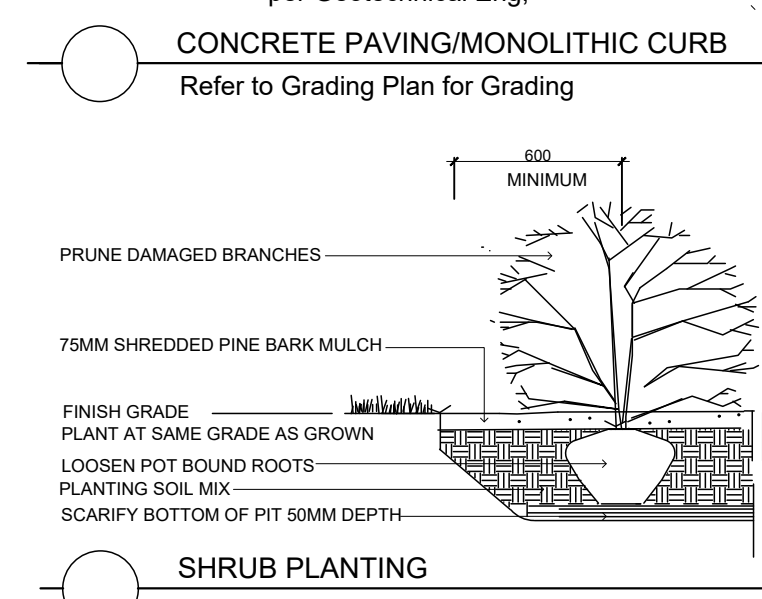

Code	Qty.	Botanical Name	Common Name	Size	Condition
AC	5	Ametanchler canadensis	Serviceberry	1.5m Ht.	B + B specimen
AR	1	Acer rubrum	Red Maple	70mm cal	B + B specimen
AS	1	Acer saccharum	Sugar Maple	70mm cal	B + B specimen
CA	5	Cornus alternifolia	Pagoda Dogwood	1.5m Ht.	B + B specimen
CO	1	Celtis occidentalis	Common Hackberry	70mm cal	B + B specimen
GB	3	Ginkgo biloba	Maidenhair Tree	70mm cal	B + B specimen
GD	1	Gymnocladus dioica	Kentucky Coffee Tree	70mm cal	B + B specimen
QM	1	Quercus macrocarpa	Bur Oak	70mm cal	B + B specimen
QR	1	Quercus rubra	Red Oak	70mm cal	B + B specimen
VL	5	Viburnum lentago	Nannyberry	1.5m Ht.	B + B specimen

Code	Qty.	Botanical Name	Common Name	Size	Condition
HK	200	Hypericum kalmianum	St. John's Wort	30cm Ht.	Pot
SA	50	Symphoricarpos albus	Snowberry	60cm Ht.	Pot
SA	50	Spiraea alba	Meadowsweet	50cm Ht.	Pot
AU	75	Arctostaphylos uva ursi	Bearberry	10cm Pot	
PM	50	Pinus mugo var. parvifolia	Dwarf Mugo Pine	30cm spr Pot	
JV	25	Juniperus virginiana	Eastern Red Cedar	1.25m Ht. Pot	
GM	75	Geranium macrorrhizum	Bigroot Geranium	9cm Pot	
GP	75	Geranium psilostemon 'Gerwat'	Rozanne Geranium	9cm Pot	
PCJ	15	Parthenocissus quinquefolia	Virginia Creeper	15cm Pot	
PV	35	Panicum virgatum	Switch Grass	15cm Pot	

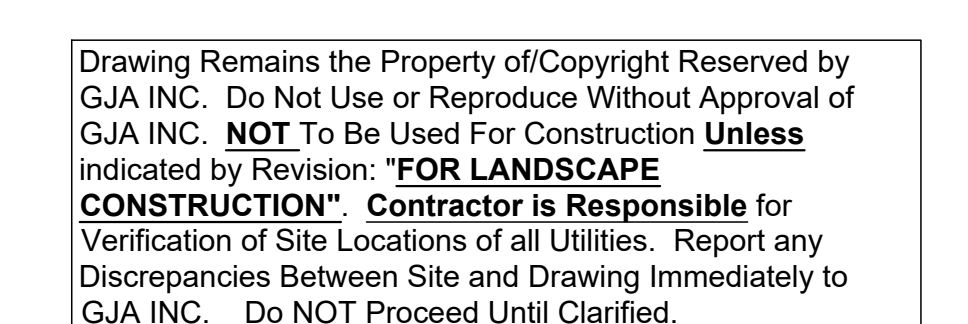
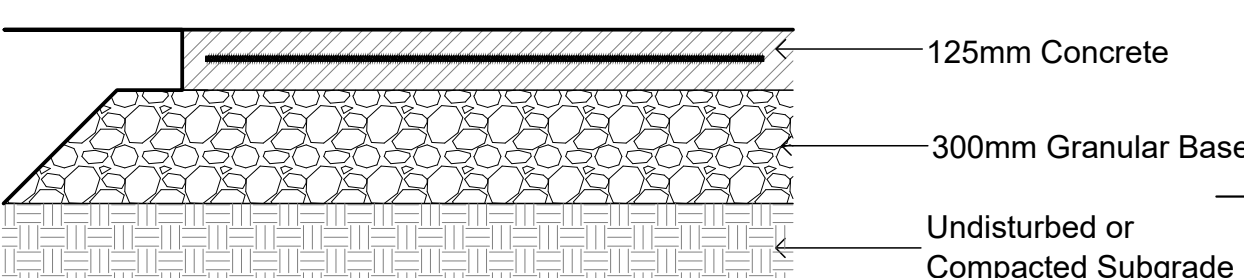

Proposed on Adjacent Residential Property  
Additional Material Not Located on Plan - Distribution on Site at Discretion of GJA Inc.

Code	Qty.	Botanical Name	Common Name	Size	Condition
HK	200	Hypericum kalmianum	St. John's Wort	30cm Ht.	Pot
SA	50	Symphoricarpos albus	Snowberry	60cm Ht.	Pot
SA	50	Spiraea alba	Meadowsweet	50cm Ht.	Pot
AU	75	Arctostaphylos uva ursi	Bearberry	10cm Pot	
PM	50	Pinus mugo var. parvifolia	Dwarf Mugo Pine	30cm spr Pot	
JV	25	Juniperus virginiana	Eastern Red Cedar	1.25m Ht. Pot	
GM	75	Geranium macrorrhizum	Bigroot Geranium	9cm Pot	
GP	75	Geranium psilostemon 'Gerwat'	Rozanne Geranium	9cm Pot	
PCJ	15	Parthenocissus quinquefolia	Virginia Creeper	15cm Pot	
PV	35	Panicum virgatum	Switch Grass	15cm Pot	

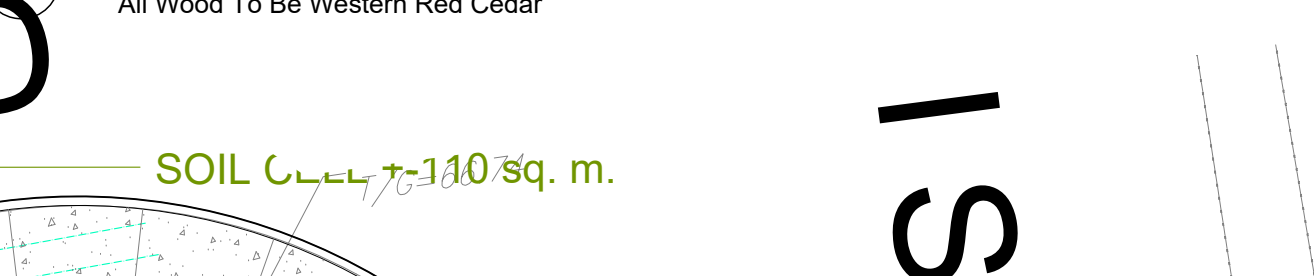
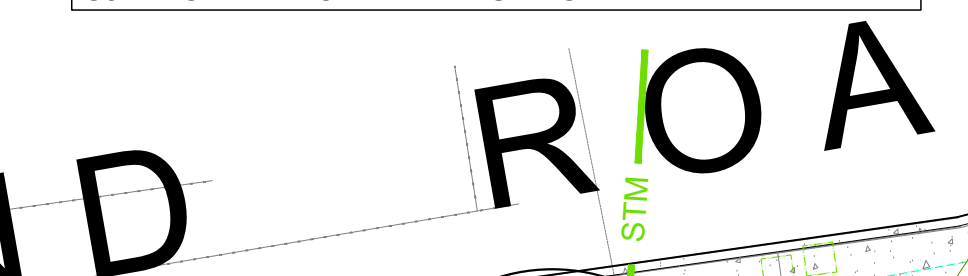
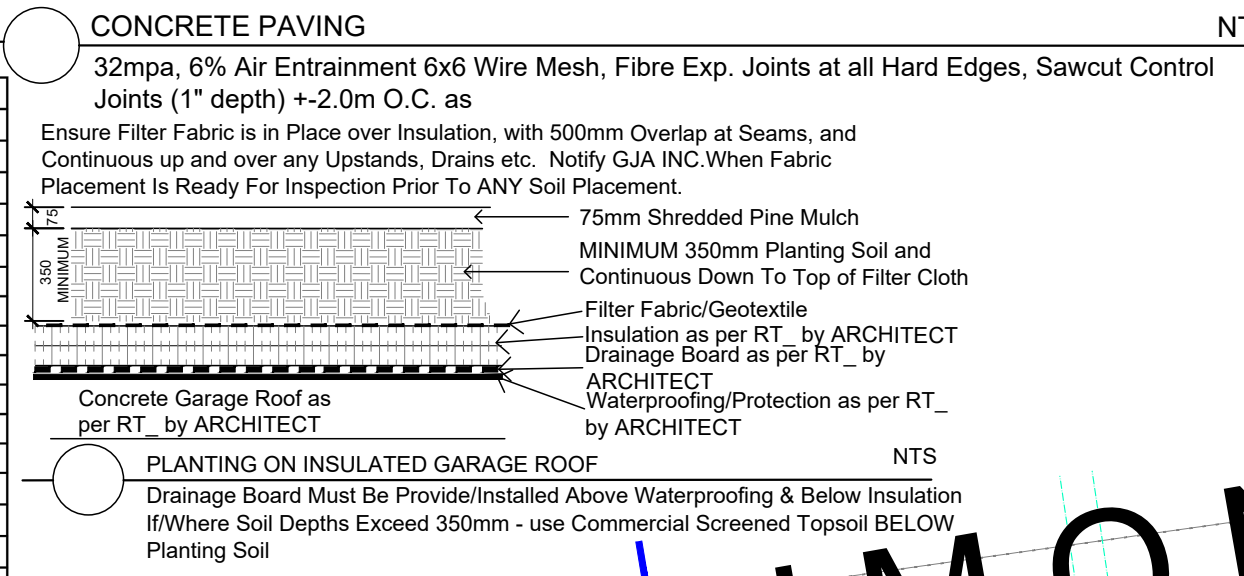
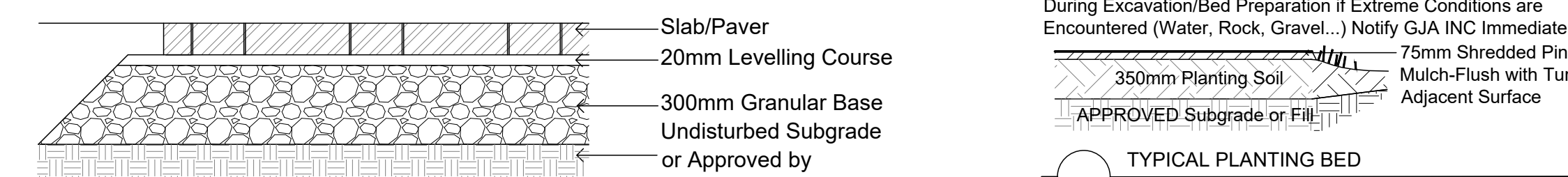

- REFER TO TCR
- Existing Tree To Remain
  - Protection for Existing Trees per City/NCC
  - Existing Tree To Be Removed
  - PROPOSED LANDSCAPE
  - Deciduous Tree
  - Shrub Planting Bed
  - Fence
  - New Turf
  - Soil Cell
  - Pedestrian Paving
  - Concrete
  - Stone/Concrete Seat Wall
- BELOW GRADE SERVICES REFER TO CIVIL /CUP
- WTR U/G Water Service
  - STM U/G Storm Service
  - SAN U/G Sanitary Service
  - U/G Gas Service
  - U/G TelCo Service
  - U/G Hydro Service
  - O/H Hydro Service
  - Fire Hydrant

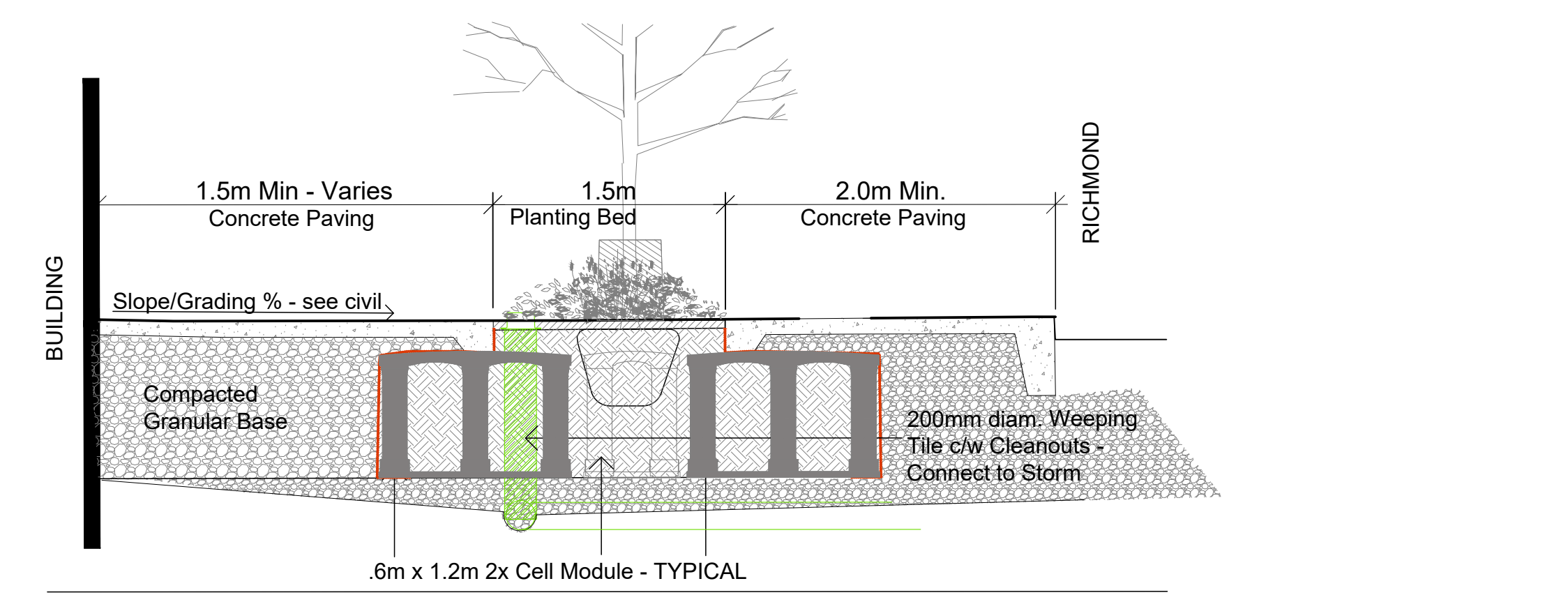
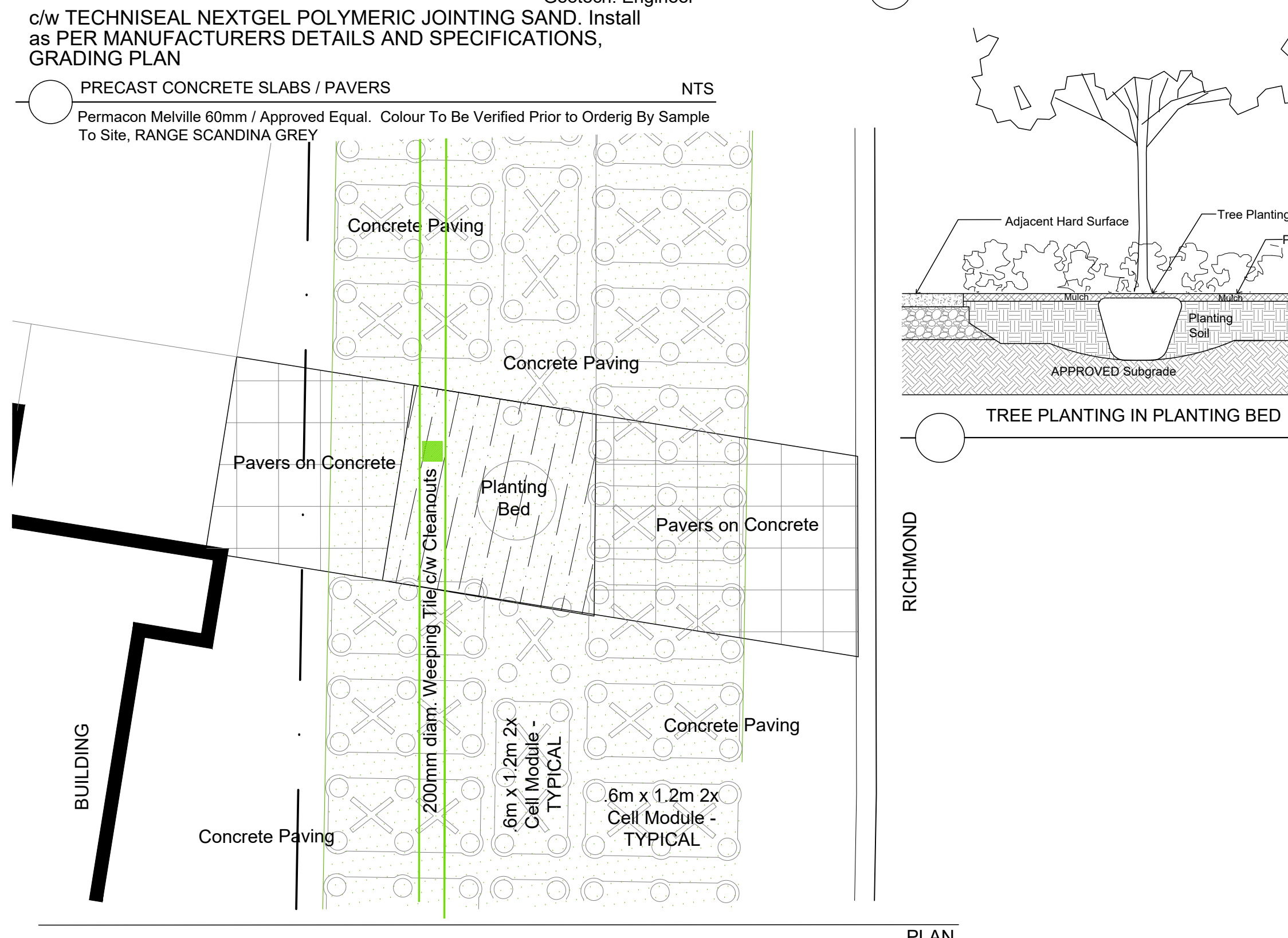
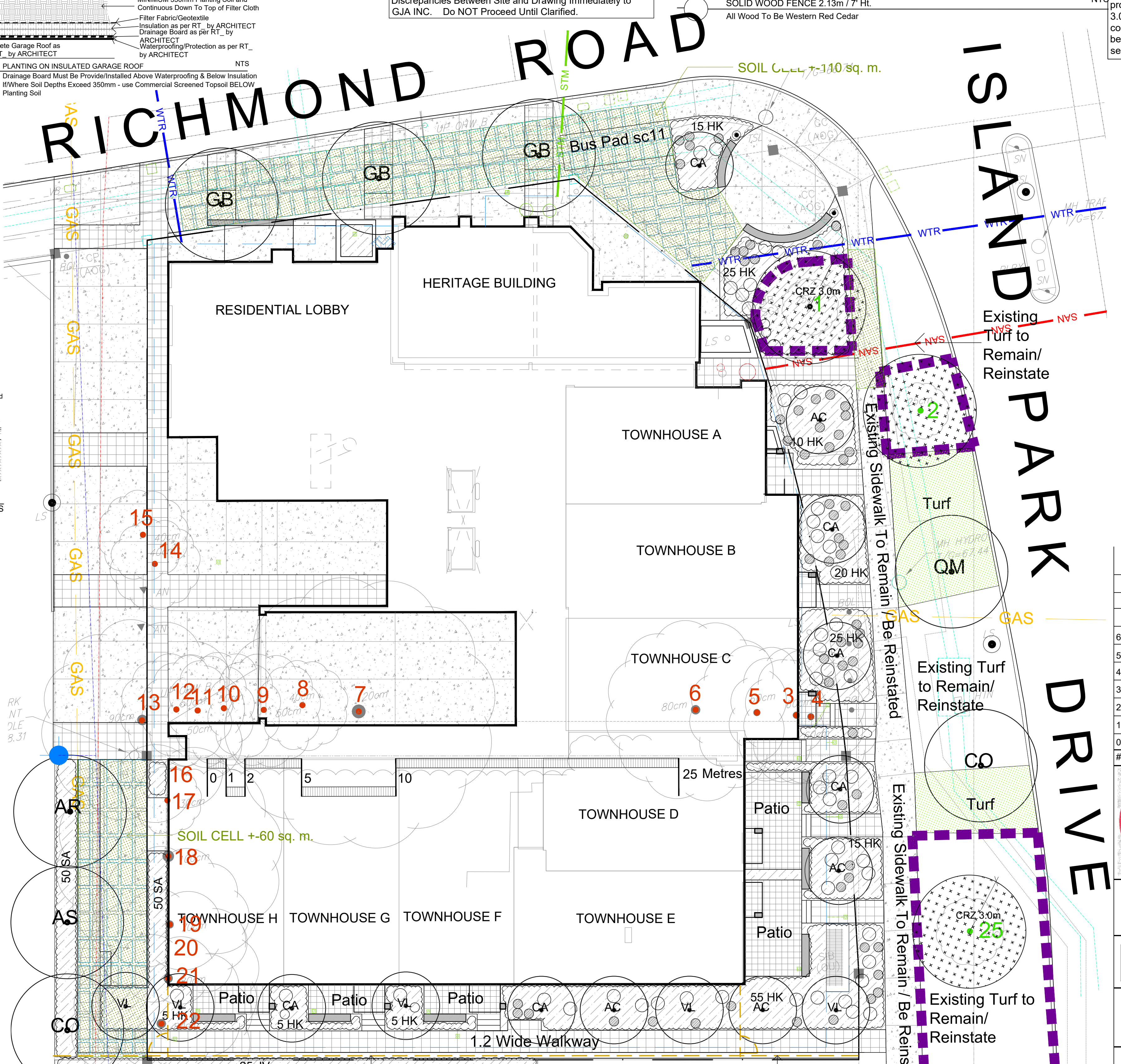

TYPICAL RICHMOND STREETSCAPE PLANTING CROSS SECTION with PLAN ABOVE  
CONTRACTOR TO PROVIDE SHOP DRAWING (BY DEEPROOT) FOR SILVA CELL PLANTING AREAS - FOR REVIEW / COMMENT / APPROVAL BY GJA INC. and CITY OF OTTAWA.

#	Revision	COORDINATION	Date
6	SITE PLAN CONTROL SUBMISSION 4	JUNE 15 2023	
5	SITE PLAN CONTROL SUBMISSION 3	APRIL 15 2023	
4	50% DD	APRIL 05 2023	
3	SITE PLAN CONTROL SUBMISSION 3	DRAFT	
2	SITE PLAN CONTROL SUBMISSION 2	NOVEMBER 18 2022	
1	SITE PLAN CONTROL SUBMISSION 1	MAY 13 2022	
0	REVIEW/COORDINATION	APRIL 2022	

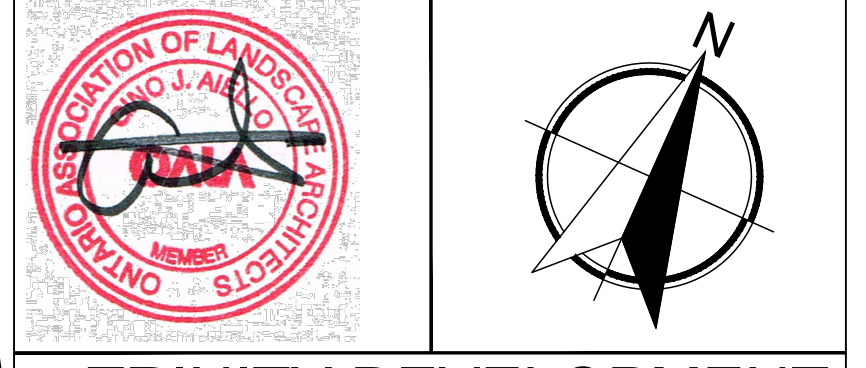

**TRINITY DEVELOPMENT GROUP**  
77 Bloor Street West 1601 Toronto M5S 1M2

**GJA** GJA INC.  
GINO J. AIELLO | LANDSCAPE ARCHITECT  
GJA.L.A.COM | (613) 286-5130 | GINO@GJA.L.A.COM  
110 DUNDAS ROAD UNIT #9 | OTTAWA ONTARIO | K2T 6Z2

**MIXED USE DEVELOPMENT**  
70 RICHMOND ROAD @ ISLAND PARK DRIVE

**Landscape Plan**  
Scale: 1:125  
City of Ottawa  
Dwg - 18851

Sheet Number  
**L1**

D07-12-22-0082