

HUNTMAR DRIVE

THIS PLAN IS TO BE READ IN CONJUNCTION WITH CIVIL PLANS 122151-NLD1&2, 122151-GP1&2 AND 122151-GR1&GR2

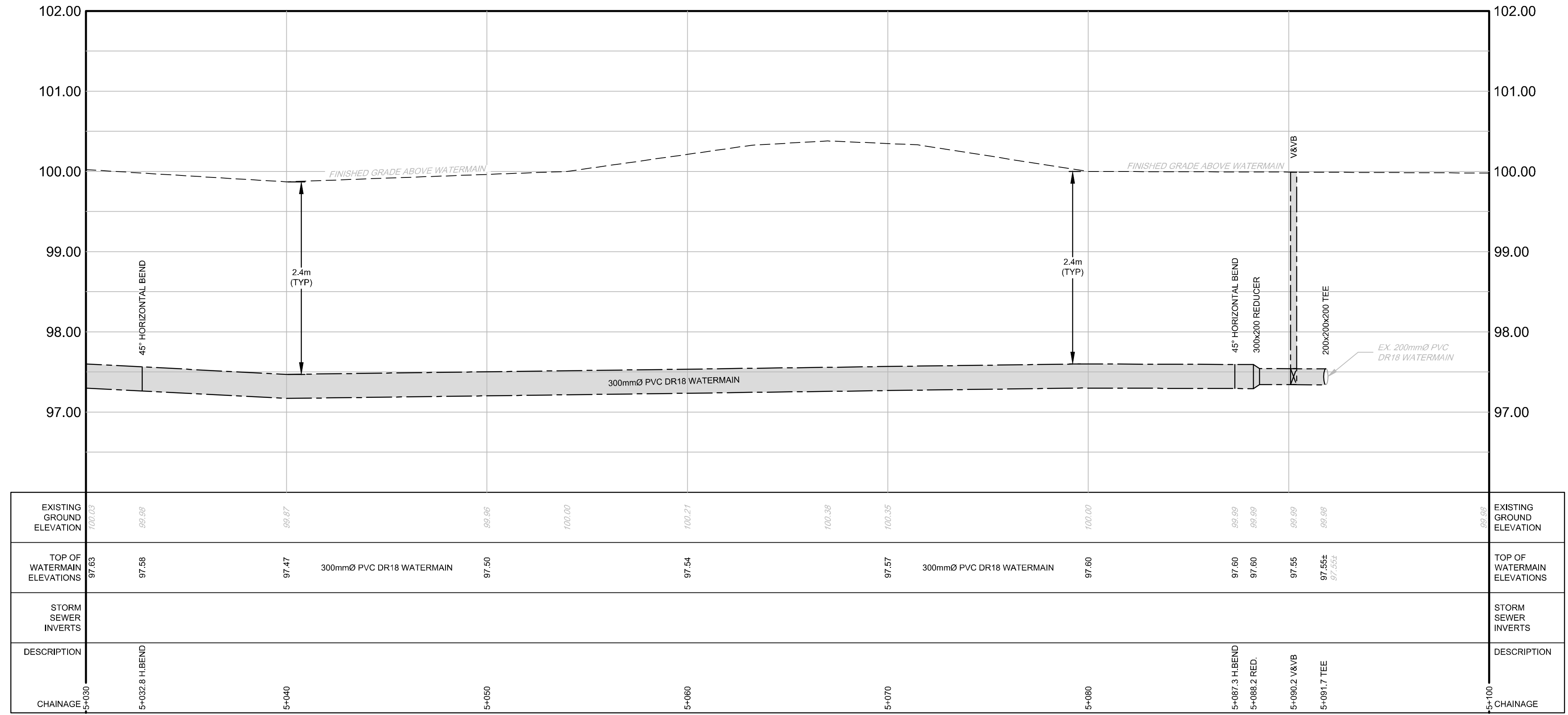
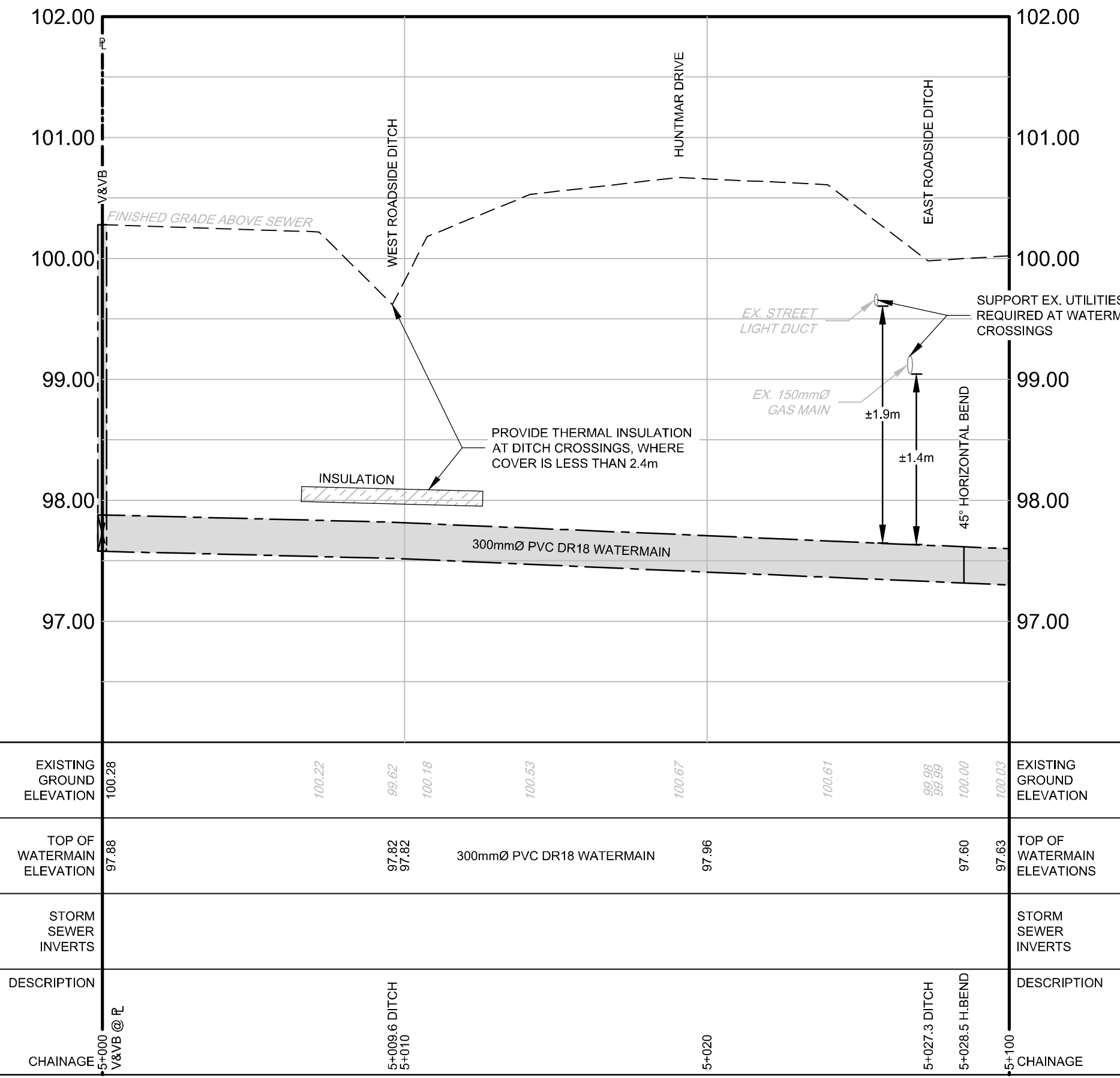

NOTE:
THE POSITION OF ALL POLE LINES, CONDUITS, WATERMANS, SEWERS AND OTHER UNDERGROUND AND OVERGROUND UTILITIES AND STRUCTURES IS NOT NECESSARILY SHOWN ON THE CONTRACT DRAWINGS, AND WHERE SHOWN, THE ACCURACY OF THE POSITION OF SUCH UTILITIES AND STRUCTURES IS NOT GUARANTEED. BEFORE STARTING WORK, DETERMINE THE EXACT LOCATION OF ALL SUCH UTILITIES AND STRUCTURES AND ASSUME ALL LIABILITY FOR DAMAGE TO THEM.

No.	REVISION	DATE	BY
3	REVISED PER CITY COMMENTS	MAY 31/23	DDB
2	REVISED PER CITY COMMENTS	MAR 30/23	DDB
1	ISSUED FOR CITY OF OTTAWA REVIEW	DEC 16/22	DDB

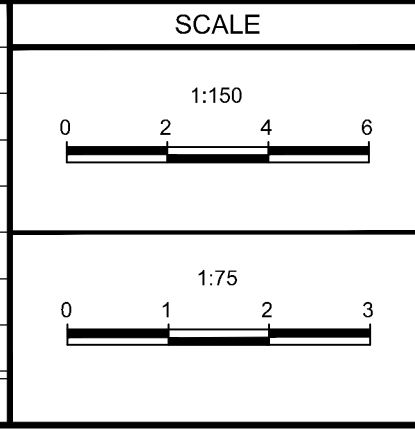

DESIGN	SM / BM / DDB
CHECKED	DDB
DRAWN	SM
CHECKED	BM / DDB
APPROVED	DDB

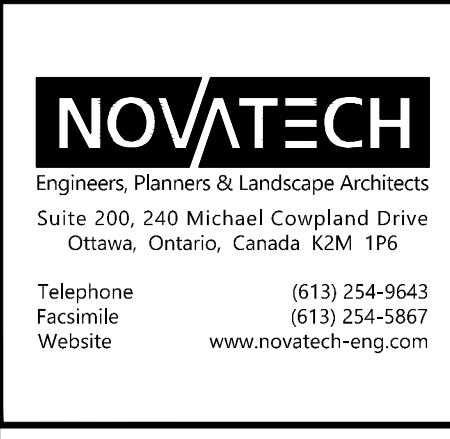

NOVATECH
Engineers, Planners & Landscape Architects
Suite 200, 240 Michael Cowpland Drive
Ottawa, Ontario, Canada K2M 1P6
Telephone: (613) 254-9643
Facsimile: (613) 254-5867
Website: www.novatech-eng.com

LOCATION
CITY OF OTTAWA
405 HUNTMAR DRIVE - WAREHOUSE DEVELOPMENT

DRAWING NAME
PLAN and PROFILE
OFF-SITE WATERMAIN EXTENSION
STATION 5+000 to 5+100

PROJECT NO.
122151

REV
REV #3

DRAWING NO.
122151-PR1