

**P1 LEVEL**  
 GFA = 18,837 ft<sup>2</sup>  
 32 PARKING SPACES

**BICYCLE PROVISIONS**  
 31 HUNG BIKE STALLS  
 45 BIKE/STORAGE LOCKERS  
 (16 ALONG AISLE + 29 IN STORAGE ROOM)  
 =  
 76 TOTAL BIKE STALLS IN P1

1 PARKING LEVEL 1  
 A2.00 1:150

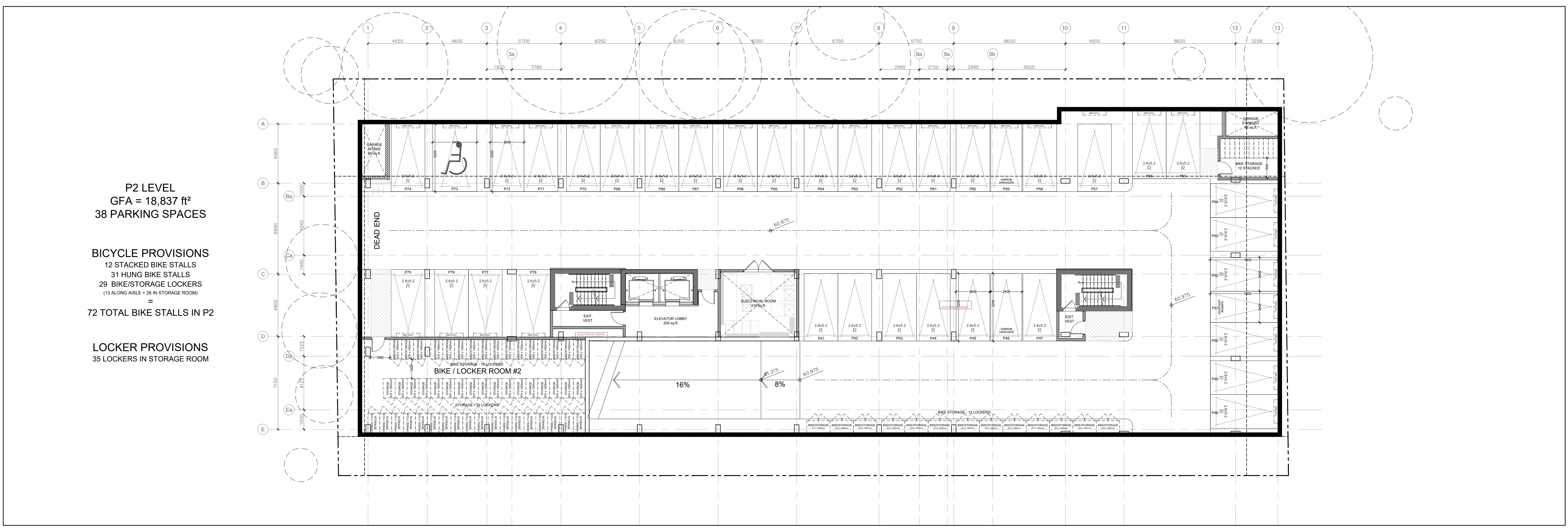

**P2 LEVEL**  
 GFA = 18,837 ft<sup>2</sup>  
 38 PARKING SPACES

**BICYCLE PROVISIONS**  
 12 STACKED BIKE STALLS  
 31 HUNG BIKE STALLS  
 29 BIKE/STORAGE LOCKERS  
 (13 ALONG AISLE + 26 IN STORAGE ROOM)  
 =  
 72 TOTAL BIKE STALLS IN P2

**LOCKER PROVISIONS**  
 35 LOCKERS IN STORAGE ROOM

2 PARKING LEVEL 2  
 A2.00 1:150

**PROJECT TEAM**

**ARCHITECT**  
 HOBIN ARCHITECTURE  
 Barry Hobin  
 bhobin@hobinarc.com

David Anderson  
 danderson@hobinarc.com  
 613.238.7200 x122

**OWNERSHIP**  
 SCARABELLI REALTIES

**PLANNING**  
 FOTENN  
 Timothy Beed  
 beed@fotenn.com

**CIVIL**  
 IBI  
 Terry Brule  
 tbrule@IBIGroup.com

**MECHANICAL & ELECTRICAL**  
 Smith & Andersen  
 Elaine Guenette  
 elaine.guenette@smithandandersen.com

Andre Drouin  
 andre.drouin@smithandandersen.com

**LANDSCAPE ARCHITECT**  
 Lashley+Associates  
 David Lashley  
 dlashley@lashleyla.com

**TRANSPORTATION**  
 CGH  
 Andrew Harfe  
 andrew.harfe@cghtransportation.com

**ENVIRONMENTAL**  
 PATERSONS  
 Scott Dennis  
 SDennis@pateronsgroup.ca

no.	date	revision
1	230505	ISSUED FOR SPC

It is the responsibility of the appropriate contractor to check and verify all dimensions on site and report all errors and/or omissions to the architect.

All contractors must comply with all pertinent codes and by-laws.

Do not scale drawings.

This drawing may not be used for construction until signed.

Copyright reserved.

**Hobin Architecture Incorporated**  
 63 Pamela Street  
 Ottawa, Ontario  
 Canada K1S3K7

T: 613-238-7200  
 F: 613-235-2005  
 E: mail@hobinarc.com  
 hobinarc.com



**HOBIN**  
 ARCHITECTURE

**PROJECT/LOCATION:**  
 30-48 CHAMBERLAIN AVE.

**DRAWING TITLE:**  
 PARKING PLANS

**DRAWN BY:** DA **DATE:** 2023-05-05 **SCALE:** 1:150

**PROJECT:** 1928 **DRAWING NO.:** A2-00

**REVISION NO.:**

