

THIS PLAN IS TO BE READ IN CONJUNCTION WITH CIVIL PLANS 122151-NLD1&2, 122151-GR1&2 AND 122151-PR1

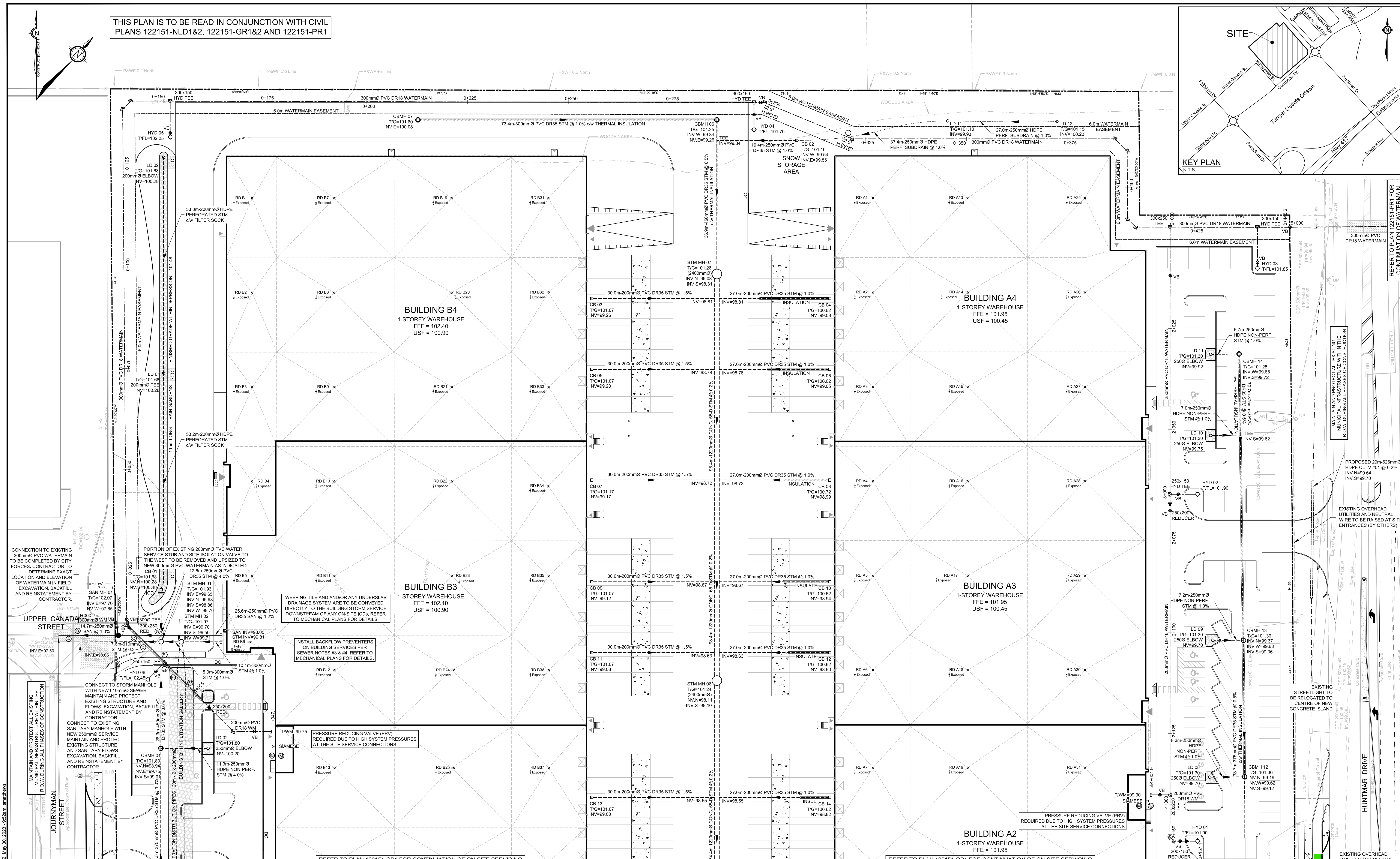
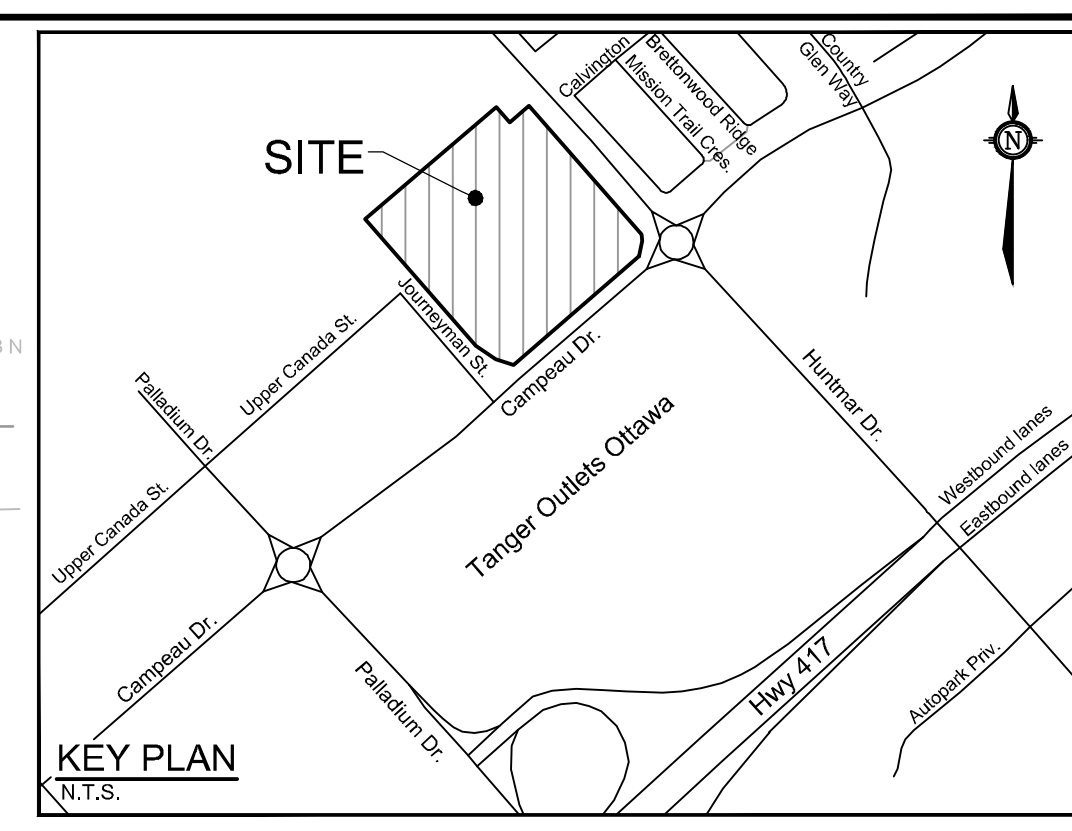

NOTE:  
THE POSITION OF ALL POLE LINES, CONDUITS, WATERMANS, SEWERS AND OTHER UNDERGROUND AND OVERGROUND UTILITIES AND STRUCTURES IS NOT NECESSARILY SHOWN ON THE CONTRACT DRAWINGS, AND WHERE SHOWN, THE ACCURACY OF THE POSITION OF SUCH UTILITIES AND STRUCTURES IS NOT GUARANTEED. BEFORE STARTING WORK, DETERMINE THE EXACT LOCATION OF ALL SUCH UTILITIES AND STRUCTURES AND ASSUME ALL LIABILITY FOR DAMAGE TO THEM.

No.	REVISION	DATE	BY
3	REVISED PER CITY COMMENTS	MAY 31/23	DDB
2	REVISED PER CITY COMMENTS	MAR 30/23	DDB
1	ISSUED FOR CITY OF OTTAWA REVIEW	DEC 16/22	DDB

SCALE	DESIGN	FOR REVIEW ONLY
1:400	SM / BM / DDB	
	CHECKED	
	DRAWN	
	CHECKED	
	APPROVED	

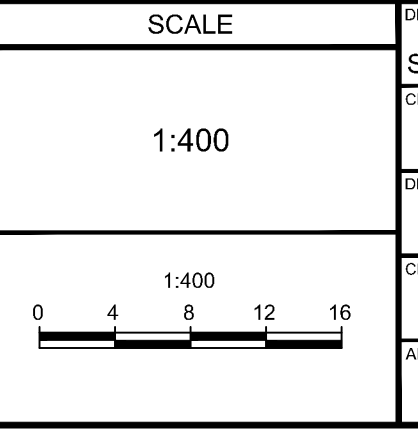

FOR REVIEW ONLY

PROFESSIONAL ENGINEER  
D. D. BLAIR  
10112237  
MAY 27 2023  
PROVINCE OF ONTARIO

**NOVATECH**  
Engineers, Planners & Landscape Architects  
Suite 200, 240 Michael Cowpland Drive  
Ottawa, Ontario, Canada K2M 1P6  
Telephone: (613) 254-8643  
Facsimile: (613) 254-8667  
Website: www.novatech-eng.com

LOCATION  
CITY OF OTTAWA  
405 HUNTMAR DRIVE - WAREHOUSE DEVELOPMENT

DRAWING NAME  
GENERAL PLAN OF SERVICES

PROJECT No.  
122151

REV #  
REV # 3

DRAWING No.  
122151-GP2

D07-12-22-0186

#18906