

**ADJACENT PROPERTY
IH - HEAVY INDUSTRIAL
ZONE**

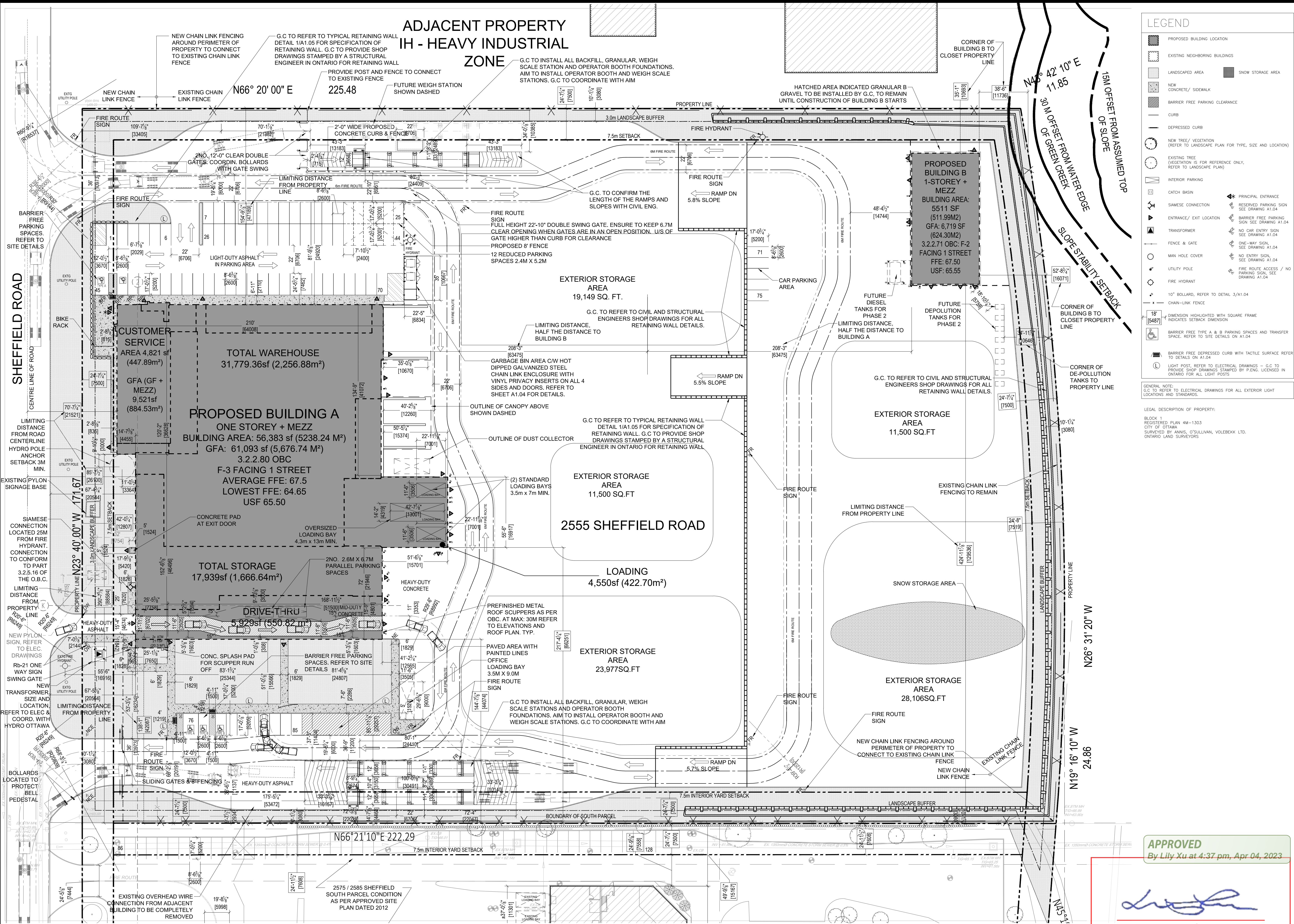

LEGEND

- PROPOSED BUILDING LOCATION
- EXISTING NEIGHBORING BUILDINGS
- LANDSCAPED AREA
- NEW CONCRETE/ SIDEWALK
- BARRIER FREE PARKING CLEARANCE
- CURB
- DEPRESSED CURB
- NEW TREE/ VEGETATION (REFER TO LANDSCAPE PLAN FOR TYPE, SIZE AND LOCATION)
- EXISTING TREE (VEGETATION IS FOR REFERENCE ONLY, REFER TO LANDSCAPE PLAN)
- INTERIOR PARKING
- CATCH BASIN
- SIAMISE CONNECTION
- ENTRANCE/ EXIT LOCATION
- TRANSFORMER
- FENCE & GATE
- MAN HOLE COVER
- UTILITY POLE
- FIRE HYDRANT
- 10" BOLLARD, REFER TO DETAIL 3/A1.04
- CHAIN-LINK FENCE
- 18" DIMENSION HIGHLIGHTED WITH SQUARE FRAME INDICATES SETBACK DIMENSION
- BARRIER FREE TYPE A & B PARKING SPACES AND TRANSFER SPACE, REFER TO SITE DETAILS ON A1.04
- BARRIER FREE DEPRESSED CURB WITH TACTILE SURFACE REFER TO DETAILS ON A1.04
- LIGHT POST, REFER TO ELECTRICAL DRAWINGS -- G.C. TO PROVIDE SHOP DRAWINGS STAMPED BY P.E. LICENSED IN ONTARIO FOR ALL LIGHT POSTS

GENERAL NOTE:
G.C. TO REFER TO ELECTRICAL DRAWINGS FOR ALL EXTERIOR LIGHT LOCATIONS AND STANDARDS.

LEGAL DESCRIPTION OF PROPERTY:
BLOCK 1
REGISTERED PLAN 4M-1303
CITY OF OTTAWA
SURVEYED BY ANNIS, O'SULLIVAN, VOLEBEK LTD.
ONTARIO LAND SURVEYORS

1. Contractor must verify all job dimensions, all drawings, details, specifications and report any discrepancies to owners before proceeding with work.
2. All drawings and specifications are instruments of service and the property of the architects which must be returned at the completion of the work, and may not be reproduced without their written permission.

ref	description	date
16	SPC REVISION	2022-08-25
15	SPC REVISION FOR REVIEW	2022-08-16
14	ISSUED FOR COORDINATION	2022-08-10
13	TRUCK STATION MODIFICATIONS	2022-07-25
12	PLYON SIGN DIMENSIONS (SITE VERIFY)	2022-07-05
11	UPDATED DRAWINGS TO SITE	2022-01-17
10	ISSUED FOR COORD	2021-11-11
09	ISSUED FOR PERMIT REV#2	2021-08-19
08	ISSUED FOR CONSTRUCTION	2021-06-03
07	ISSUED FOR PTA#1	2021-06-02
06	ISSUED FOR REVIEW	2021-05-27
05	ISSUED FOR ADDENDUM #4	2020-08-10
04	ISSUED FOR ADDENDUM #2	2020-07-29
03	ISSUED FOR ADDENDUM #1	2020-07-21
02	ISSUED FOR BUILDING TENDER	2020-07-07
01	ISSUED FOR BUILDING PERMIT	2020-06-26



OWNER:
AMERICAN IRON & METAL
9100, BOUL. HENRI-BOURASSA EST
MONTREAL, QUEBEC H1E 2S4
tel: 514-494-2000 aim-global.com

ARCHITECT:
nicholas caragianis architect inc.
137 Pamela Street,
Ottawa, ON K1S 3K9
t: 613 937 6801
f: 613 937 8999
e: info@ncarchitect.ca
www.ncarchitect.ca

PROJECT & LOCATION:
METAL RECYCLING PLANT
2555 SHEFFIELD ROAD
OTTAWA, ONT.

OFFICE FILE NUMBER: 19023

TITLE OF DRAWING: NORTH PARCEL PROPOSED SITE PLAN

APPROVED
By Lily Xu at 4:37 pm, Apr 04, 2023

LILY XU, MCIP, RPP
MANAGER, DEVELOPMENT REVIEW SOUTH
PLANNING, INFRASTRUCTURE & ECONOMIC
DEVELOPMENT DEPARTMENT, CITY OF OTTAWA

SITE PLAN: NORTH PARCEL
SCALE: 1:400

SCALE: 1:400
DATE: MARCH 2019
DRAWN BY: GL, SH, CC, AA

DRAWING #
A1.03