

| Tree No. | Tree Species | Latin Name            | Diameter (cm) | Canopy Radius (m) | Condition | Health and Structural Notes   |
|----------|--------------|-----------------------|---------------|-------------------|-----------|---|
| 1        | Honeylocust  | Gleditsia triacanthos | 12            | 2.5               | fair      | slow growth, wound on trunk 1 m from grade                                  |
| 2        | Honeylocust  | Gleditsia triacanthos | 10            | 2.5               | fair      | slow growth, broken lower branches  |
| 3        | Honeylocust  | Gleditsia triacanthos | 10            | 2.5               | fair      | surface root to east very slow growth                                       |
| 4        | Honeylocust  | Gleditsia triacanthos | 14            | 2.5               | fair      | slow growth, wound at 20 cm on east side                                    |
| 5        | Honeylocust  | Gleditsia triacanthos | 10.5          | 2.5               | poor-fair | very slow growth  |
| 6        | Honeylocust  | Gleditsia triacanthos | 13            | 2.5               | fair      | slow growth   |
| 7        | Honeylocust  | Gleditsia triacanthos | 11.5          | 2.5               | poor-fair | very slow growth  |
| 8        | Honeylocust  | Gleditsia triacanthos | 12.5          | 2.5               | fair      | very slow growth, small deadwood  |
| 9        | Honeylocust  | Gleditsia triacanthos | 13            | 2.5               | fair      | slow growth   |
| 10       | Honeylocust  | Gleditsia triacanthos | 11            | 2.5               | poor-fair | very slow growth, small deadwood  |
| 11       | Honeylocust  | Gleditsia triacanthos | 10.5          | 2.5               | poor-fair | very slow growth, small deadwood  |
| 12       | Honeylocust  | Gleditsia triacanthos | 13            | 3                 | poor-fair | good growth and also dieback at tips  |
| 13       | Honeylocust  | Gleditsia triacanthos | 11            | 3                 | fair      | grinding root to west - dehydrated bark, slugs                              |
| 14       | Norway Maple | Acer platanoides      | 21            | 3.0               | fair      | no root flare - dehydrated looking bark, slow growth                        |
| 15       | Norway Maple | Acer platanoides      | 20.5          | 3.0               | fair      | very slow growth, noticeable deadwood, no root flare to east                |
| 16       | Norway Maple | Acer platanoides      | 18            | 3.0               | poor      | dehydrated looking bark   |
| 17       | Norway Maple | Acer platanoides      | 20.5          | 3.0               | poor-fair | limited root flare to north, west, south; slow growth; rot disease          |
| 18       | Norway Maple | Acer platanoides      | 15            | 1.5               | poor      | canopy  |
| 19       | Norway Maple | Acer platanoides      | 18.5          | 2.5               | poor-fair | no root flare, slow growth  |
| 20       | Norway Maple | Acer platanoides      | 18.5          | 3.0               | fair      | no root flare, slow growth  |
| 21       | Norway Maple | Acer platanoides      | 23            | 2.0               | fair      | limited root flare, slow growth   |
| 22       | Norway Maple | Acer platanoides      | 23            | 3.0               | fair      | slow growth, small deadwood   |
| 23       | Norway Maple | Acer platanoides      | 22            | 3.5               | fair      | frank guard around trunk base, slow growth                                  |
| 24       | Norway Maple | Acer platanoides      | 24            | 3.5               | fair      | slow growth   |
| 25       | Honeylocust  | Gleditsia triacanthos | 13            | 3.0               | fair      | regular and slow growth   |
| 26       | Honeylocust  | Gleditsia triacanthos | 11            | 2.5               | poor-fair | slow growth   |
| 27       | Honeylocust  | Gleditsia triacanthos | 13            | 2.5               | poor-fair | slow growth, wound on SE side trunk 20 to 50 cm                             |
| 28       | Honeylocust  | Gleditsia triacanthos | 10            | 2.5               | fair      | regular and slow growth   |
| 29       | Honeylocust  | Gleditsia triacanthos | 11            | 2.5               | poor-fair | slow growth, wound on SE side trunk 10 to 30 cm                             |
| 30       | Honeylocust  | Gleditsia triacanthos | 9             | 2.5               | poor-fair | slow growth, wound on SE side trunk 10 to 30 cm                             |
| 31       | Honeylocust  | Gleditsia triacanthos | 11            | 2.0               | fair      | regular and slow growth, wounds at base, tight to around trunk              |
| 32       | Honeylocust  | Gleditsia triacanthos | 10.5          | 2.0               | poor-fair | very slow growth, wound at 1.4 m  |
| 33       | Honeylocust  | Gleditsia triacanthos | 11            | 2.5               | poor-fair | frank guard light against base, slow growth                                 |
| 34       | Honeylocust  | Gleditsia triacanthos | 12            | 3.5               | fair      | regular and slow growth   |
| 35       | Norway Maple | Acer platanoides      | 21            | 3.0               | poor-fair | very slow growth, limited root flare, wounded root to south, small deadwood |
| 36       | Norway Maple | Acer platanoides      | 25.5          | 3.0               | poor      | no root flare, slow growth  |

| Tree No. | Tree Species    | Latin Name            | Diameter (cm) | Canopy Radius (m) | Condition | Health and Structural Notes  |
|----------|-----------------|-----------------------|---------------|-------------------|-----------|--|
| 37       | Norway Maple    | Acer platanoides      | 22.5          | 3.5               | fair      | slow growth  |
| 38       | Norway Maple    | Acer platanoides      | 25            | 4.0               | poor-fair | slow growth, small deadwood, no root flare   |
| 39       | Norway Maple    | Acer platanoides      | 25            | 4.0               | poor-fair | very slow growth, wounded surface roots, Multiple stems at 2 metres with included bark in deadwood |
| 40       | Norway Maple    | Acer platanoides      | 25.5          | 4.0               | poor-fair | rope around branch, frank guard around trunk, slow growth, wounded surface roots                   |
| 41       | Norway Maple    | Acer platanoides      | 24.5 at 1.2 m | 3.0               | poor-fair | no root flare, canker on SE trunk at 1.4 m from grade, slow growth, small deadwood                 |
| 42       | Amur Maple      | Acer ginnala          | 12.5          | 4.0               | poor      | frank guard, rope around trunk, main stem may be dead, stem to north alive                         |
| 43       | Amur Maple      | Acer ginnala          | 14            | 3.0               | fair      | no root flare  |
| 44       | Amur Maple      | Acer ginnala          | 19            | 3.0               | fair      | canker on south side trunk at 2 m  |
| 45       | Colorado Spruce | Picea pungens         | 26            | 3.0               | good      | 8 inch growth rate, lower deadwood   |
| 46       | Colorado Spruce | Picea pungens         | 25            | 3.0               | good      | 8 inch growth rate, lower deadwood   |
| 47       | Colorado Spruce | Picea pungens         | 21            | 3.0               | good      | 8 inch growth rate, lower deadwood due to lack of light  |
| 48       | Colorado Spruce | Picea pungens         | 24            | 3.0               | good      | 8 inch growth rate, slow growth  |
| 49       | Amur Maple      | Acer ginnala          | 18.5          | 3.0               | fair      | frank splits into two stems at 1.5 m with included bark in union, slow growth                      |
| 50       | Colorado Spruce | Picea pungens         | 15            | 3.0               | dead      | no needles on tree   |
| 51       | Colorado Spruce | Picea pungens         | 20            | 3.0               | fair      | 1.4 inch growth rate, lower deadwood due to lack of light  |
| 52       | Colorado Spruce | Picea pungens         | 22.5          | 3.0               | fair      | 1 dead branch in mid canopy, 6 inch growth rate  |
| 53       | Amur Maple      | Acer ginnala          | 14            | 3.5               | fair      | leopards at base   |
| 54       | Amur Maple      | Acer ginnala          | 9.5           | 2.5               | poor      | lost leader at 1.4 m, decay in stem  |
| 55       | Colorado Spruce | Picea pungens         | 24            | 3.0               | fair      | lower deadwood   |
| 56       | Colorado Spruce | Picea pungens         | 22            | 3.0               | poor      | 8 inch growth rate, lower deadwood   |
| 57       | Colorado Spruce | Picea pungens         | 19            | 2.0               | good      | 4 inch growth rate, lower deadwood   |
| 58       | Norway Maple    | Acer platanoides      | 14.5          | 3.0               | fair      | frank guard, wounded surface roots   |
| 59       | Norway Maple    | Acer platanoides      | 13.5          | 2.0               | poor-fair | frank guard, extensive wounded surface roots, slow growth  |
| 60       | Norway Maple    | Acer platanoides      | 15            | 2.5               | poor-fair | frank guard, surface roots, slow growth  |
| 61       | Norway Maple    | Acer platanoides      | 16            | 2.5               | fair      | frank guard, slow growth   |
| 62       | Schubert Cherry | Prunus virginiana     | 13            | 4.0               | poor      | sprouts at base, Black Knot infection, canker in trunk at 1.8 to 2.5 m                             |
| 63       | Schubert Cherry | Prunus virginiana     | 14            | 3.0               | fair      | Black Knot infection, growing fine   |
| 64       | Honeylocust     | Gleditsia triacanthos | 14            | 3.0               | fair      | frank splits into three stems at 2.5 m, trunk guard  |
| 65       | Honeylocust     | Gleditsia triacanthos | 13            | 3.0               | poor-fair | frank guard, very slow growth  |
| 66       | Schubert Cherry | Prunus virginiana     | 18            | 3.0               | poor      | Black Knot infection   |
| 67       | Schubert Cherry | Prunus virginiana     | 13.5          | 3.0               | poor-fair | leafroll roots, Black Knot infection, small canker in trunk  |
| 68       | Colorado Spruce | Picea pungens         | 28            | 2.5               | poor      | poor dead for 4 m, lower lateral branches alive  |
| 69       | Colorado Spruce | Picea pungens         | 23            | 2.0               | good      | 4 inch growth rate, lower deadwood   |

| Tree No. | Tree Species    | Latin Name             | Diameter (cm) | Canopy Radius (m) | Condition | Health and Structural Notes  |
|----------|-----------------|------------------------|---------------|-------------------|-----------|--|
| 70       | Colorado Spruce | Picea pungens          | 21            | 2.5               | poor-fair | top dead for 2 m, middle lateral branches alive, extensive lower deadwood  |
| 71       | Colorado Spruce | Picea pungens          | 24            | 2.5               | good      | 8 inch growth rate, lower deadwood   |
| 72       | Colorado Spruce | Picea pungens          | 26            | 3.0               | fair      | 8 inch growth rate, slow growth  |
| 73       | Colorado Spruce | Picea pungens          | 26            | 3.0               | good      | extensive lower deadwood, dead branch in mid canopy, 4 inch growth rate  |
| 74       | Colorado Spruce | Picea pungens          | 20            | 2.5               | good      | small lower deadwood, 4 inch growth rate, full canopy  |
| 75       | Norway Maple    | Acer platanoides       | 25            | 4.0               | fair      | wounded surface roots, multiple stems at 2 m with included bark in union, slow growth                                |
| 76       | Colorado Spruce | Picea pungens          | 30.5          | 3.5               | good      | 8 inch growth rate, full canopy  |
| 77       | Colorado Spruce | Picea pungens          | 21            | 3.0               | fair      | deadwood in lower canopy due to Maple, 8 inch growth rate  |
| 78       | Colorado Spruce | Picea pungens          | 28.5          | 3.0               | fair      | deadwood in lower canopy due to Maple, 6 inch growth rate  |
| 79       | Norway Maple    | Acer platanoides       | 23.5          | 4.0               | fair      | grinding root to west, slow growth   |
| 80       | Norway Maple    | Acer platanoides       | 29            | 3.5               | fair      | grinding root to west, slow growth   |
| 81       | Norway Maple    | Acer platanoides       | 28.5          | 4.0               | fair      | slow growth, multiple stems at 2 m with included bark in union   |
| 82       | Colorado Spruce | Picea pungens          | 27.5          | 3.0               | good      | 8 inch growth rate on slope, lower deadwood  |
| 83       | Colorado Spruce | Picea pungens          | 27            | 3.0               | good      | 8 inch growth rate, lower deadwood   |
| 84       | Colorado Spruce | Picea pungens          | 19            | 3.0               | good      | 3-4 inch growth rate, lower deadwood   |
| 85       | Colorado Spruce | Picea pungens          | 26            | 3.0               | good      | lower deadwood   |
| 86       | Colorado Spruce | Picea pungens          | 26            | 3.0               | fair      | top dying, 3-4 inch growth rate, lower deadwood  |
| 87       | Colorado Spruce | Picea pungens          | 28            | 3.5               | poor      | 3.5 inch growth rate, lower deadwood   |
| 88       | Green Ash       | Fraxinus pennsylvanica | 7             | 3.5               | poor      | main stem dead due to Emerald Ash Borer, 7 sprouts at base   |
| 89       | Sugar Maple     | Acer saccharum         | 34.5          | 4.5               | good      | frank splits into two stems at 2 m with included bark in union   |
| 90       | Sugar Maple     | Acer saccharum         | 33.5          | 3.5               | poor-fair | wound up trunk from 1.8 to 1.9 m, light colored at 1.8 and 2.0 m, deadwood in canopy from stems sprouting others out |
| 91       | Amur Maple      | Acer ginnala           | 18            | 3.0               | poor      | lower deadwood, Black Knot infection   |
| 92       | Colorado Spruce | Picea pungens          | 23            | 3.0               | fair      | good   |
| 93       | Colorado Spruce | Picea pungens          | 17            | 3.0               | good      | lower deadwood, 5 inch growth rate   |
| 94       | Colorado Spruce | Picea pungens          | 24            | 3.0               | good      | lower deadwood, 5 inch growth rate   |
| 95       | Colorado Spruce | Picea pungens          | 24            | 3.0               | good      | lower deadwood, 5 inch growth rate   |
| 96       | Colorado Spruce | Picea pungens          | 21            | 3.0               | fair      | lower deadwood, 4 inch growth rate, Black Knot infection   |
| 97       | Colorado Spruce | Picea pungens          | 26            | 3.0               | good      | lower deadwood, 4 inch growth rate   |
| 98       | Colorado Spruce | Picea pungens          | 28            | 3.0               | good      | lower deadwood, 8 inch growth rate   |
| 99       | Colorado Spruce | Picea pungens          | 24            | 3.0               | good      | lower deadwood, 8 inch growth rate   |

**TREES TO BE REMOVED AND INJURED**  
 2501 Greenbank Road, Nepean, Ontario

**TREES TO BE REMOVED FOR CONSTRUCTION**

| Tree No. | Tree Species    | Diameter (cm) | Condition | Reason for Removal or Injury            |
|----------|-----------------|---------------|-----------|---|
| 65       | Honeylocust     | 12            | poor-fair | excavation for concrete post within CRZ |
| 70       | Colorado Spruce | 21            | poor-fair | excavation for concrete post within CRZ |
| 72       | Colorado Spruce | 26            | fair      | excavation for concrete post within CRZ |
| 74       | Colorado Spruce | 26            | good      | excavation for concrete post within CRZ |
| 76       | Colorado Spruce | 30.5          | good      | excavation for concrete post within CRZ |
| 77       | Colorado Spruce | 21            | fair      | excavation for concrete post within CRZ |
| 78       | Colorado Spruce | 28.5          | fair      | excavation for concrete post within CRZ |
| 83       | Colorado Spruce | 27            | good      | excavation for concrete post within CRZ |
| 84       | Colorado Spruce | 19            | good      | excavation for concrete post within CRZ |
| 85       | Colorado Spruce | 26            | good      | excavation for concrete post within CRZ |
| 86       | Colorado Spruce | 26            | fair      | excavation for concrete post within CRZ |
| 87       | Colorado Spruce | 28            | good      | excavation for concrete post within CRZ |
| 88       | Green Ash       | 7             | max       | excavation for concrete post within CRZ |
| 89       | Sugar Maple     | 34.5          | good      | excavation for concrete post within CRZ |
| 90       | Sugar Maple     | 33.5          | poor-fair | excavation for concrete post within CRZ |
| 18       | Fees            |               |           |   |

**TREES TO BE INJURED FOR CONSTRUCTION**

| Tree No. | Tree Species    | Diameter (cm) | Condition | Reason for Removal or Injury            |
|----------|-----------------|---------------|-----------|---|
| 42       | Amur Maple      | 12.5          | poor      | excavation for concrete post within CRZ |
| 43       | Amur Maple      | 14            | fair      | excavation for concrete post within CRZ |
| 44       | Amur Maple      | 19            | fair      | excavation for concrete post within CRZ |
| 45       | Colorado Spruce | 16            | fair      | excavation for concrete post within CRZ |
| 47       | Colorado Spruce | 21            | good      | excavation for concrete post within CRZ |
| 67       | Colorado Spruce | 19            | good      | excavation for concrete post within CRZ |
| 68       | Norway Maple    | 14.5          | fair      | excavation for concrete post within CRZ |
| 69       | Norway Maple    | 13.5          | poor-fair | excavation for concrete post within CRZ |
| 69       | Norway Maple    | 18            | fair      | excavation for concrete post within CRZ |
| 69       | Norway Maple    | 14            | fair      | excavation for light post within CRZ    |
| 69       | Norway Maple    | 14            | fair      | excavation for light post within CRZ    |
| 69       | Norway Maple    | 14            | fair      | excavation for light post within CRZ    |
| 71       | Colorado Spruce | 24            | good      | excavation for concrete post within CRZ |
| 73       | Colorado Spruce | 24            | good      | excavation for concrete post within CRZ |
| 73       | Colorado Spruce | 24            | good      | excavation for concrete post within CRZ |
| 73       | Colorado Spruce | 24            | good      | excavation for concrete post within CRZ |
| 73       | Colorado Spruce | 24            | good      | excavation for concrete post within CRZ |
| 81       | Norway Maple    | 25.5          | fair      | excavation for swale within CRZ         |
| 81       | Norway Maple    | 25.5          | fair      | excavation for swale within CRZ         |
| 18       | Fees            |               |           |   |

**TREES TO BE REMOVED FOR HEALTH OR STRUCTURE**

| Tree No. | Tree Species    | Diameter (cm) | Condition | Reason for Removal or Injury       |
|----------|-----------------|---------------|-----------|------------------------------------|
| 42       | Amur Maple      | 12.5          | poor      | poor health, structure, appearance |
| 43       | Amur Maple      | 14            | poor      | poor health, structure, appearance |
| 44       | Amur Maple      | 19            | poor      | poor health, structure, appearance |
| 63       | Schubert Cherry | 14            | poor      | poor health, structure, appearance |
| 63       | Schubert Cherry | 14            | poor      | poor health, structure, appearance |
| 66       | Schubert Cherry | 18            | poor      | poor health, structure, appearance |
| 67       | Schubert Cherry | 19            | poor-fair | poor health, structure, appearance |
| 68       | Colorado Spruce | 26            | poor      | poor health, structure, appearance |
| 18       | Fees            |               |           |                                    |

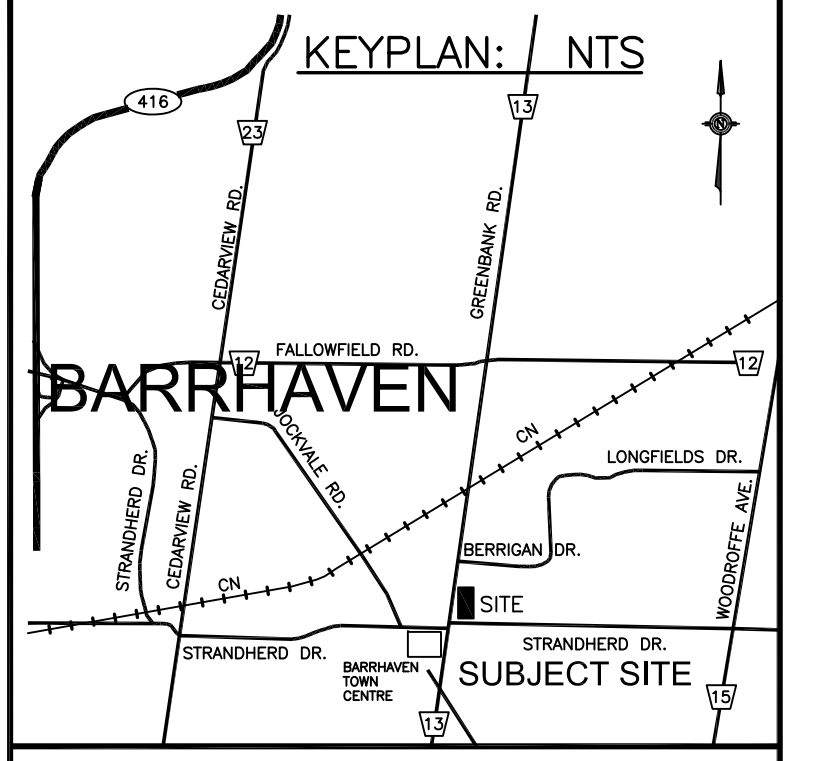

**IT IS THE CONTRACTOR'S RESPONSIBILITY TO:**

- Determine the location of all existing services and obtain necessary stake-outs before any excavation.
- Use figured dimensions as opposed to scaling and verify all dimensions at the site before commencing the work.
- Report all discrepancies to the Landscape Architect and resolve before commencing the work.

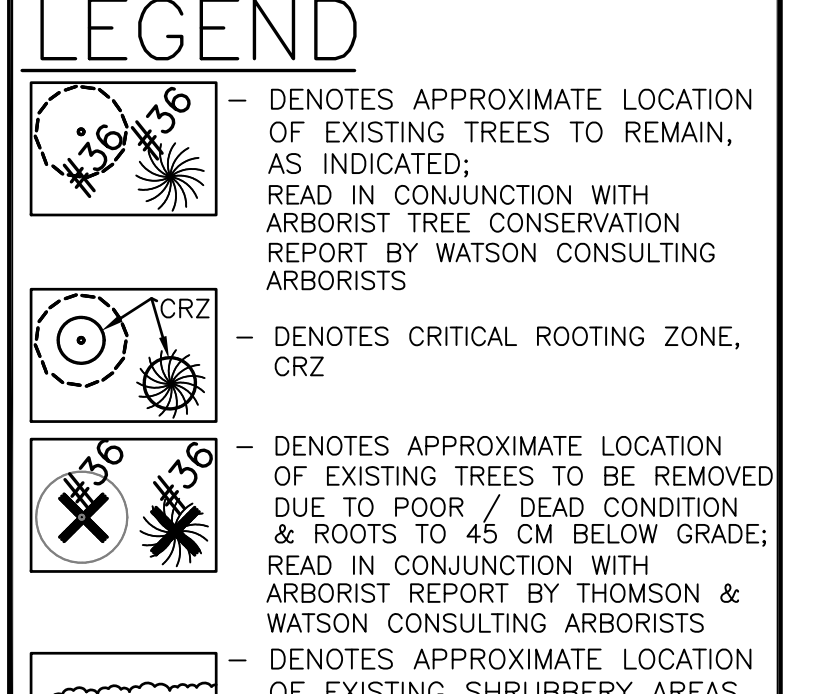

**READ IN CONJUNCTION WITH TREE CONSERVATION REPORT BY THOMSON WATSON CONSULTING ARBORISTS INC.,**

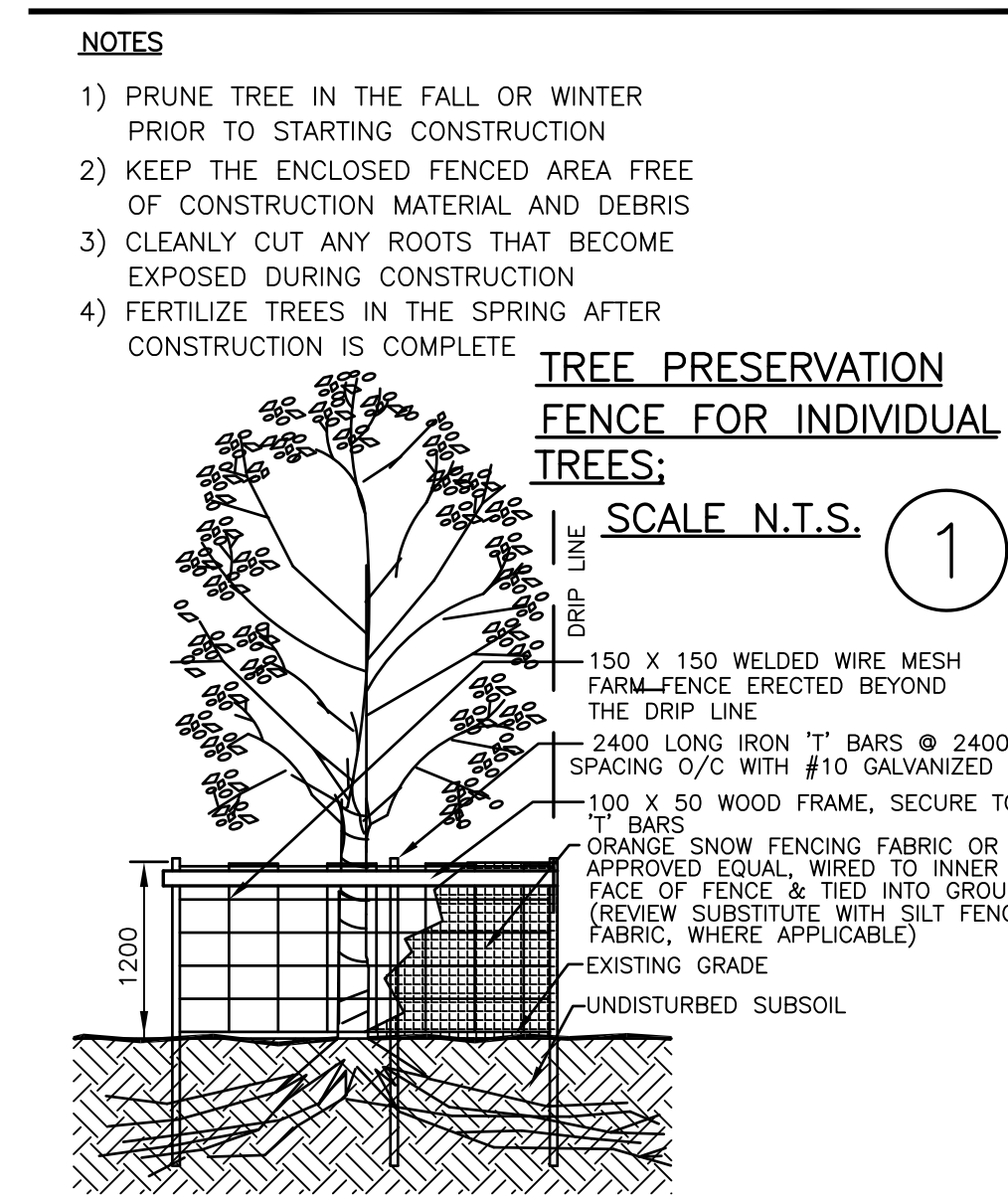
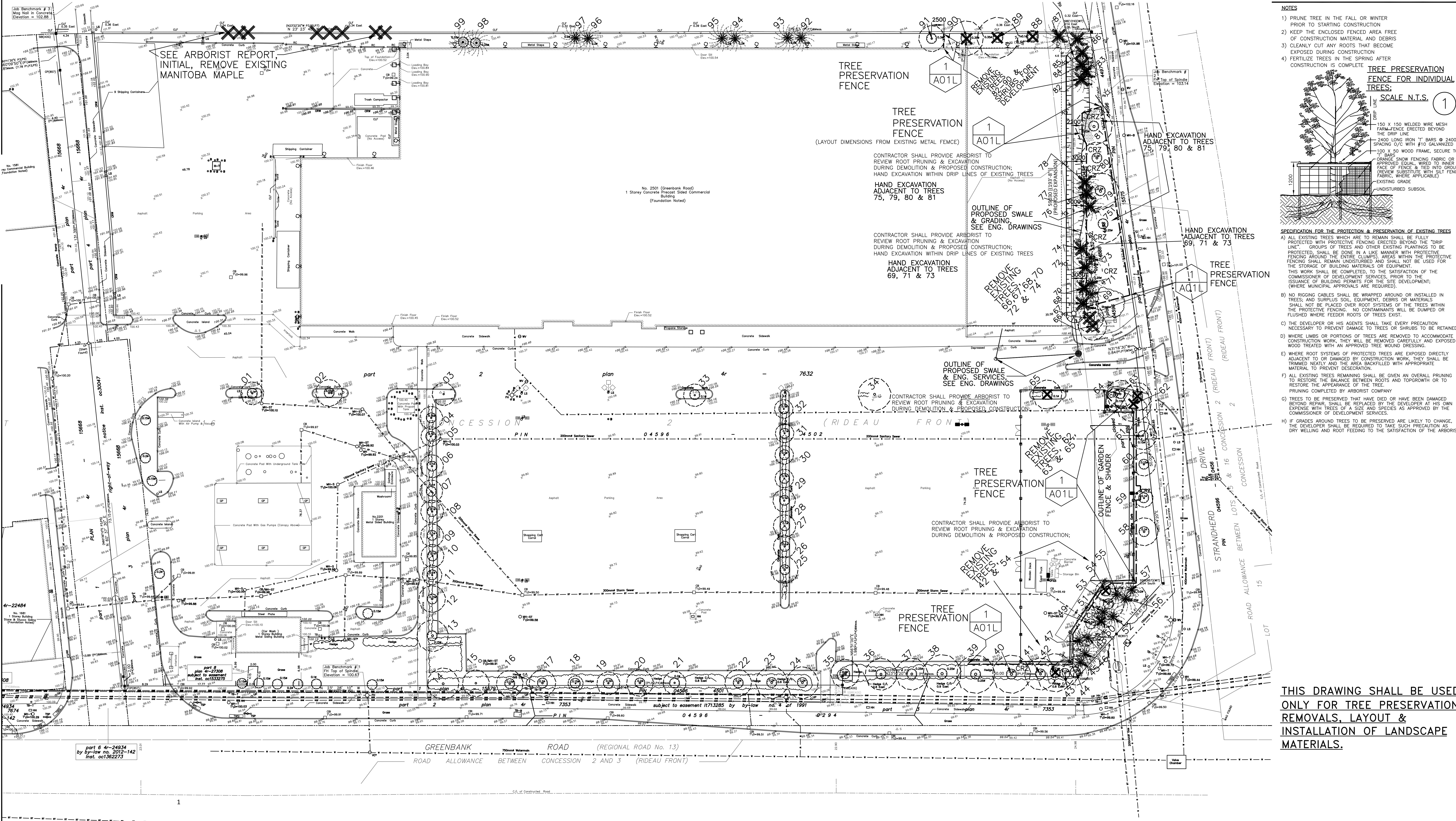

**NOTES**

- PRUNE TREE IN THE FALL OR WINTER PRIOR TO STARTING CONSTRUCTION.
- KEEP THE ENCLOSED FENCED AREA FREE OF CONSTRUCTION MATERIAL AND DEBRIS.
- CLEANLY CUT ANY ROOTS THAT BECOME EXPOSED DURING CONSTRUCTION.
- FERTILIZE TREES IN THE SPRING AFTER CONSTRUCTION IS COMPLETE.

**REVISION RECORD**

| NO. | DATE | DESCRIPTION   | BY  |
|-----|------|---|-----|
| 1   |      | ISSUE FOR SITE PLAN CONTROL   | DWK |
| 2   |      | ISSUE FOR REVIEW PLAN, APRIL 03, 2023                                       | DWK |
| 3   |      | DRAFT FOR ENGINEERING REVIEW & COORDINATION                                 | DWK |
| 4   |      | DRAFT FOR SITE PLAN DATED AUGUST 2022 & ARBORIST REPORT DATED OCTOBER, 2022 | DWK |

**DESIGN CREDIT NOTE:**  
 LANDSCAPE DESIGN BASED ON ORIGINAL DESIGN BY BROUTE ENGINEERING LIMITED, GANVILLE, ONTARIO. PHONE: 905-827-5128 FAX: 905-847-3112 JOB NO. 99-349

**PRELIMINARY, NOT FOR CONSTRUCTION**

| DATE         | REV. | DESCRIPTION   | BY  |
|--------------|------|---|-----|
| APR., 28, 23 | 5    | ISSUE FOR SITE PLAN CONTROL   | DWK |
| APR., 28, 23 | 4    | ISSUE FOR REVIEW PLAN, APRIL 03, 2023                                       | DWK |
| APR., 13, 23 | 3    | DRAFT FOR ENGINEERING REVIEW & COORDINATION                                 | DWK |
| MAR., 22, 23 | 2    | DRAFT FOR SITE PLAN DATED AUGUST 2022 & ARBORIST REPORT DATED OCTOBER, 2022 | DWK |
| DEC., 19, 22 | 1    | DATE  | DWK |

**ENGINEER**  
**PARSONS**  
 1223 MICHAEL ST., SUITE 100, OTTAWA, ONT. K1J 7T2  
 TEL: 613-381-4160 FAX: 613-739-7195

**LANDSCAPE ARCHITECT**  
**DWK** Douglas W. Karr & Associates Ltd.  
 1595 SEVENTEEN AVENUE, SUITE 301  
 RICHMOND HILL, ONTARIO L4B 3H8  
 TEL: 416-410-5190  
 email: dkarr@dwkinc.com

**NOT FOR CONSTRUCTION**  
 APRIL 28, 2023

**BARRHAVEN**  
 STORE No. 442

**CANADIAN TIRE REAL ESTATE LIMITED**  
 2890 WING ST., P.O. BOX 770, STATION K, TORONTO, CANADA M9H 2Y8  
 CONTRACTOR MUST CHECK AND VERIFY ALL DIMENSIONS AND BE RESPONSIBLE FOR ANY DISCREPANCIES BEFORE COMMENCING WORK. LATEST APPROVED DRAWING ONLY TO BE USED FOR CONSTRUCTION. PRINTS ARE NOT TO BE SCALED.

**PROJECT:**  
 CANADIAN TIRE REAL ESTATE LTD. EXPANSION OF RETAIL STORE & SERVICE CENTRE, 2501 GREENBANK RD. & TRANSDR DR. BARRHAVEN, NEPEAN, ONTARIO

**DRAWING TITLE:** TREE CONSERVATION PLAN **DRAWING NO.:** A-01L

**DRAWN:** D.W.K. **CHECKED:** D.W.K.  
**SCALE:** 1:300 **JOB NO.:** 22-1784  
**FILE NAME:** 1784-A-02L-R05 **DATE:** APRIL 28, 2023

**THIS DRAWING SHALL BE USED ONLY FOR TREE PRESERVATION, REMOVALS, LAYOUT**