

LEGEND	
	PROPERTY LINE
	PROPOSED WATERMAIN
	PROPOSED VALVE BOX
	PROPOSED STORM MANHOLE
	PROPOSED SAN MANHOLE
	PROPOSED AREA DRAIN
	PROPOSED SANITARY SEWER
	UNDERGROUND PARKING LIMITS
	PROPOSED STORM SEWER
	PROPOSED CAP
	EXISTING LEGAL ADJACENT LINE
	EXISTING STANDARD IRON BAR / CONDUIT POINT
	EXISTING FLOW DIRECTION OF SEWERS
	EXISTING SANITARY MANHOLE & SEWER
	EXISTING STORM MANHOLE & SEWER
	EXISTING CATCH BASIN
	EXISTING BUILDING ENVELOPE
	EXISTING WATERMAIN VALVE CHAMBER
	EXISTING WATERMAIN SHUT-OFF VALVE BOX
	EXISTING WATERMAIN
	EXISTING HYDRANT CYL LEAD & SHUT OFF VALVE BOX
	EXISTING GAS VALVE
	EXISTING GAS MAIN
	EXISTING ABANDONED GAS MAIN
	EXISTING BELL CONDUIT
	EXISTING OVER HEAD WIRE
	EXISTING HYDRO/UTILITY POLE
	EXISTING GUY WIRE
	EXISTING TRAFFIC MANHOLE
	EXISTING JOINT USE STREET LIGHT
	EXISTING STREET LIGHT
	EXISTING TRAFFIC HAND HOLE
	EXISTING TRAFFIC SIGN
	EXISTING DITCH INLET
	EXISTING CATCH BASIN
	EXISTING HYDRANT

- GENERAL NOTES:**
- COORDINATE AND SCHEDULE ALL WORK WITH OTHER TRADES AND CONTRACTORS.
  - DETERMINE THE EXACT LOCATION, SIZE, MATERIAL AND ELEVATION OF ALL EXISTING UTILITIES PRIOR TO COMMENCING CONSTRUCTION. PROTECT AND ASSUME RESPONSIBILITY FOR ALL EXISTING UTILITIES WHETHER OR NOT SHOWN ON THIS DRAWING.
  - OBTAIN ALL NECESSARY PERMITS AND APPROVALS FROM THE CITY OF OTTAWA BEFORE COMMENCING CONSTRUCTION.
  - BEFORE COMMENCING CONSTRUCTION OBTAIN AND PROVIDE PROOF OF COMPREHENSIVE, ALL RISK AND OPERATIONAL LIABILITY INSURANCE FOR \$5,000,000.00. INSURANCE POLICY TO NAME OWNERS, ENGINEERS AND ARCHITECTS AS CO-INSURED.
  - RESTORE ALL DISTURBED AREAS ON-SITE AND OFF-SITE, INCLUDING TRENCHES AND SURFACES ON PUBLIC ROAD ALLOWANCES TO EXISTING CONDITIONS OR BETTER TO THE SATISFACTION OF THE CITY OF OTTAWA AND ENGINEER.
  - REMOVE FROM SITE ALL EXCESS EXCAVATED MATERIAL, ORGANIC MATERIAL, AND DEBRIS UNLESS OTHERWISE INSTRUCTED BY ENGINEER. EXCAVATE AND REMOVE FROM SITE ANY CONTAMINATED MATERIAL. ALL CONTAMINATED MATERIAL SHALL BE DISPOSED OF AT A LICENSED LANDFILL FACILITY.
  - ALL ELEVATIONS ARE GEODETIC. CITY OF OTTAWA DENOTED AS PART OF LOTS 1554, 1555, 1556, AND 1557, REGISTERED PLAN 38, CITY OF OTTAWA.
  - REFER TO GEOTECHNICAL REPORT (No. PB5281-1, DATED JUL 16TH, 2020), PREPARED BY PATERSON, FOR SUBSURFACE CONDITIONS, CONSTRUCTION RECOMMENDATIONS, AND GEOTECHNICAL INSPECTION REQUIREMENTS. THE GEOTECHNICAL CONSULTANT IS TO REVIEW ON-SITE CONDITIONS AFTER EXCAVATION PRIOR TO PLACEMENT OF THE GRANULAR MATERIAL.
  - REFER TO ARCHITECTS AND LANDSCAPE ARCHITECTS DRAWINGS FOR BUILDING AND HARDSCAPE AREAS AND DIMENSIONS.
  - REFER TO STORMWATER MANAGEMENT REPORT PREPARED BY NOVATECH ENGINEERING CONSULTANTS LTD. R-2021-055- DATED APRIL 21, 2023.
  - SAW CUT AND KEY GRIND ASPHALT AT ALL ROAD CUTS AND ASPHALT TIE IN POINTS AS PER CITY OF OTTAWA STANDARDS (R10).
  - CONTRACTOR TO PROVIDE THE CONSULTANT WITH A GENERAL PLAN OF SERVICES INDICATING ALL SERVING AS-BUILT INFORMATION SHOWN ON THIS PLAN. AS-BUILT INFORMATION MUST INCLUDE: PIPE MATERIAL, SIZES, LENGTHS, SLOPES, INVERT AND TIG ELEVATIONS, STRUCTURE LOCATIONS, VALVE AND HYDRANT LOCATIONS, TWM ELEVATIONS AND ANY ALIGNMENT CHANGES, ETC.

- SEWER NOTES:**
- | SPECIFICATIONS:  | SPEC. No.   | REFERENCE             |
|--|-------------|-----------------------|
| CATCH-BASIN (600x600mm)  | 701.010     | OPSD                  |
| STORM / SANITARY MANHOLE (1200mm)  | 701.010     | OPSD                  |
| CB FRAME & COVER   | 400.020     | OPSD                  |
| STORM / SANITARY MH FRAME & COVER  | 401.010     | OPSD                  |
| SEWER TRENCH - BEDDING (GRANULAR A)                                      | 56, 57, W17 | CITY OF OTTAWA / OPSD |
| COVER (GRANULAR A OR GRANULAR B TYPE I, WITH MAXIMUM PARTICLE SIZE=25mm) | 56, 57, W17 | CITY OF OTTAWA / OPSD |
| STORM SEWER  | PVC DR 35   | CITY OF OTTAWA        |
| SANITARY SEWER   | PVC DR 35   | CITY OF OTTAWA        |
| CATCH-BASIN LEAD   | PVC DR 35   | CITY OF OTTAWA        |
| SEWER SERVICE CONNECTION - RIGID PIPE                                    | S11         | CITY OF OTTAWA        |
| SEWER SERVICE ABANDONMENT  | S11.4       | CITY OF OTTAWA        |
- INSULATE ALL PIPES (SAN/STM) THAT HAVE LESS THAN 2.0m COVER WITH 50mmx1200mm HI-40 INSULATION. PROVIDE 150mm CLEARANCE BETWEEN PIPE AND INSULATION.
  - SERVICES ARE TO BE CONSTRUCTED TO 1.0m FROM FACE OF BUILDING AT A MINIMUM SLOPE OF 1.0%.
  - PIPE BEDDING, COVER AND BACKFILL ARE TO BE COMPACTED TO AT LEAST 98% OF THE STANDARD PROCTOR MAXIMUM DRY DENSITY. THE USE OF CLEAR CRUSHED STONE AS A BEDDING LAYER SHALL NOT BE PERMITTED.
  - FLEXIBLE CONNECTIONS ARE REQUIRED FOR CONNECTING PIPES TO MANHOLES (FOR EXAMPLE KOR-N-SEAL, PSX, POSITIVE SEAL AND DURASEAL). THE CONCRETE CRADLE FOR THE PIPE CAN BE ELIMINATED.
  - THE OWNER SHALL REQUIRE THAT THE SITE SERVICING CONTRACTOR PERFORM FIELD TESTS FOR QUALITY CONTROL OF ALL SANITARY SEWERS. LEAKAGE TESTING SHALL BE COMPLETED IN ACCORDANCE WITH OPSD 410.07.16, 410.07.16.04 AND 407.07.24. DYE TESTING IS TO BE COMPLETED ON ALL SANITARY SERVICES TO CONFIRM PROPER CONNECTION TO THE SANITARY SEWER MAIN. THE FIELD TESTS SHALL BE PERFORMED IN THE PRESENCE OF A CERTIFIED PROFESSIONAL ENGINEER WHO SHALL SUBMIT A CERTIFIED COPY OF THE TEST RESULTS.
  - STORM MANHOLES AND CBHMS ARE TO HAVE 300mm SUMPS UNLESS OTHERWISE INDICATED.
  - CONTRACTOR TO TELETYPE (CCTV) ALL PROPOSED SEWERS, 200mm OR GREATER RIGID TO BASE COURSE ASPHALT. UPON COMPLETION OF CONTRACT, THE CONTRACTOR IS RESPONSIBLE TO FLUSH AND CLEAN ALL SEWERS & APPURTENANCES.
  - FULL PORT BACKWATER VALVES ARE REQUIRED ON THE SANITARY SERVICES. INSTALLED AS PER THE MANUFACTURERS RECOMMENDATIONS AND A BACKWATER VALVE IS REQUIRED ON THE STORM SERVICES / FOUNDATION DRAINS FOR EACH BUILDING, INSTALLED AS PER STD. DWG514.
  - REINSTATE ALL EXISTING PAVEMENT, CURB AND BOULEVARDS AS PER CITY OF OTTAWA R10.
  - ALL EXISTING SANITARY AND STORM SERVICES ARE TO BE CAPPED AT THE PROPERTY LINE TO THE SATISFACTION OF THE CITY OF OTTAWA'S SEWER OPERATION.
  - MONITORING TEST PORTS FOR BUILDING SERVICES TO BE INSTALLED IN PARKING GARAGE.

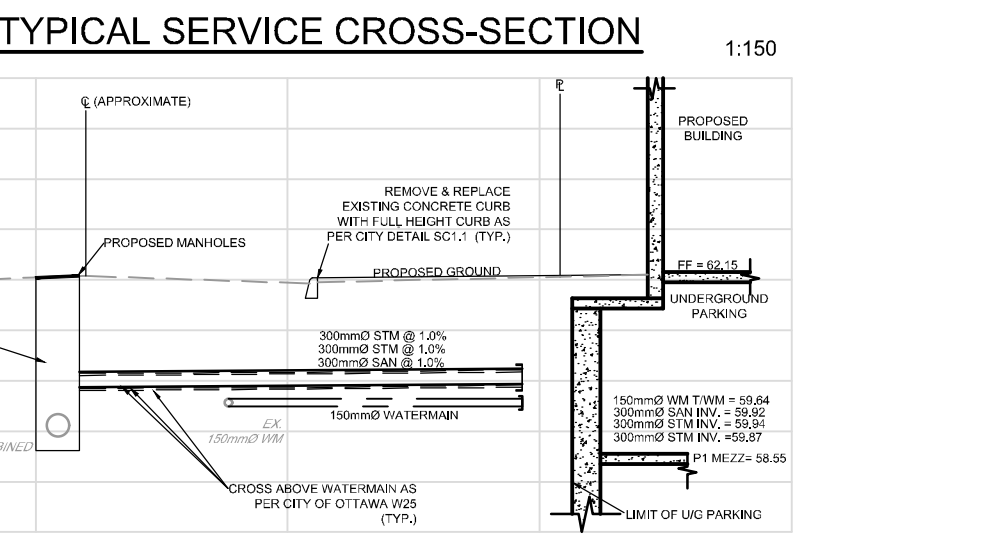

NOTE:  
THE POSITION OF ALL POLE LINES, CONDUITS, WATERMAINS, SEWERS AND OTHER UNDERGROUND AND OVERGROUND UTILITIES AND STRUCTURES IS NOT NECESSARILY SHOWN ON THE CONTRACT DRAWINGS, AND WHERE SHOWN, THE ACCURACY OF THE POSITION OF SUCH UTILITIES AND STRUCTURES IS NOT GUARANTEED. BEFORE STARTING WORK, DETERMINE THE EXACT LOCATION OF ALL SUCH UTILITIES AND STRUCTURES AND ASSUME ALL LIABILITY FOR DAMAGE TO THEM.

NOT FOR  
CONSTRUCTION

CLARIDGE HOMES  
505 PRESTON STREET,  
OTTAWA, ONTARIO  
K1S 4N7.

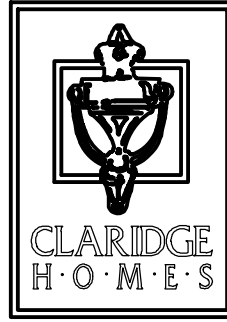

No.	REVISION	DATE	BY
3.	ISSUED FOR ZBA AND SPA	APRIL21/23	GJM
2.	ISSUED WITH SITE PLAN APPLICATION	APR15/21	JAG
1.	ISSUED FOR PRELIMINARY CONSTRUCTION	FEB22/21	JAG

SCALE	DESIGN	CHECKED	DRAWN	APPROVED
1:100	CJF	GJM	CJF	GJM

**FOR REVIEW ONLY**

PROFESSIONAL ENGINEER  
G.J. MacDONALD  
APR 24, 2023  
PROVINCE OF ONTARIO

**NOVATECH**  
Engineers, Planners & Landscape Architects  
Suite 200, 240 Michael Cowpland Drive  
Ottawa, Ontario, Canada K2M 1P6  
Telephone: (613) 254-9643  
Facsimile: (613) 254-5867  
Website: www.novatech-eng.com

LOCATION  
CITY OF OTTAWA  
ICON2 - 829 CARLING AVE.

DRAWING NAME  
GENERAL PLAN OF SERVICING

PROJECT No.  
121008

REV #  
3

DRAWING No.  
121008-GP



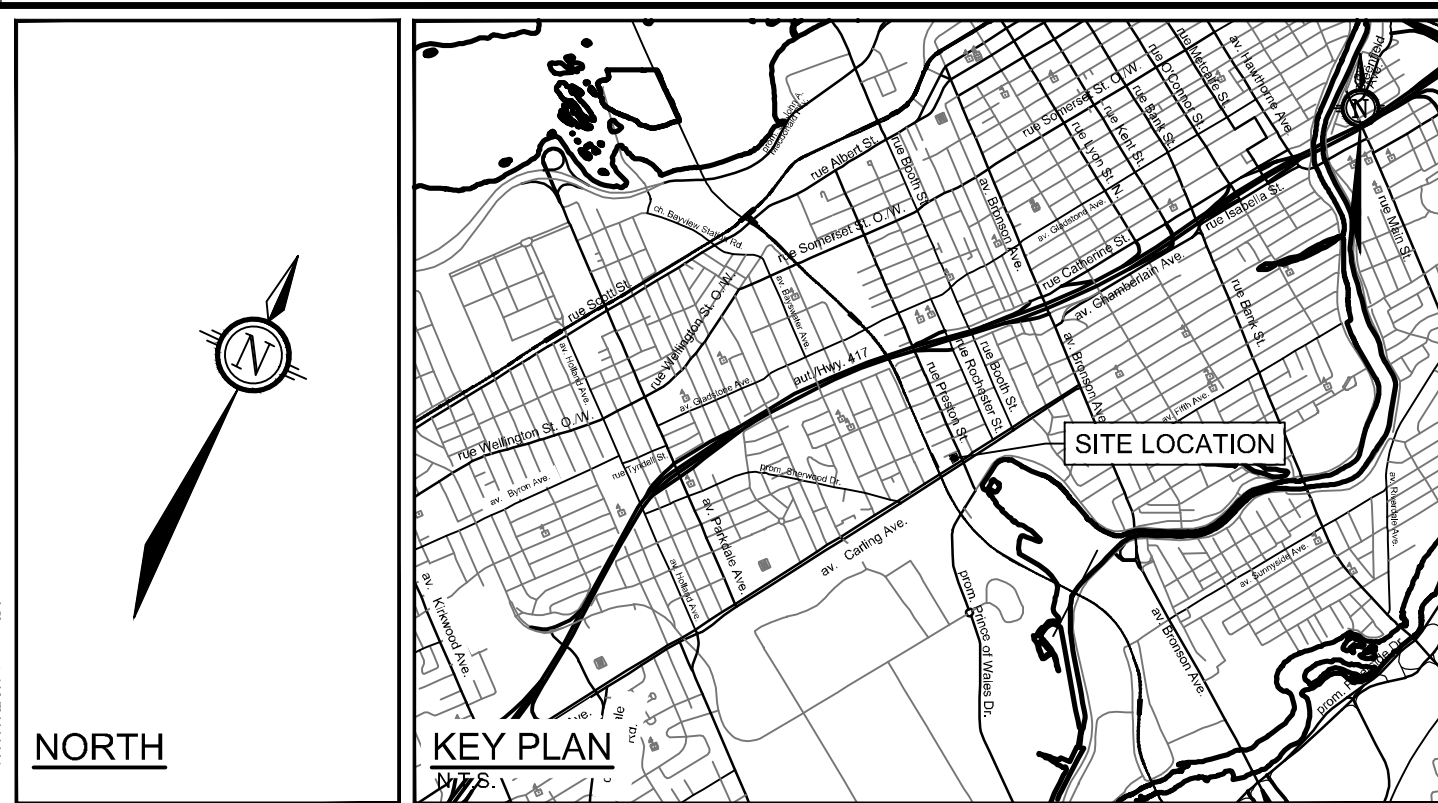
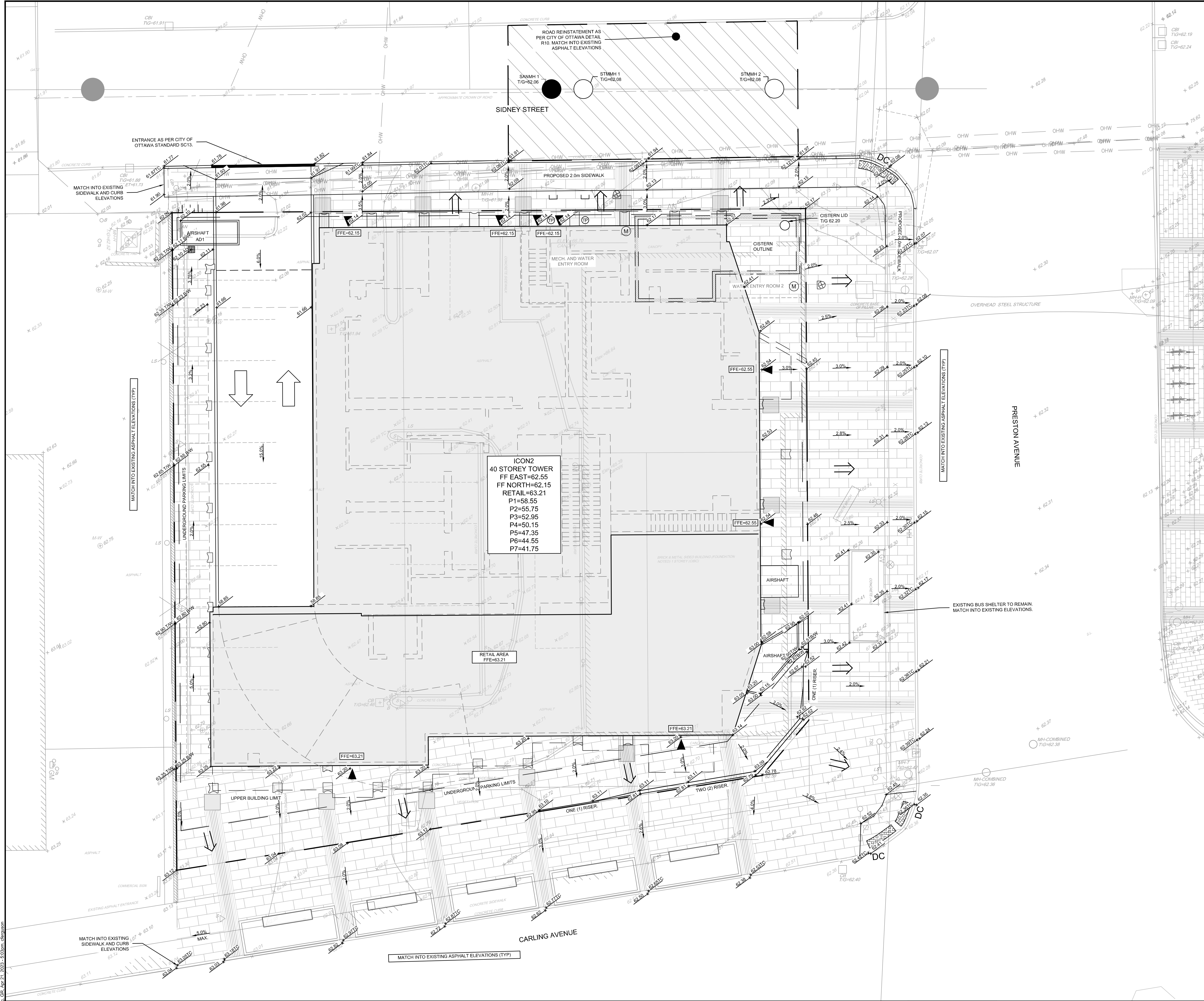

LEGEND			
---	PROPERTY LINE	SAN MH	PROPOSED SANITARY MANHOLE
DC	PROPOSED DEPRESSION CURB	STM MH	PROPOSED STORM MANHOLE
96.40	PROPOSED TACTILE WALKING SURFACE INDICATOR (TWSI)	EXISTING VALVE & VALVE BOX	EXISTING VALVE & VALVE BOX
96.40	PROPOSED ELEVATION	EXISTING VALVE & LEAD	EXISTING VALVE & LEAD
97.79AD	EXISTING ELEVATION	EXISTING SANITARY MANHOLE	EXISTING SANITARY MANHOLE
97.79AD	PROPOSED AREA DRAIN ELEVATION	EXISTING STORM MANHOLE	EXISTING STORM MANHOLE
97.79AD	PROPOSED TOP OF WALL ELEVATION	EXISTING CATCH-BASIN	EXISTING CATCH-BASIN
97.79AD	PROPOSED BOTTOM OF WALL ELEVATION	EXISTING DITCH CENTERLINE	EXISTING DITCH CENTERLINE
97.79AD	PROPOSED TOP OF CURB ELEVATION	EXISTING UTILITY POLE	EXISTING UTILITY POLE
97.79AD	PROPOSED VALVE AND VALVE BOX	EXISTING UTILITY POLE ANCHORS	EXISTING UTILITY POLE ANCHORS
97.79AD	FIRE DEPARTMENT SIAMSE CONNECTION	EXISTING STREETLIGHT	EXISTING STREETLIGHT
97.79AD	PROPOSED BUILDING ENTRANCE		
97.79AD	PROPOSED HIGH POINT		
97.79AD	TERRACING 3:1 SLOPE MAX (UNLESS OTHERWISE INDICATED)		
97.79AD	SLOPE AND DIRECTION		
97.79AD	DIRECTION OF MAJOR OVERLAND FLOW		
97.79AD	PROPOSED AREA DRAIN		

- GENERAL NOTES:**
- COORDINATE AND SCHEDULE ALL WORK WITH OTHER TRADES AND CONTRACTORS.
  - DETERMINE THE EXACT LOCATION, SIZE, MATERIAL AND ELEVATION OF ALL EXISTING UTILITIES PRIOR TO COMMENCING CONSTRUCTION. PROTECT AND ASSUME RESPONSIBILITY FOR ALL EXISTING UTILITIES WHETHER OR NOT SHOWN ON THIS DRAWING.
  - OBTAIN ALL NECESSARY PERMITS AND APPROVALS FROM THE CITY OF OTTAWA BEFORE COMMENCING CONSTRUCTION.
  - BEFORE COMMENCING CONSTRUCTION OBTAIN AND PROVIDE PROOF OF COMPREHENSIVE, ALL RISK AND OPERATIONAL LIABILITY INSURANCE FOR \$5,000,000.00, INSURANCE POLICY TO NAME OWNERS, ENGINEERS AND ARCHITECTS AS CO-INSURED.
  - RESTORE ALL DISTURBED AREAS ON-SITE AND OFF-SITE, INCLUDING TRENCHES AND SURFACES ON PUBLIC ROAD ALLOWANCES TO EXISTING CONDITIONS OR BETTER TO THE SATISFACTION OF THE CITY OF OTTAWA AND ENGINEER.
  - REMOVE FROM SITE ALL EXCESS EXCAVATED MATERIAL, ORGANIC MATERIAL AND DEBRIS UNLESS OTHERWISE INSTRUCTED BY ENGINEER. EXCAVATE AND REMOVE FROM SITE ANY CONTAMINATED MATERIAL. ALL CONTAMINATED MATERIAL SHALL BE DISPOSED OF AT A LICENSED LANDFILL FACILITY.
  - ALL ELEVATIONS ARE GEODETIC. CITY OF OTTAWA DENOTED AS PART OF LOTS 1554, 1555, 1556, AND 1557, REGISTERED PLAN 38, CITY OF OTTAWA.
  - REFER TO GEOTECHNICAL REPORT (No. PG5744-1, DATED MAY 12TH, 2021), PREPARED BY PATERSON FOR SUBSURFACE CONDITIONS, CONSTRUCTION RECOMMENDATIONS, AND GEOTECHNICAL INSPECTION REQUIREMENTS. THE GEOTECHNICAL CONSULTANT IS TO REVIEW ON-SITE CONDITIONS AFTER EXCAVATION PRIOR TO PLACEMENT OF THE GRANULAR MATERIAL.
  - REFER TO ARCHITECT'S AND LANDSCAPE ARCHITECT'S DRAWINGS FOR BUILDING AND HARDSURFACE AREAS AND DIMENSIONS.
  - REFER TO SERVICEABILITY AND STORMWATER MANAGEMENT REPORT PREPARED BY NOVATECH ENGINEERING CONSULTANTS LTD. R-2021-055 DATED APRIL 21, 2023.
  - SAW CUT AND KEY GRIND ASPHALT AT ALL ROAD CUTS AND ASPHALT TIE IN POINTS AS PER CITY OF OTTAWA STANDARDS (R10).
  - PROVIDE LINE-PARKING PAINTING.
  - ALL MATERIALS AND CONSTRUCTION METHODS SHALL BE IN ACCORDANCE WITH THE CITY OF OTTAWA STANDARDS AND SPECIFICATIONS AND ONTARIO PROVINCIAL STANDARDS AND SPECIFICATIONS. ONTARIO PROVINCIAL STANDARDS AND SPECIFICATIONS WILL APPLY WHERE NO CITY STANDARDS ARE AVAILABLE.
  - ALL PRIVATE APPROACHES MUST BE CONSTRUCTED AS PER CITY SPECIFICATION SC13.
  - ALL EXISTING INFRASTRUCTURE (STORM AND SANITARY NETWORK & MANHOLES) ON-SITE TO BE REMOVED.

- GRADING NOTES:**
- ALL TOPSOIL, ORGANIC OR DELETERIOUS MATERIAL MUST BE ENTIRELY REMOVED FROM BENEATH THE PROPOSED PAVED AREAS AS DIRECTED BY THE SITE ENGINEER OR GEOTECHNICAL ENGINEER.
  - EXPOSED SUBGRADES IN PROPOSED PAVED AREAS SHOULD BE PROOF ROLLED WITH A LARGE STEEL DRUM ROLLER AND INSPECTED BY THE GEOTECHNICAL ENGINEER PRIOR TO THE PLACEMENT OF GRANULARS.
  - ANY SOFT AREAS EVIDENT FROM THE PROOF ROLLING SHOULD BE SUB-EXCAVATED AND REPLACED WITH SUITABLE MATERIAL THAT IS FROST COMPATIBLE WITH THE EXISTING SOILS AS RECOMMENDED BY THE GEOTECHNICAL ENGINEER.
  - THE GRANULAR BASE SHOULD BE COMPACTED TO AT LEAST 100% OF THE STANDARD PROCTOR MAXIMUM DRY DENSITY VALUE. ANY ADDITIONAL GRANULAR FILL USED BELOW THE PROPOSED PAVEMENT SHOULD BE COMPACTED TO AT LEAST 98% OF THE STANDARD PROCTOR MAXIMUM DRY DENSITY VALUE.
  - MINIMUM OF 2% GRADE FOR ALL GRASS AREAS UNLESS OTHERWISE NOTED.
  - MAXIMUM TERRACING GRADE TO BE 3:1 UNLESS OTHERWISE NOTED.
  - ALL GRADES BY CURBS ARE EDGE OF PAVEMENT GRADES UNLESS OTHERWISE INDICATED.
  - ALL CURBS SHALL BE BARRIER CURB (150mm) UNLESS OTHERWISE NOTED AND CONSTRUCTED AS PER CITY OF OTTAWA STANDARDS (SC11).
  - REFER TO LANDSCAPE PLAN FOR PLANTING AND OTHER LANDSCAPE FEATURE DETAILS.
  - CONTRACTOR TO PROVIDE THE CONSULTANT WITH A GRADING PLAN INDICATING AS-BUILT ELEVATIONS OF ALL DESIGN GRADES SHOWN ON THIS PLAN.

NOTE:  
THE POSITION OF ALL POLE LINES, CONDUITS, WATERMANS, SEWERS AND OTHER UNDERGROUND AND OVERGROUND UTILITIES AND STRUCTURES IS NOT NECESSARILY SHOWN ON THE CONTRACT DRAWINGS, AND WHERE SHOWN, THE ACCURACY OF THE POSITION OF SUCH UTILITIES AND STRUCTURES IS NOT GUARANTEED. BEFORE STARTING WORK, DETERMINE THE EXACT LOCATION OF ALL SUCH UTILITIES AND STRUCTURES AND ASSUME ALL LIABILITY FOR DAMAGE TO THEM.

NOT FOR CONSTRUCTION

CLARIDGE HOMES  
CLARIDGE HOMES  
505 PRESTON STREET,  
OTTAWA, ONTARIO  
K1S 4N7.

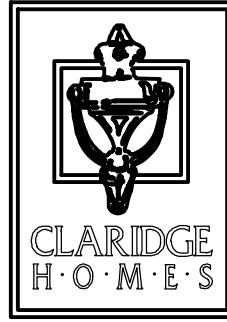

No.	REVISION	DATE	BY
4.	ISSUED FOR ZBA AND SPA	APRIL 21/23	GJM
3.	ISSUED FOR COORDINATION	JUL 13/22	CJF
2.	ISSUED WITH SITE PLAN APPLICATION	APR 15/21	JAG
1.	ISSUED FOR PRELIMINARY COORDINATION	FEB 9/21	JAG

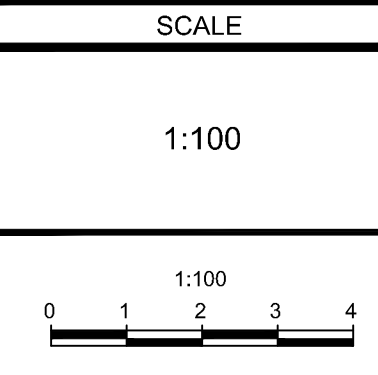

DESIGN	CJF
CHECKED	GJM
DRAWN	CJF
CHECKED	GJM
APPROVED	GJM

FOR REVIEW ONLY

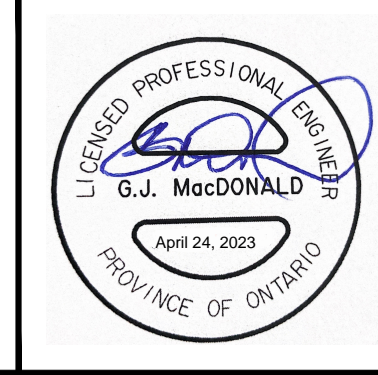

**NOVATECH**  
Engineers, Planners & Landscape Architects  
Suite 200, 240 Michael Cowpland Drive  
Ottawa, Ontario, Canada K2M 1P6  
Telephone (613) 254-9643  
Facsimile (613) 254-5867  
Website www.novatech-eng.com

LOCATION  
CITY OF OTTAWA  
ICON2 - 829 CARLING AVE.  
DRAWING NAME  
GRADING PLAN

PROJECT NO.	121008
REV	REV # 4
DRAWING NO.	121008-GR



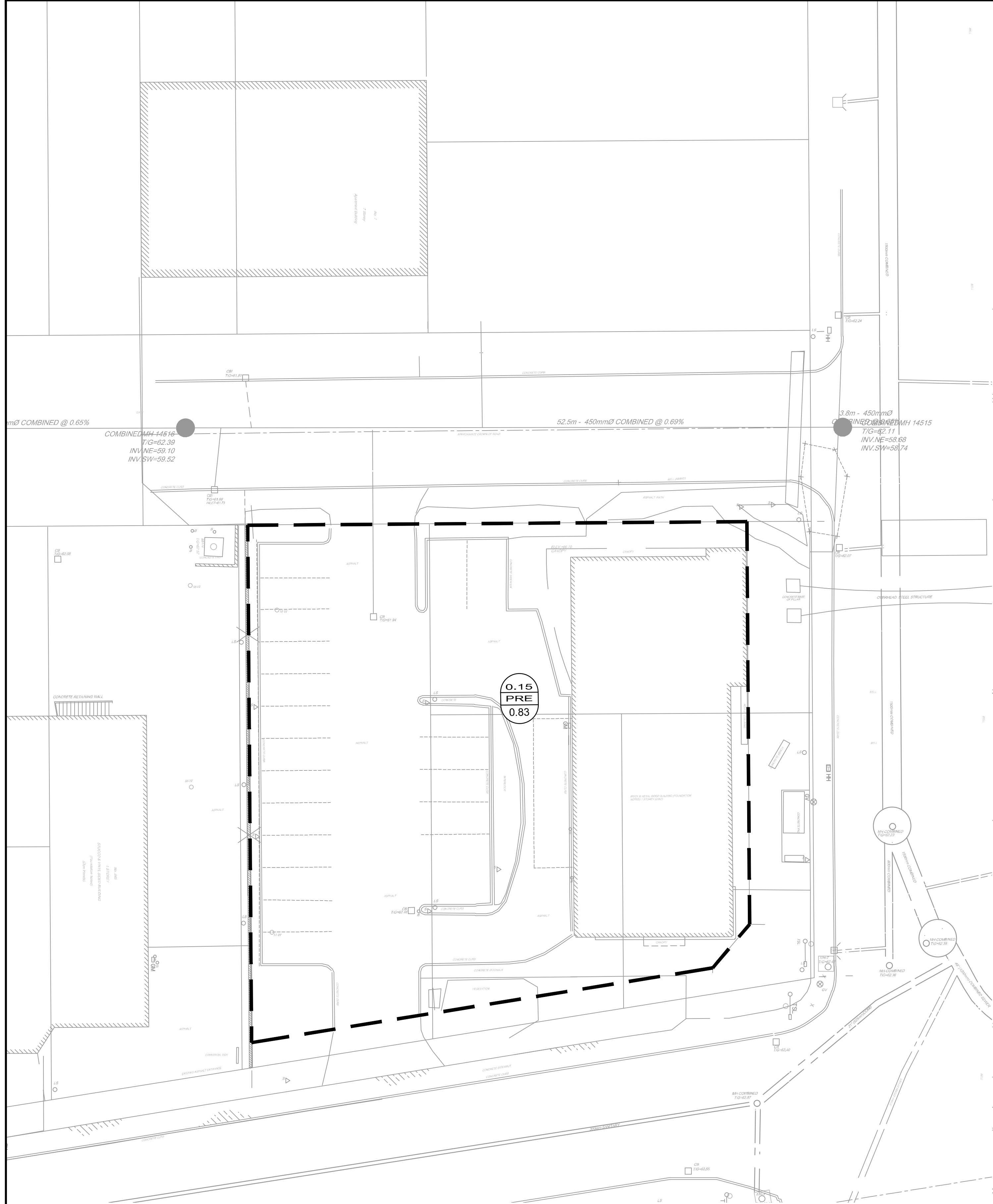

PRE-DEVELOPMENT STORMWATER PLAN

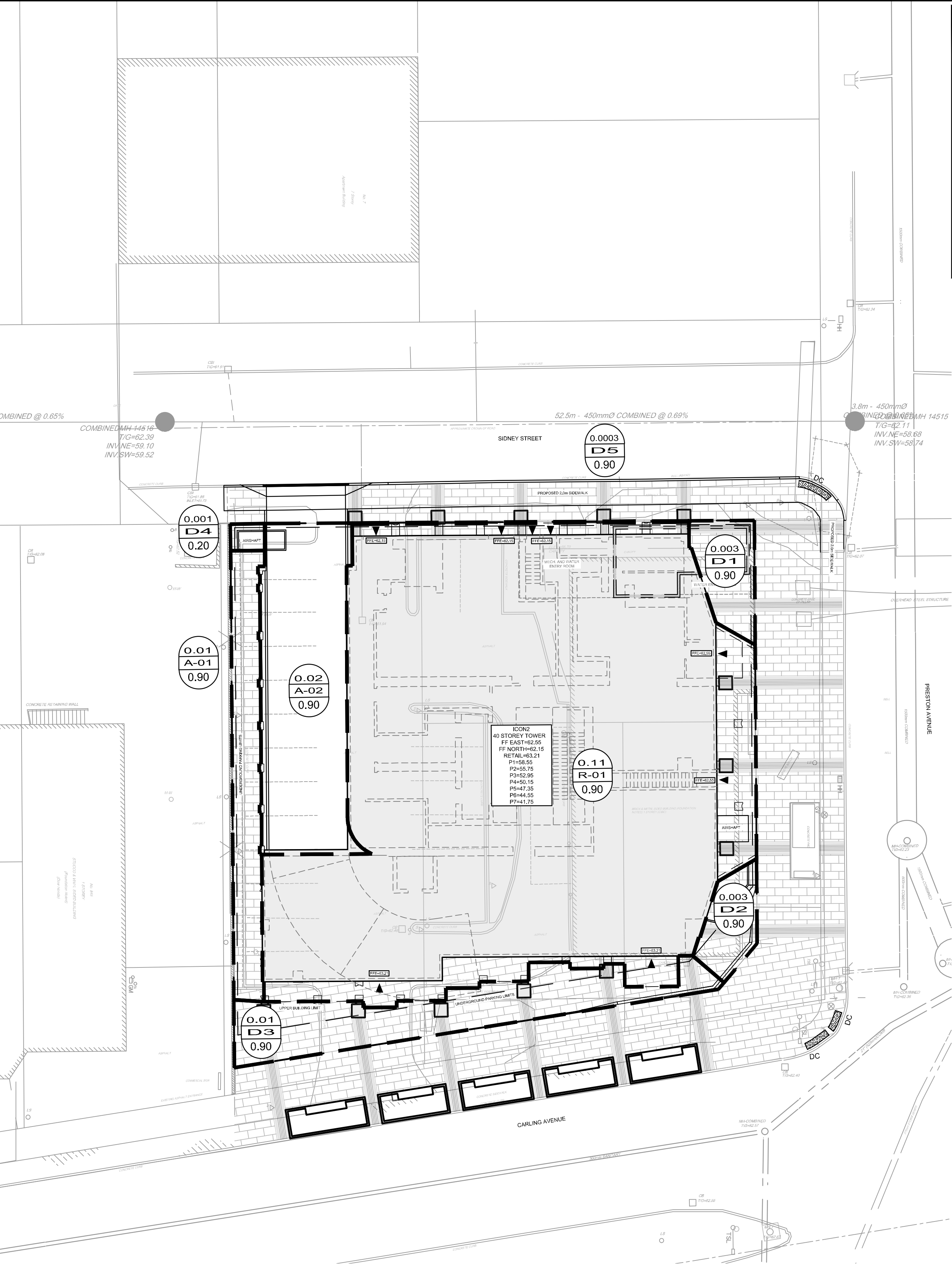

POST-DEVELOPMENT STORMWATER PLAN

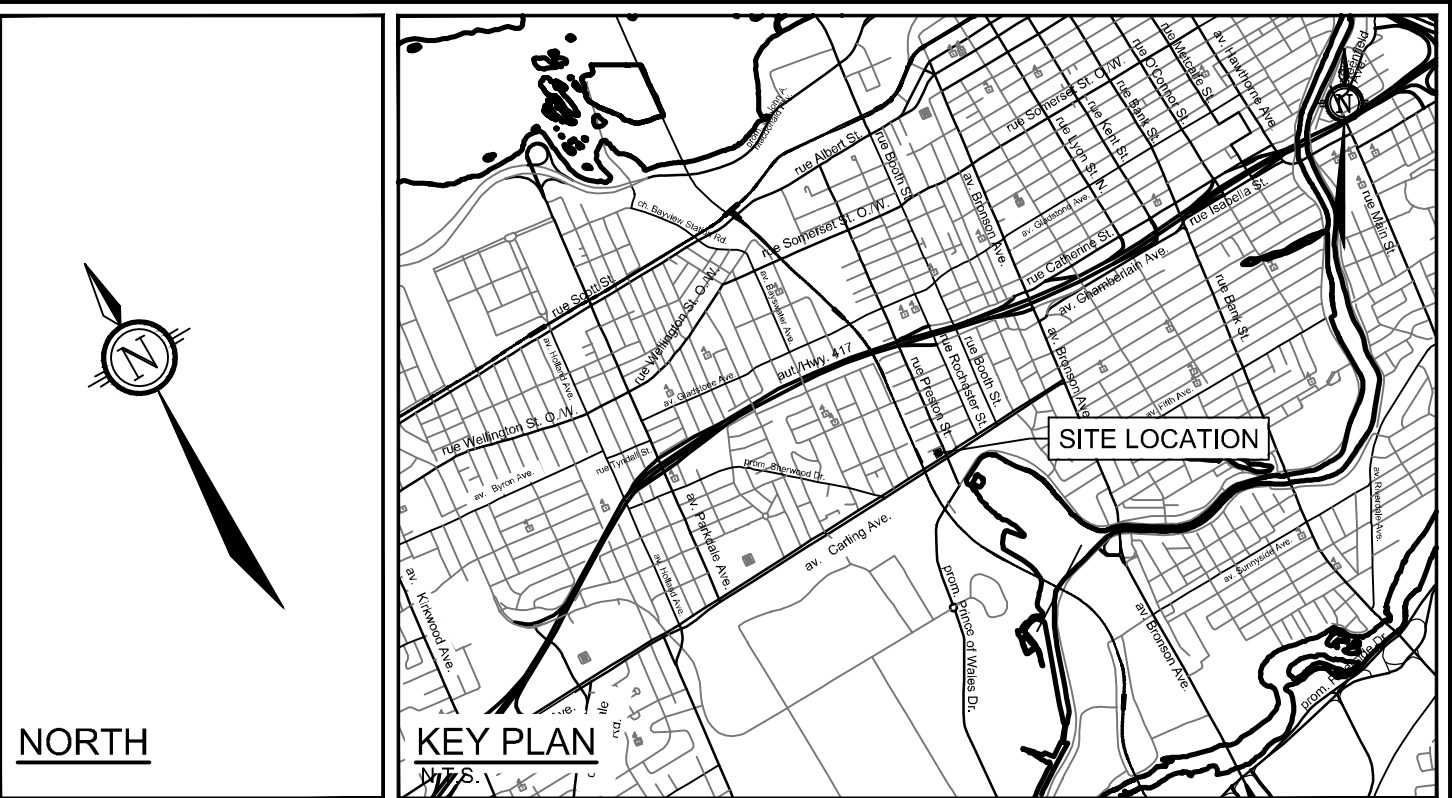

- NOTES
- STORMWATER MANAGEMENT NOTES:
- REFER TO 'SERVICEABILITY AND STORMWATER MANAGEMENT REPORT' PREPARED BY NOVATECH ENGINEERING CONSULTANTS LTD (DATED APRIL, 21 2023)
  - NO ROOF TOP CONTROL ACCOUNTED FOR.

NOTE:  
THE POSITION OF ALL POLE LINES, CONDUITS,  
WATERMANS, SEWERS AND OTHER  
UNDERGROUND AND OVERGROUND UTILITIES AND  
STRUCTURES IS NOT NECESSARILY SHOWN ON  
THE CONTRACT DRAWINGS, AND WHERE SHOWN,  
THE ACCURACY OF THE POSITION OF SUCH  
UTILITIES AND STRUCTURES IS NOT GUARANTEED.  
BEFORE STARTING WORK, DETERMINE THE EXACT  
LOCATION OF ALL SUCH UTILITIES AND  
STRUCTURES AND ASSUME ALL LIABILITY FOR  
DAMAGE TO THEM.

CLARIDGE HOMES  
CLARIDGE HOMES  
SUITE 2001,  
210 GLADSTONE AVENUE,  
OTTAWA, ONTARIO  
K2P 0Y6.

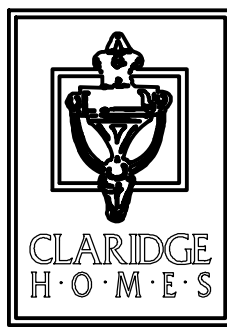

No.	REVISION	DATE	BY
3.	ISSUED FOR ZBA AND SPA	APRIL21/23	GJM
2.	ISSUED FOR COORDINATION	JUL13/22	CJF
1.	ISSUED WITH SITE PLAN APPLICATION	APR15/21	GJM

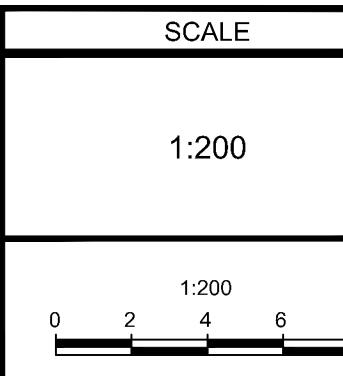

DESIGN	CJF
CHECKED	GJM
DRAWN	CJF
CHECKED	GJM
APPROVED	GJM

FOR REVIEW ONLY

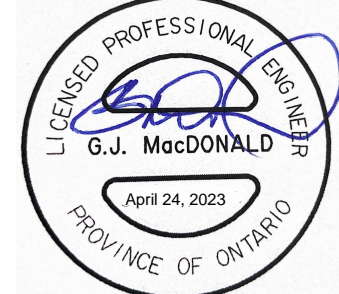

**NOVATECH**  
Engineers, Planners & Landscape Architects  
Suite 200, 240 Michael Cowpland Drive  
Ottawa, Ontario, Canada K2M 1P6  
Telephone (613) 254-9643  
Facsimile (613) 254-5867  
Website www.novatech-eng.com

LOCATION  
CITY OF OTTAWA  
ICON2 - 829 CARLING AVE.  
DRAWING NAME  
STORMWATER MANAGEMENT  
PLAN

PROJECT No.	121008
REV	REV # 3
DRAWING No.	121008-STM



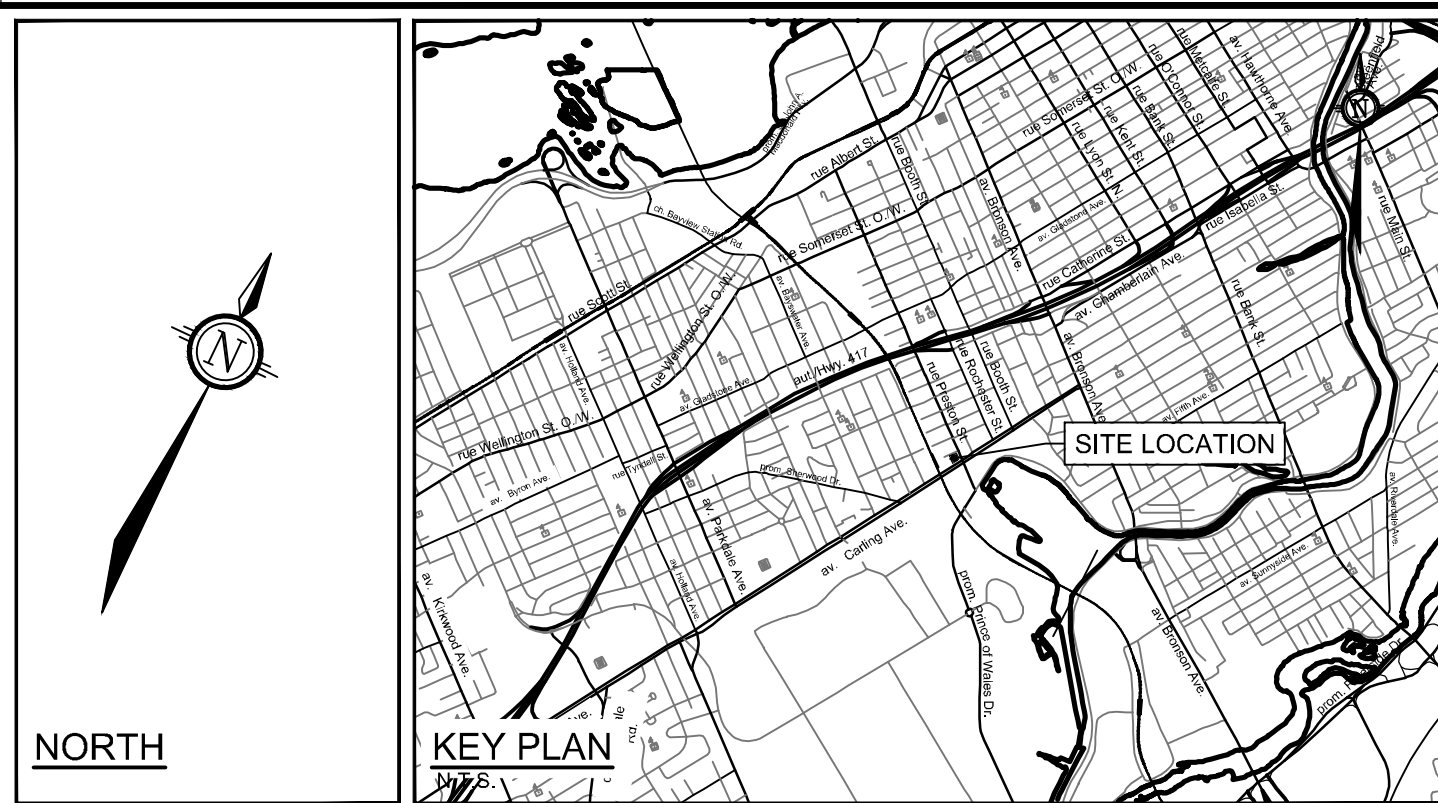
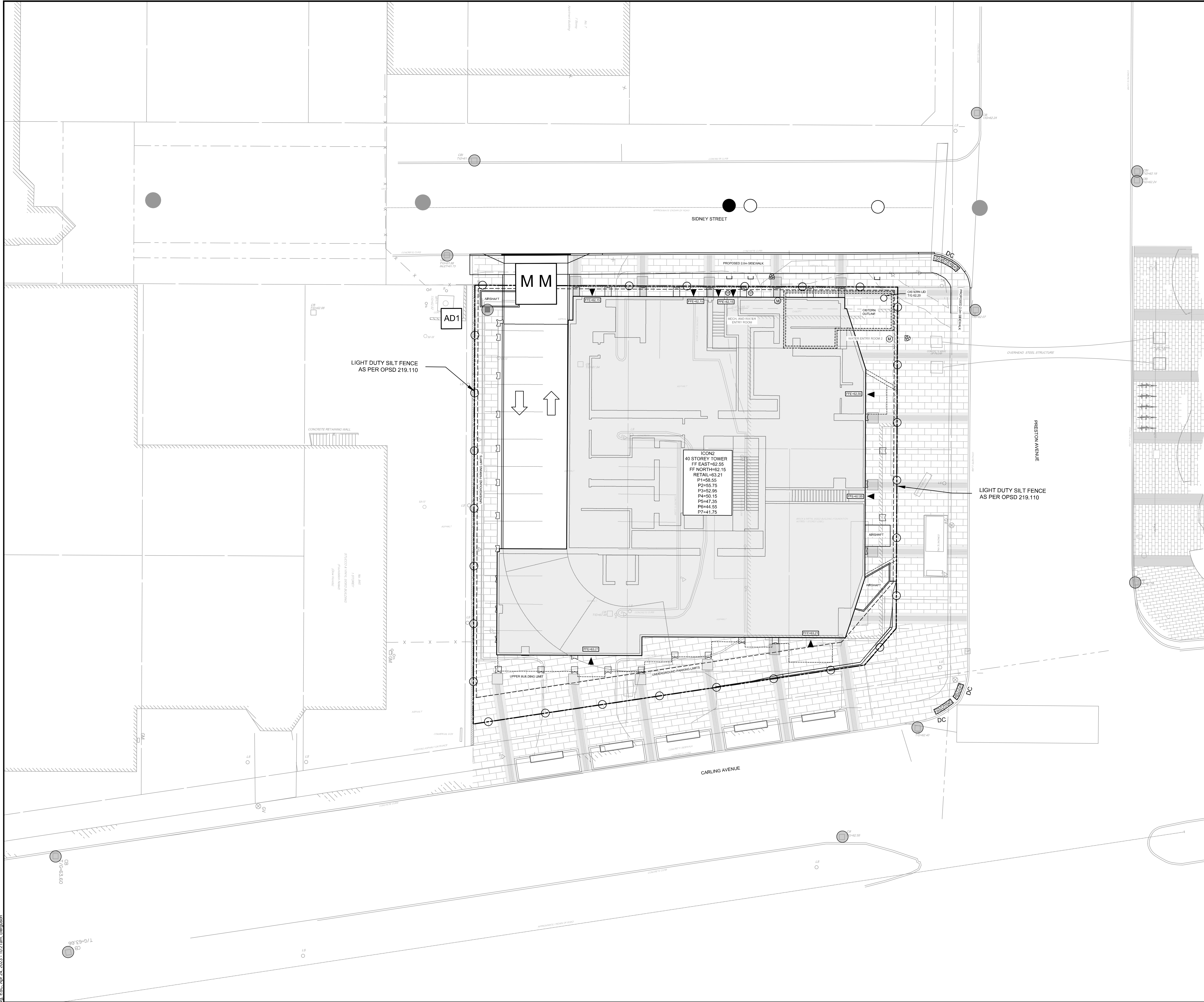

- LEGEND**
- PROPERTY LINE
  - PROPOSED CURB
  - PROPOSED DEPRESSED CURB
  - TACTILE WALKING SURFACE INDICATOR (TWSI) PER CITY DETAIL SCT. 3
  - PROPOSED MUD MAT
  - LIGHT DUTY SILT FENCE (OPSD 219.110)
  - PROPOSED FILTER BAGS AT CATCHBASINS, CATCHBASIN MANHOLES AND TRENCHDRAINS
  - PROPOSED CAP
  - PROPOSED STORM SEWER AND MANHOLE
  - PROPOSED AREA DRAIN
  - PROPOSED TRENCH DRAIN
  - PROPOSED BUILDING ENTRANCE
  - EXISTING STORM MANHOLE
  - EXISTING CATCHBASIN
  - EXISTING LIGHT STANDARD
  - EXISTING FENCE

**EROSION AND SEDIMENT CONTROL NOTES:**

- THE CONTRACTOR SHALL IMPLEMENT BEST MANAGEMENT PRACTICES, TO PROVIDE FOR PROTECTION OF THE AREA DRAINAGE SYSTEM AND THE RECEIVING WATERCOURSE, DURING CONSTRUCTION ACTIVITIES. THE CONTRACTOR ACKNOWLEDGES THAT FAILURE TO IMPLEMENT APPROPRIATE EROSION AND SEDIMENT CONTROL MEASURES MAY BE SUBJECT TO PENALTIES IMPOSED BY ANY APPLICABLE REGULATORY AGENCY.
- 1) THE OWNER AGREES TO PREPARE AND IMPLEMENT AN EROSION AND SEDIMENT CONTROL PLAN TO THE SATISFACTION OF THE CITY OF OTTAWA, APPROPRIATE TO THE SITE CONDITIONS, PRIOR TO UNDERTAKING ANY SITE ALTERATIONS (FILLING, GRADING, REMOVAL OF VEGETATION, ETC.) AND DURING ALL PHASES OF SITE PREPARATION AND CONSTRUCTION IN ACCORDANCE WITH THE CURRENT BEST MANAGEMENT PRACTICES FOR EROSION AND SEDIMENT CONTROL, SUCH AS BUT NOT LIMITED TO INSTALLING FILTER CLOTHS ACROSS MANHOLE/CATCHBASIN LIDS TO PREVENT SEDIMENTS FROM ENTERING STRUCTURES AND INSTALL AND MAINTAIN A LIGHT DUTY SILT FENCE BARRIER AS REQUIRED.
  - 2) THE CONTRACTOR SHALL PLACE FILTER BAGS UNDER THE CATCHBASIN AND MANHOLE GRATES FOR THE DURATION OF CONSTRUCTION AND WILL REMAIN IN PLACE DURING ALL PHASES OF CONSTRUCTION
  - 3) SILT FENCING FOR ENTIRE PERIMETER OF SITE, SHALL BE UTILIZED TO CONTROL EROSION FROM THE SITE DURING CONSTRUCTION.
  - 4) THE CONTRACTOR ACKNOWLEDGES THAT FAILURE TO IMPLEMENT EROSION AND SEDIMENT CONTROL MEASURES MAY BE SUBJECT TO PENALTIES IMPOSED BY ANY APPLICABLE REGULATORY AGENCY.
  - 5) PROVIDE MUD MATS AT ALL CONSTRUCTION ACCESS POINTS TO MINIMIZE SEDIMENT TRANSPORT OFFSITE.
  - 6) EROSION AND SEDIMENT CONTROL MEASURES MAY BE MODIFIED IN THE FIELD AT THE DISCRETION OF THE CITY OF OTTAWA SITE INSPECTOR OR CONSERVATION AUTHORITY.

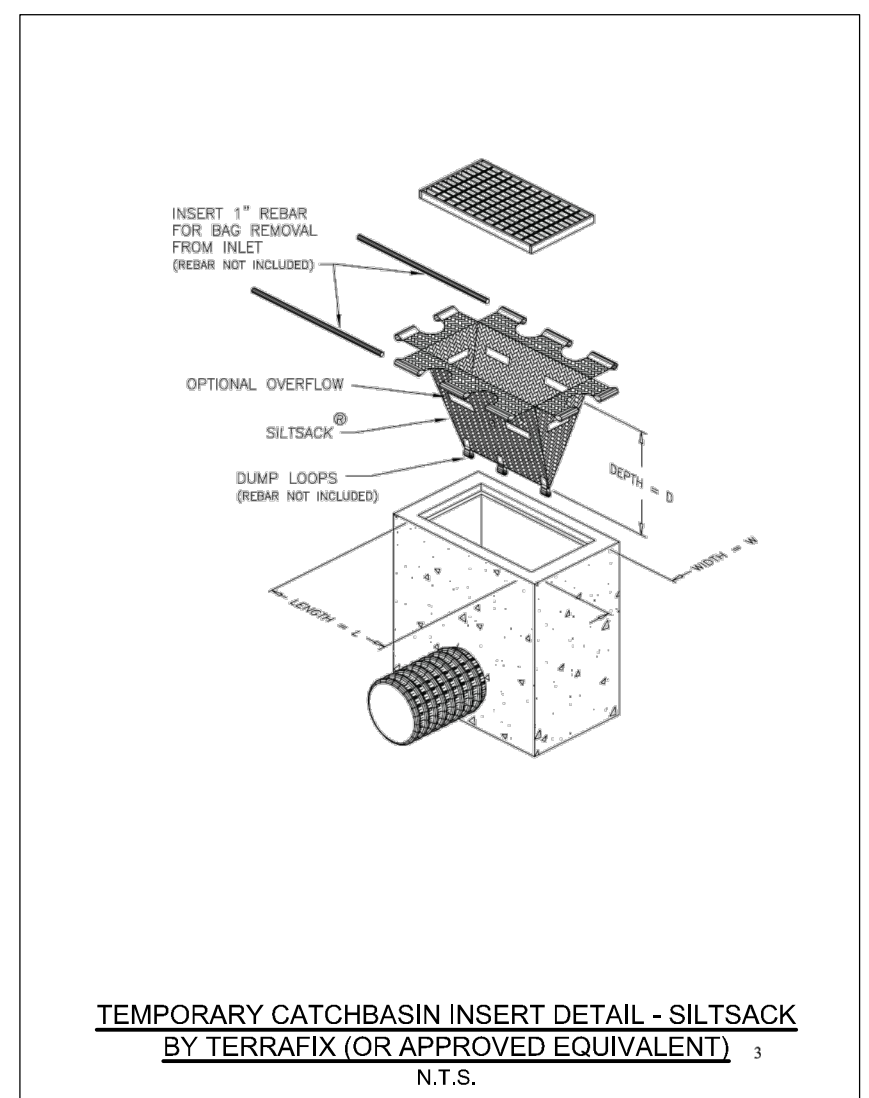
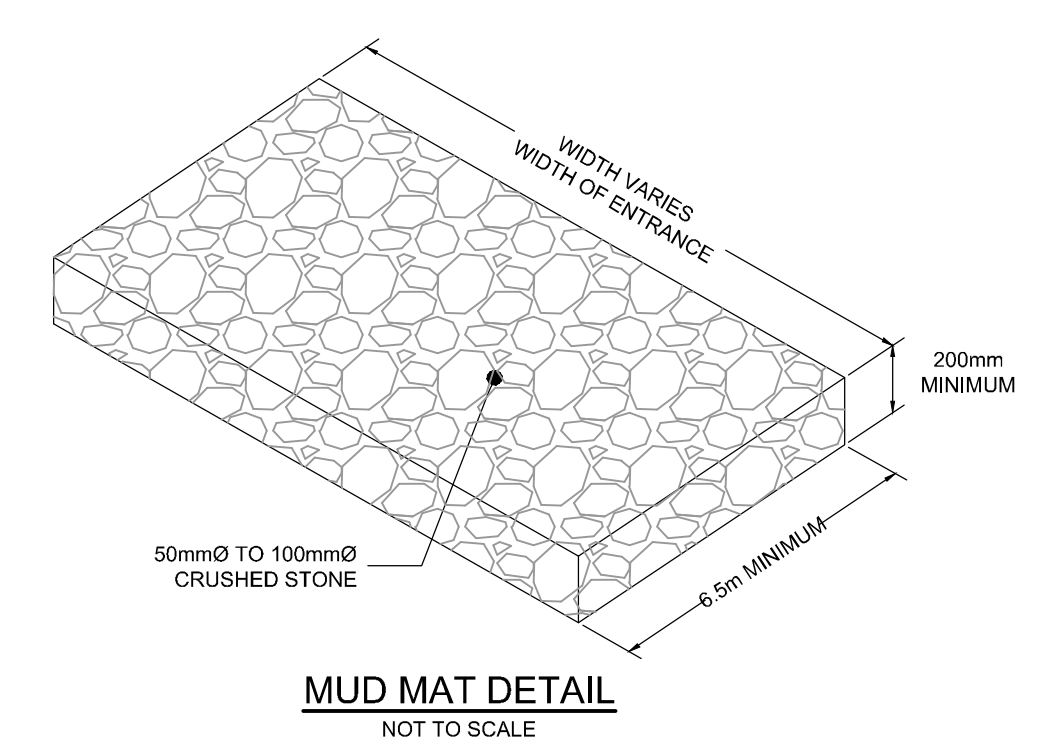

NOTE:  
THE POSITION OF ALL POLE LINES, CONDUITS, WATERMAINS, SEWERS AND OTHER UNDERGROUND AND OVERGROUND UTILITIES AND STRUCTURES IS NOT NECESSARILY SHOWN ON THE CONTRACT DRAWINGS, AND WHERE SHOWN, THE ACCURACY OF THE POSITION OF SUCH UTILITIES AND STRUCTURES IS NOT GUARANTEED. BEFORE STARTING WORK, DETERMINE THE EXACT LOCATION OF ALL SUCH UTILITIES AND STRUCTURES AND ASSUME ALL LIABILITY FOR DAMAGE TO THEM.

**CLARIDGE HOMES**  
CLARIDGE HOMES  
505 PRESTON STREET,  
OTTAWA, ONTARIO  
K1S 4N7.



No.	REVISION	DATE	BY
1.	ISSUED FOR ZBA AND SPA	APRIL 21/23	GJM

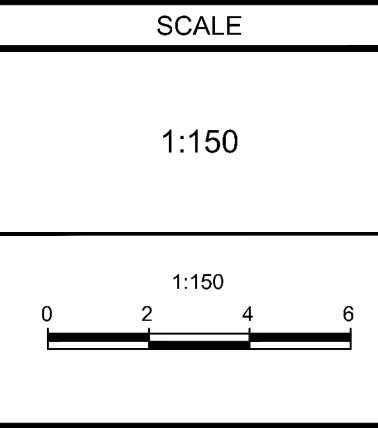

DESIGN	CJF
CHECKED	GJM
DRAWN	CJF
CHECKED	GJM
APPROVED	GJM

**FOR REVIEW ONLY**

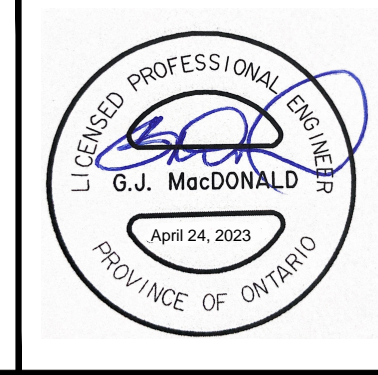

**NOVATECH**  
Engineers, Planners & Landscape Architects  
Suite 200, 240 Michael Cowpland Drive  
Ottawa, Ontario, Canada K2M 1P6  
Telephone: (613) 254-9643  
Facsimile: (613) 254-5867  
Website: www.novatech-eng.com

LOCATION  
CITY OF OTTAWA  
ICON2 - 829 CARLING AVE.  
DRAWING NAME  
**EROSION AND SEDIMENT  
CONTROL PLAN**

PROJECT No.	121008
REV	REV # 1
DRAWING No.	121008-ESC



