

- ### GENERAL NOTES
- EXTENT OF CONTRACT IS LIMITED TO WITHIN PROPERTY EXCEPT WHERE SHOWN OTHERWISE.
 - ALL WORK OUTSIDE PROPERTY LINE TO BE CONSTRUCTED TO CITY OF OTTAWA CONSTRUCTION STANDARDS.
 - IT IS THE RESPONSIBILITY OF THE APPROPRIATE CONTRACTOR OR OFFICIAL TO REPORT ANY ERRORS, OMISSIONS OR DISCREPANCIES ON THIS PLAN WITH ACTUAL SITE CONDITIONS TO THE LANDSCAPE ARCHITECT BEFORE PROCEEDING WITH CONSTRUCTION.
 - THE CONTRACTOR IS TO NOTIFY ALL UTILITY COMPANIES AND AUTHORITIES PRIOR TO ANY EXCAVATION AND ASCERTAIN LOCATIONS OF UNDERGROUND SERVICES.
 - THE CONTRACTOR IS TO RENOVATE ALL AREAS AND ITEMS DAMAGED AS A RESULT OF CONSTRUCTION ACTIVITY.
 - THE CONTRACTOR IS TO COMPLY WITH ALL PERTINENT CODES AND BY-LAWS.
 - THE CONTRACTOR IS TO MAINTAIN A POSITIVE SURFACE RUN-OFF THROUGHOUT THE ENTIRE CONSTRUCTION PERIOD.
 - THE LANDSCAPE ARCHITECT IS NOT RESPONSIBLE FOR SUBSURFACE CONDITIONS.
 - THE CONTRACTOR IS TO IDENTIFY ALL EXISTING TREES TO REMAIN ON SITE WITH THE LANDSCAPE ARCHITECT PRIOR TO CONSTRUCTION.
 - THE CONTRACTOR IS TO STAKE THE PROPOSED LOCATION OF ALL PLANT MATERIAL IN CONJUNCTION WITH THE LANDSCAPE ARCHITECT PRIOR TO EXCAVATION.
 - MINIMUM DISTANCES FOR SELECTED DECIDUOUS TREES ARE AS FOLLOWS:
 - 11.1. BUILDING FOUNDATIONS - 7.5M
 - 11.2. SIDEWALKS - 1.5M
 - 11.3. PUBLIC STREETS - 2.5M
 - 11.4. UNDERGROUND INFRASTRUCTURE - 3.0M
 - ALL TREES WITHIN 1M OF UNDERGROUND UTILITY TRENCHES ARE TO BE EXCAVATED BY HAND.
 - REMOVE ALL PROTECTIVE WRAPPING FROM TREE TRUNKS AFTER INSTALLATION.
 - STAKING OF TREES SHALL ONLY BE PERFORMED IF NECESSARY.
 - ENSURE THAT MULCH IS PULLED BACK A MINIMUM DISTANCE OF 75MM FROM BASE OF TREE TRUNK.

- ### LEGEND
- BARRETT FREE PARKING BUILDING ENTRANCE/EXIT
 - EXISTING BOLLARD TO REMAIN
 - EXISTING CURB
 - EXISTING DEPRESSED CURB
 - EXISTING SEMI-MOUNTABLE DEPRESSED CURB
 - EXISTING CHAIN LINK FENCE TO REMAIN
 - TO BE DEMOLISHED / REMOVED
 - ROAD CENTER LINE
 - FIRE ROUTE
 - SET BACK LINE
 - PROPERTY LOT LINE
 - EXISTING FIRE ROUTE SIGN TO REMAIN
 - EXISTING HANDICAPPED PARKING SIGN TO REMAIN
 - EXISTING DROP-OFF SIGN TO REMAIN
 - EXISTING ONE WAY SIGN TO REMAIN
 - EXISTING NO ENTRY SIGN TO REMAIN
 - EXISTING NO PARKING SIGN
 - EXISTING LOADING AREA SIGN TO REMAIN
 - EXISTING MISC. TRAFFIC SIGN TO REMAIN
 - EXISTING LIGHT STANDARD TO REMAIN
 - EXISTING IRON BAR (REFER TO SURVEY)
 - EXISTING FIRE DEPARTMENT CONNECTION TO REMAIN
 - EXISTING FIRE HYDRANT TO REMAIN
 - EXISTING MAN HOLE TO REMAIN
 - EXISTING CATCH BASIN TO REMAIN
 - EXISTING FLAG POLE TO REMAIN
 - NEW BOLLARD
 - NEW CURB
 - NEW DEPRESSED CURB
 - NEW MAN HOLE (REFER TO CIVIL)
 - NEW CATCH BASIN (REFER TO CIVIL)

- ### LEGEND
- EXISTING UNIT PAVERS TO REMAIN
 - EXISTING UNIT PAVERS WITH HEAVY DUTY GRANULAR BASE TO REMAIN
 - EXISTING HEAVY DUTY ASPHALT PAVING TO REMAIN
 - EXISTING LIGHT DUTY ASPHALT PAVING TO REMAIN
 - EXISTING CONCRETE WALK TO REMAIN
 - EXISTING CRUSHED STONE PATHWAY TO REMAIN
 - EXISTING MULCH TO REMAIN
 - EXISTING ARMOUR STONE RETAINING WALL
 - NEW TYPE 1 ASPHALT - HEAVY DUTY (REFER TO SPEC.)
 - NEW TYPE 2 ASPHALT - LIGHT DUTY (REFER TO SPEC.)
 - NEW CONCRETE WALK
 - NEW CRUSHED STONE PATHWAY
 - EXISTING GRASS TO REMAIN
 - PROPOSED GRASS
 - EXISTING TREES TO REMAIN (OUTSIDE LIMIT OF WORK)
 - EXISTING TREE TO BE REMOVED
 - LIMIT OF WORK
 - PROPOSED DECIDUOUS TREE

- ### DRAWING NOTES
- EXISTING PORTABLES
 - EXISTING PRECAST CONCRETE SHED
 - EXISTING GARBAGE ENCLOSURE
 - EXISTING TRANSFORMER

EXISTING TREE LIST

KEY	QTY	BOTANICAL NAME	COMMON NAME	SIZE	CONDITION	REMARKS	OWNERSHIP
CONFIRMED TREES							
PG	1	Picea glauca	White Spruce	150mm DBH	Good	To Be Removed	4000 Labelle Street

PROPOSED TREE LIST

KEY	QTY	BOTANICAL NAME	COMMON NAME	SIZE	CONDITION	SPACING
CONFIRMED TREES						
HL	3	Gleditsia triacanthos	Honey Locust	60mm cal.	BAB	
JL	1	Syringa reticulata	Japanese Tree Lilac	60mm cal.	BAB	
RM	1	Acer rubrum	Red Maple	60mm cal.	BAB	

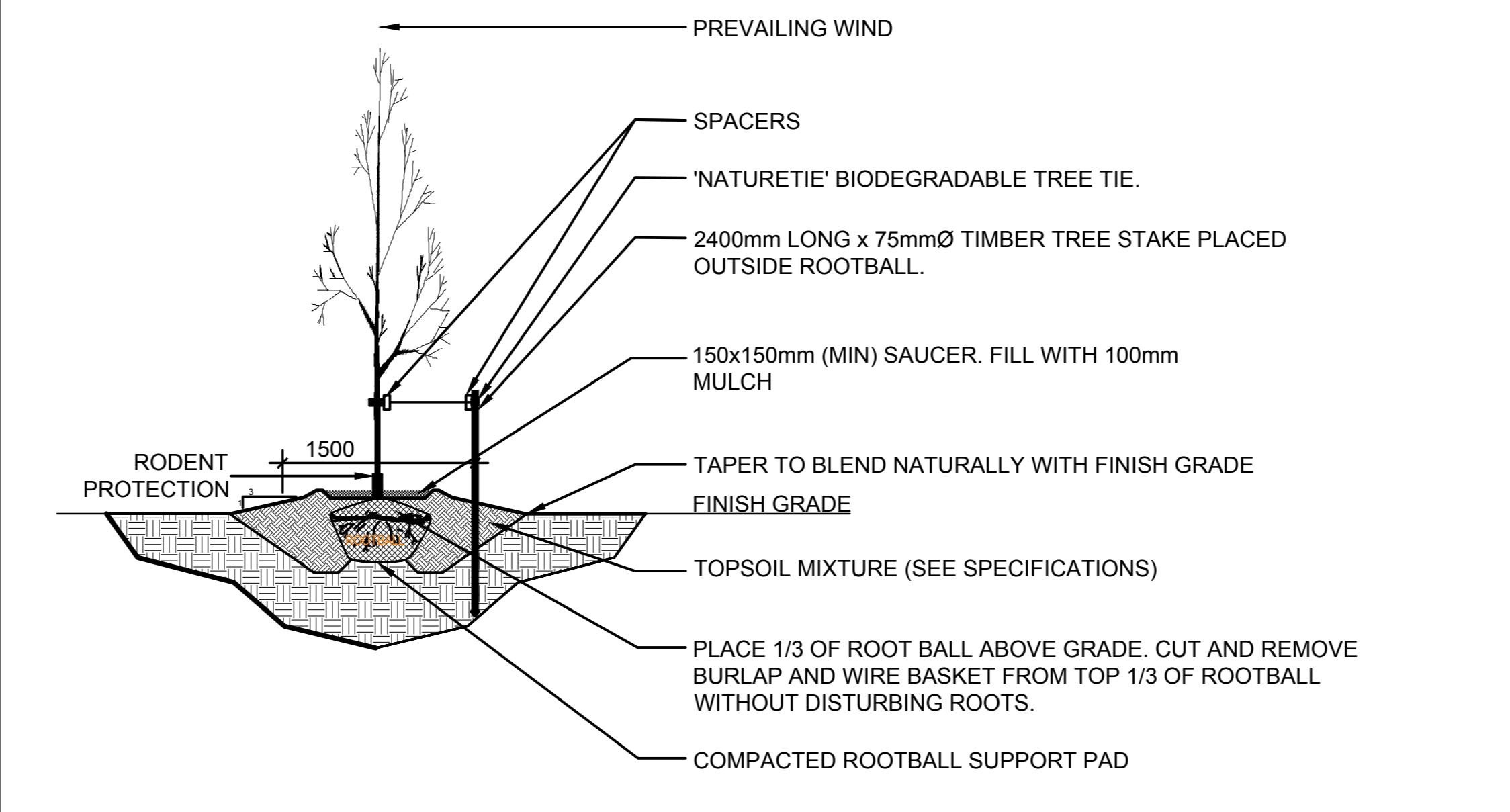

2 DECIDUOUS TREE PLANTING
L.1 NTS

REV	DATE	ISSUED FOR	BY
2	2022/04/24	REVISED AS PER CITY COMMENTS	
1	0	ISSUED FOR SITE PLAN CONTROL	

LES IDÉES, CONCEPTS, DISPOSITIONS ET PLANS MONTRÉS OU REPRÉSENTÉS PAR CE Dessin APPARTIENNENT À EDWARD J. CUHACI AND ASSOCIATES ARCHITECTS INC. ET ONT ÉTÉ CRÉÉS, ET DÉVELOPPÉS POUR ÊTRE UTILISÉS DANS LE CADRE DU PRÉSENT PROJET. ILS NE DOIVENT PAS ÊTRE UTILISÉS À D'AUTRES FINS NI COMMUNIQUÉS À QUI QUE CE SOIT SANS LA PERMISSION ÉCRITE DE EDWARD J. CUHACI AND ASSOCIATES ARCHITECTS INC.

L'ARCHITECTE DÉCLINE TOUTE RESPONSABILITÉ DÉCOULANT DE PROBLÈMES FAISANT SUITE AU NON RESPECT DES PLANS ET DEVIS OU DE L'INTENTION DU CONCEPT QU'ILS TRANSMETTENT, OU DE TOUTS PROBLÈMES POUVANT RÉSULTER DU DÉFAUT DE TIERS D'OBTENIR OU DE SUIVRE LES INSTRUCTIONS DE L'ARCHITECTE RELATIVEMENT AUX ERREURS, OMISSIONS, INCOHÉRENCES, AMBIGUITÉS OU CONTRADICTIONS ALLÉGUÉES.

L'ENTREPRENEUR DOIT VÉRIFIER TOUTES LES DIMENSIONS SUR PLACE ET INFORMER L'ARCHITECTE DE TOUT ÉCART AVANT LE DÉBUT DES TRAVAUX. NE PAS MESURER LES DESSINS À L'ÉCHELLE.

ALL IDEAS, DESIGNS, ARRANGEMENTS, AND PLANS INDICATED OR REPRESENTED BY THIS DRAWING ARE OWNED BY AND THE PROPERTY OF EDWARD J. CUHACI AND ASSOCIATES INC. AND WERE CREATED, DEVELOPED, AND DEVELOPED FOR USE ON AND IN CONNECTION WITH THE SPECIFIED PROJECT. NONE OF THE IDEAS, DESIGNS, ARRANGEMENTS OR PLANS SHALL BE USED BY OR DISCLOSED TO ANY PERSON, FIRM, OR CORPORATION FOR ANY PURPOSE WHATSOEVER WITHOUT THE WRITTEN PERMISSION OF EDWARD J. CUHACI AND ASSOCIATES INC.

THE ARCHITECT WAIVES ANY AND ALL RESPONSIBILITY AND LIABILITY FOR PROBLEMS WHICH ARISE FROM FAILURE TO FOLLOW THESE PLANS, SPECIFICATIONS, AND THE DESIGN INTENT THEY CONVEY, OR FOR PROBLEMS WHICH ARISE FROM OTHER FAILURE TO OBTAIN AND/OR FOLLOW THE ARCHITECT'S GUIDANCE WITH RESPECT TO ANY ERRORS, OMISSIONS, INCONSISTENCIES, AMBIGUITIES OR CONFLICTS WHICH ARE ALLEGED.

CONTRACTOR TO VERIFY ALL DIMENSIONS AND NOTIFY THE ARCHITECT OF ANY DISCREPANCIES BEFORE WORK COMMENCES. DO NOT SCALE DRAWINGS

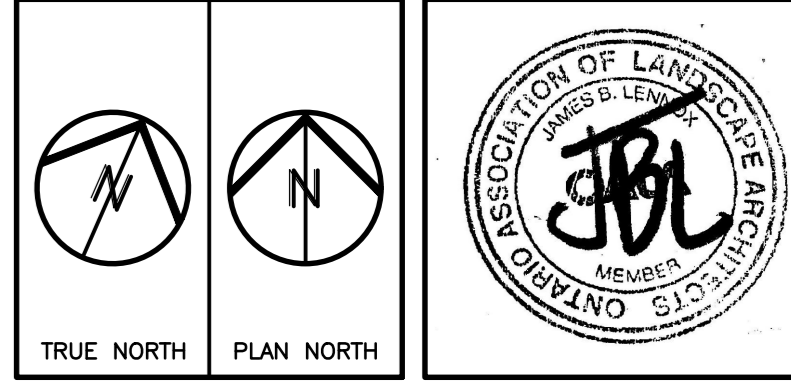

JAMES B. LENNOX & ASSOCIATES INC.
LANDSCAPE ARCHITECTS
 333 CABELLING AVE. OTTAWA, ONTARIO K1H 5A5
 Tel: (613) 722-5168 Fax: (1866) 345-2942

PROJECT TITLE/TITRE DU PROJET
COLLÈGE CATHOLIQUE
 6401 RENAUD ROAD
 OTTAWA, ONTARIO, K1W 0H8
 CE/COE
 4000 LABELLE STREET
 OTTAWA, ONTARIO, K1J 1A1
 DRAWING TITLE/TITRE DU DESSIN
TREE CONSERVATION REPORT & LANDSCAPE PLAN

SCALE	AS SHOWN	PROJ. NO.	ISSUE NO.	REV. NO.
ÉCHELLE	AS SHOWN	25EJCC211	1	---
DRAWN BY	WF	DRAWING/DESIGN		
CHECKED BY	JL			
DATE	2022	ACAD FILE/FICHE		