

LAYOUT NOTES:

- CONTRACTOR TO CONFIRM ALL DIMENSIONS AND REPORT ANY DISCREPANCIES TO CONTRACTOR ADMINISTRATOR PRIOR TO CONSTRUCTION
- LAYOUT TO BE APPROVED BY CONTRACT ADMINISTRATOR PRIOR TO ANY CONSTRUCTION OR REMOVALS
- ALL DIMENSIONS ARE IN METRIC UNLESS OTHERWISE NOTED
- CONTRACTOR IS RESPONSIBLE FOR ALL EXCAVATIONS, REMOVALS, DISPOSALS AND ROUGH GRADING AS REQUIRED TO CONSTRUCTION ALL WORKS AS SHOWN ON ALL PLANS, DETAILS AND SPECIFICATIONS
- LOCATION OF ALL UTILITIES SHOWN FOR ILLUSTRATION ONLY. CONTRACTOR MUST CONTACT ALL UTILITIES REGARDING RULES FOR WORKING IN THE AREA OF THE UTILITIES PRIOR TO COMMENCEMENT OF ANY WORK. CONTRACTOR MUST CONFIRM LOCATION OF ALL UTILITIES PRIOR TO CONSTRUCTION
- ALL EXISTING ROADS, SIDEWALKS, CURBS, FENCING, PAVING, SODDED AREAS, AND APPROACHES, ETC. TO REMAIN TO BE PROTECTED DURING CONSTRUCTION TO CONTRACT ADMINISTRATOR'S APPROVAL AT THE CONTRACTOR'S OWN COSTS.
- ALL EXISTING TREES, SHRUB BEDS, MULCH BEDS, AND SOD TO REMAIN TO BE PROTECTED DURING CONSTRUCTION. AREAS DAMAGED DURING CONSTRUCTION TO BE REPAIRED TO CONTRACT ADMINISTRATOR'S APPROVAL AT THE CONTRACTOR'S OWN COST.
- USE SPECIFIED BACKFILL IN ALL TRENCHES RUNNING BELOW ALL STRUCTURES, PAVING, WALKWAYS, ETC.
- FILL ALL HOLES AND LOW AREAS TO DESIGN SUBGRADE WITH COMPACTED FILL (SUITABLE TO SURFACE FINISH), FOR SODDED/PLANTED AREAS USE COMPACTED CLEAN EARTH FILL SUITABLE FOR PLANT GROWTH. FOR PAVED AREAS USE COMPACTED GRANULAR BASE.
- ALL TREES WITHIN OR IMMEDIATELY ADJACENT TO AREA OF WORK TO BE PROTECTED TO CITY OF OTTAWA TREE PROTECTION STANDARDS.

LEGEND:

- TOPSOIL AND SOD
- PLANT BED
- CONCRETE SIDEWALK
- HEAVY DUTY ASPHALT PAVEMENT
- LIGHT DUTY ASPHALT PAVEMENT
- PAINTED LINES
- SNOW REMOVAL AREA
- TOPSOIL AND NATIVE GRASS SEED MIX
- TOPSOIL AND DEEP ROOTING GRASS SEED MIX
- TOPSOIL AND POLLINATOR SEED MIX
- 3/4" RIVER STONE MULCH
- 2-4" RIVER STONE MULCH
- PROPERTY LINE
- EASEMENT LINE
- BUILDING OVERHANG
- EXISTING CHAINLINK FENCE
- APPROXIMATE AREA OF WORK
- EXISTING CURB
- NEW CURB
- ACCESSIBLE PARKING STALL
- PROPOSED DECIDUOUS TREE
- PROPOSED CONIFEROUS TREE
- PROPOSED DECIDUOUS SHRUB
- PROPOSED CONIFEROUS SHRUB
- EXISTING TREE TO REMAIN. TREES TO REMAIN ARE TO BE PROTECTED TO CITY OF OTTAWA STANDARDS
- EXISTING TREE TO BE REMOVED
- PLANT KEY
  - # - PLANT QUANTITY
  - Ps - PLANT SPECIES

KEYNOTES:

- EXISTING TREE TO REMAIN
- EXISTING TREE TO BE REMOVED
- SODDED AREA. REFER TO DETAIL 6/L300
- SEEDED AREA. REFER TO DETAIL 6/L300

PLANTING NOTES:

- LOCATION OF ALL PLANTS MATERIAL TO BE MARKED OUT ON SITE AND APPROVED BY CONTRACT ADMINISTRATOR PRIOR TO PLANTING
- TREE SPACING, UNLESS OTHERWISE NOTED:
  - DECIDUOUS TREES: 6.0m MIN.
  - CONIFEROUS TREES: 3.0m MIN.
- SHRUB SPACING, UNLESS OTHERWISE NOTED:
  - SMALL DECIDUOUS: 600mm O.C.
  - LARGE DECIDUOUS: 900mm O.C.
  - CONIFEROUS: 750mm O.C.
  - GRASSES: 450mm O.C.
- ALL PLANT MATERIAL TO BE BEST QUALITY, REVIEWED ON SITE BY LANDSCAPE ARCHITECT PRIOR TO PLANTING. UNACCEPTABLE PLANTS TO BE REPLACED AND NEW PLANTS APPROVED PRIOR TO PLANTING. REPLACEMENTS ARE AT CONTRACTOR'S OWN COST.
- ALL PLANTING EXCAVATIONS ARE TO BE REVIEWED AND APPROVED BY LANDSCAPE ARCHITECT PRIOR TO PLACEMENT OF DRAINAGE COURSE, FILTER FABRIC AND/OR SOIL.
- SHRUB BEDS AT PARKING AREA TO HAVE PLANTS SET BACK SO THAT THERE IS A 450mm WIDE MULCH EDGE CURB WITH FULL GROWTH OF PLANTS.

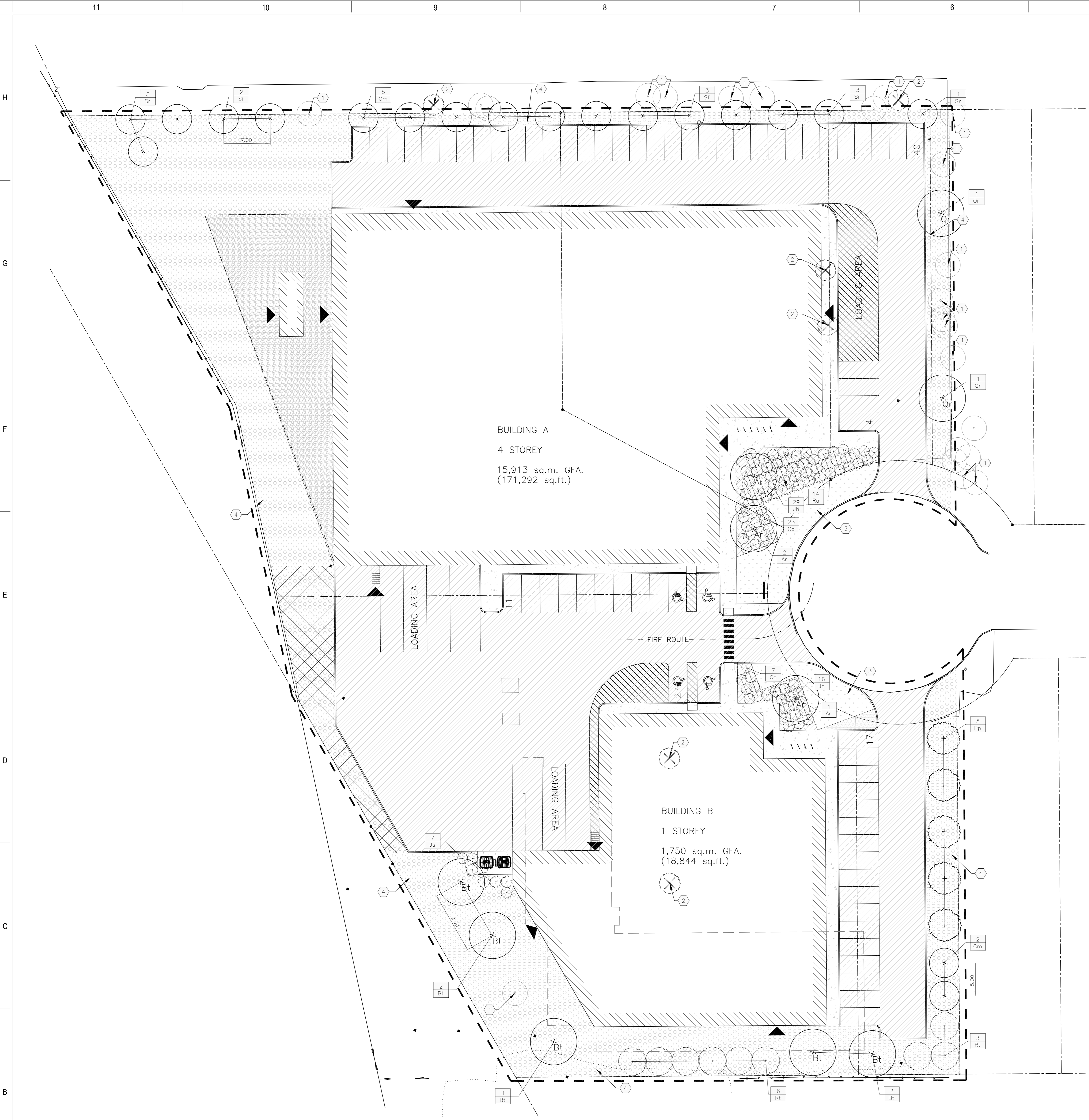

KEY	QUANTITY	BOTANICAL NAME	COMMON NAME	SPACING (mm) (75%)	SIZE	COMMENTS
<b>TREES - Deciduous</b>						
Ar	3	Acer rubrum	Red Maple	as shown	75mm Cal. B&B	TREES TO BE BALL & BURLAP. SOURCED IN SAME GROWING ZONE. ALL TREES SHOULD HAVE 5 TO 7 MAIN BRANCHES WITH DOMINANT LEADER BRANCH AND WITHOUT DEFECT. MIN ROOT ZONE VOLUME PER TREE: 21 CU. M.
St	5	Sorbus x hybrids 'Fastglat'	Columnar Oakleaf Mountain Ash	as shown	60mm Cal. B&B	
Co	7	Cotoneaster x macrobotrys 'Snowbird'	Snow Bird Hawthorn	as shown	60mm Cal. B&B	
Bt	5	Betula papyrifera	Paper Birch	as shown	75mm Cal. B&B	
Or	2	Quercus rubra	Red Oak	as shown	75mm Cal. B&B	
Sr	7	Syringa reticulata 'Inuyuki'	Inuyuki Japanese Tree Lilac	as shown	60mm Cal. B&B	
<b>TREES - Coniferous</b>						
Pp	5	Pinus pungens	Colorado Spruce	as shown	1.8m B&B	
<b>SHRUBS</b>						
Ra	14	Rhus aromatica	Fragrant Sumac	1100	5 gal.	SHRUBS TO BE IN POTS. SOURCED IN SAME GROWING ZONE. ALL SHRUBS SHOULD HAVE DENSE GROWTH, WELL ROOTED AND WITHOUT DEFECT. MIN ROOT ZONE VOLUME PER SHRUB: 5 CU. M.
Ri	9	Rhus typhina	Sagebrush Sumac	as shown	5 gal.	
Jh	45	Juniperus horizontalis 'Prince of Wales'	Prince of Wales Juniper	1200	5 gal.	
Ca	30	Cornus alba 'Balthaz'	Inuyuki Dogwood	900	5 gal.	
Js	7	Juniperus sibirica	Siberian Juniper	900	5 gal.	
<b>HYDROSEEDING AREAS</b>						
REFER TO HATCH LEGEND	205m <sup>2</sup>	Native grass seed mix: Eastern Ectocyon by DLF Pickseed		17.25kg/hectare	NA	PREPARE SOIL, INSTALL HYDROSEED, AND MAINTAIN SEEDED AREAS AS PER MANUFACTURER'S INSTRUCTIONS.

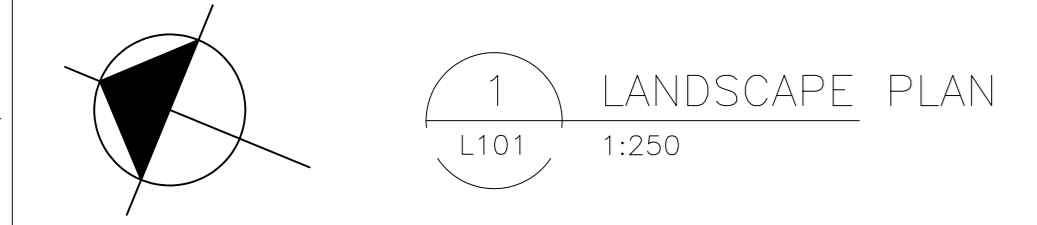

PROPOSED SELF-STORAGE  
 864 LADY ELLEN PLACE

KEY PLAN

DISCLAIMER: THE DRAWING AND DESIGN IS COPYRIGHT PROTECTED WORK AND SHALL NOT BE REPRODUCED OR TRANSMITTED IN ANY FORM OR BY ANY MEANS, ELECTRONIC OR MECHANICAL, INCLUDING PHOTOCOPYING, RECORDING, OR BY ANY INFORMATION STORAGE AND RETRIEVAL SYSTEM, WITHOUT THE WRITTEN PERMISSION OF ARCHITECTURE 49. ALL DIMENSIONS AND NOTES ARE TO BE USED AS SHOWN ON THIS DRAWING. THIS DRAWING IS NOT TO BE SCALED.

ISSUED FOR: REVISION		DATE	
1	1	03/01/2022	ISSUED FOR SPA
1	2	11/29/2022	ISSUED FOR SPA
PROJECT NO.	DATE	DESCRIPTION	
219-0008-09	2023-03-21		
DESIGNED BY:	IF THIS BAR IS NOT 25mm LONG, ADJUST YOUR PLOTTING SCALE.		
DRAWN BY:			
CHECKED BY:			
DATE OF: 2023-11-14			
LANDSCAPE ARCHITECTURE			
TITLE:			
LANDSCAPE PLAN			
SHEET NUMBER: L100 OF 101			