

# ACCESSIBLE FITNESS AREA & PING PONG AREA

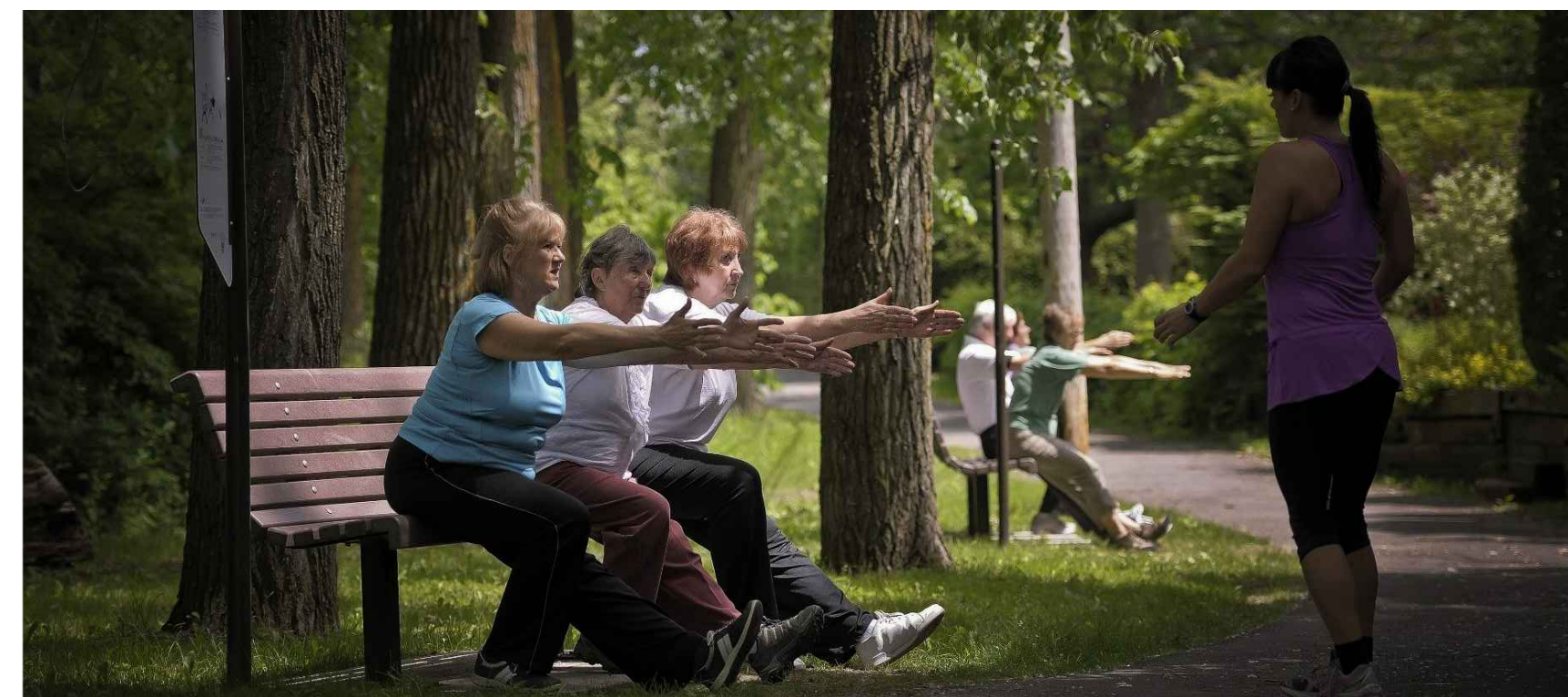

ACCESSIBLE BENCH WITH BENCH FIT

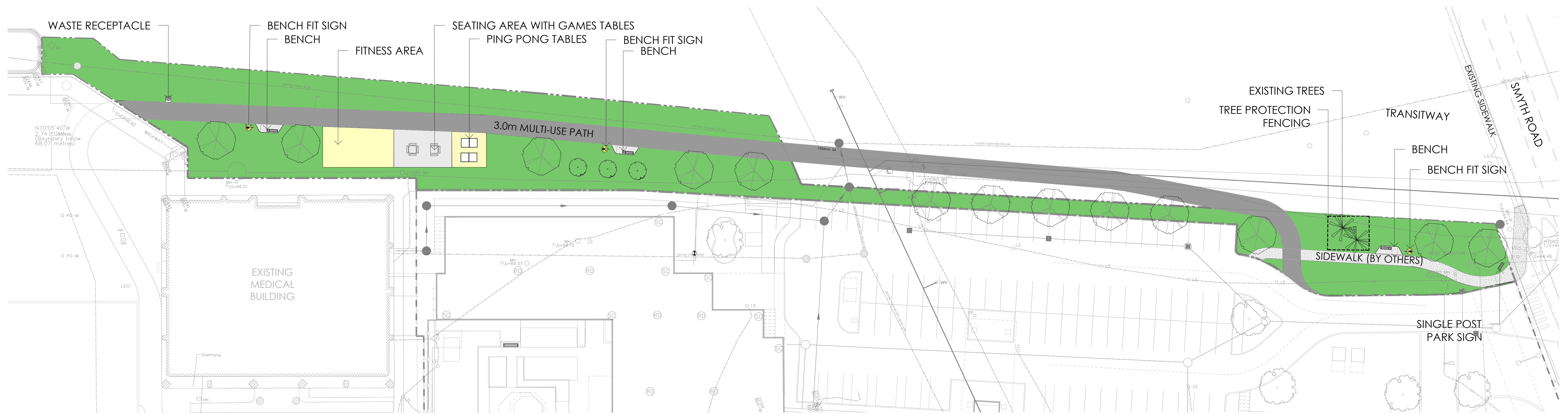

BENCH FIT SIGN



FITNESS STATION WITH ACCESSIBLE EQUIPMENT

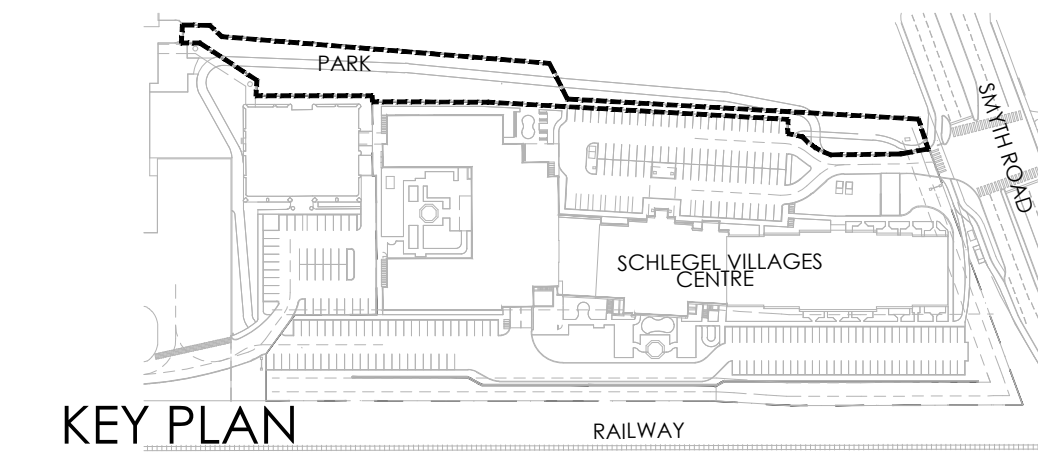

ESTIMATED CANOPY COVERAGE MATURITY				
SIZE OF TREE	AVERAGE MATURE SPREAD	CANOPY COVERAGE PER TREE	QUANTITY OF TREES	TOTAL AREA
LARGE	15m	99.4 m <sup>2</sup>	13	1,292.2m <sup>2</sup>
SMALL	5m	11.0 m <sup>2</sup>	3	33.0m <sup>2</sup>
TOTAL CANOPY COVERAGE:				1,325.2m <sup>2</sup>
TOTAL PARK AREA:				2600 m <sup>2</sup>
EST. CANOPY COVERAGE:				50%

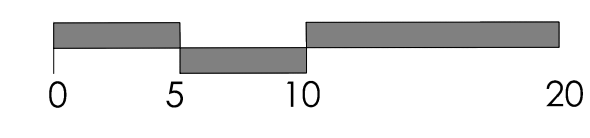

**LEGEND**

- PROPERTY LINE
- FENCING
- TREE PRESERVATION FENCE
- PLANTING
- EXISTING CONIFEROUS TREE
- DECIDUOUS TREE (OFF SITE)
- DECIDUOUS TREE
- SMALL DECIDUOUS TREE
- GRASS
- SURFACING
- FITNESS/SPORT AREA
- HEAVY DUTY ASPHALT
- C.I.P. CONCRETE PAVING
- AMENITIES
- ACCESSIBLE BENCH
- ACCESSIBLE GAME TABLE
- PARK SIGN



DECIDUOUS TREES



CONCRETE PING PONG TABLE



GAMES TABLE

