

LEGEND	
	PROPERTY LINE
	EXISTING BUILDING
	DEPRESSED CURB
	BREAK OF SLOPE - NEW
	EXISTING SANITARY SEWER
	EXISTING STORM SEWER
	EXISTING WATERMAIN
	NEW SANITARY SEWER
	NEW STORM SEWER
	NEW WATERMAIN
	NEW SILT FENCE
	NEW PERFORATED DRAIN PIPE
	NEW PERIMETER FOUNDATION DRAINAGE TO BE CONNECTED TO THE NEW STORM SEWER
	NEW LIGHT DUTY ASPHALT
	NEW HEAVY DUTY ASPHALT
	NEW CONCRETE SIDEWALK
	NEW GRASS
	NEW REINFORCED GRASS
	MILLING & OVERLAY 50mm THICK HEAVY DUTY ASPHALT AS PER CITY SPECS
	PRECAST PAVERS
	EXISTING CATCHBASIN
	EXISTING CATCHBASIN MANHOLE
	EXISTING MANHOLES
	NEW CATCHBASIN
	NEW CATCHBASIN MANHOLE
	NEW SANITARY MANHOLE
	NEW STORM MANHOLE
	NEW WATER VALVE
	NEW INLET CONTROL DEVICE
	NEW ROOF DRAIN
	NEW SCUPPER AT 150mm ABOVE ROOF DRAIN LEVEL
	NEW TRANSFORMER PAD
	EXISTING NATURAL GRADE
	PROPOSED FINISHED GRADE
	PROPOSED SLOPE
	OVERLAND FLOW ROUTE
	PROPOSED TOP OF CURB
	PROPOSED BOTTOM OF CURB

GENERAL NOTES	
1.	DESIGN AND CONSTRUCTION IS TO BE IN ACCORDANCE WITH MOST RECENT ONTARIO BUILDING CODE.
2.	THE CONTRACTOR IS RESPONSIBLE FOR CHECKING AND VERIFYING ALL DIMENSIONS WITH RESPECT TO SITE CONDITIONS AND ALL MATERIALS TO THE PROJECT. ANY DISCREPANCY SHALL BE REPORTED TO THE ENGINEER.
3.	THIS DRAWING IS TO BE READ IN CONJUNCTION WITH ALL MATERIAL RELEVANT TO THE PROJECT.
4.	ADDITIONAL DRAWINGS MAY BE ISSUED FOR CLARIFICATION TO ASSIST PROPER EXECUTION OF WORK. SUCH DRAWINGS WILL HAVE THE SAME MEANING AND INTENT AS IF THEY WERE INCLUDED WITH THE CONTRACT DOCUMENTS.
5.	CONTRACTOR MUST COMPLY WITH LOCAL BY-LAWS, ONTARIO OCCUPATIONAL HEALTH AND SAFETY ACT AND ALL REGULATIONS SET BY AUTHORITIES HAVING JURISDICTION. IN CASE OF CONFLICT OR DISCREPANCY, THE MORE STRINGENT REQUIREMENTS SHALL APPLY.
6.	CONTRACTOR RESPONSIBLE FOR OBTAINING ALL REQUIRED UTILITY LOCATES, DAYLIGHTING, INSPECTIONS, PERMITS, AND APPROVALS, INCLUDING ALL ASSOCIATED COSTS. LOCATION OF EXISTING UTILITIES ARE APPROXIMATE ONLY AND BASED ON BEST AVAILABLE INFORMATION.

DRAWING NOTES	
01	INSTALL SILT FENCE IN ACCORDANCE WITH OPSD 219.130.
02	MATCH EXISTING GRADES AT PROPERTY LINE AND LIMITS OF WORK.
03	INSTALL HEAVY DUTY PAVEMENT IN ACCORDANCE WITH DETAIL 203 ACCORDINGLY REINSTATE GRADES TO THE INTO EXISTING AND PROVIDE POSITIVE DRAINAGE TOWARDS STORM STRUCTURES.
04	INSTALL LIGHT DUTY PAVEMENT IN ACCORDANCE WITH DETAIL 103 ACCORDINGLY REINSTATE GRADES TO THE INTO EXISTING AND PROVIDE POSITIVE DRAINAGE TOWARDS STORM STRUCTURES.
05	GRADES TO SLOPE AWAY FROM THE BUILDING TO PROVIDE POSITIVE DRAINAGE.
06	ANY DISTURBED AREA WITHIN THE RIGHT-OF-WAY SHALL BE REINSTATED TO EQUAL OR BETTER CONDITION TO THE SATISFACTION OF THE CITY OF OTTAWA.
07	PROTECT EXISTING MANHOLES AND CATCHBASINS USING A FILTER SOCK OR FILTER BASE IN ACCORDANCE WITH DETAIL 403.
08	CONSTRUCT PARKING LOT LAY BY AND BUS LOOP ENTRANCE IN ACCORDANCE WITH CITY OF OTTAWA STANDARD DETAIL DRAWING SC7.1 - CURB RETURN ENTRANCES.
09	PAVEMENT TO BE WITHIN 12mm OF DOOR.
10	PROVIDE MAXIMUM 4:1 SLOPE.
11	COVER OF EXISTING CATCH BASIN TO BE MODIFIED TO TOP ENTRY GATE AS PER CITY STANDARD S19.
12	CONTRACTOR TO PROVIDE TRENCH BOX FOR EXCAVATION IN PROXIMITY OF MUNICIPAL RIGHT OF WAY.
13	NOT USED
14	TI IN NEW CONCRETE TO EXISTING CURB
15	EXISTING LIGHT STANDARD, REFER TO ARCHITECTURAL
16	PROTECT BELL JUNCTION BOX AND MANHOLE. CONTRACTOR TO COORDINATE WITH UTILITIES FOR RELOCATION AND/OR PROTECTION.
17	NEW EXTENSION OF EXISTING SIDEWALK MAINTAIN EXISTING BARRIER CURB. PROVIDE DOWELS AND JOINTS BETWEEN EXISTING AND NEW SIDEWALK EXTENSION AS APPLICABLE PER CITY OF OTTAWA STANDARD DETAILS R4, R5 AND R6. CONTRACTOR SHALL ENSURE THE STRUCTURAL INTEGRITY OF EXISTING CONCRETE SIDEWALK AND EXISTING CURB BARRIER THAT WILL REMAIN IN PLACE AND ITS UNDERLYING GRANULAR BASE WHEN COMPACTING THE SUBGRADE AND GRANULAR BASE OF THE NEW SIDEWALK EXTENSION.

EROSION AND SEDIMENT CONTROL NOTES	
1.	THE CONTRACTOR SHALL IMPLEMENT BEST MANAGEMENT PRACTICES TO PROVIDE PROTECTION OF THE AREA DRAINAGE SYSTEM AND THE RECEIVING WATER COURSE, DURING CONSTRUCTION ACTIVITIES. THIS INCLUDES LIMITING THE AMOUNT OF EXPOSED SOIL, INSTALLING SILT FENCES AND OTHER EFFECTIVE SEDIMENT TRAPS, AND INSTALLING AND MAINTAINING MUD MATS FOR OUTGOING CONSTRUCTION TRAFFIC DURING CONSTRUCTION ACTIVITIES.
2.	PREVENT SOIL LOSS DURING CONSTRUCTION (BY STORM WATER RUNOFF OR WIND EROSION).
3.	PROTECT TOPSOIL BY STOCKPILING FOR REUSE.
4.	PREVENT SEDIMENTATION OF STORM SEWERS AND RECEIVING STREAMS.
5.	PREVENT AIR POLLUTION FROM DUST AND PARTICULATE MATTER.
6.	ALL STORM MANHOLES AND CATCHBASIN MANHOLES TO HAVE 300mm SUMP. ALL CATCHBASINS TO HAVE 600mm SUMPS.
7.	INSTALL FILTER BAG INSERT IN ALL STORM MANHOLES AND CATCH BASINS IMPACTED DURING CONSTRUCTION, INCLUDING CATCH BASINS IN THE RIGHT OF WAY.
8.	SEDIMENT AND EROSION CONTROL MEASURES MAY BE MODIFIED IN THE FIELD AT THE DISCRETION OF THE CITY OF OTTAWA INSPECTOR OR CONSERVATION AUTHORITY.
9.	STORM WATER PUMPED INTO CITY SERVICE SHALL FLOW THROUGH A FILTER SOCK.
10.	THE CONTRACTOR ACKNOWLEDGES THAT FAILURE TO IMPLEMENT APPROPRIATE EROSION AND SEDIMENTATION CONTROL MEASURES MAY BE SUBJECT TO PENALTIES IMPOSED BY ANY APPLICABLE REGULATORY AGENCY.

GEOTECHNICAL NOTES	
1.	A GEOTECHNICAL ENGINEER LICENSED IN THE PROVINCE OF ONTARIO SHALL INSPECT ALL SUBGRADE SURFACES FOR FOOTING AND TRENCHES, PIPE BEDDING AND PAVEMENT STRUCTURES PRIOR TO CONSTRUCTION.
2.	IT IS STRICTLY RECOMMENDED TO REFER GEOTECHNICAL INVESTIGATION REPORT, GEOTECHNICAL INVESTIGATION PROPOSED NEW FINDLAY CREEK PUBLIC SCHOOL, 820 MIKANA ROAD, SOUTHEAST CORNER OF MIKANA ROAD AND KELLY FARM DRIVE FINDLAY CREEK COMMUNITY BY EXP SERVICES INC.
3.	IT IS ANTICIPATED THAT THE MAJORITY OF THE MATERIAL REQUIRED FOR BACKFILL PURPOSES AND FOR TRENCH BACKFILL WOULD HAVE TO BE IMPORTED AND SHOULD CONFORM TO THE RECOMMENDATION STATED IN THE GEOTECHNICAL REPORT.
4.	CONTRACTOR BIDDING ON THIS PROJECT MUST REVIEW AVAILABLE DATA AND DECIDE ON THEIR OWN THE BEST METHOD FOR THE EXCAVATION OF THE BEDROCK IF DEEMED REQUIRED.
5.	IT IS RECOMMENDED THAT THE BEDDING FOR THE UNDERGROUND SERVICES INCLUDING MATERIAL SPECIFICATIONS, THICKNESS OF COVER MATERIAL AND COMPACTION REQUIREMENTS CONFORM TO MUNICIPAL REQUIREMENTS AND/OR ONTARIO PROVINCIAL STANDARD SPECIFICATION AND DRAWINGS (OPSS AND OPSD).
6.	IT IS RECOMMENDED THAT THE PIPE BEDDING BE 300 MM THICK AND CONSIST OF OPSD GRANULAR A. THE BEDDING MATERIAL SHOULD BE PLACED ALONG THE SIDES AND ON TOP OF THE PIPE TO PROVIDE A MINIMUM COVER OF 300 MM. THE BEDDING SHOULD BE COMPACTED TO AT LEAST 98 PERCENT OF THE SPMD.
7.	THE BEDDING THICKNESS MAY BE FURTHER INCREASED IN AREAS WHERE THE SUBGRADE BECOMES DISTURBED.
8.	SINCE PAVED SURFACES WILL BE LOCATED OVER SERVICE TRENCHES, IT IS RECOMMENDED THAT THE TRENCH BACKFILL MATERIAL WITHIN THE FROST ZONE (UP TO +1.8 M BELOW FINISHED GRADE), SHOULD MATCH THE EXISTING MATERIAL IN THE ROADWAY TO MINIMIZE DIFFERENTIAL FROST HEAVING OF THE SUBGRADE. THE TRENCH BACKFILL SHOULD BE PLACED IN 300 MM THICK LIFTS AND EACH LIFT SHOULD BE COMPACTED TO 95 PERCENT SPMD.
9.	THE BEDROCK/CLINGER REUSAL, DEPTHS ACROSS THE SITE WERE VARIABLE. SHALLOW BEDROCK AND LARGE BOULDERS SHOULD BE EXPECTED DURING THE INSTALLATION OF ANY SERVICES AT THE SITE AND CONTRACTORS BIDDING ON THIS WORK SHOULD ANTICIPATE THESE CONDITIONS.
10.	IT IS ANTICIPATED THAT THE MAJORITY OF THE MATERIAL REQUIRED FOR TRENCH BACKFILL AND SUBGRADE FILL IN PARKING AREA AND ACCESS ROADS WOULD HAVE TO BE IMPORTED AND SHOULD CONFORM TO OPSD 1010 SILET SUBGRADE MATERIAL (SSM) COMPACTED TO 95 PERCENT OF THE SPMD AND THE UPPER 300 MM OF THE SUBGRADE FILL MUST BE COMPACTED TO 98% SPMD.
11.	AS PART OF THE SUBGRADE PREPARATION, THE PROPOSED PARKING AREA, PAVED AREA AND ACCESS ROADS SHOULD BE STRIPPED OF TOPSOIL AND OTHER OBVIOUSLY UNSUITABLE MATERIAL. THE SUBGRADE SHOULD BE PROPERLY SHAPED, CROWNED, THEN PROOF ROLLED WITH A HEAVY VIBRATORY ROLLER IN THE FULL-TIME PRESENCE OF A REPRESENTATIVE OF THIS OFFICE. ANY SOFT OR SPONGY SUBGRADE AREAS DETECTED SHOULD BE SUB EXCAVATED AND PROPERLY REPLACED WITH SUITABLE APPROVED BACKFILL COMPACTED TO 95 PERCENT SPMD (ASTM D698-12E2).
12.	THE SUBDRAINS ILLUSTRATED ON PLANS ARE SCHEMATIC. FULL SCHEME OF SUBDRAINS SHOULD BE INSTALLED ON BOTH SIDES OF THE ACCESS ROAD(S). SUBDRAINS SHOULD BE INSTALLED ON BOTH SIDES OF THE ACCESS ROAD(S). SUBDRAINS MUST BE INSTALLED IN THE PROPOSED PARKING AREA AT LOW POINTS AND SHOULD BE CONTINUED BETWEEN CATCHBASINS TO INTERCEPT EXCESS SURFACE AND SUBSURFACE MOISTURE AND TO PREVENT SUBGRADE SOFTENING. THIS WILL ENSURE NO WATER COLLECTS IN THE DRAINAGE COURSE, WHICH COULD RESULT IN PAVEMENT FAILURE DURING THE SPRING THAW. THE LOCATION AND EXTENT OF SUBDRAINS REQUIRED WITHIN THE PAVED AREAS SHOULD BE REVIEWED BY THE GEOTECHNICAL ENGINEER IN CONJUNCTION WITH THE PROPOSED SITE GRADING.
13.	TO MINIMIZE THE PROBLEMS OF DIFFERENTIAL MOVEMENT BETWEEN THE PAVEMENT AND CATCHBASIN/MANHOLE DUE TO FROST ACTION, THE BACKFILL AROUND THE STRUCTURES SHOULD CONSIST OF FREE-DRAINING GRANULAR PREFERABLY CONFORMING TO OPSD GRANULAR B TYPE II MATERIAL. WEEP HOLES SHOULD BE PROVIDED IN THE CATCHBASIN/MANHOLES TO FACILITATE DRAINAGE OF ANY WATER THAT MAY ACCUMULATE IN THE GRANULAR FILL.
14.	THE MOST SEVERE LOADING CONDITIONS ON LIGHT-DUTY PAVEMENT AREAS AND THE SUBGRADE MAY OCCUR DURING CONSTRUCTION. CONSEQUENTLY, SPECIAL PROVISIONS SUCH AS RESTRICTED Lanes, HALF-LOADS DURING PAVING, TEMPORARY CONSTRUCTION ROADWAYS, ETC., MAY BE REQUIRED, ESPECIALLY IF CONSTRUCTION IS CARRIED OUT DURING UNFAVORABLE WEATHER.
15.	THE FINISHED PAVEMENT SURFACE SHOULD BE FREE OF DEPRESSIONS AND SHOULD BE SLOPED (PREFERABLY AT A MINIMUM CROSS FALL OF 2 PERCENT) TO PROVIDE EFFECTIVE SURFACE DRAINAGE TOWARDS CATCH BASINS. SURFACE WATER SHOULD NOT BE ALLOWED TO POND ADJACENT TO THE OUTSIDE EDGES OF PAVED AREAS.
16.	RELATIVELY WEAKER SUBGRADE MAY DEVELOP OVER SERVICE TRENCHES AT SUBGRADE LEVEL. THESE AREAS MAY REQUIRE THE USE OF THICKER COMMER SUB-BASE MATERIAL AND THE USE OF A GEOTEXTILE AT THE SUBGRADE LEVEL. IF THIS IS THE CASE, IT IS RECOMMENDED THAT ADDITIONAL 150 MM THICK GRANULAR SUB-BASE, OPSD GRANULAR B TYPE II, SHOULD BE PROVIDED IN THESE AREAS, IN ADDITION TO THE USE OF A GEOTEXTILE AT THE SUBGRADE LEVEL.
17.	THE GRANULAR MATERIALS USED FOR PAVEMENT CONSTRUCTION SHOULD CONFORM TO ONTARIO PROVINCIAL STANDARD SPECIFICATIONS (OPSS 1010) FOR GRANULAR A AND GRANULAR B TYPE II AND SHOULD BE COMPACTED TO 100 PERCENT OF THE SPMD.
18.	THE ASPHALTIC CONCRETE USED, AND ITS PLACEMENT SHOULD MEET OPSD 1150 OR 1151 REQUIREMENTS. IT SHOULD BE COMPACTED FROM 92 PERCENT TO 97 PERCENT OF THE MRD (ASTM D2041), ASPHALT PLACEMENT SHOULD BE IN ACCORDANCE WITH OPSD 310 AND OPSD 313.
19.	ALL EARTHWORK ACTIVITIES FROM PLACEMENT AND COMPACTION OF FILL IN THE SERVICE TRENCHES TO SUBGRADE PREPARATION, PLACEMENT AND COMPACTION OF GRANULAR MATERIALS AND ASPHALTIC CONCRETE SHOULD BE INSPECTED BY QUALIFIED GEOTECHNICALS TO ENSURE THAT CONSTRUCTION OF THE SEWERS AND PAVEMENT PROCEEDS ACCORDING TO THE SPECIFICATIONS.
20.	STRINGENT CONSTRUCTION CONTROL PROCEDURES SHOULD BE MAINTAINED TO ENSURE THAT UNIFORM SUBGRADE MOISTURE AND DENSITY CONDITIONS ARE ACHIEVED.
21.	SHOULD SURFACE AND SUBSURFACE WATER SEEPAGE OCCUR INTO THE EXCAVATIONS COLLECT ANY WATER ENTERING THE EXCAVATIONS AND REMOVE IT BY PUMPING FROM SUMP.
22.	IF THE BACKFILL IN THE SERVICE TRENCHES WILL CONSIST OF GRANULAR FILL, CLAY SEALS SHOULD BE INSTALLED IN THE SERVICE TRENCHES AT SELECT INTERVALS (SPACING) AS PER CITY OF OTTAWA DRAWING NO. S8. THE SEALS SHOULD BE 1 M WIDE, EXTEND OVER THE ENTIRE TRENCH WIDTH AND FROM THE BOTTOM OF THE TRENCH TO THE UNDERSIDE OF THE PAVEMENT STRUCTURE. THE CLAY SHOULD BE COMPACTED TO 95 PERCENT SPMD. THE PURPOSE OF THE CLAY SEALS IS TO PREVENT THE PERMANENT LOWERING OF THE GROUNDWATER LEVEL. CLAY SEAL LOCATIONS SHALL BE APPROVED BY THE GEOTECHNICAL ENGINEER.
23.	IT IS RECOMMENDED THAT A GEOTEXTILE BE PLACED ON THE SURFACE OF THE SUBGRADE PRIOR TO PLACEMENT OF ANY GRANULAR SUB-BASE. THIS MUST BE ALLOWED FOR BY THE CONTRACTOR AND INSTALLED WHEN DIRECTED BY THE GEOTECHNICAL ENGINEER.
24.	THE MUNICIPAL SERVICES SHOULD BE INSTALLED IN SHORT OPEN TRENCH SECTIONS THAT ARE EXCAVATED AND BACKFILLED THE SAME DAY.

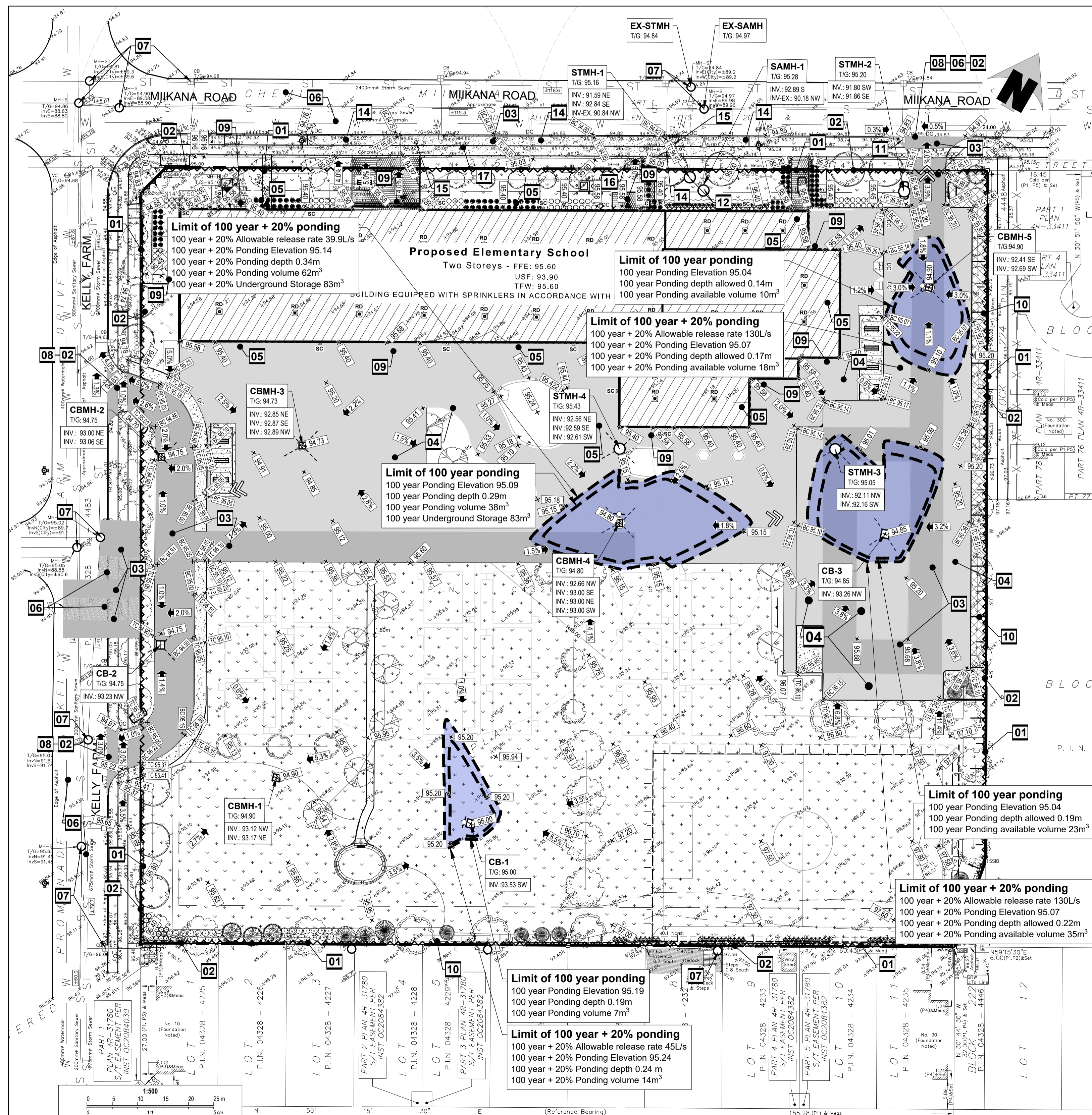

APPROVED
By Lily Xu at 3:28 pm, Apr 04, 2023

Lily Xu

LILY XU, MCIP, RPP
MANAGER, DEVELOPMENT REVIEW SOUTH
PLANNING, INFRASTRUCTURE & ECONOMIC
DEVELOPMENT DEPARTMENT, CITY OF OTTAWA



Jp2g Consultants Inc.
ENGINEERS • PLANNERS • PROJECT MANAGERS
1150 Morrison Drive, Suite 410, Ottawa, ONT.
Phone: (613) 628-7800 Fax: (613) 628-2600
21-5124A

Site Location

No.	DESCRIPTION	YYYY-MM-DD
6	ISSUED FOR SITE PLAN CONTROL REV-4	2023-03-30
5	ISSUED FOR SITE PLAN CONTROL REV-3	2023-03-07
4	ISSUED FOR TENDER REVIEW	2023-01-20
3	ISSUED FOR PERMIT ISSUANCE	2022-11-18
2	ISSUED FOR SITE PLAN CONTROL REV-2	2022-10-27
1	ISSUED FOR SITE PLAN CONTROL REV-1	2022-06-28

N45 ARCHITECTURE INC.
71 Bank Street, 7th Floor - Ottawa, Ontario K1P 5N2
tel. 613.224.0095 fax 613.224.9811

project
Findlay Creek #2 Public School

820 Miikana Road, Ottawa, Ontario
K1X 0G5

seal

drawing title	
Site Grading, Erosion and Sediment Control Plan	
scale As shown	drawn by R.I.
date June 2022	checked by A.S.
project number 22-719	drawing number C2
CONTRACTOR TO VERIFY ALL DIMENSIONS AND NOTIFY THE ARCHITECT OF ANY DISCREPANCIES BEFORE WORK COMMENCES. DO NOT SCALE DRAWINGS.	
revision	

D07-12-22-0110