

**OTTAWA - CARLETON DISTRICT SCHOOL BOARD**

**NOTE:**  
SEE CIVIL DRAWINGS FOR SITE SERVICING / GRADING.

**THIS PLAN IS ISSUED FOR SITE PLAN CONTROL SUBMISSION ONLY.**

**ADDITIONAL DETAILING AND SPECIFICATIONS ARE REQUIRED PRIOR TO TENDERING AND CONSTRUCTION.**

**LEGEND**

	PROPERTY LINE		STONEDUST PATHWAY / PAVEMENT
	CHAIN LINK FENCE		PRECAST CONCRETE PAVERS
	SOCCER BACKSTOP FENCE		REFORESTATION AREA
	ASPHALT PAVEMENT		SOD
	CONCRETE PAVEMENT		SOIL VOLUME AREAS
	EWF PLAYGROUND SURFACE		

**Plant List**

ID	Qty	Botanical name	Common name	Sched. size	Remarks
<b>STANDARD PLANTING</b>					
<b>Caliper Trees</b>					
Ab	3	Abies balsamea	Balsam Fir	200cm ht.	WB, Staked
AnG	3	Acer nigrum 'Green Column'	Green Column Black Maple	60mm caliper	WB, Staked
ArAS	3	Acer rubrum 'Autumn Spire'	Red Maple	70mm caliper	WB, Staked
As	6	Acer saccharum	Sugar Maple	70mm caliper	WB, Staked
Ca	12	Celtis occidentalis	Hackberry	70mm caliper	WB, Staked
CaPS	10	Celtis occidentalis 'Prairie Sentinel'	Prairie Sentinel Hackberry	60mm caliper	WB, Staked
GAAG	3	Ginkgo biloba 'Autumn Gold'	Autumn Gold Maidenhair Tree	60mm caliper	WB, Staked
GBS	2	Ginkgo biloba 'Princeton Sentry'	Princeton Sentry Maidenhair Tree	70mm caliper	WB, Staked
GHS	3	Ginkgo biloba 'Saratoga'	Saratoga Maidenhair Tree	60mm caliper	WB, Staked
GD	8	Gleditsia triacanthos 'Draves'	Streetkeeper Honeylocust	60mm caliper	WB, Staked
GS	2	Gleditsia triacanthos 'Shademaster'	Gleditsia Shademaster	70mm caliper	WB, Staked
Pg	9	Picea glauca	White Spruce	200cm ht.	WB, Staked
Pp	2	Picea pungens	Colorado Spruce	200cm ht.	WB, Staked
Ps	3	Pinus strobus	Eastern White Pine	200cm ht.	WB, Staked
Qm	7	Quercus macrocarpa	Burr Oak	70mm caliper	WB, Staked
Qr	8	Quercus rubra	Northern Red Oak	70mm caliper	WB, Staked
UF	9	Ulmus 'Frontier'	Frontier Elm	70mm caliper	WB, Staked
<b>Shrubs</b>					
Cr	44	Cornus racemosa	Gray Dogwood	50cm ht.	Bare root
Sa	39	Symphoricarpos albus	Snowberry	50cm ht.	Potted
<b>Perennials</b>					
Hs	#	Helictrochon sempervirens	Ornamental Oats	1 gallon pot	1 gallon pot
CaKF	#	Calamagrostis x acutiflora 'Karl Foerster'	Feather Reed Grass	1 gallon pot	Potted
PVA	#	Perennial Mix A - Sun-Shade	Perennial variety Sun-Shade	150mm pot	
<b>REFORESTATION</b>					
<b>Reforestation Trees</b>					
Asa for	6	Acer saccharum	Sugar Maple	150cm ht.	Bare root
Ase for	6	Acer rubrum	Red Maple	150cm ht.	Bare root
Ba for	6	Betula alleghaniensis	Yellow Birch	150cm ht.	Bare root
Bp for	6	Betula papyrifera	White Birch	150cm ht.	Bare root
Cc for	6	Carya cordiformis	Bitternut Hickory	150cm ht.	Bare root
Cg for	6	Carya glabra	Pignut Hickory	150cm ht.	Bare root
Co for	6	Celtis occidentalis	Common Hackberry	150cm ht.	Bare root
Gt for	6	Gleditsia triacanthos inermis	Thornless Honeylocust	150cm ht.	Bare root
Jn for	6	Juglans nigra	Black Walnut	150cm ht.	Bare root
Ll for	6	Larix laricina	American Larch Tamarack	75cm ht.	Potted
Ov for	6	Ostrya virginiana	American Hophornbeam	150cm ht.	Bare root
Pb for	6	Pinus barksiana	Jack Pine	75cm ht.	Potted
Pg for	6	Picea glauca	White Spruce	75cm ht.	Potted
Pgr for	6	Populus grandidentata	Bigtooth Aspen	150cm ht.	Bare root
Ppe for	6	Prunus pensylvanica	Pin Cherry	150cm ht.	Bare root
Ps for	6	Pinus strobus	White Pine	75cm ht.	Potted
Qa for	6	Quercus alba	White Oak	150cm ht.	Bare root
Qm for	6	Quercus macrocarpa	Bur Oak	150cm ht.	Bare root
Ta for	6	Tilia americana	Basswood	150cm ht.	Bare root
Tc for	6	Tsuga canadensis	Canadian Hemlock	75cm ht.	Potted

**GENERAL NOTES**

- All general site information and conditions compiled from existing plans, surveys and consultant's field notes. Report all discrepancies prior to any work. No responsibility is born by the Consultant for unknown subsurface conditions.
- The location of the utilities is approximate only, and the exact location should be determined by consulting the municipal authorities and utility companies concerned. The Contractor shall prove the location of utilities and shall be responsible for adequate protection from damage.
- All dimensions shown are to be verified on site prior to any construction. No deviations are to be made from the layouts as shown on this plan without prior consultation with the Landscape Architect and Owner.
- Obtain approval of Landscape Architect for granular base and layout of all pavement areas prior to construction.
- Stake planting locations and receive approval of Landscape Architect, prior to excavation of any planting pits. No substitutions of plant material shall be made without prior approval of the Landscape Architect.
- Where clay is encountered proper drainage must be ensured in tree/shrub pits, prior to planting. Have method approved by Landscape Architect.
- All sodded areas to receive a minimum of 150mm of topsoil over graded sub-base. If sod with mesh is used, mesh to be removed completely during sodding operations. Sod shall come from an approved source and shall be laid within 24 hours of being cut in the nursery. Only nursery sod shall be used.
- Final subgrade is to be approved by the Landscape Architect prior to sod being laid.
- Maintain positive surface runoff through the entire construction period.
- Reinststate all areas and items damaged as a result of construction activities.

no.	revision	date
06		
05		
04	Re-issued for Site Plan Control	2023/03/30
03	Re-issued for Site Plan Control	2023/02/17
02	Re-issued for Site Plan Control	2022/11/04
01	Issued for Site Plan Control	2022/06/28

**N45 ARCHITECTURE INC.**  
71 Bank Street, 7th Floor - Ottawa, Ontario, K1P 5N2  
tel. 613.224.0095 fax 613.224.9811

**Ruhland & Associates Ltd**  
landscape architecture • urban design • site planning  
Ph 613-224-4244 Fx 613-224-1131 info@rala.ca www.rala.ca

**FINDLAY CREEK #2 PUBLIC SCHOOL**  
OTTAWA-CARLETON DISTRICT SCHOOL BOARD

820 MIKANA ROAD  
OTTAWA, ON

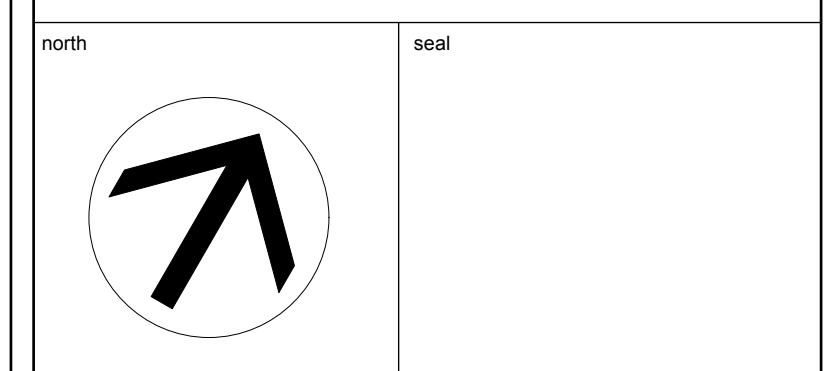

**LANDSCAPE / PLANTING PLAN**

scale	1:400	drawn by	A.A / T.F
date	2020-12-18	checked by	M.R.
project number	N45 20-600	drawing number	L-01
RA	20-1631		

CONTRACTOR TO VERIFY ALL DIMENSIONS AND NOTIFY THE ARCHITECT OF ANY DISCREPANCIES BEFORE WORK COMMENCES.

DO NOT SCALE DRAWINGS

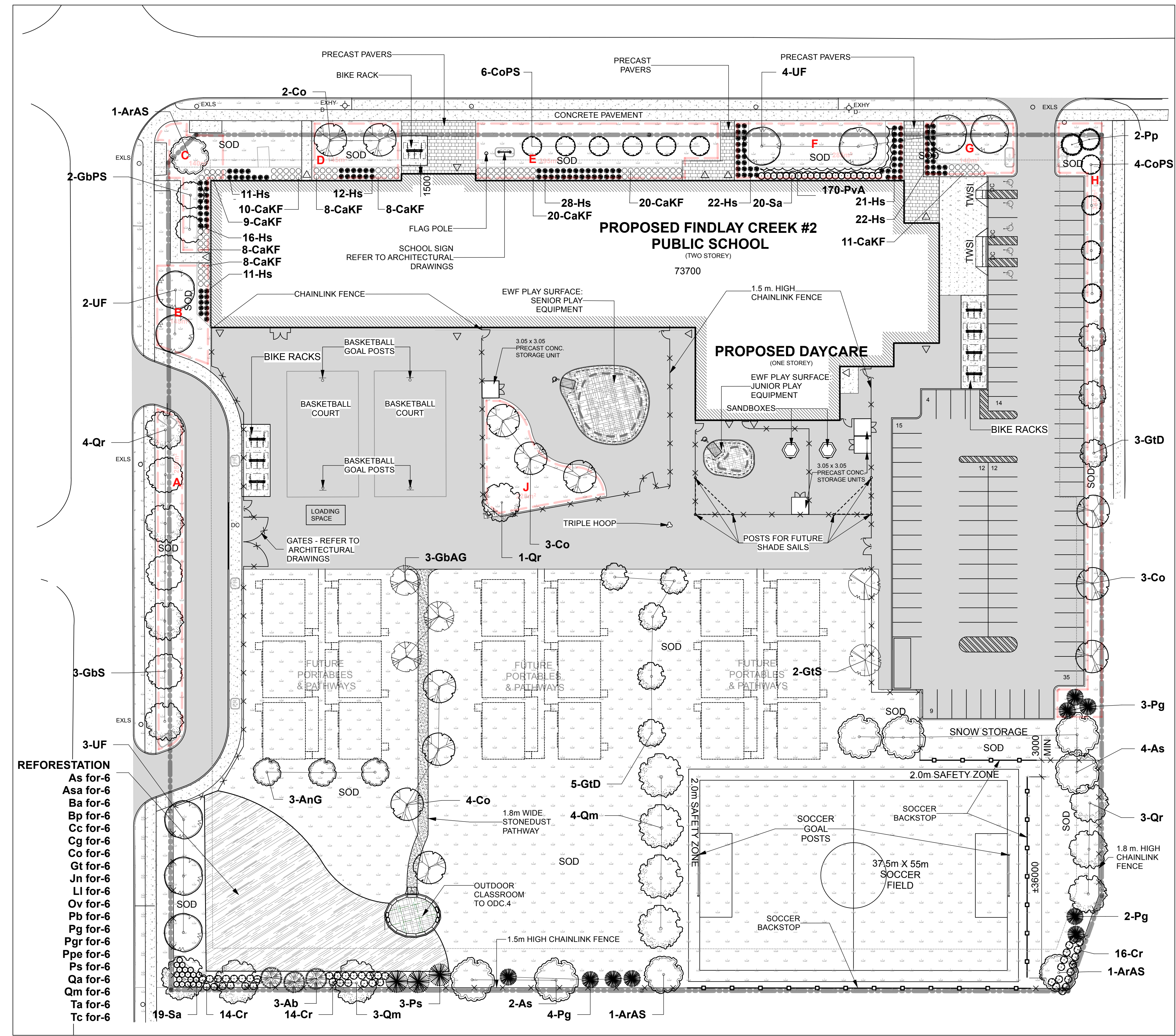

**LANDSCAPE / PLANTING PLAN**  
Scale: 1:400



**APPROVED**  
By Lily Xu at 3:28 pm, Apr 04, 2023

LILY XU, MCIP, RPP  
MANAGER, DEVELOPMENT REVIEW SOUTH PLANNING, INFRASTRUCTURE & ECONOMIC DEVELOPMENT DEPARTMENT, CITY OF OTTAWA

# 18804