

HUNTMAR DRIVE

THIS PLAN IS TO BE READ IN CONJUNCTION WITH CIVIL PLANS 122151-NLD1&2, 122151-GP1&2 AND 122151-GR1&GR2

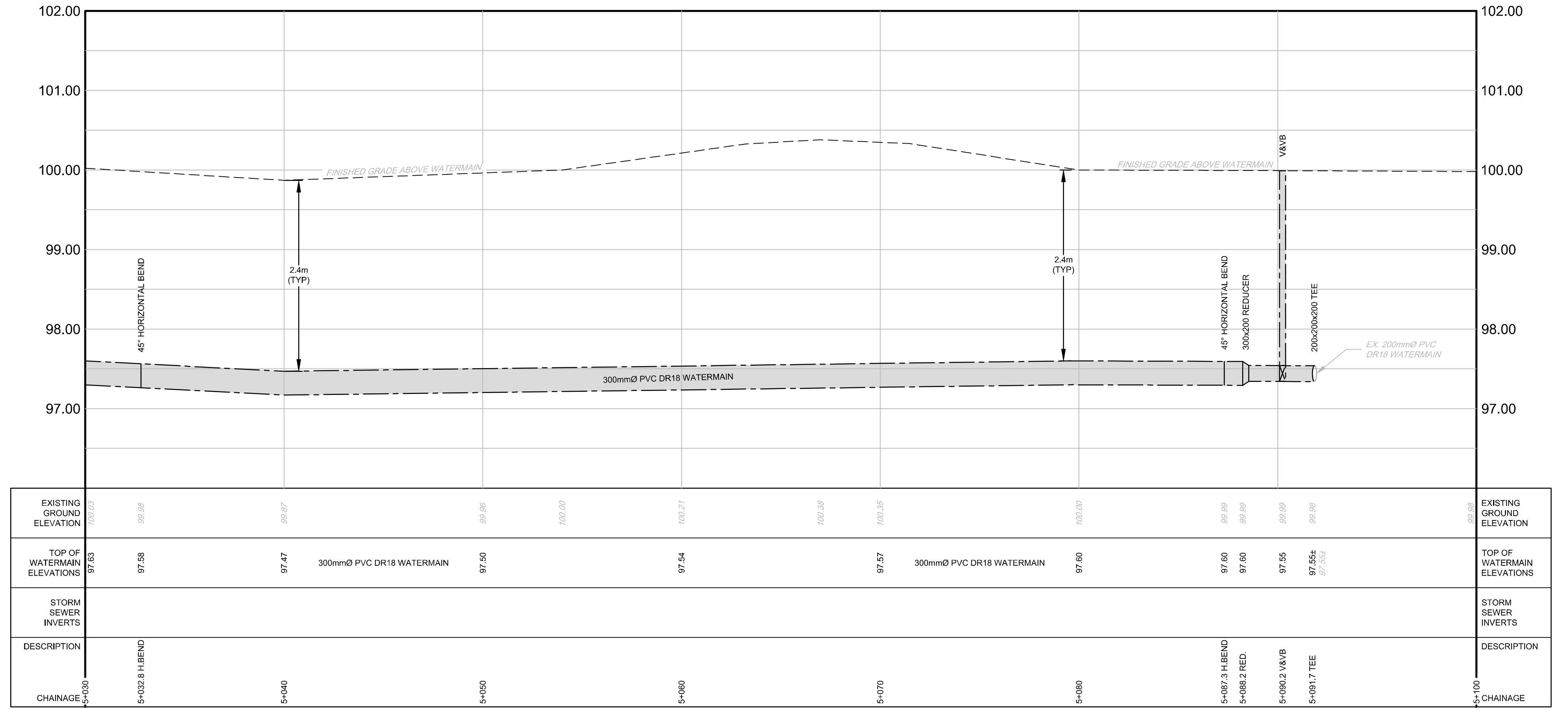
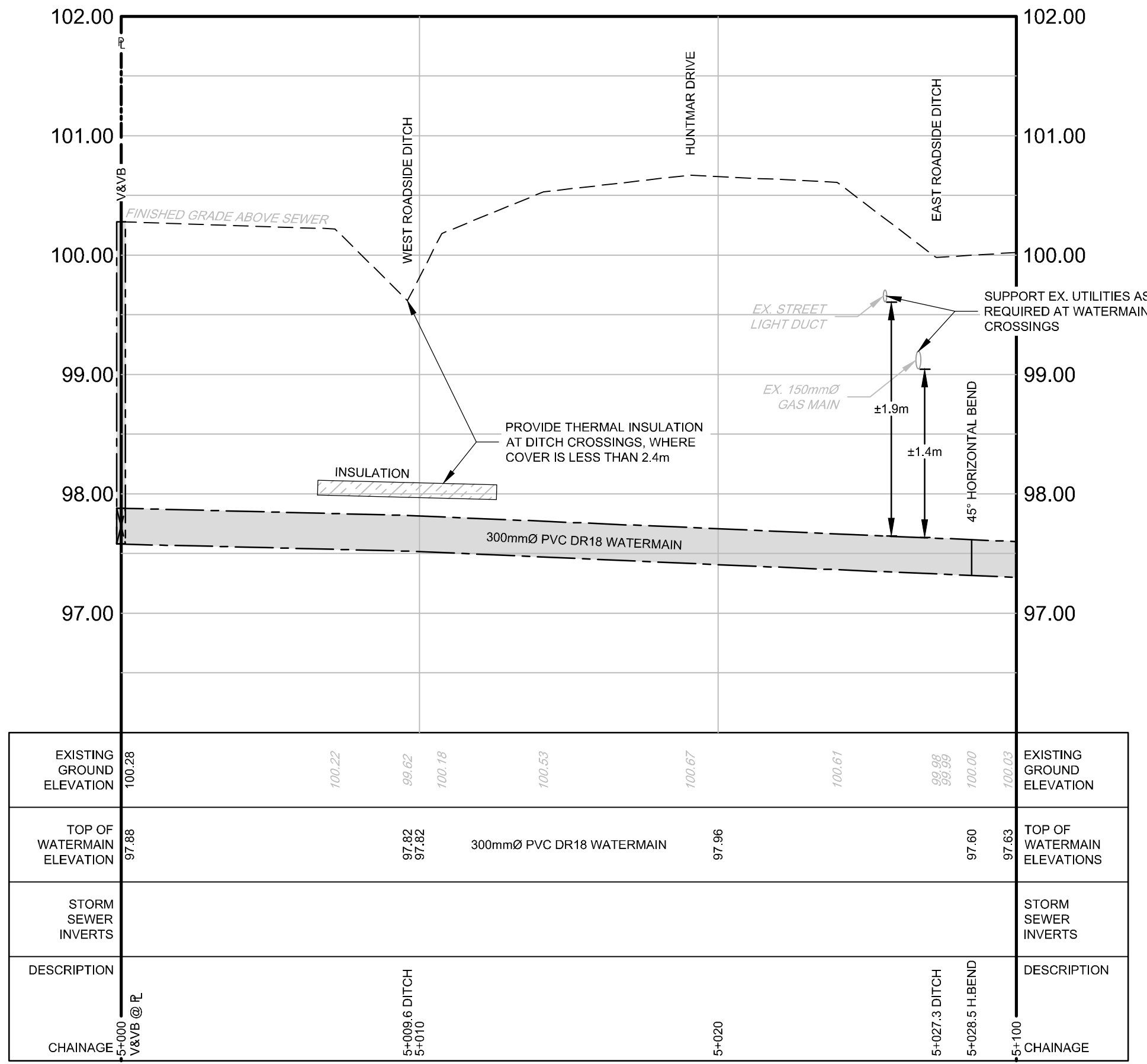

NOTE: THE POSITION OF ALL POLE LINES, CONDUITS, WATERMANS, SEWERS AND OTHER UNDERGROUND AND OVERGROUND UTILITIES AND STRUCTURES IS NOT NECESSARILY SHOWN ON THE CONTRACT DRAWINGS, AND WHERE SHOWN, THE ACCURACY OF THE POSITION OF SUCH UTILITIES AND STRUCTURES IS NOT GUARANTEED. BEFORE STARTING WORK, DETERMINE THE EXACT LOCATION OF ALL SUCH UTILITIES AND STRUCTURES AND ASSUME ALL LIABILITY FOR DAMAGE TO THEM.

| No. | REVISION | DATE | BY |
|-----|----------------------------------|-----------|-----|
| 2 | REVISED PER CITY COMMENTS | MAR 30/23 | DDB |
| 1 | ISSUED FOR CITY OF OTTAWA REVIEW | DEC 16/22 | DDB |

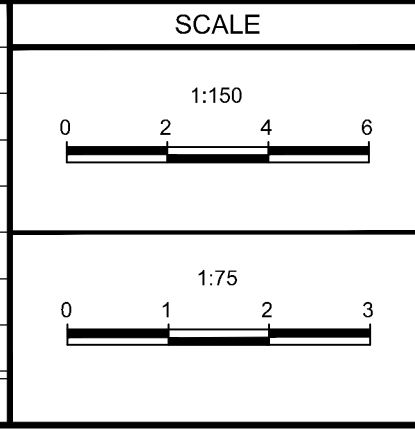

DESIGN: SM / BM / DDB
 CHECKED: DDB
 DRAWN: SM
 CHECKED: BM / DDB
 APPROVED: DDB

FOR REVIEW ONLY

PROFESSIONAL ENGINEER
 D. D. BLAIR
 103122737
 Mar 30 2023
 PROVINCE OF ONTARIO

NOVATECH
 Engineers, Planners & Landscape Architects
 Suite 200, 240 Michael Cowpland Drive
 Ottawa, Ontario, Canada K2M 1P6
 Telephone: (613) 254-9643
 Facsimile: (613) 254-5867
 Website: www.novatech-eng.com

LOCATION: CITY OF OTTAWA, 405 HUNTMAR DRIVE - WAREHOUSE DEVELOPMENT
 DRAWING NAME: PLAN and PROFILE OFF-SITE WATERMAIN EXTENSION STATION 5+000 to 5+100
 PROJECT NO.: 122151
 REV: REV #2
 DRAWING NO.: 122151-PR1