

**PROJECT TEAM**

**ARCHITECT**  
 HOBIN ARCHITECTURE  
 PATRICK BISSON  
 T: 613-238-7200

**PLANNING**  
 FOTENY CONSULTANTS INC.  
 ANGELO TREMBLAY  
 T: 613-730-5709

**CIVIL**  
 NOVATECH  
 LEE SHEETS  
 T: 613-254-9643 X209

**LANDSCAPE ARCHITECT**  
 PROJECT PASSAGE  
 SERGE GALLAN  
 T: 614-891-5442

**TRANSPORTATION**  
 NOVATECH  
 JENNIFER LUONG  
 T: 613-254-9643 X254

**ENVIRONMENTAL**  
 GRADIENT WIND ENGINEERING  
 JOSHUA FOSTER  
 T: 613-834-0634

**SURVEYOR**  
 STANTEC  
 BRIAN WEBSTER  
 T: 613-229-7444

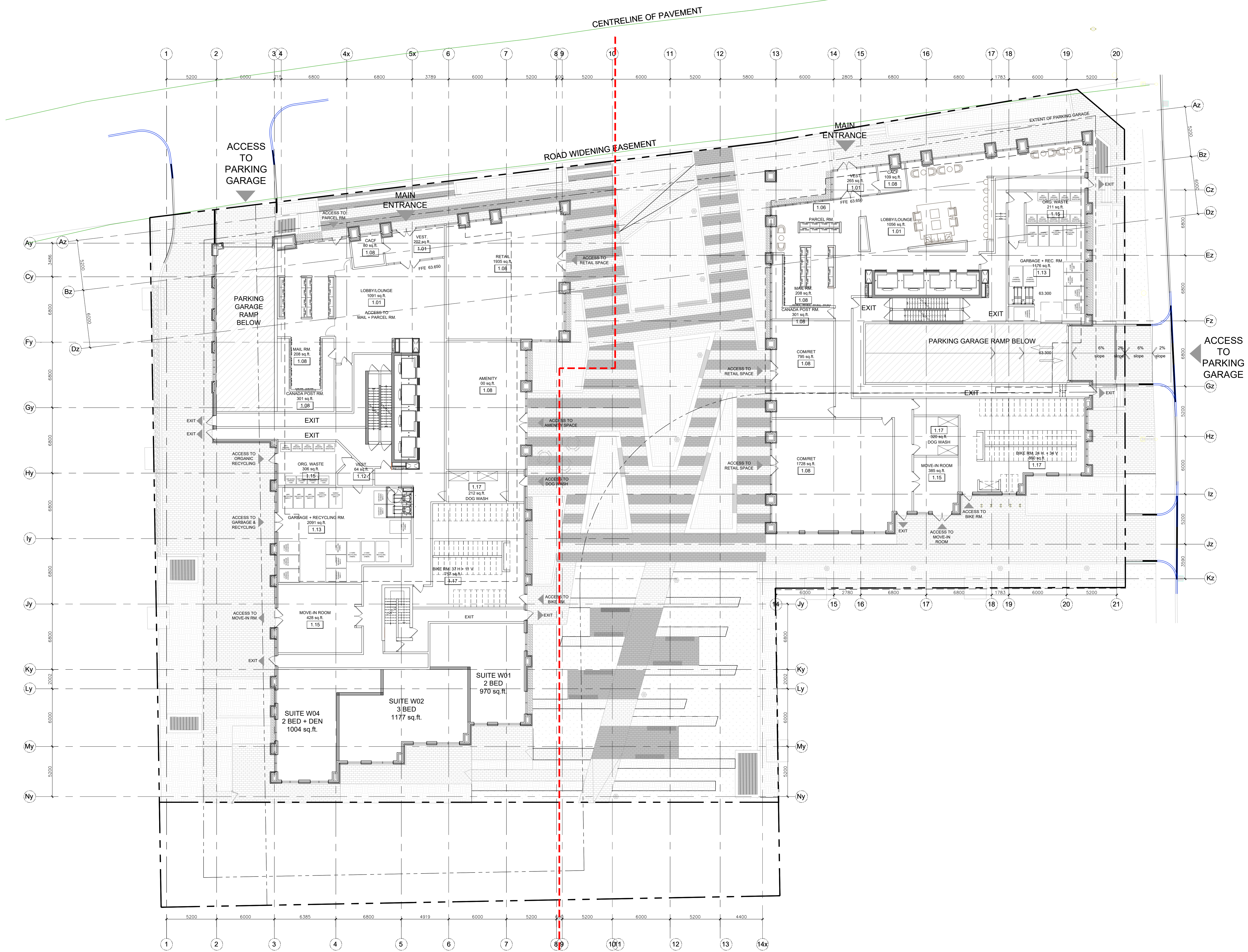

no.	date	revision
3	23-02-22	ISSUED FOR SITE PLAN CONTROL
2	22-04-07	ISSUED FOR REZONING
1	21-06-08	CITY OF OTTAWA PRECONSULTATION

It is the responsibility of the appropriate contractor to check and verify all dimensions on site and report all errors and/or omissions to the architect.

All contractors must comply with all pertinent codes and by-laws.

Do not scale drawings.

This drawing may not be used for construction until signed.

Copyright reserved.

**Hobin Architecture Incorporated**  
 63 Pamela Street  
 Ottawa, Ontario  
 Canada K1S 3K7  
 T: 613 238 7200  
 F: 613 235 2005  
 E: mail@hobinarc.com  
 hobinarc.com

**PROJECT LOCATION:**  
 MORLEY HOPPNER LTD.  
 314 & 318 ATHLONE AVE., 2006,2020, 2026 SCOTT ST.  
 OTTAWA ON.

**DRAWING TITLE:**  
 GROUND LEVEL PLAN

**DRAWN BY:** DATE: SCALE:  
 PB 23-02-22 1/150

**PROJECT:**  
 2126

**DRAWING NO.:**  
 A2.00

**REVISION NO.:**

